

ADMMR0007-014

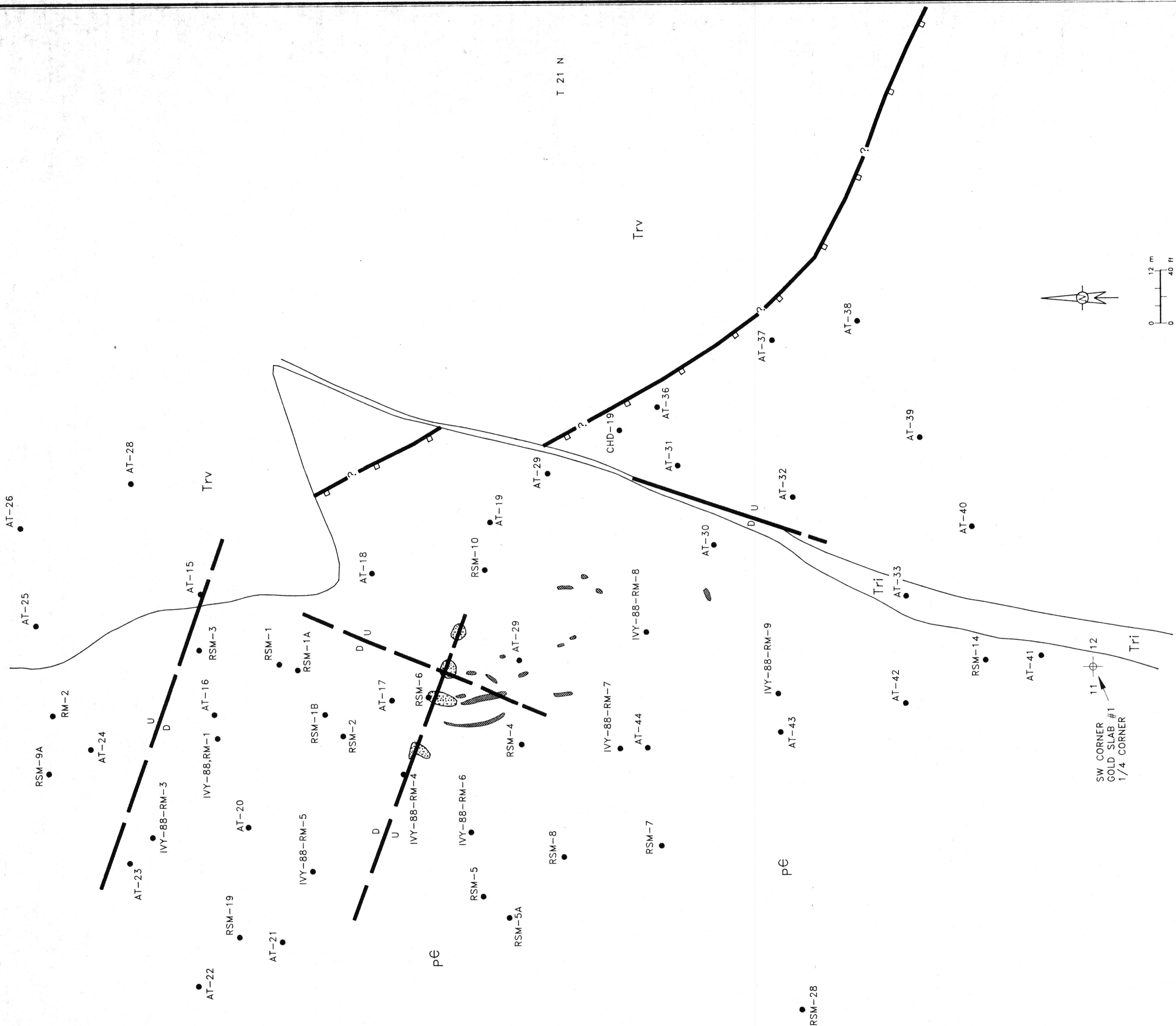

- EXPLANATION**
- DRILL HOLE
 - DETACHMENT FAULT
 - FAULT
 - [Pattern] OREGRADE (>0.03 OZ/TON Au) UNDERGROUND SAMPLES PROJECTED TO SURFACE
 - [Pattern] TERTIARY BRECCIA
 - [Pattern] TERTIARY RHYOLITE INTRUSIVE
 - [Pattern] TERTIARY RHYOLITE VOLCANICS
 - [Pattern] PRECAMBRIAN GRANITE

R 21 W

RSM-18

ADMMR0007-014

Supervisor:	Date drawn: 03/12/90	AMERICAN COPPER AND NICKEL CO., INC. SPARKS, NEVADA Project: ROADSIDE Area: MOHAVE COUNTY NEVADA GEOLOGY & DRILL PLAN
Compiled by:	Revised:	
Drawn by:	FIGURE	
Scale: 1"=40' (1:480)	SHEET	