

819
1776

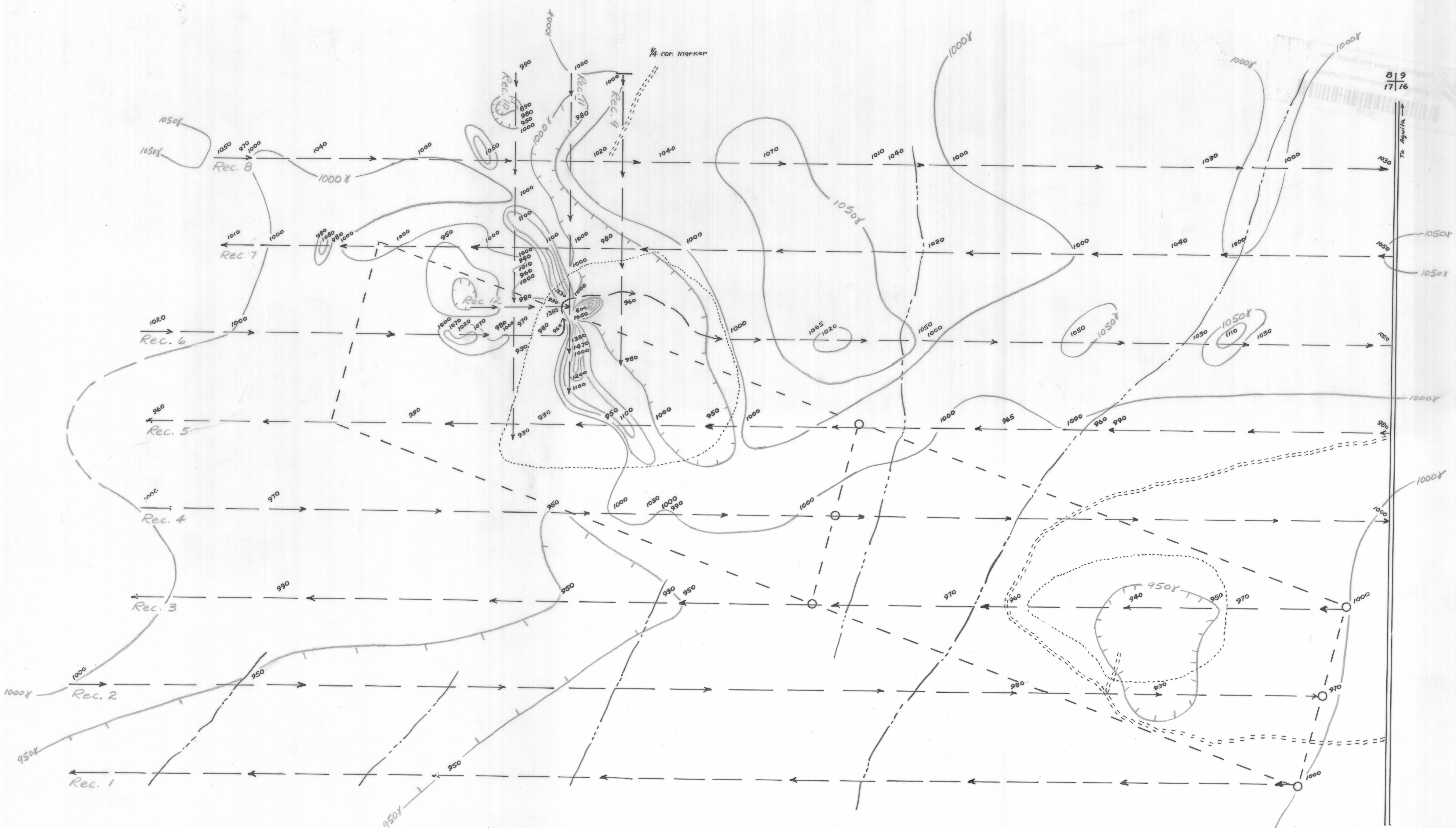

Explanation

- Scale 1" = 200' directions & locations approx.
- outline of hills
 - washes
 - ==== trails
 - ===== improved roads
 - Mopag traverse with direction of travel indicated
 - o Claim posts noted
 - 2000 Magnetic values in gammas



PROSPECT IN SEC. 17, T.4 N., R. 10 W.
 MARICOPA COUNTY, ARIZONA

MAGNETIC SURVEY
 (TOTAL INTENSITY BY MOBILE MAGNETOMETER)
 FOR
RALPH LAW
 BY
HEINRICHS GEOEXPLORATION COMPANY
 P.O. BOX 5671 TUCSON, ARIZONA

DECEMBER 1959