

RISE

INDUCED POLARIZATION SURVEY

FOUR METALS AREA

PATAGONIA

SANTA CRUZ COUNTY, ARIZ.

FOR

C.T. MOSES JR.

BY

HEINRICHS GEOEXPLORATION CO.

SCALE 1"=500 AUG.1964



T
24
S

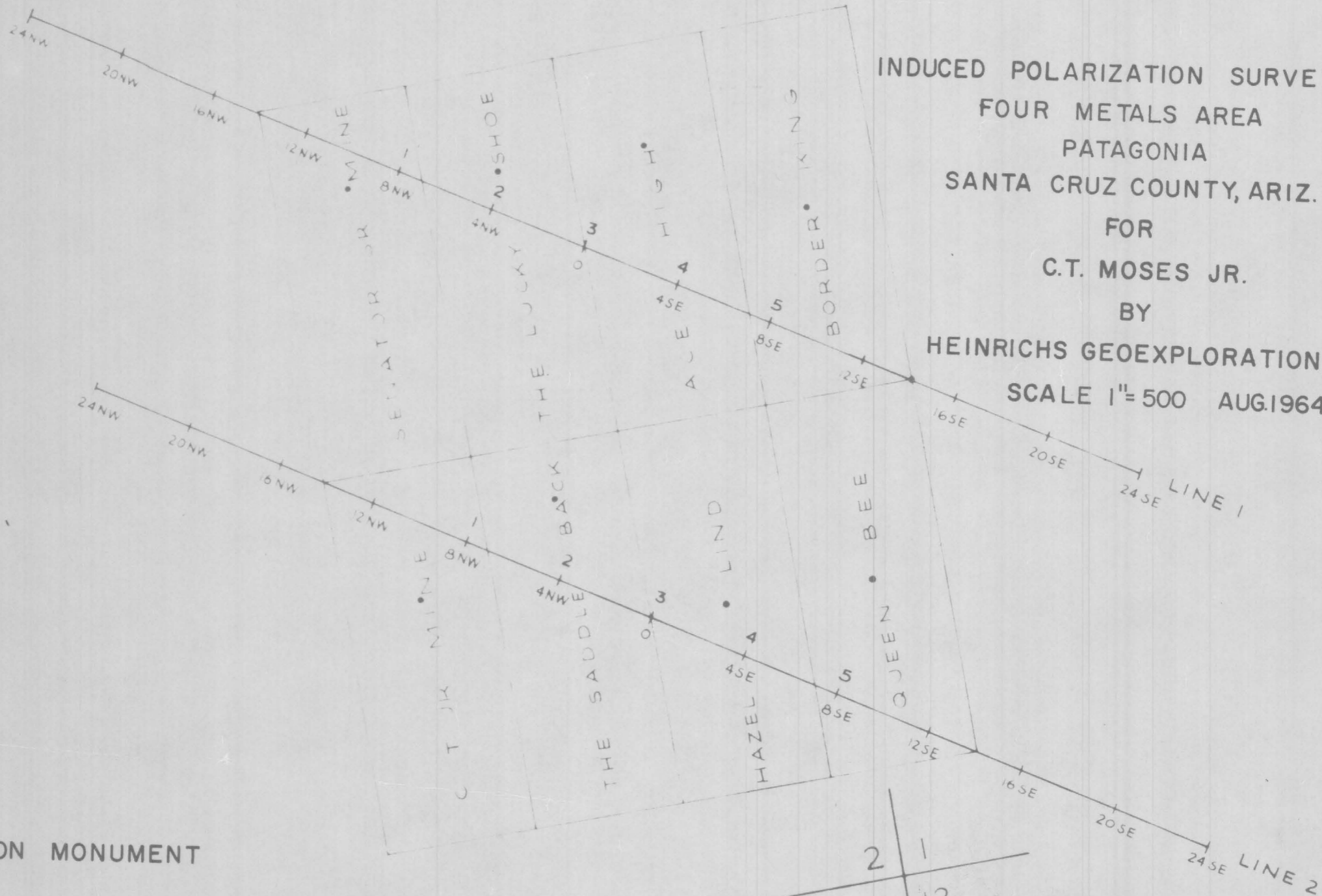

• LOCATION MONUMENT

2	1
11	12