

TOWNSHIP 17 SOUTH RANGE 15 EAST OF THE GILMAN A

PIMA COUNTY

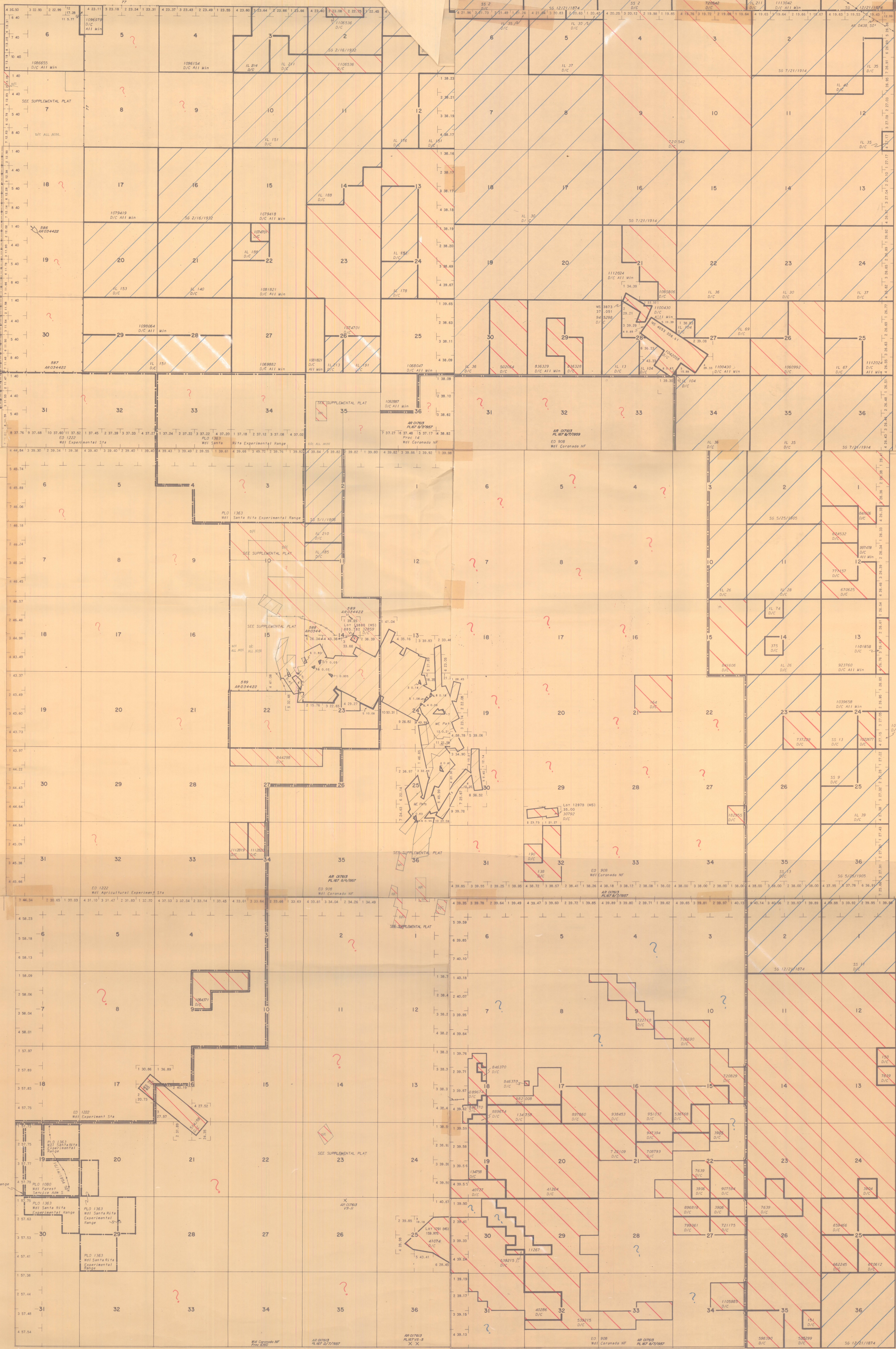

INDEX TO SEG	REMARKS
TRACT NO. T	R SEC

FOR ORDERS EFFECTING DISPOSAL OR USE OF UNIDENTIFIED LANDS WITHIN FOR CLASSIFICATION, MINERALS, WATER AND/OR OTHER PUBLIC PURPOSES, REFER TO INDEX OF MISCELLANEOUS DOCUMENTS.

DIC = PRIVATE
 S.G. = STATE GRANT
 S.S. = STATE
 L.L. = STATE LAND
 ALL MIN. = PUBLIC DOMAIN

TOWNSHIP 17 SOUTH RANGE 15 EAST

CURRENT TO	BY

FOR ORDERS EFFECTING DISPOSAL OR USE OF UNIDENTIFIED LANDS WITHIN FOR CLASSIFICATION, MINERALS, WATER AND/OR OTHER PUBLIC PURPOSES, REFER TO INDEX OF MISCELLANEOUS DOCUMENTS.

DIC = PRIVATE
 S.G. = STATE GRANT
 S.S. = STATE
 L.L. = STATE LAND
 ALL MIN. = PUBLIC DOMAIN

TOWNSHIP 17 SOUTH RANGE 15 EAST

INDEX TO SEGREGATED TRACTS	REMARKS
TRACT NO. T	R SEC SUBDIVISION

FOR ORDERS EFFECTING DISPOSAL OR USE OF UNIDENTIFIED LANDS WITHIN FOR CLASSIFICATION, MINERALS, WATER AND/OR OTHER PUBLIC PURPOSES, REFER TO INDEX OF MISCELLANEOUS DOCUMENTS.

DIC = PRIVATE
 S.G. = STATE GRANT
 S.S. = STATE
 L.L. = STATE LAND
 ALL MIN. = PUBLIC DOMAIN

TOWNSHIP 17 SOUTH RANGE 15 EAST

INDEX TO SEGREGATED TRACTS	REMARKS
TRACT NO. T	R SEC SUBDIVISION

FOR ORDERS EFFECTING DISPOSAL OR USE OF UNIDENTIFIED LANDS WITHIN FOR CLASSIFICATION, MINERALS, WATER AND/OR OTHER PUBLIC PURPOSES, REFER TO INDEX OF MISCELLANEOUS DOCUMENTS.

DIC = PRIVATE
 S.G. = STATE GRANT
 S.S. = STATE
 L.L. = STATE LAND
 ALL MIN. = PUBLIC DOMAIN

TOWNSHIP 17 SOUTH RANGE 15 EAST

CURRENT TO	BY

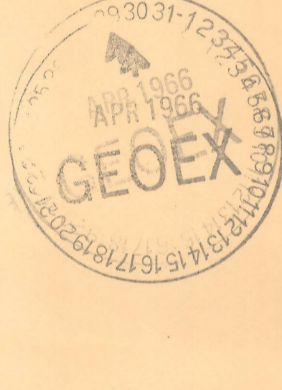

SCALE
 1" = 30' 0" TO THE INCH

SCALE
 1" = 30' 0" TO THE INCH

T. 17S.
 R. 15E.