

PARTIALLY SURVEYED TOWNSHIP 19 SOUTH RANGE 13 EAST OF THE GILA AND SALT RIVER

TOWNSHIP 19 SOUTH RANGE 14 EAST OF THE GILA AND SALT RIVER MERIDIAN, ARIZONA

PIMA COUNTY

PIMA COUNTY

STATUS OF PUBLIC DOMAIN
LAND AND MINERAL TITLES

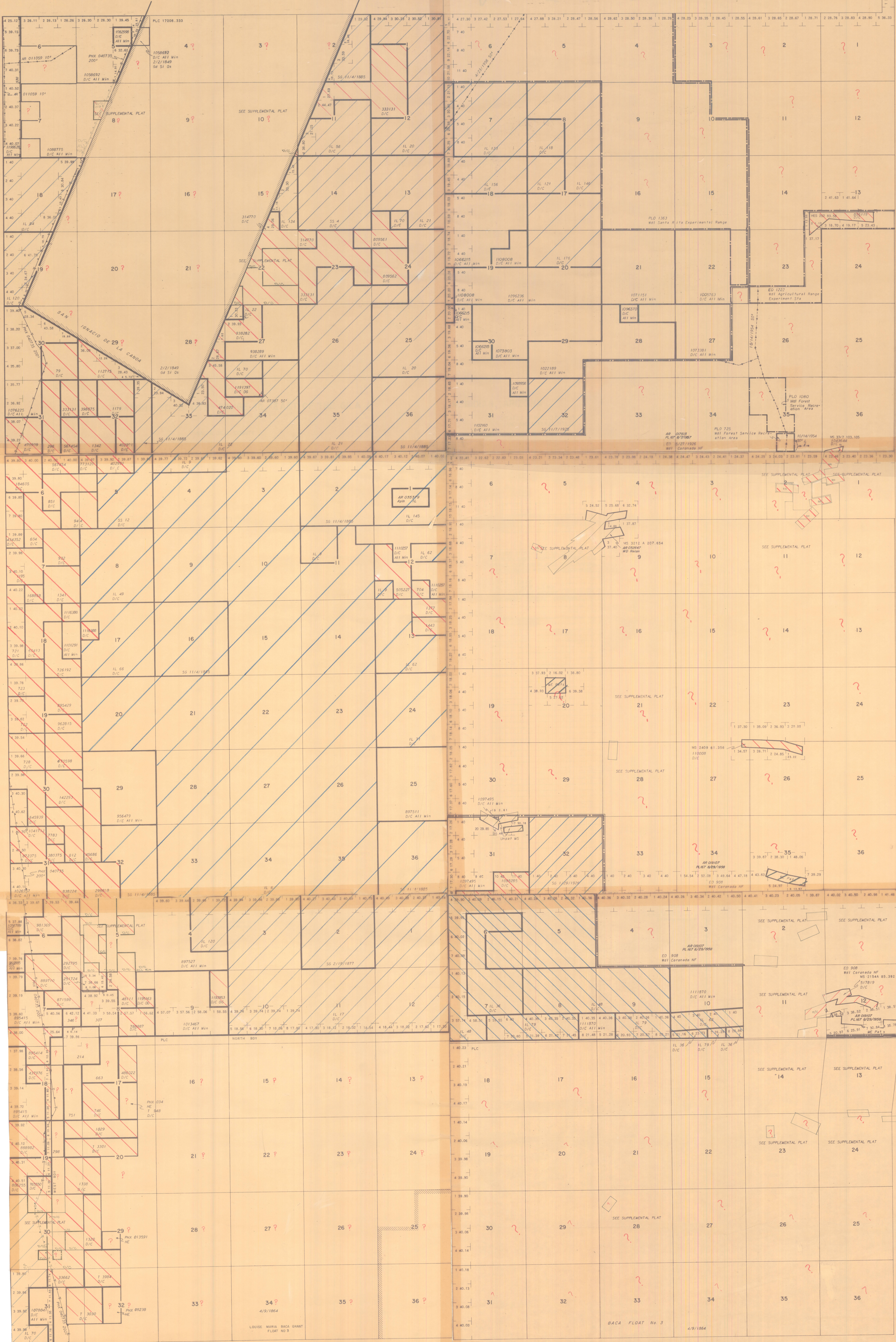

RESURVEY	ORIGINAL SURVEY	TRACT NO.	T	R	SEC.	SUBDIVISION

FOR ORDERS EFFECTING DISPOSAL OR USE OF UNIDENTIFIED LANDS WITHDRAWN FOR CLASSIFICATION, MINERALS, WATER AND/OR OTHER PUBLIC PURPOSES, REFER TO INDEX OF MISCELLANEOUS DOCUMENTS.

DIC = PRIVATE
 IL = STATE LAND
 SG = STATE GRANT
 ALL MIN. = PUBLIC DOMAIN
 TADP: SARAVARITA - 1968

TADP: SARAVARITA - 1968

CURRENT TO	BY

RESURVEY	ORIGINAL SURVEY	TRACT NO.	T	R	SEC.	SUBDIVISION

FOR ORDERS EFFECTING DISPOSAL OR USE OF UNIDENTIFIED LANDS WITHDRAWN FOR CLASSIFICATION, MINERALS, WATER AND/OR OTHER PUBLIC PURPOSES, REFER TO INDEX OF MISCELLANEOUS DOCUMENTS.

DIC = PRIVATE
 SG = STATE GRANT
 ALL MIN. = PUBLIC DOMAIN
 TADP: MT. WRIGHTSON - 1968

TADP: MT. WRIGHTSON - 1968

CURRENT TO	BY

RESURVEY	ORIGINAL SURVEY	TRACT NO.	T	R	SEC.	SUBDIVISION

FOR ORDERS EFFECTING DISPOSAL OR USE OF UNIDENTIFIED LANDS WITHDRAWN FOR CLASSIFICATION, MINERALS, WATER AND/OR OTHER PUBLIC PURPOSES, REFER TO INDEX OF MISCELLANEOUS DOCUMENTS.

DIC = PRIVATE
 IL = STATE LAND
 ALL MIN. = PUBLIC DOMAIN
 TADP: MT. WRIGHTSON - 1968

TADP: MT. WRIGHTSON - 1968

CURRENT TO	BY

SCALE
 0 9.9 19.8 29.7 39.6
 30 chains to the inch

SCALE
 0 9.9 19.8 29.7 39.6
 30 chains to the inch

T. 19 S.
 R. 14 E.