

INDEX MAP

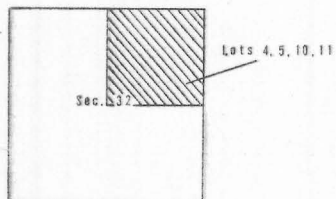

<b>HEINRICHS</b> <b>GEOEXPLORATION COMPANY</b> POST OFFICE BOX 8671, TUCSON, ARIZONA, 85703 Phone: 602/623-0578      Call: GEOEX, Tucson <small>geophysical engineers      vancouver      sydney      Job No. 186</small>	
GEOCHEMICAL SURVEY of LOTS 4, 5, 10 & 11 SECTION 32, T 13 S, R 12 E PIMA COUNTY, ARIZONA MOLYBDENUM IN PARTS PER MILLION FOR RICHARD W. GERHART	
SCALE 1" = 200'	DRAWN BY D.F.      DATE March, 1970