

INDUCED POLARIZATION LOCATION AND INTERPRETATION PLAN
of
LITTLE HILLS AREA
PINAL COUNTY, ARIZONA
for
CONTINENTAL OIL COMPANY
by
HEINRICHS GEOEXPLORATION COMPANY
Job number 798-73 March 1973

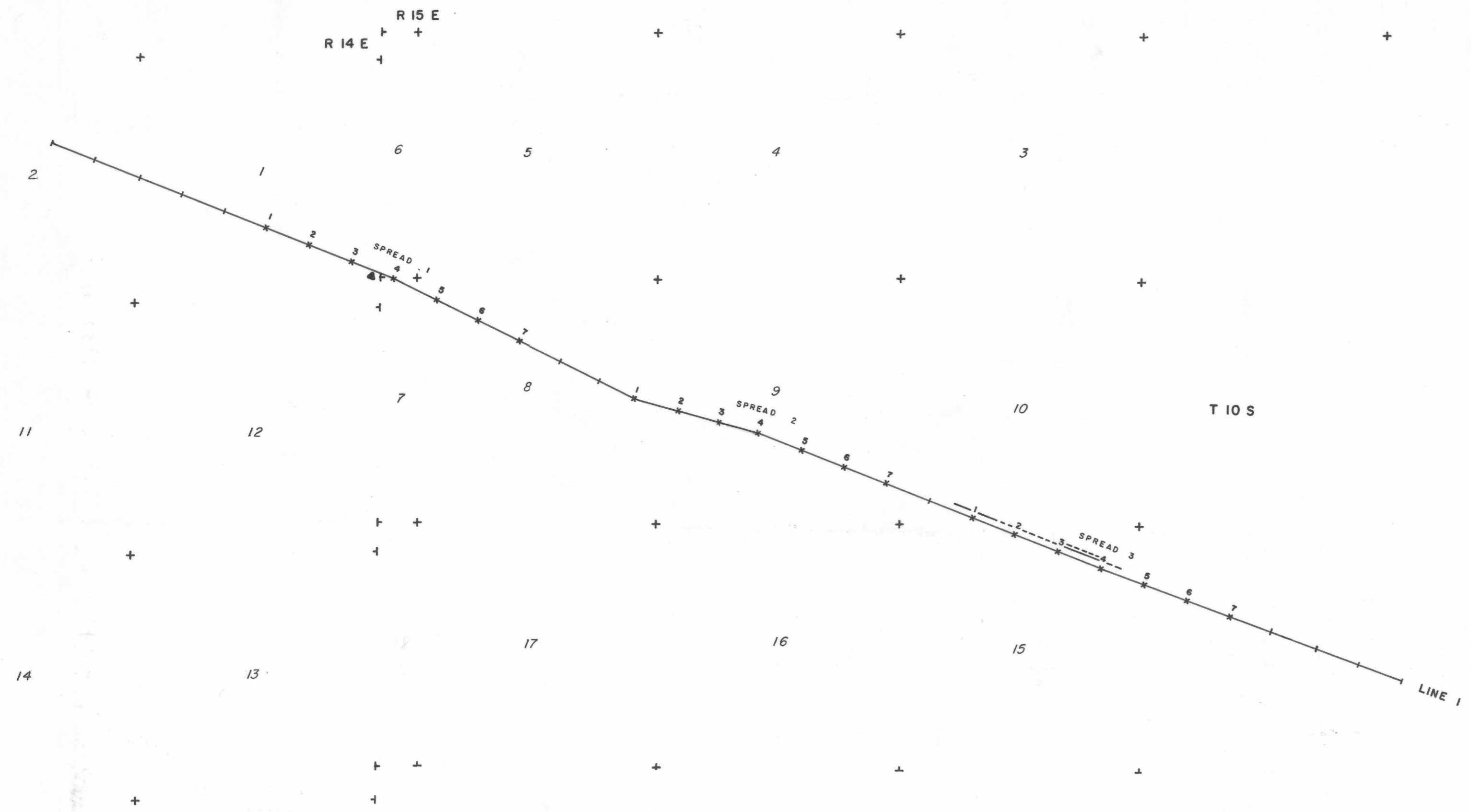

I. P. LINE
 ELECTRODE
 INTERFACE
 STATION
 SECTION CORNER
 SECTION NUMBER
 VERY WEAK
 WEAK
 MODERATE
} RELATIVE ANOMALY STRENGTH

Scale: 1:24,000