

Aguinaldo Mine

GEOLOGY SKETCH PLAN  
of  
AGUINALDO AREA  
PIMA COUNTY, ARIZONA  
for  
NOKOTA-BRIDGER-BRUCE  
by  
HEINRICHS GEOEXPLORATION COMPANY  
Job number 902-74 September 1974  
REVISED: NOVEMBER 1974  
MAY 1975

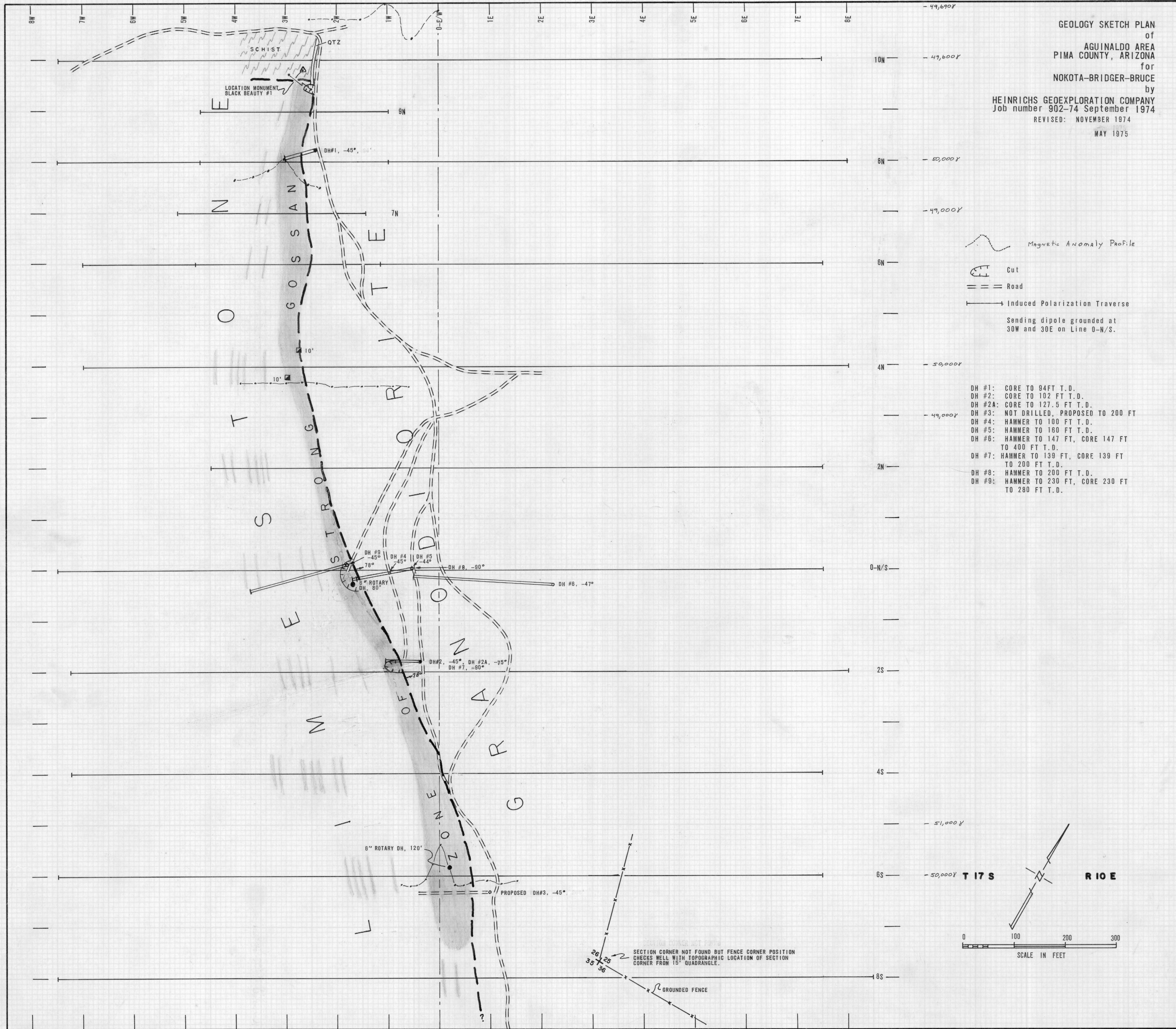

Magnetic Anomaly Profile  
Cut  
Road  
Induced Polarization Traverse

Sending dipole grounded at 30W and 30E on Line 0-N/S.

- DH #1: CORE TO 94 FT T.D.
- DH #2: CORE TO 102 FT T.D.
- DH #2A: CORE TO 127.5 FT T.D.
- DH #3: NOT DRILLED, PROPOSED TO 200 FT
- DH #4: HAMMER TO 100 FT T.D.
- DH #5: HAMMER TO 160 FT T.D.
- DH #6: HAMMER TO 147 FT, CORE 147 FT TO 400 FT T.D.
- DH #7: HAMMER TO 139 FT, CORE 139 FT TO 200 FT T.D.
- DH #8: HAMMER TO 200 FT T.D.
- DH #9: HAMMER TO 230 FT, CORE 230 FT TO 280 FT T.D.

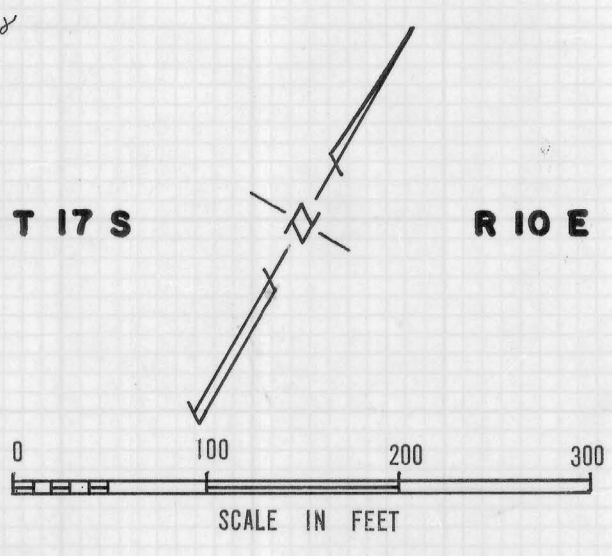

SECTION CORNER NOT FOUND BUT FENCE CORNER POSITION CHECKS WELL WITH TOPOGRAPHIC LOCATION OF SECTION CORNER FROM 15' QUADRANGLE.

GROUNDING FENCE

Handwritten notes in the bottom left corner.

Handwritten notes in the bottom right corner.