

R 13 E

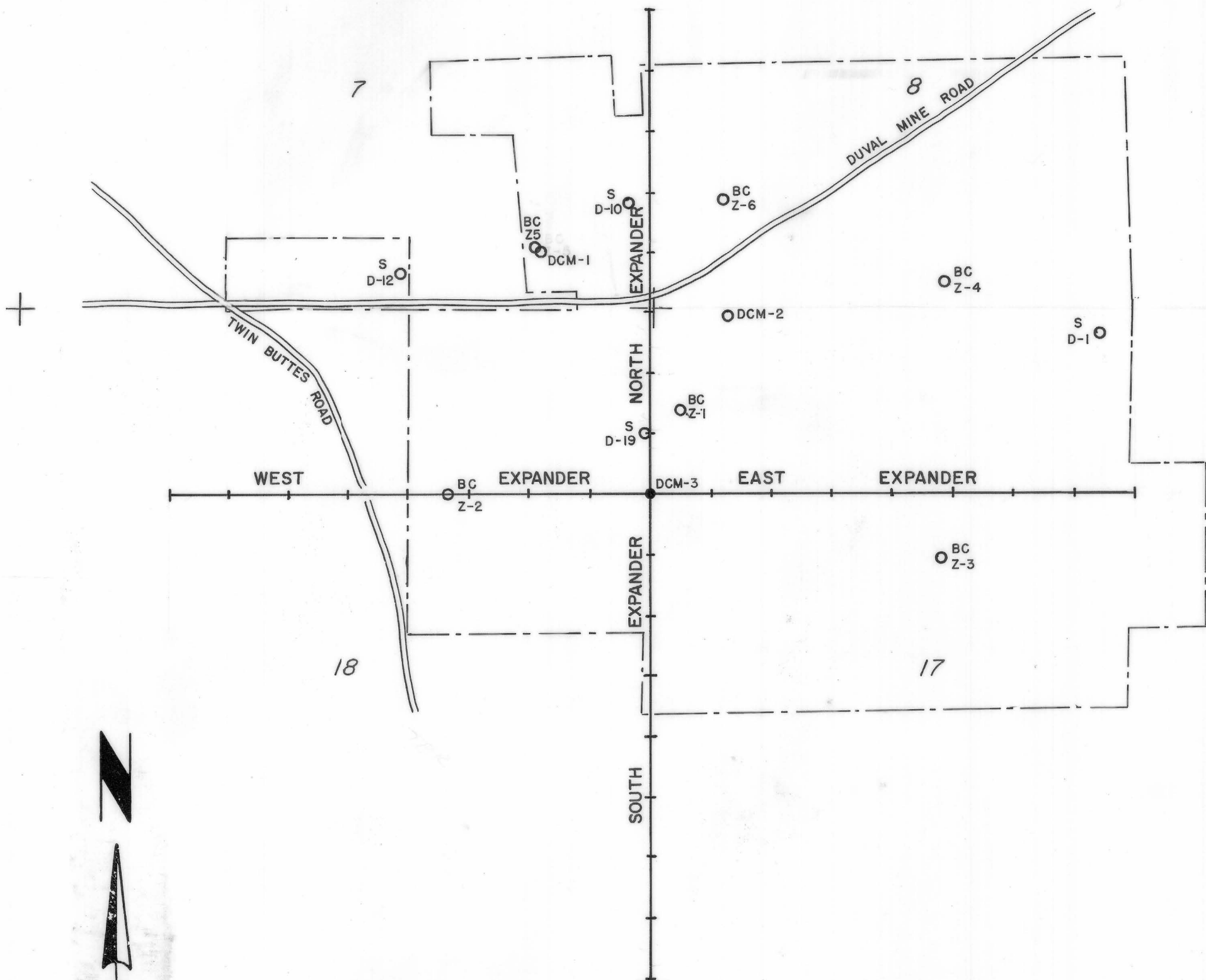

9

10

T 18 S

INFINITE ELECTRODE  
X OWELL

18

17

16

15

 HEINRICHS GEOEXPLORATION CO.  
 POST OFFICE BOX 5671, TUCSON, ARIZONA, 85703  
 GEOPHYSICAL ENGINEERS

IN-HOLE INDUCED POLARIZATION  
 LOCATION PLAN  
 DEMETRIE WASH AREA  
 PIMA COUNTY, ARIZONA

FOR  
 C. F. & I. CORP.

Scale: 1" = 1000' | Date APRIL 1967