

12
19
1210
121
1210
1210

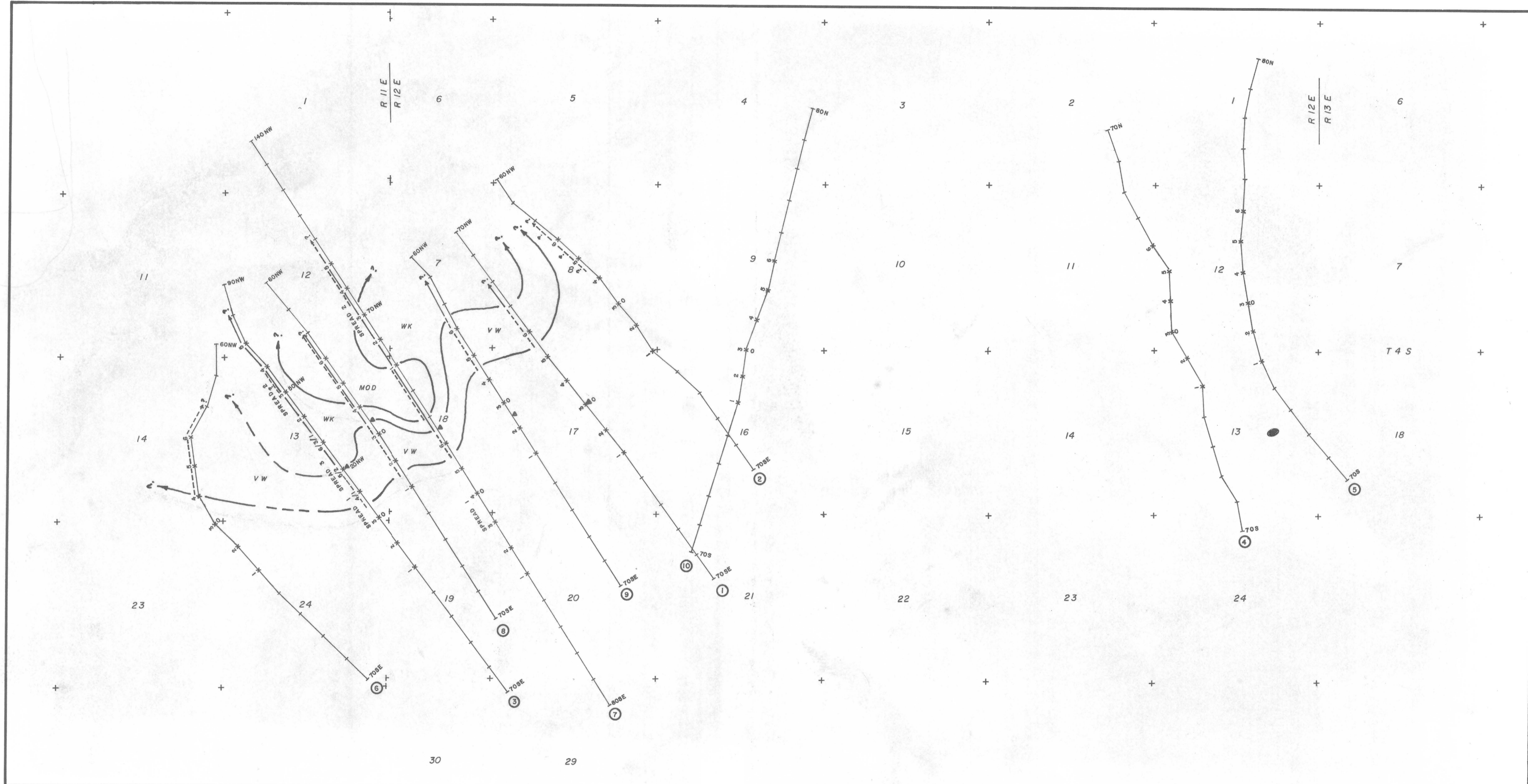

INDUCED POLARIZATION LOCATION
AND INTERPRETATION PLAN
of
THE TORTILLA AREA
PINAL COUNTY, ARIZONA
for
MR. RUSSELL BADGETT, JR
by
HEINRICHS GEOEXPLORATION COMPANY
Job number 645-71

EXPLANATION
 I. P. LINE & NUMBER
 ELECTRODE & NUMBER
 POT STATION
 INTERFACE

RELATIVE ANOMALY STRENGTH
 MOD - MODERATE
 WK - WEAK
 VW - VERY WEAK

SCALE: 1:24,000
 JULY 1971

NOTE: THIS SHEET OVERLAYS U.S.G.S.
 "NORTH BUTTE" & "GRAYBACK" QUADS.

HEINRICHS
GEOEXPLORATION COMPANY
 POST OFFICE BOX 5964, TUCSON, ARIZONA, 85703
 Phone: 602/623-0578 Cable: GEOEX, Tucson
 geophysical engineers vancouver sydney

(1210/1210)