



CONTACT INFORMATION

Mining Records Curator
Arizona Geological Survey
1520 West Adams St.
Phoenix, AZ 85007
602-771-1601
<http://www.azgs.az.gov>
inquiries@azgs.az.gov

The following file is part of the

Arizona Department of Mines and Mineral Resources Mining Collection

ACCESS STATEMENT

These digitized collections are accessible for purposes of education and research. We have indicated what we know about copyright and rights of privacy, publicity, or trademark. Due to the nature of archival collections, we are not always able to identify this information. We are eager to hear from any rights owners, so that we may obtain accurate information. Upon request, we will remove material from public view while we address a rights issue.

CONSTRAINTS STATEMENT

The Arizona Geological Survey does not claim to control all rights for all materials in its collection. These rights include, but are not limited to: copyright, privacy rights, and cultural protection rights. The User hereby assumes all responsibility for obtaining any rights to use the material in excess of "fair use."

The Survey makes no intellectual property claims to the products created by individual authors in the manuscript collections, except when the author deeded those rights to the Survey or when those authors were employed by the State of Arizona and created intellectual products as a function of their official duties. The Survey does maintain property rights to the physical and digital representations of the works.

QUALITY STATEMENT

The Arizona Geological Survey is not responsible for the accuracy of the records, information, or opinions that may be contained in the files. The Survey collects, catalogs, and archives data on mineral properties regardless of its views of the veracity or accuracy of those data.

09/26/85

ARIZONA DEPARTMENT OF MINES AND MINERAL RESOURCES FILE DATA

PRIMARY NAME: RAWHIDE

ALTERNATE NAMES:

MOHAVE COUNTY MILS NUMBER: 368C

LOCATION: TOWNSHIP 11 N RANGE 13 W SECTION 18 QTR. NW
LATITUDE: N 34DEG 17MIN 53SEC LONGITUDE: W 113DEG 39MIN 16SEC
TOPO MAP NAME: ARTILLERY PEAK - 15 MIN

CURRENT STATUS: PAST PRODUCER

COMMODITY:

LEAD-PRIMARY
COPPER-COPRODUCT
GOLD- (M) LODE-COPRODUCT
SILVER-COPRODUCT

BIBLIOGRAPHY:

ADMMR RAWHIDE MINE FILE
MALACH, R "MOHAVE CO. MINES" P. 48; 1977
MALACH, R "MOH. CO PLACE NAMES" P. 32; 1976

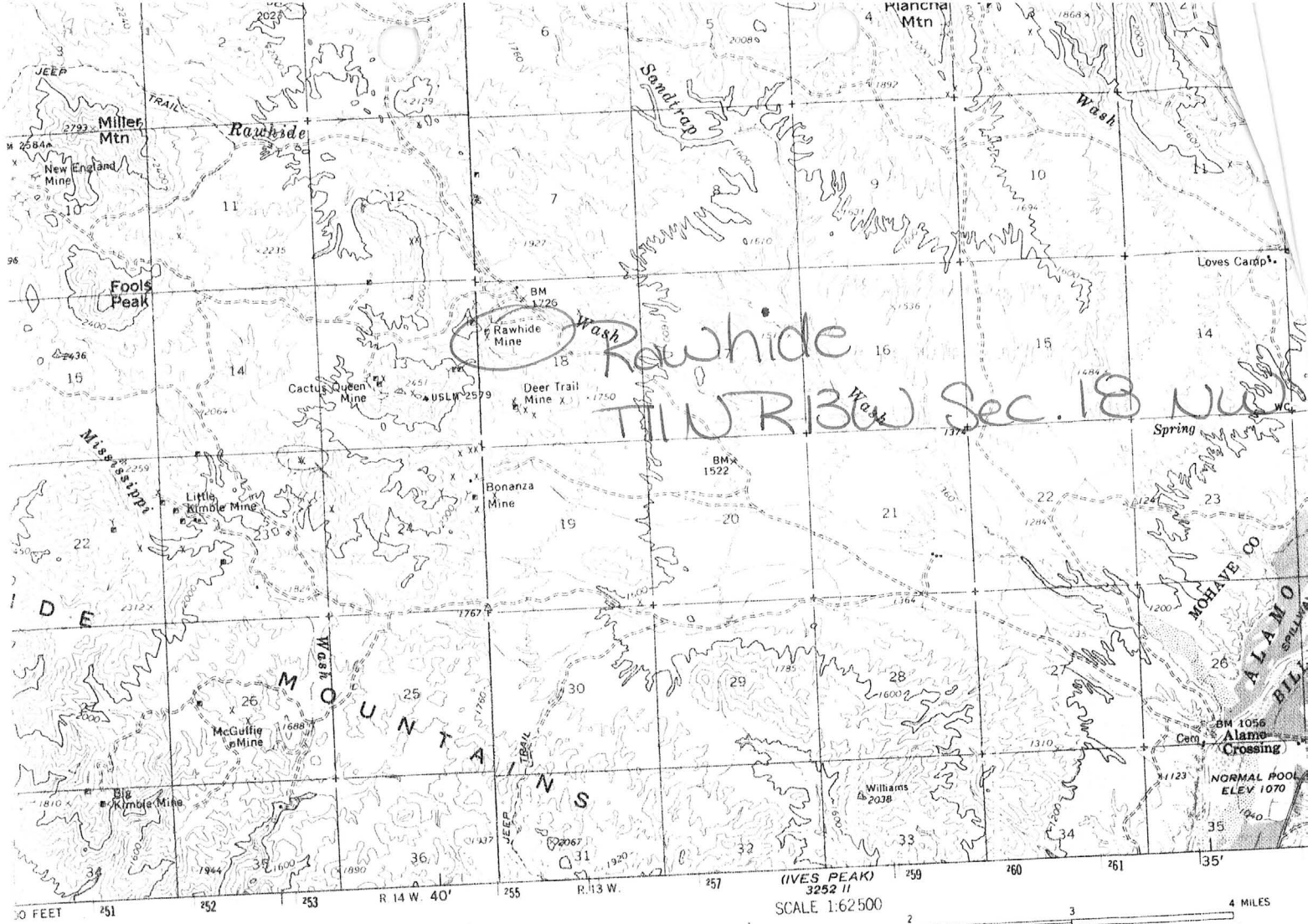

il Survey

west zone

amo Reservoir
ue pattern

UTM GRID AND 1986 MAGNETIC NORTH
DECLINATION AT CENTER OF SHEET.

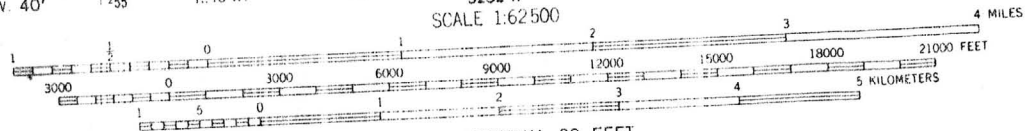
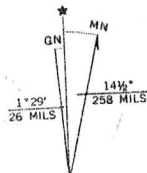

CONTOUR INTERVAL 80 FEET
DOTTED LINES REPRESENT 40-FOOT CONTOURS
DATUM IS MEAN SEA LEVEL

THIS MAP COMPLIES WITH NATIONAL MAP ACCURACY STANDARDS
FOR SALE BY U.S. GEOLOGICAL SURVEY, DENVER, COLORADO 80225, OR WASHINGTON, D.C. 20242
A FOLDER DESCRIBING TOPOGRAPHIC MAPS AND SYMBOLS IS AVAILABLE ON REQUEST

Artillery Peak 15'

| | | | | |
|--|----------------------------|--|---|---------------|
| Name of Mine or Prospect Rawhide Mine | Township 11N | Range 13W | Section 18 bcc | Priority C |
| Principal Minerals: Gold, Silver, Galena, Pyrite, Chalcocite | 1:250,000 Quad Prescott | | 7.5' - 15' Quad Artillery Peak | |
| Associated Minerals: Quartz, Calcite | District Artillery Mtn. | | Principal Product Copper, Gold Silver, Lead | |
| Type of Operation: Underground: Adits, Shafts | County Mohave | State Arizona | Type of Deposit Vein | |
| Ownership or Controlling Interest: Consult current USBLM mining claim records. | | | | |
| Access: From Alamo Crossing proceed northwest on unimproved road for 5 miles. Mine is shown on topographic quadrangle. | | | | |
| Structural Control or Geological Association: "Older Precambrian Age; Schist." ³ "The Rawhide Mine is developed numerous adits, shafts and pits on tow parallel fault zones: 174/82NE; 179/89NE. The faults are separated by 35 to 50 feet of intensely brecciated and altered material. The host rocks are Paleozoic (?) limestones. The mineralization is contained in highly fractured and altered zone with calcite, quartz, hematite and limonite. Primary mineralization was sulfide and ore appears to be supergene enriched material." ⁴ | | | | |
| Age of Mineralization: | | | | |
| Production History | | Geochemical Analyses | | |
| Considerable production. ⁴ | | Sample (1981) 81DTE730-4 high grade dump material | | |
| References | | | | |
| 1) Mallach (1977) p. 48. 2) CETA map file, Rack #19, Claim Map. 3) Wilson & Moore (1959) Geologic Map. 4) Exploration Research Associates Incorporated, Field Reconnaissance, July 1981. | | | | |

Arizona Department of Mines and Mineral Resources

INFORMATION FROM MINE CARDS IN MUSEUM

MOHAVE CO.

RAWHIDE MINE

MM 8551 Argentite & ~~Chalcopyrite~~
↳ Native Silver

MILS 368-C

O-AKA's

Rawhide (file)

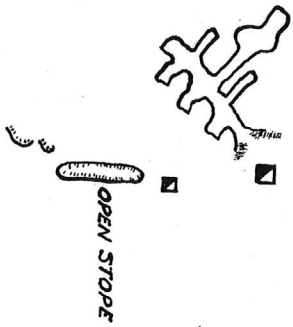
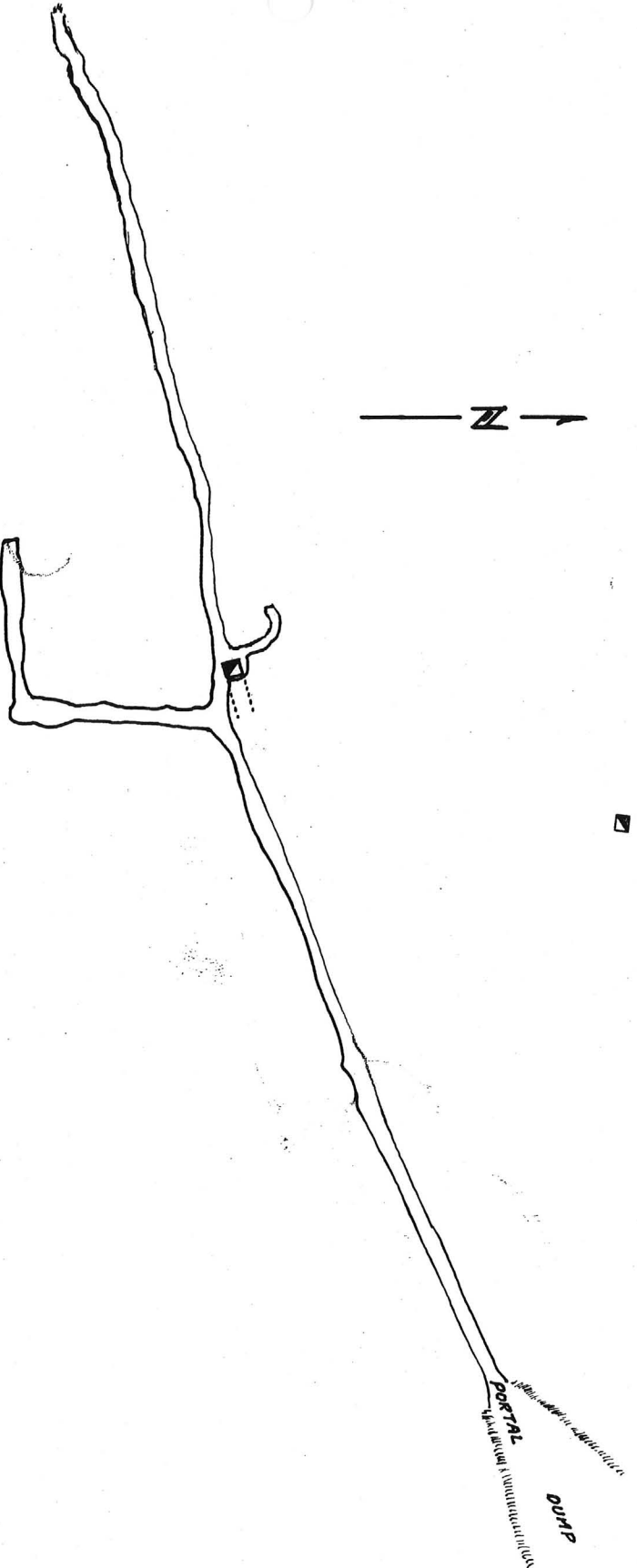

Fig 9. MAIN WORKINGS RAWHIDE MINE. OWENS MINING DISTRICT, ARIZONA.

ARIZONA DEPARTMENT OF MINES AND MINERAL RESOURCES

VERBAL INFORMATION SUMMARY

1. Mine file: 1. RAWHIDE 2. DEER TRAIL

2. Mine name if different from above:

3. County: MOHAVE

4. Information from: John Lucking

Company:

Address: 315 W. La Mar

Phoenix, AZ 85013

Phone:

5. Summary of information received, comments, etc.:

John Lucking reports that exploration activity of Phelps Dodge during the past few years may have been occurring north of the Bill Williams River in the area of the Rawhide mine and the Deer Trail mines. Precious metals hosted in low angle structures associated with hematitic alteration were the exploration targets.

Date: January 11, 1989

Nyal J. Niemuth, Mining Engineer

RAWHIDE MINE

MOHAVE COUNTY

Jim Vaughn and William C. Andruss (Roadrunner Enterprises) visited office and said Stacey (who has logging Co. in Oregon) worked the Rawhide all winter. Note FPK 8-9-68

Rawhide mine owned by a Mr. Stacey who has well drilling business in Pierce, Idaho, and is trying to develop the Rawhide Mine. Has trailer houses parked at Brown's Crossing. FTJ WR 1-10-69

Stacey and two sons have lease from Mrs. Kopher. FPK Field notes 5-6-69

Elwood Stacy, Box 1578, Wickenburg, Arizona 85358, was in the office on 4/9/81 and reported that he and his father Charles Stacy are the owners of the Rawhide Mine. Mr. Stacy said that there are 10 claims.

NJN WR 6/5/87: John Lucking (card) reported that during a recent mineral collecting trip he noticed that a Canadian company was sampling at the Rawhide (file) Mohave County.

NAME: RAW HIDE MINE

COUNTY: MOHAVE

T 1 N R 13 W SEC. 18 E 1 2000' DISTRICT: ARTILLERY PK

Artillery Peak 15

Mineralization: Cu, Ag, Au

Geology:

Type Operation:

Production:

References: Tqo

Mohave County Card File

Information from MINE INSPECTOR'S OFFICE - August 15, 1957

RAWHIDE MINE, (8 claims) Owens Dist., MOHAVE CO. 6-13-57
Rawhide, Ariz.

Owner - Clyde Cofer, Kingman, Arizona

Oper. & Lessee - Roy Williams

Pres. Joe Cornwall, Wenden, Ariz.
Supt. Bud Williams, " "

LEAD, SILVER, COPPER, GOLD 120 tons - 3 men.

STATE OF ARIZONA
FIELD ENGINEERS REPORT

This mine has lead, silver, copper and gold ore. It is not known if Mr. Kopher will do work other than assessment work for the present.

STATE OF ARIZONA
FIELD ENGINEERS REPORT

Townsend reported that Clyde Kopher, of Wikieup, was doing assessment work at the Rawhide Mine. Kopher plans to spend \$1000 on assessment work which will consists of driving a raise and a drift in the old mine. 3 men are employed. (Note that the Mine Inspectors report of August 1957 listed Clyde Cofer of Kingman as owner, they apparently having misspelled the name.)

This mine has lead, silver, copper and gold ore. It is not known if Mr. Kopher will do work other than assessment work for the present.

Information from MINE INSPECTOR'S OFFICE - August 15, 1957

RAWHIDE MINE, (8 claims) Owens Dist., MOHAVE CO. 6-13-57
Rawhide, Ariz.

Owner - Clyde Cofer, Kingman, Arizona

Oper. & Lessee - Roy Williams

Pres. Joe Cornwall, Wenden, Ariz.

Supt. Bud Williams, " "

LEAD, SILVER, COPPER, GOLD 120 tons - 3 men.

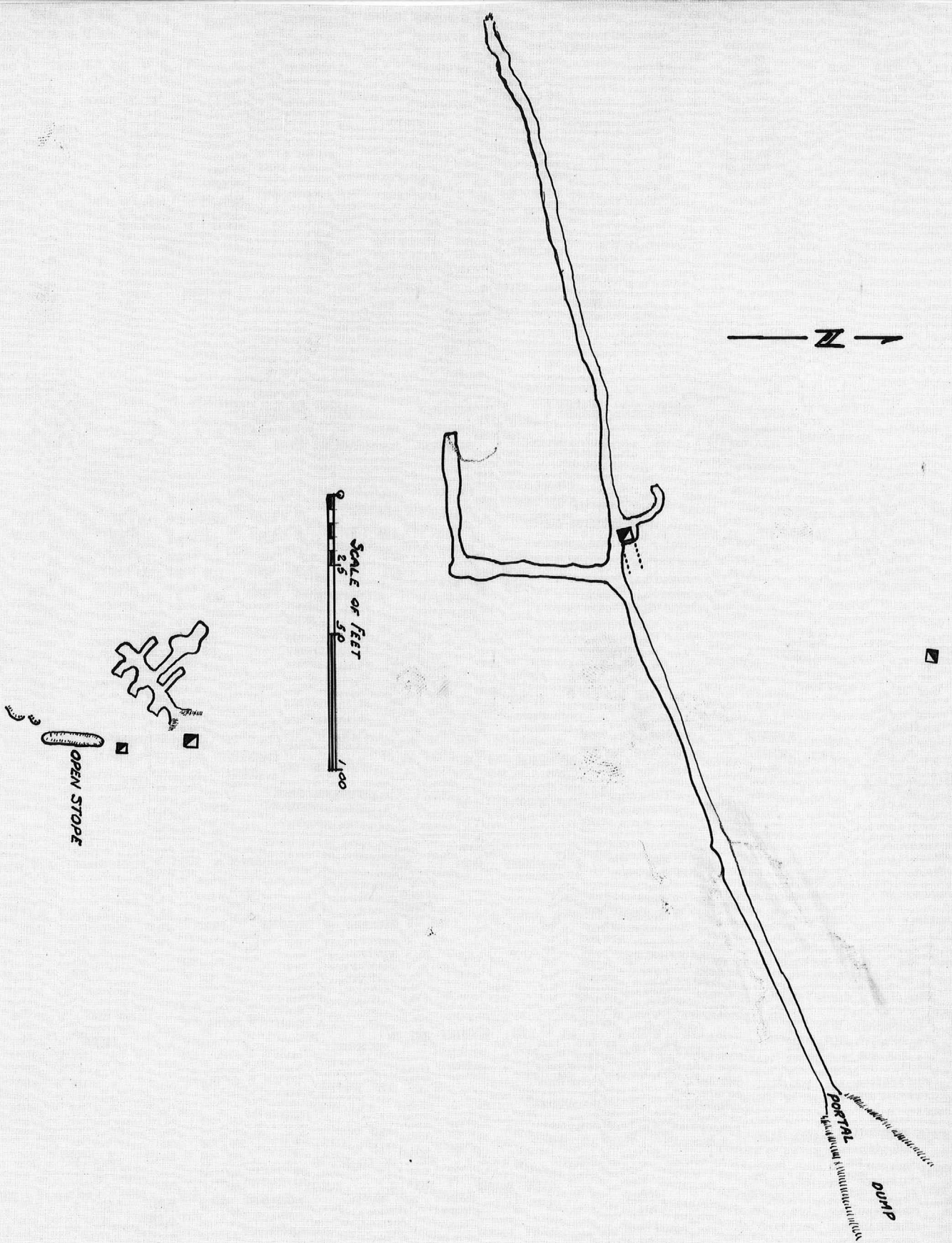

Fig 9, MAIN WORKINGS RAWHIDE MINE, OWENS MINING DISTRICT, ARIZONA.