



CONTACT INFORMATION

Mining Records Curator
Arizona Geological Survey
1520 West Adams St.
Phoenix, AZ 85007
602-771-1601
<http://www.azgs.az.gov>
inquiries@azgs.az.gov

The following file is part of the

Arizona Department of Mines and Mineral Resources Mining Collection

ACCESS STATEMENT

These digitized collections are accessible for purposes of education and research. We have indicated what we know about copyright and rights of privacy, publicity, or trademark. Due to the nature of archival collections, we are not always able to identify this information. We are eager to hear from any rights owners, so that we may obtain accurate information. Upon request, we will remove material from public view while we address a rights issue.

CONSTRAINTS STATEMENT

The Arizona Geological Survey does not claim to control all rights for all materials in its collection. These rights include, but are not limited to: copyright, privacy rights, and cultural protection rights. The User hereby assumes all responsibility for obtaining any rights to use the material in excess of "fair use."

The Survey makes no intellectual property claims to the products created by individual authors in the manuscript collections, except when the author deeded those rights to the Survey or when those authors were employed by the State of Arizona and created intellectual products as a function of their official duties. The Survey does maintain property rights to the physical and digital representations of the works.

QUALITY STATEMENT

The Arizona Geological Survey is not responsible for the accuracy of the records, information, or opinions that may be contained in the files. The Survey collects, catalogs, and archives data on mineral properties regardless of its views of the veracity or accuracy of those data.

PRINTED: 05/31/2002

ARIZONA DEPARTMENT OF MINES AND MINERAL RESOURCES AZMILS DATA

PRIMARY NAME: OVERSIGHT GROUP OF CLAIMS

ALTERNATE NAMES:

GREAT WEST
MIDNIGHT
FRACTION

PINAL COUNTY MILS NUMBER: 41

LOCATION: TOWNSHIP 1 N RANGE 8 E SECTION 11 QUARTER NE
LATITUDE: N 33DEG 27MIN 03SEC LONGITUDE: W 111DEG 29MIN 46SEC
TOPO MAP NAME: GOLDFIELD - 7.5 MIN

CURRENT STATUS: DEVEL DEPOSIT

COMMODITY:

GOLD

BIBLIOGRAPHY:

ADMMR OVERSIGHT GROUP FILE
PROPERTY EXTENDS INTO SEC. 2

R E P O R T

on

THE OVERSIGHT GROUP

of

MINING CLAIMS

SITUATION

The claims are situated in the Superstition Mining District, Goldfields, Pinal County, Arizona, close to the main road "Apache Trail" and within half mile of the Roosevelt power line.

OWNERS

J. J. Fraser and J. T. McFarland.

CLAIMS

Nine full locations and fraction comprise the group, named as follows: Oversight from 1 to 7 inclusive, Great West, Midnight and Fraction.

"See plat for relative position of claims"

The claims are surrounded on three sides by the Goldfields claims.

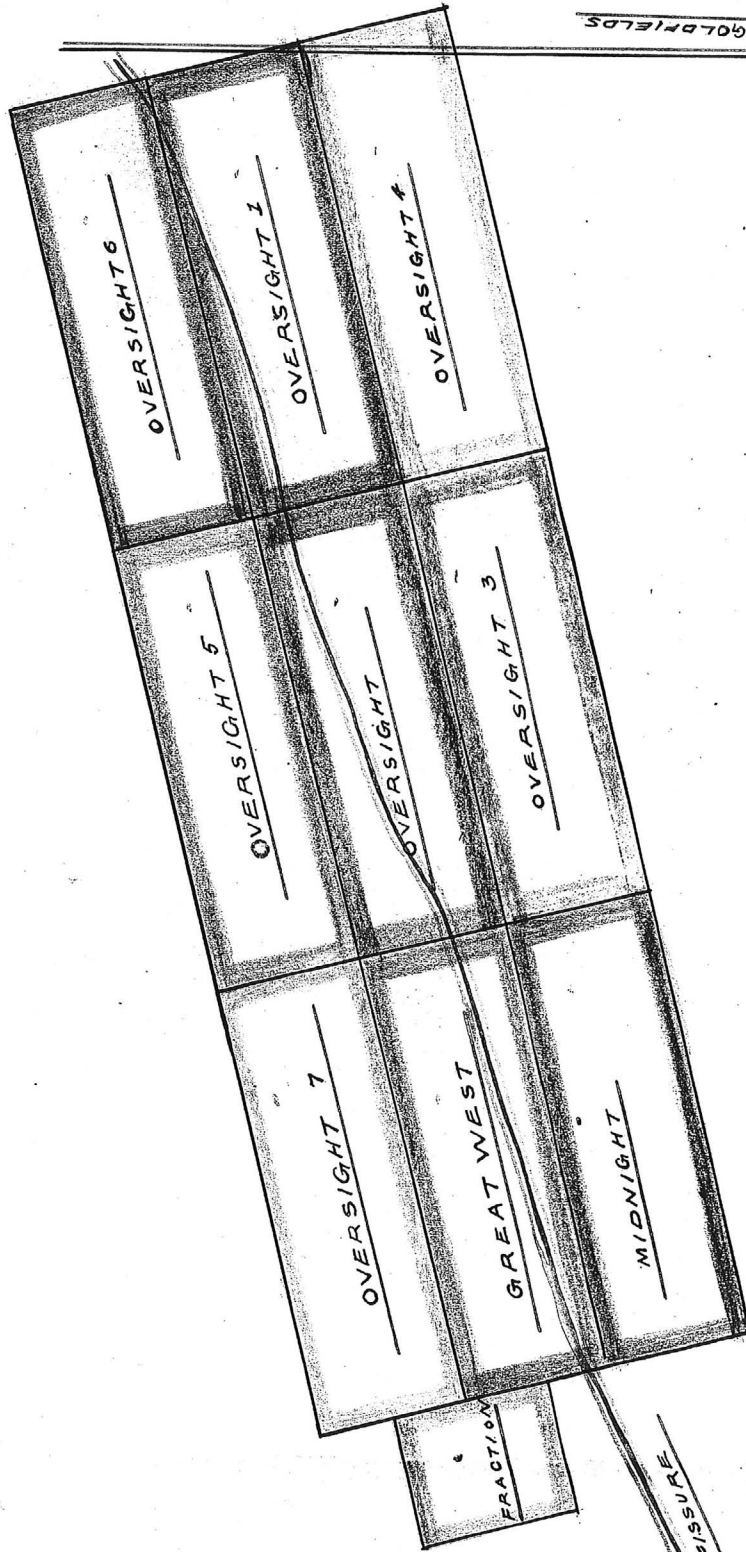

M. E. DePuy.
 Director
 Arizona
 April 20/1923

TITLES

Are held by the performance of annual assessment work.

TOPOGRAPHY

The property covers an area of gently sloping foot hills at the base of the Superstition Mountain range.

GEOLOGY

and

MINERALOGY

Most of the surface is detrital capped, with occasional exposures of andesite and monzonite, the two latter formations are surface flows and cover the underlying formation of pegmatite. This has been demonstrated beyond question by developments in the Goldfields workings, the adjoining property to the north, and on other exposures to the south, as well as in the workings of the Oversight Group itself.

The pegmatite is generally pinkish in color and mainly composed of pink feldspar and quartz, with occasional magnetite.

Where contacts occur, it is evidently along movements in the underlying structure. Some of these conditions are more particularly described under the head of workings.

A N. S. fault fissure passes through this ground.

The gold values at present are and will be found along the alterative zones, caused by mo^{ve}~~me~~nt and faulting along the fissuring and the attendant slips and lines of brecciation attendant upon those conditions.

This is unquestionably demonstrated by the occurrence of gold values in the Goldfield property.

DESCRIPTION OF WORKINGS

OVERSIGHT

CLAIM

Vertical shaft 25' deep, entirely in monzonite, with quartz seams and manganese oxide stringers. Carries low values in gold.

OVERSIGHT

NO. 1

10' vertical shaft in fine gravel, lower portion in granular oxidized pegmatite.

50' vertical shaft with cross cut 100' to E. at bottom.

Shaft in monzonite at face of cross cut, yellow porphyry 6" wide with oxidized pegmatite on east side.

28' vertical shaft by side of road in highly red oxidized monzonite, with streaks of manganese oxide.

A sample across top gave a result of \$2.40 in gold.

MIDNIGHT

45' vertical shaft and cross cut west 30'. All this working is in monzonite and assays can be obtained from \$2.00 to \$3.00 in gold.

FRACTION

14' vertical shaft and cross cut east 10'; west side of shaft andesite and east pegmatite, carries low values in gold.

GRAND VIEW

Vertical shaft 60' deep, sunk in shattered and decomposed monzonite, with oxidized streaks. Drift at bottom N. 55° E. 155' in length, courses through intensely and altered monzonite with numerous oxidized slips and selvages, for 65', at this point dark colored andesite is encountered, and the heading passes through this formation for 90' when the face enters pegmatite, altered and oxidized.

The andesite is normal, but altered along the smooth wedge shaped slips and cross fractures.

The line of demarkation between the monzonite and andesite is distinctly marked, the parting being vertical.

At a point 65' in the main heading a drift is driven south 40° East for 15' in crushed ground, smooth slicken walls and plastic selvages.

These smooth walls and slips have a general dip 40° S.W. \$2.00 gold values were obtained from samples in this area.

45' vertical shaft, N. 55° W. 200' from previous mentioned working, shaft in crushed material and detrital, cross cut at bottom N. 70° E. 85' in length, following a slip of altered granular monzonitic ^{material} oxidized and porphyritic with a dip 30° S. to a distance of 60'. Beyond this in the heading the drift enters altered oxidized pegmatite; at the contact is a red oxidized selvage 8" in width with a course at right angles to the drift N. 45° W. and dip of 40° S. W.

The drift continues to the face, in altered pegmatite. 5' back from face is a defined N. S. slip and quartz seam, with smooth walls, following course of drift, with slight dip N. the ground is friable and a sample of same returned \$2.50 gold.

Vertical shaft 20' deep on E. side line of Great West Claim, sunk in monzonite breccia, the main constituent being quartz.

Cross cut at bottom W. for 16' at face N.W. contact of monzonite and pegmatite.

Further south on east side line 10' vertical shaft in white kaolinized monzonite, pegmatite on E., the latter gave in assay result \$1.60 in gold.

Continuing S. on side line vertical shaft 17' deep, sunk in altered pegmatite.

Short drift E. midway in shaft, in porphy-rized pegmatite with streaks of manganese oxide. This material affords \$2.50 in gold.

Toward S. end line, vertical shaft
22' deep sunk in finely granular
detrital, cross cut at bottom in
granular and oxidized pegmatite, face
in normal pegmatite, and carries low
gold content.

FRACTION

14' vertical shaft in fine granular
detrital drift E. 10' in andesite, at
face pegmatite.

OVERSIGHT 3

Shows a line of yellow and gray porphyry outcropping and proven by shallow workings.

It has a general course S. 35° E.

This porphyry is evidently an altered monzonite and in spots very much kaolinized.

R E P O R T
on
THE "OVERSIGHT"
GROUP OF CLAIMS

PINAL COUNTY, ARIZONA.

April 20, 1923.

W. E. DEFTY,

Mining Engineer.

R E P O R T
on
THE OVERSIGHT GROUP
of
MINING CLAIMS

SITUATION

The claims are situated in the Superstition Mining District, Goldfields, Pinal County, Arizona, close to the main road "Apache Trail" and within half mile of the Roosevelt power line.

OWNERS

J. J. Fraser and J. T. McFarland.

CLAIMS

Nine full locations and fraction comprise the group, named as follows:

Oversight from 1 to 7 inclusive, Great West, Midnight and Fraction.

"See plat for relative position of claims"

The claims are surrounded on three sides by the Goldfields claims.

GOLD FIELDS

M. E. Dwyer.
Shasta
California
April 20/1928

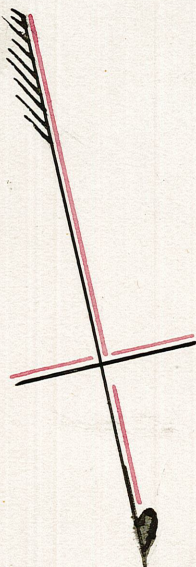

TITLES

Are held by the performance of annual assessment work.

TOPOGRAPHY

The property covers an area of gently sloping foot hills at the base of the Superstition Mountain range.

GEOLOGY

and

MINERALOGY

Most of the surface is detrital capped, with occasional exposures of andesite and monzonite, the two latter formations are surface flows and cover the underlying formation of pegmatite. This has been demonstrated beyond question by developments in the Goldfields workings, the adjoining property to the north, and on other exposures to the south, as well as in the workings of the Oversight Group itself.

The pegmatite is generally pinkish in color and mainly composed of pink feldspar and quartz, with occasional magnetite.

Where contacts occur, it is evidently along movements in the underlying structure. Some of these conditions are more particularly described under the head of workings.

A N. S. fault fissure passes through this ground.

The gold values at present are and will be found along the alterative zones, caused by movement^{ve} and faulting along the fissuring and the attendant slips and lines of brecciation attendant upon those conditions.

This is unquestionably demonstrated by the occurrence of gold values in the Goldfield property.

DESCRIPTION OF WORKINGS

OVERSIGHT
CLAIM

Vertical shaft 25' deep, entirely in monzonite, with quartz seams and manganese oxide stringers. Carries low values in gold.

OVERSIGHT
NO. 1

10' vertical shaft in fine gravel, lower portion in granular oxidized pegmatite.

50' vertical shaft with cross cut 100' to E. at bottom.

Shaft in monzonite at face of cross cut, yellow porphyry 6" wide with oxidized pegmatite on east side.

28' vertical shaft by side of road in highly red oxidized monzonite, with streaks of manganese oxide.

A sample across top gave a result of \$2.40 in gold.

MIDNIGHT

45' vertical shaft and cross cut west 30'. All this working is in monzonite and assays can be obtained from \$2.00 to \$3.00 in gold.

FRACTION

14' vertical shaft and cross cut east 10'; west side of shaft andesite and east pegmatite, carries low values in gold.

GRAND VIEW

Vertical shaft 60' deep, sunk in shattered and decomposed monzonite, with oxidized streaks. Drift at bottom N. 55° E. 155' in length, courses through intensely and altered monzonite with numerous oxidized slips and selvages, for 65', at this point dark colored andesite is encountered, and the heading passes through this formation for 90' when the face enters pegmatite, altered and oxidized.

The andesite is normal, but altered along the smooth wedge shaped slips and cross fractures.

The line of demarkation between the monzonite and andesite is distinctly marked, the parting being vertical.

At a point 65' in the main heading a drift is driven south 40° East for 15' in crushed ground, smooth slicken walls and plastic selvages.

These smooth walls and slips have a general dip 40° S.W. \$2.00 gold values were obtained from samples in this area.

45' vertical shaft, N. 55° W. 200' from previous mentioned working, shaft in crushed material and detrital, cross cut at bottom N. 70° E. 85' in length, following a slip of altered granular monzonitic ^{material} oxidized and porphyritic with a dip 30° S. to a distance of 60'. Beyond this in the heading the drift enters altered oxidized pegmatite; at the contact is a red oxidized selvage 8" in width with a course at right angles to the drift N. 45° W. and dip of 40° S. W.

The drift continues to the face, in altered pegmatite. 5' back from face is a defined N. S. slip and quartz seam, with smooth walls, following course of drift, with slight dip N. the ground is friable and a sample of same returned \$2.50 gold.

Vertical shaft 20' deep on E. side line of Great West Claim, sunk in monzonite breccia, the main constituent being quartz.

Cross cut at bottom W. for 16' at face N.W. contact of monzonite and pegmatite.

Further south on east side line 10' vertical shaft in white kaolinized monzonite, pegmatite on E., the latter gave in assay result \$1.60 in gold.

Continuing S. on side line vertical shaft 17' deep, sunk in altered pegmatite.

Short drift E. midway in shaft, in porphy-rized pegmatite with streaks of manganese oxide. This material affords \$2.50 in gold.

20

Toward S. end line, vertical shaft
22' deep sunk in finely granular
detrital, cross cut at botton in
granular and oxidized pegmatite, face
in normal pegmatite, and carries low
gold content.

FRACTION

14' vertical shaft in fine granular
detrital drift E. 10' in andesite, at
face pegmatite.

OVERSIGHT 3

Shows a line of yellow and gray porph-
ry outcropping and proven by shallow
workings.

It has a general course S. 35° E.

This porphyry is evidently an altered
monzonite and in spots very much kaolin-
ized.