



## **CONTACT INFORMATION**

Mining Records Curator  
Arizona Geological Survey  
1520 West Adams St.  
Phoenix, AZ 85007  
602-771-1601  
<http://www.azgs.az.gov>  
[inquiries@azgs.az.gov](mailto:inquiries@azgs.az.gov)

The following file is part of the

Arizona Department of Mines and Mineral Resources Mining Collection

## **ACCESS STATEMENT**

These digitized collections are accessible for purposes of education and research. We have indicated what we know about copyright and rights of privacy, publicity, or trademark. Due to the nature of archival collections, we are not always able to identify this information. We are eager to hear from any rights owners, so that we may obtain accurate information. Upon request, we will remove material from public view while we address a rights issue.

## **CONSTRAINTS STATEMENT**

The Arizona Geological Survey does not claim to control all rights for all materials in its collection. These rights include, but are not limited to: copyright, privacy rights, and cultural protection rights. The User hereby assumes all responsibility for obtaining any rights to use the material in excess of "fair use."

The Survey makes no intellectual property claims to the products created by individual authors in the manuscript collections, except when the author deeded those rights to the Survey or when those authors were employed by the State of Arizona and created intellectual products as a function of their official duties. The Survey does maintain property rights to the physical and digital representations of the works.

## **QUALITY STATEMENT**

The Arizona Geological Survey is not responsible for the accuracy of the records, information, or opinions that may be contained in the files. The Survey collects, catalogs, and archives data on mineral properties regardless of its views of the veracity or accuracy of those data.

PRINTED: 05/30/2002

ARIZONA DEPARTMENT OF MINES AND MINERAL RESOURCES AZMILS DATA

PRIMARY NAME: OPAL JANE

ALTERNATE NAMES:

HAPPY GO 1-3

EMBER 1-3

CONWAY VANADIUM

GILA COUNTY MILS NUMBER: 569

LOCATION: TOWNSHIP 7 N RANGE 12 E SECTION 34 QUARTER W2

LATITUDE: N 33DEG 54MIN 22SEC LONGITUDE: W 111DEG 07MIN 01SEC

TOPO MAP NAME: COPPER MTN - 7.5 MIN

CURRENT STATUS: EXP PROSPECT

COMMODITY:

VANADIUM

BIBLIOGRAPHY:

ADMMR OPAL JANE FILE

ADMMR A. L. FLAGG VANADIUM RPT, BK V-11

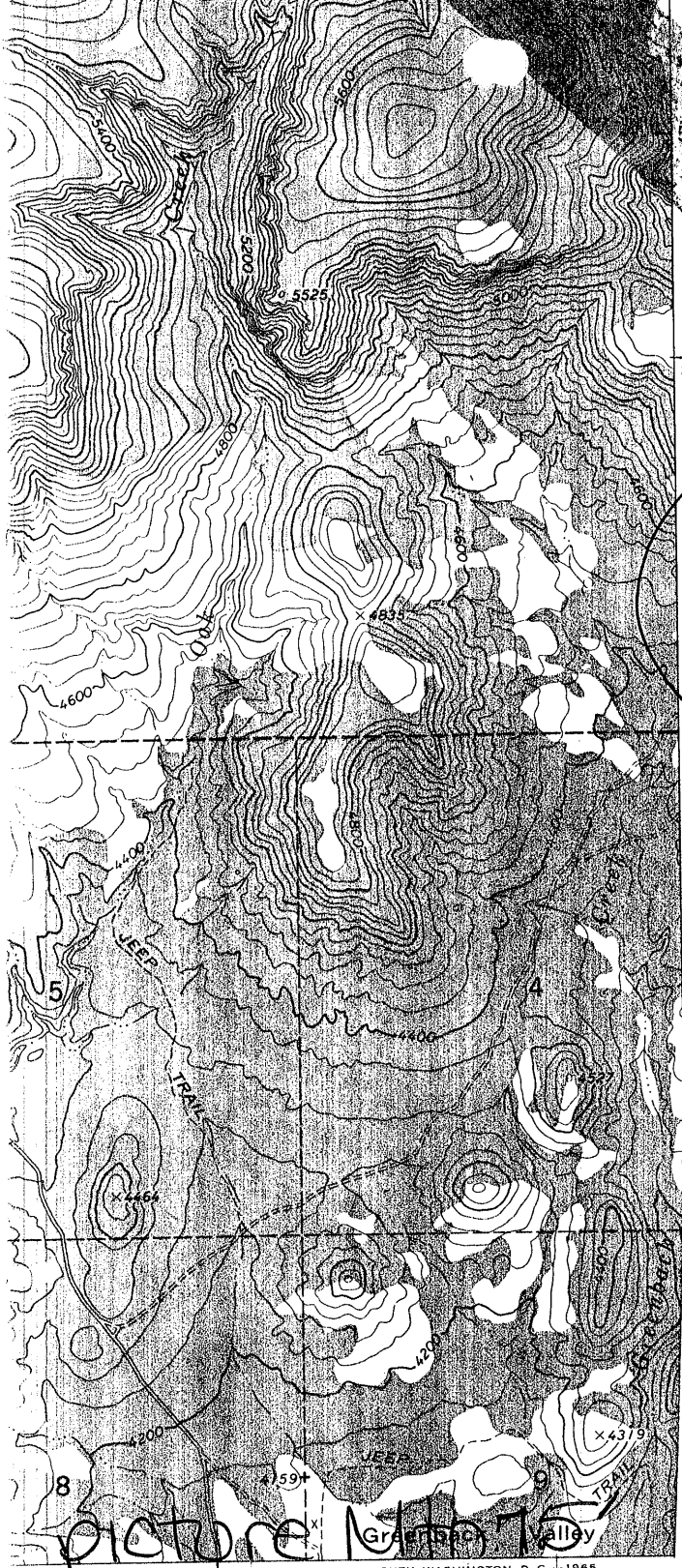

INTERIOR—GEOLOGICAL SURVEY, WASHINGTON, D. C. 1965  
 ONWAY RANCH 0.3 MI. 487000m. E. 488 111

33°52'30" 111°07'30" 210 000 FEET 490

569

ROAD CLASSIFICATION

Light-duty \_\_\_\_\_ Unimproved dirt -----

BACK CREEK  
3751 SW

**PICTURE MOUNTAIN, ARI**  
 N3352.5—W11107.5/7.5

1964

AMS 3751 NW—SERIES V898

Mapped, edited, and published by the Geological Survey  
 Control by USGS and USC&GS  
 Topography by photogrammetric methods from aerial  
 photographs taken 1962. Field checked 1964  
 Polyconic projection. 1927 North American datum  
 10,000-foot grid based on Arizona coordinate system, east zone  
 1000-meter Universal Transverse Mercator grid ticks,  
 zone 12, shown in blue  
 Where omitted, land lines have not been established

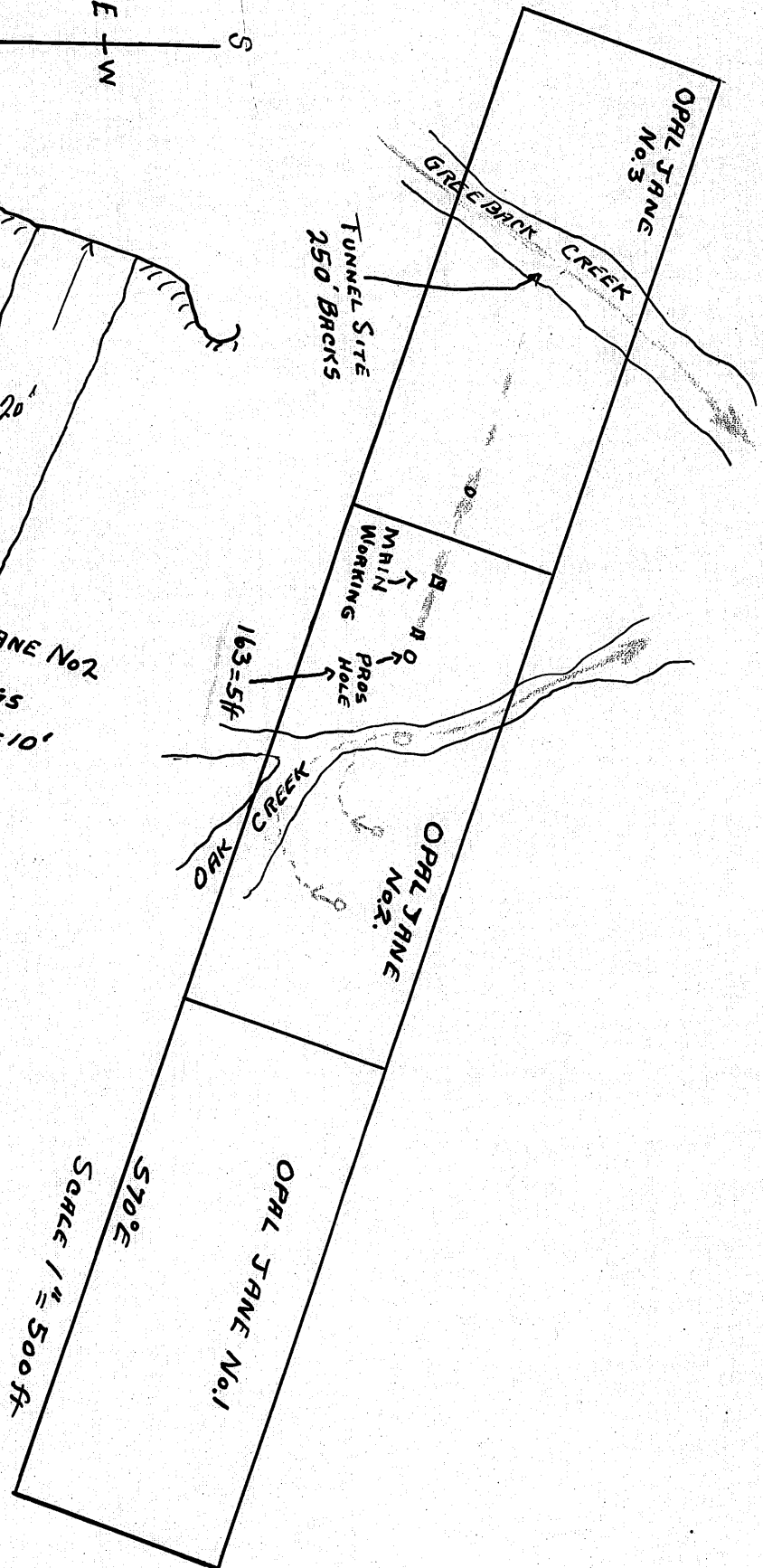
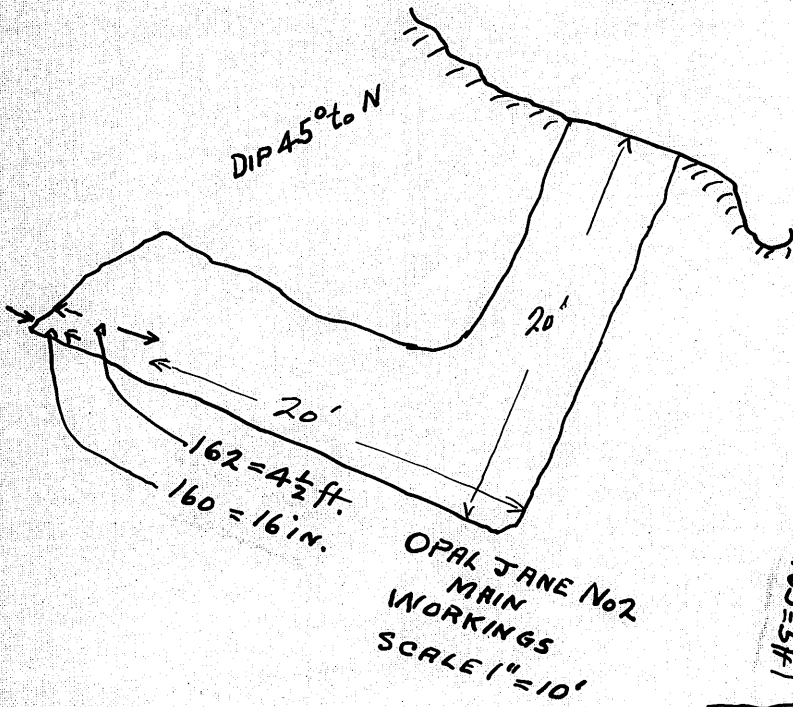
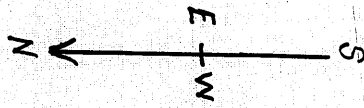

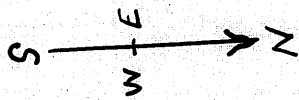
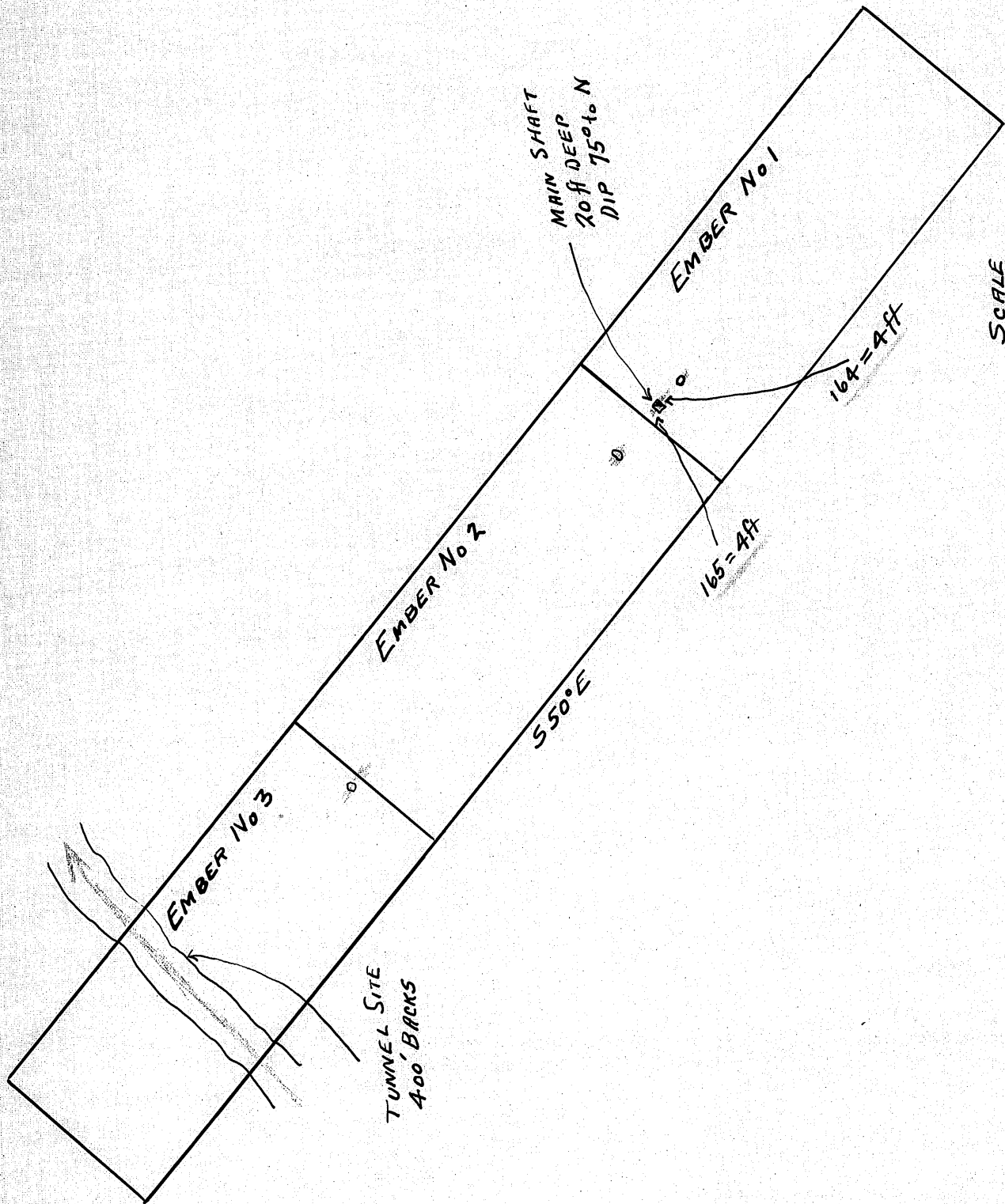

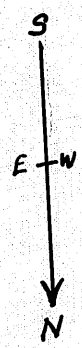
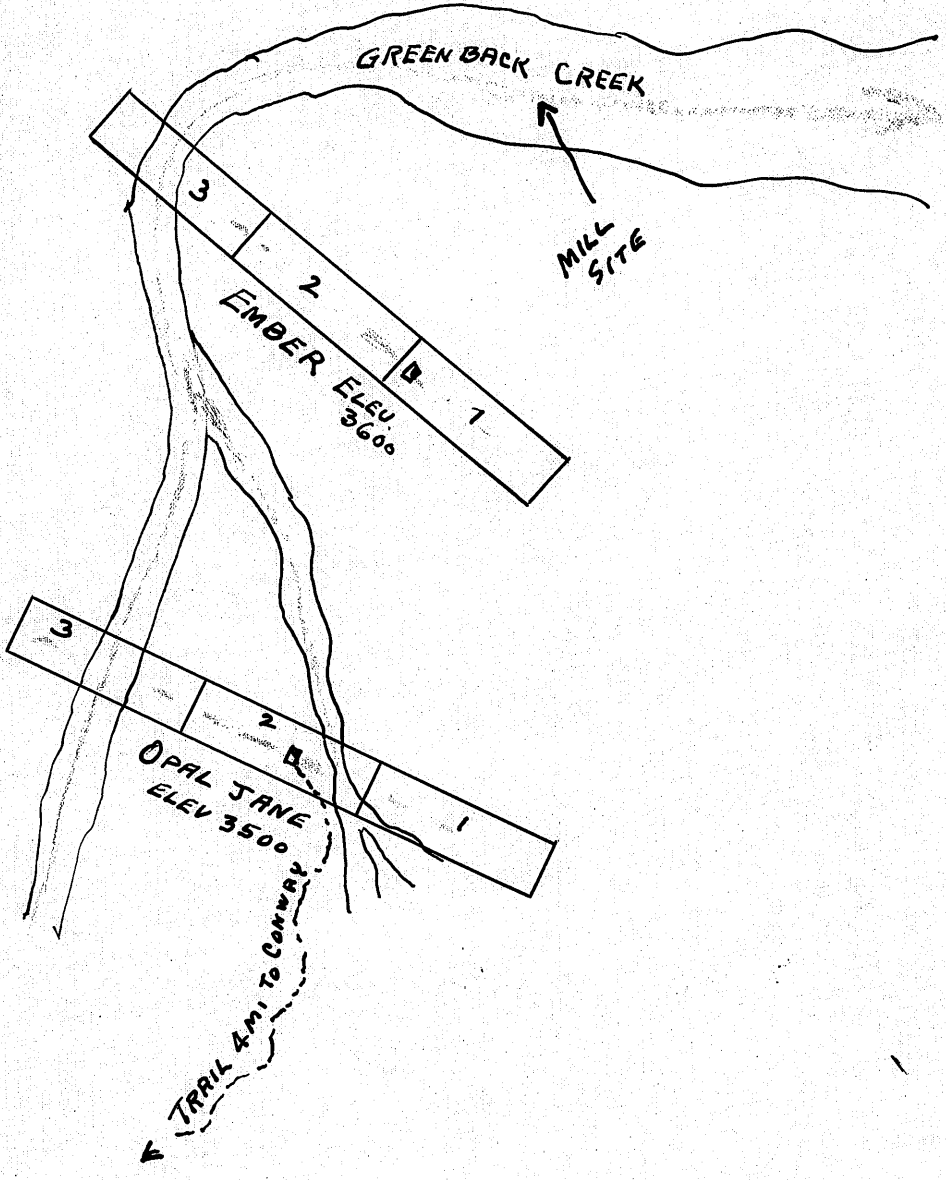
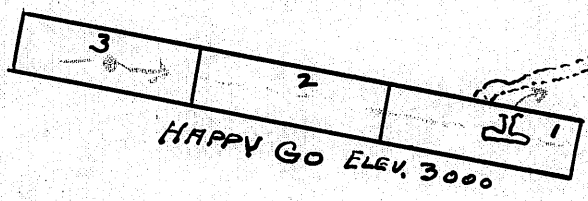



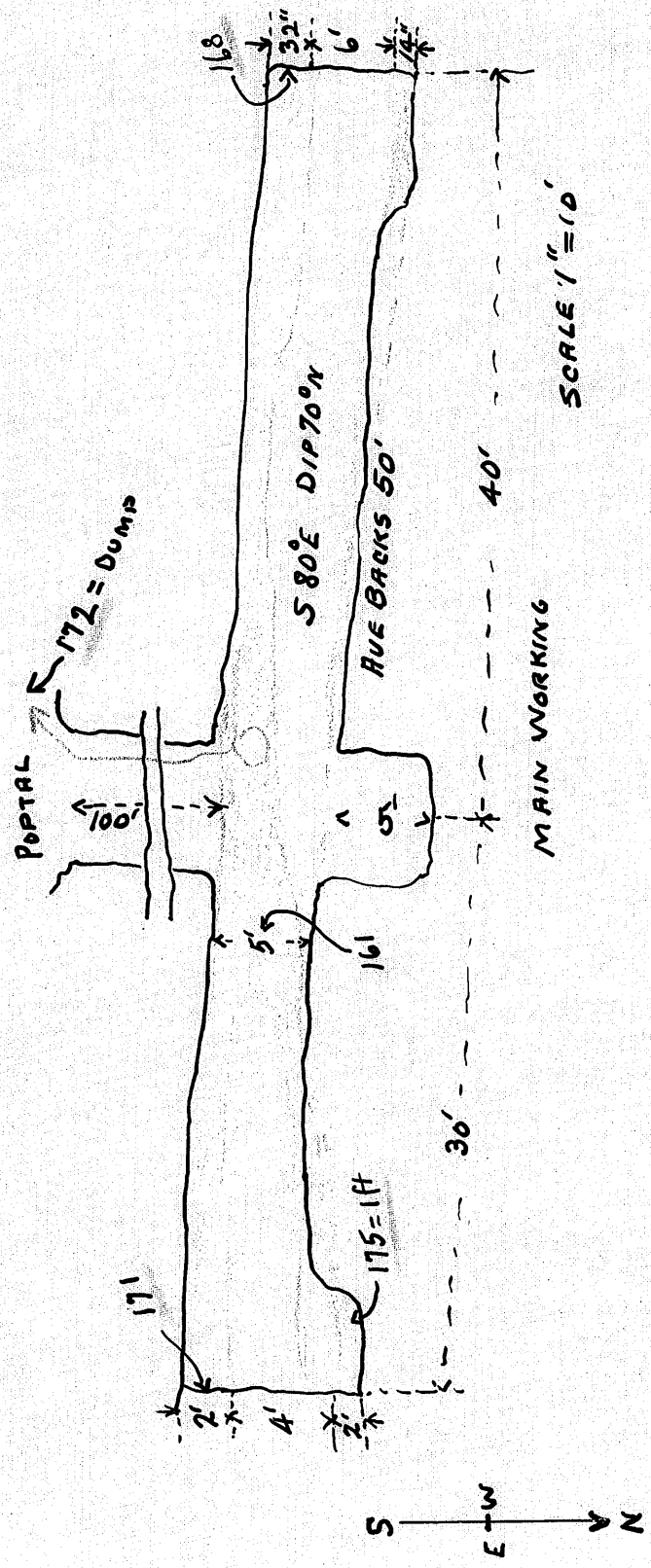
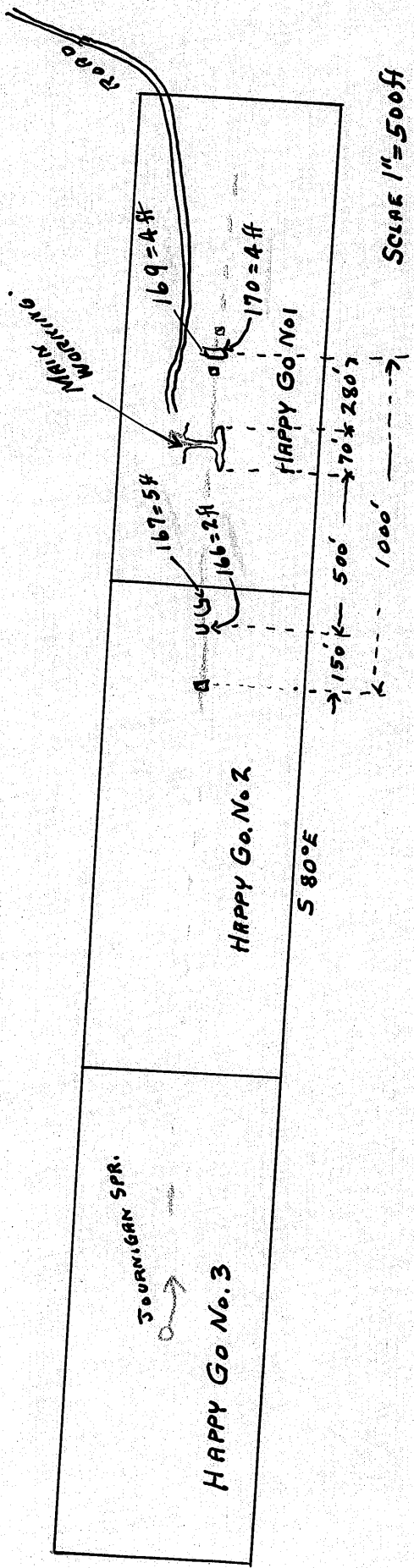

XXXXXXXXXXXXXXXXXXXXXXXXXXXX

413 Home Builders Bldg.

June 4, 1942

Mr. A. S. Lewis  
Cave Creek, Arizona

Dear Alf:

The copy of your letter to A. L. Flagg at Tucson has come to my attention and I have it in my file. Seeing you sent this copy, I took it for granted that you had mailed the original to Mr. Flagg.

Please let me know when you receive the assays and when you are advised of the next step to take.

With best wishes, I am

Yours very truly,

J. S. Coupal, Director

JSC:LP



May 25, 1942

VANADIUM  
OPAL JANE GROUP  
EMBER GROUP  
HAPPY GO GROUP

On May 17 I advised A. S. Lewis, of Cave Creek, regarding the plans of U. S. Vanadium Co. on vanadium property. I suggested that he contact the Conway brothers, Tonto Basin, on their properties.

Lewis wired May 22 that he had closed the deal, and called on May 23, stating that he had a 60-day lease and option on the Opal Jane group of three claims, on the Ember group of three claims, and on the Happy Go group.

I advised him to contact Arthur L. Flagg, and make arrangements for assaying samples and laying out an operating plan to submit.

J. S. Coupal

BOARD OF GOVERNORS:  
CHARLES F. WILLIS, PHOENIX  
CHAIRMAN  
DR. N. H. MORRISON, PHOENIX  
VICE-CHAIRMAN  
SHELTON G. DOWELL, DOUGLAS  
L. V. ROOT, KINGMAN  
LOYDE C. EDMONSON, GLOBE

# DEPARTMENT OF MINERAL RESOURCES

STATE OF ARIZONA  
518 TITLE AND TRUST BUILDING  
PHOENIX, ARIZONA



May 20, 1942

J. S. COUPAL, PHOENIX  
DIRECTOR  
W. J. GRAHAM, PHOENIX  
ASSISTANT TO THE DIRECTOR  
AND SECRETARY TO THE  
BOARD OF GOVERNORS

FIELD OFFICES AT  
GLOBE - KINGMAN  
PRESCOTT - TUCSON

REPLY TO

We have submitted your Mine Owner's Report to Mr. G. Donald Emigh, who is representing the U. S. Vanadium Corporation, with present headquarters at the Pioneer Hotel, Tucson, Arizona as being one of the properties from which vanadium production may be obtained.

The following item will explain our reason for so doing:

The U. S. Vanadium Corporation has been designated by the Metals Reserve Company to increase the production of lead vanadates and they are working in the southwest.

G. Donald Emigh, Pioneer Hotel, Tucson, is their representative, and Arthur L. Flagg, 29 W. Holly Street, Phoenix, is their field manager.

They are seeking small vanadium properties and are ready to handle them on almost any kind of a deal except actually buying properties. They will put money into development, they will lease, they will build small mills, they will work out processes, they will cooperate with the man to develop his own property. They will pay premium prices for that which they get. They will do almost anything and everything designed to bring out increased vanadium production.

An office is going to be established in Tucson and we will let you know the address as soon as we get it. Any occurrences of lead vanadates should be promptly reported to either Mr. Emigh or Mr. Flagg, or anyone who has vanadium properties should be referred to them.

We would suggest that you contact these parties at once and if you can furnish any information in addition to that which occurs in your Mine Owner's Report on file with us that you do so at once. Please advise us of your action.

With best wishes and hoping you get your property into early production, I am

Yours very truly,

*J. S. Coupal*  
J. S. Coupal,  
Director

JSC:LP

CLASS OF SERVICE

This is a full-rate Telegram or Cablegram unless its deferred character is indicated by a suitable symbol above or preceding the address.

# WESTERN UNION

1201

(16)

SYMBOLS

- DL=Day Letter
- NT=Overnight Telegram
- LC=Deferred Cable
- NLT=Cable Night Letter
- Ship Radiogram

R. B. WHITE  
PRESIDENT

NEWCOMB CARLTON  
CHAIRMAN OF THE BOARD

J. C. WILLEVER  
FIRST VICE-PRESIDENT

The filing time shown in the date line on telegrams and day letters is STANDARD TIME at point of origin. Time of receipt is STANDARD TIME at point of destination.

PSA218 10 XC=GLOBE ARIZ 22 130P

1942 MAY 22 PM 2 18

SAM COURAL=

*#3 Home Owners Bldg*

DIRECTOR DEPT MINERAL RESOURCES PHOENIX ARIZ=

CONWAY VANADIUMS CLOSED ALL HAVE GOOD VEIN APPEARANCE  
ENROUTE WINKELMAN=

ALF S LEWIS.

*34500*

*5/22 - Alf Lewis called  
 took Lewis's report on  
 Conway's property  
 - Opal mine - 3 claims  
 - Cowley group  
 - Happy go*



**ONLY WESTERN UNION**  
 can carry your message there by  
**TELEGRAPH. . Quickly, accurately**

4162

THE COMPANY WELCOMES SUGGESTIONS FROM ITS PATRONS CONCERNING ITS SERVICE

Dea. Son - Found Con. at Ariz  
Quicksilver property Tues P.M. - Moved  
to Con. Ranch. - wed. Move  
round about 25 miles to Best  
developed Con. Property - examined  
and closed. Returned Con. to  
Quicksilver and now returning  
to Con. Ranch. I hope Thurs. to  
Mon. other two Con. props.  
and close. May go direct  
to Wickenburg as am getting  
60 days here.

Must await assays but appear-  
ance OK.

Chas Diehl & a friend sent at  
Con. Ranch Monday.

Many thanks for your  
information furnished by Dept.

Yours  
A.S. Conroy  
Wickenburg

DEPARTMENT OF MINERAL RESOURCES  
STATE OF ARIZONA  
MINE OWNER'S REPORT

MO-8

Date 7-17-1939

1. Mine Opal Jane Mine
2. Location Tonto Basin, Arizona
3. Mining District & County Tonto
4. Former name Opal Jane
5. Owner Conway Bros.
6. Address (Owner)
7. Operator "
8. Address (Operator)
9. President, Owing Co.
- 9A. President, Operating Co.
10. Gen. Mgr.
14. Principal Minerals Vanadium, lead, molybdenum, Strontium
11. Mine Supt.
15. Production Rate
12. Mill Supt.
16. Mill: Type & Cap.
13. Men Employed
17. Power: Amt. & Type
18. Operations: Present
19. Operations: Planned
20. Number Claims, Title, etc. 17 recorded
21. Description: Topography & Geography monazite diabase
22. Mine Workings: Amt. & Condition Good 35 ft. shaft 14 ft. drift  
Conditions good for quick development.

calcite lime

Ore: Positive & Probable, Ore Dumps, Tailings 30 tons. Veins 48 in. wide.

A. Dimensions and Value of Ore body

Mine, Mill Equipment & Flow-Sheet

Road Conditions, Route 2 miles of road to build. \$1,000 will construct.

Water Supply Very good. 2" running springs.

Brief History The property was discovered and developed, February, 1939.

Special Problems, Reports Filed

Remarks Minerals showing good ore on 4 others working at depth of 12 ft. shafts.

If property for sale: Price, terms and address to negotiate. \$40,000.00. Terms to suit interested parties.

32. Signature.....M. J. Conway.....  
769 Ash Street, Globe, Arizona

Use additional sheets if necessary.

108  
10

DEPARTMENT OF MINERAL RESOURCES  
STATE OF ARIZONA  
OWNERS MINE REPORT

Date 7-17-1939

Mine Opal Jane

District Tonto

Location Tonto Basin, Arizona

Former name Opal Jane

Owner Conway Bros.

Address

Operator "

Address

President

Gen. Mgr.

Mine Supt.

Mill Supt.

Principal Metals Vanadium, Pb. Mo. Ce.

Men Employed

Production Rate

Mill: Type & Cap.

Power: Amt. & Type

Operations: Present

Operations Planned

Number Claims, Title, etc. 17 recorded

Description: Topog. & Geog. monazite diabase

Mine Workings: Amt. & Condition Good 35 ft. shaft 14 ft. drift  
Conditions good for quick development.

(over)



Geology & Mineralization On contact of andasite diabase igneous sugar quartz monazite  
calcite lime

Ore: Positive & Probable, Ore Dumps, Tailings 30 tons. Veins 48 in. wide.

Mine, Mill Equipment & Flow Sheet

Road Conditions, Route 2 miles of road to build. \$1,000 will construct.

Water Supply Very good. 2" running springs.

Brief History The property was discovered and developed, February, 1939.

Special Problems, Reports Filed

Remarks Minerals showing good ore on 4 others  
working at depth of 12 ft. shafts.

If property for sale: Price, terms and address to negotiate. \$40,000.00. Terms to suit interest parties.

Signed..... M. J. CONWAY

Use additional sheets if necessary. 769 Ash St., Globe, Arizona.

DEPARTMENT OF MINERAL RESOURCES  
STATE OF ARIZONA  
OWNERS MINE REPORT

06

Date 7/17/39

Mine opal zone

District TONTO

Former name opal zone

Owner Conway Bros.

Operator " " "

President ✓

Mine Supt. ✓

Principal Metals Vanadium - PB - MO - CE Men Employed ✓

Production Rate ✓

Power: Amt. & Type ✓

Operations: Present

Location Tonto Basin area

Address

Address

Gen. Mgr. ✓

Mill Supt. ✓

Mill: Type & Cap. ✓

Operations Planned

Number Claims, Title, etc. 17 recorded

Description: Topog. & Geog. Monazite Diabase

Mine Workings: Amt. & Condition good 35ft shaft 14ft drift  
Conditions good for quick development

t

Geology & Mineralization *on contact of andesite diabase  
igneous super quartz  
calcite Monazite  
lime*

Ore: Positive & Probable, Ore Dumps, Tailings *30 ton vein 4 ft wide*

Mine, Mill Equipment & Flow Sheet *✓*

Road Conditions, Route *2 miles of road to build  
\$100 will construct*

Water Supply *very good 2" running stream*

Brief History *the property was discovered and developed  
Feb - 1939*

Special Problems, Reports Filed

Remarks *Minerals showing good ore on 4 shafts  
working at depth of 12 ft shafts*

If property for sale: Price, terms and address to negotiate.

*\$40,000 Terms to suit interested parties*

Signed *M. J. Conway 769 4th St Globe*

Use additional sheets if necessary.

DEPARTMENT OF MINERAL RESOURCES  
STATE OF ARIZONA  
OWNERS MINE REPORT

Date 7-17-1939

1. Mine Opal Jane
2. Mining District & County Tonto
3. Former name Opal Jane
5. Owner  Conway Bros.  
*M. J. Conway*
7. Operator
9. President
11. Mine Supt.
13. Principal Metals Vanadium, Lead, Molybdenum,  
Cerium
15. Production Rate
17. Power: Amt. & Type
18. Operations: Present
19. Operations Planned
20. Number Claims, Title, etc. 17 recorded
21. Description: Topography & Geography monazite diabase
22. Mine Workings: Amt. & Condition Good 35 ft. shaft 14 ft. drift  
Conditions good for quick development

23. Geology & Mineralization On contact of andasite diabase lueous Sugar quartz monazite  
calcite lime

24. Ore: Positive & Probable, Ore Dumps, Tailings 30 tons. Veins 48 in. wide

24-A Vein Width, Length, Value, etc.

25. Mine, Mill Equipment & Flow Sheet

26. Road Conditions, Route 2 miles of road to build. \$1,000 will construct.

27. Water Supply Very good. 2" running springs.

28. Brief History The property was discovered and developed, February 1939.

29. Special Problems, Reports Filed

30. Remarks Minerals showing good ore on 4 others  
working at depth of 12 ft. shafts.

31. If property for sale: Price, terms and address to negotiate. \$40,000.00 Terms to suit interest  
parties.

32. Signed..... M. J. Conway.....

769 Ash St., Globe Arizona

33. Use additional sheets if necessary.

Mr. A. L. Flagg  
Pioneer Hotel  
Tucson, Arizona

*Conroy  
Vanadium*

Dear Flagg:

Following out your request I am sending you an outline of a proposal to enable work to be done on the three properties I spoke to you about and from which the samples were taken. I am preparing this proposal predicated upon the assumption that the samples taken from all points where I have proposed to do work will show assay results of at least mill grade. I am getting the cart before the horse only in order to save time and, of course, you will understand that any points where the vanadium values are unattractive, I would revise in the light of the assays.

Plan of Operation

Initial Stage - Some general prospecting work should be done, such as surface cuts and trenches, especially where the deep canyons cut these three veins. The program set out for the 'Opal Jane and 'Embers should be on a follow-the-ore basis, and followed through only as long as the values persisted. The work on the 'Happy Go would require an air compressor, the drift on the tunnel level to be carried both ways to the limits of the ore shoot with three raises to surface in the best parts of the shoot. The best raise would later on, if justified, be selected and continued downward as an inclined shaft. The amount required to bring all three properties to a decisive point along the above lines would be \$12,500.00.

Development Stage - With successful initial stage work done sufficient development to justify a 50-ton mill with adequate ore blocked out could be done with expenditure of \$27,500. If any of the three properties failed to show proper improvement it would be dropped after the initial stage.

Opal Jane and Ember

It will be necessary to pack in tools, camp and supplies to each of these two properties. For preliminary work hand steel, windless and buckets could be used to start operations and sink to depth of 50 feet each by which time a small light gasoline hoist and low triangular headframe should be ready and sinking continued to 100 feet in each of the two main shafts now about 20 feet in depth. Abundant cedar, oak and other trees will furnish most of timber necessary.

Cost of set-up and preliminary work on each property would be estimated as follows:

Moving in camp and equipment	50.00
Hoist-cable and buckets	300.00
Headframe, sorting table	100.00
Forge and Hand Steel	50.00
Powder, fuse, coal, etc.	200.00
Labor 80 ft. shaft	960.00
Labor 100 ft. drifting	900.00
Insurance and Compensation	200.00
Prospecting, Trenching, etc.	240.00

Total for each property \$3,000.00





LIST OF ASSAY SAMPLES

HAPPY GO

- 169 Low grade south side open cut at entrance  
Surface 4 ft.
- 170 High grade north side open cut at Breast  
4 ft. with 2 H.G. Streaks <sup>16A</sup> <sup>170</sup>  
(6 ft. mineralized between ~~A-1~~ and ~~A-2~~)
- 166 Good grade 24 in. (Several ft. min. gangue)
- 167 Ave - general vein including 1 ft. vein and 4 ft. decomposed  
granite and gangue 5 ft.
- Underground
- 168 Footwall vein 32" galena & qtz. At east breast
- 175 Black crystals - 14" HW vein
- 161 At junction HW & FW vein - back of drift 5' east of station - 5 ft.
- 171 Footwall vein 2 ft. at west breast.
- 172 Dump at portal.

OPAL JANE

- 163 Caueo Pros. hole black decom diorite  
5 ft. deep W. side 5 ft.
- 162 main working shaft  
General across 54" (12" good flourite & 42" brownish altered)  
E. side & cut near bottom
- 160 Same as 162 - 16 in. best ore

EMBER

- 164 20 ft. main shaft - 4 ft. general (12" good 3 ft mixed flourite,  
barite, Fe.Stain-altered material) East side
- 165 Same 4 ft. - W. side

Cline

- 173 General 8 ft. soft vein diorite
- 174 General 15 ft. hard wall rhyolite

The Happy Go may be reached by automobile road corssing Tonto Creek just above Roosevelt Lake. This road passes within two miles of the property where a passable road to mine can be used. The Ember is about 1½ miles beyond the end of the road. The Opal Jane is about 1½ miles beyond the Ember.

An excellent road can be built from the CCC-Pleasant Valley Highway connecting all the properties at a low cost as the surface material can all be graded with a bulldozer.

The Opal Jane and Ember are best reached by saddle horses from the Conway Ranch which can be reached by automobile by a road leaving the Roosevelt-Payson highway at Tonto Basin postoffice.

There is abundant water and good mill sites at the Happy Go and Opal Jane properties or an intermediate location on Greenback Creek, which would be centrally located from each and easily accessible from the highway.

My inexperience with vanadium occurrence may have caused me to overlook some of the vanadium possibilities on this property. It might, therefore, be

warranted to return and extend the sampling over a wider area in case the first set of samples are inconclusive, but I am in hopes that there will, at least, be sufficient evidence to justify you in visiting the properties as you would know just where to look for the key points for sampling.

The veins are all very persistent, showing mainly fluorite as a gangue, with silica in various forms and some of all the various spars. Galena occurs sparingly with considerable iron stained and altered material. The main country rocks in which the veins occur is a gabbro-diorite. The surrounding country is intrusive granitic with several kinds of diorite and some silicified segments of sierra ancha shales. The mines are in the western foothills of the Sierra Ancha Range.

If the vanadium values are attractive, there may be other values of gold, silver, lead, etc. that would help pay the expense of milling. I am told that these veins carry \$5.00 in gold with some silver.

Very truly yours,

✓ 

---

 Alfred Strong Lewis

Addresses

Cave Creek, Arizona  
and  
% Dept. Mineral Resources  
Phoenix, Arizona