



## **CONTACT INFORMATION**

Mining Records Curator  
Arizona Geological Survey  
1520 West Adams St.  
Phoenix, AZ 85007  
602-771-1601  
<http://www.azgs.az.gov>  
[inquiries@azgs.az.gov](mailto:inquiries@azgs.az.gov)

The following file is part of the

Arizona Department of Mines and Mineral Resources Mining Collection

## **ACCESS STATEMENT**

These digitized collections are accessible for purposes of education and research. We have indicated what we know about copyright and rights of privacy, publicity, or trademark. Due to the nature of archival collections, we are not always able to identify this information. We are eager to hear from any rights owners, so that we may obtain accurate information. Upon request, we will remove material from public view while we address a rights issue.

## **CONSTRAINTS STATEMENT**

The Arizona Geological Survey does not claim to control all rights for all materials in its collection. These rights include, but are not limited to: copyright, privacy rights, and cultural protection rights. The User hereby assumes all responsibility for obtaining any rights to use the material in excess of "fair use."

The Survey makes no intellectual property claims to the products created by individual authors in the manuscript collections, except when the author deeded those rights to the Survey or when those authors were employed by the State of Arizona and created intellectual products as a function of their official duties. The Survey does maintain property rights to the physical and digital representations of the works.

## **QUALITY STATEMENT**

The Arizona Geological Survey is not responsible for the accuracy of the records, information, or opinions that may be contained in the files. The Survey collects, catalogs, and archives data on mineral properties regardless of its views of the veracity or accuracy of those data.

PRINTED: 04/17/2002

ARIZONA DEPARTMENT OF MINES AND MINERAL RESOURCES AZMILS DATA

PRIMARY NAME: NEVER GET LEFT

ALTERNATE NAMES:

GOLDEN BUTTERFLY  
SOUTH DOG HOLE  
SOUTHERN PRIDE PATENT 1034A  
JOSEPHINE PATENT 1034A

MOHAVE COUNTY MILS NUMBER: 179A

LOCATION: TOWNSHIP 28 N RANGE 18 W SECTION 21 QUARTER SW  
LATITUDE: N 35DEG 47MIN 41SEC LONGITUDE: W 114DEG 12MIN 54SEC  
TOPO MAP NAME: GARNET MTN - 15 MIN

CURRENT STATUS: PAST PRODUCER

COMMODITY:

GOLD LODE  
SILVER  
COPPER

BIBLIOGRAPHY:

ADMMR NEVER GET LEFT FILE  
SCHRADER, F.C., USGS BULL 397, 1909, P. 123  
BLM AMC FILE 23734  
BLM MINING DISTRICT MAPS PATENT 1034A  
ALSO PROSPECTS IN SEC. 28-N2N2NW  
USGS PP 1361, P. 159

03/05/87

ARIZONA DEPARTMENT OF MINES AND MINERAL RESOURCES FILE DATA

PRIMARY NAME: NEVER GET LEFT

ALTERNATE NAMES:

GOLDEN BUTTERFLY  
SOUTH DOG HOLE  
SOUTHERN PRIDE PATENT 1034A  
JOSEPHINE PATENT 1034A

MOHAVE COUNTY MILS NUMBER: 179A

LOCATION: TOWNSHIP 28 N RANGE 18 W SECTION 21 QUARTER SW  
LATITUDE: N DEG MIN SEC LONGITUDE: W DEG MIN SEC  
TOPO MAP NAME: GARNET MTN - 15 MIN

CURRENT STATUS: PAST PRODUCER

COMMODITY:

GOLD LODE  
SILVER  
COPPER

BIBLIOGRAPHY:

ADMMR NEVER GET LEFT FILE  
SCHRADER, F.C., USGS BULL 397, 1909, P. 123  
AZ. BLM AMC FILE 23734  
BLM MINING DISTRICT MAPS PATENT 1034A  
ALSO PROSPECTS IN SEC. 28-N2N2NW

Name of Mine or Prospect: Never Get Left Mine	Township 28N	Range 18W	Section 21 cdb	Priority A
Principal Minerals: Gold, Silver	1:250,000 Quad Kingman	7.5' - 15' Quad Garnet Mtn.		
Associated Minerals: Quartz, Hematite, Chalcopyrite, Pyrite, Bornite	District Gold Basin	Principal Product Gold		
Type of Operation: Open pit & heap leach in operation 1981	County Mohave	State AZ	Type of Deposit Vein	

Ownership or Controlling Interest:  
Consult current USBLM mining claim records

Access: From the intersection of US Hwy 93 and Pierce Ferry road, proceed north on Pierce Ferry road for 20 miles. Turn left on unimproved road and proceed 4.5 miles. Mine is shown (unnamed) on topographic quadrangle.

#### Structural Control or Geological Association:

"The country rock is dark gneiss-schist. The structure dips about 50° west but the principal deposit dips about 80°N. It has a width of 6 to 8 feet and contains mainly iron-stained, copper-stained, crushed quartz-bearing gold. The country rock is greatly distributed by jointing, fracturing and faulting."<sup>1</sup>

"Extensive workings explore an 8 to 10 foot thick, quartz and alaskite vein system which strikes northwest and dips gently northeast. The vein system has been emplaced in a gneissic granodiorite which is strongly cataclastic in texture. Mineralization appears to be spotty and gold seems to be spatially associated with the copper minerals."<sup>2</sup>

#### Age of Mineralization:

Production History	Geochemical Analyses			
"Small producer, shipping ore (1909)" <sup>1</sup>	Assay (1980) <sup>2</sup>	Lab	Gold	Silver
"A cyanide heap leach operation is in operation (October 1981) by Houston-Kingman Mining Company. Size of leach pile and gold and silver yield are unknown." <sup>3</sup>	27-I-80-5	H	0.12	1.0
		H	0.220	0.14
		U	0.120	0.1
	80cj15	H	3.640	2.68
		H	3.678	2.62
		U	3.710	2.7
		P	5.10	2.6
		P	4.46	3.2
			4.44	3.4

#### References

- 1) Schrader (1909) p. 123.
- 2) Liggett and Childs (1980) Field reconnaissance.
- 3) Liggett (1981) Field reconnaissance.

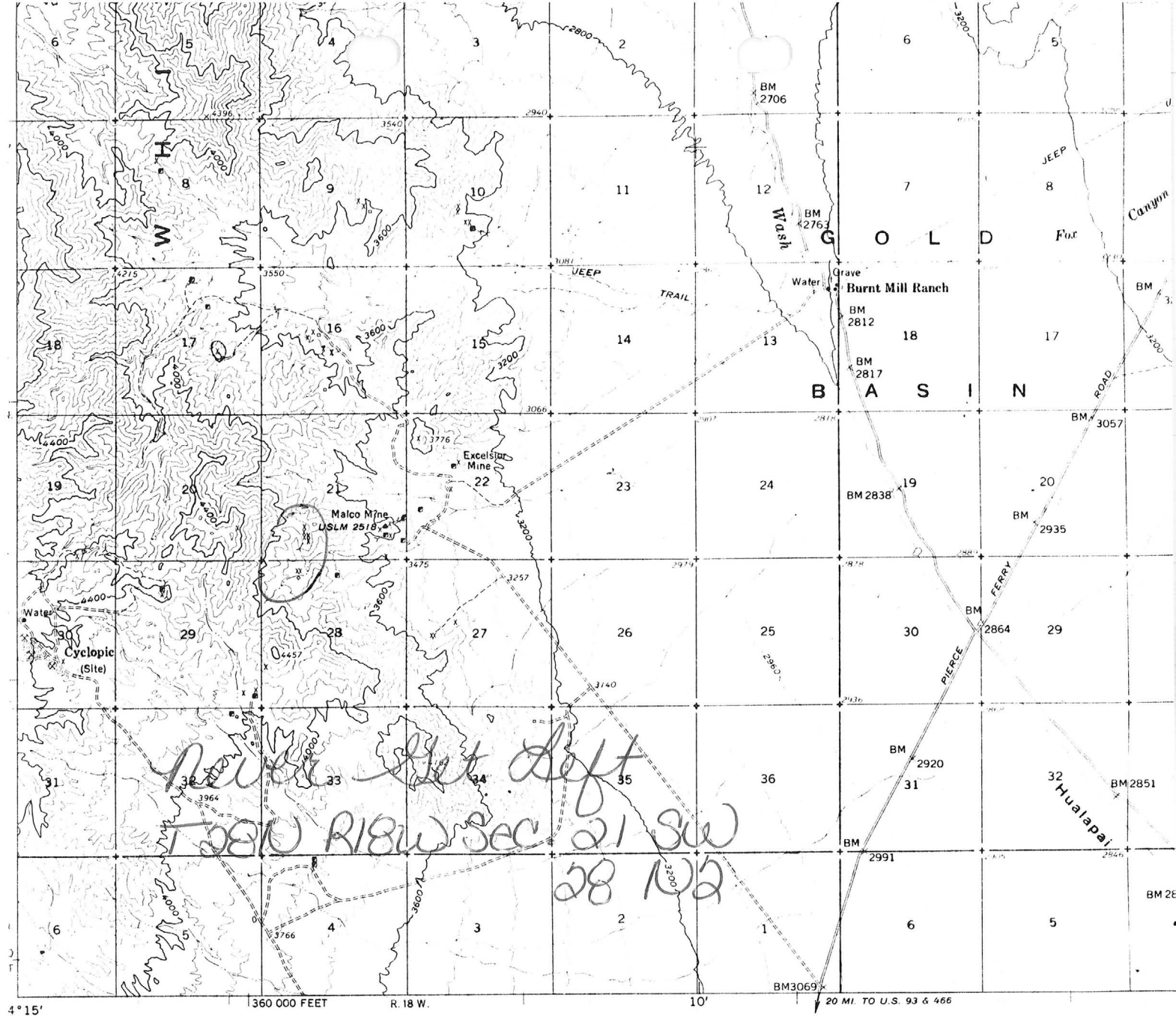

Mapped, edited, and published by the Geological Survey

Control by USGS and USC&amp;GS

Topography from aerial photographs by photogrammetric methods  
Aerial photographs taken 1958. Field check 1960

Underwater contours compiled from USDA maps  
and later sedimentation studies

Polyconic projection. 1927 North American datum  
10,000-foot grid based on Arizona coordinate system, west zone  
1000-meter Universal Transverse Mercator grid ticks,  
zone 11, shown in blue

Land lines unsurveyed in parts of T. 29 N.-R. 18 W.,  
and T. 30 N.-Rs. 17 and 18 W.

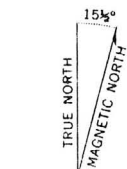

APPROXIMATE MEAN  
DECLINATION, 1960



SCALE 1:62500

CONTOUR INTERVAL 80 FEET  
DOTTED LINES REPRESENT 40-FOOT CONTOURS  
DATUM IS MEAN SEA LEVEL

THIS MAP COMPLIES WITH NATIONAL MAP ACCURACY STANDARDS  
FOR SALE BY U. S. GEOLOGICAL SURVEY, DENVER 25, COLORADO 80225  
A FOLDER DESCRIBING TOPOGRAPHIC MAPS AND SYMBOLS IS AVAILABLE

Garnet Mtn. 15'