



CONTACT INFORMATION

Mining Records Curator
Arizona Geological Survey
1520 West Adams St.
Phoenix, AZ 85007
602-771-1601
<http://www.azgs.az.gov>
inquiries@azgs.az.gov

The following file is part of the

Arizona Department of Mines and Mineral Resources Mining Collection

ACCESS STATEMENT

These digitized collections are accessible for purposes of education and research. We have indicated what we know about copyright and rights of privacy, publicity, or trademark. Due to the nature of archival collections, we are not always able to identify this information. We are eager to hear from any rights owners, so that we may obtain accurate information. Upon request, we will remove material from public view while we address a rights issue.

CONSTRAINTS STATEMENT

The Arizona Geological Survey does not claim to control all rights for all materials in its collection. These rights include, but are not limited to: copyright, privacy rights, and cultural protection rights. The User hereby assumes all responsibility for obtaining any rights to use the material in excess of "fair use."

The Survey makes no intellectual property claims to the products created by individual authors in the manuscript collections, except when the author deeded those rights to the Survey or when those authors were employed by the State of Arizona and created intellectual products as a function of their official duties. The Survey does maintain property rights to the physical and digital representations of the works.

QUALITY STATEMENT

The Arizona Geological Survey is not responsible for the accuracy of the records, information, or opinions that may be contained in the files. The Survey collects, catalogs, and archives data on mineral properties regardless of its views of the veracity or accuracy of those data.

PRINTED: 04/17/2002

ARIZONA DEPARTMENT OF MINES AND MINERAL RESOURCES AZMILS DATA

PRIMARY NAME: MYSTERY

ALTERNATE NAMES:
TUNGSTEN GROUP

YAVAPAI COUNTY MILS NUMBER: 928B

LOCATION: TOWNSHIP 8 N RANGE 1 E SECTION 28 QUARTER NW
LATITUDE: N 34DEG 00MIN 32SEC LONGITUDE: W 112DEG 16MIN 16SEC
TOPO MAP NAME: COLUMBIA - 7.5 MIN

CURRENT STATUS: PAST PRODUCER

COMMODITY:
LEAD
GOLD
SILVER

BIBLIOGRAPHY:
USGS COLUMBIA QUAD
ADMMR MYSTERY MINE FILE
BLM AMC FILE 89967
ADMMR GOLDEN ANCHOR FILE
ADMMR TUNGSTEN GROUP FILE

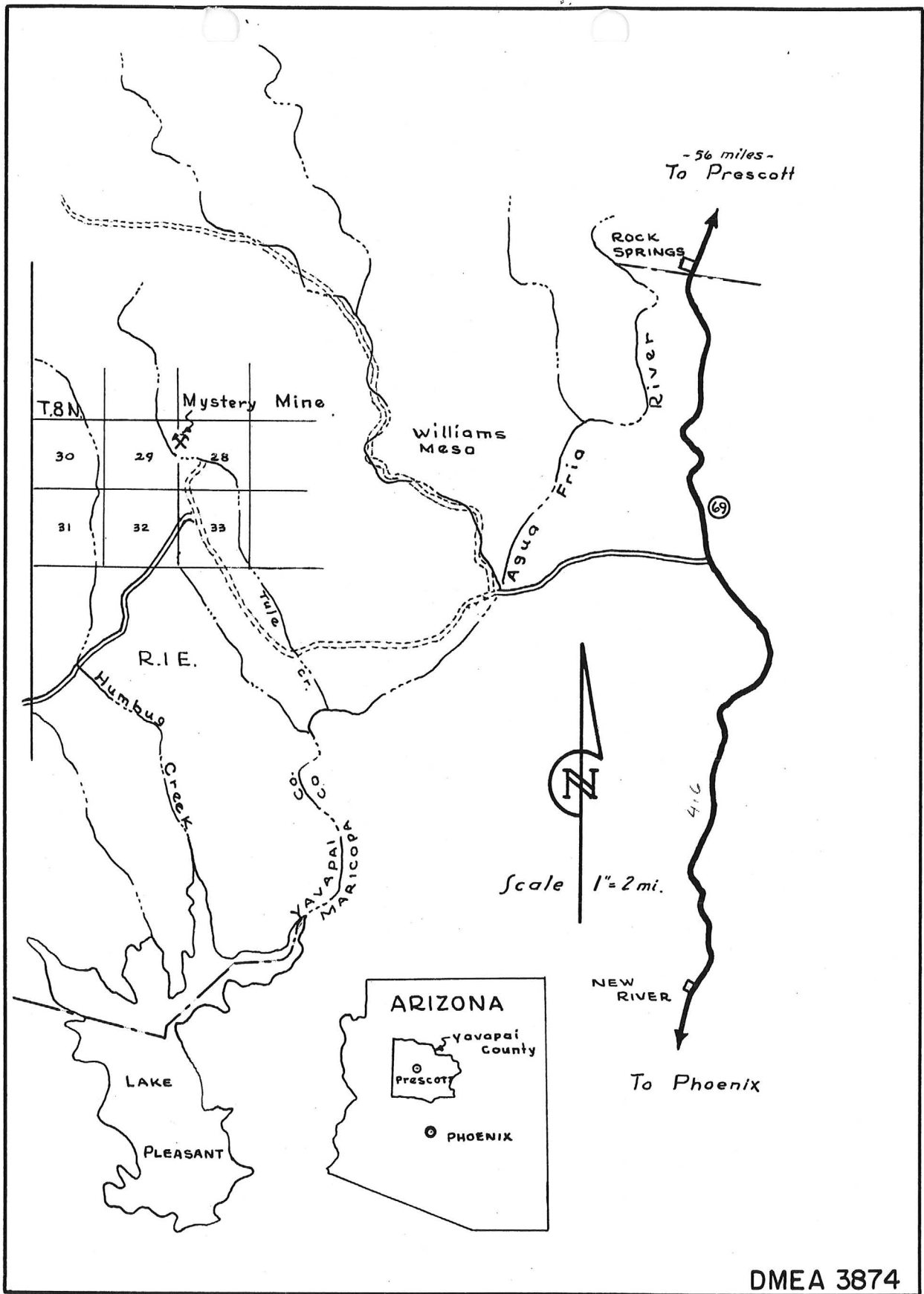

FIG. 1 LOCATION MAP, MYSTERY MINE, ARIZ.

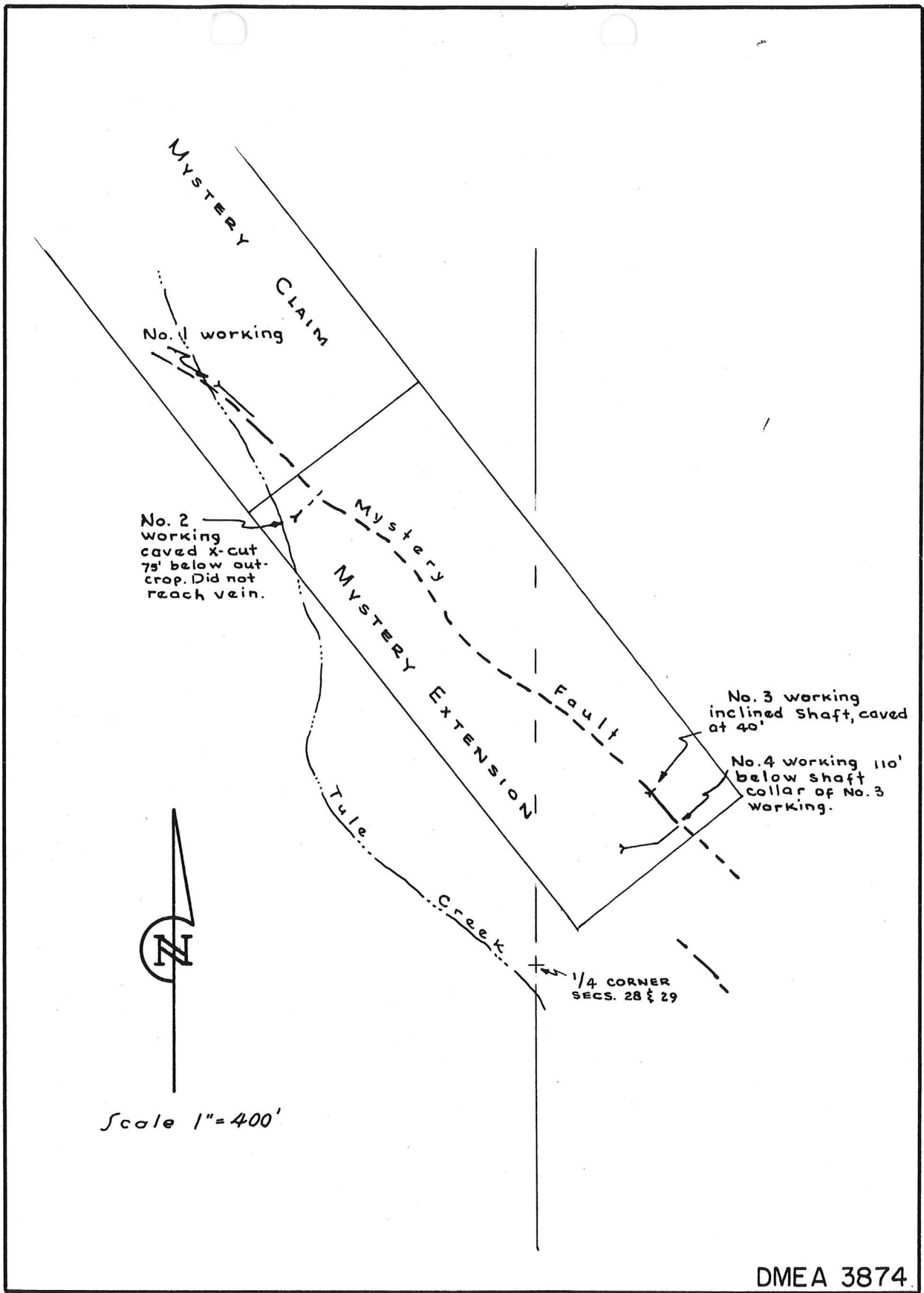

FIGURE NO. 2 CLAIM MAP, MYSTERY MINE
 YAVAPAI COUNTY, ARIZ.

May 27, 1957

MYSTERY

YAVAPAI COUNTY

This property inactive.

MARK GEMMILL

NAME OF MINE: MYSTERY

COUNTY: YAVAPAI

DISTRICT:

METALS: Pb, Ag, Au

OPERATOR AND ADDRESS:

MINE STATUS

DATE:

6/15/44

J.B. Johnson, Box 356,
Glendale, Ariz.

DATE:

6/15/44

5/45

3/46

Producing

Idle

Shipping & developing

Developing

REFERENCES

BLM Mining Claims File 89967

Golden Anchor file

Tungsten Group file

MILS Sheet sequence number 0040251463

File Your Mine Owner's Report With The Department of Mineral Resources

COMPLETE LIST OF ARIZONA MINES BEING COMPILED

A complete list of the mines in Arizona and pertinent data relating to them is being compiled by the Arizona Department of Mineral Resources, Capitol Building, Phoenix, Arizona. The principal purpose of this undertaking is to facilitate the selling and leasing of Arizona mines and encourage primary development of the state's mineral wealth.

The compilation is being made as a service to potential purchasers and leasers of mining properties and to those who would sell their mines or who desire to raise capital for further work. In order to accomplish the purpose of bringing buyers and sellers together, it is vital that the department have authentic and complete information in its files.

The work is, of course, free of charge. All that one must do to have his mine listed is to fill out the attached Mine Owner's Report and send it to the department. Either the owner or the operator of a property may fill out the report. No commission is allowed in case a deal is completed if the department was responsible for making the contact.

Four copies are made of each report sent in to the office. One is returned to the person who prepared the original, one is delivered to the department field engineer who covers that particular district, and two are retained in the Phoenix files.

As reports are received, the mines are classified as to the predominant metal, the character of the mine, development work done, etc. Then, when an inquiry is received for a gold prospect, an operating copper mine, a silver property that would justify the installation of a mill, or mines of other classifications, it is possible to give a preliminary report on all the mines available which fit the specifications.

The mine reports filed in the office, together with other reports on the same properties, made by Department of Mineral Resources field engineers, are made available to the prospective purchaser and he is advised to directly contact the owners to obtain further details. Engineers of the department visit the properties on which reports are sent in to confirm the information contained in the owner's report.

It is important that the mine owner, in filling out the report, give the information requested as completely as possible. A few reports have been filled out with a brief remark to the effect that it is a good prospect and anyone who is interested can come out and see it. A prospective investor would never give such a report a second glance.

One must put his best foot forward in attempting to sell a mine, just as in any other type of merchandising. An interest in a property can only be created when it can be described in detail.

The Mine Owner's Report has been prepared with great care and with attention to the questions that a potential investor will want answered before making a detailed investigation. Those who are interested in making a contact with persons who might buy, lease, or finance operations at their mines should fill the report out accurately and in as great detail as possible. Even if the property is only a prospect, the larger part of the information can be furnished and the owner stands a much better chance in interesting capital if the details are clearly set forth.

Mine maps, smelter returns, reports by independent engineers, or references to publications where additional information is available are all of value. Any such material will be filed carefully, will not be allowed to leave the department office, and will be returned on request.

Statements should be accurate and specific. If a man wants a property with a three-foot vein and looks a mine over where a mine report claims such a vein in sight but which, when examined, proves to be only six inches, you can't expect him to make a deal. Both your time and his are wasted.

Also, if you claim \$40 ore, of which you may have been able to sort out a small shipment, and sampling shows \$8 ore, the chances are that you will not make a deal. You can be enthusiastic and optimistic, but you should be accurate.

For your benefit, complete information regarding your property should be filed with the Department of Mineral Resources, Capitol Building, Phoenix, Arizona. Even if the mine is not for sale, or is leased, the material should be available in department files for some one may be seeking just what you have and might make an attractive offer.

The department has received many inquiries as to mining opportunities in Arizona. The contacts it has been able to make and the services it has rendered have been responsible for the operation of a number of mines in the state. People are constantly looking for promising mining properties and their requirements vary widely. Some want strategic minerals, others are looking for non-metallics, inquiries are received for placer mines, and some persons specify small mines while others want large ones.

Your mine may be just what someone is looking for, but obviously the department cannot assist you if it does not have the necessary data at hand. The more complete the information is the better for the first impression is made with the Mine Owner's Report.

In order to assist the mine owner in filling out the report, the items on which information is desired have been numbered and an explanation is given. The item numbers on the attached report correspond with the instruction numbers listed on the following page.

INSTRUCTIONS FOR FILLING OUT REPORT

1. **MINE.** Name by which mine or group of mining claims is generally known. For example, the Arizona Eastern Gold Mines Company owns a number of patented and unpatented claims generally known as the Octave mine. In that case the name would be Octave Mine.
2. **LOCATION.** Miles and direction to property from the nearest town and the route to take to reach it. Where possible, name section, township, and range in which mine is located.
3. **MINING DISTRICT AND COUNTY.** Name of mining district and county in which mine is located. The aforementioned Octave mine is in the Weaver mining district, Yavapai County.
4. **FORMER NAME.** Name or names by which mine was formerly known if it has not always had the name listed under item 1.
5. **OWNER.** Name or names of owner or owners. If mine is owned by a company or corporation, give that name.
6. **ADDRESS (OWNER).** Permanent mailing address of owner listed under item 5. Also, location of residence and place of business (this is particularly important when mail is received at a post office or R. F. D. box).
7. **OPERATOR.** Name or names of operator or operators if property is being worked under lease, contract, or some form of working agreement. Give company name if operated by a company.
8. **ADDRESS (OPERATOR).** Permanent mailing address of operator or operators listed under item 7. Also, location of residence and place of business (this is particularly important when mail is received at a post office or R. F. D. box).
9. **PRESIDENT, OWNING COMPANY.** Name of president if mine is owned by a company or corporation.
- 9A. **PRESIDENT, OPERATING COMPANY.** Name of president of operating company if the mine is being worked by other than the owning company.
10. **GENERAL MANAGER.** Name of the man in actual personal charge of operations.
11. **MINE SUPERINTENDENT.** Name of mine superintendent if operations require the services of a mine superintendent in addition to a general manager.
12. **MILL SUPERINTENDENT.** Name of mill superintendent if operations require the services of a mill superintendent in addition to a general manager.
13. **MEN EMPLOYED.** Number of men employed in connection with the operation of the property at the time this report is made. If none are employed, please state so. If employment is intermittent, give, besides the number of men employed at present, the average number of shifts per month or year.
14. **PRINCIPAL MINERALS.** The various metals or non-metals occurring or sought for in commercial quantities. Arrange in order of their relative importance from a standpoint of value.
15. **PRODUCTION RATE.** Express in tons of ore produced per day, week, month, or year. In case of placer properties give the number of yards handled. If production is intermittent, the output per year is preferred.
16. **MILL: TYPE AND CAPACITY.** If property is equipped with a mill, state the type; that is, cyanide, flotation, gravity concentration, amalgamation, etc. Also, give capacity in tons per hour or tons per 24 hours.
17. **POWER: AMOUNT AND TYPE.** State the total amount of horsepower used in full operation. Also, name the kind of power (Diesel, gasoline, electric, etc.) and if more than one type is used indicate the amount of each type in horsepower.
18. **OPERATIONS: PRESENT.** State in detail the work that is being done, such as shaft sinking, drifting or tunneling, raising, stoping, construction, repair work, or whatever else the operations may consist of. If the property is not being operated, please say so.
19. **OPERATIONS: PLANNED.** If additional work is planned for the coming year, outline what is contemplated.
20. **NUMBER OF CLAIMS, TITLE, ETC.** State the number of claims, listing those that are patented and those that are unpatented. A rough sketch or map showing the relative location of the claims and the principal workings would greatly increase the value of this report.
21. **DESCRIPTION: TOPOGRAPHY AND GEOGRAPHY.** State the elevation of the main workings and the approximate high and low points on the property. Describe the topography as to whether the land is rugged, steep, rolling, flat, etc. Give the general geography, such as the location of the claims in relation to mountain ranges, valleys, rivers, washes, etc., in the immediate vicinity.
22. **MINE WORKINGS: AMOUNT AND CONDITION.** State the number of shafts, their depths, inclination, type, condition, distance from collar to water, and also give details regarding ore bins, headframes, etc. List similar information as to number, condition, and equipment of adit tunnels, drifts, crosscuts, winzes, raises, surface cuts, or any other workings. Rough sketches should be provided to show the location of the various workings where possible.
23. **GEOLOGY AND MINERALIZATION.** Geological features of the orebody, such as the type of rock, faulting, folding, and any other striking characteristics of the vicinity. Tell type of deposit—whether sedimentary, igneous, or metamorphic—whether the vein is a fissure vein or replacement deposit—and describe the mineralization, telling whether the values occur as oxides or sulphides.
24. **ORE: POSITIVE AND PROBABLE. ORE DUMPS, TAILINGS.** Estimate the tonnage and value, and state how determined, of ore blocked out or reasonably in sight. Give a reasonable estimate of the ore that could be developed by additional work and an outline of that work. Estimate the tonnage and average value of ore dumps and tailings of commercial grade.
- 24A. **DIMENSIONS AND VALUE OF ORE BODY.** State the average dimensions of the ore body, such as the width and length as proved by mine workings or surface cuts and also give the average values of the various workings or veins. If more than one ore body or vein system, please describe.
25. **MINE, MILL EQUIPMENT AND FLOW-SHEET.** List the mine equipment and tell its condition. If equipped with a mill, describe the various items of equipment and give a flow-sheet. Show the percentage recovery made in milling and the grade of concentrates produced.
26. **ROAD CONDITIONS, ROUTE.** Type and condition of road to mine and maximum grade. Is it passable the year around? Can it be negotiated by new, low-clearance cars? Describe in detail just how to get to the mine from the nearest highway and railroad. If information can be obtained en route, state from whom and where.
27. **WATER SUPPLY.** Source and supply of domestic and mill water. If none available indicate so and give information on how it can be developed and quantity that should be obtained. Also give rainfall in area if possible.
28. **BRIEF HISTORY.** Briefly relate history and production if known. Tell when discovered and first worked and output in tons and value of ore milled or shipped. Give the names of the early owners and operators.
29. **SPECIAL PROBLEMS, REPORTS FILED, ETC.** List your technical problems and other difficulties apart from a lack of capital for development. If you have filed engineers' reports or maps or other data, please note here.
30. **REMARKS.** The owner may use this space for additional information not called for. The department would like to have the owner's prediction as to what might be done with the property and how much money it would take.
31. **IF PROPERTY IS FOR SALE: PRICE, TERMS, AND ADDRESS TO NEGOTIATE.** State whether the property is for sale or lease, the price, and the terms. This statement is not in any way binding, but rather to give the prospective purchaser an idea as to whether or not the property is within his range.
32. **SIGNATURE.** The signature of the owner or the operator of the property who filled out this report should be placed on this line.
33. **USE ADDITIONAL SHEETS IF NECESSARY.** If additional pertinent information should be included, or if it is desired to give a more comprehensive presentation, use additional sheets and label them with the numbers and headings on the Mine Owner's Report.

COPY

June 15, 1944

Chas. H. Dunning, Director
Department of Mineral Resources
Room 304 Home Builders Bldg.
Phoenix, Arizona

Dear Mr. Dunning:

J. B. Johnston, box 356, Glendale, shipped a car of lead ore to El Paso in December from the Mystery Mine in Tip Top district. He was paid some \$400 as "A" premium. In January and February two cars were shipped from this mine by A. H. Koppinger, 25 E. Indian School Rd., Phoenix. The premium was not paid on these last shipments. He has written Cong. Murdock complaining about the matter, but has received no reply.

Apparently, this is another of those cases in which payment was not made, due to shipper or owner failing to notify both Quota Committee and smelter of change of operation or status of property. A warning to this effect was carried in November "Pay Dirt" at request of AS&R. Their New York office will not authorize El Paso to make payment until change clears Quota Committee.

I asked Johnston to bring in his shipping returns so that we may follow up this case and also advise him what he must do.

Very truly yours

George A. Ballam

DEPARTMENT OF MINERAL RESOURCES
STATE OF ARIZONA
MINE OWNER'S REPORT

Date *Mar 11-1946*

1. Mine *Mystery*
2. Location *10 mi East Center Hot Springs
T & N R 1 E.*
3. Mining District & County *Humburg*
4. Former name *same*
5. Owner *J. B. Johnston*
6. Address (Owner) *Box 356
Glendale, Calif*
7. Operator *same*
8. Address (Operator)
9. President, Owing Co.
- 9A. President, Operating Co.
10. Gen. Mgr.
11. Mine Supt.
12. Mill Supt.
13. Men Employed
14. Principal Minerals *Lead, gold, Silver*
15. Production Rate *occasional shipments*
16. Mill: Type & Cap.
17. Power: Amt. & Type
18. Operations: Present
shipment
19. Operations: Planned
20. Number Claims, Title, etc. *22 claims, held location & assessment work.*
21. Description: Topography & Geography
rough & hilly
22. Mine Workings: Amt. & Condition
*Tunnels 900 ft
3 shaft - 50 ft each*

(over)

23. Geology & Mineralization

P. Dist. & pegmatite
DEPARTMENT OF MINES & GEOLOGY
STATE OF CALIFORNIA
MINE OWNERS' REPORT

24. Ore: Positive & Probable, Ore Dumps, Tailings

little

24A. Dimensions and Value of Ore body

*Value shipped 65⁰⁰ per ton
2 ft vein*

25. Mine, Mill Equipment & Flow-Sheet

✓

26. Road Conditions, Route

*good - reach property by way of Pleasant
Valley Dam -*

27. Water Supply

plenty

28. Brief History

29. Special Problems, Reports Filed

30. Remarks

31. If property for sale: Price, terms and address to negotiate.

*not for sale at this time
as option has been given*

32. Signature.....

J. B. Johnston

33. Use additional sheets if necessary.

ARIZONA DEPARTMENT OF MINERAL RESOURCES
MINERAL BUILDING, FAIRGROUNDS
PHOENIX, ARIZONA

June 30, 1958

To the Owner or Operator of the Arizona Mining Property named below:

<u>Mystery Mine (Yavapai Co.)</u>	<u>Lead, gold, silver</u>
(Property)	(ore)

We have an old listing of the above property which we would like to have brought up to date.

Please fill out the enclosed Mine Owner's Report form with as complete detail as possible and attach copies of reports, maps, assay returns, shipment returns or other data which you have not sent us before and which might interest a prospective buyer in looking at the property.

Frank P. Knight

FRANK P. KNIGHT,
Director.

Enc: Mine Owner's Report

MINERAL RESOURCES
of Arizona
ding, Fairgrounds
X, ARIZONA



REASON CHECKED
Unclaimed Refused
Unknown
Insufficient address
Moved, Left no address
No such office in state
Do not remail in this envelope

not this box

Mr. J. B. Johnson

~~Box 356~~

~~Glendale, Arizona~~

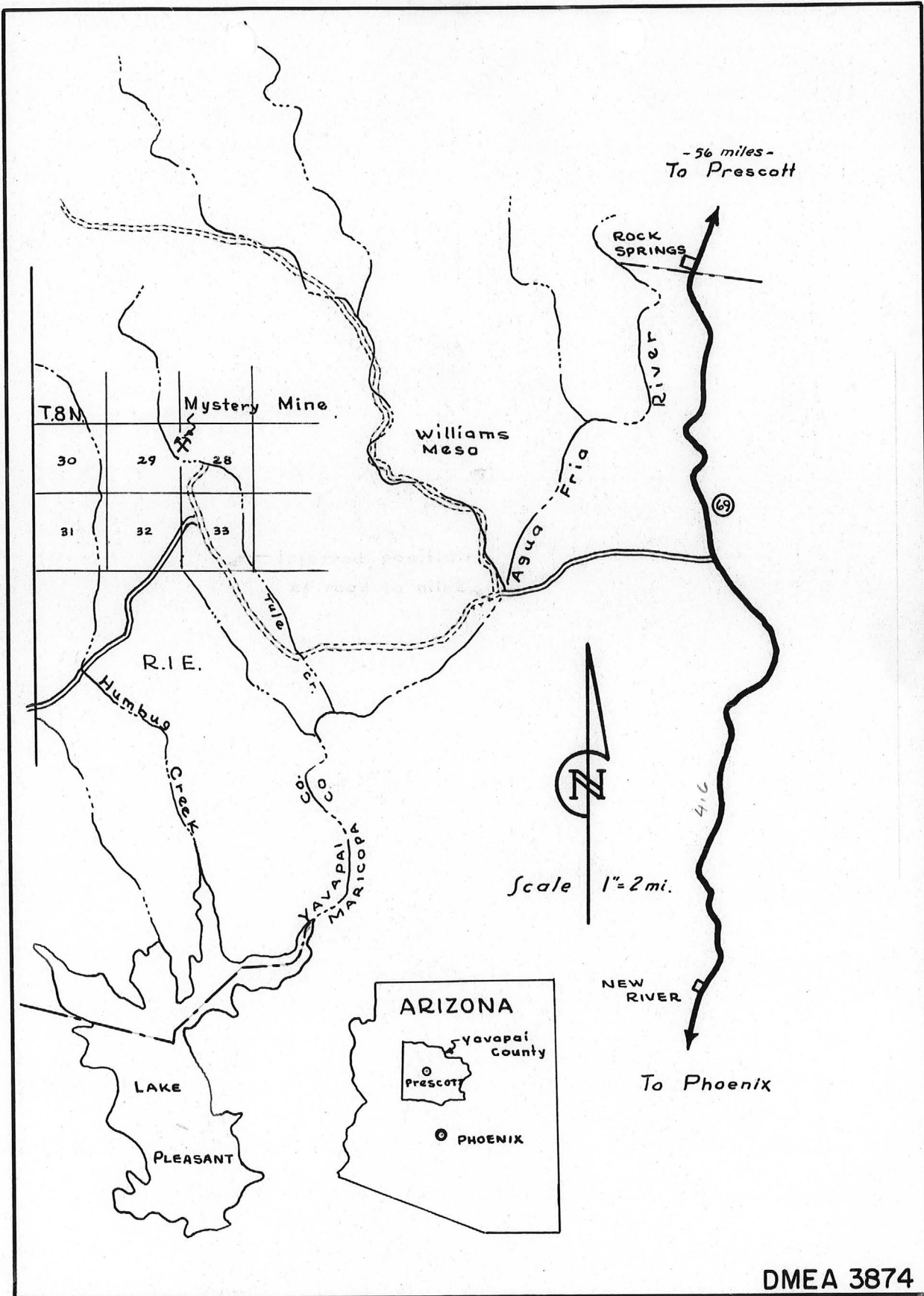

FIG. 1 LOCATION MAP, MYSTERY MINE, ARIZ.

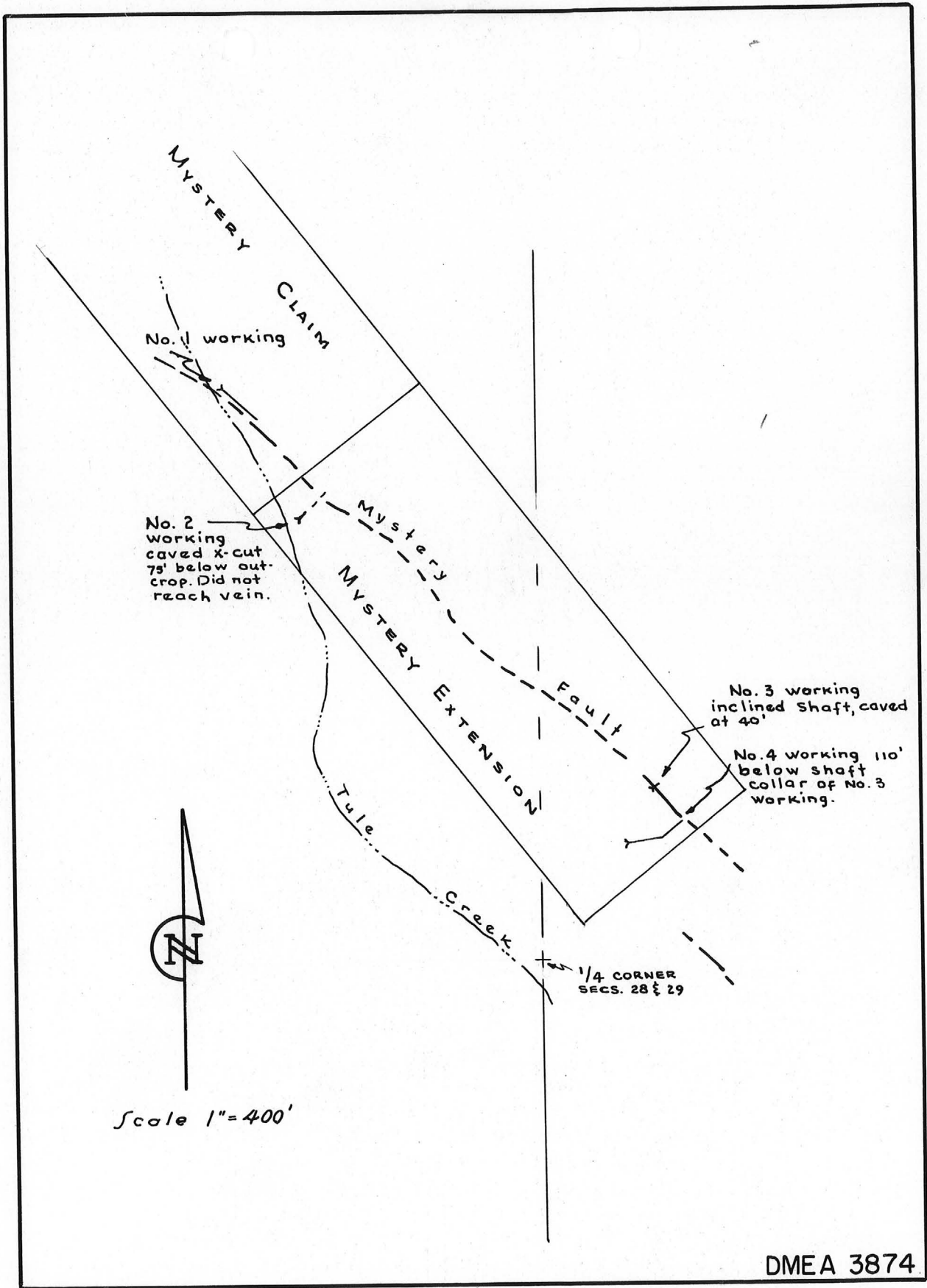

FIGURE NO. 2 CLAIM MAP, MYSTERY MINE
YAVAPAI COUNTY, ARIZ.