



CONTACT INFORMATION

Mining Records Curator
Arizona Geological Survey
1520 West Adams St.
Phoenix, AZ 85007
602-771-1601
<http://www.azgs.az.gov>
inquiries@azgs.az.gov

The following file is part of the

Arizona Department of Mines and Mineral Resources Mining Collection

ACCESS STATEMENT

These digitized collections are accessible for purposes of education and research. We have indicated what we know about copyright and rights of privacy, publicity, or trademark. Due to the nature of archival collections, we are not always able to identify this information. We are eager to hear from any rights owners, so that we may obtain accurate information. Upon request, we will remove material from public view while we address a rights issue.

CONSTRAINTS STATEMENT

The Arizona Geological Survey does not claim to control all rights for all materials in its collection. These rights include, but are not limited to: copyright, privacy rights, and cultural protection rights. The User hereby assumes all responsibility for obtaining any rights to use the material in excess of "fair use."

The Survey makes no intellectual property claims to the products created by individual authors in the manuscript collections, except when the author deeded those rights to the Survey or when those authors were employed by the State of Arizona and created intellectual products as a function of their official duties. The Survey does maintain property rights to the physical and digital representations of the works.

QUALITY STATEMENT

The Arizona Geological Survey is not responsible for the accuracy of the records, information, or opinions that may be contained in the files. The Survey collects, catalogs, and archives data on mineral properties regardless of its views of the veracity or accuracy of those data.

PRINTED: 03/22/2002

ARIZONA DEPARTMENT OF MINES AND MINERAL RESOURCES AZMILS DATA

PRIMARY NAME: MOLLIE GIBSON

ALTERNATE NAMES:
DOLLIE GIBSON

SANTA CRUZ COUNTY MILS NUMBER: 165

LOCATION: TOWNSHIP 23 S RANGE 16 E SECTION 16 QUARTER E2
LATITUDE: N 31DEG 25MIN 48SEC LONGITUDE: W 110DEG 42MIN 35SEC
TOPO MAP NAME: HARSHAW - 7.5 MIN

CURRENT STATUS: PAST PRODUCER

COMMODITY:
LEAD
SILVER

BIBLIOGRAPHY:
AZBM CLIPPING FILE 1919-1930
ARIZONA MINING JOURNAL JAN. 1, 1922, P. 24
ARIZONA MINING JOURNAL JUNE 30, 1940, P. 3-6
ADMMR MOLLIE GIBSON FILE

11/25/96

ARIZONA DEPARTMENT OF MINES AND MINERAL RESOURCES FILE DATA

PRIMARY NAME: MOLLIE GIBSON

ALTERNATE NAMES:

DOLLIE GIBSON

SANTA CRUZ COUNTY MILS NUMBER: 165

LOCATION: TOWNSHIP 23 S RANGE 16 E SECTION 16 QUARTER E2
LATITUDE: N 31DEG 25MIN 48SEC LONGITUDE: W 110DEG 42MIN 35SEC
TOPO MAP NAME: HARSHAW - 7.5 MIN

CURRENT STATUS: PAST PRODUCER

COMMODITY:

LEAD
SILVER

BIBLIOGRAPHY:

AZBM CLIPPING FILE 1919-1930
ARIZONA MINING JOURNAL JAN. 1, 1922, P. 24
ARIZONA MINING JOURNAL JUNE 30, 1940, P. 3-6
ADMMR MOLLIE GIBSON FILE

23 S

Lawshaw 7 1/2' Quad



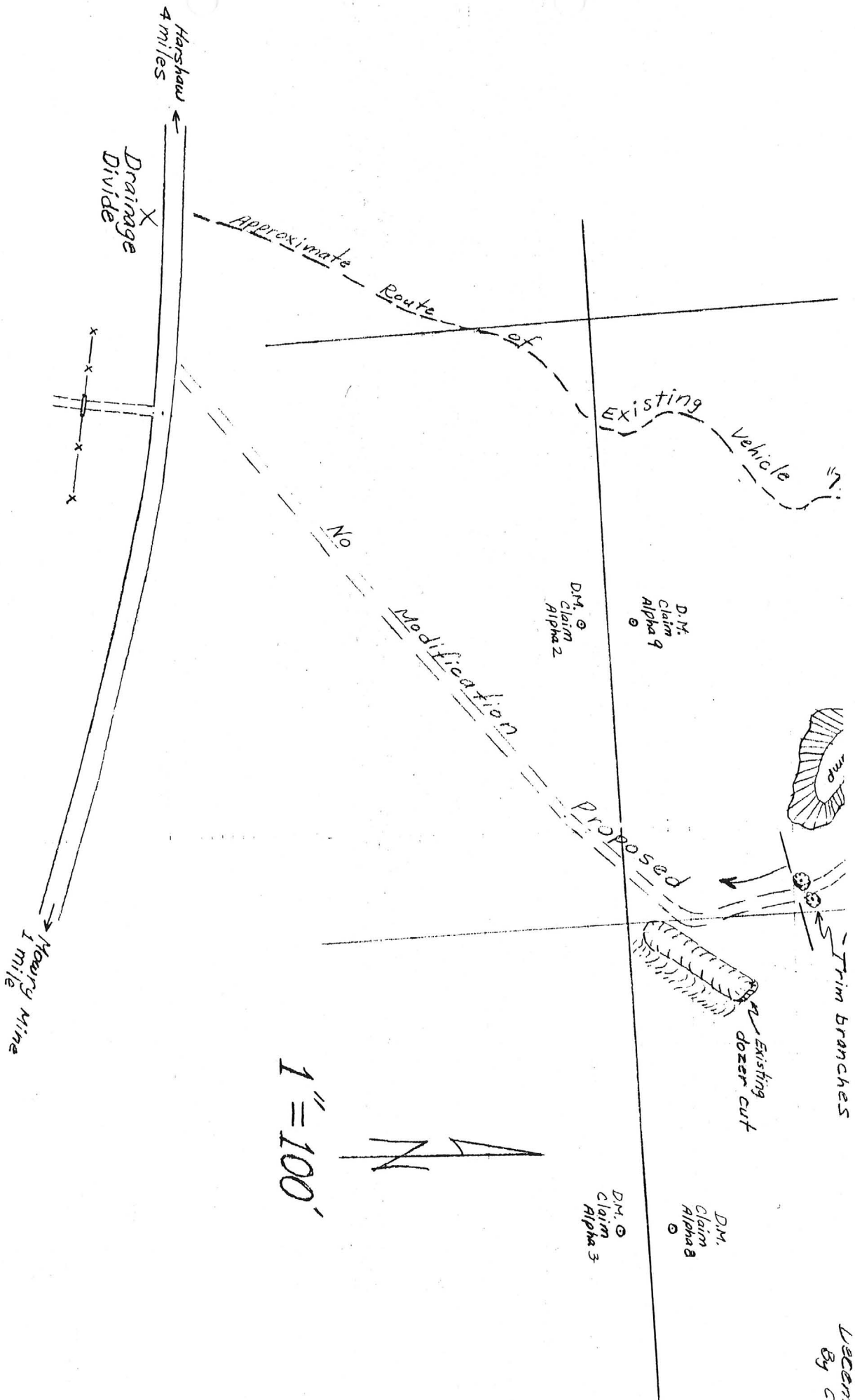

LECEN
By C

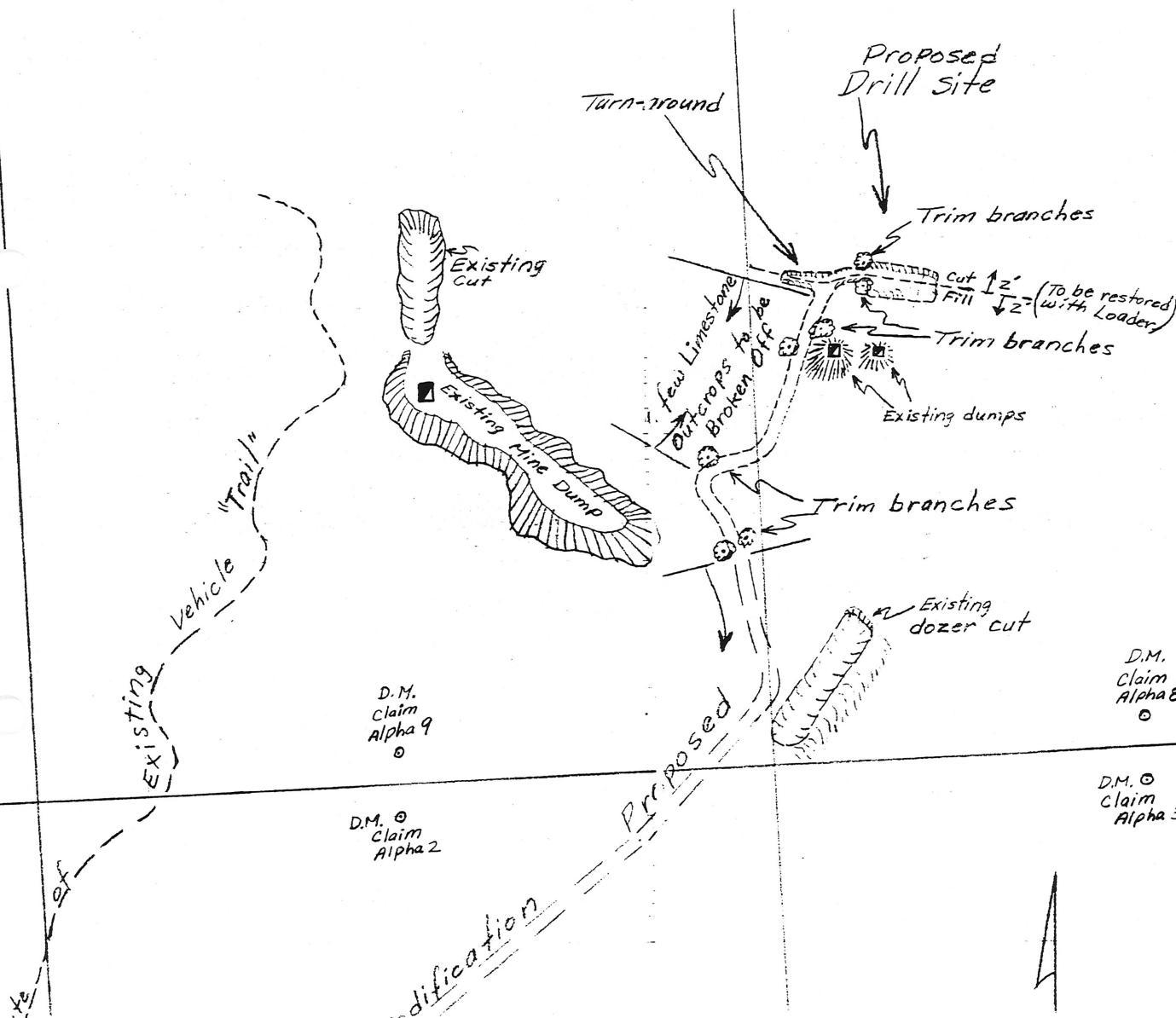

Continental
Materials
Corporation

Proposed Drill Site
and drill road

SE $\frac{1}{4}$, protracted
section 16, T. 23S, R. 16E
Santa Cruz County, Ariz.
Harshaw 7 $\frac{1}{2}$ ' quad.

December, 1977
By C.J. Orback

VOLUME 11, NUMBER 1, APRIL 1978
Santa Cruz Co.

CONTINENTAL MATERIALS CORPORATION

Mining Division Office: Suite 101, 2002 N. Forbes Blvd. * P.O. Box 50726, Tucson, Arizona 85703 Phone (602) 882-4144

April 11, 1978

Mr. William Kastelic
UV Industries, Inc.
University Club Bldg.
136 East South Temple
Salt Lake City, Utah 84111

Dear Mr. Kastelic:

As I explained in our phone conversation of last Thursday, we had just found ourselves beginning a drill hole on your property some 12 miles south of Patagonia — without benefit of a prior agreement. This was due of course to an inadequate land status search on our part. And, for reasons of economy, high public visibility, and trespass laws I hope all equipment and the core-logging trailer have been removed before now. I might also add that I suddenly feel an urge, probably resistible, to remove at least the claim notices, because they include my name.

Since you indicated that we might form some sort of mutually beneficial exploration agreement and requested a proposal I would like to reiterate what I believe to be the potential of the area, and something of the local geology (See enclosures).

The area that interested me is about three quarters of a mile northwest of the old Mowry Mine. Potentially productive ground consists mainly of some 2,000 feet of the Harshaw Creek fault. Dip length of this part of the fault would vary from 500 to 1,000 feet, where Martin and Abrigo limestones are in the footwall. Lateral limits, northwest and southeast, would be at the intersections of the two northerly trending faults and the Harshaw Creek fault. In addition, the lowermost limestone in the section may constitute ore for some hundreds of feet northward, downdip, from the Harshaw Creek fault. Certainly less than a million tons and hopefully at least a third that much good grade argentiferous galena might be found.

Structurally this is an elevated fault block which includes the crest of a northward plunging anticline. The lowermost carbonate in the section is nearest the surface here and is within drilling and mining distance, assuming a small ore body to be present. In addition, this is the locality toward which hydrothermal fluid would have moved upward from the northwest, north and east through faults and the permeable bedding planes of the Martin and Abrigo limestone. Hopefully fluid would have been partially ponded against the Cretaceous rocks in the hanging wall of the Harshaw Creek fault.

Lollie Gibson(?) A slight amount of galena can be found on the dump the the old small mine near the drill site. And, up to several feet of hematite, magnetite, manganese oxides, quartz and various calcium silicates are locally present along the fault in this vicinity.

As to a proposal, or basis for initiating negotiations, I would suggest a lease at 7½% royalty with payments to your company proportional to your percentage of interest in the property in the event a third party may have royalty rights. We will, of course, assume maintenance costs such as taxes and for assessment work drill at least one hole before September, 1978 and complete at least a second hole before one year had passed or relinquish the property. In the event a viable deposit is disclosed UV Industries would have a first opportunity to participate in a joint venture operation if it was indicated.

Hopefully I have piqued your interest a bit and the proposed terms are sufficiently close to being agreeable that we can sign an agreement in relatively short order.

Yours very truly,



C. J. Orback
Geologist

CJO/lk

Enclosures

cc: H. M. Smithson
S. M. Gunther
C. H. Reynolds