



CONTACT INFORMATION

Mining Records Curator
Arizona Geological Survey
1520 West Adams St.
Phoenix, AZ 85007
602-771-1601
<http://www.azgs.az.gov>
inquiries@azgs.az.gov

The following file is part of the

Arizona Department of Mines and Mineral Resources Mining Collection

ACCESS STATEMENT

These digitized collections are accessible for purposes of education and research. We have indicated what we know about copyright and rights of privacy, publicity, or trademark. Due to the nature of archival collections, we are not always able to identify this information. We are eager to hear from any rights owners, so that we may obtain accurate information. Upon request, we will remove material from public view while we address a rights issue.

CONSTRAINTS STATEMENT

The Arizona Geological Survey does not claim to control all rights for all materials in its collection. These rights include, but are not limited to: copyright, privacy rights, and cultural protection rights. The User hereby assumes all responsibility for obtaining any rights to use the material in excess of "fair use."

The Survey makes no intellectual property claims to the products created by individual authors in the manuscript collections, except when the author deeded those rights to the Survey or when those authors were employed by the State of Arizona and created intellectual products as a function of their official duties. The Survey does maintain property rights to the physical and digital representations of the works.

QUALITY STATEMENT

The Arizona Geological Survey is not responsible for the accuracy of the records, information, or opinions that may be contained in the files. The Survey collects, catalogs, and archives data on mineral properties regardless of its views of the veracity or accuracy of those data.

PRINTED: 02/01/2002

ARIZONA DEPARTMENT OF MINES AND MINERAL RESOURCES AZMILS DATA

PRIMARY NAME: MCGUFFIE

ALTERNATE NAMES:

SALLY ANN GROUP
ISHAM PROPERTY
MOUNTAIN ROSE
KING MEDICI

MOHAVE COUNTY MILS NUMBER: 387A

LOCATION: TOWNSHIP 11 N RANGE 14 W SECTION 26 QUARTER SW
LATITUDE: N 34DEG 16MIN 00SEC LONGITUDE: W 113DEG 41MIN 09SEC
TOPO MAP NAME: ARTILLERY PEAK - 15 MIN

CURRENT STATUS: PAST PRODUCER

COMMODITY:

GOLD LODE
GOLD
SILVER
COPPER

BIBLIOGRAPHY:

ADMMR MCGUFFIE FILE
ADMMR MOHAVE MINE FILE
ADMMR "U" FILE, GOLD - SALLY ANNE GROUP

Name of Mine or Prospect McGuffie	Township 11N	Range 14W	Section 26 cac	Priority C
Principal Minerals:	1:250,000 Quad Prescott		7.5' - 15' Quad Artillery Peak	
Associated Minerals:	District Artillery Mountain		Principal Product	
Type of Operation:	County Mohave	State Arizona	Type of Deposit	

Ownership or Controlling Interest:
Consult current USBLM mining claim records.

Access: Vehicle access is difficult due to poor road conditions; consult topographic map for existing jeep trails.

Structural Control or Geological Association:

"Older Precambrian Age, schist."¹

"The McGuffie mine and surrounding prospects occur in mylonitic gneiss structurally below the Rawhide Mountains detachment fault."²

Age of Mineralization:

Production History

Geochemical Analyses

References

- 1) Wilson & Moore (1959) Geologic map.
- 2) Schackelford (1976) Geologic map.

ARIZONA DEPARTMENT OF MINERAL RESOURCES
 MINERAL BUILDING, FAIRGROUNDS
 PHOENIX, ARIZONA

July 16, 1958

Mrs. Venice Wilkes
 Aguila
 Arizona

DEPT
 F

ining Property named below:

.d, silver, copper, lead
 (ore)

erty which we would like to have

RETURNED TO
 REASON CHECKED
 Unclaimed
 Unknown
 Insufficient postage
 Moved, left no address
 No such office in state
 Do not re-mail in this envelope
 POSTAGE DUE 2 CENTS

Fairgrounds brought up to date
 ARIZONA

report form with as complete detail
 ps, assay returns, shipment returns
 fore and which might interest a
 y.

Mrs. Venice Wilkes
 1608 E. Washington St.
 Phoenix, Arizona

Frank P. Knight

FRANK P. KNIGHT,
 Director.

Reason for non-delivery:
 Moved-left no address
 Unknown
 No such number
 Refused
 Unclaimed
 Deceased
 initials: R. R. 912

9561 PM
 JUL 17 1958

RECEIVED
 JUL 21 1958
 DEPT. MINERAL RESOURCES
 PHOENIX, ARIZONA

Mrs. Venice Wilkes
~~Willis~~
 Arizona

RETURNED TO
 REASON CHECKED
 Unclaimed
 Unknown
 Insufficient postage
 Moved, left no address
 No such office in state
 Do not re-mail in this envelope
 POSTAGE DUE 2 CENTS

Tracy Bagdall 11/58

ARIZONA DEPARTMENT OF MINERAL RESOURCES
MINERAL BUILDING, FAIRGROUNDS
PHOENIX, ARIZONA

July 16, 1958

To the Owner or Operator of the Arizona Mining Property named below:

Sally Ann (Mohave County)	gold, silver, copper, lead
(Property)	(ore)

We have an old listing of the above property which we would like to have brought up to date.

Please fill out the enclosed Mine Owner's Report form with as complete detail as possible and attach copies of reports, maps, assay returns, shipment returns or other data which you have not sent us before and which might interest a prospective buyer in looking at the property.

Frank P. Knight

FRANK P. KNIGHT,
Director.

Enc: Mine Owner's Report

SALLY ANNE MINE

MOHAVE COUNTY

An interview at Congress Junction with Mrs. McGuffie. Learned that work is continuing at the Sally Anne mine; and that the director of the work, James Tearney, has negotiated a lease with option to purchase agreement with Banner Mining Company for the Cleopatra mine (another of his holdings). It is said the Banner people are now conducting an examination of the property. TPL WR 8-27-60

Eight mining claims seven miles southwest of Alamo Crossing near Congress Junction, Arizona, have been purchased by James Tearney of Tucson from Mrs. Venice McGuffie. The claims contain gold, silver and copper, as well as silica which the new owner intends to mine. The ore will be shipped by truck to Wenden and then shipped by rail to the American Smelting & Refining Co. smelter at Hayden, Arizona. When in full operation, about 35 persons are expected to be employed. Mining World August 1960 p. 48

This property active Feb. 1961

RRB WR 5/8/81 - Clyde Moeller reports that he has the old McGuffie Mine (filed as the Sally Ann) now called Rose Mining, in Sec. 26, T11N, R14W, Yav. Co. He wanted to know if he should drill to see if there is massive bornite beneath old workings. His partner Fred Finnell gets good assays on samples that other assayers get poor assays on. He is convinced that ~~the~~ assays are unreliable and that Fred Finnell's "secret process" will make a big producer of the property. My comments on "secret processes" were not appreciated.

Post

SALLY ANN MINE

MOHAVE COUNTY

No information on this property. Mark Gemmill
May 27, 1957

Visited the St. Jude Mining Co. camp and their Sally Ann mine workings, also the Cleopatra workings, 5 miles east of the Camp. Both properties are under the same management and are active with a total of 6 men working. The Sally Ann property and the camp are leased from the owner Mrs. McGuffie, operator of the hotel at Congress Junction. The work consists of advancing a deep cut on a copper vein and sorting out a certain amount of copper ore for shipment. Mr. James F. Tearney, 2342 N. Ritchie Blvd., Tucson, is the principal in the St. Jude Mining Co. Also, he operates the Cleopatra (on a lease from the owner) as a personal venture. Work at the Cleopatra consists of cleaning up the pit with the expectation of resuming open cut mining of copper-gold ore. The Cleopatra is owned by W. Stewart Thompson, 2141 W 83rd St., Los Angeles, Calif. Interviewed Mrs. McGuffie at Congress Junction re her deal on the Sally Ann Mine. TPL WR 6-18-60

96

DEPARTMENT OF MINERAL RESOURCES
State of Arizona
MINE OWNER'S REPORT

T. MINERAL RESOURCES
RECEIVED
OCT 8 1946
PHOENIX
ARIZONA

Date Oct 7 - 1946

1. Mine: SALLY ANN
2. Location: Sec. unsurveyed Twp. _____ Range _____ Nearest Town Aguila
Distance _____ Direction _____ Road Condition _____
3. Mining District & County: Awens Dist. Mohave Co.
4. Former Name of Mine: Deham Property
5. Owner: Verice Wilkes
Address: at present Hillside, Ariz.
6. Operator: not in operation now.
Address: _____
7. Principal Minerals: Gold - Silver copper - lead Molybdenum
8. Number of Claims: nine Lode Lode Placer _____
Patented _____ Unpatented unpatented
9. Type of Surrounding Terrain: Rolling - elevation around 2000 ft.
10. Geology & Mineralization: Quartz - no faulting
dip of about 45°
11. Dimension & Value of Ore Body: 10 to 26 -

12. Ore "Blocked Out" or "In Sight":

Have no ore blocked out

Ore Probable:

Ore body according to engineer's report may be as wide at 40 ft. Runs one mile in length.

13. Mine Workings—Amount and Condition:

No.	Feet	Condition
Shafts	#1 - 40 ft	good
Raises	#6 + #5 -	about 25 ft each
Tunnels		
Crosscuts		
Stopes		

14. Water Supply:

Have 2 dams for water supply. One on the mill site - another 1000 ft above it. Have 700 ft of 2 in pipe line bringing water

15. Brief History:

from upper dam - which is 40 ft wide and 7 ft high.

History: Claims were first located by a man named Deham and upon his death were taken over by the Rogers Bros from whom I acquired them.

16. Signature:

Venice L. Wilkes.

17. If Property for Sale, List Approximate Price and Terms:

yes. Price \$5000⁰⁰

Terms to suit purchaser.

MISCELLANEOUS

Have a new - 3 room house on this property - Built partly of rock & partly of lumber. Has a 12 x 24 living room 11 x 12 kitchen 11 x 12 bed room - with clothes closet. Large fireplace in living room - Plenty of windows for good light.

Have a ~~small~~ shed for tools etc. Open air blacksmith shop.

This house alone cost me over \$1000.⁰⁰

All of my assay reports are out at the mine so it is impossible for me to fill in the map, as I do not remember the exact amounts.

Sally Ann Mine

MELVIN H. JONES
Mining Geologist

November 20, 1979.

MEMORANDUM FOR THE RECORD.

VISIT TO THE MCGUFFIE MINE LEACHING OPERATION FOR THE RECOVERY OF GOLD.

On 25 October, 1979, the undersigned, accompanied by August Gangola, Robert Olinger, and a Mr. Sams (of Las Vegas, Nev.) visited the McGuffie Mine in the Rawhide Mountains, near Almo Lake (Bill Williams river) in Mohave County, Arizona. To get there one goes Westerly thru the Hualapai Mountains out of Wickieup, Arizona to the South end of Sacramento Valley (near Yucca) and thence South to the Almo Dam area. It is about 75 miles on the road. The operation is located in Section 26, T-11-N, R-14-W and is SW of Artillery Peak. The old Big Kimball gold mine is about one mile to the Southwest of the McGuffie.

A lady by the name of Shirley Rose, who resides in a mobil trailer home in Wickieup (in back of the Mobile Service Station) owns and operates the leaching plant. She was unable to accompany us on the trip, but she has two men employes at the site, who are full time workers. A Mrs. McGuffie owns the mine.

GEOLOGY. The McGuffie Mine is in the Rawhide Mountains, which is immediately to the West of the Artillery Mountains. The latter contains one of the largest manganese deposits in the United States. The bulk of the formations are Pre-Cambrian metamorphosed sedimentary rocks, and also in the area are the Cobweb basalts, Sandtrap conglomerates, Chapin Wash formation, and the Artillery formation (USGS Bulletin 961). To the West are the Rawhide Mountains which are mostly Pre-Cambrian monzonites, which are allied with the Yavapai series of granitics. The Au values are in iron stained silicious formations which sporadically appear in seams and faults in the medium grained chloritized Monzonites. Also in the Rawhide vicinity are some Redwall limestones of Devonian age, on which the Rawhide Mine (Pb-Ag) is located.

Near the cyaniding plant are several old gold exploratory adits, and the material being processed came from the ore piles of the mentioned diggings (and from other nearby locations, I was told).

GENERAL. Below the site of the leaching plant, there are some additional exploratory pits of ancient age where copper in lode form can be observed. These are mostly carbonates and oxides, and this area was examined years ago by the writer, as a potential Cu producer. Then, I was accompanied by one of Mrs. McGuffie's former partners. Incidentally, Mrs. McGuffie, a very elderly lady, lives in a house near the leaching plant. I did not see her on this trip.

The leaching operation consists of two man made ponds, with bottoms covered with plastic sheeting. The larger pond had several hundred tons of Au containing rock piled thereon, and a spraying

system with many equi-spaced outlets is operated on a 24 hour a day basis. A smaller lower pond collects the pregnate solution, which is by pumping action, re-sprayed on the ore pile, on a continuous basis. The Au is collected from the pregnate solution by periodically processing the same in tanks containing activated carbon. Adjustable fixed controls are on the lines to keep the ph factor at the correct degree, and to add necessary sodium cyanide, as required. A small wood shack is nearby, as living quarters for the operating personell. The leaching plant equipment was purchased from the Esquipool brothers of Tombstone, Arizona, I was told.

One of the problems with this operation is that sufficient water is not available at the site. It has to be hauled by a water tank truck from Almo Lake, which is some miles away. The mentioned employees do all of the required tasks, including the hauling of the water, and keeping a close check on equipment controls.

Another problem at the plant is that wild life approach the cyanidation ponds and drink the water, which kills them almost instantly. Several dead rabbits and birds were seen.

This plant has been in operation for only a short time. Several five gallon containers containing gold concentrates, were shown the writer. I was told that Manager Rose is currently in the process of buying a furnace, for recovering the values out of the concentrates. No information was available as to the Au values in the concentrates (at least the employees did not have this information).

The writer does not claim to be an expert in the Metallurgy field, especially in chemically processing of gold, but my criticisms follow:

1. The cost of having to haul the water to the plant could be a cost factor, greatly reducing the potential profits.
2. The ore in the leaching piles had not been uniformly crushed. It will run from fines to large cobble sized particles. It is the opinion of the undersigned that it should all be crushed to pebble size (possible one inch).
3. Some copper stains were noted on the ore. The copper of course will have a bad deliterious effect on the use of cyanide.

It may be recalled that Manager Rose received some publicity some months ago in the "Western Prospector and Miner" as being connected with a Tombstone, Arizona gold leaching operation. She informed me the McGuffie plant and the contract to buy the ore, could be purchased for around \$100,000.00 .

MELVIN H JONES
Mining Geologist.

1601 Sandhill Rd #36,
Las Vegas, Nevada 89104.

DEPARTMENT OF MINERAL RESOURCES

STATE OF ARIZONA
FIELD ENGINEERS REPORT

Mine Sally Anne (Cu, Au)

Date August 10, 1960

District Owens, Mohave County

Engineer Travis P. Lane

Subject: Visit to property, June 15, 1960

Property: The Sally Anne group of 7 unpatented mining claims together with one mill-site claim is located some 5 miles westerly from Alamo. The claims are owned by Mrs. McGuffey, proprietor of the hotel and restaurant at Congress Junction.

Operator: St. Jude Mining Co. is operating the property under a lease-option contract from Mrs. McGuffey. The principal, and director of the work is James F. Tearney, 2342 N. Ritchie Blvd., Tucson. He and his two boys are living at Mrs. Guffey's camp near the mine. Two men are employed starting an adit in a cut showing copper oxide in a vein above the camp. Robert C. Burns, Box 257, Congress Junction, is the superintendent. As each round is broken the ore is sorted out for eventual shipment. The property had made no shipments to the time of this visit.

I have learned recently that one or two cars were shipped shortly after this visit. No data re copper-gold content are available, but it is said the grade was low.

Mr. Tearney is concurrently working the nearby Cleopatra property as a personal venture.

March 29, 1944

MEMORANDUM

TO: Elgin B. Holt

FROM: B. W. Brown

Mrs. Venice Wilkes was in the office today and informed us that she was making application to the O.D.T. for gas for her pick-up truck to remove ore from the Sally Ann or Betty Joy mines in Mohave County.

As this is in your district and would seem to indicate pending activity, I felt that you should be advised.

May 20, 1944

Mrs. Venice Wilkes
Sally Ann Mine
Aguila, Arizona

Dear Venice:

I am sorry I was unable to get to your property but on the 15th of May my resignation was accepted and I am now trying to get busy on private work which is keeping me quite busy.

It is very doubtful when I can make the proposed trip to the property. If I do get chance I will make it but right now I am so tied up that it is questionable if I can make it before you are through.

Yours very truly,

J. S. Coupai

JSC:LP

Sally Ann Mines
May 8 - 1944

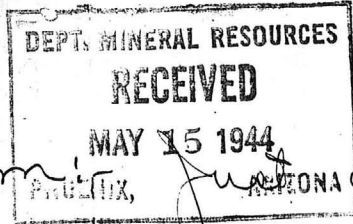

Dear Sam, Just a few lines to remind you that we would like to have you bring out your Altimeter and also your ultra-violet prospecting lamp. We are having a great time and are looking forward to your visit. Have decided to drive back & forth until we see how we progress. Excuse paper as my pen is doing a little cartooning.

Hoping to be seeing you soon
Love
Sally
Venice.

DEPARTMENT OF MINERAL RESOURCES
STATE OF ARIZONA
MINE OWNER'S REPORT

Date June 6 - 1940

1. Mine Sally Ann.
2. Location S. E. Corner, Mohave Co.
3. Mining District & County Owens, Mohave Co.
4. Former name Isham Property
5. Owner Venice Wilkes
6. Address (Owner) 1608 E. Washington St. Phoenix, Ariz
7. Operator " "
8. Address (Operator) " "
9. President, Owing Co.
- 9A. President, Operating Co.
10. Gen. Mgr.
11. Mine Supt.
12. Mill Supt.
13. Men Employed
14. Principal Minerals - Gold, Silver, Copper, Quicksilver.
15. Production Rate
16. Mill: Type & Cap. none
17. Power: Amt. & Type Hand Power
18. Operations: Present
not being operated at present.

19. Operations: Planned Extension on #5 tunnel - completion of road from #4 to #5 - completion of road from #6 to main road.

20. Number Claims, Title, etc. Seven claims numbering from no. 1 to no. 7.

21. Description: Topography & Geography at 2000 ft. above Williams River bed rough.

22. Mine Workings: Amt. & Condition little work has been done - has a shaft 35 ft deep - #2 has to one 38 ft. the other about 32 to 35 we never measured it. as several small ation holes on it -

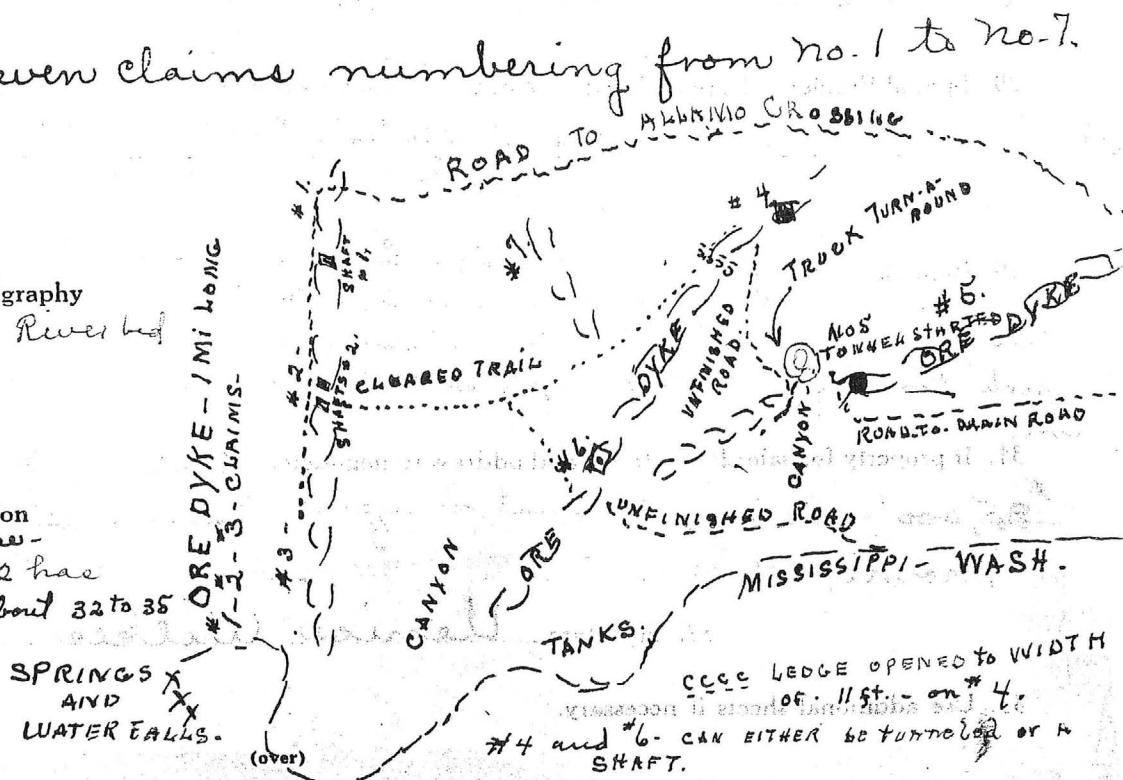

3. Geology & Mineralization

Fissure veins - Quartz full of big holes carry of hematite
copper ore contains sulphides.

Igneous

4. Ore: Positive & Probable, Ore Dumps, Tailings

4A. Dimensions and Value of Ore body Ore body of # 1 - 2 - 3 - varies in width from
10 to 20 ft. In # 1 shaft - 2 1/2 ft of Ore - # 2 shaft. 3 to 4 ft of Ore - # 4 opened to a width of
7 ft. # 6 opened to about 2 1/2 or 3 ft. # 5 had 8 in. to begin tunnel has
rowed in but expect it to open right out again. All values have been

5. Mine, Mill Equipment & Flow-Sheet

used by assay - general sample - quartered down. # 1 - dump - av. 6.60 - 7.00 gold -
contains copper. 1.05 gold - 6.19 silver - 5.95% copper - total 12.37
" 1% copper - .70 " - 1.15 " - # 5 - 7.20% silver - 70+ gold - 28.49 70
copper - total 48.49.

6. Road Conditions, Route

a road graded to within 3 1/2 mi of mine. good road to completed to # 1 -
and # 3 claims - Route - go N.W. from Aquila to the Adams crossing on the Williams
- Cass River - follow road to forks - trail is marked by Road signs - Either -
marked - Sally Ann mine - or Phipps -

7. Water Supply

mill site located on the Mississippi Springs which are located about
from the end of the # 3 claim. Flow freely all winter. Have plenty of water for
use in summer - if there is the usual amount of Rain fall. Can be easily
dammed to provide plenty of water storage.

8. Brief History

Rodgers and brothers owned part of the property - shipped some ore
on # 1. Found it too low a grade for shipping ore on such a long haul.

9. Special Problems, Reports Filed

Mr Finlayson, formerly with the "Vulture"
and the Property over and stated that it had the ear marks for
being a good deep mine, but that it was not a poor mans proposition

10. Remarks

A new hi-way has been surveyed within 3 mi of this property, a short
one from Phoenix to Boulder Dam - It is to be paved. Formation test work & tunneling
has been completed for the Bulls head Dam on the Williams River. This will
show plenty of water & cheap electricity. Also a bridge across the river, over the

11. If property for sale: Price, terms and address to negotiate.

This property is for sale - for
\$5,000 - Terms to suit buyer - Venice Wilkes - 1608 - E. Washington
Phoenix, Ariz.

32. Signature Venice Wilkes

33. Use additional sheets if necessary.

DEPARTMENT OF MINERAL RESOURCES
STATE OF ARIZONA
OWNERS MINE REPORT

Date June 6, 1940

1. Mine Sally Ann
2. Mining District & County Owens, Mohave Co.
3. Former name Isham Property
4. Location S. E. Corner, Mohave Co.
5. Owner Venice Wilkes
6. Address (Owner) 1608 E. Washington St.
Phoenix, Arizona
7. Operator " "
8. Address (Operator) " "
9. President
10. Gen. Mgr.
11. Mine Supt.
12. Mill Supt.
13. Principal Metals Gold, Silver, Copper,
Quicksilver.
14. Men Employed
15. Production Rate
16. Mill: Type & Cap. None
17. Power: Amt. & Type Hand Power
18. Operations: Present Not being operated at present.
19. Operations Planned Extension on #5 tunnel. Completion of road from #4 to #5.
Completion of road from #6 to main road.
20. Number Claims, Title, etc. Seven claims numbering from No. 1 to No. 7.
21. Description: Topography & Geography About 2000 ft. above Williams River bed.
Quite rough.
22. Mine Workings: Amt. & Condition Very little work has been done. #1 has a shaft 35 ft.
deep. #2 has 2 shafts one 38 ft. the other about 32 to 35 ft. I have never
measured it. #3 has several small exploration holes on it. This dike has been
opened up in 10 to 12 places just to a depth of from 5 to 10 ft. #6 and #4 have
no work done except location work. #5 has a 20 ft. tunnel. #7 just location work.
Shafts are almost vertical. #4 opened up ledge on surface 13 ft. in width. #6
2 to 3 ft. of ore.

(over)

23. Geology & Mineralization Fissure veins. Quartz full of big holes carrying Hematite. Copper ore contains sulphides. Igneous.

24. Ore: Positive & Probable, Ore Dumps, Tailings

24-A Vein Width, Length, Value, etc. Ore body of #1, #2, #3 varies in width from 18 inches to 6 ft. In #1 shaft, 2½ ft. of ore. #2 shaft, 3 to 4 ft. of ore. #4 opened to a width of 13 ft. #6 opened to about 2½ or 3 ft. #5 had 8 in. to begin tunnel has narrowed in but expect it to open right out again. All values have been procured by assay, general sample, quartered down. #1 dump ave. \$6.60 to \$7 gold. #2 contains copper \$1.05 gold, 61¢ silver, 5.95% copper, Total \$12.37 #4 contains 1% copper \$0.70 gold, \$1.15 silver, #5, 7.2 oz. silver, 70¢ gold, 28.49% copper, Total \$48.49.

26. Road Conditions, Route Main road graded to within 3½ miles of mine. Good road completed to #1, #2, and #3 claims. Route, go N. W. from Aguila to the Alamo crossing on the Williams River, cross river, follow road to forks, trail is marked by road signs. Either marked Sally Ann Mine or Phipps

27. Water Supply Have mill site located on the Mississippi Springs which are located about 550 ft. from the end of #3 claim. Flow freely all winter. Have plenty of water for camp use in summer if there is the usual amount of rain fall. Can be easily dammed to provide plenty of water storage.

28. Brief History Tom Rodgers and brothers owned part of the property, shipped some ore from #1. Found it too low a grade for shipping ore on such a long haul.

29. Special Problems, Reports Filed Mr. Finlayson, formerly with the "Vulture" looked the property over and stated that it had the ear marks for making a good deep mine, but that it was not a poor man's proposition.

30. Remarks A new highway has been surveyed within 3 miles of this property. A short cut from Phoenix to Boulder Dam. It is to be paved. Formation test work and tunneling has been completed for the Bulls Head Dam on the Williams River. This will furnish plenty of water and cheap electricity. Also a bridge across the river over the dam.

31. If property for sale: Price, terms and address to negotiate. This property is for sale for \$25,000. Terms to suit buyer. Venice Wilkes 1608 E. Washington St., Phoenix, Arizona.

32. Signed..... Venice Wilkes.....

33. Use additional sheets if necessary.

M. S. 1-

DEPARTMENT OF MINERAL RESOURCES
STATE OF ARIZONA
OWNERS MINE REPORT

Mine Sally Ann
District Owens (Mohave) Yuma
Former name Isham Property
Owner Venice Wilkes
Operator "
President
Mine Supt.
Principal Metals gold, silver, copper
Production Rate
Power: Amt. & Type
Operations: Present

Date July 19 - 1939
Location 9 mi S.W. Allamo
Crossing on Williams River
Address mesa, Ariz R. #1 Elds Jct
Address " " " "
Gen. Mgr.
Mill Supt.
Men Employed
Mill: Type & Cap.

Operations Planned development on #3 - #4 - #5 beginning
Sept 1st - 1939.

Number Claims, Title, etc. 5 - Sally Ann - #1 - #2 - #3 - #4 - #5

Description: Topog. & Geog.

Mine Workings: Amt. & Condition Formation blocky. #1 - has a 45ft chaf
#2 - 2 Shafts - 1 about 60 one about 75ft.

Geology & Mineralization

Ore: Positive & Probable, Ore Dumps, Tailings

Mine, Mill Equipment & Flow Sheet

Road Conditions, Route good for desert road. go to Aguila Ariz. then N.W to Allams Crossing - cross the River. follow trail to Rodgers mine to where the road branches take left hand road.

Water Supply none on Property. Water in Mississippi Springs in winter. 1 1/2 mi otherwise get water from Williams River

Brief History Property originally located by Isham + his son. thence to the Rodgers Bros. and then to the present owner.

Special Problems, Reports Filed

Remarks

If property for sale: Price, terms and address to negotiate.

for Lease or for Sale - My property is either Price \$15,000.00

Signed Venice Wilkes

Use additional sheets if necessary.

Rt 1 76 Ebo Tuth - near by

DEPARTMENT OF MINERAL RESOURCES
STATE OF ARIZONA

FIELD ENGINEERS REPORT

MS 1

Mine Sally Ann (7 claims).

Date Dec. 13, 1939.

District Owens Dist., Mohave Co.

Engineer Elgin B. Holt.

Subject:

SYNOPSIS REPORT

OWNER: Mrs. Venice Wilkes, ~~Aguila, Arizona.~~ *Bldg. 2280, Unit R, 3rd St. Domitovis, San Bernardino, Calif.*

LOCATION: Property located in Owens Mining District, Mohave Co., Arizona, 8 miles westerly from Alamo Crossing. It is reached by a county road from Aguila, 30 miles distant from property.

GEOLOGY: The country rock consists of granite-gneiss-schist complex of pre-Cambrian origin.

VEINS: A number of prominent quartz, copper stained, veins traverse property. These range from 9 inches to 6 feet in width. Strike of main vein NW - SE; dip nearly vertical.

PRINCIPAL METALS: Gold and copper.

DEVELOPMENT WORK: Consists of three shafts - 35, 50 and 60 feet deep. Also one tunnel on vein 20 feet in length.

MEN EMPLOYED: One man only is now employed, taking out shipping ore assaying about \$50.00 per ton in gold, silver and copper.

WATER: Water for domestic use is obtained from near-by well. Water for milling plant would have to be pumped from Williams River 3 miles from property. Elevation above sea level about 2,000 feet.

CHARACTER OF ORE: There are two types of ore which occur in the various veins of property, as follows: (1) Copper stained quartz, assaying 3% copper and from \$10.00 to \$50.00 per ton in gold and silver; (2) Free milling gold quartz with variable values ranging up to \$30.00 or \$40.00 per ton. Also, high grade copper glance (chalcocite) has recently been encountered in one of the shafts referred to.

OPINION: The property is worthy of deeper development, which may result in uncovering ore shoots that would justify the installation of say a 50-ton mill at a later time. As a matter of fact, the same type of copper-gold veins, as above described, are found at numerous points within a radius of 10 miles of this property and from several of these ore is now being mined and shipped to smelters for treatment. Due to the isolation of this area and bad roads, only the higher grades of ores can be moved at a profit. This entire district warrants a careful investigation by a strong company with a view to opening up a number of meritorious mines, which would supply ore for a plant having a capacity of 100 tons per day.

- Mountain Rose Mining -

Formally known as:

SALLY ANN

CONTACT 3-5-79

ALFRED HARRELL

SPRINGERVILLE ARIZ.

TELE 333-4844

BOX 794

ETAGER ARIZONA

OR

CONTACT AT

STATE MAINE MINE

TOM BSTONE

SHIRLEY ROSE

457-3601

To whom it may concern - -

I would like to point out here some of our ideas to the investor.

First of all we do not wish you to invest any more capital than is necessary to get the mining venture in operation.

At the time of signing an agreement with you we will need \$5,000.00 of the additional expense money. This money will be used for traveling expenses in order to obtain the most reasonable deal we can on the other equipment involved, also to buy fencing material and begin the fencing of the pad & pond as these things are a first priority.

The enclosed estimates of cost are merely rough estimates. For example I have listed \$25,000.00 for a cat on one report, we have since discovered a used cat with dozer + ripper in very good shape, that we can purchase out right for \$12,000.00. In other words with some shopping around we can come up with a good economical deal for the investor. Purchase of the equipment, etc, could be handled with a dual checking account. We want the investor to know where every dollar of his money is going. We intend on making it with the mining operation, not with our backs money.

Shirley Rose

SUBMITTE TO DMR. 3-5-79

MOUNTAIN ROSE MINING

SHIRLEY ROSE

BOX 866

= TOMBSTONE, ARIZONA 85638

-MINE-

Formally known as "Sally Ann group", also "McGuffie Mine prop." *Cardamom*
Now known as Mountain Rose mining property. *4/25/72*

-LOC ATION-

Rawhide mountains, south east Mohave county, state of Arizona, Owens mining district. Section 35, Township II north, range 14 west.

Nearest towns, Wikiup, 59 miles. Kingman, 129 miles. Kingman is the nearest shipping point.

Road from Wikiup is good county maintained road. A light plane landing strip is 24 miles from property.

-PRINCIPAL MINERALS-

Copper, gold, silver, and uranium. Spectrographic [?] analysis show many other minerals present.

-OWNER-

✓ Venice McGuffie, Box 511, Yarnell, Arizona. Now leased by Shirley Rose with option to purchase.

-MINING PROPERTY-

Property consists of 20 original claims, 10 regular and 10 extensions. All on federal land and all unpatented. I am now in the process of staking many more claims in the area as the ground around the property is open and prospecting in the area has disclosed other ore zones.

-MILL SITE AND WATER RIGHT-

Location of Mill site and Water rights filed February 7, 1940 in book 4 of Mill sites and Water rights book 4, page 84 in Kingman, Arizona.

-WATER SUPPLY-

The water right covers the Mississippi Springs where there is a 40 ft. rock and concrete dam. A 750 ft. 2 inch pipe line brought the water to the house. Vandals have taken part of the pipe line. There is also another small dam about 1500 ft. below the house where there is continuous seepage. A good water supply could be developed in several places without great expense.

-HOUSING FACILITIES-

There is a nice 4 room house, equipped for year around living. It has 2 bedrooms, living room, and large kitchen. Has large fire place. Plenty of good wood is available. A large sleeping porch provides comfort on hot nights. House is wired for electricity. Also large butane tank for stove and refrigerator.

Large storage shed (galvanized siding and concrete floors). Could be converted to bunk house.

-ACCESSIBILITY TO CLAIMS-

The workings on all claims can be reached by good mine roads. A short trail leads to one exploration tunnel.

-WORKINGS-

Workings consist of 3 tunnels, 3 shafts and one trench.

-VEINS-

There are 4 parallel veins where the one has protruded onto the surface, each about a mile in length. Ore also has protruded on the sides of the mountains. It has been declared ideal for open pitting and the ore lends itself to leaching.

New prospecting in the area has disclosed many more rich veins in the area.

-GEOLOGIST ED RUNDELLS REPORT-

Extracts below are taken from last mine report made by geologist Ed Rundel, now deceased.

TYPE OF SURROUNDING TERRAIN: Mountainous in part; rolling hills; semi-flat and flat ridges(Cu outcrops) accessible in part by roads. Roads could be made over most of the area with a minimum amount of dozing. There are a number of places where a drill rig can set up without preperation. All in all, it is more accessible for drilling than many other mining areas.

GEOLOGY AND MINERALIZATION: The district is in the "BASIN AND RANGE PROVINCE", where intense faulting and folding has occurred. The major folds in Arizona have developed in four general directions---ne-sw.,nw-se., n-s., and e-w. all of these trends are not considered to be of the the first order of importance for each era, but in Arizona, the dominant direction of folds are ne-sw., for the older Pre-Cambrian, but nw-se., and n-s., for the Laramide which began in the late Cretaceous and extended into the Cenozoic era. The shear fractures and faults may form in as many as eight or more directions. However, pronounced variations from these directions may occur in areas where the folds are of the plunging type, or if tilting has occurred subsequent to the folding, fracturing, and faulting. Consequently, trends may appear to be haphazard if the geometric implications are ignored.

LARAMIDE features have not been distinguished separately from those of the LATER CENOZOIC. It is a recognized fact that AGE assignments, based other than upon Fossil evidence or geochemicals assignments, are not very satisfactory. LARAMIDE has no definitive time limits, and its convenient usage to designate an interval of time is not accepted officually by the U.S. geological survey. Many geologists tend to assign its features entirely to the TERTIARY, and have designated granite rocks as such for several areas; likewise for schist, gneiss, volcanic, and sedimentary rocks. Activity is marked by intrusive bodies of igneous rock, dikes, plugs, and volcanic rocks. It appears to blend with the crustal unrest and igneous activity of middle to LATE CENOZOIC era. POST LARAMIDE erosion exposed ore bodies but later sedimentation, volcanism, and faulting concealed many of them. A tabulation of several mines or districts indicated that the lower level of Post Laramide general oxidation coincided with present water levels in only 20% of the cases; it was either above or below in 80% of them.

Mineralization appears to be associated with intrusive igneous rocks composed of orthoclase and plagioclase feldspar, with some biotite. The intrusives have a granular texture; the intermediate types being syenite, diorite and gabbro@dolerite)---- their felsitic equivalents are andesite and basalt. Rhyolite flows occur in washes and a few other places. Gneiss occurs in areas of great pressure and heat. Mica and Hornblende schists are the metamorphic rocks; sedimentary and from a basic igneous rock, such as gabbro. Minor intrusions are Dikes, Sills, and Plugs.

BRIEF DESCRIPTION OF DEPOSIT: Replacements in Limestone are of special interest because of their abundance and relatively high grade ore. Copper ore outcrops at the grass-roots in many places on the ridges, sides and slopes, while in other places there are numerous indications of ore being near the surface. The small crusts of Limestone on some of the rocks appears to have occurred from solution and fusion since a solution often times dissolves one mineral and at the same time replaces the limestone with which the solution is in contact.

There are indications where interlacing veins have woven together instead of emanating from a central vein---which would have to be a whopper. Depth of over burden over the entire area has not been determined at this date. However, there is a large area where it is light.

MALACHITE, AZURITE, CHALOCITE, and small amounts of BORNITE(although primary) occurs in areas of enrichment.

-MOUNTAIN ROSE MINE - EVALUATION- SHIRLEY ROSE-

This property, which I have a years lease and option to purchase on, is owned by Venice McGuffie Yarnell, Arizona.

It consists of 20 unpatented mining claims, a mill site, a 2 bedroom house, also a water right which is legally filed in Kingman, Arizona.

A good gravel county maintained road leads to properties. Good roads then cover the property.

Two dams on Mississippi Canyon, which runs through property, provide water from Mississippi Springs. These dams are also part of property.

The huge Alamo lake lies 8 miles from property.

Electric lines are in the area but do not run to property.

I project this property as an open pit. The veins and dikes run along the top of the low ridges. Very little over-burden on any thing. Most places there is none. Low rolling hills thru out area make accessibility excellent.

Country rock in area consists of entirely of a fractured white quartzite containing a high percentage of silica and some limestone.

Valuable ores in area are Copper, Silver, gold, and I expect more extensive testing and prospecting in area to turn up many more valuable minerals. Ground around area is all open for staking and I am presently staking more claims in area on newly discovered ore veins.

One drill hole (the only drilling that was ever done in area) showed good copper sulfides at 65 ft.

This property has never been mined. Some test tunnels and shafts and one d drill hole don't begin to bring out the potential of this excellent prop.

VALLEY ASSAY OFFICE
AND ORE TESTING LABORATORY
MEMORANDUM OF ASSAY.

Made for Ed. Rundle

Tempe, Arizona..... May 31, 1972.

SAMPLE NO.	PER TON OF 2000 POUNDS AVOIRDUPOIS								COPPER, OR		LEAD, OR		ZINC, OR		TOTAL	
	GOLD, PLATINUM				SILVER				%	cts.	%	cts.	%	cts.	%	cts.
	AT	PER OUNCE			AT	PER OUNCE										
	OZs.	100's	¢	cts.	OZS.	100's	¢	cts.	%	¢	cts.	%	¢	cts.	%	cts.
1	0.	06			1.	80			6.	3						
2	0.	04			1.	10			6.	8						
3	1.	22			1.	40			6.	2						
REMARKS:																



NO.

BY.....
Registered Assayer.

CHARGE @ 24.00 Pd.

Form DRW-2060 (Rev. 11-74)
(47-0154.00)

PHELPS DODGE CORPORATION
DOUGLAS REDUCTION WORKS

*Sample Taken From
ore in barrel Test
after it had leached
for 4 days.*

ASSAY AND ANALYSIS CERTIFICATE

DOUGLAS, ARIZONA February 15, 1979, 19

NAME Hand Sample, Gilbert: Bone

Smelter Lot	Shipper's Lot	Copper %	OZS. PER TON		SiO ₂ %	Al ₂ O ₃ %	Fe %	CaO %	MgO %	Mn %	Zn %	P ₂ %	S %	Cl %		
			SILVER	GOLD											%	%
1658			0.15	3.031	83.9	6.5										

Chief Chemist

C. CHARLES O. PARKER & CO.

CHEMISTS • ASSAYERS • ENGINEERS

TELEPHONE 623-1852
2114 CURTIS STREET
DENVER, COLORADO 80205

____ QUALITATIVE
XXX SEMI-QUANTITATIVE
____ QUANTITATIVE

ANALYTICAL REPORT

Folio 70
Date April 8, 1972

TO: Reed Engr. Co
P. O. Box 121, 1242 Evergreen Road
Wrightwood, Calif. 92397

(mistake made in shipping address)

SAMPLE: Submitted by Ed Rundle

Copper 2.30%	Iron 3.50%	Lanthanum _____
Silver 11.16 oz/ton (Fire Assay)	Cobalt _____	Cerium _____
Gold 0.05 oz/ton (Fire Assay)	Nickel 0.009%	Praseodymium _____
Zinc 0.23%	Cesium _____	Neodymium _____
Cadmium _____	Rubidium 0.011%	Samarium _____
Mercury _____	Barium 0.30%	Europium _____
Gallium _____	Strontium 0.027%	Gadolinium _____
Indium _____	Titanium 0.066%	Terbium _____
Thallium _____	Zirconium 0.004%	Dysprosium _____
Germanium _____	Hafnium _____	Holmium _____
Tin _____	Thorium _____	Erbium _____
Lead 0.18%	Vanadium _____	Thulium _____
Arsenic _____	Columbium _____	Ytterbium _____
Antimony _____	Tantalum _____	Lutetium _____
Bismuth 0.023%	Chromium 0.006%	Yttrium _____
Selenium _____	Molybdenum _____	_____
Tellurium _____	Tungsten _____	_____
Bromine _____	Uranium 0.0026%	_____
Iodine _____	Manganese 0.040%	_____

LABORATORY REPORT

Mariposa Spectrographic Laboratory

CHARGES: \$7.00 (includes Au-Ag assay)

LAB NO. 31 01

Qualitative Spectrographic Analysis

Date 4/9/72

ANALYST BY:

ELEMENTS FOUND AND ESTIMATED PERCENTAGE RANGE OF CONCENTRATION

SAMPLE MARK

#3

ELEMENT	Not Less Than %	Not More Than %	ELEMENT	Not Less Than %	Not More Than %	ELEMENT	Not Less Than %	Not More Than %
Aluminum	.003	0.04	Lithium			Thallium		
Antimony			Magnesium	.003	.009	Thorium		
Arsenic			Manganese	.001	.006	Tin	---	.001
Bismuth	.0004	.0007	Mercury			Titanium	.0007	.001
Calcium			Molybdenum	.0007	.003	Tungsten		
Carbon	.003	.009	Nickel	.0004	.0009	Uranium		
Chromium			Osmium			Vanadium	.0004	.0009
Copper	.0008	.004	Palladium			Zinc		
Fluorine			Phosphorus			Zirconium		
Gold			Platinum	not detected in sample		RARE EARTHS:		
Iron	.0007	.003	Potassium			Cerium		
Lead			Rhenium			Dysprosium		
Mercury			Rhodium			Erbium		
Nickel	2.0	4.0	Rubidium			Europium		
Platinum			Ruthenium			Gadolinium		
Silver			Scandium			Holmium		
Sulfur	---	.0015	Silicon (as SiO2)	20.0	22.0	Lanthanum		
Tantalum			Silver	.0002	.0007	Neodymium		
Tellurium		Trace	Sodium			Praseodymium		
			Strontium			Samarium		
	1.0	3.0	Tantalum			Ytterbium		
	0.10	0.25	Tellurium			Yttrium		

See letter.

Respectfully Submitted

MARIPOSA SPECTROGRAPHIC LABORATORY (Spectrographer)

VALLEY ASSAY OFFICE AND ORE TESTING LABORATORY

MEMORANDUM OF ASSAY

Our former geologist
Made for
J. O. FURBLE

SAMPLE NO.	PER TON OF 2000 POUNDS AVOIRDUPOIS				COPPER OR		LEAD, OR		ZINC, OR		TOTAL	
	GOLD, PLATINUM		SILVER		PER LB.	AT	PER LB.	AT	PER LB.	AT		
	100%	100%	100%	100%	CG.	AT	CG.	AT	CG.	AT	CG.	AT
1	46.70		3.80		5.8							
REMARKS:												

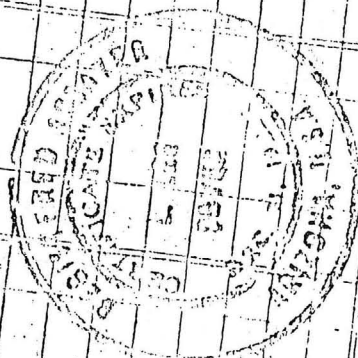

CHARGE \$ 3.00 Ea. The accuracy of the above determination was confirmed by a re-run, dated April 21, 1972, and signed by the Assayer. A Troy Ounce has 480 grains. Above Gold assay equals 42.55 ounces Troy weight.

BY _____
Registered Assayer.

-CYANIDE LEACHING-

For property potential for cyanide leaching I ran the following cyanide leaching barrel tests. Percentages of gold and silver were obtained by Atomic Absorption.

Date----2/8/1979

M#1---Very coarse ore from small stock pile on top of ground on ridge #4.

<u>Hours ran</u>	<u>AG.</u>	<u>AU.</u>	<u>Value per ton</u>	<u>Values per day 65 ton plant</u>	<u>Values per day 300 ton plant</u>
24	.025	.005	\$1.31	\$87.10	\$402.00
48	.04	.011	\$2.84	\$184.60	\$852.00
72	.04	.02	\$4.91	\$319.15	\$1,473.00
100	.08	.023	\$5.91	\$384.15	\$1,773.00

M#2---Finer ground ore from shallow shaft waste on ridge #4.

24	.03	.154	\$35.65	\$2,317.25	\$10,695.00
48	.045	.258	\$59.69	\$3,879.85	\$17,907.00
72	.06	.255	\$59.11	\$3842.15	\$17,733.00
100	.095	.295	\$68.58	\$4,457.70	\$20,574.00

NOTE---- Several of these samples would run as good as the above one if they were crushed to a 20 fine.

M#3---Sample came from small pile of rock from shallow shaft ridge#3.

24	.06	.030	\$7.36	\$478.40	\$2,208.00
48	.075	.036	\$8.86	\$575.90	\$2,658.00
72	.085	.030	\$7.55	\$448.50	\$2,265.00
100	.11	.037	\$9.35	\$607.75	\$2,805.00

M#4---Shallow hole on top of ridge #3.

24	.025	.009	\$2.26	\$146.90	\$678.00
48	.025	.01	\$2.49	\$161.85	\$748.00
72	.025	.013	\$3.18	\$206.70	\$954.00
100	.055	.017	\$4.33	\$281.45	\$1,299.00

M#5---Finer ground ore from little deeper in ground, top of ridge #2.

24	.035	.049	\$11.54	\$750.10	\$3,462.00
48	.05	.07	\$16.48	\$1,071.20	\$4,944.00
72	.05	.078	\$18.32	\$1,190.80	\$5,496.00
100	.08	.09	\$21.32	\$1,385.80	\$6,396.00

M#6---Shallow hole top of ground ridge #2.

24	.03	tr.	\$.23	\$14.35	\$69.00
48	.035	.003	\$.96	\$62.40	\$288.00
72	.025	.01	\$2.49	\$161.85	\$747.00
100	.02	.013	\$3.14	\$204.10	\$942.00

M#7---Small dump from shallow shaft ridge #3.

24	.25	.026	\$7.90	\$513.50	\$2,370.00
48	.34	.036	\$10.90	\$708.50	\$3,270.00

MT#1---Taken along tunnel wall #1.

20	.15	.003	\$1.81	\$117.65	\$543.00
40	.09	tr.	\$.69	\$44.85	\$207.00
66	.11	.005	\$1.17	\$76.05	\$351.00

MT#2---Taken across face of deposit at tunnel #2.

20	.66	.026	\$11.06	\$718.90	\$3,318.00
----	-----	------	---------	----------	------------

MT#2---cont.

40	.87	.011	\$9.23	\$589.95	\$2,769.00
66	1.10	.011	\$11.00	\$715.00	\$3,300.00

PHELPS DODGE ASSAY SAMPLE (from ore that had leached for 4 days in barrel test.

.18	.031	\$8.13	\$528.45	\$2,439.00
-----	------	--------	----------	------------

MCGUFFIE (SALLY ANNE) MINE

-ESTIMATION ON TONNAGE AND VALUES-

Estimate only on four ridges lying in a N.W. to S.E. direction. And only on principle ore body..

Total estimated ore tonnage-----323,000 tons.

Overall valuation per ton of ore as of 2/21/79-----\$12.16

Value of ridge ore estimated at-----\$3,927,680.00

Each ridge is comprised of an ore vein approx. 10 ft. wide by 5200 ft. long. Drilling has shown the oxidation zone ending at 65 ft. in depth. Further depth is estimated as copper sulfate ore.

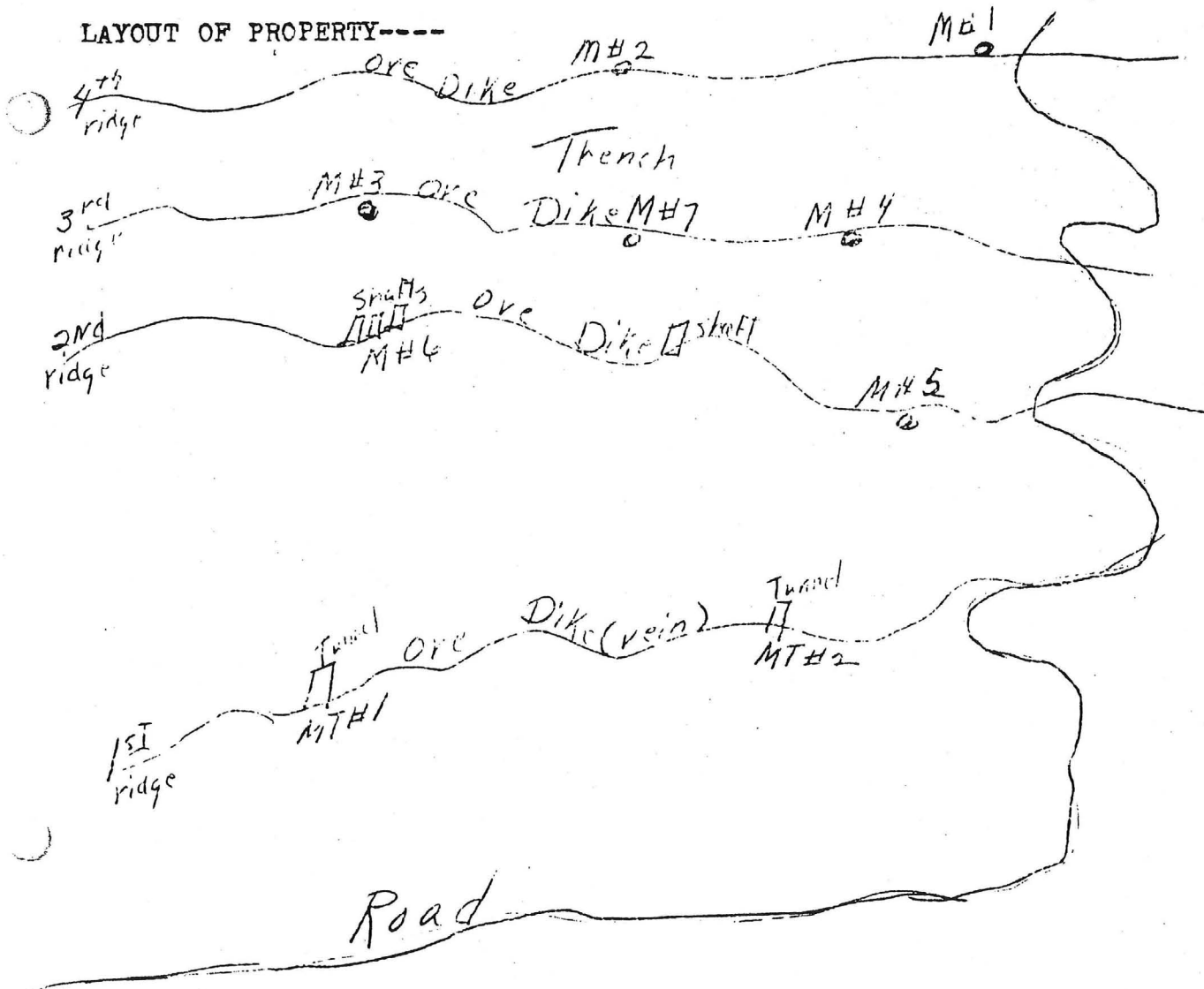

-PRINCIPALS INVESTMENTS-

EXCELLENT PROPERTY- (Thougherly tested.)

EXPERIENCED IN SETTING UP AND OPERATING LEACHING PLANT SYSTEM.

65 ton leaching plant, chemicals and pipes-----	\$5,111.00
Backhoe-----	\$3000.00
Tools-----	\$ 500.00
Trailer set up for lab.-----	\$ 600.00
Company Pick-up-----	\$1100.00
Cinder blocks, etc. for 2 bldgs.-----	\$2500.00
Lab and Barrel test equipment-----	\$ 200.00
Furnace-----	\$ 200.00

	TOTAL-----
	\$13,211.00

-PROPOSED INVESTMENTS AND RETURNS ON THIS PROPERTY-

INITIAL INVESTMENT-----\$24,748.00

RETURNS RECEIVED FOR TRIPLE THE INVESTMENT-----\$74,244.00

TERMS-----20% until initial investment is paid, 10% thereafter until triple the investment has been paid.

PROPOSED PROJECT-----

One 65 ton plant operated 12 hours a day, 5 days a week. Eventual purchase of 300 ton plant and larger operation.

BALANCE ON PLANT-----\$1400.00

USED D6 CAT-----\$4000.00

DUMP TRUCK-----\$3000.00

2 ELECTRIC GENERATORS-----\$1068.00

PLASTIC-----\$1280.00

PAY OFF PREVIOUS INVESTOR-----\$8000.00

ADDITIONAL EXPENSE-----\$5000.00

INITIAL INVESTMENT-----\$17,348.00

RETURNS RECEIVED FOR TRIPLE THE INVESTMENT-----\$52,044.00

TERMS----20% until initial investment is paid off, 10% thereafter until triple the investment has been paid.

PROPOSED PROJECT----

One 65 ton plant operated 12 hours a day, 5 days a week.

DRILL WELL, PUMP AND PIPE-----\$4000.00

D-6 CAT-----\$6000.00

2 GENERATORS-----

PLASTIC-----\$1,280.00

\$1068.00

ADDITIONAL EXPENSE-----\$5000.00

INITIAL INVESTMENT-----\$62,700.00

RETURNS RECEIVED FOR TRIPLE THE INVESTMENT-----\$188,100.00

TERMS-----20% until initial investment has been paid, 10% thereafter
until triple the investment has been paid.

PROPOSED PROJECT-----

300 ton plant operated 24 hours a day, 5 days a week.

3000TON PLANT-----\$21,000.00

D-6 CAT(used)-----\$ 6,000.00

DUMP TRUCK (used)-----\$ 3000.00

ONE HIRED MAN(\$5.00 per hr. 4 mo.--\$ 2800.00

LUMBER FOR THREE SHEDS-----\$ 2000.00

GAS AND DIESEL EXP.-----\$ 1400.00

CHEMICAL EXP.-----\$ 1000.00

4 GAS GENERATORS-----\$ 2497.00

DRILLING WELL, WATER PIPE AND PUMP-\$ 1000.00

PAY OFF PREVIOUS INVESTOR-----\$ 8000.00

ADDITIONAL EXPENSE-----\$ 7000.00

INITIAL INVESTMENT-----\$178,927.71

RETURNS RECEIVED FOR TRIPLE THE INVESTMENT-----\$536,781.00

TERMS-----20% until initial investment is paid, 10% thereafter until triple the investment has been paid.

PROPOSED PROJECT-----

One 300 ton plant running 24 hours a day. Pad and pond set up so 2 more 300 ton plants can be added, at no additional manpower,. Prospecting and testing in area for new ore deposits. Staking of new claims. Setting up and operating crusher to run previously leached ore and crush new.

D-8 CAT WITH RIPPERS-----\$25,000.00

300 TON PLANT-----\$21,000.00

2 DIESEL GENERATOR PLANTS-----\$13,000.00

HIRED MAN, \$5.00 per hr. 6 mo.-----\$ 5200.00

U.S. DUES-----\$ 1,485.00

3 MFN AT \$3.50 per hr. 6 mo.-----\$10,920.00

U.S. DUES-----\$ 3,822.00

LAB EQUIP.(\$10,000 A.A MACH., CHEMICALS)-----\$13,500.00

3 15X20 BLDGS.-----\$11,250.00

FRONT END LOADER (used)-----\$15,000.00

DIESEL 14 rd, DUMP TRUCK(used)-----\$ 5500.00

WELL DRILLING, PIPE, PUMP,ETC.-----\$ 6500.00

PLASTIC(250X350)-----\$14,000.00

TRAILER HOOK UPS-----\$ 2500.00

ACCOUNTING SERVICE-----\$ 3,000.00

PAY OFF PREVIOUS INVESTER-----\$ 8000.00

COMPANY TRANSPORTATION-----\$ 4500.00

ADDITIONAL EXPENSES -----\$ 15,000.00

-SUMMARY-

Our primary intent is to develop a working, profitable, mining venture. Profitable to both the principals and the investors. Our goal is to make and develop the properties and our business into a long term project. We do not intend to get "rich over night" but to use the money on the accomplishment of a profitable business.

All invested monies will be deposited in a account with the investor recieving the reciepts and the company having the canceled checks.

We do not wish for an investor to feel like we are out to get his money as many in the field are, but we do feel that both the investor and the operators shall maintain a proper and manageable distance. At any time the investor shall have access to the records, but the operators shall have total control of the plant, its operation, and anything to do with setting up and operation.

Any proposals are negotiable and are not meant to be binding. They are only proposals, contracts will be drawn and negotiated.

Pay off on investment in cash
or Gold & Silver.

To whom it may concern - -

I would like to point out here some of our ideas to the investor.

First of all we do not wish you to invest any more capital than is necessary to get the mining venture in operation.

At the time of signing an agreement with you we will need \$5,000.00 of the additional expense money. This money will be used for traveling expenses in order to obtain the most reasonable deal we can on the other equipment involved, also to buy fencing materials and begin the fencing of the pad & pond as these things are a first priority.

The enclosed estimates of cost are merely rough estimates. For example I have listed \$25,000.00 for a cat on one report, we have since discovered a used cat with dozer & ripper in very good shape, that we can purchase out right for \$12,000.00. In other words with some shopping around we can come up with a good economical deal for the investor. Purchase of the equipment, etc, could be handled with a dual checking account. We want the investor to know where every dollar of his money is going. We intend on making it with the mining operation, not with our backs' money.

Shirley Rose

MOUNTAIN ROSE MINING

SHIRLEY ROSE

BOX 866

= TOMBSTONE, ARIZONA 85638

-MINE-

Formally known as "Sally Ann group", also "McGuffie Mine prop." *Cardaguer*
Now known as Mountain Rose mining property. *4/25/72*

-LOCATION-

Rawhide mountains, south east Mohave county, state of Arizona, Owens
mining district. Section 35, Township II north, range 14 west.

Nearest towns, Wikiup, 59 miles. Kingman, 129 miles. Kingman is the
nearest shipping point.

Road from Wikiup is good county maintained road. A light plane
landing strip is 24 miles from property.

-PRINCIPAL MINERALS-

Copper, gold, silver, and uranium. Spectrographic analysis [?] show many
other minerals present.

-OWNER-

✓ Venice McGuffie, Box 511, Yarnell, Arizona. Now leased by Shirley
Rose with option to purchase.

-MINING PROPERTY-

Property consists of 20 original claims, 10 regular and 10 extensions. All on federal land and all unpatented. I am now in the process of staking many more claims in the area as the ground around the property is open and prospecting in the area has disclosed other ore zones.

-MILL SITE AND WATER RIGHT-

Location of Mill site and Water rights filed February 7, 1940 in book 4 of Mill sites and Water rights book 4, page 84 in Kingman, Arizona.

-WATER SUPPLY-

The water right covers the Mississippi Springs where there is a 40 ft. rock and concrete dam. A 750 ft. 2 inch pipe line brought the water to the house. Vandals have taken part of the pipe line. There is also another small dam about 1500 ft. below the house where there is continuous seepage. A good water supply could be developed in several places without great expense.

-HOUSING FACILITIES-

There is a nice 4 room house, equipped for year around living. It has 2 bedrooms, living room, and large kitchen. Has large fire place. Plenty of good wood is available. A large sleeping porch provides comfort on hot nights. House is wired for electricity. Also large butane tank for stove and refrigerator.

Large storage shed (galvanized siding and concrete floors). Could be converted to bunk house.

-ACCESSIBILITY TO CLAIMS-

The workings on all claims can be reached by good mine roads. A short trail leads to one exploration tunnel.

-WORKINGS-

Workings consist of 3 tunnels, 3 shafts and one trench.

-VEINS-

There are 4 parallel veins where the one has protruded onto the surface, each about a mile in length. Ore also has protruded on the sides of the mountains. It has been declared ideal for open pitting and the ore lends itself to leaching.

New prospecting in the area has disclosed many more rich veins in the area.

-GEOLOGIST ED RUNDELLS REPORT-

Extracts below are taken from last mine report made by geologist Ed Rundel, now deceased.

TYPE OF SURROUNDING TERRAIN: Mountainous in part; rolling hills; semi-flat and flat ridges(Cu outcrops) accessible in part by roads. Roads could be made over most of the area with a minimum amount of dozing. There are a number of places where a drill rig can set up without preparation. All in all, it is more accessible for drilling than many other mining areas.

GEOLOGY AND MINERALIZATION: The district is in the "BASIN AND RANGE PROVINCE", where intense faulting and folding has occurred. The major folds in Arizona have developed in four general directions---ne-sw.,nw-se., n-s., and e-w. all of these trends are not considered to be of the the first order of importance for each era, but in Arizona, the dominant direction of folds are ne-sw., for the older Pre-Cambrian, but nw-se., and n-s., for the Laramide which began in the late Cretaceous and extended into the Cenozoic era. The shear fractures and faults may form in as many as eight or more directions. However, pronounced variations from these directions may occur in areas where the folds are of the plunging type, or if tilting has occurred subsequent to the folding, fracturing, and faulting. Consequently, trends may appear to be haphazard if the geometric implications are ignored.

LARAMIDE features have not been distinguished separately from those of the LATER CENOZOIC. It is a recognized fact that AGE assignments, based other than upon Fossil evidence or geochemicals assignments, are not very satisfactory. LARAMIDE has no definitive time limits, and its convenient usage to designate an interval of time is not accepted officually by the U.S. geological survey. Many geologists tend to assign its features entirely to the TERTIARY, and have designated granite rocks as such for several areas; likewise for schist, gneiss, volcanic, and sedimentary rocks. Activity is marked by intrusive bodies of igneous rock, dikes, plugs, and volcanic rocks. It appears to blend with the crustal unrest and igneous activity of middle to LATE CENOZOIC era. POST LARAMIDE erosion exposed ore bodies but later sedimentation, volcanism, and faulting concealed many of them. A tabulation of several mines or districts indicated that the lower level of Post Laramide general oxidation coincided with present water levels in only 20% of the cases; it was either above or below in 80% of them.

Mineralization appears to be associated with intrusive igneous rocks composed of orthoclase and plagioclase feldspar, with some biotite. The intrusives have a granular texture; the intermediate types being syenite, diorite and gabbro(dolerite)---- their felsitic equivalents are andesite and basalt. Rhyolite flows occur in washes and a few other places. Gneiss occurs in areas of great pressure and heat. Mica and Hornblende schists are the metamorphic rocks; sedimentary and from a basic igneous rock, such as gabbro. Minor intrusions are Dikes, Sills, and Plugs.

BRIEF DESCRIPTION OF DEPOSIT: Replacements in Limestone are of special interest because of their abundance and relatively high grade ore. Copper ore outcrops at the grass-roots in many places on the ridges, sides and slopes, while in other places there are numerous indications of ore being near the surface. The small crusts of Limestone on some of the rocks appears to have occurred from solution and fusion since a solution often times dissolves one mineral and at the same time replaces the limestone with which the solution is in contact.

There are indications where interlacing veins have woven together instead of emanating from a central vein---which would have to be a whopper. Depth of over burden over the entire area has not been determined at this date. However, there is a large area where it is light.

MALACHITE, AZURITE, CHALOCITE, and small amounts of BORNITE(although primary) occurs in areas of enrichment.

-MOUNTAIN ROSE MINE - EVALUATION- SHIRLEY ROSE-

This property, which I have a years lease and option to purchase on, is owned by Venice McGuffie Yarnell, Arizona.

It consists of 20 unpatented mining claims, a mill site, a 2 bedroom house, also a water right which is legally filed in Kingman, Arizona.

A good gravel county maintained road leads to properties. Good roads then cover the property.

Two dams on Mississippi Canyon, which runs through property, provide water from Mississippi Springs. These dams are also part of property.

The huge Alamo lake lies 8 miles from property.

Electric lines are in the area but do not run to property.

I project this property as an open pit. The veins and dikes run along the top of the low ridges. Very little over-burden on any thing. Most places there is none. Low rolling hills thru out area make accessibility excellent.

Country rock in area consists of entirely of a fractured white quartzite containing a high percentage of silica and some limestone.

Valuable ores in area are Copper, Silver, gold, and I expect more extensive testing and prospecting in area to turn up many more valuable minerals. Ground around area is all open for staking and I am presently staking more claims in area on newly discovered ore veins.

One drill hole (the only drilling that was ever done in area) showed good copper sulfides at 65 ft.

This property has never been mined. Some test tunnels and shafts and one drill hole don't begin to bring out the potential of this excellent prop.

VALLEY ASSAY OFFICE AND ORE TESTING LABORATORY

MEMORANDUM OF ASSAY

Made for W.A. Rundle Tempe, Arizona May 31 1972

SAMPLE NO.	PER TON OF 2000 POUNDS AVOIRDUPOIS		GOLD, PLATINUM		SILVER		COPPER, OR		LEAD, OR		ZINC, OR		TOTAL
	AT	PER OUNCE	AT	PER OUNCE	AT	PER OUNCE	AT	PER LB.	AT	PER LB.	AT	PER LB.	
	OZ.	100%	OZ.	100%	OZ.	100%	OZ.	100%	OZ.	100%	OZ.	100%	OZ.
1	0.06		1.30		6.5								
2	0.04		1.10		6.3								
3	1.52		1.40		6.2								
REMARKS:													

NO. 24.00 Pd. BY 31.1.72
Registered Assayer.

Form DRW-2060 (Rev. 11-74)
(47-0154.00)

PHELPS DODGE CORPORATION
DOUGLAS REDUCTION WORKS.

*Sample Taken From
ore in barrel Test
after it had leached
for 4 days.*

ASSAY AND ANALYSIS CERTIFICATE

DOUGLAS, ARIZONA February 15, 1979, 19.....

NAME Hand Sample, Gilbert: Reno

Smelter Lot	Shipper's Lot	Copper %	OZS. PER TON		SiO ₂ %	Al ₂ O ₃ %	Fe %	CaO %	MgO %	Mn %	Zn %	Pb %	S %	Cl %		
			SILVER	GOLD											%	%
1658			0.05	3.031	63.9	6.5										

Chief Chemist

CHARLES O. PARKER & CO.

CHEMISTS • ASSAYERS • ENGINEERS

TELEPHONE 623-1852
2114 CURTIS STREET
DENVER, COLORADO 80205

____ QUALITATIVE
XXX SEMI-QUANTITATIVE
____ QUANTITATIVE

ANALYTICAL REPORT

Polio 70

Date April 8, 1972

TO: Reed Engr. Co
P. O. Box 121, 1242 Evergreen Road
Wrightwood, Calif. 92397

(mistake made in shipping address)

SAMPLE: Submitted by Ed Rundle

Copper 2.30%	Iron 3.50%	Lanthanum _____
Silver 11.16 oz/ton (Fire Assay)	Cobalt _____	Cerium _____
Gold 0.05 oz/ton (Fire Assay)	Nickel 0.009%	Praseodymium _____
Zinc 0.23%	Cesium _____	Neodymium _____
Cadmium _____	Rubidium 0.011%	Samarium _____
Mercury _____	Barium 0.30%	Europium _____
Gallium _____	Strontium 0.027%	Gadolinium _____
Indium _____	Titanium 0.066%	Terbium _____
Thallium _____	Zirconium 0.004%	Dysprosium _____
Germanium _____	Hafnium _____	Holmium _____
Tin _____	Thorium _____	Erbium _____
Lead 0.48%	Vanadium _____	Thulium _____
Arsenic _____	Columbium _____	Ytterbium _____
Antimony _____	Tantalum _____	Lutetium _____
Bismuth 0.023%	Chromium 0.006%	Yttrium _____
Selenium _____	Molybdenum _____	_____
Tellurium _____	Tungsten _____	_____
Bromine _____	Uranium 0.008%	_____
Iodine _____	Manganese 0.040%	_____

LABORATORY REPORT

Mariposa Spectrographic Laboratory

SOURCES: 27.00 (includes Au-Ag assay)

LAB NO. 1101

Qualitative Spectrographic Analysis

Date 4/9/72

ANALYZED BY:

1. 100000

2. 100

3. 100000 5543

ELEMENTS FOUND
AND ESTIMATED PERCENTAGE RANGE
OF CONCENTRATION

SAMPLE MARK

#3

ELEMENT	Not Less Than %	Not More Than %	ELEMENT	Not Less Than %	Not More Than %	ELEMENT	Not Less Than %	Not More Than %
Aluminum	.003	0.04	Lithium			Thallium		
Antimony			Magnesium	.003	.009	Thorium		
Barium			Manganese	.001	.006	Tin	---	.001
Bismuth	.0004	.0007	Mercury			Titanium	.0007	.001
Cadmium	.003	.009	Molybdenum	.0007	.003	Tungsten		
Cerium			Nickel	.0004	.0009	Uranium		
Chromium	.0008	.004	Osmium			Vanadium	.0004	.0009
Cobalt			Palladium			Zinc		
Copper			Phosphorus			Zirconium		
Fluorine	.0007	.003	Platinum	Not detected in sample		RARE EARTHS:		
Gold			Potassium			Cerium		
Iron			Rhenium			Dysprosium		
Lead	2.0	4.0	Rhodium			Erbium		
Mercury			Rubidium			Europium		
Molybdenum			Ruthenium			Gadolinium		
Nickel			Scandium			Holmium		
Platinum			Silicon (as SiO2)	20.0	22.0	Lanthanum		
Platinum			Silver	.0002	.0007	Neodymium		
Platinum			Sodium			Praseodymium		
Platinum			Strontium			Samarium		
Platinum			Tantalum			Ytterbium		
Platinum			Tellurium			Yttrium		
Platinum	1.0	3.0						
Platinum	0.10	0.25						

See letter.

Respectfully Submitted

[Signature]
MARIPOSA SPECTROGRAPHIC LABORATORY (Spectrographer)

100000
100
100000 5543

-CYANIDE LEACHING-

For property potential for cyanide leaching I ran the following cyanide leaching barrel tests. Percentages of gold and silver were obtained by Atomic Absorption.

Date----2/8/1979

M#1---Very course ore from small stock pile on top of ground on ridge #4.

<u>Hours ran</u>	<u>AG.</u>	<u>AU.</u>	<u>Value per ton</u>	<u>Values per day 65 ton plant</u>	<u>Values per day 300 ton plant</u>
24	.025	.005	\$1.31	\$87.10	\$402.00
48	.04	.011	\$2.84	\$184.60	\$852.00
72	.04	.02	\$4.91	\$319.15	\$1,473.00
100	.08	.023	\$5.91	\$384.15	\$1,773.00

M#2---Finer ground ore from shallow shaft waste on ridge #4.

24	.03	.154	\$35.65	\$2,317.25	\$10,695.00
48	.045	.258	\$59.69	\$3,879.85	\$17,907.60
72	.06	.255	\$59.11	\$3842.15	\$17,733.00
100	.095	.295	\$68.58	\$4,457.70	\$20,574.00

NOTE---- Several of these samples would run as good as the above one if they were crushed to a 20 fine.

M#3---Sample came from small pile of rock from shallow shaft ridge#3.

24	.06	.030	\$7.36	\$478.40	\$2,208.00
48	.075	.036	\$8.86	\$575.90	\$2,658.00
72	.085	.030	\$7.55	\$448.50	\$2,265.00
100	.11	.037	\$9.35	\$607.75	\$2,805.00

M#4---Shallow hole on top of ridge #3.

24	.025	.009	\$2.26	\$146.90	\$678.00
48	.025	.01	\$2.49	\$161.85	\$748.00
72	.025	.013	\$3.18	\$206.70	\$954.00
100	.055	.017	\$4.33	\$281.45	\$1,299.00

M#5---Finer ground ore from little deeper in ground, top of ridge #2.

24	.035	.049	\$11.54	\$750.10	\$3,462.00
48	.05	.07	\$16.48	\$1,071.20	\$4,944.00
72	.05	.078	\$18.32	\$1,190.80	\$5,496.00
100	.08	.09	\$21.32	\$1,385.80	\$6,396.00

M#6---Shallow hole top of ground ridge #2.

24	.03	tr.	\$.23	\$14.35	\$69.00
48	.035	.003	\$.96	\$62.40	\$288.00
72	.025	.01	\$2.49	\$161.85	\$747.00
100	.02	.013	\$3.14	\$204.10	\$942.00

M#7---Small dump from shallow shaft ridge #3.

24	.25	.026	\$7.90	\$513.50	\$2,370.00
48	.34	.036	\$10.90	\$708.50	\$3,270.00

MT#1---Taken along tunnel wall #1.

20	.15	.003	\$1.81	\$117.65	\$543.00
40	.09	tr.	\$.69	\$44.85	\$207.00
66	.11	.005	\$1.17	\$76.05	\$351.00

MT#2---Taken across face of deposit at tunnel #2.

20	.66	.026	\$11.06	\$718.90	\$3,318.00
----	-----	------	---------	----------	------------

MT#2---cont.

40	.87	.011	\$9.23	\$589.95	\$2,769.00
66	1.10	.011	\$11.00	\$715.00	\$3,300.00

PHELPS DODGE ASSAY SAMPLE(from ore that had leached for 4 days in barrel test.

.17	.031	\$8.13	\$528.45	\$2,439.00
-----	------	--------	----------	------------

MCGUEFIE (SALLY ANNE) MINE

-ESTIMATION ON TONNAGE AND VALUES-

Estimate only on four ridges lying in a N.W. to S.E. direction. And only on principle ore body..

Total estimated ore tonnage-----323,000 tons.

Overall valuation per ton of ore as of 2/21/79-----\$12.16

Value of ridge ore estimated at-----\$3,927,680.00

Each ridge is comprised of an ore vein approx. 10 ft. wide by 5200 ft. long. Drilling has shown the oxidation zone ending at 65 ft. in depth. Further depth is estimated as copper sulfate ore.

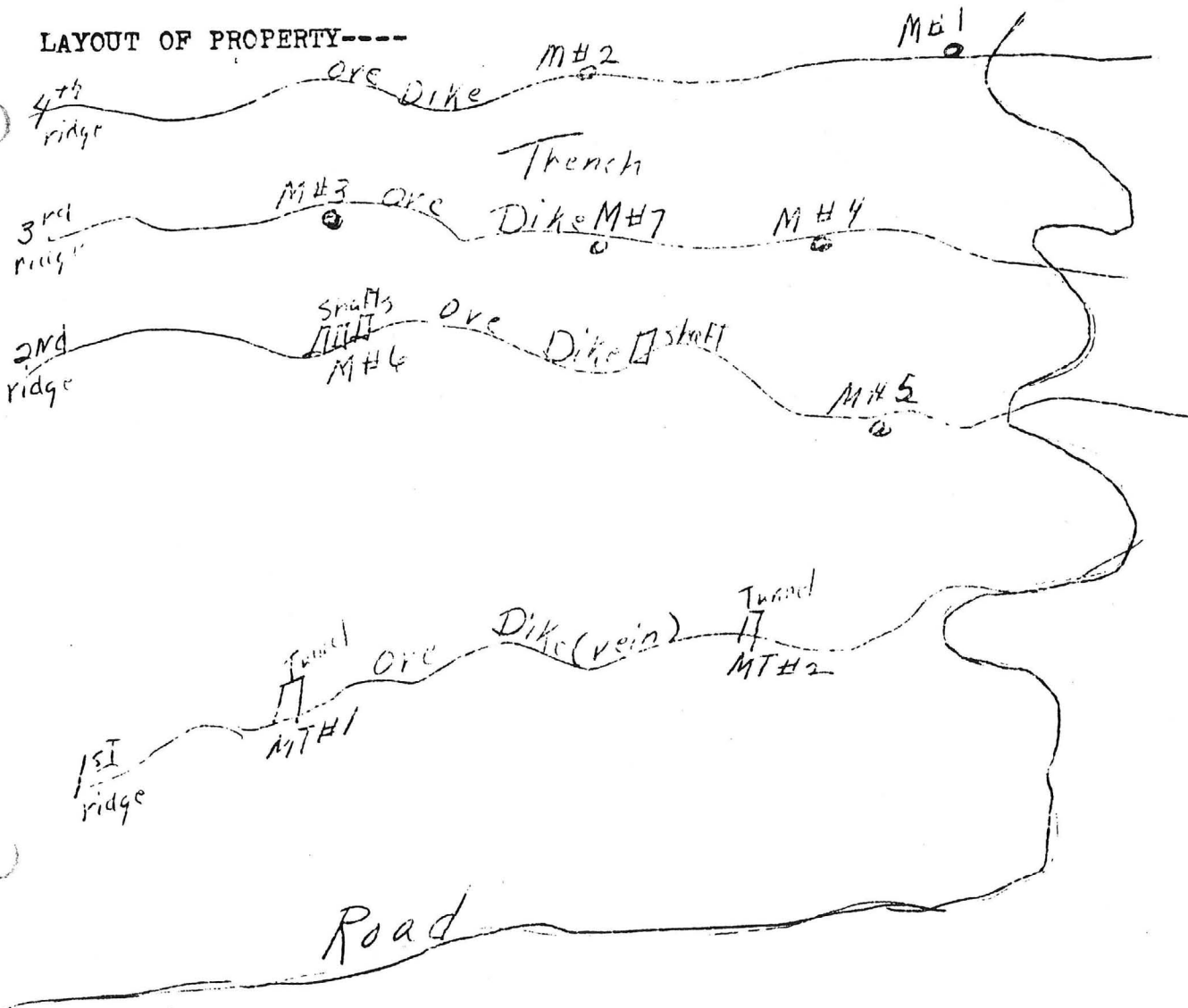

-PRINCIPALS INVESTMENTS-

EXCELLENT PROPERTY- (Thougerly tested.)

EXPERIENCED IN SETTING UP AND OPERATING LEACHING PLANT SYSTEM.

65 ton leaching plant, chemicals and pipes-----	\$5,111.00
Backhoe-----	\$3000.00
Tools-----	\$ 500.00
Trailer set up for lab.-----	\$ 600.00
Company Pick-up-----	\$1100.00
Cinder blocks, etc. for 2 bldgs.-----	\$2500.00
Lab and Barrel test equipment-----	\$ 200.00
Furnace-----	<u>\$ 200.00</u>

--

TOTAL-----\$13,211.00

-PROPOSED INVESTMENTS AND RETURNS ON THIS PROPERTY-

INITIAL INVESTMENT-----\$24,748.00

RETURNS RECEIVED FOR TRIPLE THE INVESTMENT-----\$74,244.00

TERMS-----20% until initial investment is paid, 10% thereafter until triple the investment has been paid.

PROPOSED PROJECT-----

One 65 ton plant operated 12 hours a day, 5 days a week. Eventual purchase of 300 ton plant and larger operation.

BALANCE ON PLANT-----\$1400.00

USED D6 CAT-----\$4000.00

DUMP TRUCK-----\$3000.00

2 ELECTRIC GENERATORS-----\$1068.00

PLASTIC-----\$1280.00

PAY OFF PREVIOUS INVESTOR-----\$8000.00

ADDITIONAL EXPENSE-----\$5000.00

INITIAL INVESTMENT-----\$17,348.00

RETURNS RECEIVED FOR TRIPLE THE INVESTMENT-----\$52,044.00

TERMS----20% until initial investment is paid off, 10% thereafter until triple the investment has been paid.

PROPOSED PROJECT----

One 65 ton plant operated 12 hours a day, 5 days a week.

DRILL WELL, PUMP AND PIPE-----\$4000.00

D-6 CAT-----\$6000.00

2 GENERATORS-----

PLASTIC-----\$1,280.00

\$1068.00

ADDITIONAL EXPENSE-----\$5000.00

INITIAL INVESTMENT-----\$62,700.00

RETURNS RECEIVED FOR TRIPLE THE INVESTMENT-----\$188,100.00

TERMS-----20% until initial investment has been paid, 10% thereafter
until triple the investment has been paid.

PROPOSED PROJECT-----

300 ton plant operated 24 hours a day, 5 days a week.

3000TON PLANT-----\$21,000.00

D-6 CAT(used)-----\$ 6,000.00

DUMP TRUCK (used)-----\$ 3000.00

ONE HIRED MAN(\$5.00 per hr. 4 mo.--\$ 2800.00

LUMBER FOR THREE SHEDS-----\$ 2000.00

GAS AND DIESEL EXP.-----\$ 1400.00

CHEMICAL EXP.-----\$ 1000.00

4 GAS GENERATORS-----\$ 2497.00

DRILLING WELL, WATER PIPE AND PUMP-\$ 1000.00

PAY OFF PREVIOUS INVESTOR-----\$ 8000.00

ADDITIONAL EXPENSE-----\$ 7000.00

INITIAL INVESTMENT-----\$178,927.71

RETURNS RECEIVED FOR TRIPLE THE INVESTMENT-----\$536,781.00

TERMS-----20% until initial investment is paid, 10% thereafter until triple the investment has been paid.

PROPOSED PROJECT-----

One 300 ton plant running 24 hours a day. Pad and pond set up so 2 more 300 ton plants can be added, at no additional manpower,. Prospecting and testing in area for new ore deposits. Staking of new claims. Setting up and operating crusher to run previously leached ore and crush new.

D-8 CAT WITH RIPPERS-----\$25,000.00

300 TON PLANT-----\$21,000.00

2 DIESEL GENERATOR PLANTS-----\$13,000.00

HIRED MAN, \$5.00 per hr. 6 mo.-----\$ 5200.00

U.S. DUES-----\$ 1,495.00

3 MEN AT \$3.50 per hr. 6 mo.-----\$10,920.00

U.S. DUES-----\$ 3,822.00

LAB EQUIP.(\$10,000 A.A MACH., CHEMICALS)-----\$18,500.00

3 15X20 BLDGS.-----\$11,250.00

FRONT END LOADER (used)-----\$15,000.00

DIESEL 14 yd, DUMP TRUCK(used)-----\$ 5500.00

WELL DRILLING, PIPE, PUMP, ETC.-----\$ 6500.00

PLASTIC(250X350)-----\$14,000.00

TRAILER HOOK UPS-----\$ 2500.00

ACCOUNTING SERVICE-----\$ 3,000.00

PAY OFF PREVIOUS INVESTER-----\$ 8000.00

COMPANY TRANSPORTATION-----\$ 4500.00

ADDITIONAL EXPENSES -----\$ 15,000.00

-SUMMARY-

Our primary intent is to develop a working, profitable, mining venture. Profitable to both the principals and the investors. Our goal is to make and develop the properties and our business into a long term project. We do not intend to get "rich over night" but to use the money on the accomplishment of a profitable business.

All invested monies will be deposited in a account with the investor recieving the receipts and the company having the canceled checks.

We do not wish for an investor to feel like we are out to get his money as many in the field are, but we do feel that both the investor and the operators shall maintain a proper and manageable distance. At any time the investor shall have access to the records, but the operators shall have total control of the plant, its operation, and anything to do with setting up and operation.

Any proposals are negotiable and are not meant to be binding. They are only proposals, contracts will be drawn and negotiated.

Pay off on investment in cash
or Gold & Silver.