



CONTACT INFORMATION

Mining Records Curator
Arizona Geological Survey
1520 West Adams St.
Phoenix, AZ 85007
602-771-1601
<http://www.azgs.az.gov>
inquiries@azgs.az.gov

The following file is part of the

Arizona Department of Mines and Mineral Resources Mining Collection

ACCESS STATEMENT

These digitized collections are accessible for purposes of education and research. We have indicated what we know about copyright and rights of privacy, publicity, or trademark. Due to the nature of archival collections, we are not always able to identify this information. We are eager to hear from any rights owners, so that we may obtain accurate information. Upon request, we will remove material from public view while we address a rights issue.

CONSTRAINTS STATEMENT

The Arizona Geological Survey does not claim to control all rights for all materials in its collection. These rights include, but are not limited to: copyright, privacy rights, and cultural protection rights. The User hereby assumes all responsibility for obtaining any rights to use the material in excess of "fair use."

The Survey makes no intellectual property claims to the products created by individual authors in the manuscript collections, except when the author deeded those rights to the Survey or when those authors were employed by the State of Arizona and created intellectual products as a function of their official duties. The Survey does maintain property rights to the physical and digital representations of the works.

QUALITY STATEMENT

The Arizona Geological Survey is not responsible for the accuracy of the records, information, or opinions that may be contained in the files. The Survey collects, catalogs, and archives data on mineral properties regardless of its views of the veracity or accuracy of those data.

PRINTED: 01/31/2002

ARIZONA DEPARTMENT OF MINES AND MINERAL RESOURCES AZMILS DATA

PRIMARY NAME: MAMMOTH GROUP

ALTERNATE NAMES:

MCCAFFERTY GROUP
RED BIRD
SIDEWINDER
GILA MONSTER
MAMMOTH NO. 1-11
TIP TOP
RATTLESNAKE

PIMA COUNTY MILS NUMBER: 436

LOCATION: TOWNSHIP 21 S RANGE 10 E SECTION 7 QUARTER S2
LATITUDE: N 31DEG 36MIN 32SEC LONGITUDE: W 111DEG 21MIN 33SEC
TOPO MAP NAME: ARIVACA - 15 MIN

CURRENT STATUS: PAST PRODUCER

COMMODITY:

SILVER
GOLD LODE
COPPER
LEAD

BIBLIOGRAPHY:

AZBM FILE DATA
ADMMR MAMMOTH GROUP FILE
ADDITIONAL WORKINGS SEC. 18

Kypselis Bros. 9-4-42
Ruey Star Rte., Box 277
Tucson

MAMMOTH GROUP

(Formerly McCafferty Group)

MILS MAMMOTH GROUP

MILS CONSOLIDATED ARIZONA MINE

ARIZONA

PIMA COUNTY
~~HELVETIA~~ DIST.

T21S, R10E, Sec 18, 7

Lee Wilton, Arivaca, Arizona (Dec'd) was the owner of the McCafferty Claims.
His nephew George C. Burrow, 39 Kanan Rd, Agaula, California is now the owner.

GW1 WR 8/29/70

MM-10

DEPARTMENT OF MINERAL RESOURCES

STATE OF ARIZONA

MINE OWNER'S REPORT

Date July 31, 1941

1. Mine: Mammoth Group
2. Location: Arivaca, Arizona
3. Mining District & County: Arivaca Mining District, Pima Co., Arizona
4. Former Name: Ma Cafferty Group
5. Present Owners: Keppler Bros.
6. Address (Owner) Arivaca, Arizona
7. Operator
8. Address (Operator)
9. President, Owning Co.
- 9A. President, Operating Co.
10. Gen. Mgr.
14. Principal Minerals: gold, silver, scheelite and vanadium
11. Mine Supt.
15. Production Rate
12. Mill Supt.
16. Mill: Type & Cap.
13. Men Employed
17. Power: Amt. & Type
18. Operations: Present

MAMMOTH GROUP

Cu, Zn

Pima

10 - 7

S T 21 S R 5 E

Keppler Bros., Box 277, Ruby Star Rte., Tucson

'45

19. Operations: Planned
20. Number Claims, Title, etc. Eleven - Mammoth Group.

21. Description: Topography & Geography: This property is about 3500 ft. altitude. The main workings consisted of incline shaft 400 feet deep, water level 40 feet. Mine closed down in 1886, too much water for worn out pumps. Ore production at the time of closing 12 tons a day using hand steel. No compressors those days. Topography fairly rugged.

22. Mine Workings: Amt. & Condition

see Mammoth Group - Book V-IV - A.L. Flagg vanadium reports

USBM "U" File states VANADIUM POOR

(over)

23. Geology & Mineralization: Andesite foot wall. Porphyry hanging wall.
24. Ore: Positive & Probable, Ore Dumps, Tailings: Main McCafferty shaft dump good milling proposition - plenty dump and plenty water and perfect millsite.
- 24A. Dimensions and Value of Ore body: Fisher vein - 8 in. to 7 ft. wide. Will average 18 in.
25. Mine, Mill Equipment & Flow-Sheet
26. Road Conditions, Route: 1/2 mile from main Sasaby highway. 3 1/2 miles west of Arivaca.
27. Water Supply: Plenty of water and perfect millsite. Water from main McCafferty shaft. Sufficient water to run a pretty large mill.
28. Brief History: This property started work in the early 70's. They put up mill on what is now known as the Wilber place. Milled all the ore from surrounding claims. McCafferty shaft, about 1 mile north of old mill tailing pile. The man having the contract to pack the ore from the McCafferty shaft to the mill is still living at Arivaca - he is near 90 years old now. He had 30 burros in his train. He made 4 trips daily from mine to mill - 200# to the burro - making a total of 12 tons a day from the shaft. All ore came up out of the shaft already sacked in barley sacks. The old suction hose core is still in the ground. 2 1/2 in. pumps could not handle water (old steam boilers using mesquite wood for fuel). In '86 silver was very low but according to best information available they were making money when they closed down. In order to continue work they would have to install new pumps and boiler, and freighting facilities were bull teams and muel teams and an awful long haul, and silver being low decided to close down till silver came up which never happened for years. Down to the water level the shaft is in perfect shape. We believe that it is a mine already made by unwatering shaft and putting it in working condition. We have found scheelite for 1000 ft. in lengths on the vein and the ore coming from the bottom of shaft also shows scheelite. The principal minerals are gold, silver, scheelite and vanadium.
29. Special Problems, Reports Filed
30. Remarks: Doc Meriman, Sasaby, Arizona, can give all details about the old property.
31. If property for sale: Price, terms and address to negotiate. Will either sell outright or give lease and bond. \$20,000.

Signed: Keppler Bros.
Arivaca, Arizona

DEPARTMENT OF MINERAL RESOURCES
STATE OF ARIZONA
MINE OWNER'S REPORT

Date July 31 1941

1. Mine Mammoth Group

2. Location Arivaca Ariz

3. Mining District & County Arivaca Mining district, Pima Co Ariz

4. Former name Mac Cafferty Group

Present 5. Owners Keppeler Bros

6. Address (Owner) Arivaca Ariz

7. Operator

8. Address (Operator)

9. President, Owning Co.

9A. President, Operating Co.

10. Gen. Mgr.

14. Principal Minerals Gold, silver, Lead

11. Mine Supt.

15. Production Rate 8 tons daily

12. Mill Supt.

16. Mill: Type & Cap.

13. Men Employed

17. Power: Amt. & Type

18. Operations: Present

19. Operations: Planned

20. Number Claims, Title, etc. Eleven, Mammoth Group

21. Description: Topography & Geography This Property is about 3500 ft altitude. The main workings consisted of an incline shaft, 400 feet deep. water level 40 feet. mine closed down in 1886, too much water for worn out pumps. ore production at the time of closing 12 tons a day. using hand steel, no compressors those days. Topography Fairly rugged.

22. Mine Workings: Amt. & Condition

23. Geology & Mineralization Under 5' Foot well. Porphy hanging wall

24. Ore: Positive & Probable, Ore Dumps, Tailings Main Mc Carbert shaft dump
Good milling proposition Plenty dump & plenty water
& perfect mill sight

24A. Dimensions and Value of Ore body Thicker vein, 6' to 7 ft. wide. dip
average 18 in

25. Mine, Mill Equipment & Flow-Sheet

26. Road Conditions, Route 1/2 mile from main Sasaby Highway. { 3 1/2
miles west of Arivaca

27. Water Supply Plenty water, & perfect mill sight. Water
from main Mc Carbert shaft. Sufficient water to
run a pretty large mill

28. Brief History find on Special Page.

29. Special Problems, Reports Filed

30. Remarks Doc Meriman, Sasaby Arizona can give
all details about the old property

31. If property for sale: Price, terms and address to negotiate. Will either sell out
right or give Lease & Bond. \$90,000

32. Signature Heppard Brown Arivaca Ariz

33. Use additional sheets if necessary.

DEPARTMENT OF MINERAL RESOURCES
STATE OF ARIZONA
OWNERS MINE REPORT

Date 6-22-39 (8-12-40)

1. Mine Mammoth Group
2. Mining District & County Arivaca
3. Former name McCafferty (shaft)
4. Location 3 miles s.w. of Arivaca
5. Owner Keppler Bros.
6. Address (Owner)
7. Operator (owner)
8. Address (Operator)
9. President
10. Gen. Mgr.
11. Mine Supt.
12. Mill Supt.
13. Principal Metals silver, lead, gold (vanadium)
14. Men Employed
15. Production Rate Not established
16. Mill: Type & Cap.
17. Power: Amt. & Type none
18. Operations: Present
19. Operations Planned Continue drift and open ore body
20. Number Claims, Title, etc. 16 unpatented claims. Was surveyed for patent.
21. Description: Topography & Geography S. slope of Guijas Mts. Joins Amado group on its westend. Incline 45° and less.
22. Mine Workings: Amt. & Condition 400' shaft water; 70 ft. no timbering
50' shaft with 13' x cut
#9: 175' shaft 75' drift 20' face
Tiptop: 30' drift

23. Geology & Mineralization Coma vein andesite and porphyry. A vein in slate porphyry.
Some tin. Vein width 2' 7" top 4' bottom

24. Ore: Positive & Probable, Ore Dumps, Tailings

24-A Vein Width, Length, Value, etc.

25. Mine, Mill Equipment & Flow Sheet Old 3 stamp mill

26. Road Conditions, Route Good 1/4 mile off highway. Now building road to tunnel.

27. Water Supply Water in main shaft, in #2 shaft, and in Tiptop.

28. Brief History

29. Special Problems, Reports Filed

Begin by pumping out McCafferty. (8-12-40)-Practically all of our development work has been on our Mammoth claim #1, that McCafferty 400 ft shaft is ore. We have done about 75 ft of open cut work, showing up the vein all the way and incidentally taking out some highgrade ore. The exposed vein shows to be from 18" to 2ft wide. Also, sank a 4x12x30' shaft, also taking out high grade all the way down. Now we are drifting on a large cross cut vein that cuts the main McCafferty vein. The cross vein shows considerable high grade silver-gold ores. The pure quality ran .30 gold, 8.9 ozs silver. We are in about 30 ft now. We figure on cutting the McCafferty vein in about 10 ft farther. Where we expect to encounter a good sized body of good ore. There continues the drift until we connect up with the 400 ft shaft, probably a few feet below where the water stands at 71 feet from the collar of (of the shaft. We thoroughly believe that the McCafferty shaft is already a made mine. All (that it needs is unwatering and put in working shape.

32. Signed. Keppler Bros.

33. Use additional sheets if necessary.

Arivaca Ariz.
July 15- 40

Mr. J. L. Coupal
Phoenix Ariz

Dear Mr Coupal.

Yours of July 5th 40. Recd.

We are writing you the developments we have made since our last entry.

Practically all of our development work has been on our Mammoth claim No (1) that M Cafferty 400 foot shaft is on. We have done about 75 feet of open cut work, showing up the vein all the way & incidentally taking out some high grade ore. The exposed vein shows to be from 18 in to 2 feet wide.

also sank a $4 \times 12 \times 30$ ft shaft. also taking out high grade all the way down. Now we are drifting on a large cross vein that cuts the main M Cafferty vein. The cross vein shows considerable high grade silver gold ore. The pure quantity runs 30 gold. 8.9 oz silver. We are in

about 30 feet now. We figure on
cutting the McCafferty vein in about
10 feet farther. Where we expect to
encounter a good sized Boddy of
good ore. Then continue the drift
until we connect up with the 400
ft shaft, probably a few feet below
where the water stands at 21 feet
from the collar of the shaft.

We thoroughly believe that the McCafferty
shaft is already a made mine,
all that it needs is unwatering
& put in working shape.

That is about all of the new workings
as yet. If we are lucky when we
cut the vein we will let you know
Very Truly yours

Keppeler Bros
you understand more about filling in the
form than we do. so will let you
do it. X B.

28. Brief Histo.

This property started work in the Early 70's. They put up Mill on what is now known as The Wilber place. Milled all the ore from surrounding claims. McCafferty shaft, about 1 mile North of old Mill tailing Pile. The man having the contract to pack the ore from the McCafferty shaft to the mill is still living at Arivaca. He is near 90 years old now. He had 30 Burro in his Train. He made 4 trips daily from mine to mill 200# to the Burro. making a total of 12 Tons a day from the shaft. All ore came up out of the shaft already sacked in Bailey sacks. The old section hole core is still on the ground. 2 1/2 in. Pumps could not handle water. { Old Steam Boilers. using Mesquite Wood for fuel. Am 86 silver was very low. But according to best information available they was making money when they closed down

In order to continue work, they would
have to install new Pumps & Boiler,
& Freighting facilities were Bull Teams
& Mule Teams & an awful long haul,
& silver being low decided to close
down till silver came up. which
never happened for years
Down to the water level. The shaft is
in perfect shape. We believe that
it is a mine already made by
unwatering shaft & putting in
worse condition. We have found
Scheelite for 1000 ft in length on
the vein, & the ore coming from
the bottom of shaft also shows Scheelite
The principle Minerals are Gold, silver
Scheelite & Vanadium.

Heppen Bros

Trivica Aug

Sept 4. 47

Mr Sam Coupal

Phoenix

Dear Mr Coupal

We don't remember if we wrote you that
the Vancouver people sent their
Engineer out to see us or not. Any
way they did & taken some samples.
They also went up to see Edwards &
Campbell, up Higharea way. They
seem to be getting busy. Mr Coupal we
are changing our address to
Ruby Star Route, Box 277, Tucson.
For this Post Office is unreliable we
couldn't stand it any longer. We
reported the Trivica Deputy P.M.,
to the Post Master General, yesterday
for refusing to make us out a
Money order, & acting unbecomingly
to a Post Master so please send or
pay Ditts & Matting Cards to the
above address Ruby Star Route Box 277
Tucson Ariz, over

but none of that every thing is quiet
in this neck of the woods.

With best wishes, & Hurrah for
Jones, we remain yours Truly

H. J. & C. B. Keppeler.

July 29, 1941

Mr. F. C. Keppler
Arivaca, Arizona

Dear Mr. Keppler:

I have your letter of July 24th relative to your tungsten property which you state you are willing to sell on bond and lease to the right kind of people.

I am enclosing a mine owner's report and will you kindly give us the data asked for on this report, as this is exactly the information that anyone who is seeking a property would like to know before they take the trouble to look it over.

It is well worth your while to spend a little time working up this report as it must be remembered that, based upon the information in this report, the prospective buyer decides whether or not he will look further into the property and make a personal examination. Therefore, if that which we have for sale is not attractively presented, we can hardly expect the customer to consider it. Of course, you know what you have but it must be remembered that the prospective buyer knows nothing about you or the opportunities of your property at the time when he first surveys the file and decides which ones are worthy of further investigation.

We want to help you move your property and we believe that we can do so with your cooperation in presenting it well.

Of course, since the Governor's veto of our appropriations we are not as well equipped to make copies of reports and send them all over the country as we did before, but we are going to do the best we can in bringing buyers and sellers together.

Hoping that we will hear from you again soon with the mine owner's report filled out, and wishing you all success, I am

Yours very truly,

Chairman, Board of Governors
Arizona Department of Mineral Resources

CFW:LP
Enc.

September 11, 1942

✓ Keppler Brothers
Ruby Star Route, Box 277
Tucson, Arizona

Dear Sirs:

Many thanks for your letter of September 4,
and I have noted the change in address. I am sorry
to hear of the dissatisfaction with the present Post
Office and hope the change in address straightens
this out.

I talked with the U. S. Vanadium about
your property and they evidently find the ore too
low-grade to warrant additional work on their part.

With best wishes and kindest regards, I am

Very truly yours,

J. S. Coupal,
Director

JSC:hal

June 8, 1942

MEMORANDUM

To: Director, Dept. Mineral Resources
From: George A. Ballam.

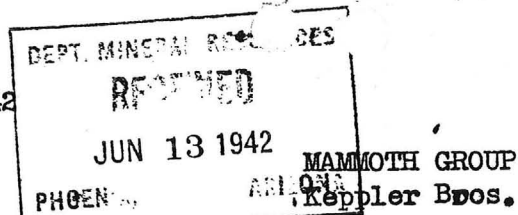

The Mammoth Group of 11 claims is located about 3 miles west of Arivaca, and is owned by the Keppler Bros. of that address.

There is a 400' inclined shaft on the property, with water 70' from the surface. The operation, originally gold-copper, was carried on about fifty years ago. There is a dump containing about 5,000 tons of material which has been shown to contain scheelite in undetermined amounts.

Open cuts made by the owners on the outcrop recently, and extending for a distance of about 1,000' to the south of the shaft have revealed considerable amounts of scheelite and vanadium.

The owners have been requested to report the vanadium showings to Mr. Emigh, Tucson representative of the U.S. Vanadium Corp., and also wish Mr. Campbell of this department to investigate the tungsten occurrence.

Two men are working on the property, trenching along the outcrop.

George A. Ballam

Urivaca Ariz June 24th 01

Mr J. D. Coupal. Phoenix Ariz
Director, Dept of Mineral resources.

I am here making a true statement
of our Schelite prospect on our
unapert, vein which shows schelite
nearly every place we have exposed.
The vein for a distance of over one
thousand feet, as seen from the
look of it with the mineral lamp
it will average a good milling
grade, I would say around 2%.

Near the north end of Mammoth #1 claim
there is what is supposed to be a 400 foot
incline shaft. The lamp shows consid-
erable schelite over this dump, and
quartz that was on the platform, at
the collar of the shaft, shows schelite
under the lamp. 2 large boulders that
with a combined weight of 800 to 1000 #
I believe will average 6% or more.
There is 5 claims on this same vein.

I am sure there is water enough in
the shaft to supply a good size mill.
I am further sure that within one
hour with the mineral lamp I can
show any ^{one} enough ore to satisfy him
go to sampling. we will sell or we
will bond & take to the right
kind of people.

I will guarantee every statement
made here. Very Truly

F. L. Keppler

Keppler Bros mines

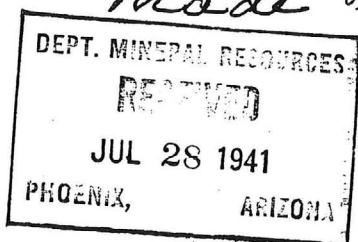

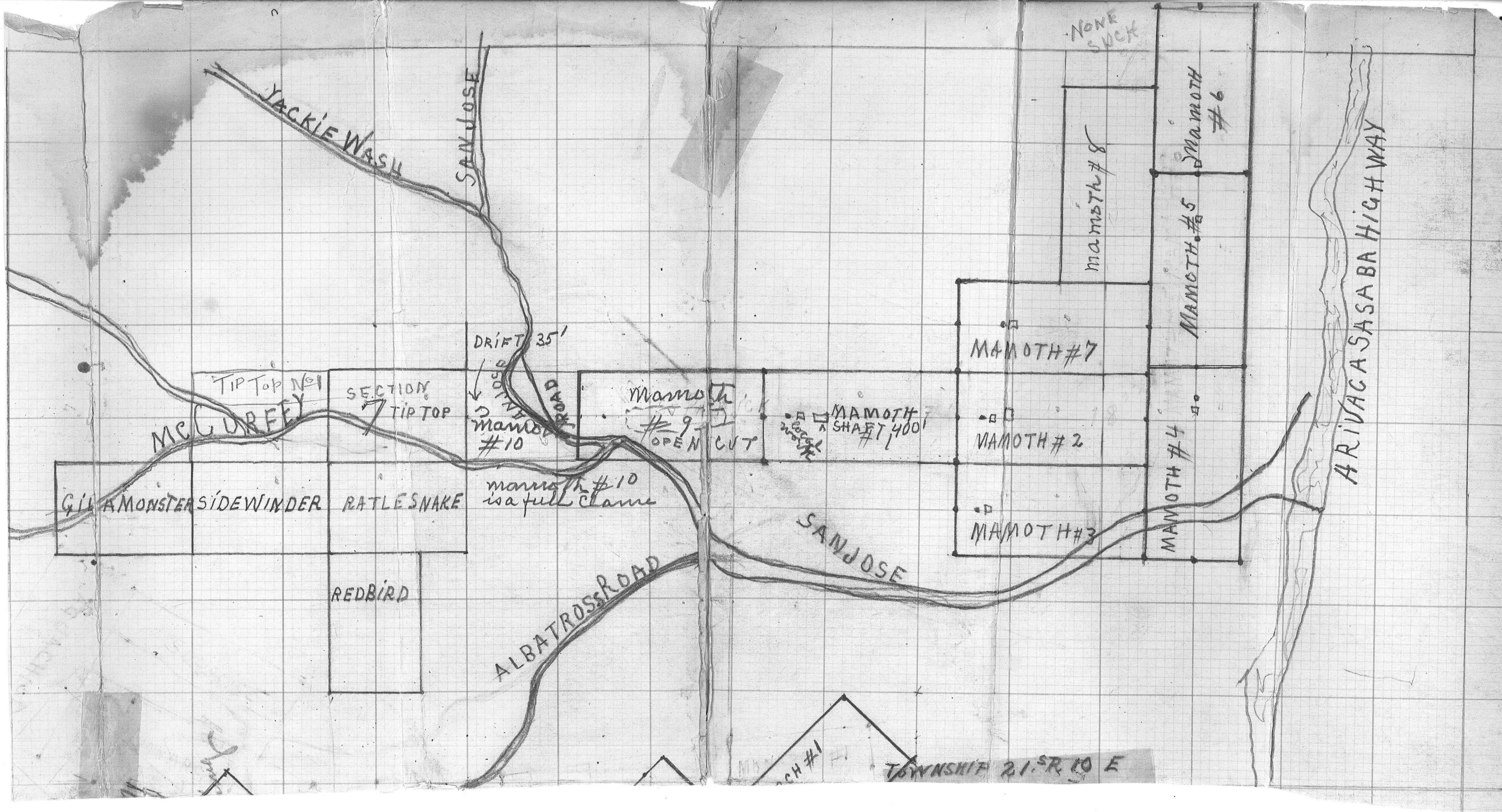

McGURFEY

TIP TOP No 1

SECTION
TIPTOP

DRIFT 35'

MAMOTH #10

MAMOTH #9
OPEN CUT

MAMOTH SHAFT #1,400'

MAMOTH #7

MAMOTH #2

MAMOTH #3

MAMOTH #4

MAMOTH #5

MAMOTH #6

MAMOTH #8

ALBATROSS ROAD

SANDJOSE

ARIVACA SABA HIGHWAY

NONE SUCK

CH #1

TOWNSHIP 21.5R. 10 E

GIL A MONSTER SIDEWINDER

RATTLE SNAKE

REDBIRD

MAMOTH #10 is a full claim