



## **CONTACT INFORMATION**

Mining Records Curator  
Arizona Geological Survey  
1520 West Adams St.  
Phoenix, AZ 85007  
602-771-1601  
<http://www.azgs.az.gov>  
[inquiries@azgs.az.gov](mailto:inquiries@azgs.az.gov)

The following file is part of the

Arizona Department of Mines and Mineral Resources Mining Collection

## **ACCESS STATEMENT**

These digitized collections are accessible for purposes of education and research. We have indicated what we know about copyright and rights of privacy, publicity, or trademark. Due to the nature of archival collections, we are not always able to identify this information. We are eager to hear from any rights owners, so that we may obtain accurate information. Upon request, we will remove material from public view while we address a rights issue.

## **CONSTRAINTS STATEMENT**

The Arizona Geological Survey does not claim to control all rights for all materials in its collection. These rights include, but are not limited to: copyright, privacy rights, and cultural protection rights. The User hereby assumes all responsibility for obtaining any rights to use the material in excess of "fair use."

The Survey makes no intellectual property claims to the products created by individual authors in the manuscript collections, except when the author deeded those rights to the Survey or when those authors were employed by the State of Arizona and created intellectual products as a function of their official duties. The Survey does maintain property rights to the physical and digital representations of the works.

## **QUALITY STATEMENT**

The Arizona Geological Survey is not responsible for the accuracy of the records, information, or opinions that may be contained in the files. The Survey collects, catalogs, and archives data on mineral properties regardless of its views of the veracity or accuracy of those data.

PRINTED: 11/20/2001

ARIZONA DEPARTMENT OF MINES AND MINERAL RESOURCES AZMILS DATA

PRIMARY NAME: LOEY AND LENA PROSPECT

ALTERNATE NAMES:  
CLAIM MS 3929

GILA COUNTY MILS NUMBER: 290

LOCATION: TOWNSHIP 5 N RANGE 17 E SECTION 5 QUARTER E2  
LATITUDE: N 33DEG 51MIN 20SEC LONGITUDE: W 110DEG 32MIN 55SEC  
TOPO MAP NAME: BLUE HOUSE MTN - 15 MIN

CURRENT STATUS: EXP PROSPECT

COMMODITY:  
ASBESTOS LONG FIBER

BIBLIOGRAPHY:  
WILSON ED ASB DEPTS AZ AZBM BULL 126 1928  
P 65  
ADMMR LOEY AND LENA CLAIMS FILE  
STEWART L A CHRYS-ASB DEPTS AZ USBM IC 7706  
1955 P 47  
BLM MINING DISTRICT SHEET 187

SOLID LINES - BRUNTON SURVEY  
DASHED LINES - SKETCHED

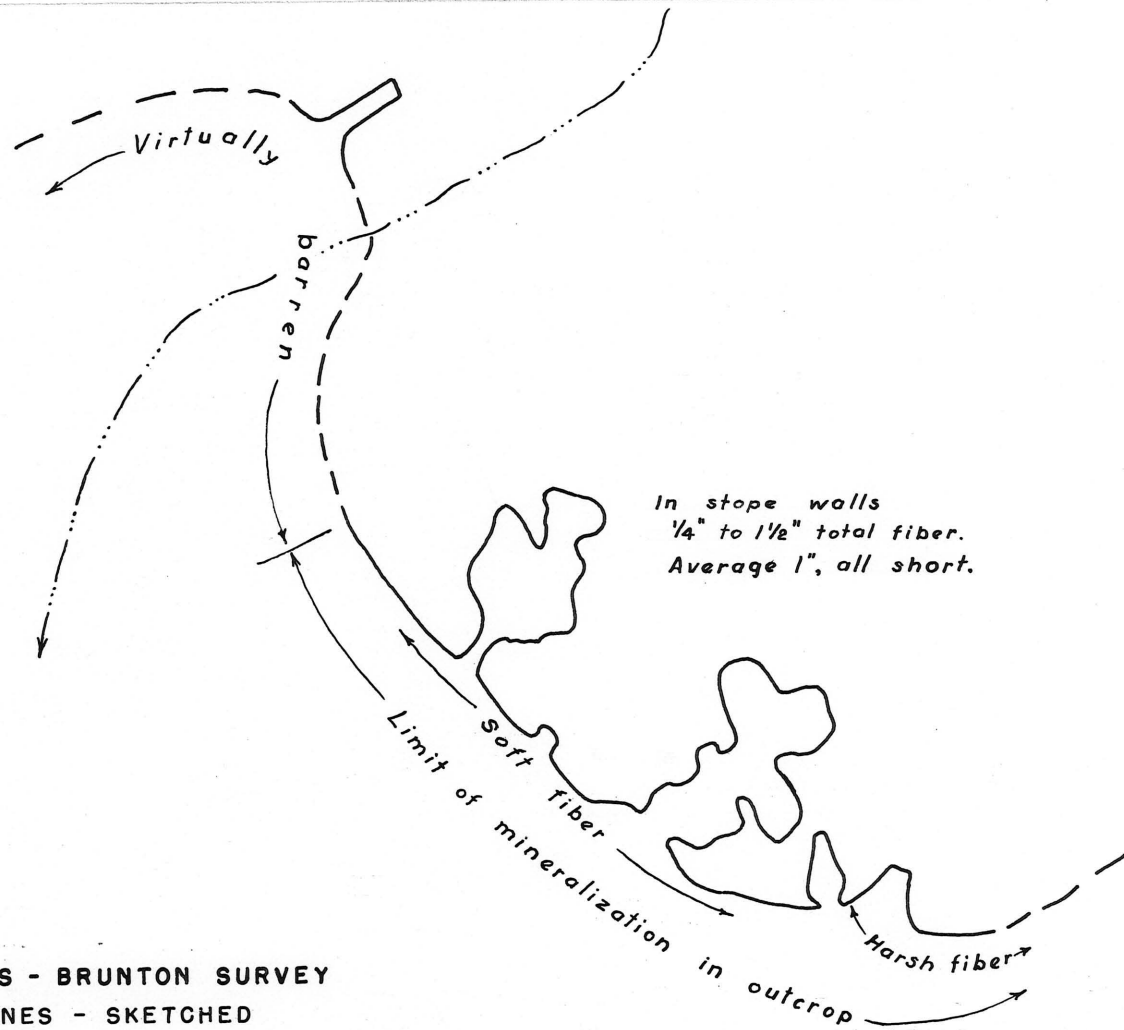

SCALE - 1" = 50'

DMEA 2867

FIGURE 3. - LOEY AND LENA MINE WORKINGS - GILA COUNTY, ARIZONA

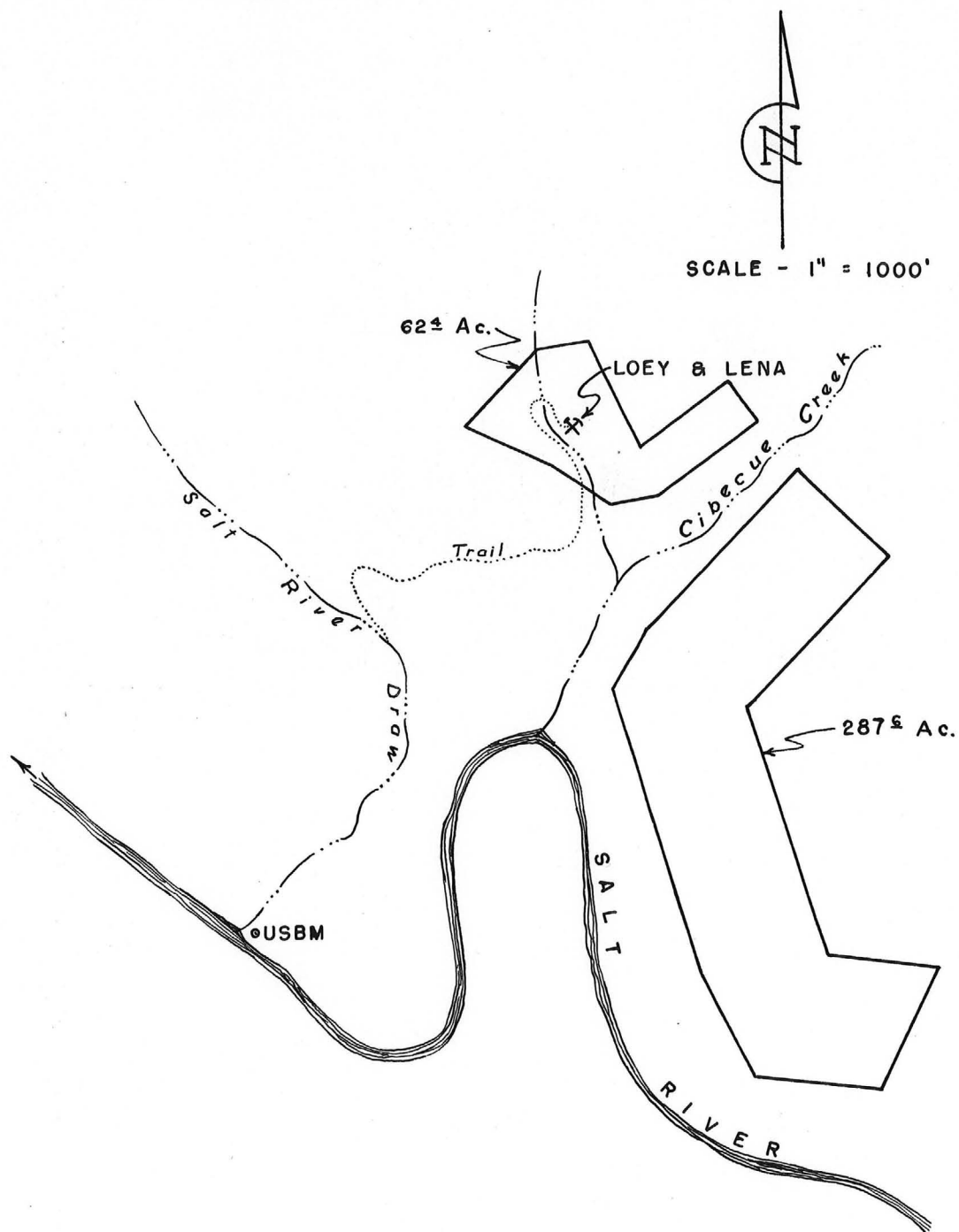

SECTIONS 4, 5, 8, 9 & 16  
 T. 5 N. R. 17 E.  
 UNSURVEYED  
 FORT APACHE INDIAN RESERVATION  
 COPIED FROM DOCKET MAP

DMEA 2865

FIGURE 2. - MAP OF LOEY & LENA NO. 2 LEASE

ADDITIONAL REFERENCES

See: ABM Bull. 126, p. ~~85~~<sup>65</sup> (Lorie & Lena Claim)

See: IC 7706, p. 47 (Loey & Lena Prospect)

See: MINERAL DEPOSITS OF THE FORT APACHE INDIAN RES.,  
ARIZONA by Richard T. Moore, Geologist. 1967.

*In Geology files.*

Now ABM Bul. 177

BLM Mining District Sheet 187

MILS Sheet sequence number 0040070464 (p. 1998)

FORT APACHE MINING CO.  
LOEY AND LENA PROSPECT

GILA COUNTY  
FORT APACHE INDIAN RESERVATION

The Loey and Lena property is situated on the Fort Apache Indian Reservation near its southern boundary, approximately 1 mile north of the junction of Cibecue Creek and Salt River. Bruce E. Swartout of McNary, Ariz., and Eugene V. Ethelbah are applicants for a lease of the 62-acre tract that contains the deposit. It can be reached via the Indian Service road that goes down the north bank of Salt River from near the bridge on U. S. Highway 60. At 6.2 miles from the highway, a 1.2 mile road goes up Salt River Draw to the old camp of the Apache mine. From this camp a 1-1/2-mile steep trail leads northward to the Loey and Lena workings, which are in approximate sec. 5, T. 5 N., R. 17 E., un~~sur~~veyed, at an altitude of about 4,300 feet.

#### HISTORY

The Loey and Lena claim was originally located by C. O. Reidhead before 1928. The deposit first was worked in 1928-29 and again intermittently from 1935 to 1940. Only a few tons of hand-cobbed fiber was produced during these periods by hand drilling. In 1943 a small mill was built near the mine. It consisted of a jaw crusher, rolls and screens, all small units. The mill never was put in operation and later was dismantled.

Bruce E. Swartout applied for a lease on the property in 1953.

#### GEOLOGIC SETTING

The deposit is situated at the bottom of a high cliff of massive algal limestone overlain by Troy quartzite. The outcrop of the deposit is confined to a length of about 200 feet. The principal asbestos-bearing serpentine zone is immediately under the base of the algal member. Locally, there is a second zone about 2 feet lower in the section.

A thick diabase sill underlies the deposit, but the contact is obscured by overburden. In a canyon about 100 feet west of the workings, the top of the sill is 25 feet below the algal base. Approximately 300 feet to the east, the diabase appears to have cut up discordantly to approximately the base of the algal member. Because of the talus slopes, the exact relation of the diabase-limestone contact cannot be seen.

The upper asbestos zone is 8 to 10 inches thick and contains traces to veins of asbestos totaling 1-1/2 inches in thickness. The lower zone, which contains asbestos only in a few places, includes asbestos veins totaling as much as 1/2 inch. The mineralized area has been opened by two 50 foot stopes averaging 20 to 25 feet wide and by 3 shallow cuts. Except for approximately 50 feet of the eastern end of the outcrop, where the asbestos is harsh, all fiber exposed is soft and of high tensile strength.

FORT APACHE MINING CO.  
LOEY AND LENA PROSPECT

GILA COUNTY  
FORT APACHE INDIAN RESERVATION

West of the workings, asbestos is present in the serpentine zone for 50 feet, beyond which only traces exist fairly strong sperpentinization.

The limestone bedding is horizontal and appears to have been but little disturbed by the diabase intrusion. A postmineral bedding-plane fault is present about 4 to 5 feet below the ore zone.

Taken from BUREAU OF MINES - I C 7706, pp 47 and 48

File: CDDD

April 3, 1944

Office of Price Administration  
War Price and Rationing Board 81.7.1  
Ellis Building  
Phoenix, Arizona

Gentlemen:

C. L. Allen, Box 1817, Phoenix, is operating the Ft. Apache Mining Co. property situated 50 miles north of Globe in the Salt River Mining District. His travel in this operation necessitates making three or four round trips per month. At present he is shipping asbestos to the Kyle Mill in Globe and is preparing to mill ore from this mine.

This travel is recommended as essential to the war effort.

Very truly yours,

George A. Ballam  
Assistant to the Director

GAB:JES



May 11, 1943

MEMORANDUM

Fort Apache Mining Company  
(Asbestos)

TO: Charles F. Willis            Attention of Miss Doyle

FROM: J. S. Coupal

Lois & Lena

Fort Apache Mining Company, Lois and Leaner lode, five claims asbestos located at the mouth of Cibique Creek and between Cibique and Salt Draw, Gila County. C. L. Allen, correspondent, 806 North Ninth Avenue, Box 1817, Phoenix; C. O. Redhead, 1601 East Washington; and J. D. Williams, 3958 South Central Avenue, are owners of the property--a three-way, equal partnership split.

Property developed by two 80 foot drifts on ore. They are making application for \$10,000 mine loan, awaiting road and market before getting into operation. The property is located just east and adjoining the Apache Asbestos Mines owned by Dr. A. J. McInyre, Luhrs Building, Phoenix.

c - Andrew Macfarlane