



CONTACT INFORMATION

Mining Records Curator
Arizona Geological Survey
1520 West Adams St.
Phoenix, AZ 85007
602-771-1601
<http://www.azgs.az.gov>
inquiries@azgs.az.gov

The following file is part of the

Arizona Department of Mines and Mineral Resources Mining Collection

ACCESS STATEMENT

These digitized collections are accessible for purposes of education and research. We have indicated what we know about copyright and rights of privacy, publicity, or trademark. Due to the nature of archival collections, we are not always able to identify this information. We are eager to hear from any rights owners, so that we may obtain accurate information. Upon request, we will remove material from public view while we address a rights issue.

CONSTRAINTS STATEMENT

The Arizona Geological Survey does not claim to control all rights for all materials in its collection. These rights include, but are not limited to: copyright, privacy rights, and cultural protection rights. The User hereby assumes all responsibility for obtaining any rights to use the material in excess of "fair use."

The Survey makes no intellectual property claims to the products created by individual authors in the manuscript collections, except when the author deeded those rights to the Survey or when those authors were employed by the State of Arizona and created intellectual products as a function of their official duties. The Survey does maintain property rights to the physical and digital representations of the works.

QUALITY STATEMENT

The Arizona Geological Survey is not responsible for the accuracy of the records, information, or opinions that may be contained in the files. The Survey collects, catalogs, and archives data on mineral properties regardless of its views of the veracity or accuracy of those data.

PRINTED: 11/08/2001

ARIZONA DEPARTMENT OF MINES AND MINERAL RESOURCES AZMILS DATA

PRIMARY NAME: KING COPPER GROUP

ALTERNATE NAMES:

HARRY HAWSER PROPERTY

GILA COUNTY MILS NUMBER: 90

LOCATION: TOWNSHIP 1 S RANGE 14 E SECTION 24 QUARTER SW

LATITUDE: N 33DEG 19MIN 40SEC LONGITUDE: W 110DEG 53MIN 30SEC

TOPO MAP NAME: PINAL RANCH - 7.5 MIN

CURRENT STATUS: PAST PRODUCER

COMMODITY:

COPPER

BIBLIOGRAPHY:

ADMMR KING COPPER GROUP FILE

Aug 28 1943

KING COPPER GROUP
Of 10 Unpatented Claims
Globe - Miami.

A. Macfarlane

Report after Investigation

The "King Copper Group" of ten unpatented claims is located in the Globe-Miami District about thirteen miles Southerly from the City of Miami on the North-easterly slope of the Pinal Mountains.

OWNERSHIP: Mr. Frank E. Carrow and Mr. M. P. Carrow of Globe, Arizona, by location of the claims and quiet claim given by previous owner. This group was known formerly as Harry Hawser Mine. *Transfer of 1/4 interest made in favor of John G. Russell of Globe, Arizona.*

ROADS: Connecting the mine to rail head at Miami and the bins of the International Smelter, seven miles paved Highway No. 70 to opposite Castle Dome Junction, thence Southeasterly five to six miles over county highway to Dr. Little's ranch, thence one mile over stub road to King Mine. This last mile should be repaired before starting to truck the ores.

MINE WORKINGS: Consists principally of a main tunnel about 450 feet from portal, thence Northwesterly to heading. At a point about 150 feet Northwest of tunnel portal a series of copper stringers were opened and drifted on for nearly 200 lineal feet along their Northwesterly course and this mineralization widened to over 20 feet by a brecciating of the vein gangue and its impregnation by copper bearing solutions and attendant deposition along the fractured course.

A main hanging wall pay streak varying from six inches to one foot wide, is persistent in its course and an important copper feeder for a mineralized body of about 160 feet in length along the Northwesterly course of said mineralization.

In this brecciated and mineralized area, two winzes were sunk, stated to depth of over fifty feet each below tunnel floor, the ore stringers seem to be stronger and more pronounced along the tunnel floor than ceiling and again some shallow stoping along tunnel floor is evident.

In short distance after cutting the above hanging wall lead other stringers with a North 21 degrees West course made up a distinct F. W. mineralization fully twenty feet North of the hanging wall, thus making the entire mineralized mass to have a width of more than twenty feet, the footwall yet not fully determined. A total of about 600 lineal feet of development has been made in this main tunnel and this footage has opened a body of copper 160 feet long by 20 feet wide to yet unknown depth and apparently this mineralization will carry an average copper content of 1.2% to 1.8% per ton.

MINERALIZATION: Of the King Claims is conformable to this entire area of Miami. The copper deposition found in a gangue of Pinal Schist often in contact with Quartzite, Diabase and Dacite flows.

Immediately south of King workings a body of surface Gossanized Quartzite is prominent, this in turn is ended against a monzonitic and Dacite mass covering most of the King ground.

KING COPPER GROUP
 Of 10 Unpatented Claims
 Globe - Miami

Report after Investigation
 Page two - Mineralization Continued

Between the Quartzite and Monzonite is a body of Pinal Schist, silicated by veinlets of Quartz, carrying copper mostly in the Azurite form and general copper carbonization.

In the seams are depositions of black Oxides and secondary glance, these occurrences enriching the gangue in close proximity to the veinlets.

This brecciation within certain zones of the King tunnel may have formed commercial sized ore bodies of 3% to 4.5% Cu., depending entirely on degree of brecciation, plus the presence of a definite pay streak with a general vein course along which the ores are laid down.

SAMPLING; Of the principal elements forming the apparent ore shoots and the assays thereof gives the following:

Sample No. 1. At a point where hanging wall pay streak is well defined one foot in tunnel back	Assays 9.64% cu.
Composite of six samples, no gold or silver	4.78
Sample No. 2. F.W.Stope general sample 4 feet wide	1.01
Sample No. 3, F.W.Stope, heading Northwest, 3 feet wide	3.18
Sample No. 4, H.W.of Winze No. 2, 2½ feet wide	1.77
Sample No. 5, F.W.of Winze No. 2 1½ feet wide	1.36
Sample No. 6, H.W.Pay Streak West of Winze 2/3 foot wide	11.72

Grade of ore stoppe width four feet, including a pay streak; assume:
 1 foot of 9% cu. per 1 foot equals 180 pounds cu.
 3 feet of 1.5% cu. 30 pounds x 3 feet equals 90 pounds cu.
 Divide 4 ft.) 270(67.5 pounds, divided by 20 equals 3.35% cu.
 as an average over a four foot width where a one foot is a pay streak of 9% cu.

AVAILABLE COPPER ORES: It is proposed to muck and repair No. 2 Winze to its full depth of fifty feet or more and to stoppe that block of ground as marked A - B on sketch maps, following the paystreak and enrichment thereof with a mining width of about four feet.

It is estimated 2,200 tons of about 3.5% cu. is below tunnel floor and another 1,000 tons of about the same grade above the tunnel back.

The attached smelter analysis sheet stated to be of a carlot of ore sold and mined from the area above the winzes shows 8.29% cu. No doubt this material was obtained largely from the fracture mineralization or enriched veinlets and lenses.

This valuation of 3½% cu. for a width of four feet may be lower than the ores to be actually produced by mining along the widest and enriched veinlet or stringer ore system; however, 3½% cu. is taken in this report as a minimum coper content of the ores to be mined and sold that will produce the largest tonnage of marketable ores from this mine. This proposed stoping is of ores limited to a width of four to five feet found within a much wider mineralized area.

KING COPPER GROUP
Of 10 Unpatented Claims
Globe - Miami

Report after Investigation
Page three - Available Copper Ores, Continued.

Former stoping along the back of the main tunnel was carried to fully twenty feet from hanging to footwall. Samples taken now of the mineralized body shows that the deposit gangue exclusive of the enriched veinlets contains from about one per cent to two per cent copper, while assays of the ore bands show values of eight per cent to twelve per cent copper.

The total mineralized area now as exposed by tunnel and the two winzes represents a body 160 feet along the strike of the fractures by twenty feet in width and assuming a depth of 100 feet gives a block of 320,000 cubic feet or about 21,333 tons of potential copper bearing material.

It is quite reasonable to assume this intensely fractured area will extend to depth and that the copper content may increase.

In the event the ore deposition as opened along the fifty foot level of Winze 2 is of fair copper content, then the short tunnel now sixty feet to heading and about 200 feet lower than the main tunnel should be advanced to explore the above potential copper body.

Daily output after the installation of a two drill compressor plant, should be about ten tons daily, this initial output should be attained within sixty days after beginning the plan of operation, as set forth.

During the past four months work of rehabilitating this mine has proceeded and the property has now installed a compressor, air fan, air & water lines for drilling, trackage from portal & tunnel dump to main counter shaft. Head frame above the counter shaft skids, ladders, small mine tools etc.

For accommodation of labor, 2 small houses and two trailer houses have been built & installed. It is now proposed to drift on the 55' level below the tunnel to block out & mine the ore of this area.

The Owners have taken additional samples of the pay streaks in order to guide them in the mining of such areas of the mineralization as will yield a smelter grade of ore. See sketch for tonnage and assays, tabulated as follows.

Tonnage and assays, tabulated as follows. (note insert assay) The road to mine has been improved and an ore bin built just below the tunnel, all to the end of copper production from this mine.

A. Macfarlane

ASSAY CERTIFICATE

Globe, Ariz., Aug 26, 1943

King Copper Co.

John G. Russell

Sample No.	Owner's Mark on Sample		GOLD		SILVER		TOTAL VALUE PER TON	PERCENTAGE OF				
			OZS. PER TON	VALUE PER TON	OZS. PER TON	VALUE PER TON		COP'R	IRON	TIN	LEAD	
<i>On Map</i> 7	<i>101</i>	—	—	—	—	—	—	11.76				
8	<i>102</i>	—	—	—	—	—	—	6.52				
9	<i>103</i>	—	—	—	—	—	—	22.58				
10	<i>104</i>	—	—	—	—	—	—	9.39				
11	<i>105</i>	—	—	—	—	—	—	1.33				
12	<i>106</i>	—	—	—	—	—	—	4.94				

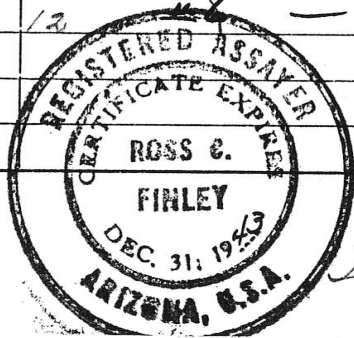

Ross C. Finley

Assayer

Insert the tabulation of this tin report and.

DEPARTMENT OF MINERAL RESOURCES
STATE OF ARIZONA
FIELD ENGINEERS REPORT

Mine KING COPPER GROUP

Date August 28, 1943

District Globe-Miami

Engineer A. Macfarlane

Subject: REPORT AFTER INVESTIGATION

The "King Copper Group" of ten unpatented claims is located in the Globe-Miami District about thirteen miles Southerly from the City of Miami on the northeasterly slope of the Pinal Mountains.

OWNERSHIP: Mr. Frank E. Carrow and Mr. M. P. Carrow of Globe, Arizona, by location of the claims and quiet claim given by previous owner. This group was known formerly as Harry Hawser Mine. Transfer of 1/4 interest made in favor of John G. Russell of Globe, Arizona.

ROADS: Connecting the mine to rail head at Miami and the bins of the International Smelter, seven miles paved Highway No. 70 to opposite Castle Dome Junction, thence Southeasterly five to six miles over county highway to Dr. Little's ranch, thence one mile over stub road to King Mine. This last mile should be repaired before starting to truck the ores.

MINE WORKINGS: Consists principally of a main tunnel about 450 feet from portal, thence Northwesterly to heading. At a point about 150 feet northwest of tunnel portal a series of copper stringers were opened and drifted on for nearly 200 lineal feet along their northwesterly course and this mineralization widened to over 20 feet by a brecciating of the vein gangue and its impregnation by copper bearing solutions and attendant deposition along the fractured course.

A main hanging wall pay streak varying from six inches to one foot wide, is persistent in its course and an important copper feeder for a mineralized body of about 160 feet in length along the northwesterly course of said mineralization.

In this brecciated and mineralized area, two winzes were sunk, stated to depth of over fifty feet each below tunnel floor, the ore stringers seem to be stronger and more pronounced along the tunnel floor than ceiling and again some shallow stoping along tunnel floor is evident.

In short distance after cutting the above hanging wall lead other stringers with a North 21° west course made up a distinct F. W. mineralization fully twenty feet north of the hanging wall, thus making the entire mineralized mass to have a width of more than twenty feet, the footwall yet not fully determined. A total of about 600 lineal feet of development has been made in this main tunnel and this footage has opened a body of copper 160 feet long by 20 feet wide to yet unknown depth and apparently this mineralization will carry an average copper content of 1.2% to 1.8% per ton.

MINERALIZATION Of the King Claims is conformable to this entire area of Miami. The copper deposition found in agangue of Pinal schist often in contact with Quartzite, Diabase and Dacite flows.

Immediately south of King workings a body of surface Gossanized Quartzite is prominent, this in turn is ended against a monzonitic and Dacite mass covering most of the King ground.

Between the Quartzite and Monzonite is a body of Pinal Schist, silicated by veinlets of Quartz, carrying copper mostly in the Azurite form and general copper carbonization.

In the seams are depositions of black Oxides and secondary glance, these occurrences enriching the gangue in close proximity to the veinlets.

This brecciation within certain zones of the King tunnel may have formed commercial sized ore bodies of 3% to 4.5% cu., depending entirely on degree of brecciation, plus the presence of a definite pay streak with a general vein course along which the ores are laid down.

SAMPLING: Of the principal elements forming the apparent ore shoots and the assays thereof gives the following.

	Assays
Sample No. 1. At the point where hanging wall pay streak is well defined one foot in tunnel back	9.64% cu.
Composite of six samples, no gold or silver	4.78
Sample No. 2. F. W. Stope general sample 4 feet wide	1.01
Sample No. 3. F. W. Stope heading Northwest, 3 feet wide	3.18
Sample No. 4. H. W. of Winze No. 2, 2½ ft. wide	1.77
Sample No. 5. F. W. of Winze No. 2, 1½ ft. wide	1.36
Sample No. 6. H. W. Pay Streak West of Winze 2/3 foot wide	11.72

Grade of ore stope width four feet, including a pay streak; assume:

1 foot of 9% cu. per 1 foot equals 180 pounds cu.

3 feet of 1.5% cu. 30 pounds x 3 feet equals 90 pounds cu.

Divide 4 ft.) 270 (67.5 pounds, divided by 20 equals 3.35% cu.
as an average over a four foot width where a one foot is a pay streak of 9% cu.

AVAILABLE COPPER ORES: It is proposed to muck and repair No. 2 Winze to its full depth of fifty feet or more and to stope that block of ground as marked A - B on sketch maps, following the paystreak and enrichment thereof with a mining width of about four feet.

It is estimated 2,200 tons of about 3.5% cu. is below tunnel floor and another 1,000 tons of about the same grade above the tunnel back.

The attached smelter analysis sheet stated to be of a carlot of ore sold and mined from the area above the winzes shows 8.29% cu. No doubt this material was obtained largely from the fracture mineralization or enriched veinlets and lenzes.

This valuation of 3½% cu. for a width of four feet may be lower than the ores to be actually produced by mining along the widest and enriched veinlet or stringer ore system; however, 3½ cu. is taken in this report as a minimum copper content of the ores to be mined and sold that will produce the largest tonnage of marketable ores from this mine. This proposed stoping is of ores limited to a width of four to five feet found within a much wider mineralized area.

Former stoping along the back of the main tunnel was carried to fully twenty feet from hanging to footwall. Samples taken now of the mineralized body shows that the deposit gangue exclusive of the enriched veinlets contains from about one per cent to two per cent copper, while assays of the ore bands show values of eight per cent to twelve per cent copper.

The total mineralized area now as exposed by tunnel and the two winzes represents a body 160 feet along the strike of the fractures by twenty feet in width and assuming a depth of 100 feet gives a block of 320,000 cubic feet or about 21,333 tons of potential

copper bearing material.

It is quite reasonable to assume this intensely fractured area will extend to depth and that copper content may increase.

In the event the ore deposition as opened along the fifty foot level of Winze 2 is of fair copper content, then the short tunnel now sixty feet to heading and about 200 feet lower than the main tunnel should be advanced to explore the above potential copper body.

Daily output after the installation of a two drill compressor plant, should be about ten tons, this initial output should be attained within sixty days after beginning the plan of operation as set forth.

During the past four months work of rehabilitating this mine has proceeded and the property has now installed a compressor, air fan, air and water lines for drilling, trackage from portal and tunnel dump to main counter shaft, head frame above the counter shaft, skids, ladders, small mine tools, etc.

For accomodation of labor, two small houses and two trailer houses have been built and installed.

It is now proposed to drift on the 55' level below the tunnel to block out and mine the ores of this area.

The owners have taken additional samples of the pay streaks in order to guide them in the mining of such areas of the mineralization as will yield a smelter grade of ore. See sketch for tonnage and assays, tabulated as follows.

On map 7.....	11.76%
" " 8.....	6.52%
" " 9.....	22.58%
" " 10.....	9.39%
" " 11.....	1.33%
" " 12.....	4.94%

The road to mine has been improved and an ore bin built just below the tunnel, all to the end of copper production from this mine.

A. Macfarlane
Field Engineer

DEPARTMENT OF MINERAL RESOURCES
STATE OF ARIZONA
FIELD ENGINEERS REPORT

Mine KING COPPER, Cu.

Date April 6, 1943

District Globe-Miami

Engineer Earl F. Hastings

Subject: Reconstruction Finance Corporation
Mine Loan

Docket No.

Phx C-175

Date Application Received

April 2, 1943

Date of Field Examination

March 26, 1943

Date of Report

April 5, 1943

1. Name and address of applicant (correspondent):

Jack G. Russell, Box 1433, Globe, Arizona.

2. Character of project and estimated cost thereof:

Copper. To reopen and rehabilitate main tunnel level and #2 winze; to drift on ore from winze bottom, stope ore from above tunnel and from new drift.

3. Location of property:

Globe-Miami Mining District, Sec. 24, T 1 S, R 14 E, Gila County, Arizona.

4. Applicant's interest in or ownership of property:

A limited partnership of which applicant holds a one-fourth interest.

5. Loan requested:

\$5,000.00.

6. Loan recommended:

\$5,000.00.

7. Comments:

(A) Added to the docket is the report including maps by A. Macfarlane, Field Engineer, Department of Mineral Resources, dated March 26, 1943.

(B) The above report indicates a possible production of 3,200 tons of 3.5% copper ore along a 160-foot shoot to the depth of the present workings. This tonnage can be materially increased by wider stoping with a resultant lower grade product. The Macfarlane report is brief and descriptive; it is therefore unnecessary to review the points contained therein.

(C) On the basis of this report, coupled with the favorable geological and geographical conditions to be found, this loan is recommended.

ARIZONA DEPARTMENT OF MINERAL RESOURCES

Earl F. Hastings, Projects Engineer

DEPARTMENT OF MINERAL RESOURCES
STATE OF ARIZONA
FIELD ENGINEERS REPORT

Mine KING COPPER GROUP
Of 10 Unpatented Claims
District Globe - Miami

Date March 26, 1943

Engineer A. Macfarlane

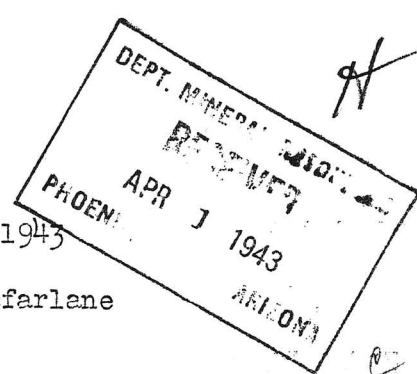

Subject: Report after Investigation

The "King Copper Group" of ten unpatented claims is located in the Globe - Miami District about thirteen miles Southerly from the City of Miami on the North-easterly slope of the Pinal Mountains.

OWNERSHIP: Mr. Frank E. Carrow and Mr. M. P. Carrow of Globe, Arizona, by location of the claims and quit claim given by previous owner. This group was known formerly as Harry Hawser Mine.

ROADS: Connecting the mine to rail head at Miami and the bins of the International Smelter, seven miles paved highway No. 70 to opposite Castle Dome Junction, thence Southeasterly five to six miles over county highway to Dr. Little's ranch, thence one mile over stub road to King Mine, this last mile should be repaired before starting to truck the ores.

MINE WORKINGS: Consists principally of a main tunnel about 450 Feet from portal, thence Northwesterly to heading. At a point about 150 Feet Northwest of tunnel portal a series of copper stringers were opened and drifted on for nearly 200 lineal feet along their Northwesterly course and this mineralization widened to over 20 feet by a brecciating of the vein gangue and its impregnation by copper bearing solutions and attendant deposition along the fractured course.

A main hanging wall pay streak varying from six inches to one foot wide, is persistent in its course and an important copper feeder for a mineralized body of about 160 feet in length along the Northwesterly course of said mineralization.

In this brecciated and mineralized area, two winzes were sunk, stated to depth of over fifty feet each, below tunnel floor, the ore stringers seem to be stronger and more pronounced along the tunnel floor than ceiling and again some shallow stoping along tunnel floor is evident.

In short distance after cutting the above hanging wall lead other stringers with a North 21 degrees West course made up a distinct F.W. mineralization fully twenty feet North of the hanging wall, thus making the entire mineralized mass to have a width of more than twenty feet, the footwall yet not fully determined. A total of about 600 lineal feet of development has been made in this main tunnel and this footage has opened a body of copper 160 feet long by 20 feet wide to yet unknown depth and apparently this mineralization will carry an average copper content of 1.2% to 1.8% per ton.

MINERALIZATION: Of the King Claims is conformable to this entire area of Miami. The copper deposition found in a gangue of Pinal Schist often in contact with Quartzite, Diabase and Dacite flows.

Immediately south of King workings a body of surface Gossanized Quartzite is prominent, this in turn is ended against a monzonitic and Dacite mass covering most of the King ground.

DEPARTMENT OF MINERAL RESOURCES
STATE OF ARIZONA
FIELD ENGINEERS REPORT

Mine KING COPPER GROUP
 Of 10 Unpatented Claims
 District Globe - Miami

Date
 Engineer

Subject: Report after Investigation
 Page two - Mineralization Continued

Between the Quartzite and Monzonite is a body of Pinal Schist, silicated by veinlets of Quartz, carrying copper mostly in the Azurite form and general copper carbonization.

In the seams are depositions of black Oxides and secondary glance, these occurrences enriching the gangue in close proximity to the veinlets.

This brecciation within certain zones of the King tunnel may have formed commercial sized ore bodies of 3% to 4.5% cu., depending entirely on degree of brecciation, plus the presence of a definite pay streak with a general vein course along which the ores are laid down.

SAMPLING: Of the principal elements forming the apparent ore shoots and the assays thereof gives the following:

	Assays
Sample No. 1. At a point where hanging wall pay streak is well defined one foot in tunnel back	9.64 cu. %
Composite of six samples, no gold or silver	4.78
Sample No. 2. F. W. Stope general sample 4 feet wide	1.01
Sample No. 3. F. W. Stope, heading Northwest, 3 feet wide	3.18
Sample No. 4. H. W. of Winze No. 2, $2\frac{1}{2}$ feet wide	1.77
Sample No. 5. F. W. of Winze No. 2 $1\frac{1}{2}$ feet wide	1.36
Sample No. 6. H. W. Pay Streak West of Winze $2/3$ foot wide	11.72

Grade of ore stope width four feet, including a pay streak; assume:

- 1 foot of 9% cu. per 1 foot equals 180 pounds cu.
- 3 feet of 1.5% cu. 30 pounds x 3 feet equals 90 pounds cu.
- Divide 4 ft. $\times 270$ (67.5 pounds, divided by 20 equals 3.35% cu. as an average over a four foot width where a one foot is a pay streak of 9% cu.

AVAILABLE COPPER ORES: It is proposed to muck and repair No. 2 Winze to its full depth of fifty feet or more and to stope that block of ground as marked A - B on sketch maps, following the paystreak and enrichments thereof with a mining width of about four feet.

It is estimated 2,200 tons of about 3.5% cu. is below tunnel floor and another 1,000 tons of about the same grade above the tunnel back.

The attached smelter analysis sheet stated to be of a carlot of ore sold and mined from the area above the winzes shows 8.29% cu. No doubt this material was obtained largely from the fracture mineralization or enriched veinlets and lenses.

This valuation of $3\frac{1}{2}\%$ cu. for a width of four feet may be lower than the ores to be actually produced by mining along the widest and enriched veinlet or stringer ore system; however, $3\frac{1}{2}\%$ cu. is taken in this report as a minimum copper content of the ores to be mined and sold that will produce the largest tonnage of marketable ores from this mine. This proposed stoping is of ores limited to a width of four to five feet found within a much wider mineralized area.

DEPARTMENT OF MINERAL RESOURCES
STATE OF ARIZONA
FIELD ENGINEERS REPORT

Mine KING COPPER GROUP
Of 10 Unpatented Claims
District Globe - Miami

Date

Engineer

Subject: Report after Investigation
Page three - Available Copper Ores, Continued

Former stoping along the back of the main tunnel was carried to fully twenty feet from hanging to footwall. Samples taken now of the mineralized body shows that the deposit gangue exclusive of the enriched veinlets contains from about one percent to two percent copper, while assays of the ore bands show values of eight percent to twelve percent copper.

The total mineralized area now as exposed by tunnel and the two winzes represents a body 160 feet along the strike of the fractures by twenty feet in width and assuming a depth of 100 feet gives a block of 320,000 cubic feet or about 21,333 tons of potential copper bearing material.

It is quite reasonable to assume this intensely fractured area will extend to depth and that the copper content may increase.

In the event the ore deposition as opened along the fifty foot level of Winze 2 is of fair copper content, then the short tunnel now sixty feet to heading and about 200 feet lower than the main tunnel should be advanced to explore the above potential copper body.

Daily output after the instalation of a two drill compressor plant, should be about ten tons daily, this initial output should be attained within sixty days after beginning the plan of operation.

DEPARTMENT OF MINERAL RESOURCES
 STATE OF ARIZONA
 419 HOME BUILDERS BUILDING
 128 N. 1ST AVENUE
 PHOENIX, ARIZONA

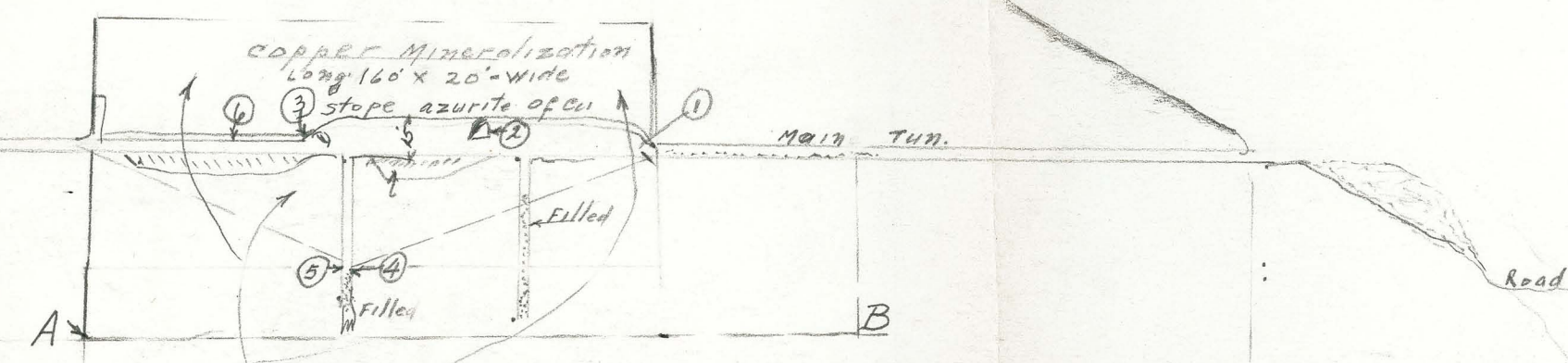

Proposed to stop: Long. Sec. King Mine
 $160' \times 50' \times 4' = 3200$ tons @ 3.5% average = 5.73 Smelter value
 ore above Tun. 3.32 Premium "
 back 1000 " " 3.5% cu 9.05 Total
 Total Tons 3200 available @ 9.05 = 28,960.00

Smelting and Trucking Costs @ 4.75 x 3200 = 15,200
 To cover Mining loan 13,760.

Notes of Field Engr. Dept. of Mineral Resources
 March 30 1943 Globe Arizona.

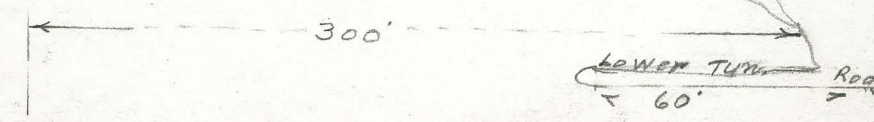

300' back

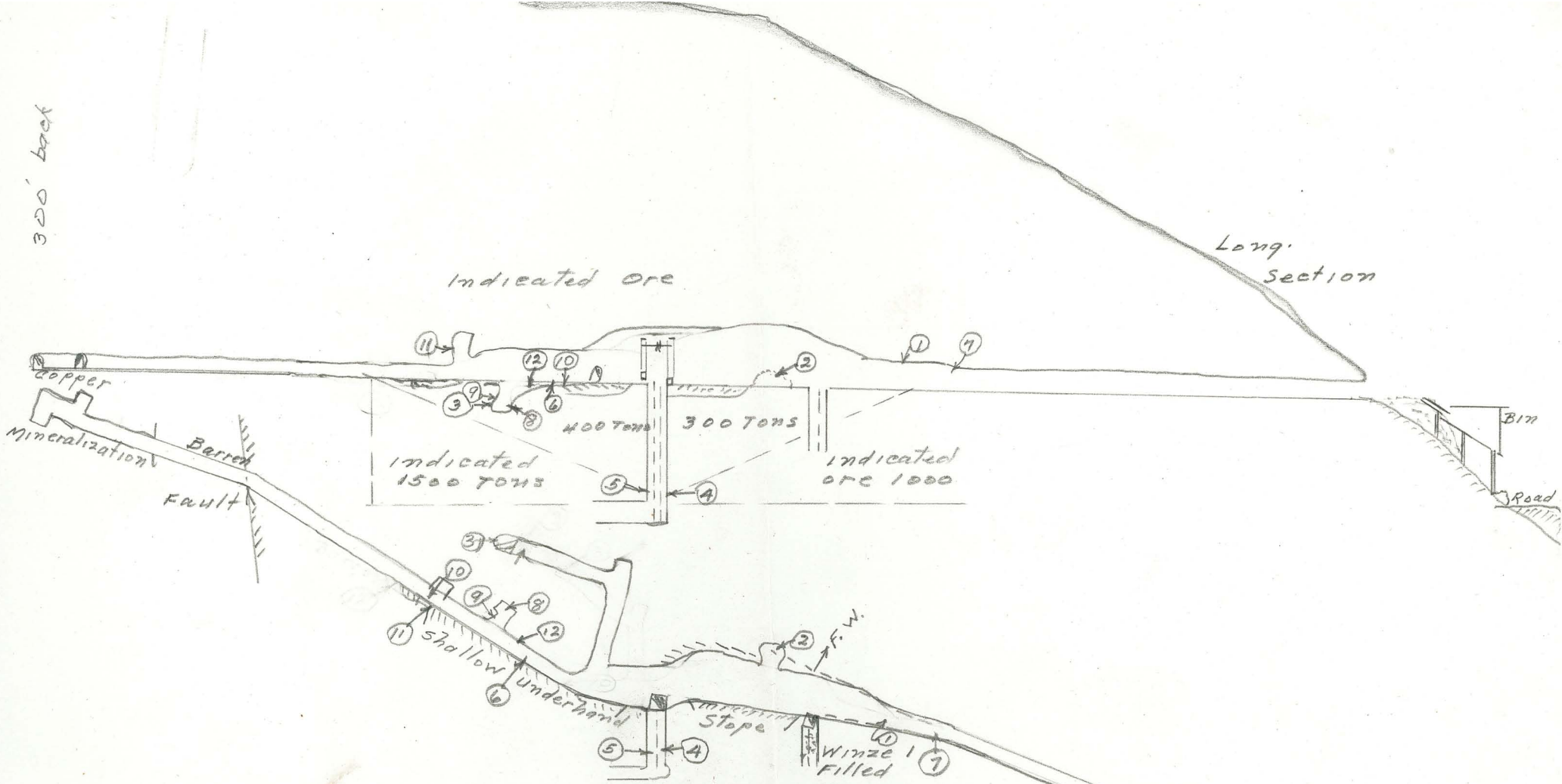

Sketch Plan & Section

KING COPPER MINE

Globe - Miami District

Gila County, Arizona Owners -

- Carrow Bros. And J.G. Russell

Globe, Arizona. Scale 1" TO 50 FT

August 28th 1943 Notes Of

Mineral Resources Dept

A. Macfarlane Field Engr.

Nos	Ag	Cu %	List	Width	Place
1		9.64	12"		Tun back
2		1.01	48"		F.W. of Wide Stope
3		3.18	36"		W. end F.W. Drift
4		1.77	30"		N.W. of winze
5		1.36	18"		F.W.
6		11.72	9"		pay streak Tun back
7		11.76	12"		"
8		6.52	14"		winze in F.W.
9		22.58	9"		" pay streak
10		9.39	14"		pay streak Tun back
11		1.33	48"		N.W. VEIN
12		4.94	30"		N.W. "

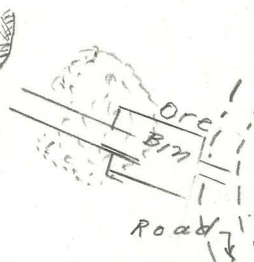

DEPARTMENT OF MINERAL RESOURCES
 STATE OF ARIZONA
 413 HOME BUILDERS BUILDING
 128 N. 1ST AVENUE
 PHOENIX, ARIZONA

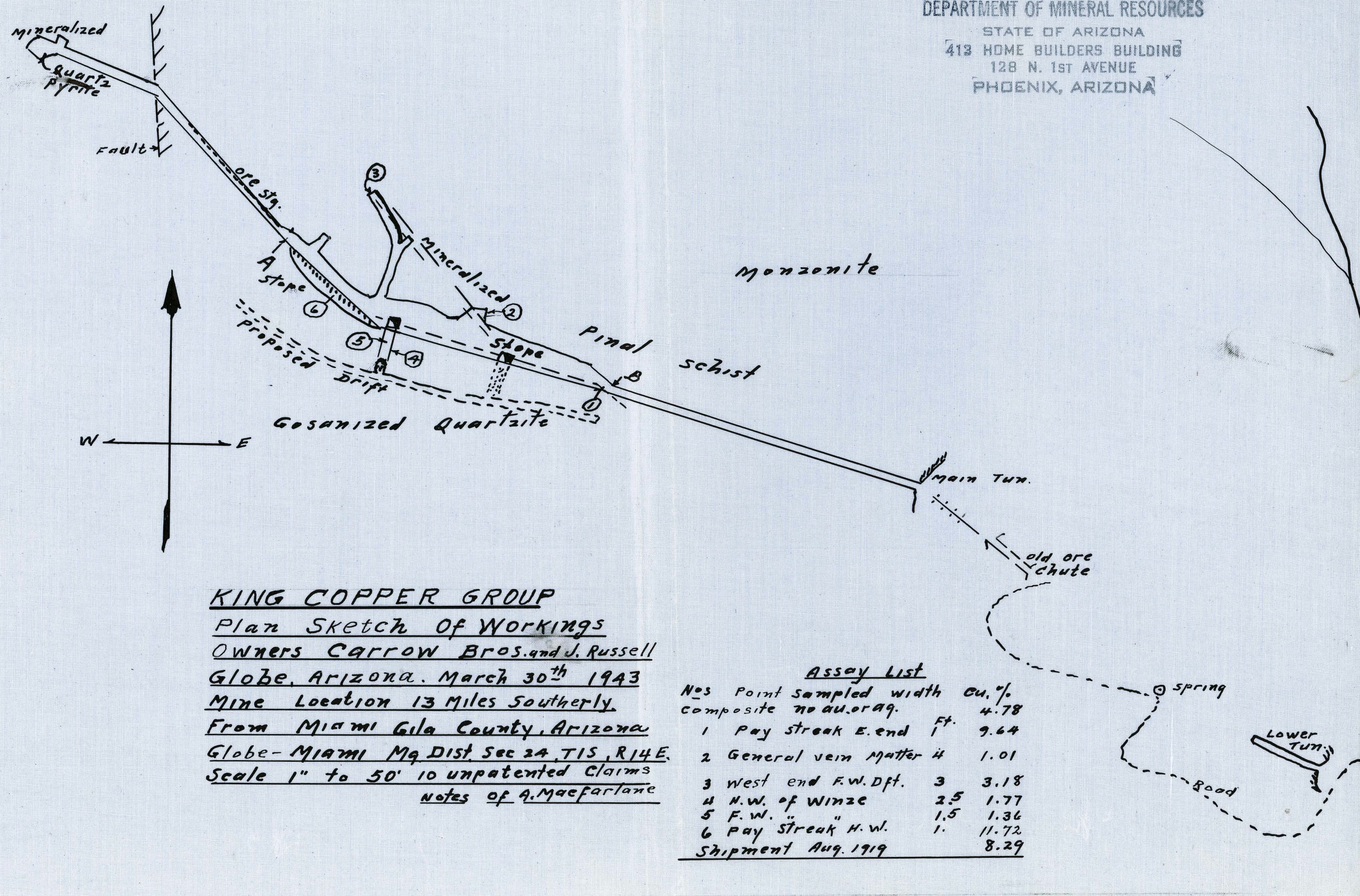

KING COPPER GROUP

Plan Sketch of Workings

Owners Carrow Bros. and J. Russell

Globe, Arizona. March 30th 1943

Mine Location 13 Miles Southerly.

From Miami Gila County, Arizona

Globe-Miami M₉ Dist. Sec 24, T15, R14E.

Scale 1" to 50' 10 unpatented Claims

Notes of A. Macfarlane

Assay List

Nos	Point Sampled	width	cu. %
	composite	no au. or ag.	4.78
1	Pay streak E. end	1 Ft.	9.64
2	General vein matter	4	1.01
3	West end F.W. Dft.	3	3.18
4	H.W. of Winze	2.5	1.77
5	F.W. "	1.5	1.36
6	Pay streak " H.W.	1.	11.72
	Shipment Aug. 1919		8.29