



CONTACT INFORMATION

Mining Records Curator
Arizona Geological Survey
1520 West Adams St.
Phoenix, AZ 85007
602-771-1601
<http://www.azgs.az.gov>
inquiries@azgs.az.gov

The following file is part of the

Arizona Department of Mines and Mineral Resources Mining Collection

ACCESS STATEMENT

These digitized collections are accessible for purposes of education and research. We have indicated what we know about copyright and rights of privacy, publicity, or trademark. Due to the nature of archival collections, we are not always able to identify this information. We are eager to hear from any rights owners, so that we may obtain accurate information. Upon request, we will remove material from public view while we address a rights issue.

CONSTRAINTS STATEMENT

The Arizona Geological Survey does not claim to control all rights for all materials in its collection. These rights include, but are not limited to: copyright, privacy rights, and cultural protection rights. The User hereby assumes all responsibility for obtaining any rights to use the material in excess of "fair use."

The Survey makes no intellectual property claims to the products created by individual authors in the manuscript collections, except when the author deeded those rights to the Survey or when those authors were employed by the State of Arizona and created intellectual products as a function of their official duties. The Survey does maintain property rights to the physical and digital representations of the works.

QUALITY STATEMENT

The Arizona Geological Survey is not responsible for the accuracy of the records, information, or opinions that may be contained in the files. The Survey collects, catalogs, and archives data on mineral properties regardless of its views of the veracity or accuracy of those data.

02/09/94

ARIZONA DEPARTMENT OF MINES AND MINERAL RESOURCES FILE DATA

PRIMARY NAME: KEYSTONE

ALTERNATE NAMES:

ROADRUNNER PROSPECTORS 23

PINAL COUNTY MILS NUMBER: 766

LOCATION: TOWNSHIP 5 S RANGE 15 E SECTION 4 QUARTER W2
LATITUDE: N 33DEG 01MIN 30SEC LONGITUDE: W 110DEG 49MIN 16SEC
TOPO MAP NAME: HAYDEN - 7.5 MIN

CURRENT STATUS: PRODUCER

COMMODITY:

GOLD PLACER

BIBLIOGRAPHY:

ADMMR KEYSTONE FILE
CLAIMS EXTEND INTO SE, SEC. 33, T4S R15E

ROADRUNNER PROSPECTORS' CLUB, INC.



MAP NUMBER

23

QUADRANGLE

Hayden

CLAIM NAMES AND TOPO MAP REFERENCE NUMBERS

KEYSTONE #1 THROUGH #18

SECTION 33 AND SECTION 4, 4S-15E, 5S-15E

Altitude 2200'

GENERAL DIRECTIONS/LOCATION

FROM SUPERIOR TURN S.E. ON HIGHWAY 177 TOWARD HAYDEN, (S.E. DIRECTION) APPROXIMATELY 27 MILES. AT MILE POST 140 + 150', MAKE LEFT TURN ON TO DIRT ROAD JUST BEFORE BRIDGE. APPROXIMATELY 1/10 MILE TO GATE. PLEASE KEEP GATE CLOSED. FROM GATE TO SOUTH BOUNDARY OF CLAIMS IS APPROXIMATELY 1/2 MILE.

PROSPECTING INFORMATION

ROADS: GOOD TO ROUGH IN SPOTS.

VEHICLE: HIGH CLEARANCE, PASSENGER CAR ACCESS TO SOME AREAS.

CAMPING: MANY AREAS, LIMITED FIRE WOOD.

METHODS: DRY WASHING, VACUUM METHODS.

MISC: EXTREMELY HOT DURING SUMMER MONTHS.

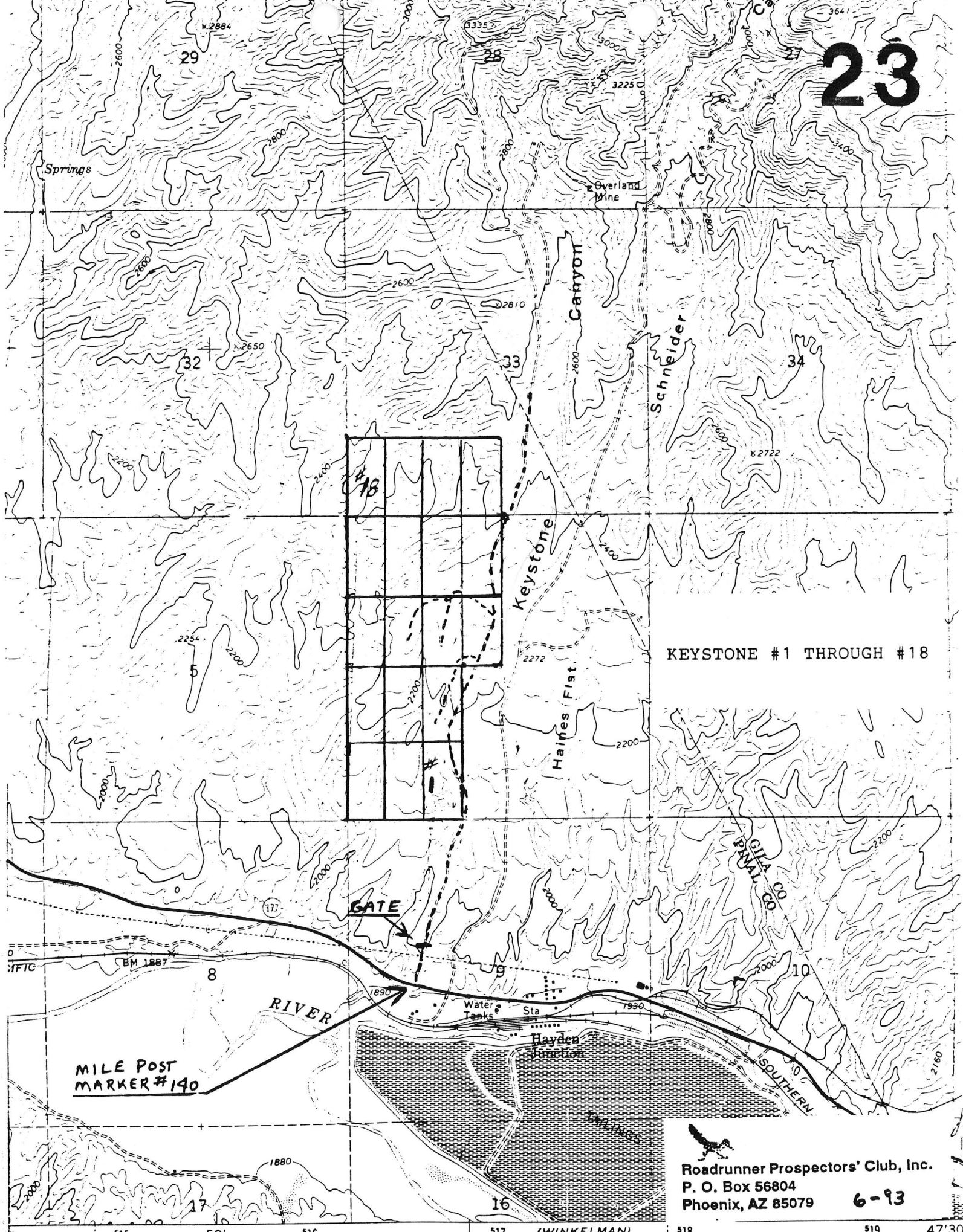

KEYSTONE #1 THROUGH #18

MILE POST MARKER #140

Roadrunner Prospectors' Club, Inc.
P. O. Box 56804
Phoenix, AZ 85079

6-93