



CONTACT INFORMATION

Mining Records Curator
Arizona Geological Survey
1520 West Adams St.
Phoenix, AZ 85007
602-771-1601
<http://www.azgs.az.gov>
inquiries@azgs.az.gov

The following file is part of the

Arizona Department of Mines and Mineral Resources Mining Collection

ACCESS STATEMENT

These digitized collections are accessible for purposes of education and research. We have indicated what we know about copyright and rights of privacy, publicity, or trademark. Due to the nature of archival collections, we are not always able to identify this information. We are eager to hear from any rights owners, so that we may obtain accurate information. Upon request, we will remove material from public view while we address a rights issue.

CONSTRAINTS STATEMENT

The Arizona Geological Survey does not claim to control all rights for all materials in its collection. These rights include, but are not limited to: copyright, privacy rights, and cultural protection rights. The User hereby assumes all responsibility for obtaining any rights to use the material in excess of "fair use."

The Survey makes no intellectual property claims to the products created by individual authors in the manuscript collections, except when the author deeded those rights to the Survey or when those authors were employed by the State of Arizona and created intellectual products as a function of their official duties. The Survey does maintain property rights to the physical and digital representations of the works.

QUALITY STATEMENT

The Arizona Geological Survey is not responsible for the accuracy of the records, information, or opinions that may be contained in the files. The Survey collects, catalogs, and archives data on mineral properties regardless of its views of the veracity or accuracy of those data.

PRINTED: 06-14-2006

ARIZONA DEPARTMENT OF MINES AND MINERAL RESOURCES AZMILS DATA

PRIMARY NAME: HARTMAN

ALTERNATE NAMES:
KLONDIKE

YAVAPAI COUNTY MILS NUMBER: 425

LOCATION: TOWNSHIP 10 N RANGE 5 W SECTION 16 QUARTER SW
LATITUDE: N 34DEG 12MIN 12SEC LONGITUDE: W 112DEG 46MIN 59SEC
TOPO MAP NAME: CONGRESS - 7.5 MIN

CURRENT STATUS: EXP PROSPECT

COMMODITY:
GOLD
SILVER
LEAD

BIBLIOGRAPHY:
USGS CONGRESS QUAD
ADMMR GEOLOGY FILE E.A. STONE & T.H. KUHN
SMALLER MINES AND PROSPECTS NEAR CONGRESS
1945 P 5
ADMMR KLONDIKE MINE FILE

N
ALVARO

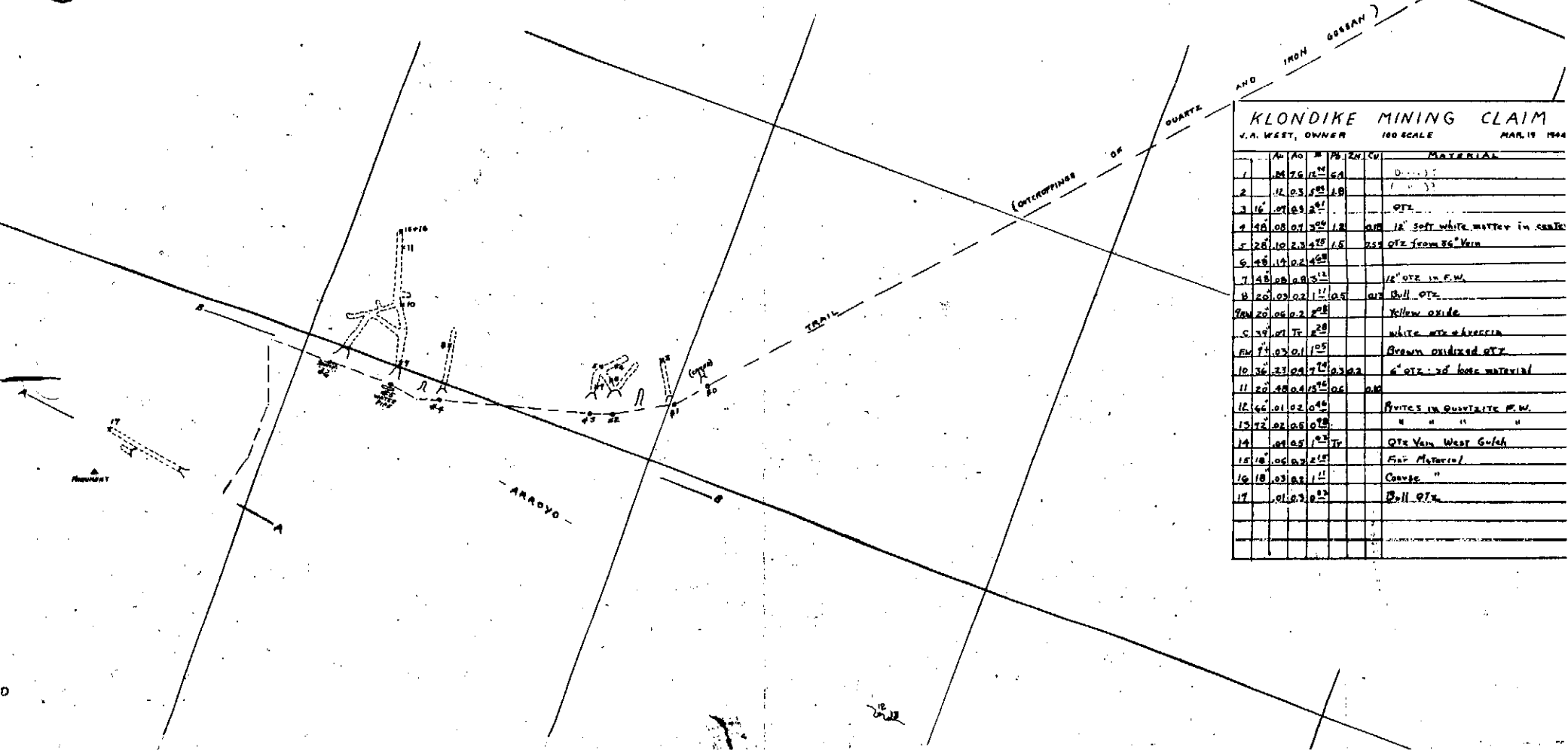
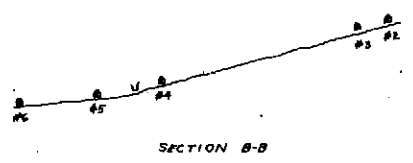
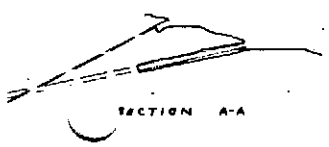

KLONDIKE MINING CLAIM
 J.A. WEST, OWNER 100 SCALE MAR. 19 1904

	Fe	Cu	Ag	Si	Other	MATERIAL
1	.04	.76	.12	.08		D...
2	.12	.03	.03	.19		" "
3	.07	.03	.01			QZ
4	.08	.07	.01	.12		12" soft white matter in cracks
5	.10	.23	.01	.15		QZ from 26" vein
6	.19	.02	.01			
7	.08	.08	.01			12" QZ in F.W.
8	.03	.02	.01	.05		QZ Bull QZ
9	.06	.02	.01			Yellow oxide
10	.07	.01	.01			white etc. shalvein
11	.03	.01	.01			Brown oxidized QZ
12	.23	.04	.01	.03	.02	6" QZ - 20' long interval
13	.48	.04	.01	.06		QZ
14	.01	.02	.01			FRITES IN QUARTZITE F.W.
15	.02	.01	.01			" " " "
16	.05	.01	.01			QZ vein West Gulch
17	.06	.03	.01			Flat Material
18	.03	.03	.01			Course "
19	.03	.01	.01			Bull QZ

J. ANDREW WEST

ATTORNEY-AT-LAW

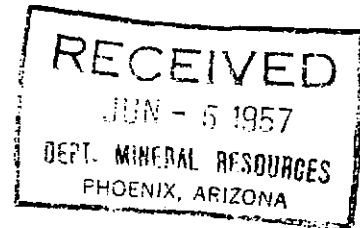
5070 HOLDEN AVENUE
ARLINGTON, CALIFORNIAJune-Three
1 9 5 7.DEPARTMENT OF MINERAL RESOURCES
PHOENIX, ARIZONA

Gentlemen:

I have two promising gold properties in Yavapai County, and with conditions as they are an operator should be able to make money.

NO. I.

KLONDIKE: Located in U.S. Highway 89 about two miles easterly from the Congress Mine and adjoining the Alvarado on the east are eight lode and one placer claim. Work done to date include a shaft or tunnel as the vein is fairly flat. The work is in about 300 feet. At this point there is a fault and the ore there assays about one ounce in gold. The behavior of the ore is identical with the Congress. It stands to reason that in another hundred feet the value of the ore will increase very much. It happens the property is under a tall mountain and so protected that citrus could grow on the placer claim. The tunnel produces water and there is a boxed canyon nearby where the water could be stored. Furthermore the summer rains would overflow the dam. The water could be piped by gravity to the citrus. The price of this property is \$150,000, or to the right operator would contract on purely a royalty basis.

NO. II.

On the Santa Marie River about thirty miles west of Congress I have about thirty lode claims and over 400 acres of placers, covering the ancient River bed. The ore is a readdy quartz and the ore is free-milling. It is known to be free to the 500 level at least. On a patented claim on the south a tunnel was driven from the River and the tunnel is 500 feet lower than the workings on top of the mountain. The ore in the tunnel is free-milling. There is water. Would let go the three groups of lodes and the placers for \$250,000. or to the right operator would contract on a royalty basis. This property is excellent for a operator would like to farm out a group or two to his friends and develop a group for himself. The climate is ideal. During the hottest part of the summer a cool breeze comes up the River and makes sleeping perfect. This property is less than five miles westerly from the Phoenix-Kingman Highway. As to the road: In completing the road in doing the annual labor to July 1, 1958 I surrounded one or two sand beds. In a days time two more sand beds could be surrounded by skirting a low range of mountains.

Respectfully yours,

J. ANDREW WEST

JAW-emw
Copy to Chas Willis

STATE OF ARIZONA
DEPARTMENT OF MINERAL RESOURCES
MINERAL BUILDING, FAIRGROUNDS
PHOENIX, ARIZONA



June 6, 1957

Mr. J. Andrew West
5070 Holden Avenue
Arlington, California

Dear Mr. West:

The enclosed letter describes the function of this Department with respect to buyers and sellers of properties.

If you will give us the names of your Yavapai County properties we will place them in our file of properties for sale. We enclose Mine Owner's Report blanks for your convenience in the matter.

Yours very truly,

FRANK P. KNIGHT,
Director.

Encs.

FK:lp

C
O
P
Y

15

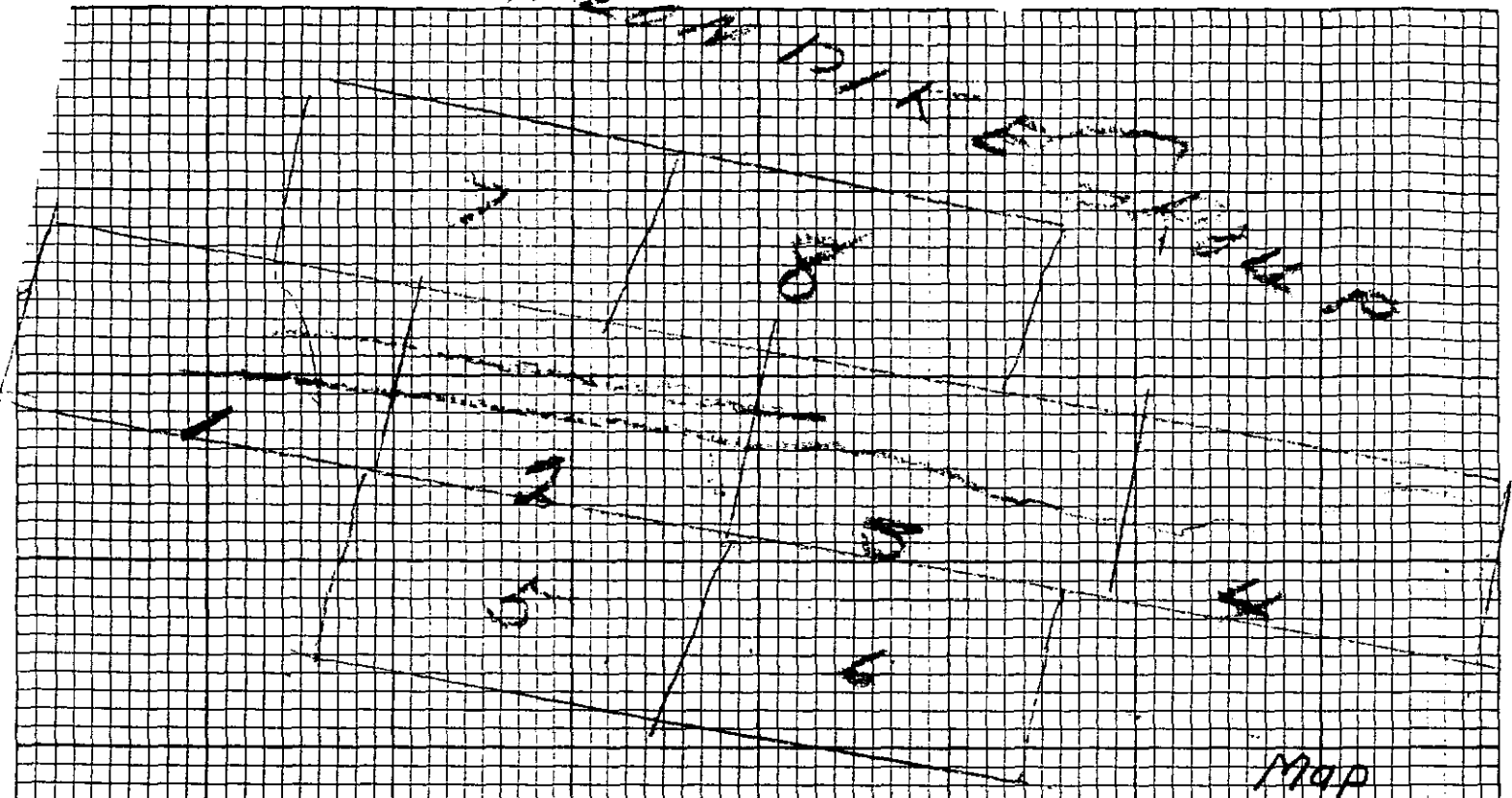

Scale
Date

Yorrell
1911

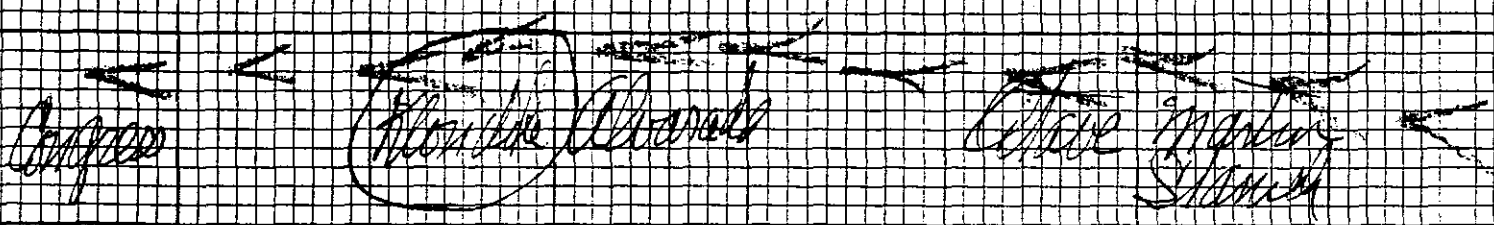

← Beaver Range

Section

Scale
Date

DEPARTMENT OF MINERAL RESOURCES
State of Arizona
MINE OWNER'S REPORT

Date May 24-1946

1. Mine: KLONDIKE
2. Location: Sec. _____ Twp. _____ Range. _____ Nearest Town. Yarnell Ariz
Distance 2 mi Direction Southern Road Condition on Highway 89 US
3. Mining District & County: Weaver Mining Dist. Yavapai Co Ariz
4. Former Name of Mine: Klondike since 1928
5. Owner: J Andrew West
Address: Box 844 Yarnell, Ariz
6. Operator: _____
Address: _____
7. Principal Minerals: Gold + silver
8. Number of Claims: 8 Lode yes Placer _____
Patented _____ Unpatented yes
9. Type of Surrounding Terrain: Mount. Property has a purple
porphyry and a diabase foot resembling
the old Congress mine
10. Geology & Mineralization: R. L. D'Arcy while Subst. U.S.
Museum at Jerome Ariz. examined the old
Congress and then the Klondike and then
made the statement hereto attached which
compared the Congress and Klondike
11. Dimension & Value of Ore Body: _____
Have several shallow inclined shafts
showing lead, silver and assaying gold,
averaging around \$700. The country
is so arranged that the veins could be
explored at the 500 ft. level with a vertical
hole 80 ft deep. Mr. Mills of Iron King mine
determined this. In his opinion this

ed show if the mine is another Congress or above, last reveal a lot of valuable inf. material

12. Ore "Blocked Out" or "In Sight":

Vein explored for 2000 ft with openings and mineralization precisely like the old Congress

Ore Probable:

By putting down 3 drill holes at the 500 level. Since the vein is flat that could be done

13. Mine Workings—Amount and Condition:

No.	Feet	Condition
Shafts 8	1000	good
Raises none		
Tunnels		
Crosscuts 2		
Stopes none		

14. Water Supply:

running water

15. Brief History:

was found during Congress boom and might have been developed at that time but it is reported grower asked too much cash as a down payment and was too high generally

16. Signature:

J. Andrew West

17. If Property for Sale, List Approximate Price and Terms:

100 000 on royalty basis. No payment otherwise

DEPARTMENT OF MINERAL RESOURCES

MINE OWNERS REPORT

June 28, 1957

Date

KLONDIKE MINE

- 1. Mine: KLONDIKE MINE
2. Location: Weaver Mining District, Yavapai County, Arizona

3. Mining District & County: Weaver Mining District, Yavapai County, Arizona

4. Former Name of Mine: KLONDIKE

5. Owner: J. ANDREW WEST

Address: 5070 Holden Avenue, Arlington, California

6. Operator: NONE

Address: NONE

7. Principal Minerals: Gold and Silver

8. Number of Claims: Eight Lode One Placer

Patented: Unpatented

9. Type of Surrounding Terrain: Porphyry hanging and diabase footwall

Some work was done on the property during the past

10. Geology & Mineralization: ... carrying gold varying at different points of dike

11. Dimension & Value of Ore Body: There is shaft in 250 feet and ore ... shaft produces a lot of water. There is a perfect dam sit a she rt distant to the east.

The placer claim is under the mountain and will grow oranges and grape fruit, and it could be watered from the mining operation.

12. Ore "Blocked Out" or "In-Sight": **By counteracting and pumping the water behind a dam to be built in a narrow gorge an operator would soon be mining ore averaging better than a half ounce in gold and silver. The property offers one of the best opportunities in mining in the State of Arizona.**

Ore Probable: **Since vein is opened up with several shallow shafts operator could have miners taking ore out in several places, and by planting citrus on the placer this fall, and building an irrigation system with the dam and some pipe the citrus could be watered and would soon be bearing.**

13. Mine Workings—Amount and Condition: **See above**

No.	Feet	Condition
Shafts.....	
Raises.....	
Tunnels.....	
Crosscuts.....	
Stopes.....	

14. Water Supply: **Described above.**

15. Brief History: **Some work was done on the property during the boom days of the Congress, and the owner at the time was offered a fabulous amount for the same. I have owned it about fifteen years and have the annual work recorded to July 1, 1958.**

Will sell on purely a royalty basis and let the total consideration be \$100,000.00 or more in that way. Of course, I would expect the operator to be reliable and have a good reputation.

16. Signature: *J. A. [Signature]*

17. Property for Sale, List Approximate Price and Terms: **10% Royalty**

Jerome, Arizona
February 28, 1925

Mr. J. Andrew West
Attorney at law
Prescott, Arizona

Dear Sir:

In reply to your request for a statement concerning the KLONDIKE GROUP near Congress, Arizona, will say that I spent a day recently looking over the old CONGRESS MINE, from which the late Frank Murphy and associates are said to have made \$10,000,000. and the KLONDIKE GROUP. The veins running thru the KLONDIKE GROUP have about the same strike and dip with geological conditions very similar to the CONGRESS VEINS. The two properties are situated in the same sheared zone. The KLONDIKE VEINS show very good values in gold at all points, and is traceable for several hundred feet. In the surface workings of the KLONDIKE VEINS I have seen several grades of silver are carrying gold at different places. In some cases the real worth of the property could be determined at a minimum expense. The vein is opened up with several shallow shafts. The property is located on an excellent HIGHWAY, and is only about six miles from the depot on the Santa Fe Railway at Congress Junction, Arizona. The KLONDIKE has a good water supply and indications that enough water could be developed for mining and milling.

Yours very truly,

R. L. D'ARCY

(Supt. UVX MINE, Jerome Arizona)

Copy

Arizona Metals Inc., W.J. Loring, Mgr.
Assay office at Mines
May 11, 1928

A.L. McFarland, Assayer

Mine Name: KLONDIKE MINE #2

Sample No.	Description	Gold Val. per ton	Silver Val. per ton	Total value
#1A	85' in face of drift 0) to 2 ft	5.95	17.50	21.45
#1	NW side of drift 20' in front portal 0 to 5'	1.88	Trace	1.88
#2	NW side drift 40' in from portal 0 to 4'	5.80	1.07	4.67
#3	NW side of drift 60' from portal 12.5 ft.	2.43	0.68	3.11
#4	NW side of drift 80' in. 0 to 5 ft.	5.29	0.50	5.79
#5	NW side of drift 100' in. 0 to 14"	9.38	0.33	9.68
#6	NW side of drift 120' in. 0 to 12"	2.82	0.12	2.94
#7	NW side of drift 140' in. 0 to 12"	0.42	Trace	0.42
#8	NW side of Drift 160' in. 0 to 12"	5.80	Trace	5.80
#9	NW side of drift 180' in. 0 to 122 2'	4.56	Trace	4.56
#10	SE side of drift 170' in. 0 to 5'	4.00	Trace	4.00
#11	SE side of drift 150' in. 0 to 12"	2.06	Trace	2.06
#12	SE side of drift 130' in. 0 to 8"	1.45	Trace	1.45
#13	SE side of drift 110' in. 0 to 8"	3.18	0.37	3.55
#14	SE side of drift 90' in. 0 to 16"	4.98	Trace	4.98
#15	SE side of drift 70' in. 0 to 5'	12.00	2.45	14.45
#16	SE side of drift 50' in. 0 to 5'	18.40	.06	18.46
#17	SE side of drift 30' in. 0 to 4'	2.80	.26	3.16
#18	SE side of drift 10' in. 0 to 4'	5.48	Trace	5.48
#19	NW side drift 75' fr. portal 0 to 18"	5.18	2.20	7.38
2646	300' from N. end line #6 tunnel portal	16.50	15.85 lead 49.68	79.81
2647	Tunnel #6 300 ft. from end line	5.80	5.47 lead 36.20	47.47
2648	Tunnel # 6 about 32 in. wide	5.69	Trace Trace	5.69
2649	continuation #2648 0 to 16"	2.38	2.08 6.48	10.94
2650	continuation #2648 16 to 24"	102.55	20.29 53.88	84.52
2651	Special sample taken from vein where six ft. wide	17.51	16.22 36.54	70.27
2652	#5 Tunnel 44'	1.34	.04 .90	3.28
2653	Tunnel # 2 0 to 4' Quartz	6.40	.09 .18	6.67
2654	Tunnel #2	5.80	.27 .15	6.22
2655	Tunnel #2	6.20	1.98 2.58	10.76
2656	Tunnell #1	1.34		1.34

Submitted to show general mineralization of the vein. While this property adjoins the Alvorado, which is now the pride of Yavapai County, and is in sight of the Congress which again is going full blast, these values are perhaps better than were the surface values of the other properties. The thing that makes the mine in this district is enough depth to encounter the gold sulphides. Since the KLONDIKE has two inclined shafts to a depth of over 150 feet another 200 feet should determine if the KLONDIKE is another CONGRESS or ALVORADO.