



## **CONTACT INFORMATION**

Mining Records Curator  
Arizona Geological Survey  
1520 West Adams St.  
Phoenix, AZ 85007  
602-771-1601  
<http://www.azgs.az.gov>  
[inquiries@azgs.az.gov](mailto:inquiries@azgs.az.gov)

The following file is part of the

Arizona Department of Mines and Mineral Resources Mining Collection

## **ACCESS STATEMENT**

These digitized collections are accessible for purposes of education and research. We have indicated what we know about copyright and rights of privacy, publicity, or trademark. Due to the nature of archival collections, we are not always able to identify this information. We are eager to hear from any rights owners, so that we may obtain accurate information. Upon request, we will remove material from public view while we address a rights issue.

## **CONSTRAINTS STATEMENT**

The Arizona Geological Survey does not claim to control all rights for all materials in its collection. These rights include, but are not limited to: copyright, privacy rights, and cultural protection rights. The User hereby assumes all responsibility for obtaining any rights to use the material in excess of "fair use."

The Survey makes no intellectual property claims to the products created by individual authors in the manuscript collections, except when the author deeded those rights to the Survey or when those authors were employed by the State of Arizona and created intellectual products as a function of their official duties. The Survey does maintain property rights to the physical and digital representations of the works.

## **QUALITY STATEMENT**

The Arizona Geological Survey is not responsible for the accuracy of the records, information, or opinions that may be contained in the files. The Survey collects, catalogs, and archives data on mineral properties regardless of its views of the veracity or accuracy of those data.

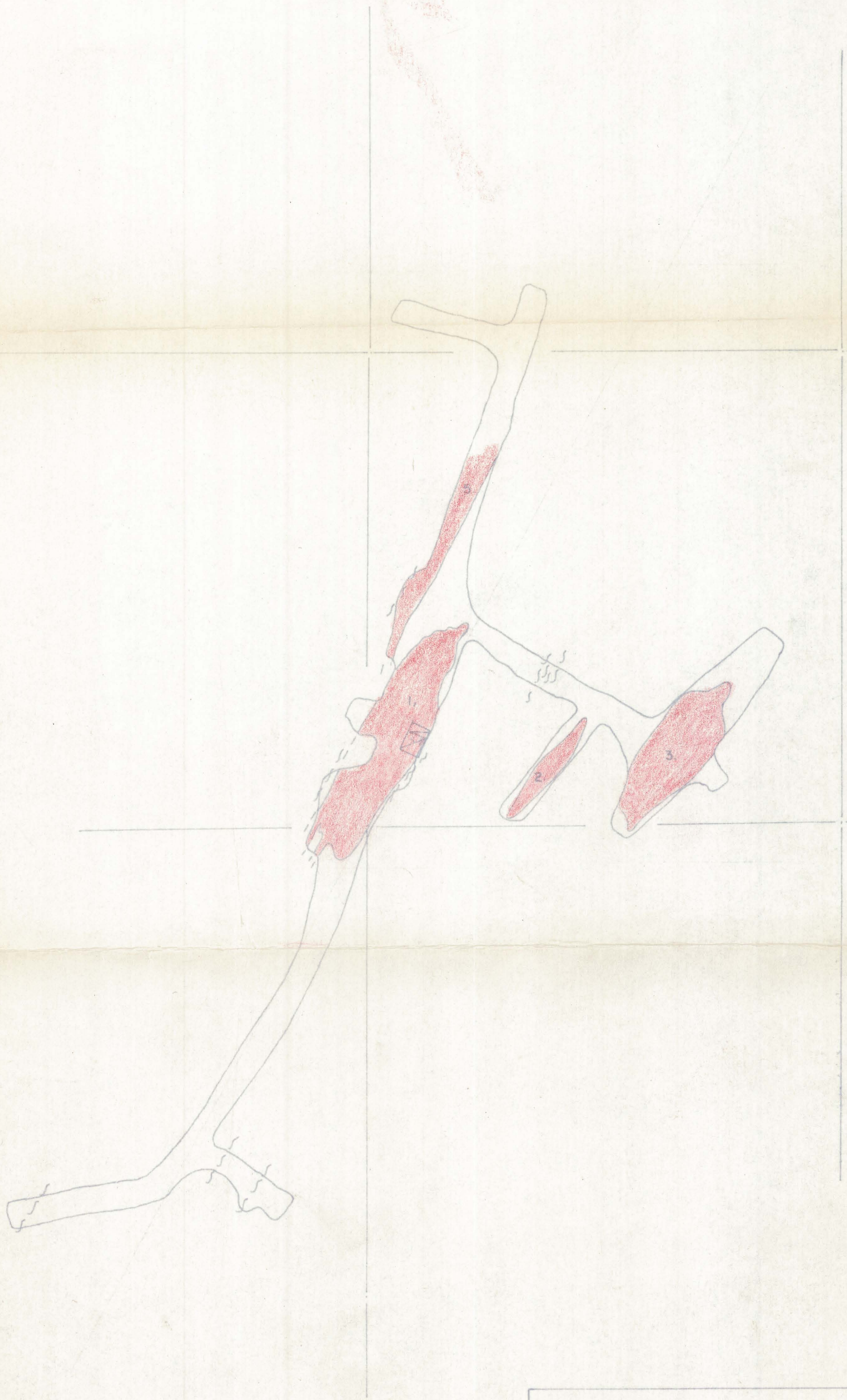

HACKBERRY MINE - FOR S.D.M. CORP.

SCALE 1" = 20'

100' LEVEL

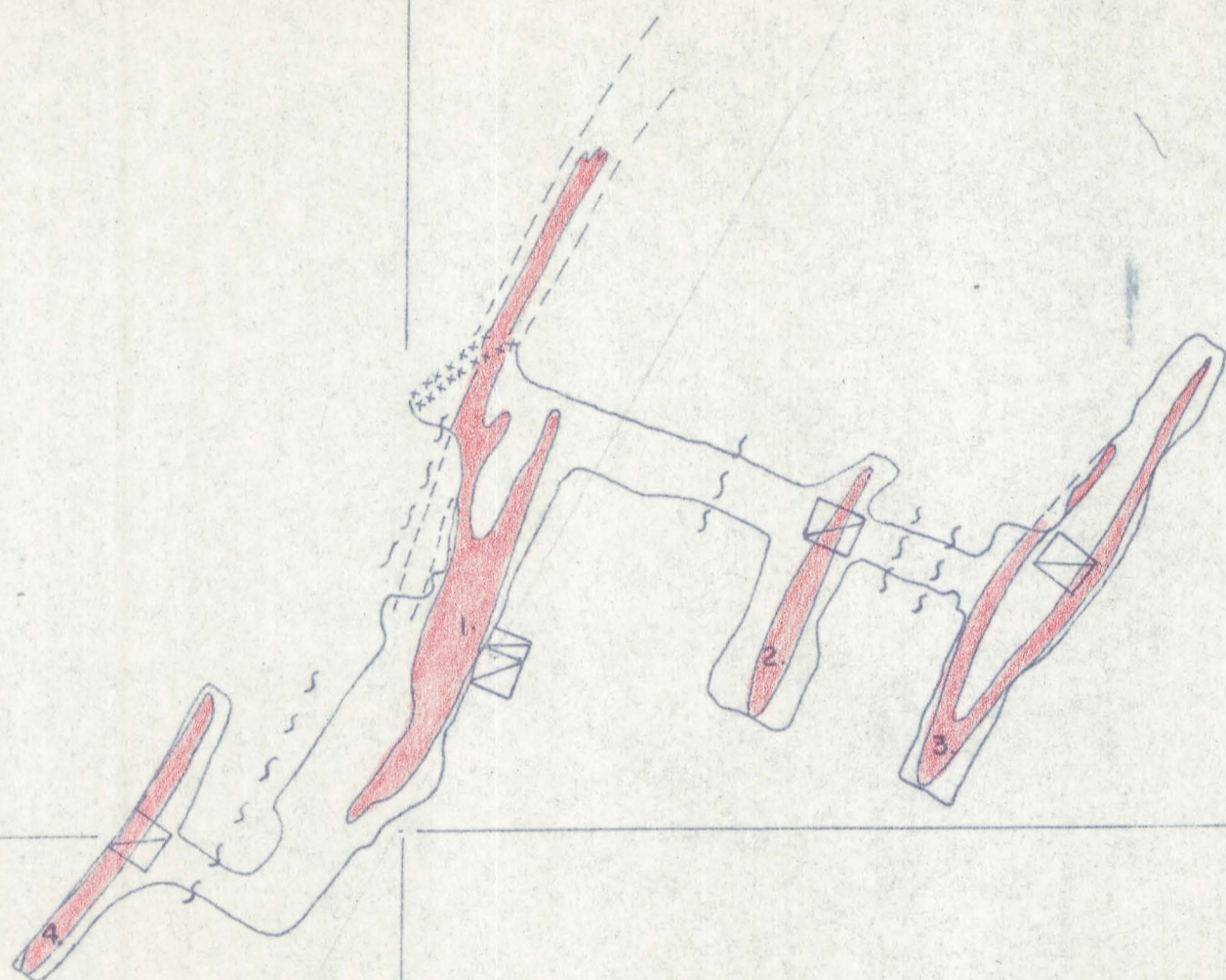



HACKBERRY MINE - FOR S.D.M. CORP

SCALE 1" = 20'

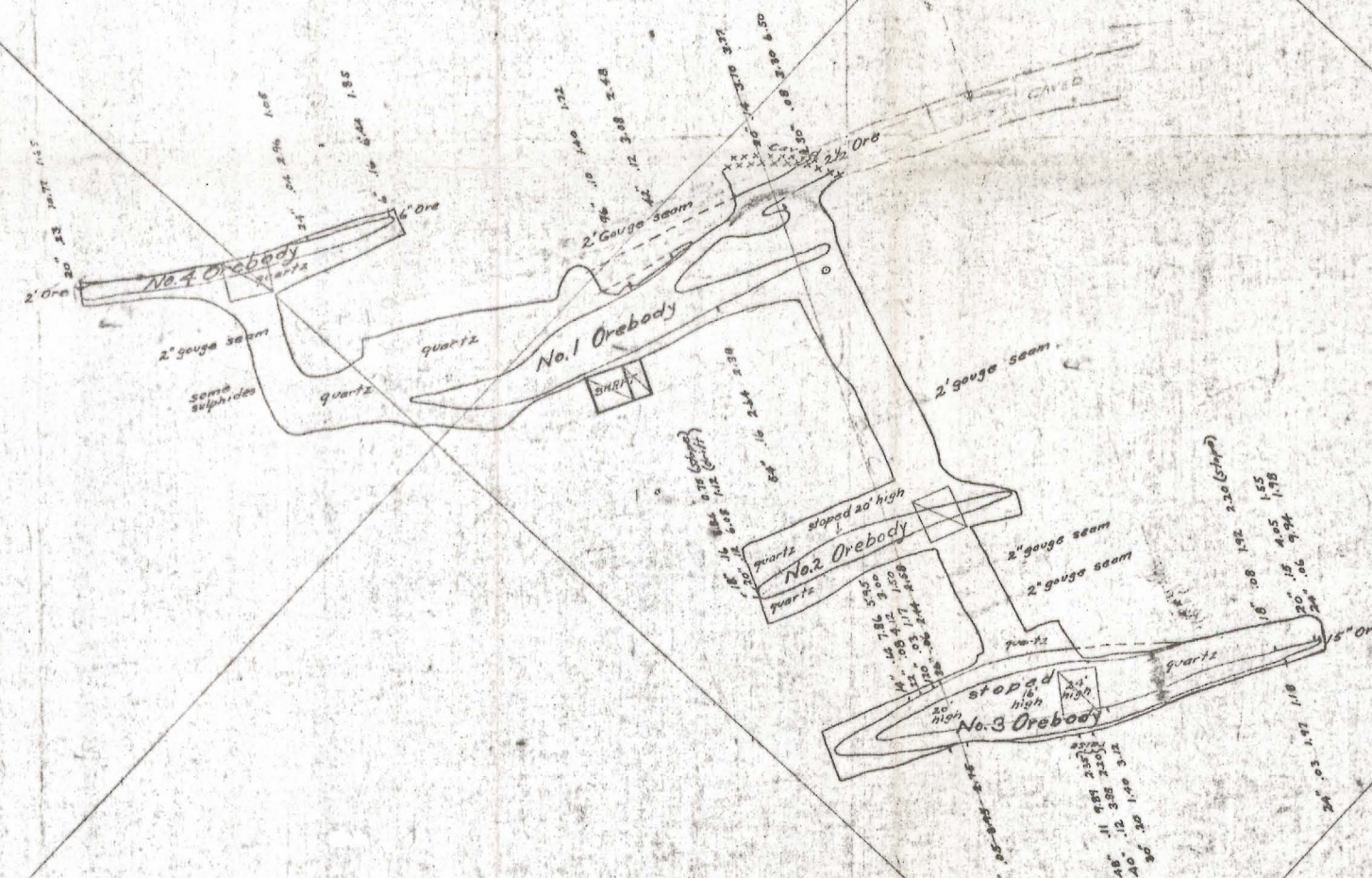
150 FOOT LEVEL

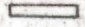
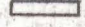

LEGEND

-  Ore in place
-  Stopped areas above level
-  Probable ore
-  Strike faults or gouge seams

HACKBERRY MINE

150 LEVEL

Scale 1" = 10'

Assays Shown as follows:  
 Inches Width - Oz. Gold - Oz. Silver - % Copper - % Lead

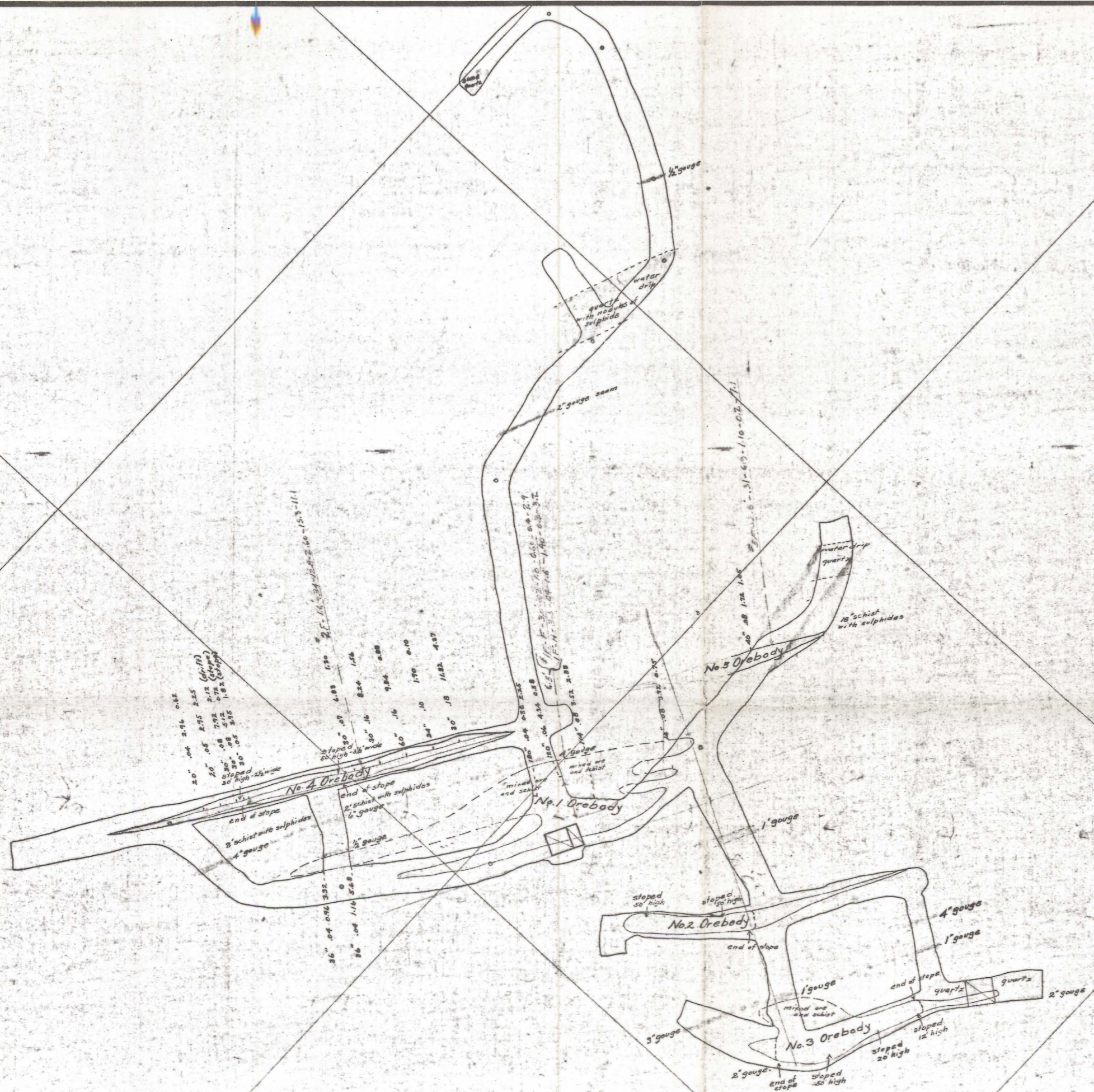

Assay data for No. 4 Orebody:

20"	04	2.4	0.12
20"	08	2.95	2.25
20"	12	2.7	2.12
20"	16	2.7	2.12
20"	20	2.7	2.12
20"	24	2.7	2.12
20"	28	2.7	2.12
20"	32	2.7	2.12
20"	36	2.7	2.12
20"	40	2.7	2.12
20"	44	2.7	2.12
20"	48	2.7	2.12
20"	52	2.7	2.12
20"	56	2.7	2.12
20"	60	2.7	2.12
20"	64	2.7	2.12
20"	68	2.7	2.12
20"	72	2.7	2.12
20"	76	2.7	2.12
20"	80	2.7	2.12
20"	84	2.7	2.12
20"	88	2.7	2.12
20"	92	2.7	2.12
20"	96	2.7	2.12
20"	100	2.7	2.12
20"	104	2.7	2.12
20"	108	2.7	2.12
20"	112	2.7	2.12
20"	116	2.7	2.12
20"	120	2.7	2.12

- LEGEND**
- Ore in place
  - Stopped areas above level
  - Probable ore
  - Strike faults or gouge seams

# HACKBERRY MINE

200 LEVEL

Scale 1" = 10'  
 Assays Shown as follows:  
 Inches Width - Oz. Gold - Oz. Silver - % Copper - % Lead

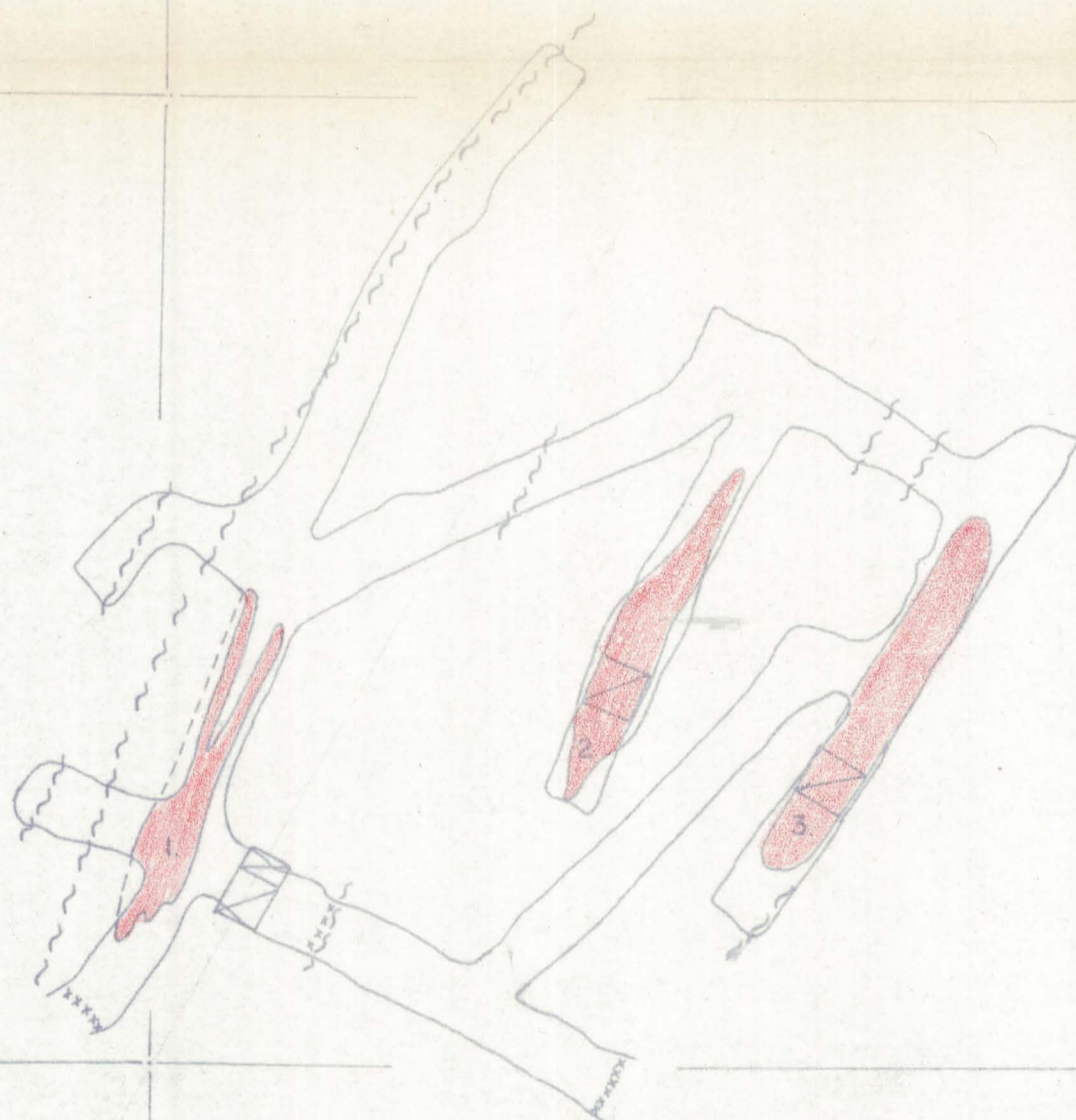

HACKBERRY MINE - FOR S.D.M. CORP.

SCALE 1" = 20'

250 FOOT LEVEL..

Nov 15 1905

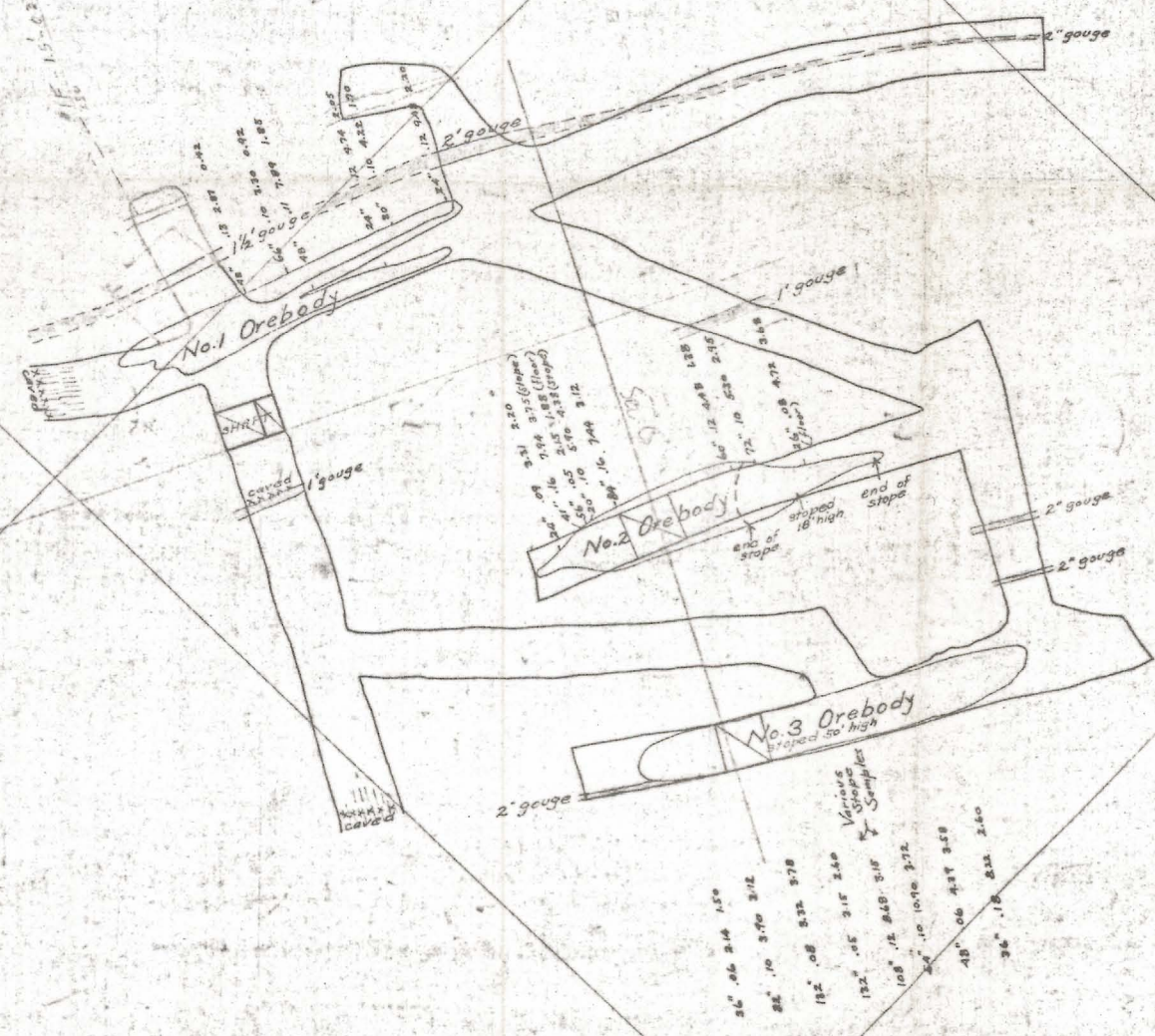

- LEGEND**
- Ore in place
  - Stopped areas above level
  - Probable ore
  - Strike faults or gouge seams

26" .06 214 150  
 28" .10 270 212  
 182" .08 533 378  
 132" .05 215 240  
 108" .12 240 215  
 24" .10 1070 372  
 48" .06 437 259  
 36" .18 222 240  
 Various  
 Groups  
 of  
 Samples

**HACKBERRY MINE**  
**250 LEVEL**

Scale 1" = 20'

Assays Shown as follows:  
 Inches Width - Oz. Gold - Oz. Silver - % Copper - % Lead

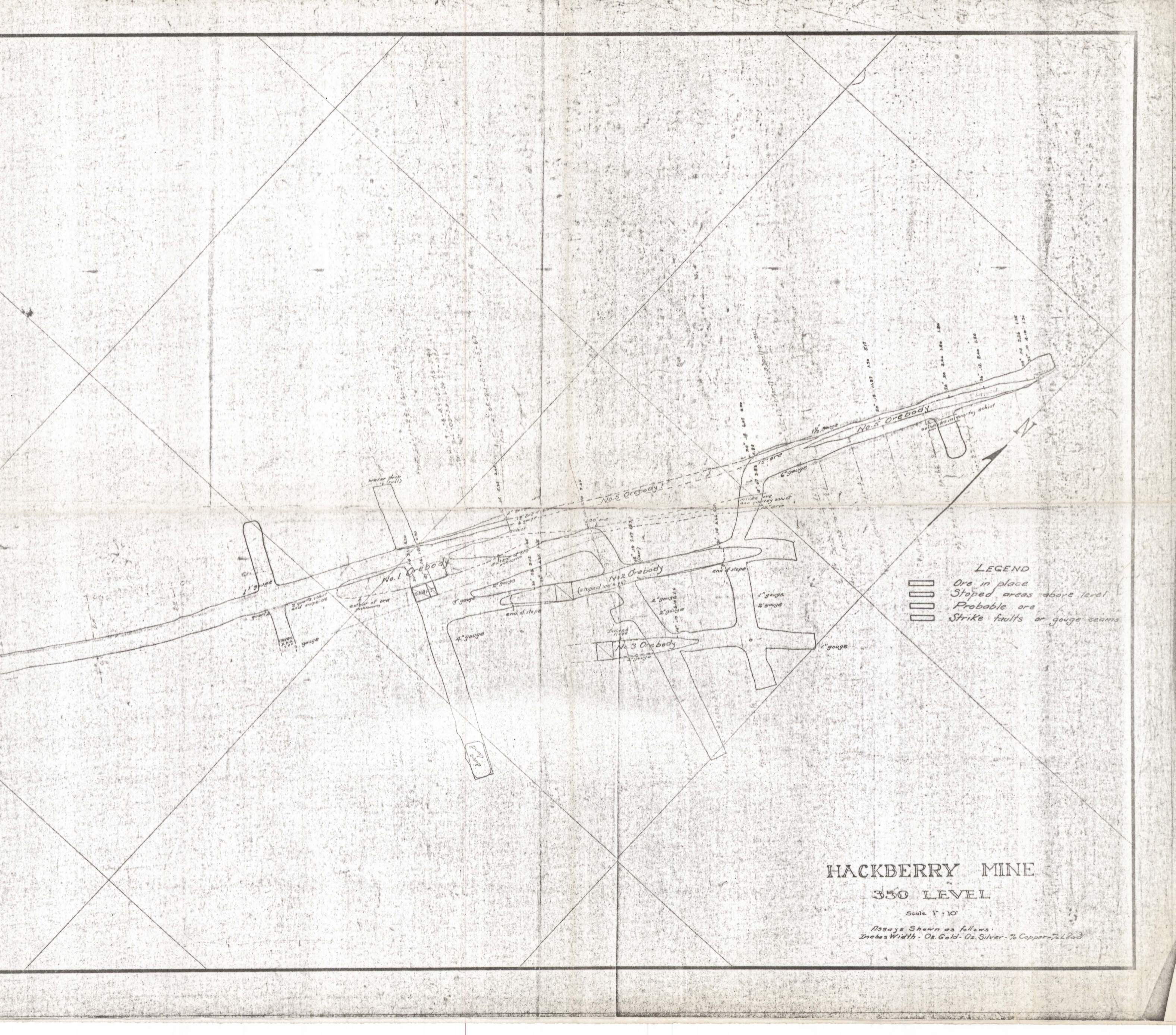

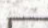
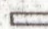
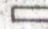
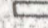
- LEGEND**
-  Ore in place
  -  Stoped areas above level
  -  Probable ore
  -  Strike faults or gouge seams

# HACKBERRY MINE

350 LEVEL

Scale 1" = 10'

Assays Shown as follows:  
 Inches Width - Oz. Gold - Oz. Silver - % Copper - % Lead



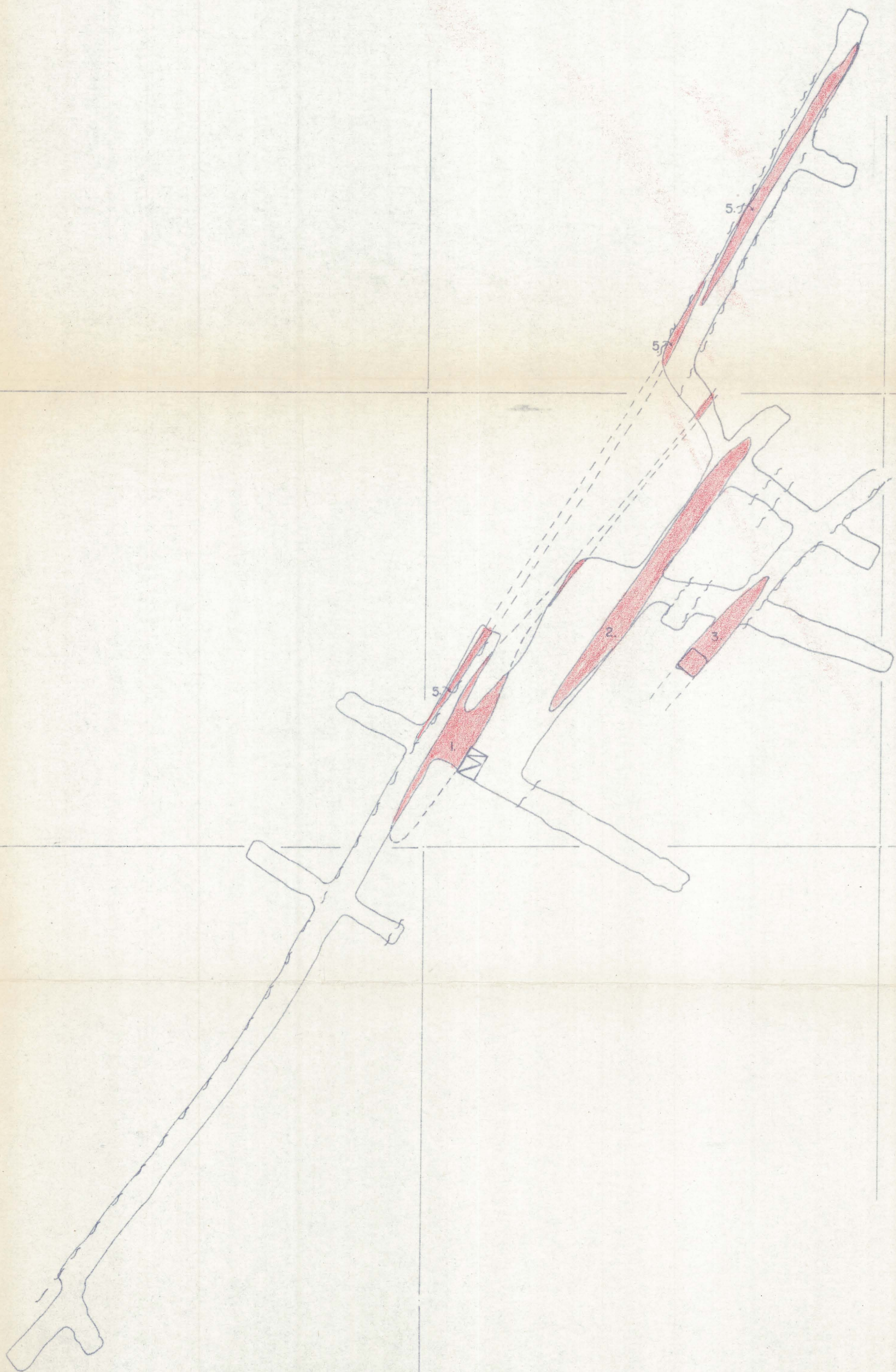

HACKBERRY MINE - FOR S.D.M. CORP.

SCALE 1" = 20'

350 FOOT LEVEL

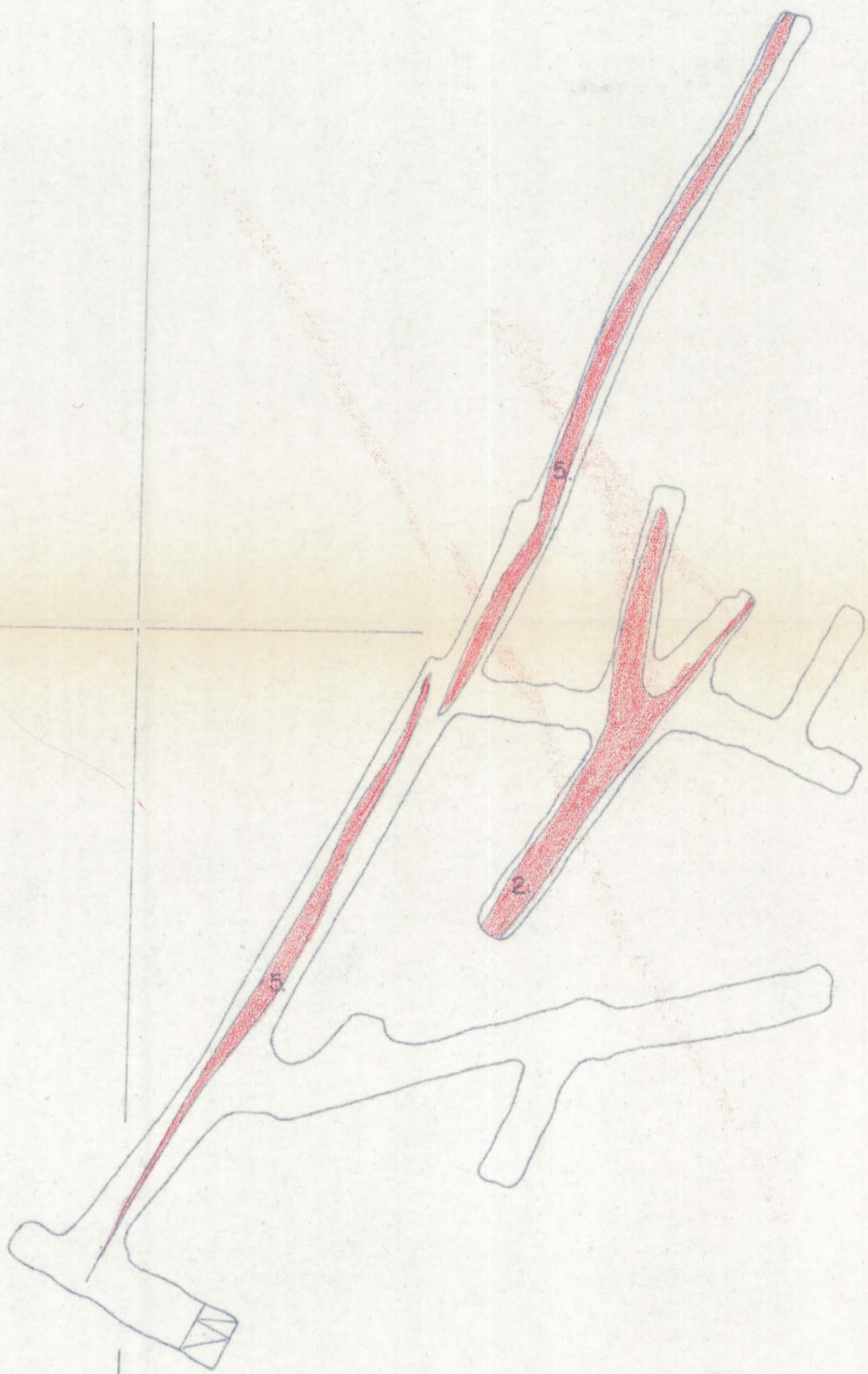

HACKBERRY MINE - FOR S.D.M. CORP.

SCALE 1" = 20'

450 FOOT LEVEL.



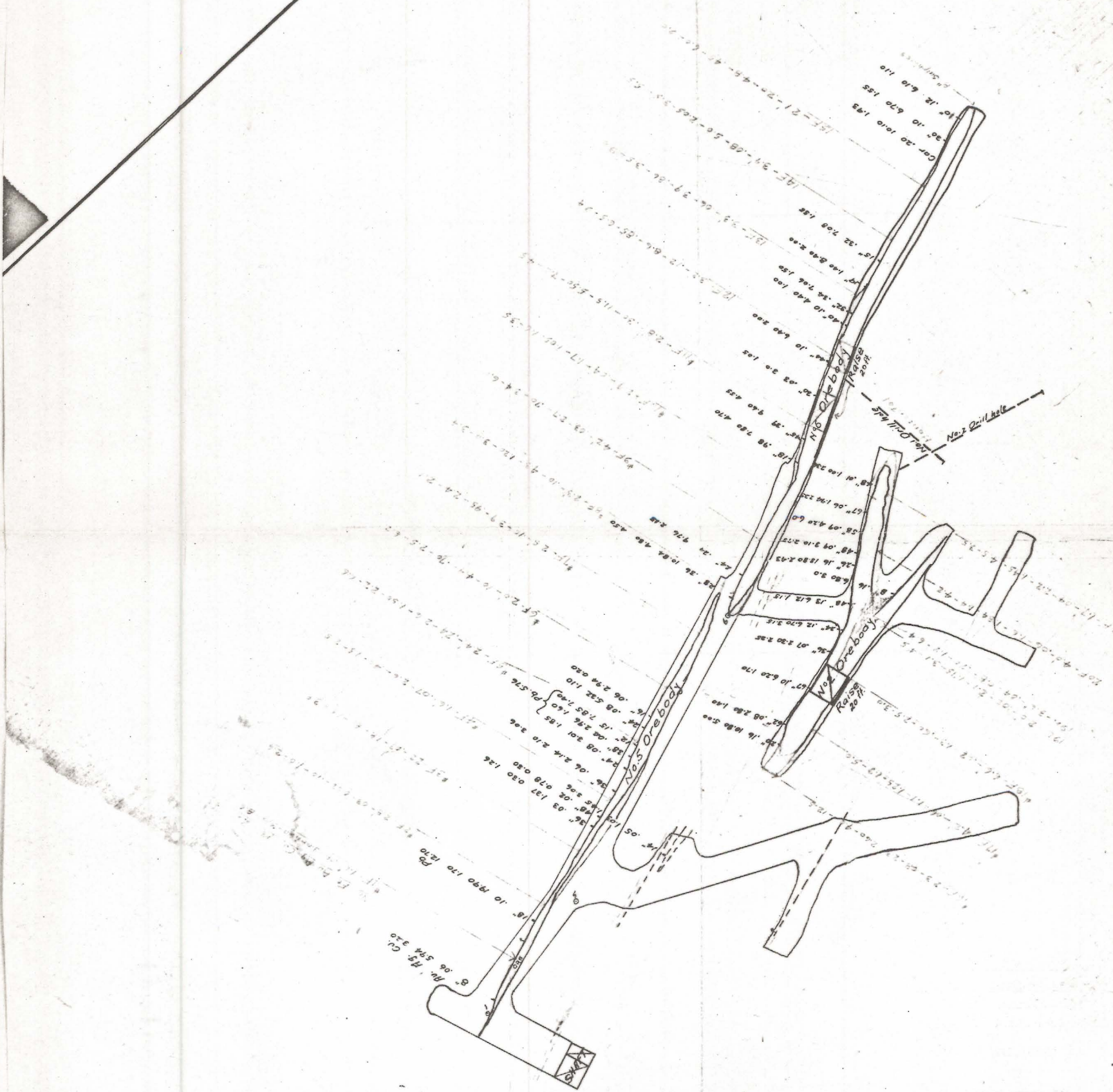

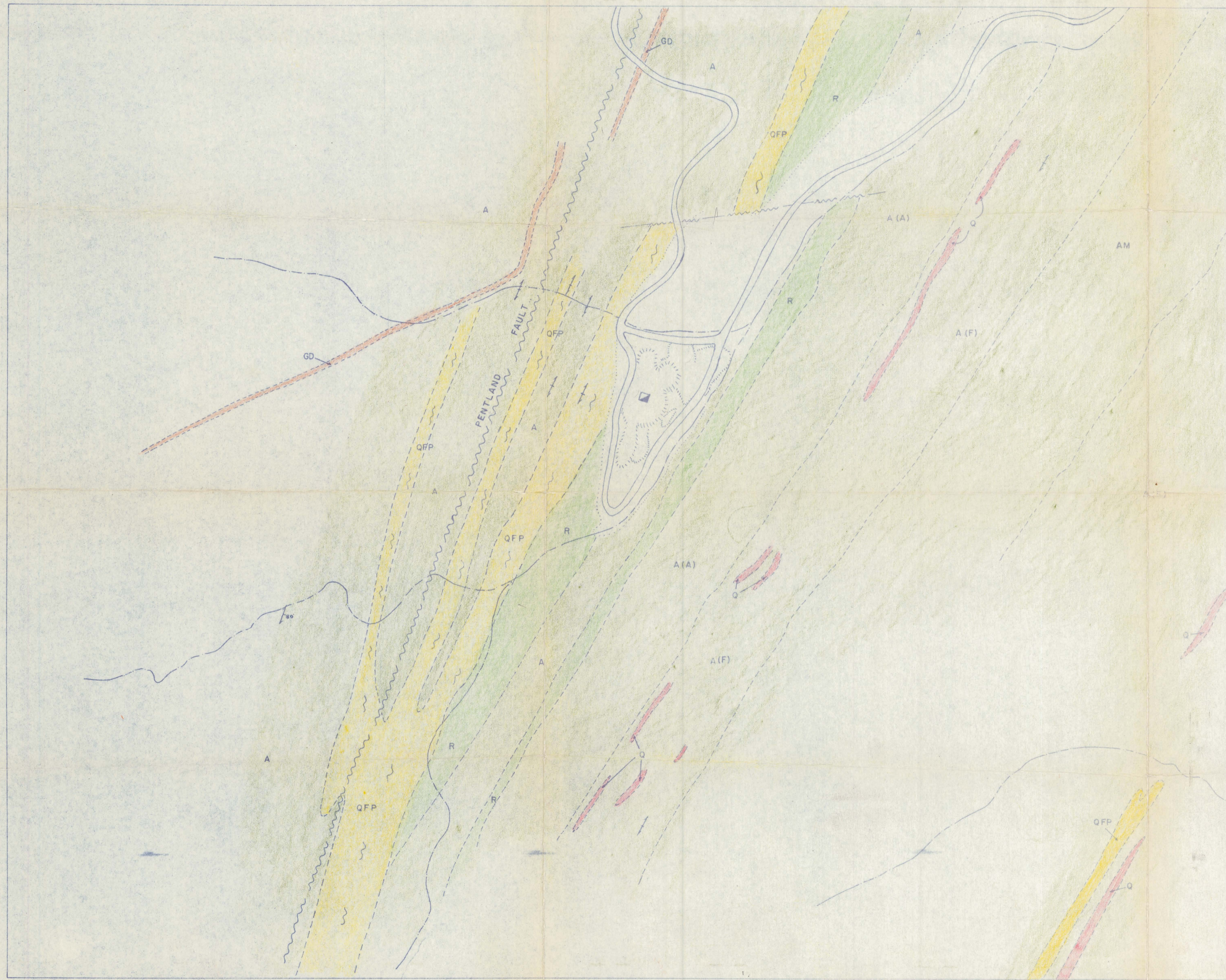

Nov. 1955



450'  
HACKBERRY.  
10 Scale.



- L E G E N D -

-  QUARTZ VEINS
  -  GRANODIORITE DIKES
  -  QUARTZ FELDSPAR PORPHYRY
  -  RHYOLITE FLOW (MAY BE SCHISTOSE)
  -  ANDESITE (FLOW?) - COARSE-GRAINED & MASSIVE.
  -  ANDESITE
    - AGGLOMERATIC
    - FLOW
- GF = "IRON KING VOLCANICS"

HACKBERRY MINE AREA

FOR SHATTUCK DENN MINING CORPORATION

SCALE 1" = 200'

GEOLOGY MODIFIED AFTER "NEW JERSEY ZINC" - AX-AR-610