



CONTACT INFORMATION

Mining Records Curator
Arizona Geological Survey
1520 West Adams St.
Phoenix, AZ 85007
602-771-1601
<http://www.azgs.az.gov>
inquiries@azgs.az.gov

The following file is part of the

Arizona Department of Mines and Mineral Resources Mining Collection

ACCESS STATEMENT

These digitized collections are accessible for purposes of education and research. We have indicated what we know about copyright and rights of privacy, publicity, or trademark. Due to the nature of archival collections, we are not always able to identify this information. We are eager to hear from any rights owners, so that we may obtain accurate information. Upon request, we will remove material from public view while we address a rights issue.

CONSTRAINTS STATEMENT

The Arizona Geological Survey does not claim to control all rights for all materials in its collection. These rights include, but are not limited to: copyright, privacy rights, and cultural protection rights. The User hereby assumes all responsibility for obtaining any rights to use the material in excess of "fair use."

The Survey makes no intellectual property claims to the products created by individual authors in the manuscript collections, except when the author deeded those rights to the Survey or when those authors were employed by the State of Arizona and created intellectual products as a function of their official duties. The Survey does maintain property rights to the physical and digital representations of the works.

QUALITY STATEMENT

The Arizona Geological Survey is not responsible for the accuracy of the records, information, or opinions that may be contained in the files. The Survey collects, catalogs, and archives data on mineral properties regardless of its views of the veracity or accuracy of those data.

PRINTED: 08/07/2001

ARIZONA DEPARTMENT OF MINES AND MINERAL RESOURCES AZMILS DATA

PRIMARY NAME: GRUBSTAKE

ALTERNATE NAMES:

SCRIBNER

SCRIVER

SANTA CRUZ COUNTY MILS NUMBER: 69D

LOCATION: TOWNSHIP 23 S RANGE 11 E SECTION 19 QUARTER SE
LATITUDE: N 31DEG 24MIN 37SEC LONGITUDE: W 111DEG 15MIN 01SEC
TOPO MAP NAME: ORO BLANCO - 15 MIN

CURRENT STATUS: PAST PRODUCER

COMMODITY:

GOLD

SILVER

COPPER

BIBLIOGRAPHY:

INDEX TO MINING PROP. IN SANTA CRUZ CO.

PRIVATE RECORDS

SANTA CRUZ CO. RECORDER'S RECORDS

AZBM CARD FILE SANTA CRUZ CO.

ADMMR GRUBSTAKE FILE

KNIGHT, L.H. JR., P. 64, 1970, ADMMR GEO FILE

ARIZONA DEPARTMENT OF MINES AND MINERAL RESOURCES

INFORMATION FROM MINE CARDS IN MUSEUM

ARIZONA

SANTA CRUZ CO.

GRUBSTAKE MINE

MM 2665 Ore of Lead, Zinc, Copper, Iron,
Manganese, Magnesium

MILS # 69D

2-AKA

Grubstake (file)

GRUBSTAKE MINE

SANTA CRUZ COUNTY
ORO BLANCO DISTRICT
T23S R11E Sec 19

AKA: Scribner, Sriver

MILS Santa Cruz Index #69D

ABM Bull 191, p.64

Geology Report- Knight, Louis H. Jr. "Structure and Mineralization of the Oro
Blanco Mining District" 1970

Bartlett Mtn. Quadrangle 7ap (Included in file)

SANTACRU - Table Records

| | | | | | | | | | | |
|--|------------------------|-------------------------------------|-----------------------|----------------------------|----------------------|----------------------|----------------------|-------------------|--|--|
| NUMBER 69D | FILE F | CONT 0 | CONT1 N | PRNAME GRUBSTAKE | | | | | | |
| ALTNAME1 SCRIBNER | | | | ALTNAME2 SCRIVER | | | | | | |
| ALTNAME3 | | | | ALTNAME4 | | | | | | |
| ALTNAME5 | | | | ALTNAME6 | | | | | | |
| CURSTAT PAST PRODUCER | | MNAME ORO BLANCO - 15 MIN | | | NLATDEG 31 | | NLATMIN 24 | | | |
| NLATSEC 37 | WLONGDEG 111 | WLONGMIN 15 | WLONGSEC 01 | TOWN 23 S | RANGE 11 E | SECTION 19 | QUARTER SE | COM1 AU | | |
| MODI1 | COM2 AG | MODI2 | COM3 CU | MODI3 | COM4 | MODI4 | | | | |
| COM5 | MODI5 | COM6 | MODI6 | COM7 | MODI7 | | | | | |
| BIB1 INDEX TO MINING PROP. IN SANTA CRUZ CO. | | | | | | | | | | |
| BIB2 PRIVATE RECORDS | | | | | | | | | | |
| BIB3 SANTA CRUZ CO. RECORDER'S RECORDS | | | | | | | | | | |
| BIB4 AZBM CARD FILE SANTA CRUZ CO. | | | | | | | | | | |

GRUBSTAKE

SANTA CRUZ COUNTY
Oro Blanco District

MG WR 7/8/83: A watchman lives at the Grubstake Mine, Santa Cruz County. There are many different pieces of equipment on the property. During the early part of this year, John Frye mined some fresh rock from the Grubstake. It appears that he was crushing and grinding this material to about 1/4 inch and cyaniding it in a large truck-mounted cement mixer. The watchman said there has been no mining since April.

MG WR 7/8/83: Mr. Duane Arnold, ex-mine engineer at the Brick mine, was hired by Mr. Floyd Durkee of Oklahoma, to sample the Grubstake Mine, Santa Cruz County, prepare mine maps, and write a report on the mine's potential. Mr. Arnold defined a small tonnage of gold ore and recommended the mine for further exploration and development. Mr. Durkee, the potential buyer of the property, has had the area flown for infrared aerial photographs; according to Arnold, these photographs define several major vein structures. Although Mr. Frye is negotiating the sale of the property, the Whittinghills of Arivaca are still part owners.

MG WR 7/13/84: Mr. Floyd Durkee (c) reports he is in the process of buying the Grubstake mine in Santa Cruz Co.

GRUBSTAKE

SANTA CRUZ COUNTY
ORO BLANCO DISTRICT

RRB WR 2/27/81: George Lottridge of J.T. Enterprises, Vancouver, Washington, called to inquire about the availability of custom mills in Arivaca area. Mike Greeley supplied the names of Mr. Becker, Cactus Bowl Lanes, Tucson, who has a mill near Twin Buttes, and John Frye, Grubstake Mining Development, P.O. Box 115, Sonoita 85637, mobile unit 624-6646 E0436, who has a mill near Ruby.

MG WR 4/24/81: John W. Frye, President of Grubstake Mining Development Co. in Santa Cruz County called to say he has shut down operations and wants to sell. I understand, from another source, that he is asking \$400,000. I provided information on the operation to a consulting engineer calling from Denver.

MG WR 9/24/82: U.S. Bureau of Mines Reported production from Oro Blanco Mining District, Santa Cruz County. Grubstake Mine produced 195 tons in 1935 and 1937-1940. Produced: 400 pounds of copper, 1,405 ounces of silver and 156 ounces of gold.

MG WR 2/11/83: Mr. John Frey requested assistance with his precious metal recovery system at the Grubstake Mine, Santa Cruz County. He is mining ore from the Grubstake. I put him in touch with Dave Rabb who was able to visit the property and assist him.

MG WR 5/27/83: Several sources report that the Grubstake mine of Santa Cruz County was bought recently by Mr. Floyd Durkee of Oklahoma. Apparently Mr. Durkee has also purchased the Morning Star, Oz, and Rainbow properties, Tyndall District, Santa Cruz County and the Yellow Brick Road property, Oro Blanco District, Santa Cruz County.

MG WR 5/27/83: I could find no listing of the Yellow Brick Road claim, Santa Cruz County on the BLM microfiche.

GRUBSTAKE

SANTA CRUZ COUNTY
ORO BLANCO DISTRICT

Au and Ag

See Thesis: Structure & Mineralization of the Oro Blanco Mining District, Arizona Santa Cruz County, by Dr. Louis H. Knight Jr. 1970 - Geology File.

See: A report on the Field Work Prospecting & Geology of the District contiguous to the Montana Mines, Ruby, Arizona, F.E. Gregory, Sept. 1935 - Geology File.

See: ABM Bulletin 191, page 64, T23S, R11E, Sec. 19

VBD WR 9/3/81: I drove to the Arizona College of Technology between Mammoth and Winkelman to drop off a box of mining periodicals which they were pleased to receive. I met Jay Flumer and Louis Reinwand. The college plans to move the old arrastra on the Grubstake Claim in the Oro Blanco District to the campus sometime next week.

VBD WR 10/31/75: The Grubstake lode mining claim has been sold to Norman J. Lunde, P.O. Box 181, Arivaca, Arizona 85601. The Grubstake claim is situated in Section 19, T23S, R11E.

VBD WR 11/4/75: Gene Bailey of Arivaca stopped at office to procure maps of the old Grubstake Mine in the Oro Blanco District. He said he and the new owner Norman J. Lunde, planned to sample dumps and make cyanidation tests. If tests are successful, they will set up a very small cyanide plant. I will provide maps from my files next week. I'm certain the Phoenix office has underground maps but no copies are in the Tucson office.

VBD WR 3/4/76: I talked to Gene Bailey and Mr. Lundy. They are moving equipment to the Grubstake mine for a small cyanide leaching operation. The mine is situated in the Oro Blanco Mining District, Santa Cruz County.

MG WR 1/23/81: Talked to Harry J. Whittinghill, P.O. Box 91, Arivaca, Arizona 85601, phone 398-2390. He owns the Grubstake Mine in the Oro Blanco District of Santa Cruz County. He is leasing the mine to J.W. Fry, mobile phone 1-624-6646, unit 0436. Mr. Fry is trying to establish a gold operation; his mill is on the Grubstake and the mine is on the Sorrel Top.

Durkee Mine, Santa Cruz Co.



STATE OF ARIZONA
DEPARTMENT OF MINERAL RESOURCES
416 W. CONGRESS, ROOM 161
TUCSON, ARIZONA 85701

602/628-5399

March 16, 1983

RECEIVED

MAR 17 1983

DEPT. MINERAL RESOURCES
PHOENIX, ARIZONA

circulate

Mr. Jack R. Martin
1399 E. 26 St.
Tulsa, OK 74114

Dear Jack,

Thank you for your letter of March 1 and the "Arivaca Explorations Report I".

I think your comments of March 1 to Mr. Durkee are well spoken. Your recommended procedure to follow in evaluating the properties and interests is sound and basically correct.

Title to the various mining claims should be checked at the county recorder's office and at the Bureau of Land Management. Also in general many carefully collected samples are required to properly evaluate the potential of any mineralized deposit.

If I can be of any further assistance, please do not hesitate to call.

Sincerely,

Mike Greeley

Michael N. Greeley
Field Engineer

MNG:fd

March 1, 1983

Mr. M. N. Greeley
State Of Arizona
Department of Mineral Resources
State Office Building
416 West Congress
Room 161
Tucson, AR. 85701

Re: Enclosures

Dear Mike:

The letter to Floyd Durkee states exactly my approach to looking for investors. The procedures follow the suggestions made by you, Dr. Peirce, Dave Rabb and Stanton Keith. I may be clear out in the North Forty but if I was approached to invest in these deals, I wouldn't ask for - but - would demand such required information as is outlined in the procedure as suggested. I was personally acquainted with the "bath" my Father took in the Kirkland, Skull Valley, Humboldt areas in 1925.

The proposals to invest \$850,000.00 (\$500,000.00 Frye & \$350,000.00 Durkee) could possibly be a good deal but I am going to have to see more than has been offered to date.

Floyd Durkee paid \$57,000.00 to West Twohey and Debbie Baker (the widow of Jim Twohey who committed suicide. Jim was West Twohey's brother, and owned the original claims) for 81.25% of the listed claims and W.Twohey & D. Baker retained 18.75%. My question from the outset has been- What did Durkee get for his money?

Durkee is far afield from his normal business which is oil. Floyd has been very successful, is square as a die and I hope this new venture will work out.

If you have an opportunity I would appreciate hearing from both you and Dr. Peirce as to whether I am overly cautious or just plain nuts.

Thanks for the information.

Very truly yours,



Jack R. Martin
1399 E. 26 Street
Tulsa, OK. 74114

March 1, 1983

Mr. Floyd Durkee
P.O. Box 151
Terlton, Oklahoma 74081

RE: Prospective investment in your claims in Santa Cruz and Pima Counties, Arizona, and the operating mines and claims for sale by John W. Frye in the Oro Blanco and Arivaca Districts of Pima and Santa Cruz Counties, Arizona.

Dear Floyd:

Pursuant to the above captioned reference, I suggest that we hold these matters in abeyance until we have a meeting, establish the required factual information and formulate a plan for prospective investors based on more sound investment information. Any action taken by the interested parties must be such that would withstand the scrutiny of all State and Federal agencies, particularly the securities divisions of the States of Oklahoma and Arizona.

Floyd, I have spent a considerable amount of time and money in long distance calls to knowledgeable persons to obtain maps, plats and sources of information so that any presentation made to a prospective investor would stand up in a legal action, if it should become necessary.

The following is not an attempt to dash cold water on any enthusiasm on the part of any of us. However, certain factors must be reckoned with to protect your investment made to date and the proposed plan of development. Take time, Floyd, to analyze and evaluate everything that has transpired to date. What would your reaction be if you were approached today to invest in the Twohey claims? After you analyze the following suggestions made by persons who have spent a lifetime in "Hard Rock" mining and geology, I want to know your reaction and whether you agree that we should follow their advise:

- 1 - West Twohey has presented little more than pure speculation in his "Arivaca Explorations Report" that you gave to me. This report contains too many suppositions that can't be verified and no claim recording information nor the actual location by Section, Township & Range. The economics as presented are theory and, to my knowledge, NO ASSAYS HAVE BEEN PRESENTED THAT WOULD SUBSTANTIATE THE ACTUAL MINERAL CONTENT OF ANY OF THE CLAIMS, NOR A FEASIBLE METHOD OF EXTRACTION, AND EXPECTED RECOVERY OF MINERAL CONTENT PER TON AS WOULD BE OUTLINED BY A

REGISTERED GEOLOGICAL ENGINEER. The costs involved are an overriding factor and are of vast import not only to an investor, but to you as an owner of the majority interests.

- 2 - The John W. Frye properties fall in exactly the same category as outlined hereinabove. The burden of PROOF falls on the Seller, whether it be for investment purposes or for transfer of assets in claims, mines or machinery. A suggested procedure has been offered and, in my opinion, we should follow it.

PROCEDURE

JOHN W. FRYE PROPERTIES

1. Frye should provide a current Fair Market Value or Salvage Value appraisal of all equipment offered for sale. This appraisal must be made by a knowledgeable and currently operating company that will certify loan value. Relative to that value, age and remaining depreciation are factors and any monies paid over and above the FMV or SV of the equipment should be given serious consideration. No lending institution would approve any loan over and above the equipment FMV or SV, so why would an investor? Since selling "good will" is not an issue, the only things of actual value are the extraction and other equipment. Any other values, regardless of the seller's claims of anticipated future mineral recovery, are pure theory UNTIL a Registered Metallurgist in the State of Arizona, working independently, takes samplings from the operating mines and the remaining nine claims and identified them and submits them to an established assay office. After the Metallurgist has completed his work, a State of Arizona Registered Geological Engineer should be employed to work out all of the economics that pertain to extraction, type of equipment to be used, provide a cost analysis for the maximum results that can be expected. The Metallurgist and Geological Engineer will provide the Seller, Buyer and/or Investors the costs of mining the ore, extracting the mineral content and the minimum and maximum recovery per ton of ore mined. Any other procedure than this would be totally unacceptable to any investor since this is based on both common sense and good business acumen. It stands to reason that a Seller is not going to downplay an offering. Therefore,

| | |
|-------------|---|
| REFERENCE 1 | F1 < USBM - ABGMT PRODUCTION FILE DATA |
| REFERENCE 2 | F2 < USBM FILE DATA - CLUSTER# 47 - GRUBSTAKE MINE |
| REFERENCE 3 | F3 < KEITH, S.B., 1975, ABM BULL. 191, P. 64 |
| REFERENCE 4 | F4 < KNIGHT, LOUIS H. JR., 1970, STRUCTURE AND MINERALIZATION OF THE ORO BLANCO MINING DISTRICT, SANTA CRUZ COUNTY, ARIZONA. PH.D. DISSERTATION UNIVERSITY OF ARIZONA |

R5 < SEQUENCE > mid # 69D

RECORD IDENTIFICATION

RECORD NUMBER B10 < 83-105 > RECORD TYPE B20 < X, I, M > DEPOSIT NUMBER B40 < >
REPORT DATE G1 < 83-105 > INFORMATION SOURCE B30 < 1, 2 > FILE LINK IDENT. B50 < USBM-004023005G >
REPORTER(SUPERVISOR) G2 < LARABA PETER > (last, first, middle initial) < CALDER SUSAN > (last, first, middle initial)
REPORTER AFFILIATION G5 < ABGMT > SITE NAME A10 < GRUBSTAKE MINE >
SYNONYMS A11 < SCRIBNER SCRIVER >

| | | | |
|--------------------------|---|------------------------|--|
| *MINING DISTRICT/AREA | A30 < ORO BLANCO DISTRICT | | |
| *COUNTY | A60 < SANTA CRUZ | > | *STATE A50 < AZ |
| | | | *COUNTRY A40 < U.S. |
| *PHYSIOGRAPHIC PROV | A63 < 1.2.1 | | |
| *DRAINAGE AREA | A62 < 1.5.0.8.0.2.0.0.V. LOWER COLORADO | > | *LAND STATUS A64 < 4.1.1. . . . (1979) |
| *QUADRANGLE NAME | A90 < BARTLETT MTN., ARIZ | (1979) - | *QUADRANGLE SCALE A100 < 24000 |
| *SECOND QUAD NAME | A92 < ORO BLANCO | (1942) - | *SECOND QUAD SCALE A91 < 62500 |
| *ELEVATION | A107 < 4000 FT | | |
| <hr/> | | | |
| *UTM | | *ACCURACY | *GEODETIC |
| *NORTHING A120 < 3475325 | | *ACCURATE ACC (circle) | *LATITUDE A70 < 31-24-50 N |
| *EASTING A130 < 476125 | | *ESTIMATED EST < _____ | *LONGITUDE A80 < 111-15-04 W |
| *ZONE NUMBER A110 < 11A | | | |

*TOWNSHIP(S) A77 < 0235 : : : : : > *RANGE(S) A78 < 011 E : : : : : >
*SECTION(S) A79 < 19 : : : : : >
*SECTION FRACTION(S) A76 < SW OF SW OF NE >
ERIDIAN(S) A81 < GILA AND SALT RIVER >

POSITION FROM NEAREST PROMINENT LOCALITY A82 < 1/2 MILE NE OF BARTLET MTN
LOCATION COMMENTS A83 < ON THE WEST SIDE OF SCRIBNER GULCH, ABOUT 1/2 MILE SE OF WARSAW MINE

* ESSENTIAL INFORMATION
+ ESSENTIAL SOMETIMES OR HIGHLY RECOMMENDED

GENERAL COMMENTS GEN

reliability and the actual facts present must be the work of independent persons with established expertise.

2. It is vital that the "independent" status of both the Metallurgist and the Geological Engineer be adhered to. Their combined findings will reflect what can reasonably be expected in return on investment and over what period of time. A Seller is going to show only the best side of his wares. In this case, that is not acceptable. Only after the above procedure has been followed can differences be worked out if the Seller disagrees with the findings.

DURKEE, BAKER- TWOHEY INTERESTS

1. The above procedure should be followed on the claims now owned and/or any other claims purchased, if these interests are to be offered to investors.

I am advised that Frye has employed D.D. Rabb to evaluate both the Grubstake and Sorrell Too mines. The extent of his work is not known to me, nor whether he will evaluate the remaining nine claims included in Frye's offer for sale for \$1.5 million. Whatever the case may be, it is my opinion that Frye should provide a copy of Rabb's report to you before going any further with this.

Respectfully yours,



Jack R. Martin

JRM/sac

cc: Tom Baines
John Danner

JRM/sac

Abstracted Frye

ARI. NA DEPARTMENT C MINERAL RESOURCES

Mineral Building, Fairgrounds

Phoenix, Arizona

1. Information from: John W. Frye
Address: P.O. Box 115, Sonoita, AZ 85637; Phone 455-5697
2. Mine: Grubstake 3. No. of Claims - Patented _____
Unpatented yes
4. Location: Approx. 6 miles SE of Arivaca - Ruby Road (Santa Cruz Co.)
5. Sec 19 Tp 23S Range 11E 6. Mining District _____
7. Owner: Harry J. Whittinghill
8. Address: P.O. Box 91, Arivaca, AZ 85601 (Phone 398-2390)
9. Operating Co.: Grubstake Mining Development Co.
10. Address: P.O. Box 115, Sonoita, AZ 85637
11. President: John W. Frye 12. Foreman: Harold Green
~~Gen. Mgr.~~
13. Principal Metals: Au, Ag 14. No. Employed: 9
15. Mill, Type & Capacity: Ball mill, amalgam tables
16. Present Operations: (a) Down ☐ (b) Assessment work ☐ (c) Exploration ☐
(d) Production ☒ (e) Rate _____ tpd.
17. New Work Planned: _____

18. Misc. Notes: The Grubstake mine is not being worked. Instead there is a ball mill, amalgam tables, and laboratory. Ores and concentrates are treated on a custom basis. Receive much material from Mexico. Refined metal is produced. The company charges 50% of the recovery.
Some periodic production comes from the company-operated Sorrel Top mine. Mr. Frye is generally contacted by mobile phone unit 624-6646, No. 0436.

Date: 1-29-81

(Signature)

(Field Engineer)

Affidavit of Labor Performed and Improvements Made

STATE OF ARIZONA,
County of Cochise } ss.

VERNON B DALE being duly sworn, deposes and says that he is a citizen of the United States and more than twenty-one years of age, and resides at Dragoon in Cochise County, State of Arizona, and is personally acquainted with the mining claim known as Creek stake

mining claim, situate in Oro Blanco Mining District, County of Santa Cruz, State of Arizona, the location notice of which is recorded in the office of the County Recorder of said County, in Book 27 of Records of Mines, at page 75; that between the 1st day of September, A. D. 1972, and the 1st day of September, A. D. 1973, at least two hundred dollars worth of work and improvements were done and performed upon said claim, not including the location work of said claim. Such work and improvements were made by and at the expense of VERNON Dale for Lawrence F. Long owner of said claim for the purpose of complying with the laws of the United States pertaining to assessment of annual work, and VERNON DALE, Ed Grasmoen & Pat Grasmoen

were the men employed by said owner, and who labored upon said claim, did said work and improvements, the same being as follows, to-wit:

| | |
|-------------------------------------|---------------|
| <u>Mining - Six - 8-hour shifts</u> | <u>120.00</u> |
| <u>Mine Drainage - 3 shifts</u> | <u>60.00</u> |
| <u>Tools & Supplies</u> | <u>35.00</u> |
| <u>Camp & road improvements</u> | <u>50.00</u> |

FEE NO. 3178
I do hereby certify that the within instrument was filed and recorded at the request of Vernon B. Dale at 8:45 o'clock A. M. Docket No. 162 Page 202

STATE OF ARIZONA, County of Santa Cruz - SS.
on AUG 20 1973 I do hereby certify that the within instrument was filed and recorded at the request of Vernon B. Dale at 8:45 o'clock A. M. Docket No. 162 Page 202
Records of Santa Cruz County, Arizona.
WITNESS my hand and official seal the day and year first above written.
By G. ESPINOSA MORENO, COUNTY RECORDER
Laura C. Fontes
Deputy

Notary Public.

QUIT-CLAIM DEED

THIS INDENTURE, Made the 2nd day of December, 1971,
between L. F. LONG, single, Grantor, and VERNON B. DALE, Grantee.

WITNESSETH: That the said Grantor, for and in
consideration of the sum of Ten Dollars, (\$10.00), to him in hand
paid by the said Grantee, the receipt whereof is hereby confessed
and acknowledged, has, released and quit-claimed, and by these
presents does release and quit-claim unto the said Grantee, and to
his heirs and assigns forever, all the right, title, interest,
claim and demand which the said Grantor has in and to the
following described property situate in the Oro Blanca Mining
District, Santa Cruz County, State of Arizona, to-wit:

Unpatented mining claim known as Grub Stake Mining Claim
No. 1, Notice of Location of which is recorded at Page 175, in
Book 27 Mining Locations in the Office of County Recorder of Santa
Cruz County, Nogales, State of Arizona, and being situate a few
100 feet South East of U. S. M. M. No. 2. Said claim runs from
the discovery monument, or stake on which the notice is posted,
Nine Hundred (900) feet in a North West direction to the North
West center end monument, or stake, and Six Hundred (600) feet in
a South East direction from the aforesaid monument, or stake, to
the South East center end monument or stake, and is also by two
corner monuments, or stakes, at each end of said claim, one on
each side of and 300 feet from the center end monuments, or stakes,
making the claim in the form of a parallelogram.

TO HAVE AND TO HOLD the same together with all the appurtenances thereunto belonging, to the grantee, his heirs and assigns forever.

IN WITNESS WHEREOF, the said grantor has hereunto set his hand the day and year first above written.

L. F. Long
L. F. Long

STATE OF WEST VIRGINIA,

COUNTY OF Braxton, TO-WIT:

On this the 14th day of December, 1971, before me, Mary R. [unclear], the undersigned Notary Public, personally appeared L. F. LONG, known to me (or satisfactorily proven) to be the person whose name is subscribed to the within instrument and acknowledged that he executed the same for the purposes therein contained.

In witness whereof I hereunto set my hand and official seal.

[Signature]
Notary Public

My commission expires:

December 15, 1972

IVER JAMES JONES
ATTORNEY AT LAW
GIVEN BUILDING
SUTTON, WEST VIRGINIA
26601

PREPARED BY:

Jeniver J. Jones
Attorney at Law
Given Building
Sutton, West Virginia 26601

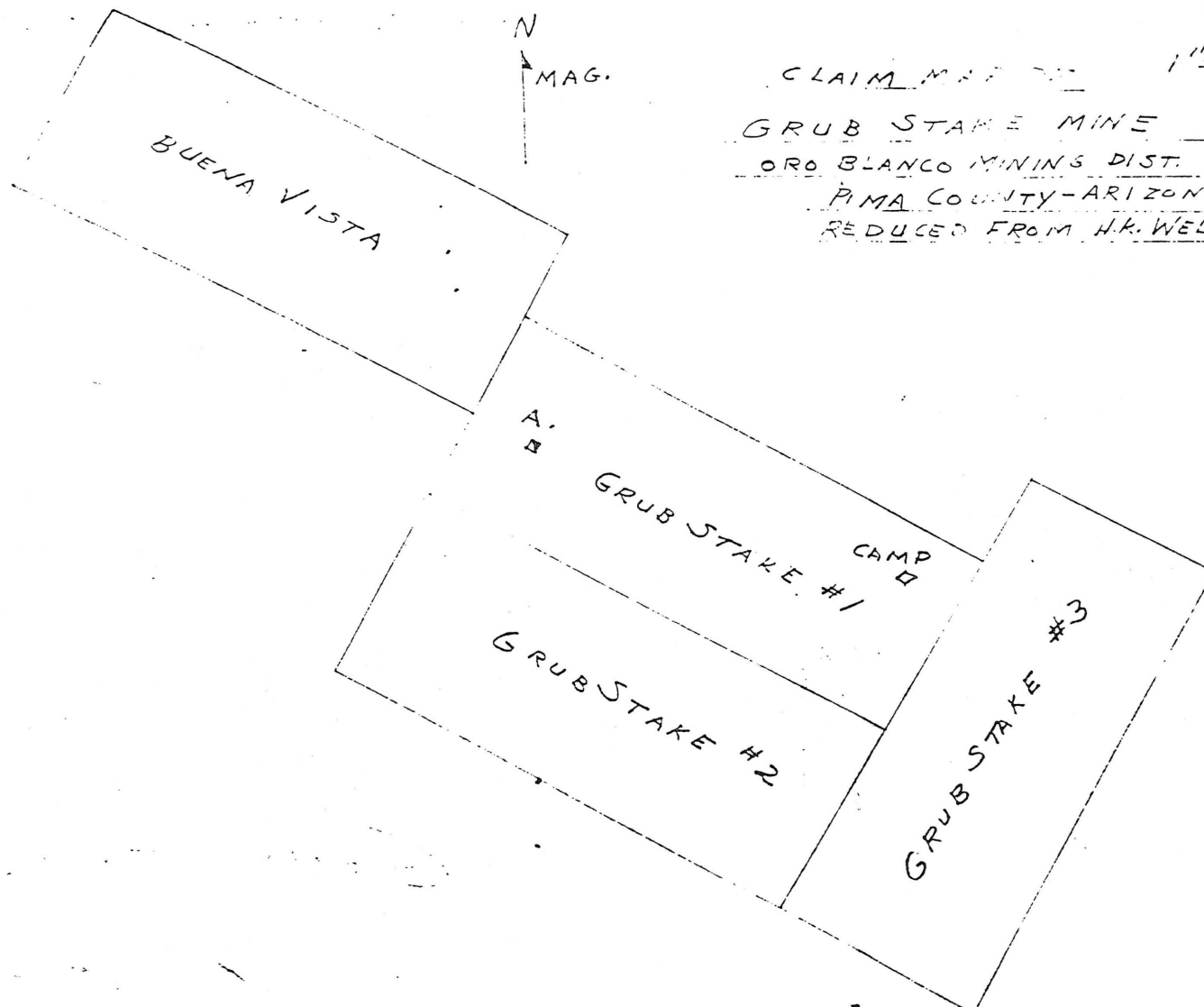

CLAIM MAP NO. 2.
 1" = 400'
 GRUB STAKE MINE
 ORO BLANCO MINING DIST.
 PIMA COUNTY - ARIZONA
 REDUCED FROM H.K. WELCH MAP

LIST OF PAYS

| DATE | TONS | ST. |
|----------|-------|-----|
| 12/12/36 | 2.46 | 0.1 |
| 5/23/35 | 26.02 | 0.1 |
| 3/20/35 | 2.81 | 0.1 |
| 8/4/35 | 2.74 | 0.8 |
| 8/8/35 | 2.80 | 0.8 |
| 8/9/35 | 5.60 | 0.6 |
| 8/10/35 | 2.85 | 0.1 |
| 8/11/35 | 3.70 | 0.1 |
| 8/13/35 | 4.44 | 0.3 |
| " | 2.50 | 0.3 |
| " | 4.75 | 0.2 |
| 8/14/35 | 2.52 | 0.7 |
| 8/15/35 | 2.775 | 0.5 |
| 8/17/35 | 2.21 | 0.6 |
| 8/15/35 | 2.22 | 0.1 |
| 8/1/35 | 2.74 | 0.1 |
| 8/1/35 | 5.60 | 0.1 |
| 7/26/35 | 3.08 | 0.1 |
| 7/27/35 | 3.12 | 0.1 |
| 7/28/35 | 3.00 | 0.1 |
| 7/30/35 | 3.00 | 0.1 |