



## **CONTACT INFORMATION**

Mining Records Curator  
Arizona Geological Survey  
1520 West Adams St.  
Phoenix, AZ 85007  
602-771-1601  
<http://www.azgs.az.gov>  
[inquiries@azgs.az.gov](mailto:inquiries@azgs.az.gov)

The following file is part of the

Arizona Department of Mines and Mineral Resources Mining Collection

## **ACCESS STATEMENT**

These digitized collections are accessible for purposes of education and research. We have indicated what we know about copyright and rights of privacy, publicity, or trademark. Due to the nature of archival collections, we are not always able to identify this information. We are eager to hear from any rights owners, so that we may obtain accurate information. Upon request, we will remove material from public view while we address a rights issue.

## **CONSTRAINTS STATEMENT**

The Arizona Geological Survey does not claim to control all rights for all materials in its collection. These rights include, but are not limited to: copyright, privacy rights, and cultural protection rights. The User hereby assumes all responsibility for obtaining any rights to use the material in excess of "fair use."

The Survey makes no intellectual property claims to the products created by individual authors in the manuscript collections, except when the author deeded those rights to the Survey or when those authors were employed by the State of Arizona and created intellectual products as a function of their official duties. The Survey does maintain property rights to the physical and digital representations of the works.

## **QUALITY STATEMENT**

The Arizona Geological Survey is not responsible for the accuracy of the records, information, or opinions that may be contained in the files. The Survey collects, catalogs, and archives data on mineral properties regardless of its views of the veracity or accuracy of those data.

PRINTED: 08/07/2001

ARIZONA DEPARTMENT OF MINES AND MINERAL RESOURCES AZMILS DATA

PRIMARY NAME: GREAT SOUTHERN

ALTERNATE NAMES:

KILROY  
HOGAN

YAVAPAI COUNTY MILS NUMBER: 219A

LOCATION: TOWNSHIP 8 N RANGE 3 W SECTION 32 QUARTER NW  
LATITUDE: N 33DEG 59MIN 55SEC LONGITUDE: W 112DEG 36MIN 05SEC  
TOPO MAP NAME: RED PICACHO - 7.5 MIN

CURRENT STATUS: EXP PROSPECT

COMMODITY:

SILVER  
LEAD  
GOLD  
FLUORINE

BIBLIOGRAPHY:

USGS RED PICACHO QUAD  
ADMMR DIAMOND JOE MINE FILE  
ADMMR GREAT SOUTHERN MINE FILE  
BLM AMC FILE 13754

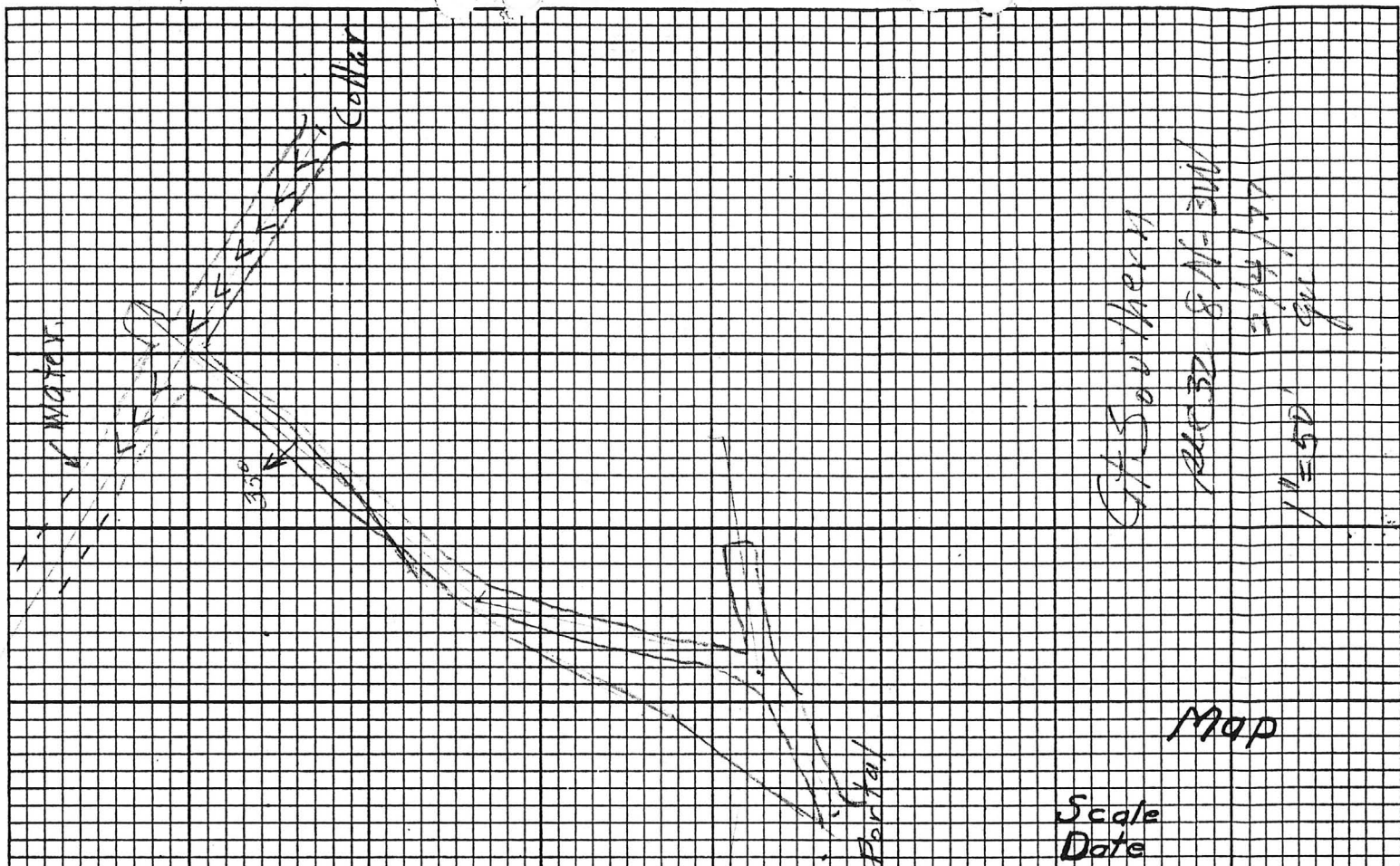

City Southern  
 RUCB 8 N-3W  
 2/1/77  
 1/15/50 gm

Map

Scale  
 Date

Section

Scale  
 Date

GREAT SOUTHERN MINE (file)

See: HOGAN CLAIMS (card)

Yavapai County  
Blue Tank Mining District

Section 32, T8N, R3W, about 8 miles southeast of Wickenburg.



GW WR 6/15/76: Went with Charles Hallman of the Rollin' Hogan Cafe, south of Wickenburg, to his 5 unpatented Hogan claims near the old Great Souther in Sec. 32, T8N, R3W, about 8 miles by road NE of Wickenburg. Here a 4' to 8' brecciated basalt(?) dike trends  $N5^{\circ}W$  and dips  $50^{\circ}E$  in which there is, in places, considerable calcite, quartz, fluorite, and galena. This structure is traceable for approximately 1500 ft along the east side of Monarch Wash. Near the north end the fluorspar and galena are major constituents for approximately 200 ft along the strike. There is an inclined shaft of undetermined depth, near the south end of the fluorspar-galena mineralization. It was suggested that the dike be properly sampled at predetermined intervals before any major investment was committed, as Mr. Hallman had previously inquired about buying a mill.

---

CJH WR 9/10/80: C.D. Hallman, Box 1122, Wickenburg, Arizona 85358, phone 684-2853. Has eight (8) unpatented claims eight miles east of Wickenburg on the Castle Hot Springs Road. The property was originally the Great Southern and then the Tyndall now the Hogan Mine. Wants to mine the property for silver. Discussed some metallurgy with him and suggested he take a sample to Dave Rabb.

*Great Southern not near Castle Hot Springs Rd.*

---

RECNO M030502  
REC\_TYPE S  
USER\_FIELD \*U94/2  
REP\_DATE 83 04  
FIL\_LINK CIMRI  
REP PETERSON, JOCELYN A.  
REP\_AFF USGS  
SYN GREAT EASTERN CLAIM, RATTLER GROUP, KILROY, HOGAN  
DIST BLUE TANK DISTRICT  
COUNTY YAVAPAI  
STATE\_CODE AZ  
CTRY\_CODE US  
PHYS 11  
DRAIN 15070103  
LAND\_ST 01  
UTM\_N 3762991.  
UTM\_E 352282.2  
UTM\_Z +12  
ACC ACC  
TOWNSHIP 008N  
RANGE 003W  
SECTION 32  
SECT\_FRACT NW/4, NEAR CORNER SEC 29, 30, 31, 32  
MERIDIAN GILA AND SALT RIVER  
LOCATION INFO FROM LAND.ST :1964  
SITE GREAT SOUTHERN MINE

---

LAT 33.9989  
LONG -112.5994  
CTRY\_NAME UNITED STATES  
COMM0D PB AG MO F  
ORE\_MAT GALENA, CERUSSITE, ANGLESITE, WULFENITE  
GAD \$22.50/TON (1923)  
MAJOR PB AG MO  
CLH\_USE 94/07/11  
TRACE F  
PROD U  
STATUS 2  
DEP\_TYPE VEIN  
DEP\_SIZE S  
DDESC\_COM PHILLIPS REPORTS THAT MINERALIZATION IS IN A BRECCIATED  
DIKE.  
QUAD250 PHOENIX  
DWORK\_COM 130 FT SHAFT ON GREAT EASTERN VEIN IN 1921, 65 FT SHAFT ON  
RATTLE R NO. 2 WITH 18 FT CROSSCUT  
NORE\_MINS HEMATITE, QUARTZ, FLUORITE, CALCITE  
CONT\_CODE NA  
GEN\_COM THIS REPORT WAS TAKEN FROM RECORD M030502 OF JAN WILT IN  
MOLYBDENU M FILE, CONTACT PERSON T.G. THEODORE, USGS ;  
INFO.SRC : 1 PUB LIT; 2 UNPUB REPT  
REF ABM FILE DATA. |RED PICACHO TOPO SHEET. |SPECIMEN IN  
COLLECTION OF STANLEY B. KEITH 2/11/80. |PHILLIPS, K.A.,  
1987, ARIZONA INDUSTRIAL MINERALS: ARIZONA DEPARTMENT OF  
MINES AND MINERAL RESOURCES MINERAL REPORT 4, 185 P.  
CONT\_NAME NORTH AMERICA  
STATE\_NAME ARIZONA  
WORK\_TYPE U  
UPD\_DATE 92 12  
UPDATER ORRIS, GRETA J.  
COMMOD\_TYP B  
QUAD24 RED PICACHO

DATE ISSUE 95/5/18  
UPD\_AFF USGS  
PROF\_ID 100  
PROF\_LOC 100  
PF\_COMMOD 100  
PROF\_EXPL 50  
PFDESC\_DEP 25  
PFDESC\_WRK 100  
PROF\_GEOL 14  
PROF\_REF 100  
PROF\_ALL 65  
HR\_TYPE\_MV GRANITE (FOOTWALL) DIABASE (HANGING WALL)  
AR\_TYPE\_MV PORPHYRITIC GRANITE  
DEP\_CODE 11000  
HUC 15070103

*rel*

D. ALAN BREESE, SR.

Assayer and Chemist

SINCE 1940

1947 SO. DECATUR STREET

DENVER, COLORADO 80219

GREAT SOUTHERN  
MINE  
CAVED STONE

WET ASSAY  
NEAR WICKENBURG

FIRE ASSAY

AREA CODE 303  
PHONE 934-3898

REPORT ON DETERMINATIONS MADE FOR...

Mr. Melvin H. Jones

Box 1196

Wickenburg, Az., 85358.

Mar. 31, 1979.

SAMPLE MARKS	METALS	Amount per		PER CENT	Value per Ton		TOTALS
		Ozs.	Ton Hds.		Dollars	Cents	
"Tinsdale" .. (High limestone.)	Gold Silver Lead	Trace/ Trace.		0.01			

GOLD AT \_\_\_\_\_ PER OUNCE

LEAD AT \_\_\_\_\_ PER UNIT

ZINC AT \_\_\_\_\_ PER UNIT

SILVER AT \_\_\_\_\_ PER OUNCE

COPPER AT \_\_\_\_\_ PER UNIT

Thank you.  
By *D. Alan Breese, Sr.*

STATE OF ARIZO.  
DEPARTMENT OF MINERAL RESOURCES  
MINERAL BUILDING, FAIRGROUNDS  
PHOENIX, ARIZONA 85007

Pink - Reading  
Subject - Great Southern  
Mine <sup>Site</sup>  
Copies - JHJ, GW

A Reconnaissance Of Part Of The Great Southern Mine

C  
O  
P  
Y  
The property, covered by three unpatented "Hogan" claims, is in Section 32, T8N, R3W, about 8 miles southeast of Wickenburg. It is shown on USGS topographic map "Red Picacho." Messrs. Henry Bain, Morristown, and Chas. Hallman, Wickenburg, are the present claimants.

The area is underlain by pre-Cambrian granite which is coarse-grained and grayish. At the portal of the adit-drift there is a 3 ft. diabase dike intruded into the granite. Along the base of the dike there is a fault which in places contains a mineralized breccia up to 3 ft. in thickness. For the first 150 ft. the adit is actually a lateral (see sketch) but finally encounters the mineralization about 100 ft. SW of the large (15' X 10') inclined shaft. A sample was cut at the intersection of the drift and shaft. The assay indicated a trace of gold, silver 1.60/ton.

On the surface near the collar of the incline the vein has been mined through an area of 20 ft. X 70 ft., the remainder is about 2 ft. thick. Just north of the shaft there is a "stack" (not a pile) of coarse ore neatly stacked into a rectangular area 20' X 50' X 4' high. A chip sample taken from the top of this ore assayed 1.36 oz. gold, 5.84 oz. silver/ton. About 10' below and 50' south of the shaft collar is another smaller "stack" of ore boulders which weren't sampled.

About 40 ft. below the drift the shaft contains water; therefore, couldn't be examined, but from the size of the dump it is probably at least 250 ft. deep.

---

G.W. Walker  
Field Engineer

3/10/77





STATE OF ARIZONA  
DEPARTMENT OF MINERAL RESOURCES  
MINERAL BUILDING, FAIRGROUNDS  
PHOENIX, ARIZONA 85007

602/271-3791

*Circulate to 02  
Especially  
Return to client  
As 3/10/77*

A Reconnaissance Of Part Of The Great Southern Mine

The property, covered by three unpatented "Hogan" claims, is in Section 32, T8N, R3W, about 8 miles southeast of Wickenburg. It is shown on USGS topographic map "Red Picacho." Messrs. Henry Bain, Morristown, and Chas. Hallman, Wickenburg, are the present claimants.

The area is underlain by pre-Cambrian granite which is coarse-grained and grayish. At the portal of the adit-drift there is a 3 ft. diabase dike intruded into the granite. Along the base of the dike there is a fault which in places contains a mineralized breccia up to 3 ft. in thickness. For the first 150 ft. the adit is actually a lateral (see sketch) but finally encounters the mineralization about 100 ft. SW of the large (15' X 10') inclined shaft. A sample was cut at the intersection of the drift and shaft. The assay indicated a trace of gold, silver 1.60/ton.

On the surface near the collar of the incline the vein has been mined through an area of 20 ft. X 70 ft., the remainder is about 2 ft. thick. Just north of the shaft there is a "stack" (not a pile) of coarse ore neatly stacked into a rectangular area 20' X 50' X 4' high. A chip sample taken from the top of this ore assayed 1.36 oz. gold, 5.84 oz. silver/ton. About 10' below and 50' south of the shaft collar is another smaller "stack" of ore boulders which weren't sampled.

About 40 ft. below the drift the shaft contains water; therefore, couldn't be examined, but from the size of the dump it is probably at least 250 ft. deep.

*Glen Walker*

Glen Walker  
Field Engineer

3/10/77

M. i. Walter

**D. R. Curry, Assayer**

# ASSAY CERTIFICATE

14437 Rios Canyon Road  
El Cajon, Calif. 92021  
(714) 443-1754

El Cajon, Calif., 2-20-77 19

I hereby Certify that the samples described below, received from

Henry Bain

assay as follows:

OWNER'S MARK AND SAMPLE	G O L D		S I L V E R		TOTAL VALUE PER TON	PERCENTAGE OF		
	Ozs. Per Ton	Value Per Ton	Ozs. Per Ton	Value Per Ton		Copper	Lead	Zinc
F Sample	Trace		1 60	7 23	7 23			slip at top
G "	1 36	187 81	5 84	26 43	214 44			sample top
H "	0 06	8 20	2 34	10 67	18.95			Red rock sample in work.

GOLD at \$138.00 per oz.

SILVER at \$4.56 per oz.

LEAD at \_\_\_\_\_ c

COPPER at \_\_\_\_\_ c

Charges

9.00 Paid

D. R. Curry

Assayer