



CONTACT INFORMATION

Mining Records Curator
Arizona Geological Survey
1520 West Adams St.
Phoenix, AZ 85007
602-771-1601
<http://www.azgs.az.gov>
inquiries@azgs.az.gov

The following file is part of the

Arizona Department of Mines and Mineral Resources Mining Collection

ACCESS STATEMENT

These digitized collections are accessible for purposes of education and research. We have indicated what we know about copyright and rights of privacy, publicity, or trademark. Due to the nature of archival collections, we are not always able to identify this information. We are eager to hear from any rights owners, so that we may obtain accurate information. Upon request, we will remove material from public view while we address a rights issue.

CONSTRAINTS STATEMENT

The Arizona Geological Survey does not claim to control all rights for all materials in its collection. These rights include, but are not limited to: copyright, privacy rights, and cultural protection rights. The User hereby assumes all responsibility for obtaining any rights to use the material in excess of "fair use."

The Survey makes no intellectual property claims to the products created by individual authors in the manuscript collections, except when the author deeded those rights to the Survey or when those authors were employed by the State of Arizona and created intellectual products as a function of their official duties. The Survey does maintain property rights to the physical and digital representations of the works.

QUALITY STATEMENT

The Arizona Geological Survey is not responsible for the accuracy of the records, information, or opinions that may be contained in the files. The Survey collects, catalogs, and archives data on mineral properties regardless of its views of the veracity or accuracy of those data.

03/29/93

ARIZONA DEPARTMENT OF MINES AND MINERAL RESOURCES FILE DATA

PRIMARY NAME: GOLDEN SLIPPER

ALTERNATE NAMES:

YAVAPAI COUNTY MILS NUMBER: 217

LOCATION: TOWNSHIP 7 N RANGE 2 W SECTION 18 QUARTER SW
LATITUDE: N 33DEG 56MIN 43SEC LONGITUDE: W 112DEG 30MIN 55SEC
TOPO MAP NAME: RED PICACHO - 7.5 MIN

CURRENT STATUS: PAST PRODUCER

COMMODITY:

GOLD
IRON SULFIDE
COPPER OXIDE

BIBLIOGRAPHY:

USGS RED PICACHO QUAD
ADMMR GOLDEN SLIPPER FILE
WILSON, E.D. ETAL. AZ LODE GOLD MINES AZBM
BULL 137 1967 P 65
WORKINGS ALSO IN SE SEC. 13

GOLDEN SLIPPER

YAVAPAI COUNTY

RRB WR 1/1/82: George E. Cook and son, P.O. Box 72, Marristown, AZ reports he has claims in section 24, T7N R3W (Harris Operation, Daniel Group, Golden Slipper).

GOLDEN SLIPPER MINE

YAVAPAI COUNTY

ABM Bull. 137 p. 65

PALMER C. BYRNE
DAVID S. ELLSWORTH

LAW OFFICES OF
PALMER C. BYRNE
FIRST NATIONAL BANK BUILDING
PRESCOTT, ARIZONA

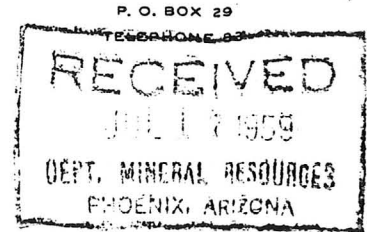

July 16, 1959

Department of Mineral Resources
State of Arizona
Fairgrounds
Phoenix, Arizona

Gentlemen: Re: Golden Slipper No. 1 and 2
 Old Mill Stream Company - Owner

I am enclosing herewith mine owners report of the above unpatented mining claims, together with copy of the map of the same.

My client the Old Mill Stream Company is anxious to sell these claims or to make some disposition of them. It has set no price, but has requested them to be listed on a "submit offer" basis.

Any correspondence in connection therewith should be addressed to the Old Mill Stream Company, c/o The Chase Manhattan Bank, 24 Pine Street, New York (15) New York.

If you desire any further information I will be glad to give it to you if I can. However, in this connection there has been listed on the report all of the information that we have concerning the claims.

Very truly yours,

Palmer C. Byrne
Palmer C. Byrne

PCB/he

DEPARTMENT OF MINERAL RESOURCES
State of Arizona
MINE OWNER'S REPORT

RECEIVED
JULY 16 1957

Date July 16, 1957

1. Mine: Golden Slipper
2. Location: Sec. 18 Twp. 7 N. Range 2 W. Nearest Town Morristown Distance 11 miles
Direction: Nearest R.R. Distance:
Road Conditions: Poor
3. Mining District and County: White Picacho, Yavapai County
4. Former Name of Mine: Golden Slipper
5. Owner: Old Mill Stream Company
Address: c/o Chase Manhattan Bank, 24 Pine Street, New York, New York
6. Operator: See remarks
Address:
7. Principal Minerals: In the past, gold
8. Number of Claims: Lode 2 Patented Unpatented X
Placer Patented Unpatented
9. Type of Surrounding Terrain: The mine is situated in a finger or trough of Tertiary volcanics protruding from a larger area of these rocks to the northeast. This trough is surrounded by Pre-Cambrian schists to the east, west and south.
10. Geology and Mineralization: The prevailing rock locally present, is a rhyolite, a great deal of which shows unusually perfect flow banding. To the northeast is an area of volcanic rocks, probably mostly flows but possibly containing some intrusive material. This series ranges from rhyolite to andesite.
11. Dimension and Value of Ore Body:

Please give as complete information as possible and attach copies of engineer's reports, shipment returns, maps, etc. if you wish to have them available in this Department's files for inspection by prospective lessors or buyers.

(over)

12. Ore "Blocked Out" or "In Sight":

Ore Probable:

13. Mine Workings—Amount and Condition:

No.	Feet	Condition
Shafts.....		
Raises.....		
Tunnels.....		
Crosscuts.....		
Stopes.....		

14. Water Supply:

15. Brief History:

16. Remarks: These claims are held by an Estate through the Old Mill Stream Company, and the Bank is executor of this Estate. Due to lack of information we would consider any offers on a submit offer basis.

17. If Property for Sale, List Approximate Price and Terms: See remarks

18. Signature:

By Theris E. Leahy 24 Pine Street, N.Y. 15, N.Y.
Treasurer

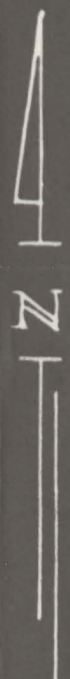
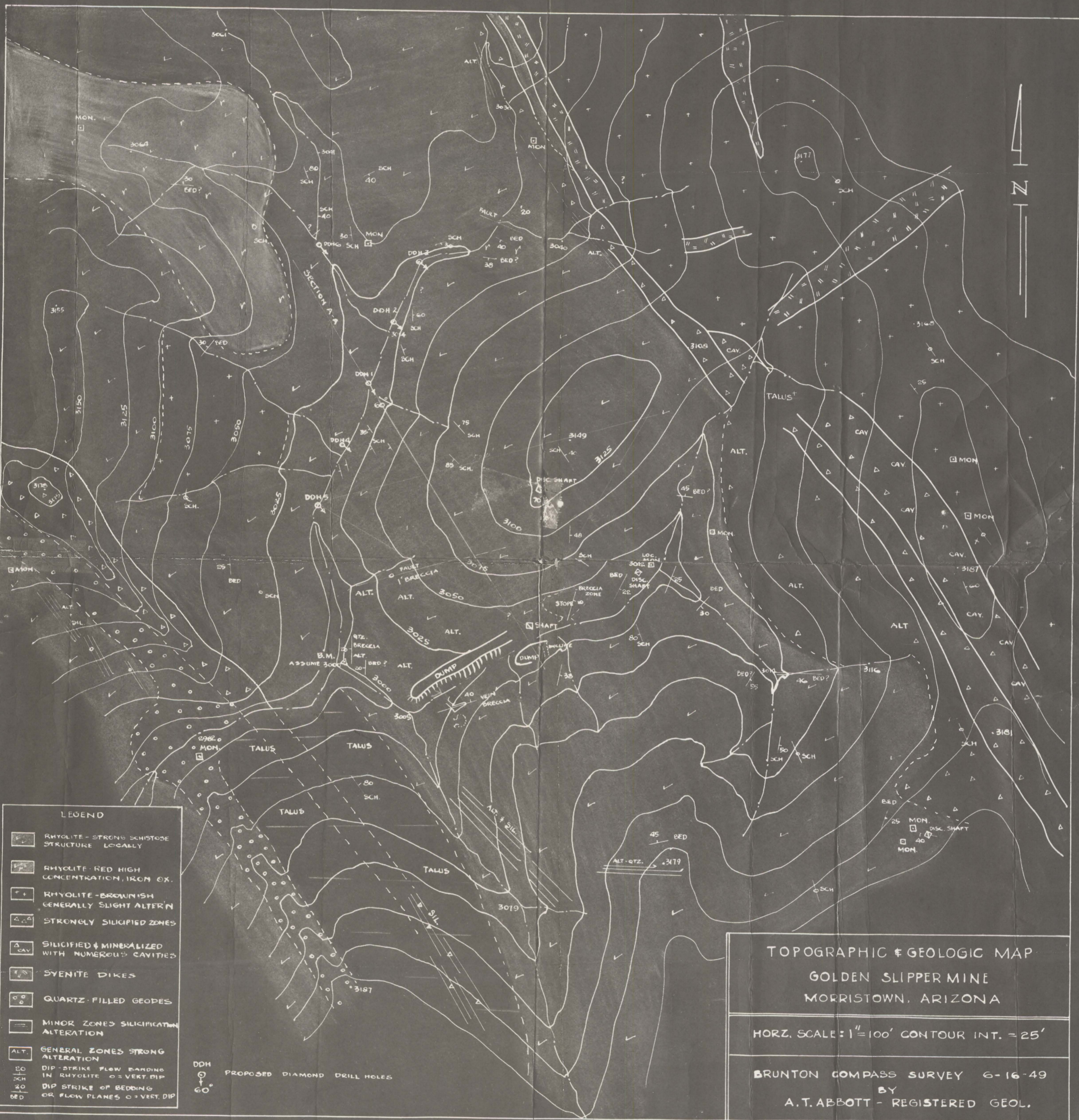

LEGEND

	RHYOLITE - STRONG SCHISTOSE STRUCTURE LOCALLY
	RHYOLITE - RED HIGH CONCENTRATION, IRON OX.
	RHYOLITE - BROWNISH GENERALLY SLIGHT ALTER N
	STRONGLY SILICIFIED ZONES
	SILICIFIED & MINERALIZED WITH NUMEROUS CAVITIES
	SYENITE DIKES
	QUARTZ-FILLED GEODES
	MINOR ZONES SILICIFICATION ALTERATION
	GENERAL ZONES STRONG ALTERATION
	DIP - STRIKE FLOW BANDING IN RHYOLITE O = VERT. DIP
	DIP STRIKE OF BEDDING OR FLOW PLANES O = VERT. DIP

DDH
 60°
 PROPOSED DIAMOND DRILL HOLES

TOPOGRAPHIC & GEOLOGIC MAP
GOLDEN SLIPPER MINE
MORRISTOWN, ARIZONA

HORZ. SCALE: 1" = 100' CONTOUR INT. = 25'

BRUNTON COMPASS SURVEY 6-16-49
 BY
 A.T. ABBOTT - REGISTERED GEOL.