

GOLD DUST AND ORION MINING Co's.

PROPERTIES AT OATMAN ARIZONA.

By RICHARD LLOYD.

The claims belong to the

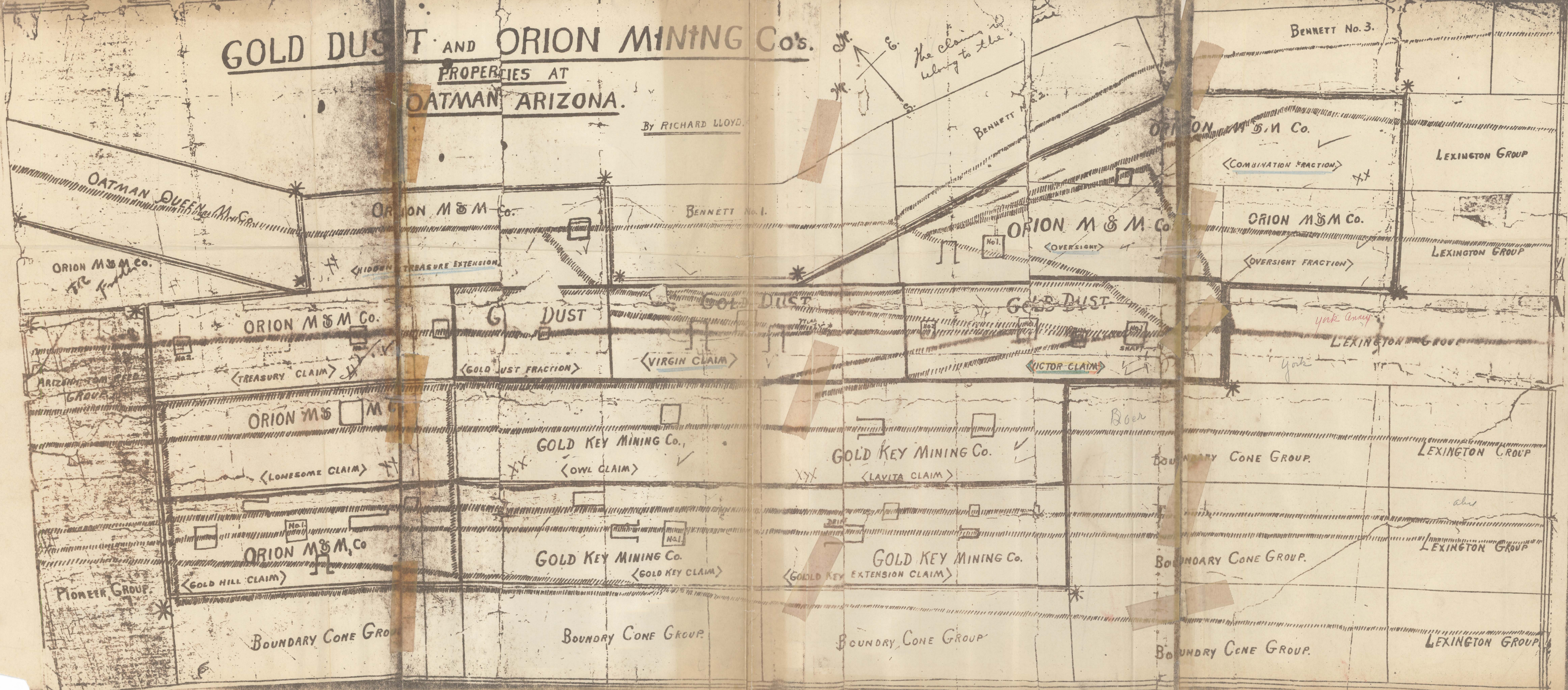

OATMAN QUEEN M Co.

ORION M & M Co.

BENNETT No. 1.

BENNETT No. 2.

ORION M & M Co.

BENNETT No. 3.

LEXINGTON GROUP

<COMBINATION FRACTION>

ORION M & M Co.

ORION M & M Co.

LEXINGTON GROUP

<OVERSIGHT FRACTION>

ORION M & M Co.

ORION M & M Co.

GOLD DUST

GOLD DUST

GOLD DUST

LEXINGTON GROUP

<TREASURY CLAIM>

<GOLD DUST FRACTION>

<VIRGIN CLAIM>

<VICTOR CLAIM>

ARIZONA REEF GROUP

ORION M & M Co.

GOLD KEY MINING Co.

GOLD KEY MINING Co.

BOUNDARY CONE GROUP.

LEXINGTON GROUP

<LONESOME CLAIM>

<OWL CLAIM>

<LAVITA CLAIM>

ORION M & M Co.

GOLD KEY MINING Co.

GOLD KEY MINING Co.

BOUNDARY CONE GROUP.

LEXINGTON GROUP

<GOLD HILL CLAIM>

<GOLD KEY CLAIM>

<GOLD KEY EXTENSION CLAIM>

PIONEER GROUP

BOUNDARY CONE GROUP

BOUNDARY CONE GROUP

BOUNDARY CONE GROUP

BOUNDARY CONE GROUP.

LEXINGTON GROUP