



CONTACT INFORMATION

Mining Records Curator
Arizona Geological Survey
1520 West Adams St.
Phoenix, AZ 85007
602-771-1601
<http://www.azgs.az.gov>
inquiries@azgs.az.gov

The following file is part of the

Arizona Department of Mines and Mineral Resources Mining Collection

ACCESS STATEMENT

These digitized collections are accessible for purposes of education and research. We have indicated what we know about copyright and rights of privacy, publicity, or trademark. Due to the nature of archival collections, we are not always able to identify this information. We are eager to hear from any rights owners, so that we may obtain accurate information. Upon request, we will remove material from public view while we address a rights issue.

CONSTRAINTS STATEMENT

The Arizona Geological Survey does not claim to control all rights for all materials in its collection. These rights include, but are not limited to: copyright, privacy rights, and cultural protection rights. The User hereby assumes all responsibility for obtaining any rights to use the material in excess of "fair use."

The Survey makes no intellectual property claims to the products created by individual authors in the manuscript collections, except when the author deeded those rights to the Survey or when those authors were employed by the State of Arizona and created intellectual products as a function of their official duties. The Survey does maintain property rights to the physical and digital representations of the works.

QUALITY STATEMENT

The Arizona Geological Survey is not responsible for the accuracy of the records, information, or opinions that may be contained in the files. The Survey collects, catalogs, and archives data on mineral properties regardless of its views of the veracity or accuracy of those data.

PRINTED: 07-21-2010

ARIZONA DEPARTMENT OF MINES AND MINERAL RESOURCES AZMILS DATA

PRIMARY NAME: GOLD CROWN

ALTERNATE NAMES:
BILLY BOONE

SANTA CRUZ COUNTY MILS NUMBER: 133

LOCATION: TOWNSHIP 22 S RANGE 10 E SECTION 26 QUARTER SW
LATITUDE: N 31DEG 28MIN 53SEC LONGITUDE: W 111DEG 17MIN 49SEC
TOPO MAP NAME: ORO BLANCO - 15 MIN

CURRENT STATUS: EXP PROSPECT

COMMODITY:
GOLD
SILVER

BIBLIOGRAPHY:
ADMMR GOLD CROWN MINES AND MILLS FILE

SANTACRU - Table Records

NUMBER 133	FILE Y	CONT 0	CONT1 N	PRNAME GOLD CROWN				
ALTNAME1				ALTNAME2				
ALTNAME3				ALTNAME4				
ALTNAME5				ALTNAME6				
CURSTAT EXP PROSPECT		MNAME ORO BLANCO - 15 MIN			NLATDEG 31		NLATMIN 28	
NLATSEC 53	WLONGDEG 111	WLONGMIN 17	WLONGSEC 49	TOWN 22 S	RANGE 10 E	SECTION 26	QUARTER SW	COM1 AU
MOD11	COM2 AG	MODI2	COM3	MODI3	COM4	MODI4		
COM5	MODI5	COM6	MODI6	COM7	MODI7			
BIB1 ADMMR GOLD CROWN MINES AND MILLS FILE								
BIB2								
BIB3								
BIB4								

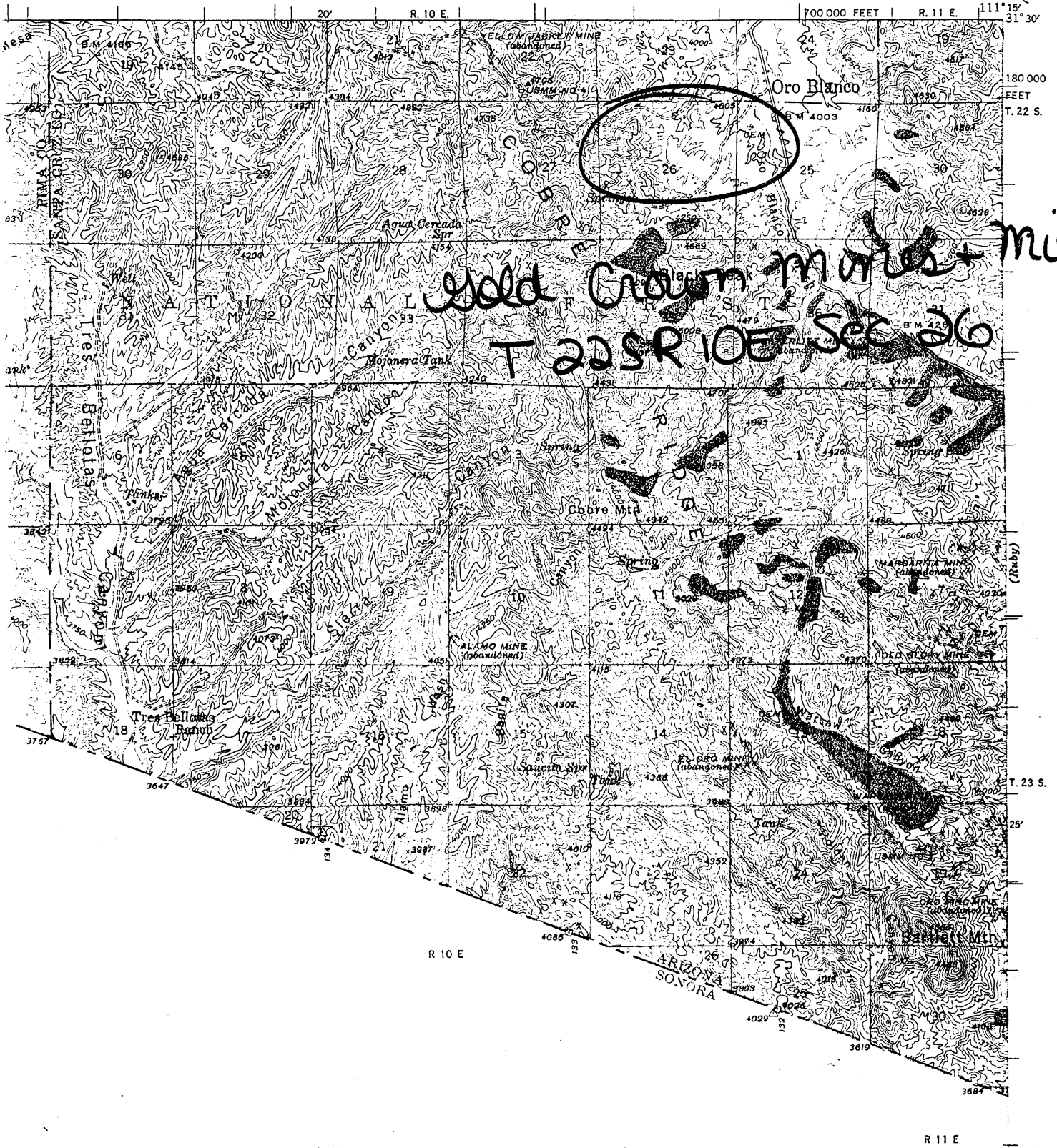

Oro Blanco 15'

GOLD CROWN MINES & MILL

SANTA CRUZ COUNTY
ORO BLANCO DISTRICT
T22S R10E Sec. 26

Santa Cruz MILS Index #133

USGS Oro Blanco 15' Quad (included in file)

DEPARTMENT OF MINERAL RESOURCES
STATE OF ARIZONA
FIELD ENGINEERS REPORT

FILED
OCT 19 1964

Mine Gold Crown Mines & Mill

Date September 1, 1964

District Oro Blanco District, Santa Cruz Co.

Engineer Axel L. Johnson

Subject: Visit to Mill. Information from Mrs. Marion Mallory and T.E. Daniels.

Location: The mill & 2 mill sites are in Sec. 26 - T. 22 S. - R. 10 E. To reach mill site, drive south from Arivaca a distance of $7\frac{1}{2}$ miles, turn left and drive $1\frac{1}{8}$ miles to the mill.

The mining claims are mostly in Sec. 27 - T. 22 S. - R. 10 E., about $\frac{3}{4}$ miles west of the mill by air line and 3 miles by road.

Owners:

(1) Gold Crown Mining Co., Ltd., Box 206, Arivaca, Ariz., composed of the following:

Mrs. Marion Mallory, 2440 East Greenlee Road, Tucson

T. E. Daniels, Box 206, Arivaca, Ariz.

Norman Adams, 1111 S. Horne St., Mesa, Ariz.

owners of 6 unpat. claims and 2 mill sites. (Names of claims shown below.)

(2) Mr. & Mrs. Guy S. Mallory, 2440 East Greenlee Road, Tucson, owners of 4 unpat. claims (names of claims shown below).

Operators: same as above

Number of Claims:

(1) 6 unpatented claims owned by Gold Crown Mining Co., Ltd., viz: - Billy Boone, Gold Crown Nos. 1, 2, & 3, and Copper Strike #1 and #2, and also 2 mill sites.

(2) 4 unpatented claims owned by Mr. & Mrs. Guy S. Mallory, viz: - Gold Spoon #s 1 to 4 inclusive.

Principal Minerals Principally gold and silver, with a small amount of copper.

Present Mining Activity: Mill construction and mill tests. 3 men working. T.E. Daniels, foreman.

Geology & Mineralization: Mrs. Mallory reports an ore vein on the Billy Boone claim about 6 to 7 ft. wide, dipping 30 degrees north with ore values running \$18 to \$20 per ton in gold and about 8 oz. in silver. The footwall & hanging wall was reported to be granite and diorite. Engineer was unable to get to the claim as the road to same is not passable.

Milling Facilities: Mill construction is now in progress, and owners report they expect to have the mill finished in 2 or 3 weeks.

Milling equipment will consist of (a) $1\frac{1}{4}$ " screen (b) small ore bin (3) 30' conveyor belt (d) $1\frac{1}{4}$ " screen (e) Stephen Gold Recovery Table (bottom deck only) (f) Wilfley Table & (g) Rod Mill amalgamator. All the equipment is installed except the Wilfley Table & the 15 ton Rod Mill, which will be delivered tomorrow.

Additional equipment which will be used in the milling operation consist of (a) 25 KW electric generator (b) 1 Hammermill (c) 1 Jaw Crusher (d) 2 small amalgamators (e) 2 bulldozers, and (f) 1 - 6 ton truck.

The mill capacity is expected to be 50 tons per 9 hour day.

Old Mine Workings: The old mine workings on the Billy Boone claims are reported to be

(1) - 1 inclined shaft - (30 deg. incline) - 40 ft. deep

(2) - 1 inclined shaft - (30 deg. incline) - 18 ft. deep

Gold Crown Mine (continued)

Proposed Plans: Proposed plans by the company are as follows: -

- (1) To finish the mill construction.
- (2) To mill the gold placer ore in the wash on the Gold Crown #1 claim near the mill site, which is reported to run from \$3.50 to \$6.50 per ton in gold.
- (3) To repair the road to the BillyBoone claim (about 3 miles).
- (4) To install a mine hoist and gallows frame at the 40 ft. inclined shaft at the Billy Boone, with arrangement for the bucket to empty directly into the mine truck.
- (5) To mine and mill the ore from the Billy Boone shaft.