



CONTACT INFORMATION

Mining Records Curator
Arizona Geological Survey
1520 West Adams St.
Phoenix, AZ 85007
602-771-1601
<http://www.azgs.az.gov>
inquiries@azgs.az.gov

The following file is part of the

Arizona Department of Mines and Mineral Resources Mining Collection

ACCESS STATEMENT

These digitized collections are accessible for purposes of education and research. We have indicated what we know about copyright and rights of privacy, publicity, or trademark. Due to the nature of archival collections, we are not always able to identify this information. We are eager to hear from any rights owners, so that we may obtain accurate information. Upon request, we will remove material from public view while we address a rights issue.

CONSTRAINTS STATEMENT

The Arizona Geological Survey does not claim to control all rights for all materials in its collection. These rights include, but are not limited to: copyright, privacy rights, and cultural protection rights. The User hereby assumes all responsibility for obtaining any rights to use the material in excess of "fair use."

The Survey makes no intellectual property claims to the products created by individual authors in the manuscript collections, except when the author deeded those rights to the Survey or when those authors were employed by the State of Arizona and created intellectual products as a function of their official duties. The Survey does maintain property rights to the physical and digital representations of the works.

QUALITY STATEMENT

The Arizona Geological Survey is not responsible for the accuracy of the records, information, or opinions that may be contained in the files. The Survey collects, catalogs, and archives data on mineral properties regardless of its views of the veracity or accuracy of those data.

PRINTED: 06-10-2009

ARIZONA DEPARTMENT OF MINES AND MINERAL RESOURCES AZMILS DATA

PRIMARY NAME: GOLCONDA

ALTERNATE NAMES:

N. STOCKTON HILL ORO GOLCONDA
GREEN LINNET MINE

MOHAVE COUNTY MILS NUMBER: 87C

LOCATION: TOWNSHIP 22 N RANGE 17 W SECTION 6 QUARTER E2
LATITUDE: N 35DEG 19MIN 28SEC LONGITUDE: W 114DEG 07MIN 36SEC
TOPO MAP NAME: CERBAT - 7.5 MIN

CURRENT STATUS: PAST PRODUCER

COMMODITY:

ZINC SULFIDE
COPPER
LEAD SULFIDE
GOLD
SILVER

BIBLIOGRAPHY:

ADMMR GOLCONDA MINE FILE
ADMMR PAC MILLSITE FILE-RPT OF 4/14/85 NJN
ADMMR MOHAVE CUSTOM MILL PROJECT
HAURY, P.S. "ZINC-LEAD MINES IN WALLAPAI MNG
DIST, MOH. CTY, AZ" USBM RI 4101, P 32; 1947
SCHRADER, F.C. "MIN. DPSTS OF CRBT RNGE, BLCK
MTNS, GRND WSH CLFS, AZ" USGS BUL 397, P 100
AZ. MNG JNL, 8/20, P 13, 10/17, P 23
DINGS, M. "WALLAPAI MNG DIST, CRBT MTN, AZ"
USGS BULL 978-E, P. 147, 153-154
THURSTIN, R.A. "NELSON TRANS TUNNEL" (ADMMR
GEOLOGY FILE)
WEED'S MINES HANDBOOK, VOL. XIII, P 368
MOORE, R. "MINERAL & WATER RESOURCES OF AZ"
AZBM BULL 180, P. 193; 1969
RME 4026, PROSPERITY & PRIMROSE CLAIMS
HERNON, R.M. "AZ ORE DEPTS-AIME REGNL MEETNG"
AZBM BULL 145, P. 112; 1938
MALACH, R. "MOHAVE CTY MINES" P. 21; 1977
ELSING, M.J. "AZ METAL PRODUCTION" AZBM BULL
140, P. 147; 1936
TENNEY, J.B. "1ST RPT OF MIN. INDUST. OF AZ"
AZBM BULL 125, P. 87, 1928
A.E.C. 172-485, P. 117

CONTINUED ON NEXT PAGE

CONTINUATION OF GOLCONDA

RANSOME, F.L. "GEOL. OF OATMAN GOLD DIST, AZ"
USGS BULL 743, P. 30-50; 1923
AZ. MNG. ASSOC. "COMM. ON BLM UPPER SONORAN
DRAFT, WILDERNESS IMPACT STATEMENT"
(ADMMR GEO. FILE)
RABB, D. "REC. OF METAL VALUES PRIOR TO RECLA
MATION OF MND AREAS OF THE SW" (ADMMR GEO F)
ADMMR MAPS UPSTAIRS DRAWER 7 FLAT FILE BOX
THOMAS, B.E. "GEOL. OF CHLORIDE QUAD" P 404,
1953 (ADMMR GEOLOGY FILE)
AZBM BULL. 397, P 100



3916

3915

3914

20'

T. 23 N.

T. 22 N.

3913

3912

(STOCKTON HILL)
3154.1 SE

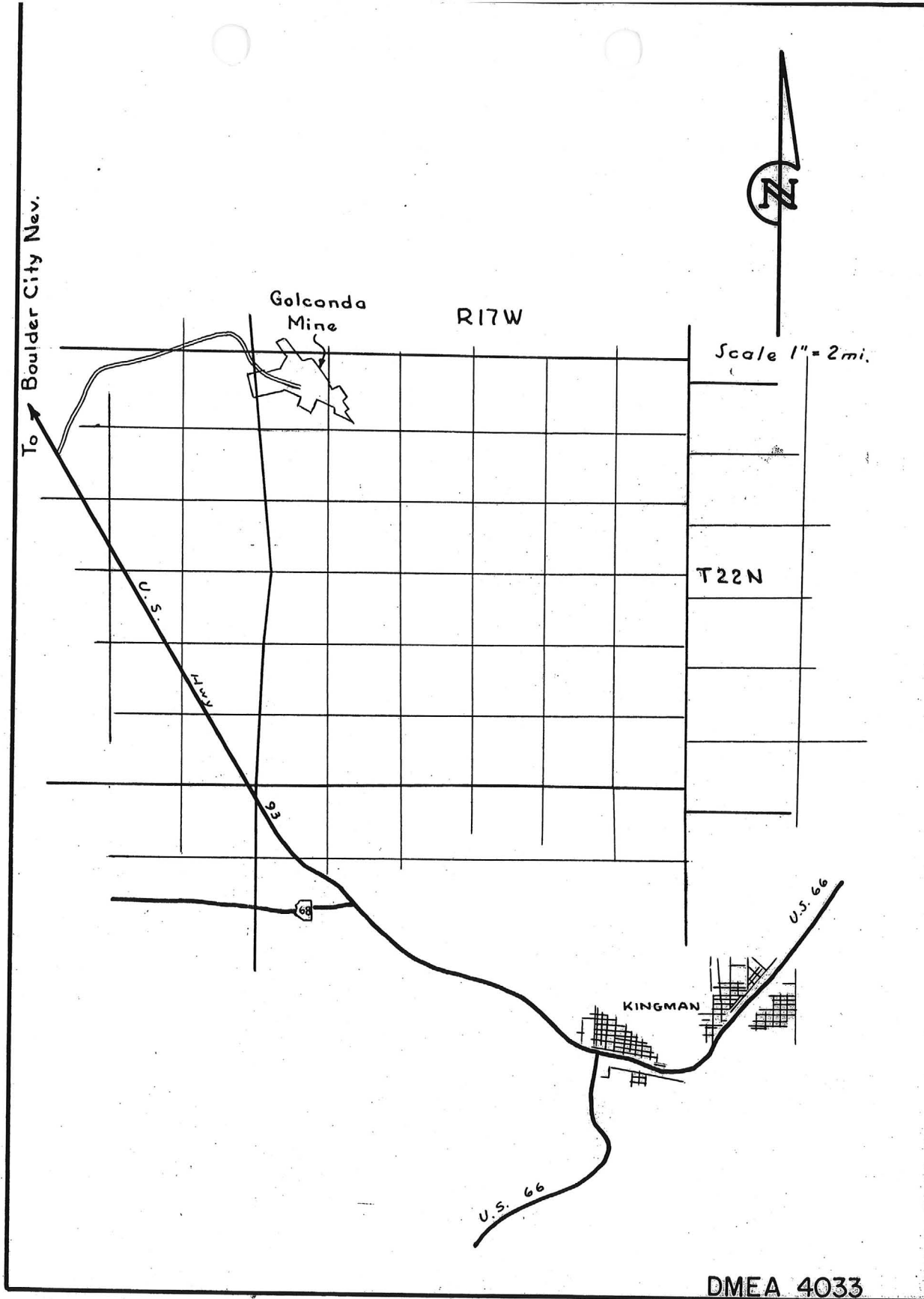

FIG. 1- LOCATION MAP, GOLCONDA MINE
THE ARIZONA GOLCONDA METALS INC.
MOHAVE COUNTY, ARIZONA

"The Arizona Golconda Metals Inc. to be added for map."

Selenium

4033

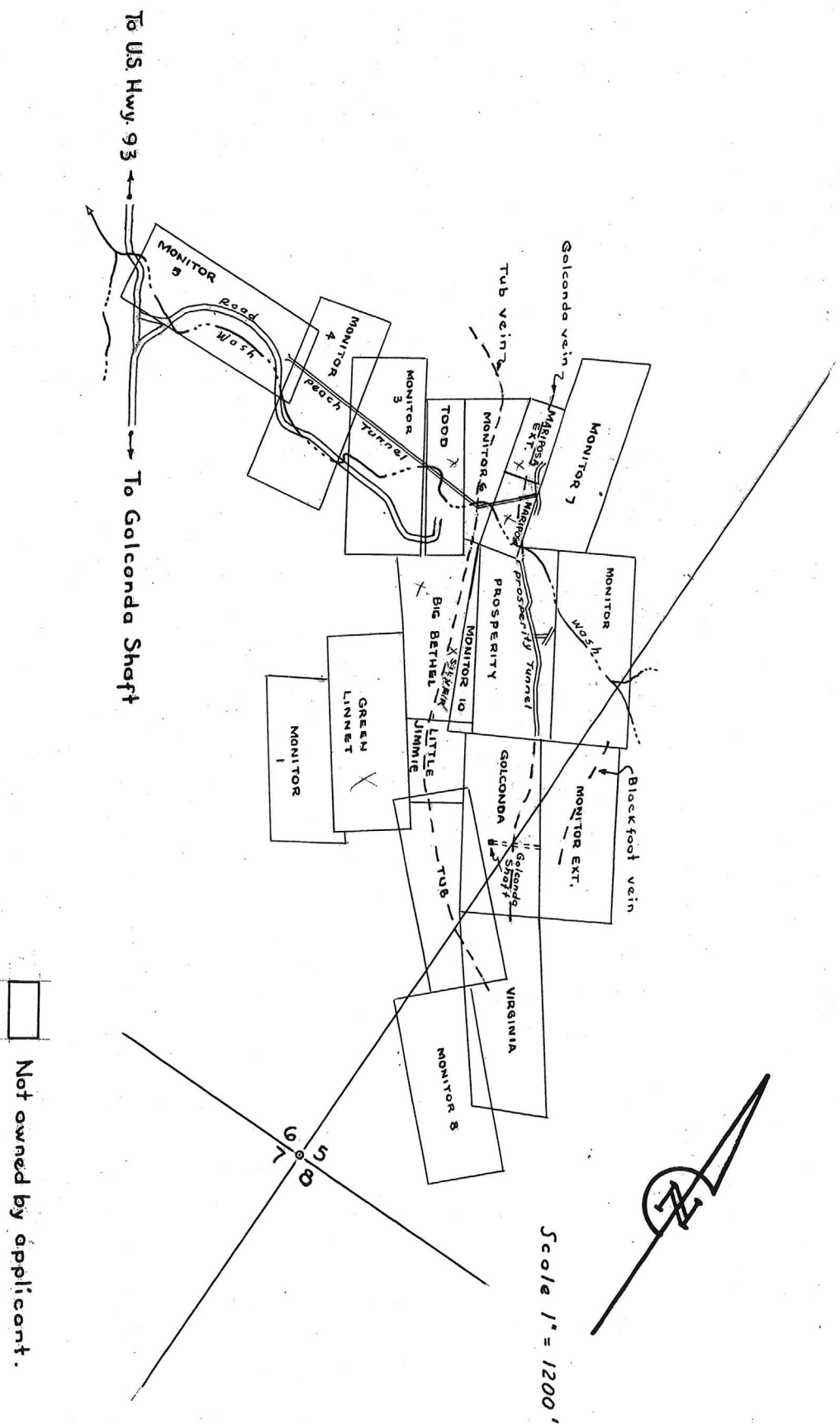

FIG-2 CLAIM MAP, GOLCONDA MINE
THE ARIZONA GOLCONDA METALS INC.
MOHAVE COUNTY, ARIZONA

DMEA 4033

	%	%
	Cu ₃ O ₈	eU ₃ O ₈
8159	0.035	0.038
8160	0.025	0.027
8161	0.128	0.075



Scintillometer Survey
Scale 1" = 50'
2 / 10 / 53

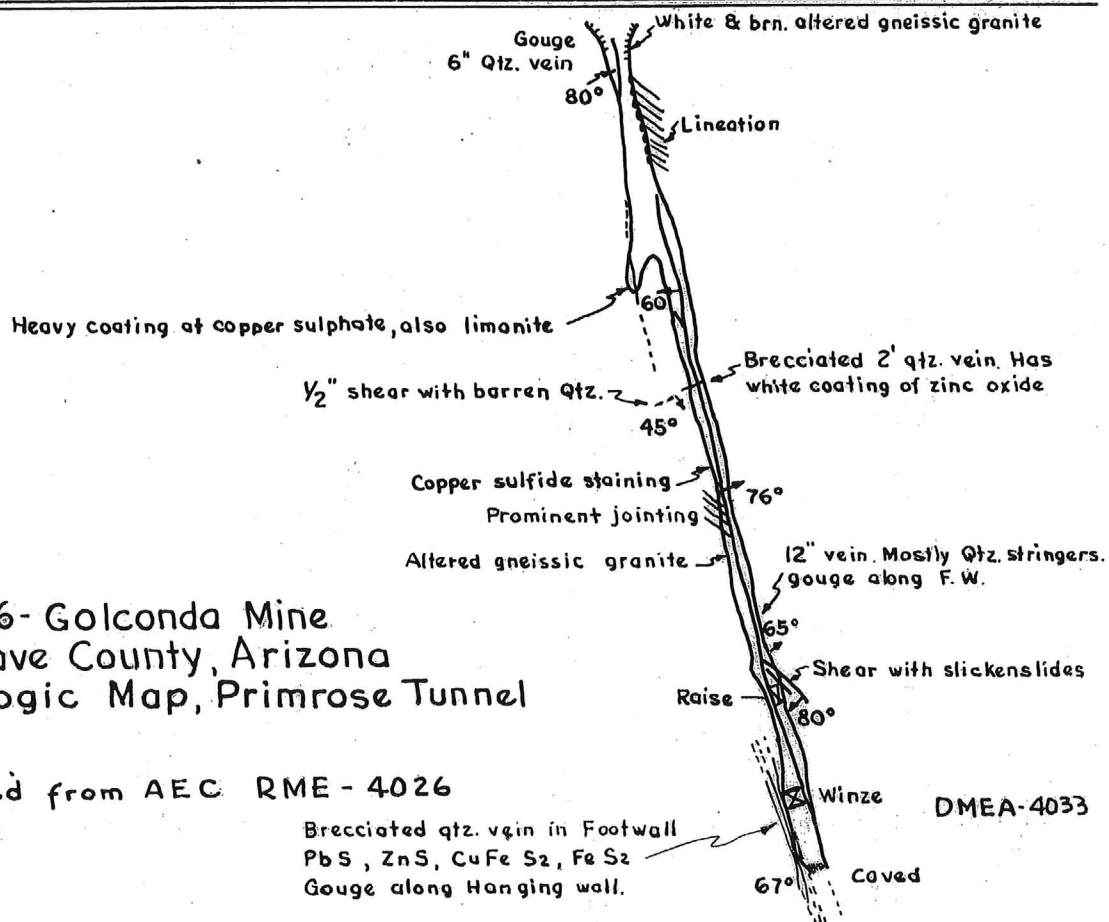
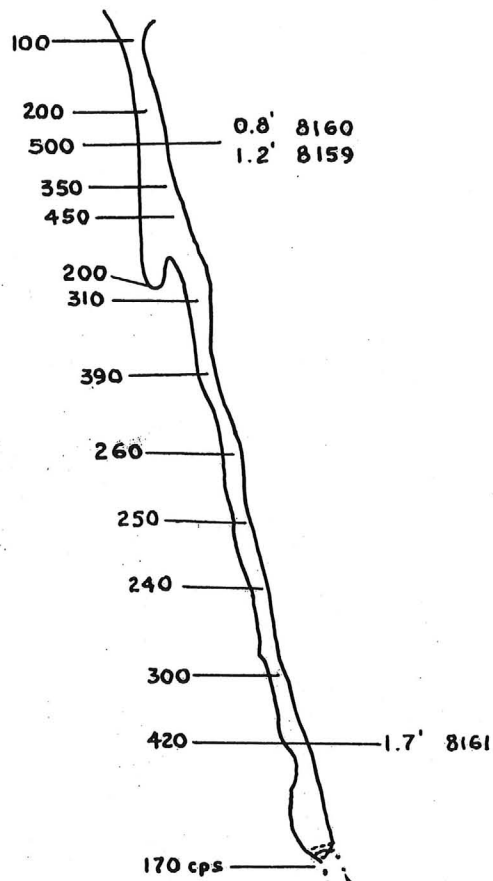

Fig-6- Golconda Mine
Mohave County, Arizona
Geologic Map, Primrose Tunnel

Copied from AEC RME-4026

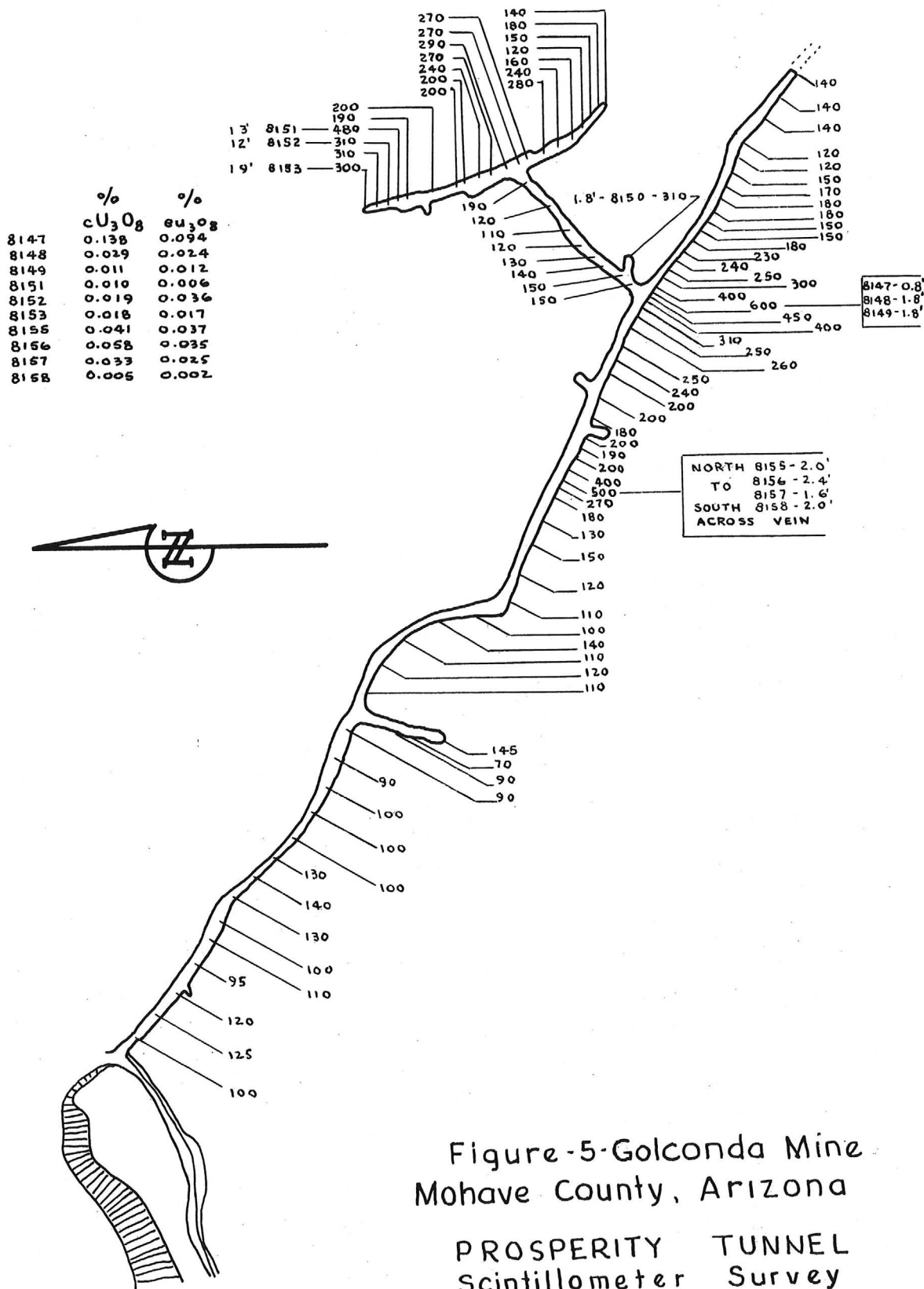

Figure-5-Golconda Mine
Mohave County, Arizona

PROSPERITY TUNNEL
Scintillometer Survey

Scale: 1" = 100'
Background = 40 C.P.S.
Feb 10, 1953

Copied from AEC RME - 4026

DMEA 4033

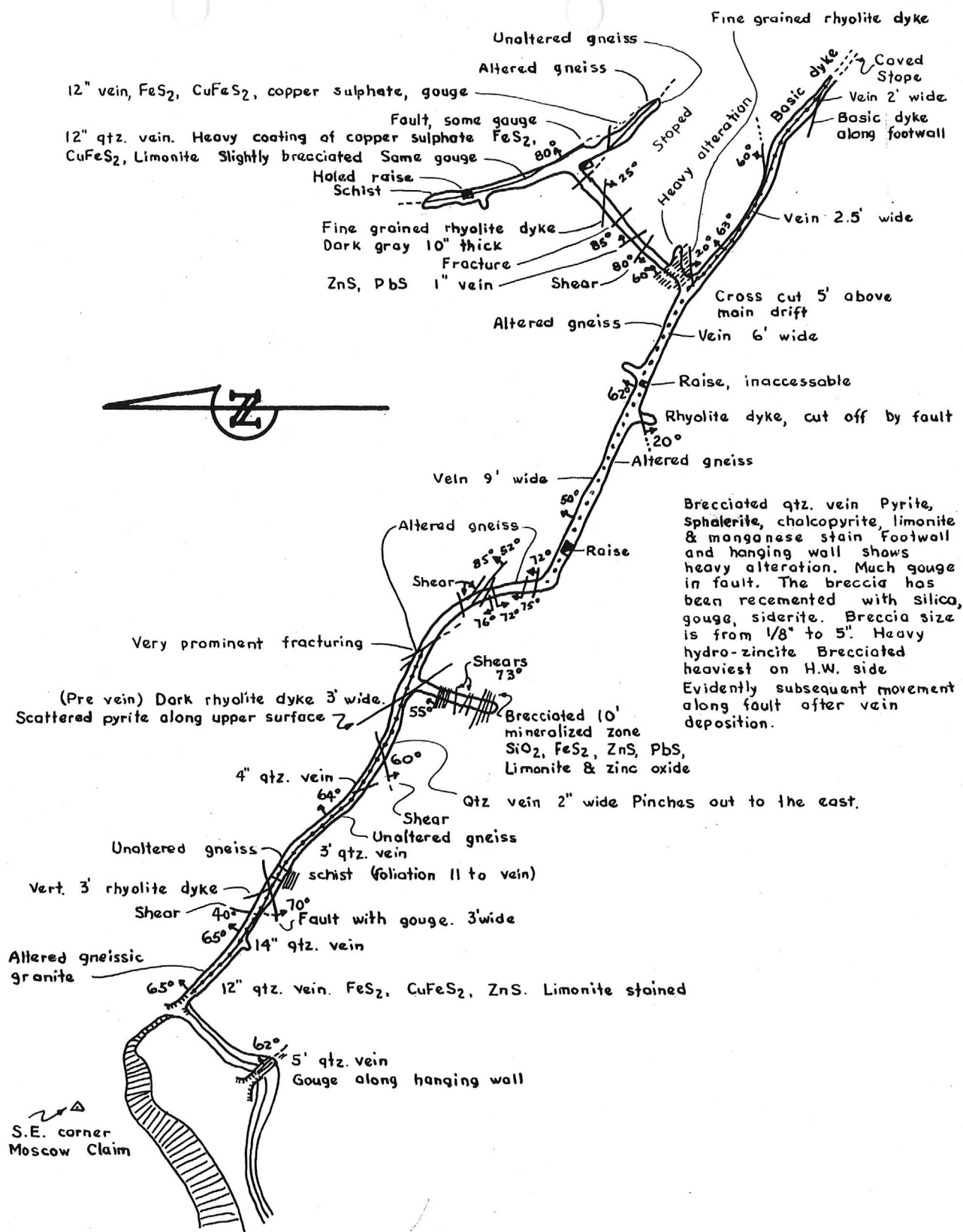

-Geologic Map-

GOLCONDA MINE

MOHAVE COUNTY

RRB WR 11/5/82: Visited the Golconda Mine. No one was there but the property appeared to be active. Ore is apparently being trucked elsewhere for processing. Sign on the gate - Resource Partners, Ltd., Lakewood, Colorado, Chloride, Arizona, Mining Division, Golconda Project.

NJN Mine Report 4/14/83: Doug Lee of the Lee Mining Corporation, P.O. Box 3849, Kingman, Arizona 86401, reported that the Resource Partner cyanide leach operation at the Golconda site has been shut down with no production of precious metals ever occurring. The BiMetals carbon plant and stripping circuit had been removed from the Golconda site and was currently sitting in the equipment yard at the PAC mine.

NJN WR 7/13/84: Ed Huskinson (c) with Gamin Resources (c) in Kingman reported that they have optioned the Golconda Mine (f) Mohave Co.

NJN WR 9/27/85: Ed Huskinson (c) reports that Gamin Resources has spent \$12,000 on road building in preparation to do 3-4,000 feet of drilling at the Golconda Mine (f) Mohave County. The plans are to drill one 2,000 feet deep hole and deflect an additional 4-3 holes from that main hole. The drilling will be from the east with the hole inclined about 70' to the west. Penetration of 4 structures is anticipated.

NJN WR 1/10/86: Ed Huskinson reported that Gamin Resources (c) has hired Boyles Brothers drillers and they are currently on site at the Golconda mine (f) Mohave County.

NJN WR 1/17/86: Ed Huskinson visited and reported that Gamin Resources (c) will be using Boyles Brothers Drilling Co.'s Navidrill system on a down the hole water driven motor to guide and direct offsets holes from the main drill hole. The main hole is currently at the 1200' of a planned 1400' depth. Mr. Huskinson provided a NE-SW cross section map thru the plane of the Golconda and Blackfoot veins.

R/H

GOLCONDA

MOHAVE COUNTY

NJN WR 10/3/86: Corwin Coe (c) Arizona Silver (c) reports that they are trying to sell the Yucca Floatation Mill (f) Mohave County to Gamin Inc (c) to use with ore from their Golconda (f) Mohave County.

GOLCONDA MINE

MOHAVE COUNTY
WALLAPAI MINING DIST.

Roy Montague of the Chico said that Big Horn Mining Co of Salt Lake City,

Clyde Davis, geologist had taken option on the Chico Mines property. They also have option on the Golden Eagle (?) and the Golconda properties.

FTJ WR 7/18/69

Pat Patterson is rehabilitating the 2000 foot Peach crosscut at the old Golconda mine south of Mineral Park. GW WR 9/6/72

Went to Pat Patterson's place and had to wait until noon for him to return from Kingman. He said they had retaken 1800 feet of the Peach Tunnel at the old Golconda mine when they encountered a gougy fault zone about 60 ft. long. After retimbering it for about 30 ft. it caved again. He, therefore, has quit work temporarily but will continue to the shaft and retimber it eventually. He also said Mr. De Lucci, San Luis Obispo mercury miner, was doing some surface drilling on the Dan Harper Rattlesnake claim west of Chloride. No one was at the rig when visited. Mr. Patterson said he was the last to drill in the vicinity of Mrs. Trevillian's Midas claim south of Chloride some 3 years ago. GW WR 11/2/72

Went to Chloride to see Pat ^APatterson, but he wasn't in. GW WR 11/1/72

Went on to Pat Patterson's place and had to wait until noon for him to return from Kingman. He said they had retaken 1800 feet of the Peach Tunnel at the old Golconda mine when they encountered a gougy fault zone about 60 ft. long. After retimbering it for about 30 ft. it caved again. He, therefore, has quit work temporarily but will continue to the shaft and retimber it eventually. He also said Mr. De Lucci, San Luis Obispo mercury miner, was doing some surface drilling on the Dan Harper Rattlesnake claim west of Chloride. No one was at the rig when visited. Mr. Patterson said he was the last to drill in the vicinity of Mrs. Trevillian's Midas claim south of Chloride some 3 years ago. (We had received a letter of inquiry from Mrs. Trevillian). GW WR 11/2/72

Pat Patterson lost his father on December 5th who had been ill for a couple of months, he was 87. Hence Pat hasn't been active at the Golconda recently. GW WR 12/6/72

Mr. Pat Patterson wasn't at home for comment on the Golconda but Mr. Mead said he had visited the property recently and that no one nor any equipment was there at the time. GW WR 2/8/73

Pat Patterson, Chloride, has had a compressed air trammer stolen from the Peach Tunnel at the Golconda mine. It was suggested he contact the Arizona Highway Patrol. Pat said Warren Mallory, pres. of Apache Oro Mining Company, Laramie, Wyoming had written him requesting he take a large number of samples from their 100+ gold claims in Los Basin (about 60 miles NE of Kingman). Pat also said he was the administrator for Arnold Dekkerts' property which he has leased to the DeLucci interests of Paso Robles, California. Mrs. Mojeski jumped Dekkerts' claims before his funeral and someone took about 35 tons of the ore toward Oatman, presumably for milling, but dumped it near Mr. Edgerton's place at the foot of the mountain east of Oatman. GW WR 3/7/73

Nyal Niemuth

From: Ed Huskinson, Jr <huskye@ctaz.com>
To: Nyal Niemuth <njn22r@hotmail.com>
Sent: Wednesday, February 02, 2000 3:08 PM
Subject: Re: My Gold Mine

Date: Tuesday, February 01, 2000 11:44 PM
Subject: Goldconda Web Page

George: Educated investors are liable to scoff at the mistakes on the web page. I suggest you change the following:

FINANCIAL OVERVIEW

- 1) Line 4. "...resent drilling.." should read "recent" drilling, with a c, not an s. And eliminate the beginning of the last sentence about drilling. Just say "Reserve calculations from Livgard Consultants, Ltd.", and that's all.
- 2) As project manager I have completed an exhaustive review. Of what? You should say "...an exhaustive review of all available data."
- 3) Tub and Blackfoot veins systems... It's a system, a vein system, and it is singular, not plural.
- 4) "The very rich reserves, indicated by drilling in the area, of the Tub shaft is considered, at the present time, as a production possibility and immediate source of revenue." This sentence has 4 commas, not one of which is necessary. People will laugh. I know I would. Try this: The reserves encountered by drilling in the area of the Tub shaft are considered to be a source of immediate production and revenue. Or keep the "present time" thing and say "The reserves encountered by drilling in the area of the Tub shaft are considered to be a source of immediate production and revenue at this time. The word "reserves" is plural; hence, it takes the plural verb "are" rather than the singular verb "is".
- 5) "....ameanable" is misspelled. It should be "amenable". The sentence would read better as follows: The ore in the Tub and Blackfoot areas appears to be amenable to high recovery of precious metal by low cost heap leach methods, and could quickly generate in excess of \$500,000.00.
- 6) "The Project Geologist.....etc....a drilling project on Goldconda?s (should be Goldconda's) neighboring mine Cyprus Amax; ...etc." This is untrue. I control a project on ground adjacent to and contiguous with the Goldconda claimblock. This ground is not owned by Cyprus Amax, and the misrepresentation could be harmful to me and to the Goldconda group.
- 7) Mr. Huskinson has also informed me that should we consider immediate bulk sales of these ores to evaluate the amounts of particular metals in the ore, namely Gemainium (should be "germanium") and gallium for calculation into those sales. Well, this should read thusly: Mr Huskinson has also informed me that we should consider running bulk assays for gallium and germanium on the Golconda ores because the revenues generated from the sale of these high-priced byproducts, often found in polymetallic sulphide systems such as these, can be quite substantial.
- 8) Last sentence: Goldcond?s should be Goldconda's

PURCHASING

- 1) Line 4. Change the words "mining claim" to the one word "property". By saying mining claim you infer that we have only one claim, a 20 acre standard-size mining claim. Correct industry usage is property, or possibly project, maybe even claimblock, but not mining claim.
- 2) "Over 1.75 billion dollars of ore by 1997 prices was found in a study by an independent firm." This is one of those sentences that teachers love to skewer, because it states that this huge amount of money was found in a study. Well, where is this study? Do they mean a library or den? Oh, a *financial* type of study. Well, was the study undertaken on the property? There are lots of studies that find 1.75 billion dollars of ore, but I guarantee none of them were written about the Golconda, maybe about some other property somewhere (like, Bre-X, maybe), but not about ours. So lose this sentence unless Livgard (or whoever) is ready, right now, to back it up. If so, then please accept my apology in advance. If not, then please accept my advice and do away with this possibly misleading sentence, ok?

FUTURE WEB DEVELOPMENT

Change the last word "mine" to the word minesite or property or claimblock or project. Use whichever of these sounds best to you. Page 2 of 2

And that's about it. You must effect these changes ASAP. The astute investor, or even the casual pair of eyeballs that just peruse the site, will be put off by the misspellings and so forth, and the guys who know what they are talking about will recognize the incorrect terminology and lack of common industry usage (buzzspeak, I think it's called). With these corrections, the site will be more palatable/attractive to possible investors. E-mail me if questions, or call in the morning. I'm tired, and have been at it since before sunup.

More later,

Ed

DENVER-GOLDEN JOINS GOLCONDA CHEMICALS
IN ARIZONA VENTURE

Accelerated exploration of the Golconda Mining properties near Kingman, Arizona, will be undertaken as part of a joint venture by Golconda Chemicals Corporation of Kingman and Denver-Golden Oil & Uranium Corporation of Denver, Colorado. The property, about 12 miles north of Kingman, involves some 21 mining claims and includes the famed Golconda mine which is credited with a production of zinc between 1908 and 1917, as well as silver, lead and gold.

Denver-Golden will direct exploration, development and mining of the property, while Golconda will handle processing of the ore. During the last three years, Golconda Chemical has devoted much of its efforts to the design and economics of a chemical manufacturing and marketing enterprise. The property was leased by Golconda in 1957.

Aerial, surface, and underground surveys will be undertaken by Denver-Golden before diamond drilling and drifting is started to delineate old or new ore bodies. If sufficient mineral reserves are blocked out by the exploration, Denver-Golden is expected to invest \$600,000 in completing the project. Operator of the Schwartzwald uranium mine in Colorado, Denver Golden is also engaged in a major exploration program on a gold property near Silverton, Colorado.

Taken from MINING WORLD, March 1961 Issue, p 56.

Allen Byrd, Res. Engr., Denver-Golden Oil & Uranium Co.,
1820 1st Nat'l Bank Bldg.,
Denver, Colorado

Active 10-1961
Property active 2-1962 - 4 men working.

From "The Wallapai Project" by Mountain States Resource Development, Inc.
Complete report in Tennessee-Schuykill file.

Ore minerals are principally cerargyrite (silver), native gold, galena (lead) sphalerite (zinc), and chalcopyrite (copper). Some arsenopyrite occurs along with cerrusite and oxidized base metal minerals. One can consider this to be a typical "Rocky Mountain Lead, Zinc, Copper Ore."

In March 1977 Messers Dale and Rudy reported on their efforts to justify a custom mill for the small miners of Mohave County. They were funded by a government grant and did their work in conjunction with a number of governmental agencies. In the northern part of the district they report 256,700 tons of dump and tailing ore grading .018 to .103 oz/T gold, .66 to 6.63 oz/t silver, .03 to .16% copper, .13 to 1.79% lead and .50 to 3.56% zinc. They considered this to be proven ore.

It is interesting to note that this is only the northern part of the district and only includes materials that were easily accessible. Items like the buried table and jig tails at the Tennessee were not included.

H. Mason Coggin, a well known and respected mining engineer, evaluated the Copper Age group of claims in April, 1980. He measured many ore occurrences and interpreted a number of undeveloped one in the Copper Age group has a potential of 4.730 million tons averaging \$200/ton.

In the Hidden Treasure section of the property Mr. Coggin estimates .5 million tons of ore grading \$200/ton or better.

The Arizona Bureau of Mines lists the following known reserves in the Wallapai Mining District:

Mine	Tons	% Cu	% Pb	% Zn	oz/T Au	oz/T Ag
Banner	3841	.5	22.6	11.9	.21	7.4
	5000	.5	22.6	11.9	.21	7.4
Summit	25,000	.58	4.3	6.3	.066	4.5
	25,000	.58	4.3	6.3	.066	4.5
Golconda	400,000	.5	.5	14.0	.20	4.0
	40,000	.5	.5	14.0	.20	4.0
Fountain Head	1,250	.61	.65	16.4	.2	3.5
	3,750	.61	.65	16.4	.2	3.5
Detroit	1600	2.31	1.0	5.5	.01	7.2
	1600	2.31	1.0	5.5	.01	7.2
Wrigley	56,000	.1	9.0	.1	.1	.2
Tennessee	29,503	.1	4.1	8.2	.01	.2
	50,000	.1	4.1	8.2	.01	.2

Mr. Eldon Lee

9 Jun 82

Page 4

Tennessee	100,000	.1	4.1	8.2	.01	.2
New Moon	11,000	.1	5.0	8.0	.05	7.5
	9,900	.1	5.0	8.0	.05	7.5
	10,000	.1	5.0	8.0	.05	7.5
Minnesota	900	.6	5.0	4.0	.01	.2
Lone Jack	2000	.19	5.51	4.66	.035	3.47
Copper Age	7,000	.1	3.6	7.3	.06	2.0
	7,000	.1	3.6	7.3	.06	2.0
Champion	570	.1	8.0	15.6	.26	10.0
	6,000	.1	8.0	15.6	.26	10.0
	6,000	.1	8.0	15.6	.26	10.0

While the above represent substantial exploration and are very conservative, especially since this is what their taxes are based upon, it is not fully conclusive. Mining costs, metallurgical techniques and markets must be developed. However these do show the substantial amounts of ore left in the mines.

Howard H. Heilman examined the Golconda Mine in great detail. He measured the reserves in numerous structures and defined those reserves as follows:

Virginia	350,000 tons
Tub	400,000
Little Jimmie	150,000
Peach Triangle	350,000
Golconda	300,000
Prosperity	80,000
Primrose	80,000
Blackfoot	90,000
	<u>1,800,000</u>

Mr. Heilman values these ores as follows:

Zinc	16%
Lead	.5%
Copper	.5%
Gold & Silver	\$120.00/T*

* Bases on \$300/oz gold and \$6.00/oz silver.

The whole emphasis that comes from the Golconda reports is that the mine was shut down when the fire occurred and once stopped was not restarted. The stopes that were in production are in approximately the same situation as when the mine closed.

Tonnages as indicated above were confirmed by H. G. Humes and The American Metal Company. Grades in their estimates ran higher in lead and copper and slightly lower in zinc.

Mr. Eldon Lee
9 Jun 82
Page 5

Dump samples on the Golconda were taken and measurements of tonnage were made. The measured tonnages are as follows:

Chats	15,000 tons
Lower Blackfoot	3,000
Middle Blackfoot	7,000
Upper Blackfoot	500
Prosperity	8,000
Tub	3,000
Silver	7,000
Tails	20,000
Golconda	30,000
	<u>93,500</u>

Of the dump ore, approximately 6,000 tons of it will not meet \$65/T gross metal value criteria leaving some 87,500 tons.

Samples taken by CEC have confirmed some of the grades quoted. The ongoing program of sampling each dump by complete trenching and then metallurgical testing the sampled material will accurately prove not only the tonnage and assay of each dump, but will also define what can be recovered from these dumps.

Metallurgically the ores in the Wallapai District are best treated by flotation. Recoveries as follows can be expected on ores that are freshly mined:

Lead and Silver	90-95%
Copper and Gold	85-90%
Zinc	75-85%

Ores that have been oxidized by weathering (e.g. dump ores) are also best treated by flotation unless the weathering is severe. One might expect a 5% reduction in recovery, but otherwise the treatment should be unaffected.

Gravity separation means can also be used on the Wallapai ores. Recoveries are lower, but oxidation has no effect. Some cases of highly oxidized ores yield higher recoveries than flotation, but these are not very important in the district.

Ores with high sulfides should never be treated by leaching techniques. This is a waste of time, money and resources.

The most important item in determining the best method of treatment is metallurgical testing. Ores, even ores from similar mines, must be tested and the parameters for optimum treatment established. A few dollars spent on professional metallurgical testing will save hundreds of thousands in the final analysis.

Summarizing one can state that dump ores and tailings in the district—that will meet a \$65/T gross metal value are substantial. If the reports issued by competent personnel quoted herein are correct the tonnage is in excess of 300,000 tons. While CEC is

DEPARTMENT OF MINERAL RESOURCES

STATE OF ARIZONA

FIELD ENGINEERS REPORT

Mine Golconda
District Wallapai
Subject: Production

Date May 1, 1985
Engineer Ken A. Phillips

Recorded production from the Wallapai mining district,
MOHAVE County according to an abstract of U. S. Bureau of Mines
data was obtained from the Arizona Bureau of Geology and Mineral Technology.

Production is recorded for the period 1908-1957

Cumulative totals are:	Tons of ore	206,103
	Pounds of copper	359,423
	Pounds of lead	2,030,785
	Troy ounces of gold	17,626
	Troy ounces of silver	433,784
	Pounds of zinc	47,873,654

The following mines or mining claims in the district contributed to the
production: Golconda

GOLCONDA 11 11/10

GAMIN RESOURCES INC.

SUITE 406-837 WEST HASTINGS STREET
VANCOUVER, B.C., V6C 1B6
TELEPHONE (604) 662-7110

November 12, 1985

NEWS RELEASE

Management is pleased to announce the commencement of diamond drilling on the "Golconda" mining properties. The initial three thousand five hundred feet (3,500') of diamond drilling is being done under contract with Boyles Bros. Drilling Company.

Gamin Resources Inc. has recently received two hundred and seventy-five thousand dollars (\$275,000.00) by way of a financing through the facilities of the Vancouver Stock Exchange. With financing in hand the Company will carry out the programs as recommended by Thomas R. Tough, P.Eng.

During the past several weeks, access roads to the "Golconda" mining properties were upgraded and diamond drilling pads for equipment were constructed. Geological and ground surveys were also undertaken.

The property is located 15 miles north of Kingman, Arizona and within a four mile radius of the Company's "De La Fontaine", "Sixty-three", and "IXL" properties.

The "Golconda" is comprised of five (5) patented and sixteen (16) lode mining claims.

Listed below in order of historical significance are the fourteen (14) mines which exist on the Golconda property and have produced in the past:

Golconda	Green Linnet
Tub-Bethel	Mexican
Prosperity	Oro Fino
Primrose	Virginia
Little Jimmy	Gold Reserve
Blackfoot	Copper King
Peach	Black Metal

The "Golconda" mine was last worked on October 17, 1917, when a fire devastated the mill and head frame at the top of the 1,400 foot deep incline shaft. This milling plant had been rebuilt two or three weeks prior to the fire to operate at 250 tons per day, and fire insurance reduced to half in June 1917 with the installation of new fire hydrant equipment plus additional water pumping and storage areas. The accidental fire was caused by an overflow of heavy residual fuel used to fire the "oil field type boiler" during the "shakedown runs" of the new mill. Reconstruction of a new milling plant was planned to begin almost immediately following the fire; World War I ended, zinc prices failed, and other than sporadic promotions to re-open the mine, no further mining was undertaken.

John D. Wanvig, Jr., mining engineer and superintendent of the "Golconda" mine from 1915 to 1917 reported in his letter of March 28, 1919 that: "during the last nine months of production, fully twenty-five (25) percent of the mill feed ores came from development work. Gold and silver values increased in the mine with depth".

Smelter returns for 1915 show \$2.57 per ton in gold and silver values. Smelter returns for 1917 show \$9.46 per ton in gold and silver values. Gold price at that time: \$20.65 per ounce; Silver \$0.79 per ounce.

"United States Geological Survey" puts the "Golconda" mines production for the two years previous to the 1917 fire at:

Gold	20,752 ounces
Silver	510,180 ounces
Copper	354,703 pounds
Lead	2,031,719 pounds
Zinc	56,226,020 pounds

The mine run materials averaged per the mill heads in 1917:

Gold	0.20 ounces per ton
Silver	4.50 ounces per ton
Zinc	16 + % (320 pounds plus per ton)
Copper	.5% (10 pounds per ton)
Lead	.5% (10 pounds per ton)

Mr. Tough further states: "Almost all of the known veins on the property have experienced surface and/or underground development with varying amounts of production reported."

Tub-Bethel Vein:

"The Tub-Bethel Vein was worked from a cross-cut driven from the 300-foot level of the Golconda Mine which cut the vein at 150 feet (46 m) down dip from the surface. Widths of 40 to 50 feet (12 to 15 m) were encountered." In 1912, it was reported that "one carload, roughly sorted of large waste boulders, averaged 0.60 oz. gold/ton, 9.9 oz. silver/ton, 32.6% zinc (652 pounds per ton), and 6% lead (120 pounds per ton)."

Allen C. Redding (consultant) reported to the company June 30, 1913: "Vein 40' to 50' wide" and "blocked out mill ore averaged 15% to 18% zinc" (300 to 360 pounds) "and \$8.00 to \$10.00 in precious metals." (1913 prices for gold and silver).

The Primrose Tunnel Workings:

"The Primrose Tunnel workings, connected to the Prosperity Drift, were also rehabilitated in 1957. The vein experienced production, but the exact figures are not known. The Bethel Tunnel, some 700 feet (213 m) in length, cross-cuts the Primrose Vein below the lowest Primrose levels. Contains values primarily in silver, gold and copper."

The Prosperity Tunnel:

"The Prosperity Tunnel was driven for a length of 1,950 feet (595 m) at the same elevation as the 600 foot level of the Golconda workings, where it connects with the shaft and drains the water from the shaft to this level. (The U.S.G.S. stated that there was sufficient water made in the workings to operate a 300 ton/day flotation mill). Rehabilitated for 1,650 feet (503 m) in 1957 by Golconda Chemicals Corporation, vein widths of nine feet (2.7 m) were encountered with good grades. Production from the vein was considerable and the mined material averaged \$220.00 per ton prior to 1935."

Blackfoot Vein:

"Mineralization consists of gold, silver and secondary copper minerals. Values ran as high as 180 oz. of silver/ton, 3.0 oz. gold/ton and 15% copper" (300 pounds/ton). "Six carloads of hand-sorted material were shipped from the dumps in the 1930's and smelter sheets showed an average of 0.27 oz. gold/ton, 27 oz. silver/ton, 6% zinc, 0.5% lead and 0.3% copper. High grade sphalerite was encountered at depth."

Mexican Vein:

"The Mexican Vein dips to the northeast, strikes to the northwest, has produced considerable high grade material from shallow workings, reported to have averaged 9.0 oz. gold/ton and 312 oz. silver/ton."

Peach Tunnel'

"The Peach Tunnel was driven a length of some 3,500 feet (1,067 m) at the same elevation as the 1,000 foot level of the Golconda Mine. The Peach Tunnel connects with the Oro Plata Shaft" and "there is between 400 and 800 feet (122 and 244 m) to be driven to reach the Golconda shaft workings." The Oro Plata "production by 1935 amounted to \$500,000.00" and "grade prior to 1935 was stated to have averaged 3.0 oz. gold/ton, 25 oz. silver/ton and 6% lead."

The balance of the property workings consists of shallow shafts, short drifts and cross-cuts. Although records indicate that highgrade gold, silver, zinc and lead were shipped, space considerations do not permit discussions of them at this time. Nevertheless, they remain as potential target areas for future exploration work.

Golconda Chemicals Corp., through old records, geological and engineering reports, consultants' reports and the rehabilitation of old workings, including mapping and sampling, estimated the potential tonnages to be in excess of one million eight hundred thousand (1,800,000) tons, containing values in zinc, gold, silver, copper and lead.

Targets for the tonnage:

Golconda	deeper and along strike of vein
Tub-Bethel	deeper and along strike of vein
Prosperity	deeper and along strike of vein
Primrose	deeper and along strike of vein
Blackfoot	deeper and along strike of vein
Little Jimmy	extension of the "Tub-Bethel" vein to the north
Virginia	intersection of "Golconda", "Tub-Bethel" and "Blackfoot" veins to the south
Peach	confluence of "Golconda", "Tub-Bethel", "Primrose" and "Blackfoot" veins to the north

It should be noted that "the De La Fontaine Vein" (see Newsletter dated October 31, 1984) "which forms part of the eastern extension of the Golconda system, was thoroughly mapped and sampled by Gamin Resources Inc. in 1984. Reserve estimates based on this evaluation resulted in 23,311 tons grading 1.34 oz. silver/ton, 10.17% lead (203.40 pounds per ton), 4.72% zinc (94.40 pounds/ton) and a further 9,438 tons with a weighted average grade of 0.65 oz. silver/ton, 4.80% lead (96 pounds/ton) and 2.60% zinc (52 pounds/ton)." Excellent additional reserve potentials exist along strike and downdip.

The United States Department of the Interior-Bureau of Mines Report of Investigation 4101 dated August 1947, "Examination of zinc-lead mines in the Wallapai Mining District, Mohave County, Arizona", stated that samples and shipments made from the mine predominated in zinc. Example: "The mine was operated recently" (1943) "and yielded two carloads of sorted ore in the last few months. The reported metal content of these shipments was 14% lead" (280 pounds per ton), "28% zinc" (560 pounds per ton), "0.02 ounces of gold and 2.0 ounces of silver per ton." This material was obviously taken from the areas of limited stoping mentioned earlier, and at today's values of 18¢ per pound for lead, 38¢ per pound for zinc, \$6.00 per ounce for silver and \$325.00 per ounce for gold would average \$281.70 per ton of material.

Mr. Tough recommends a two phase program. "The main target areas are along strike and to depth on the Golconda-Prosperity-Primrose-Oro Plata Vein System, the Tub-Bethel structure, the Blackfoot Vein, the Little Jimmy Vein; the area of intersections of the Golconda, Tub-Bethel and Blackfoot Veins on the Virginia claim, and the Bronco Dyke area." Both surface and underground diamond drilling is to be undertaken, as both underground and open pit potential exist, including the possibility of "blind" zones that do not outcrop. "The De La Fontaine Vein should be drilled to test the mineralized zone along strike and to depth." As work progresses, the numerous other attractive target areas will be reported on and incorporated into the exploration program.

Roughly based on the gold, silver, zinc, copper, lead values reported in previous production, and the tonnage potentials outlined, a suggested 300 ton per day mining and milling operation would have the following estimated cash flows (in American dollars):

Zinc	16.0% (320 pounds per ton)	@	\$.35 per pound	=	\$112.00
Gold	0.20 ounces per ton	@	320.00 per ounce	=	64.00
Silver	4.50 ounces per ton	@	6.00 per ounce	=	27.00
Copper	.5% (10 pounds per ton)	@	0.60 per pound	=	6.00
Lead	.5% (10 pounds per ton)	@	0.18 per pound	=	1.80
Estimated gross value per ton:					<u>\$210.80</u>

Assumptions:

Dilution of ore in mining:	less 10% (210.80 - 21.08 = \$189.72)	
Metals recovered in milling operations:	approx. 95% (95% of \$189.72 = \$180.00)	
Estimated cost of mining, milling, shipping, smelting, overhead, etc.:	\$58.00 per ton	
Estimated net value per ton:		<u>\$122.00</u>

Yearly income based on a 300 ton per day mining and milling operation is estimated as follows:

\$122.00 per ton x 300 tons per day x 350 operating days per year = \$12,810,000 (Can. \$17,357,000) net before government taxes, repayment of capital or interest on borrowings, etc.

Attractive long term benefits and growth projections are at hand for Gamin Resources Inc. In the short term, the diamond drilling program will benefit the Company by re-establishing known reserves and by locating and verifying the attractive new areas of potential mineralization.

Respectfully prepared
and submitted from
information provided by
the Company's representatives
and consultants

On behalf of the Board of Directors

Allen B. Stinson
Director & President

Listed:
Vancouver Stock Exchange
Symbol: GAMV

GAMIN RESOURCES INC.

Capitalization:

Authorized — 10,000,000 common shares
Issued — 2,981,344 common shares

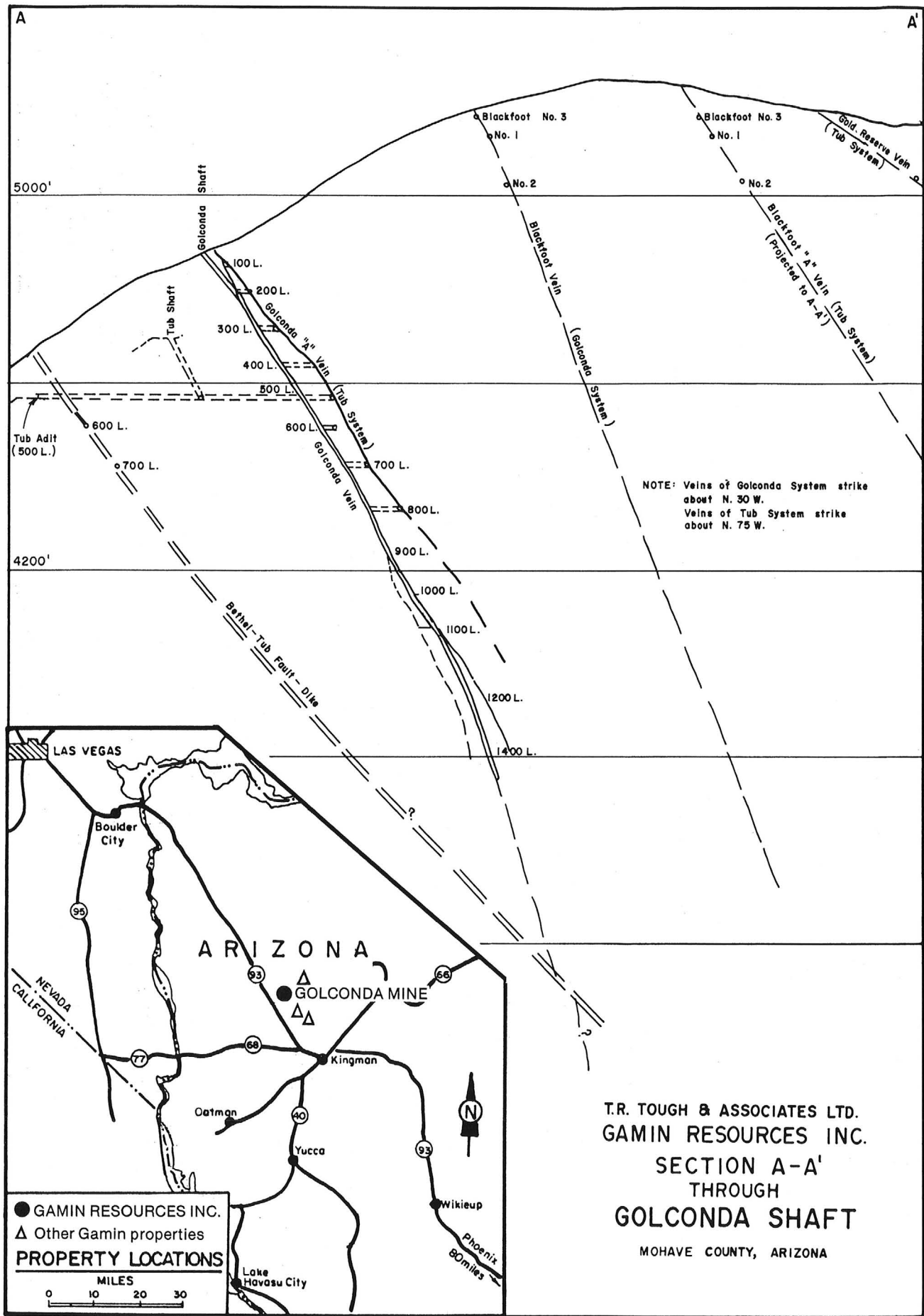

CORPORATE INFORMATION

Head Office: 406-837 West Hastings Street
Vancouver, British Columbia V6C 1B6 (604) 662-7110

Geological Consultants: Thomas R. Tough, P.Eng.
408-850 West Hastings Street
Vancouver, British Columbia V6C 1E1 (604) 687-2922

Officers and Directors: Allen B. Stinson
President & Director
Robert A. Stinson
Vice President & Director
Tatjana K. Pessl
Secretary/Treasurer & Director
John J. Oberbillig, P.Eng.
Director
Silvia F. Rutledge
Director
Barry D. Speton
Director

Shares Listed: Vancouver Stock Exchange
Trading Symbol GAMV
Standard and Poor's Corporation
Corporate Records & Financial Coverage

Transfer Agent and Registrar: National Trust Company
900 Park Place Tower
666 Burrard Street,
Vancouver, British Columbia V6C 2Z9 (604) 684-8431

Legal Counsel: Speton & Company
960-789 West Pender Street
Vancouver, British Columbia V6C 1H2

Auditors: Smith, Flynn, Staley
Chartered Accountants
225-4299 Canada Way
Burnaby, British Columbia V5G 1H3

Bankers: Bank of Montreal
595 Burrard Street
Vancouver, British Columbia V7X 1L7

GAMIN RESOURCES INC.



STATE OF ARIZONA

DEPARTMENT OF MINES AND MINERAL RESOURCES

Mineral Building, Fairgrounds, Phoenix, Arizona 85007 • (602) 255-3791

May 2, 1985

Mr. Ed Huskinson Jr.
Senior Exploration Geologist
Gamin Resources Inc.
845 Ridgecrest
Kingman, AZ 86401

Dear Mr. Huskinson:

Thank you for your interest in the Golconda Mine in the Wallapai Mining District of Mohave County.

A review of official records show the Golconda to have been a historically important zinc producer in Arizona. On a statewide basis and based on cumulative production, the Golconda appears to rank either ninth, tenth, or eleventh as a zinc producer. This production covered an intermittent period of production between 1908 and 1957. During that period its cumulative production is as listed:

Tons of ore	206,000
Pounds of copper recovered	359,000
Troy ounces of silver recovered	434,000
Troy ounces of gold recovered	18,000
Pounds of lead recovered	2,031,000
Pounds of zinc recovered	47,874,000

Other important zinc producers are:

<u>Mine Name</u>	<u>Approx. Pounds of Zinc in Millions</u>
Iron King	600+
Bisbee	350+
Old Dick (Bruce)	300+
Flux	100+
United Verde and/or United Verde Ext.	95+
Mammoth-St. Anthony	85+
San Xavier	85+
Superior (Magma)	75+
Washington (Indiana)	70+
Tennessee	67+
Golconda	47+

The Golconda Mine was apparently Arizona's largest zinc producer in 1911. In that year the Wallapai District accounted for 4,477,000 pounds of zinc out of a statewide total of 4,563,000 pounds and the Golconda Mine produced the bulk of the ore in its district. (U.S. Geol. Survey Mineral Resources of the United States - Part I - Metals 1911).

Ed Huskinson Jr.

May 2, 1985

Page 2

The Arizona Department of Mines & Mineral Resources is enthusiastic about Gamin Resources desire to develop base and precious metal deposits in Arizona.

Please feel free to contact us anytime we might be of further assistance.

Sincerely,

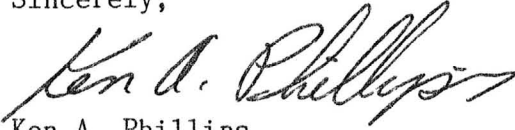
A handwritten signature in cursive script that reads "Ken A. Phillips". The signature is written in dark ink and is positioned above the printed name and title.

Ken A. Phillips
Mineral Resources Engineer

KAP:sk

LEAD-ZINC QUESTIONNAIRE

October 9 1957.

Do you approve of the Emergency Lead-Zinc Committee's seeking relief for the lead-zinc industry and has it your authorization to speak for you? yes

What Arizona Mines and Mills in the lead-zinc class do you control?

(1) GOLCONDA

(2) _____

Which ones are operating? (1) NONE (2) _____

If not operating, when shut down? (1) * (2) _____

Number employed, prior to shut-down, in mine, mill or sections thereof producing lead or zinc ores? (1) _____ (2) _____

Number so employed on January 1, 1957? (1) NONE (2) _____

Number so employed on October 1, 1957? (1) 7 (2) _____

Remarks Development work under way since May 1957 but reactivation not economic at present metal prices.

GOLCONDA CHEMICALS CORP.

Company

By: Howard H. Heilman

Signature President

Please fill in NOW, tear off, and mail to:

Arizona Department of Mineral Resources
Mineral Building, Fairgrounds
Phoenix, Arizona

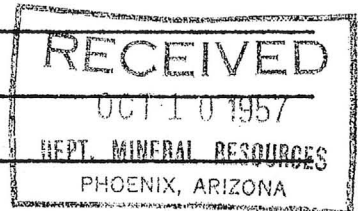

Information from MINE INSPECTOR'S OFFICE - August 15, 1957

' GOLCONDA MINE 5 Claims Walapai Dist., MOHAVE CO. 6-12-57

' GOLCONDA CHEMICAL CORP., Box 1190, Kingman, Ariz.

Pres - 'Howard H. Heilman " "

Sec. ' Herold Gilmore " "

Supt - 'Pat Patterson, Chloride, Ariz.

Z - G - S - L Development - 7 men

L.A.S.



District sheet in T. 22 N., R. 17 W., Secs. 5

and 6 show numerous patented mining claims - not all in
one show that they are
/ survey and none/connected with this as Golconda Group,

The following may and may not be of the Group but are
patented:

	claim
MS 527	- pat. 1st Ext of Mariposa (by Ora Plata)
MS 528	- Todd - 529 - Maricopa claim
MS 1315	- Tub
MS 2427	- Prosperity - 11845 # 3978102
MS 2987	- Silver and Big Bethel claims
2617	- Golconda

6-11-56

lp

✓ Owner is: Pontiac Mines Inc % Golconda
Chemical Corp. 545 So. Figueroa St.
L. A. Ca. (11/72)

1-1916
Mojave County, the Great Zinc Producer of Arizona

The report of the Geological Survey conveys to the reader of mining history the story of the manner in which Mojave county is building up its mining industry and forging to the front as a producer of gold, silver, copper, zinc and lead. Today its stands at the head of Arizona counties as a producer of zinc and gold, and at the same time is close to the head as a producer of lead. Cochise county now holding first position in the production of silver, copper and lead.

Two mines in this county—the Golconda and the Tennessee—produced last year nearly 15,000,000 pounds of spelter, against about 7,000,000 pounds in 1914. The value of the entire spelter production of the state was \$2,540,000, and more than \$2,000,000 of this is credited to Mojave county. This is in excess of all the gold and silver produced by the other mines of the county. Aside from this, the Tennessee mine produced a large tonnage of lead, the zinc and lead ores being shipped to the concentrating plant at Needles.

The Golconda mine also produced gold and silver, it being understood that these values paid for mining and spelter product. It is understood that these values for mining and all other fixed charges against the spelter product. It is understood that the entire production of spelter, gold and silver by the Golconda mine for the year is far in excess of \$1,000,000 and that the Tennessee mine is also credited with more than \$1,000,000 in gold, silver lead and zinc.

These two mines have not been touted to any extent, the management not having stocks for sale, but having in view the commercializing of the properties. With two such producers in the gold fields of Mojave county, or elsewhere, they would be touted the world over. And yet these mines are employing many men, and are buying machinery and supplies that would make the gold sections sit up and take notice. The Golconda is one of the most ideal zinc mines in the world. Its ores are free from all the deleterious basis that make the western zinc ores hard to handle. It is for this reason that the mine was able to get one of the best contracts ever offered a producing zinc mine in the United States and enable it to have a great market all the time.

It is these two mines that will make history during the year 1916 and to which Mojave county looks for a steady production of the two necessary metals.

The Golconda is being equipped with a flotation plant, which will be in operation as soon as it can be connected with electric power that is now going out for the Kingman plant. And the Tennessee is also to be better equipped when the electricity is brought into that camp.

A Large Zinc Plant

The following article is from the Butte Miner and gives a very interesting account of the new zinc plant

which will be the largest in the world. The article ought to be of especial interest to those mining in Arizona for it practically and successfully solves the problem of treating low grade zinc ores. We have many properties with zinc contents in its ores that would not be treated and in fact, such was penalized by the smelters. The "Golconda" (in that great mining county of Mayane) the largest zinc mine in the southwest ships all its ores for reduction to Oklahoma, probably in the near future these ores will be treated at home.

Drifting on the 360 foot level of the Golconda Extension has shown up ore of good milling grade, about six feet in width. Many developments in the county in every direction are certainly making good and enhancing faith in this promising area.

Feb. 1916

The Golconda Zinc mine paid \$85,000 in dividends for the last quarter. The large force of 265 men are employed at the property being the largest in its history. The property belonging to James H. Haas in Mineral Park has been bonded to a Phoenix party for \$50,000. The findings comprise about 12-1915

Mojave County 1915

August Ravell of Tempe and other two partners are opening up a prospect named Black Butte on the extension of the Golconda. In drifting 12 feet a 12 inch streak of galena ore has been uncovered, and this is being treated and sacked ready for shipment. This ore averages 58 per cent zinc, 12 per cent silver and 18 in gold. The claim is an extension of the Golconda to the east and being about one mile from the working shaft of that important property. About a mile north is Stockton Hill, where John Boyle (who brought the Golconda to its present stage of productiveness) is working a property with a large force of men.

Directly south, about three-quarters of a mile is Cerbat, an old time and celebrated camp. About two miles east is located the 63 mine, another old time producer of rich silver ore. On one claim of the group of seven, called the Lead King, good zinc ore has already been discovered.

With systematic development the property promises well to be of some importance. There is little question about the future of the district, in intelligent and practical hands satisfactory results. Some of them have already gone far beyond expectations and there is legitimate hope of others being added to the prosperous list.

Geologically conditions in the Oatman district are similar to those in that part of Tonopah, where the veins are covered with a flow of eruptive rock. At Oatman the cap rock is a rhyolite that is later than the vein formation. The ancient surface existing at the time of this rhyolite flow can be traced by following the line where the rhyolite has softened the rock below it.

Other properties are in varied stages of activity. The Golconda mine, the largest zinc property in the southwest, is making its heavy shipments of zinc ores weekly. All this district thirty years ago was alive with activity and production of Bonanza ores, and, although rich finds will undoubtedly be made, the great future and stability of the camp will depend upon its lower grade material. The present practical demonstrations are sufficient evidence of what may be expected with systematic development.

It was reported at the ASMOA 1/7/75 meeting that Dupont has acquired the Golconda and Chico properties in the Cerbats. VBD WR 1/7/75

I spent the day on the Golconda mine property. VBD WR 7/18/76

RRB WR 3/3/80: Dick Newsome, Ferndale, Washington, got copy of report from Golconda Mine, Mohave County. He is considering buying or leasing it.

NJN WR 11/6/81: H. M. Coggin reported that the dumps will be leached at the Golconda Mine, Mohave County.

It was reported that the Archean Company is active at the Golconda Mine, Mohave County.

KAP WR 2/26/82: Resources Partners Cyanide Leach Operation on Golconda Mine tailings, Cerbat District, Mohave County. Here the organization has constructed a heap of some 10,000 tons consisting of 5,000 tons of jig tailings and 5,000 tons of mine dump. At the time of visit a solution of sodium hydroxide (no cyanide) was being circulated through the heap to bring up the ph., ph of the off solution was running 6.5. Plans are to leach with cyanide and recover gold with a Bi Metals carbon adsorption plant. The operation is powered by a diesel generator set. A work force of 4-5 men are employed.

NJN WR 3/26/82: Information received from H. Mason Coggin, a Phoenix mining engineer, on Resource Partners Inc., who are operating heap leach operations in the Cerbat Mountains on the Golconda Mine and PAC Mines, Mohave County. Their address is: Resource Partners, 274 Union Blvd. Suite 400, Lakewood, Colorado 80228. Bob Dickson is the manager of their operations in the Kingman area.

DEPARTMENT OF MINERAL RESOURCES

STATE OF ARIZONA

Mine Golconda Mine

District **Mineral Park**

Subject: **Activity report**

C. G. Patterson, Chloride, Arizona is supervising the work. They are reopening the 600' level drift which connects with the Golconda shaft.

The Golconda shaft was last mined in 1917 and the ore is mainly zinc.

DEPARTMENT OF MINERAL RESOURCES
STATE OF ARIZONA
FIELD ENGINEERS REPORT

Mine	Golconda Mine	Date	July 12, 1957
District	Mineral Park	Engineer	B. J. SQUIRE
Subject:	Activity report		

Golconda Chemicals Corp., P. O. Box 1190, Kingman, Arizona, has a lease and bond on the Golconda Mine.

C. G. Patterson, Chloride, Arizona is supervising the work. They are reopening the 600' level drift which connects with the Golconda shaft.

The Golconda shaft was last mined in 1917 and the ore is mainly zinc.

DEPARTMENT OF MINERAL RESOURCES
STATE OF ARIZONA
FIELD ENGINEERS REPORT

Mine . Golconda Group

Date April 12, 1956

District Cerbat

Engineer Mark Gemmill

Subject: Present Status

Within the past three years the Golconda and several adjoining properties have been acquired by ARIZONA GOLCONDA METALS INC. John S. Bagg, Pres. and Genl Mgr. Kingman, Arizona.

of

The plan/reopening the mines is the tapping of the Golconda workings on the 1000 ft. level by continuing a tunnel which existed in the Davenport Mine, which is north of the Golconda. This was a Cross-cut tunnel which had cut the Golconda vein. The work planned is drifting south on the vein to the Golconda workings. The estimated distance was about 3500 ft. Within the past yearx about 2000 ft. has been driven.

Mr. Bagg informed the writer that due to financial reasons work was stopped recently, but that he expects to get started again soon.

The property is well equipped for the development work under way, and the work has been carried on in a capable manner.

Maps and reports in the files give a good description of these properties, past production etc.

Mr. Bagg stated that he planned to build a milling plant after the properties are opened if sufficient ore is found to justify it. It is hoped that he will be able to go through with his plans as the proposition appears to have considerable merit.

October 7, 1943

Mr. Bertram A. Ball
323 South Highland Avenue
Los Angeles, California

Dear Mr. Ball:

I have just received a letter from H. B. Lawrence, president of the Pontiac Mines, Incorporated, Room 401, 1052 West Sixth Street, Los Angeles (14) in which he states that "the Golconda Mine is now available, or will be very shortly, and if you so desire, negotiations may be reopened; and we shall be glad to learn your wishes in the matter."

The Golconda is a large potential Zinc producer and you may still be interested in considering some plan for putting it into operation. Mr. Lawrence granted a leasing bond to Bollinger and Williams of Kingman and they made their application for a Government loan which was rejected.

I do believe the property is worthy of private capital opening the mine up so as to expose the Zinc ore which records show exists and, when the ore is exposed, I believe Government aid may be obtained for full-scale operation of the mine. There has been a tightening up of Government aid on Zinc properties, due mainly to labor shortage and the granting of a Government loan is somewhat uncertain unless approached through certain channels of which I know you are in close touch. I would be glad to cooperate with you in this matter if you so desire; or, if you wish, you could go through Mr. Lawrence.

I will hold up replying to Mr. Lawrence until I hear your wishes in this matter.

Yours very truly,

J. S. Coupal, Director

October 7, 1943

Mr. H. B. Lawrence, President
Pontiac Mines, Incorporated
Room 401
1052 West Sixth Street
Los Angeles (14), California

Dear Mr. Lawrence:

Many thanks for your letter of October 5,
regarding the Golconda. I would be pleased to be kept
advised. I have mentioned it to a Mr. Ball in Los Angeles
who may contact you, but I may have other contacts who are
in the market for good properties.

Yours very truly,

J. S. Coupal, Director

JSC:JE

PONTIAC MINES, INCORPORATED

- H. B. LAWRENCE, PRESIDENT -

1052 WEST SIXTH ST.

ROOM 401

LOS ANGELES, CALIFORNIA

(14)



October 5, 1943

Mr. J. S. Coupal,
413 Home Builders Bldg.,
Phoenix, Arizona

Dear Mr. Coupal:

Just a line to advise you that the
"Golconda" is available, or will be very shortly,
and if you so desire negotiations may be reopened;
and we shall be glad to learn your wishes in the matter.

With kindest regards,

Very truly yours,

H. B. Lawrence
President.

May 12, 1943

Mr. H. B. Lawrence
1052 West Sixth Street
Room 602
Los Angeles, California

Dear Mr. Lawrence:

Many thanks for the cartoon which has just been received this morning. I talked with Mr. Willis regarding the one he received and he thinks the subject is very well treated indeed.

I will be glad to be kept posted as to the progress made on the lease on the Colconda. I am sorry that the people I had in mind were not in time to get a similar contract.

With best wishes and kindest personal regards,
I am

Very truly yours,

J. S. Coupal, Director

JSC:kk

Salanda

PONTIAC MINES, INCORPORATED

- H. B. LAWRENCE, PRESIDENT -

1052 WEST SIXTH ST.

ROOM 402-602

LOS ANGELES, CALIFORNIA

May 8, 1943

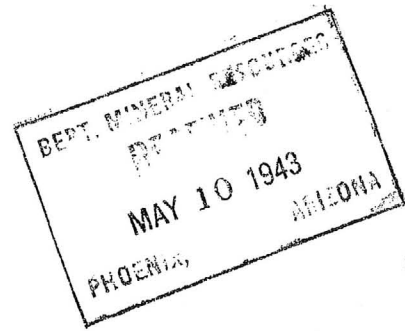

Mr. J. S. Coupal,
413 Home Builders Bldg.,
Phoenix, Arizona

Dear Mr. Coupal:

Thank you for yours of the 6th instant
with advice of visit from Judge Bollinger and Mr. Williams;
I am pleased to learn that they are proceeding in accordance
with plans and shall be pleased to learn of their progress.

I will be glad to keep in touch with you and
will appreciate whatever you may be able to forward from your
end. Reciprocating your good wishes and with best regards,
I am

Very truly yours,

H. B. Lawrence

May 6, 1943

Mr. H. B. Lawrence
1052 West Sixth Street
Room 602
Los Angeles, California

Dear Mr. Lawrence:

Yesterday Judge W. E. Bollinger and Ray Williams from Kingman called at the office and discussed with me their plans for an application for a loan on the Coleman property under the lease which you granted them. I imagine they will shortly file their application for a loan and I will be very much interested in being kept posted as to their progress.

If they are unable to get their loan, I believe I could reopen negotiations with the parties mentioned for obtaining a lease and option on the property and believe my recommendations of driving the Peach tunnel would be followed.

There is a certain amount of gamble which must be taken in mining and in a great many instances the government or the RFC do not feel warranted in taking these gambles.

I believe Judge Bollinger stated that they would apply for about a \$30,000 loan. I will anxiously await information as to their success in getting such a loan for unwatering purposes.

I enjoyed meeting you very much and have passed your good wishes along to both Earl Hastings and Mr. Willis.

With best wishes and kindest regards, I am

Very truly yours,

J. S. Coupal, Director

JSC:kk

cc - Mr. H. H. Snow
Mayan Hotel
Eighth and New Hampshire
Los Angeles, California

May 6, 1943

Mr. H. H. Snow
Mayan Hotel
Eighth and New Hampshire
Los Angeles, California

Dear Bill:

I am enclosing a copy of a letter I have just written to Mr. Lawrence.

I doubt very much the granting of a \$30,000 loan by the RFC for unwatering the Golconda property.

I understand that the terms of the lease Mr. Lawrence made were a ten year lease with a ten percent royalty, no minimum payments designated and with only one stipulation, and that is that 150 shifts a month be put on the mine work after July 1, 1943.

I believe this to be a fair contract and I am sorry that we were not able to get it for Mr. Ball.

Very truly yours,

J. S. Coupal, Director

JSC:kk
Enclosure

April 19, 1943

Mr. H. B. Lawrence
1052 West Sixth Street
Room 602
Los Angeles, California

Dear Mr. Lawrence:

Thank you for your letter of April 16.

I will look forward to discussing some details on the
Golconda with you within a week or ten days' time.

My plans have somewhat changed so that I probably
will not be in Los Angeles until around Monday, April 26,
but feel sure that I will see you at that time.

Very truly yours,

J. S. Coupal, Director

JSC:kk

PONTIAC MINES, INCORPORATED

- H. B. LAWRENCE, PRESIDENT -

1052 WEST SIXTH ST.

ROOM 602

LOS ANGELES, CALIFORNIA

April 16th, 1943

Mr. J. S. Coupal, Director
Department of Mineral Resources
State of Arizona,
Phoenix, Arizona

Dear Mr. Coupal:

I am pleased to acknowledge your letter of the 14th inst. and note your interest in bringing the Golconda mine to the attention of prospective operators.

A number of inquiries have been received and real interest shown by several, and we would like to see the property in production. However, no definite commitments have been made and it is still open for the responsible party who can qualify, and it's "first come first served",

You have in your offices there, reports, maps and data mailed to yourself as well as that sent to Mr. Willis and Mr. Hastings, which I believe you will find altogether complete.

The record of the mine justifies your fine opinion of it and my own knowledge of it and experience with it would corroborate it.

I shall be pleased to see you on your visit here next week and discuss with you the situation as suggested. We would like to make a deal that would bring the property into early production, on a straight lease, lease with option to purchase and apply royalties on the purchase, or, if desired, an outright purchase with definite specified payments. The price, terms and conditions to be agreed upon pending the plan selected.

Thanking you for the inquiry and anticipating an early meeting, I am

Very truly yours,
H. B. Lawrence
President
PONTIAC MINES, INCORPORATED