



CONTACT INFORMATION

Mining Records Curator
Arizona Geological Survey
1520 West Adams St.
Phoenix, AZ 85007
602-771-1601
<http://www.azgs.az.gov>
inquiries@azgs.az.gov

The following file is part of the

Arizona Department of Mines and Mineral Resources Mining Collection

ACCESS STATEMENT

These digitized collections are accessible for purposes of education and research. We have indicated what we know about copyright and rights of privacy, publicity, or trademark. Due to the nature of archival collections, we are not always able to identify this information. We are eager to hear from any rights owners, so that we may obtain accurate information. Upon request, we will remove material from public view while we address a rights issue.

CONSTRAINTS STATEMENT

The Arizona Geological Survey does not claim to control all rights for all materials in its collection. These rights include, but are not limited to: copyright, privacy rights, and cultural protection rights. The User hereby assumes all responsibility for obtaining any rights to use the material in excess of "fair use."

The Survey makes no intellectual property claims to the products created by individual authors in the manuscript collections, except when the author deeded those rights to the Survey or when those authors were employed by the State of Arizona and created intellectual products as a function of their official duties. The Survey does maintain property rights to the physical and digital representations of the works.

QUALITY STATEMENT

The Arizona Geological Survey is not responsible for the accuracy of the records, information, or opinions that may be contained in the files. The Survey collects, catalogs, and archives data on mineral properties regardless of its views of the veracity or accuracy of those data.

12/18/90

ARIZONA DEPARTMENT OF MINES AND MINERAL RESOURCES FILE DATA

PRIMARY NAME: ELDORADO

ALTERNATE NAMES:

MOHAVE COUNTY MILS NUMBER: 179B

LOCATION: TOWNSHIP 28 N RANGE 18 W SECTION 21 QUARTER SE
LATITUDE: N 35DEG 47MIN 55SEC LONGITUDE: W 114DEG 12MIN 21SEC
TOPO MAP NAME: GARNET MTN - 15 MIN

CURRENT STATUS: PAST PRODUCER

COMMODITY:

GOLD LODE
SILVER
TUNGSTEN

BIBLIOGRAPHY:

ADMMR ELDORADO MINE FILE
SCHRADER, F.C. "MIN. DEPTS OF CRBT RNGE, BLCK
MTNS, GRND WSH CLFS, AZ" USGS BUL 397, P 120-1
WILSON, E.D. "AZ LODE GOLD MINES" AZBM BULL
137, P 76, 1967
AEC 172-485 MOH.CTY PRELIM. RECONN. RPT, P149
INDIAN CLAIMS COMM. DOCKET 90, OVL. 1, P 92,
1964
KOSCHMANN, A.H. "PRIN. GOLD-PROD. DIST. OF TH
US" USGS PP 610, P 40, 1968
USGS PP1361, P. 137

T. 29 N.

(SENATOR MTN.)

50'

T. 28 N.

Golden Rule Peak

Elephant

White

Wash

Bluebird Mine

Pa VABM 4685

Hualapai

Burnt Mill Ranch

Excelsior Mine

Maloo Mine
USLM 2518

Eldorado

Cyclopic (Site)

Garnet Mtn.
Quad

6607

RISW

PIERCE FERRY

ROAD

Hualapai

Name of Mine or Prospect:	Eldorado Mine		Section	Range	Township
	28N	18W	19 d		B
Principal Minerals:	1:250,000 Quad		7.5' - 15' Quad		
Gold	Kingman		Garnet Mtn.		
Associated Minerals:	District		Principal Product		
Quartz, Malachite, Vanadinite, $PbCO_3$	Gold Basin		Gold		
Type of Operation:	County	State	Type of Deposit		
Underground: Tunnels, Drifts	Mohave	Ar.	Vein		
Ownership or Controlling Interest:					
Arizona-Minnesota Gold Mining Co. (1909) ¹					
Access: From the intersection of Pierce Ferry Road and U.S. 93, proceed north on Pierce Ferry Road for 22.5 miles, turn left on unimproved road for 2 miles, turn left for 3.0 miles, then right for 2.0 miles. Mine is located (unnamed) north of Cyclopic site on topographic quadrangle.					
Structural Control or Geological Association:					
<p>"Elevation 4000 feet, 1000 feet above Hualapai Wash about 2 miles distant. The country rock is a reddish schistose medium grained granite. In the northeast portion at the surface and in the bottom of the mine, a dark friable biotite granite. The contact between the two rocks dips 30°W and is sharp and is probably a fault plane. Deposit is a fissure vein which strikes N50°E and dips 65°SE. Vein averages several feet of ore shoots up to 20 inches thick. It contains iron stained free milling gold. Northwest of apex of the vein above described and about 50 feet above it, is the blanket vein which is exposed for a length of 600 ft. and a width of about 100 ft.; which has contributed largely to the output of the mine. It dips about 25°E."¹</p>					
Age of Mineralization:					
Production History			Geochemical Analyses		
Discovery in 1870. (1909) ¹ production total value \$65,000 2000 feet of tunnels 40,000 ft. ³ stopes			<u>Assay (1938)²</u> Vein average \$12 to \$15 ton in gold		
References					
1) Schrader (1909) p. 2) Mallach (1977) p. 53. 3) CETA map file Rack #12 and #26, claim, assay, and underground map.					

For: Eldorado Mines Co.
C. W. Burcham - locator
Sec. 28 (S.W. 1/4) T. 28 N,
R. 13 W. G. 8 S. R. M.
Gold Basin Mining Dist.
Mohave Co., Arizona.

This map traced from original on file with C. W. Burcham,
Nov. 12, 1941 By E. Ross Housholder E. M.

Registered Engineer #257
Kingman, Arizona.
12-E

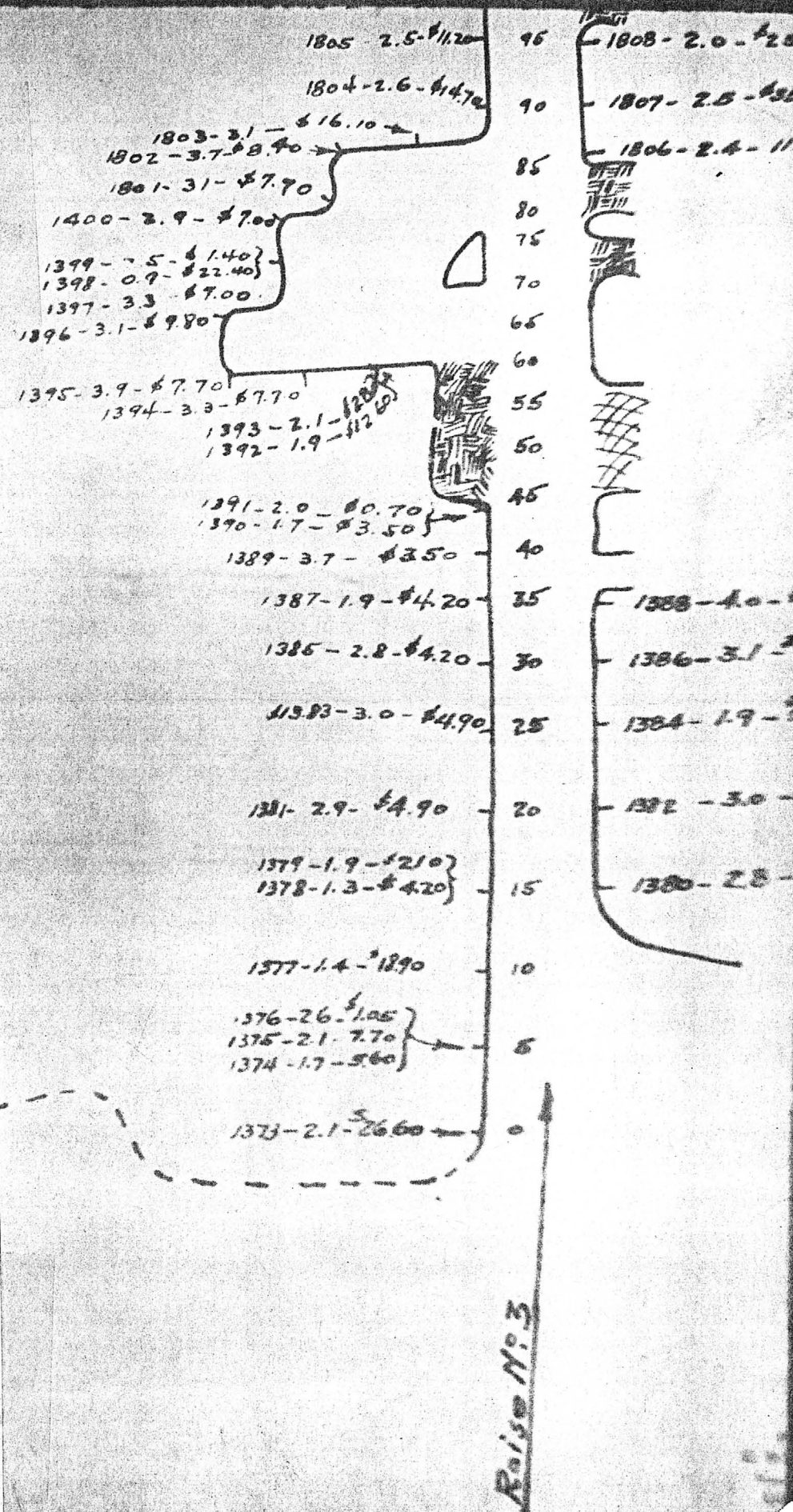
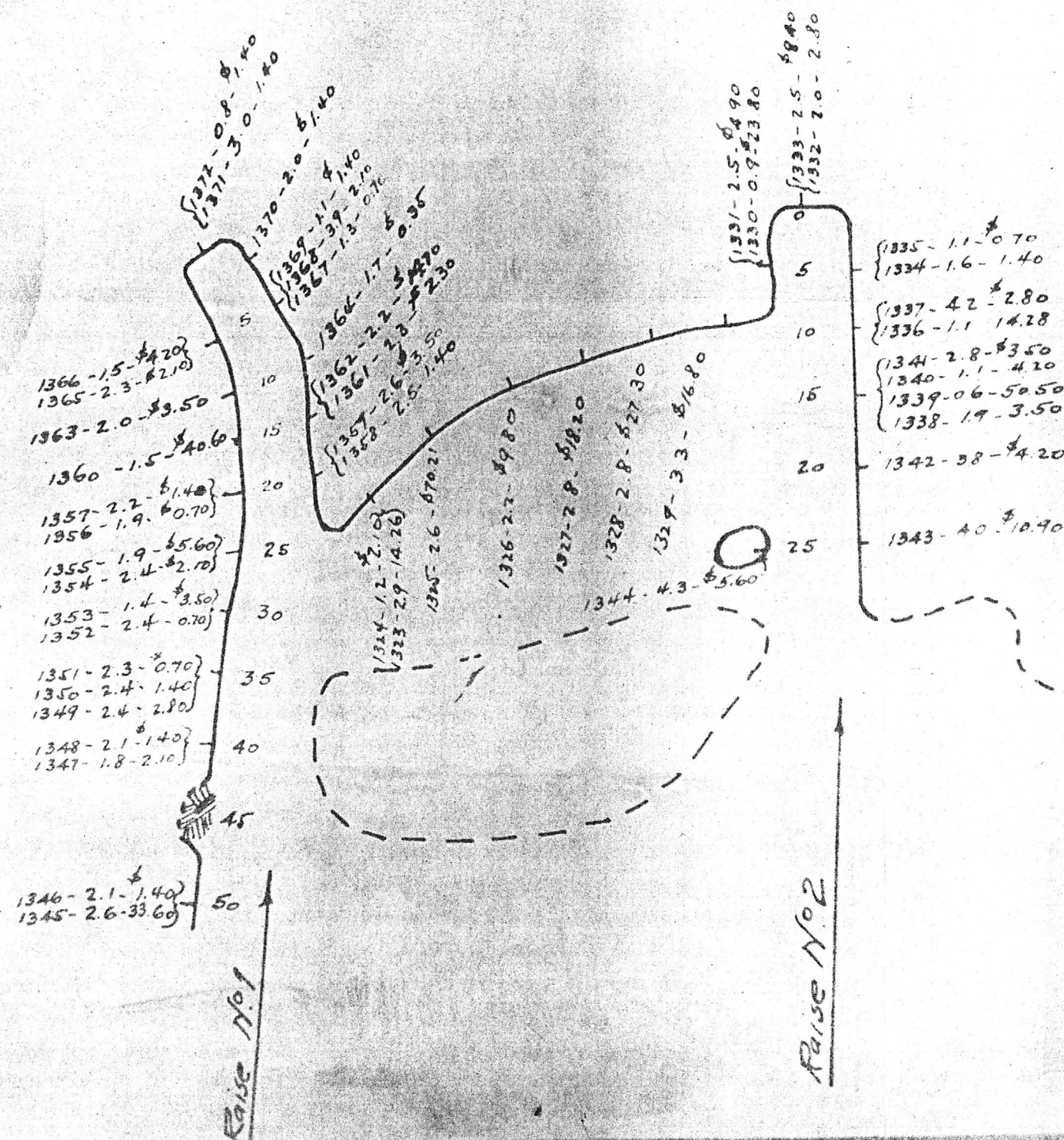

Rough Plan Sketch of
South End
Eldorado Blanket
Vein

Showing Assay Returns From Sampling.
Nov. 7, 8, 9, 11, 15, 16, 17, & 18, 1938 By
B. E. Charles For Producers Mines.
Sampling Interval 5 Feet.

Note: Samples read 1st Sample Number 1829-2.0
2nd Width In Feet
3rd Assay Value Gold In Dollars
 (Calculated at \$35.00 per oz.)
 1828-2

Sample Locations Marked By Stake & Number

"No scale"

Refer.:: Eldorado Mines Co.
C. W. Burham - locator
Sec. 28 (S.W. 1/4) T. 28 N,
R. 13 W., G. 83 R. M.
Gold Basin Mining Dist.
Mohave Co., Arizona.

This map traced from original on file with C.W. Burcham,
Nov. 12, 1941 By E. Ross Housholder E.M.
Registered Engineer #257
Kingman, Arizona.
12-E

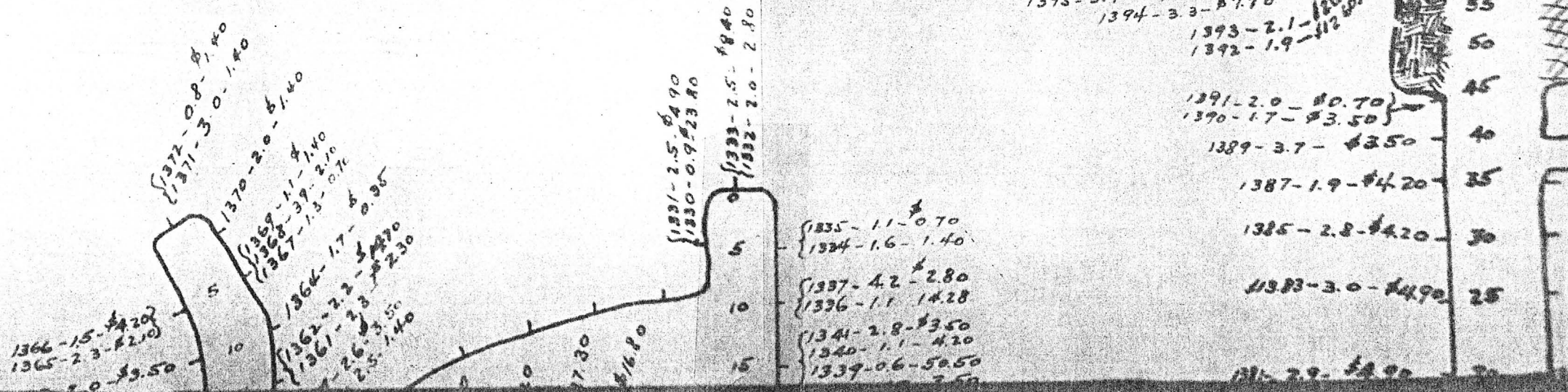

ELDORADO MINE

MOHAVE COUNTY

NJN WR 6/20/86: Ed Huskinson (c) reported that Roy Lamely (sp?) has done a report on the Eldorado (f) and OK Mine (f) area of Mohave County for Big Bar Gold.

NJN WR 3/4/88: Don Valin reported that Clyde Hutcheson of Sedona owns the Eldorado (file) Mohave County and, during the summer of '87, ran a heap leach cyanide operation on open pit material. He estimated that they leached about 5,000 tons.

RH

MINE VISIT REPORT

Mine: Eldorado

County: Mohave T28N R18W Sec 21 SE $\frac{1}{4}$

Engineers: Nyal J. Niemuth and Richard R. Beard

Date: April 19, 1984

Map and Photos attached

The Eldorado Mine, shown as the Malco Mine on the Garnet Mtn Quadrangle map was visited. There was no one at the property but the equipment appeared to have been operated recently. There was a tracked frontend loader, a rubber tired front end loader, a water truck and camp trailer on site.

The equipment consisted of a jaw crusher, a screen, a gyratory crusher, a set of rolls and a vibrating inclined plate agglomerator. The pad was partially loaded with the pelletized ore. Above ground swimming pools are being used for solutions and there is a small building to house the extraction and laboratory equipment.

It appeared that either crushed ore or leach residue had been used to surface the road from the Eldorado to the O.K. Excelsior.

Due to a locked gate and time constraints none of the mine workings were visited.



Eldorado

4/17/84



Eldorado

4/17/84



DEPARTMENT OF MINERAL RESOURCES

State of Arizona

MINE OWNER'S REPORT

Date September 27, 1958

1. Mine: Eldorado Mine
2. Location: Sec. 21, 28 Twp. 28 Range 18 Nearest Town Kingman Distance 5.8 miles
Direction North Nearest R.R. Santa Fe Distance 32
Road Conditions Good
3. Mining District and County: Gold Basin, Mohave
4. Former Name of Mine: Eldorado mine
5. Owner: C. W. Buschman
Address: 724 Stewart Ave., Kingman, Arizona
6. Operator: _____
Address: _____
7. Principal Minerals: Gold
8. Number of Claims: Lode 8 Patented _____ Unpatented 8
Placer _____ Patented _____ Unpatented _____
9. Type of Surrounding Terrain: High foot hills with 2 small canyons, one on each side, and on the south end
10. Geology and Mineralization: The prevailing rock formation is pre-Cambrian granites complex intruded by dykes of later igneous origin. The vein is a light-colored medium grained quartz, carrying free gold fissure vein in the red schistified granite
11. Dimension and Value of Ore Body: open pit 600 ft. long, 200 ft. wide and 8 ft. thick. Value \$12 per ton. The vertical vein on the south end of open-pit is 3 to 4 wide. Value \$35 per ton. needs development.

Please give as complete information as possible and attach copies of engineer's reports, shipment returns, maps, etc. if you wish to have them available in this Department's files for inspection by prospective lessors or buyers.

(over)

12. Ore "Blocked Out" or "in Sight": 75,000 opn. pit are. Vertical vein has several hundred tons of in stores.

Ore Probable: The downward trend of the blanket vein could be picked by diamond drilling. also diamond the vertical veins.

13. Mine Workings—Amount and Condition: 2380 ft., good

No.	Feet	Condition
Shafts.....	80 on vein	
Raises.....	300	
Tunnels—dists	2000	good
Crosscuts.....	150	good
Stopes.....	40,000 cu. ft. on three levels	

90,000 cu. ft. of underground work.

14. Water Supply: available

15. Brief History: Gold was found in the Eldorado mine about 1872. Minnesota & Arizona Gold Mining Company, of Minneapolis, installed a 10 ton cyanide leaching plant in 1900, and operated until the mill burned in 1905 when operation was suspended.

16. Remarks: The pit mine ore could be handled and milled for \$2 or less, as it can be bulldozed into the mill in one operation. For this reason, makes it an ideal operation, at low cost.

17. If Property for Sale, List Approximate Price and Terms: prefer royalty deal. But would sell for cash or on terms. Price open.

18. Signature: C W Burcham

WESTERN MACHINERY COMPANY

OFFICES AND WAREHOUSES

SAN FRANCISCO, CALIFORNIA
LOS ANGELES, CALIFORNIA
SACRAMENTO, CALIFORNIA
SALT LAKE CITY, UTAH
SPOKANE, WASHINGTON
DENVER, COLORADO
WASHINGTON, D. C.
PHOENIX, ARIZONA
NEW YORK, N. Y.

"Wemco Products"

TELEPHONE 3-4101
124 EAST BUCHANAN STREET
P. O. Box 2224
PHOENIX, ARIZONA
October 27, 1947.



CABLE ADDRESS
"WEMACHY"

RECEIVED

OCT 28 1947
DEPT. MINERAL RESOURCES
PHOENIX, ARIZONA

Mr. Charles Dunning
Arizona Mineral Resource Board
Mineral Building, Fairgrounds
Phoenix, Arizona

Dear Mr. Dunning:

A Mr. C. W. Burcham, Kingman, Arizona, wrote our San Francisco Office wanting to know if we knew anybody who was interested in taking over his mine. Our San Francisco Office referred it to us here, and at that time he did not give us any information on it. I wrote him for a report on it, or any data he might have available, which he just sent us a few days ago. I am enclosing herewith my complete file on this, and am wondering if you know of anybody who would be interested in it. I have no interest in it except to see mining in general progress. It may be that you already know this mine and possibly know all about it.

If you are interested in reading the report and looking at the maps, please do so, and then return them to me so that I can in turn send them back to Mr. Burcham.

Yours very truly,

WESTERN MACHINERY COMPANY

BY

J. E. Keller
J. E. Keller, Mgr.

JPK:hj
ENCL.

November 14, 1947

Mr. C. W. Burcham
Box 681
Kingman, Arizona

Dear Mr. Burcham:

Mr. J. P. Keller of the Western Machinery Company, Phoenix, has referred your letter and report by R. C. Jacobson, together with three maps of the Eldorado Mining Company, to us.

Due to the high cost of labor and equipment there is very little interest at the present time in Arizona gold mining. I would, however, suggest that you furnish us with a copy of the report and maps you sent Mr. Keller, which we are returning as per your request. In the future we will undoubtedly have some calls for property of this sort when business conditions become more stabilized. It would be well to have a complete report of your property in our files.

Yours very truly,

RICM:mh
Enc.

Roger I. C. Manning
Field Engineer

P 7 Box 681
Kingman, Arizona
October 22, 1947

Mr. J. P. Keller
Western Machinery Co
P.O. Box 2224
Phoenix, Arizona

Dear Mr. Keller:

I have received your letter of October 20th, stating that you frequently run across people interested in gold mines. I own a very good gold mine for a small operation.

The mine is developed by 2,000 ft. of tunnels and drifts. There is more than 40,000 tons of ore that will average around \$11.00 per ton in gold.

I am sending you Mr. R. C. Jacobson's Report and three maps of the Eldorado mine. Mr. Jacobson's report does not give the property due credit under modern conditions.

Would be please to hear from soon.
when you have finished with report. please return

Very truly yours,
C. W. Burcham

November 14, 1947

Mr. C. W. Burcham
Box 681
Kingman, Arizona

Dear Mr. Burcham:

Mr. J. P. Keller of the Western Machinery Company, Phoenix, has referred your letter and report by R. C. Jacobson, together with three maps of the Eldorado Mining Company, to us.

Due to the high cost of labor and equipment there is very little interest at the present time in Arizona gold mining. I would, however, suggest that you furnish us with a copy of the report and maps you sent Mr. Keller, which we are returning as per your request. In the future we will undoubtedly have some calls for property of this sort when business conditions become more stabilized. It would be well to have a complete report of your property in our files.

Yours very truly,

Roger I. C. Manning
Field Engineer

RICM:mh
Enc.

References: ABM Bull. 137, p. 76 ; USGS 7.P. # 610, p. 40
USGS Bull. 397, DEPARTMENT OF MINERAL RESOURCES
STATE OF ARIZONA
p. 120, 121. MINE OWNER'S REPORT

Date July 21, 1939

✓ Mine ELDORADO

2. Location Mohave

Mining District & County Gold Basin

Former name ✓

Owner C. W. Burcham ✓

6. Address (Owner) Kingman, Arizona

Operator

8. Address (Operator)

President, Owning Co.

9A. President, Operating Co.

Gen. Mgr.

14. Principal Minerals ✓ Gold

Mine Supt.

15. Production Rate

Mill Supt.

16. Mill: Type & Cap.

Men Employed

17. Power: Amt. & Type

Operations: Present

Operations: Planned Soon as mill is constructed in district.

Number Claims, Title, etc. 8 unpatented - title by location

Description: Topography & Geography Low hilly area of about six miles square. The prevailing rock formation of the district is the pre-cambrian granite complex intruded by dykes of later igneous origin.

Mine Workings: Amt. & Condition About 2000 ft. drifts and crosscut tunnels. Most of timbering and workings in good condition.

Geology & Mineralization Fissure in granite in conjunction on east with chloritic schist - upper segment of vein tilted forming a blanket outcrop about 200 ft. x 600 ft. with slight dip to east. Average 4 to 10 feet thick little overburden.

Ore: Positive & Probable, Ore Dumps, Tailings Estimated about 38,000 tons in blanket; 2000 to 3,000 tons dump material. Samples show average \$10.50 told per ton.

A. Dimensions and Value of Ore body

Mine, Mill Equipment & Flow-Sheet Free milling ore will require cyanide milling plant.

Road Conditions, Route 34 miles on Boulder Dam Road; 20 miles on Pierce's Ferry road, and 6 miles on OK road. Good condition.

Water Supply Have spring 11 miles away. Water may be had from the Colorado River or may be leased or purchased from other near by owners.

Brief History Discovered about 1880. From 1890-1906 actively mined and milled ore by Minnesota and Arizona Gold Mining Company. Produced some 6,000 tons about \$100,000.00. Old stamp mill followed by cyanide leaching - extractions 85% to 95%.

Special Problems, Reports Filed To get capital to develop the Gold Basin and Lost Basin Mining Districts.

Remarks The property has good possibilities for future development.

If property for sale: Price, terms and address to negotiate. For sale or lease. Price and terms may be arranged by writing to C. W. Burcham, P. O. Box 681, Kingman, Arizona.

32. Signature.....(Signed) C. W. Burcham

DEPARTMENT OF MINERAL RESOURCES
STATE OF ARIZONA
OWNERS MINE REPORT

Date *July 21st, 1939*

✓
Mine *Eldorado*
District *Gold Basin*

Location *Mahau*

Former name
Owner ✓ *CW Burcham*

Address *Kingman, Arizona*

Operator

Address

President

Gen. Mgr.

Mine Supt.

Mill Supt.

Principal Metals ✓ *Gold*

Men Employed

Production Rate

Mill: Type & Cap.

Power: Amt. & Type

Operations: Present

Operations Planned *Soon as mill is constructed in district*

Number Claims, Title, etc. *8 unpatented - Title by location*

Description: Topog. & Geog. *Low hilly area of about six miles square. The prevailing rock formation of the district is the Pre-Cambrian granite complex intruded by dykes of later igneous origin.*
Mine Workings: Amt. & Condition *about 2000 ft drifts and cross cut tunnels. Most of timbering and working in good condition.*

(over)

Geology & Mineralization

Fracture in granite in conjunction on East with Chloritic schist. Upper segment of vein tilted forming a blanket outcrop about 200 ft x 600 ft with slight dip to East, average 4 to 10 ft thick little overburden.

Ore: Positive & Probable, Ore Dumps, Tailings

Estimated about 38,000 tons in blanket. 2,000 to 3,000 tons dump material. Samples show average \$10.50 gold per ton.

Mine, Mill Equipment & Flow Sheet

Fresh milling as will require cyanide milling plant

Road Conditions, Route

34 miles on Boulder Dam road - 20 miles on Pierce's Ferry road and 6 miles on A.K. road. Good condition.

Water Supply

Hans Spring 11 miles away. Water may be had from the Colorado River or may be leased or purchased from other men by owners.

Brief History

Discovered about 1880. From 1890-1906 actively mined and milled ore by Minnesota and Arizona Gold Mining Company. Produced some 6000 tons, about \$100,000.00. Old stamp mill followed by cyanide leaching. Extractions 85-90% to 95%.

Special Problems, Reports Filed

Basin and To get capital to develop the Gold and Lost Basin mining districts.

Remarks

The property has good possibilities for future development

If property for sale: Price, terms and address to negotiate.

For sale or lease - Price and Terms may be arranged by writing to C.W. Burcham, P.O. Box 681 Kingman, Arizona

Signed

C.W. Burcham

ME-4
DEPARTMENT OF MINERAL RESOURCES
STATE OF ARIZONA
OWNERS MINE REPORT

Date July 21, 1939

✓
Mine ELDORADO

District Gold Basin

Location Mohave

Former name

Owner C. W. Burcham

Address Kingman, Arizona

Operator

Address

President

Gen. Mgr.

Mine Supt.

Mill Supt.

Principal Metals Gold

Men Employed

Production Rate

Mill: Type & Cap.

Power: Amt. & Type

Operations: Present

Operations Planned Soon as mill is constructed in district.

Number Claims, Title, etc. 8 unpatented - title by location.

Description: Topog. & Geog. Low hilly area of about six miles square. The prevailing rock formation of the district is the pre-cambrian granite complex intruded by dykes of later ~~ing~~ igneous origin.

Mine Workings: Amt. & Condition About 2000 ft. drifts and crosscut tunnels. Most of timbering and workings in good condition.

(over)

Geology & Mineralization Fissure in granite in conjunction on east with chloritic schist - upper segment of vein tilted forming a blanket outcrop about 200 ft x 600 ft with slight dip to east. Average 4 to 10 feet thick little overburden.

Ore: Positive & Probable, Ore Dumps, Tailings Estimated about 38,000 tons in ~~sample~~ blanket; 2,000 to 3,000 tons dump material. Samples show average \$10.50 told per ton.

Mine, Mill Equipment & Flow Sheet Free milling ore will require cyanide milling plant.

Road Conditions, Route 34 miles on Boulder Dam Road; 20 miles on Pierce's Ferry road, and 6 miles on OK road. Good condition.

Water Supply Have spring 11 miles away. Water may be had from the Colorado River or may be leased or purchased from other near by owners.

Brief History Discovered about 1880. From 1890-1906 actively mined and milled ore by Minnesota and Arizona Gold Mining Company. Produced some 6,000 tons about \$100,000.00. Old stamp mill followed by cyanide leaching - extractions 85% to 95%.

Special Problems, Reports Filed To get capital to develop the Gold Basin and Lost Basin Mining Districts.

Remarks The property has good possibilities for future development.

If property for sale: Price, terms and address to negotiate. For sale or lease. Price and terms may be arranged by writing to C. W. Burcham, P. O. Box 681, Kingman, Arizona.

Signed..... C. W. BURCHAM

Use additional sheets if necessary.

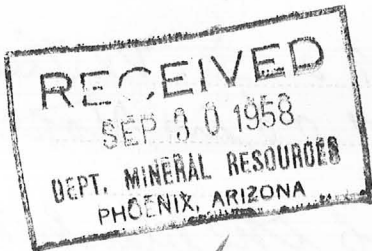

DEPARTMENT OF MINERAL RESOURCES

State of Arizona

MINE OWNER'S REPORT

Date September 27, 1958

1. Mine: Eldorado Mine
2. Location: Sec. 21, 28 Twp. 28 Range 18 Nearest Town Kingman Distance 58 miles
Direction North Nearest R.R. Santa Fe Distance 32
Road Conditions Good
3. Mining District and County: Gold Basin, Mohave
4. Former Name of Mine: Eldorado mine
5. Owner: C. W. Buscham
Address: 724 Stowell Ave., Kingman, Arizona
6. Operator: _____
Address: _____
7. Principal Minerals: Gold
8. Number of Claims: Lode 8 Patented _____ Unpatented 8
Placer _____ Patented _____ Unpatented _____
9. Type of Surrounding Terrain: High foot hills with 2 small canyons, one on each side, and on the south end
10. Geology and Mineralization: The prevailing rock formation is pre-Cambrian granites complex intruded by dykes of later igneous origin. The vein is a light-colored medium grained quartz carrying free gold fissure vein in the red schistified granite
11. Dimension and Value of Ore Body: open pit 600 ft. long, 200 ft. wide and 8 ft. thick. Value \$12 per ton. The vertical vein on the south end of open-pit is 3 to 4 wide. Value \$35 per ton. needs development.

Please give as complete information as possible and attach copies of engineer's reports, shipment returns, maps, etc. if you wish to have them available in this Department's files for inspection by prospective lessors or buyers.

(over)

12. Ore "Blocked Out" or "In Sight": 75,000 open pit ore. Vertical vein has several hundred tons of in stopes.

Ore Probable: The downward trend at the blanket vein could be picked by diamond drilling, also diamond the vertical veins.

13. Mine Workings—Amount and Condition: 2380 ft., good

No.	Feet	Condition
Shafts	80 on vein	
Raises	300	
Tunnels—drifts	2000	good
Crosscuts	150	good
Stopes	40,000 cu. ft. on three levels	

90,000 cu. ft. of underground work.

14. Water Supply: available

15. Brief History: Gold was found in the Eldorado mine about 1872. Minnesota & Arizona Gold Mining Company, of Minneapolis, installed a 10 ton cyanide leaching plant in 1900, and operated until the mill burned in 1905 when operation was suspended.

16. Remarks: The pit mine ore could be handled and milled for \$2 or less, as it can be bulldozed into the mill in one operation. For this reason, makes it an ideal operation, at low cost.

17. If Property for Sale, List Approximate Price and Terms: prefer royalty deal. But would sell for cash or on terms. Price open.

18. Signature: C W Burcham

WESTERN MACHINERY COMPANY

OFFICES AND WAREHOUSES

SAN FRANCISCO, CALIFORNIA
LOS ANGELES, CALIFORNIA
SACRAMENTO, CALIFORNIA
SALT LAKE CITY, UTAH
SPOKANE, WASHINGTON
DENVER, COLORADO
WASHINGTON, D. C.
PHOENIX, ARIZONA
NEW YORK, N. Y.

"Wemco Products"

TELEPHONE 3-4101
124 EAST BUCHANAN STREET
P. O. Box 2224
PHOENIX, ARIZONA

October 27, 1947.



CABLE ADDRESS
"WEMACHY"

RECEIVED

OCT 28 1947

DEPT. MINERAL RESOURCES
PHOENIX, ARIZONA

Mr. Charles Dunning
Arizona Mineral Resource Board
Mineral Building, Fairgrounds
Phoenix, Arizona

Dear Mr. Dunning:

A Mr. C. W. Burcham, Kingman, Arizona, wrote our San Francisco Office wanting to know if we knew anybody who was interested in taking over his mine. Our San Francisco Office referred it to us here, and at that time he did not give us any information on it. I wrote him for a report on it, or any data he might have available, which he just sent us a few days ago. I am enclosing herewith my complete file on this, and am wondering if you know of anybody who would be interested in it. I have no interest in it except to see mining in general progress. It may be that you already know this mine and possibly know all about it.

If you are interested in reading the report and looking at the maps, please do so, and then return them to me so that I can in turn send them back to Mr. Burcham.

Yours very truly,

WESTERN MACHINERY COMPANY

BY

J. P. Keller
J. P. Keller, Mgr.

JPK:hj
ENCL.

P.O. Box 681
Kingman, Arizona
October 22, 1947

Mr. J.P. Keller
Western Machinery Co
P.O. Box 2224
Phoenix, Arizona

Dear Mr. Keller:

I have received your letter of October 20th, stating that you frequently run across people interested in gold mines. I own a very good gold mine for a small operation.

The mine is developed by 2,000 ft. of tunnels and drifts. There is more than 40,000 tons of ore that will average around \$11.00 per ton in gold.

I am sending you Mr. R.C. Jacobson's Report and three maps of the Eldorado mine. Mr. Jacobson's report does not give the property due credit under modern conditions.

Would be please to hear from soon.
when you have finished with report. please return

Very truly yours,
CW Burcham

November 14, 1947

Mr. C. W. Burcham
Box 681
Kingman, Arizona

Dear Mr. Burcham:

Mr. J. P. Keller of the Western Machinery Company, Phoenix, has referred your letter and report by R. C. Jacobson, together with three maps of the Eldorado Mining Company, to us.

Due to the high cost of labor and equipment there is very little interest at the present time in Arizona gold mining. I would, however, suggest that you furnish us with a copy of the report and maps you sent Mr. Keller, which we are returning as per your request. In the future we will undoubtedly have some calls for property of this sort when business conditions become more stabilized. It would be well to have a complete report of your property in our files.

Yours very truly,

RICM:mh
Enc.

Roger I. C. Manning
Field Engineer

DEPARTMENT OF MINERAL RESOURCES

STATE OF ARIZONA

OWNERS MINE REPORT

Date July 21, 1939

Mine **ELDORADO**

District **Gold Basin**

Location **Mohave**

Former name

Owner **C. W. Burcham**

Address **Kingman, Arizona**

Operator

Address

President

Gen. Mgr.

Mine Supt.

Mill Supt.

Principal Metals **Gold**

Men Employed

Production Rate

Mill: Type & Cap.

Power: Amt. & Type

Operations: Present

Operations Planned **Soon as mill is constructed in district.**

Number Claims, Title, etc. **8 unpatented - title by location.**

Description: Topog. & Geog. **Low hilly area of about six miles square. The prevailing rock formation of the district is the pre-cambrian granite complex intruded by dykes of later igneous origin.**

Mine Workings: Amt. & Condition **About 2000 ft. drifts and crosscut tunnels. Most of timbering and workings in good condition.**

Geology & Mineralization Fissure in granite in conjunction on east with chloritic schist - upper segment of vein tilted forming a blanket outcrop about 200 ft x 600 ft with slight dip to east. Average 4 to 10 feet thick little overburden.

Ore: Positive & Probable, Ore Dumps, Tailings Estimated about 38,000 tons in ~~samples~~ blanket; 2,000 to 3,000 tons dump material. Samples show average \$10.50 told per ton.

Mine, Mill Equipment & Flow Sheet Free milling ore will require cyanide milling plant.

Road Conditions, Route 34 miles on Boulder Dam Road; 20 miles on Pierce's Ferry road, and 6 miles on OK road. Good condition.

Water Supply Have spring 11 miles away. Water may be had from the Colorado River or may be leased or purchased from other near by owners.

Brief History Discovered about 1880. From 1890-1906 actively mined and milled ore by Minnesota and Arizona Gold Mining Company. Produced some 6,000 tons about \$100,000.00. Old stamp mill followed by cyanide leaching - extractions 85% to 95%.

Special Problems, Reports Filed To get capital to develop the Gold Basin and Lost Basin Mining Districts.

Remarks The property has good possibilities for future development.

If property for sale: Price, terms and address to negotiate. For sale or lease. Price and terms may be arranged by writing to C. W. Burcham, P. O. Box 681, Kingman, Arizona.

ATTACHED:

Signed..... C. W. BURCHAM

Use additional sheets if necessary.

Geology & Mineralization

fissure in granite in conjunction on
East with Chloritic schist - upper segment
at vein tilted forming a blanket outcrop about
200 ft x 600 ft with slight dip to East, average 4
to 10 ft thick little overburden.

Ore: Positive & Probable, Ore Dumps, Tailings

Estimated about 38,000 tons in
blanket. 2,000 to 3,000 tons dump material -
Samples show average \$10.50 gold per ton.

Mine, Mill Equipment & Flow Sheet

Fres milling as will require
cyanide milling plant

Road Conditions, Route

34 miles on Boulder Dam road - 20 miles
on Pierce's Ferry road and 6 miles on A.K. road.
Good condition.

Water Supply

Hans Spring 11 miles away. Water
may be had from the Colorado River or may
be leased or purchased from other men by owners.

Brief History

Discovered about 1880. From 1890 - 1906 actively
mined and milled ore by Minnesota and Arizona
Gold Mining Company. Produced some 6,000 tons, about
\$100,000.00. Old stamp mill followed by cyanide leaching.
Extractions 85-90 to 95%.

Special Problems, Reports Filed

To get capital to develop the Gold
Basis and Lost Basin mining districts.

Remarks

The property has good possibilities for
future development

If property for sale: Price, terms and address to negotiate.

For sale or lease -
Price and Terms may be arranged by
writing to C.W. Burcham, P.O. Box 681
Kingman, Arizona

Signed

C.W. Burcham

DEPARTMENT OF MINERAL RESOURCES
STATE OF ARIZONA
OWNERS MINE REPORT

Date *July 21st, 1939*

Mine *Eldorado*
District *Gold Basin*

Location *Maham*

Former name

Owner *CW Burcham*

Address *Kingman, Arizona*

Operator

Address

President

Gen. Mgr.

Mine Supt.

Mill Supt.

Principal Metals

Gold

Men Employed

Production Rate

Mill: Type & Cap.

Power: Amt. & Type

Operations: Present

Operations Planned

Soon as mill is constructed in district

Number Claims, Title, etc.

8 Unpatented - Title by location

Description: Topog. & Geog.

Low hilly area of about six miles square. The prevailing rock formation of the district is the pre-Cambrian granite complex intruded by dykes of later igneous origin.

Mine Workings: Amt. & Condition

about 2000 ft drifts and cross cut tunnels. Most of timbering and working in good condition.

(over)

References: ABM Bull. 137 p. 76, USGS R.P. # 610 p. 40
USGS Bull. 397, DEPARTMENT OF MINERAL RESOURCES
STATE OF ARIZONA
p. 120, 121. MINE OWNER'S REPORT

Date July 21, 1939

1. Mine **ELDORADO** 2. Location **Mohave**
3. Mining District & County **Gold Basin**
4. Former name
5. Owner **G. W. Burcham** 6. Address (Owner) **Kingman, Arizona**
7. Operator 8. Address (Operator)
9. President, Owning Co. 9A. President, Operating Co.
10. Gen. Mgr. 14. Principal Minerals **Gold**
11. Mine Supt. 15. Production Rate
12. Mill Supt. 16. Mill: Type & Cap.
13. Men Employed 17. Power: Amt. & Type
18. Operations: Present

19. Operations: Planned **Soon as mill is constructed in district.**

20. Number Claims, Title, etc. **8 unpatented - title by location**

21. Description: Topography & Geography **Low hilly area of about six miles square. The prevailing rock formation of the district is the pre-cambrian granite complex intruded by dykes of later igneous origin.**

22. Mine Workings: Amt. & Condition **About 2000 ft. drifts and crosscut tunnels. Most of timbering and workings in good condition.**

(Signed) G. W. Burcham

23. Geology & Mineralization Fissure in granite in conjunction on east with chloritic schist - upper segment of vein tilted forming a blanket outcrop about 200 ft. x 600 ft. with slight dip to east. Average 4 to 10 feet thick little overburden.

24. Ore: Positive & Probable, Ore Dumps, Tailings Estimated about 38,000 tons in blanket; 2000 to 3,000 tons dump material. Samples show average \$10.50 told per ton.

24A. Dimensions and Value of Ore body

25. Mine, Mill Equipment & Flow-Sheet Free milling ore will require cyanide milling plant.

26. Road Conditions, Route 34 miles on Boulder Dam Road; 20 miles on Pierce's Ferry road, and 6 miles on OK road. Good condition.

27. Water Supply Have spring 11 miles away. Water may be had from the Colorado River or may be leased or purchased from other near by owners.

28. Brief History Discovered about 1880. From 1890-1906 actively mined and milled ore by Minnesota and Arizona Gold Mining Company. Produced some 6,000 tons about \$100,000.00. Old stamp mill followed by cyanide leaching - extractions 85% to 95%.

29. Special Problems, Reports Filed To get capital to develop the Gold Basin and Lost Basin Mining Districts.

30. Remarks The property has good possibilities for future development.

31. If property for sale: Price, terms and address to negotiate. For sale or lease. Price and terms may be arranged by writing to C. W. Burcham, P. O. Box 681, Kingman, Arizona.

32. Signature.....(Signed) C. W. Burcham

33. Use additional sheets if necessary.