



## **CONTACT INFORMATION**

Mining Records Curator  
Arizona Geological Survey  
1520 West Adams St.  
Phoenix, AZ 85007  
602-771-1601  
<http://www.azgs.az.gov>  
[inquiries@azgs.az.gov](mailto:inquiries@azgs.az.gov)

The following file is part of the

Arizona Department of Mines and Mineral Resources Mining Collection

## **ACCESS STATEMENT**

These digitized collections are accessible for purposes of education and research. We have indicated what we know about copyright and rights of privacy, publicity, or trademark. Due to the nature of archival collections, we are not always able to identify this information. We are eager to hear from any rights owners, so that we may obtain accurate information. Upon request, we will remove material from public view while we address a rights issue.

## **CONSTRAINTS STATEMENT**

The Arizona Geological Survey does not claim to control all rights for all materials in its collection. These rights include, but are not limited to: copyright, privacy rights, and cultural protection rights. The User hereby assumes all responsibility for obtaining any rights to use the material in excess of "fair use."

The Survey makes no intellectual property claims to the products created by individual authors in the manuscript collections, except when the author deeded those rights to the Survey or when those authors were employed by the State of Arizona and created intellectual products as a function of their official duties. The Survey does maintain property rights to the physical and digital representations of the works.

## **QUALITY STATEMENT**

The Arizona Geological Survey is not responsible for the accuracy of the records, information, or opinions that may be contained in the files. The Survey collects, catalogs, and archives data on mineral properties regardless of its views of the veracity or accuracy of those data.

PRINTED: 10-12-2011

ARIZONA DEPARTMENT OF MINES AND MINERAL RESOURCES AZMILS DATA

PRIMARY NAME: EL PITO COPPER CLAIMS

ALTERNATE NAMES:

GILA COUNTY MILS NUMBER: 188

LOCATION: TOWNSHIP 2 N RANGE 13 E SECTION 21 QUARTER C  
LATITUDE: N 33DEG 30MIN 25SEC LONGITUDE: W 111DEG 02MIN 30SEC  
TOPO MAP NAME: TWO BAR MOUNTAIN - 7.5 MIN

CURRENT STATUS: EXP PROSPECT

COMMODITY:  
COPPER

BIBLIOGRAPHY:  
ADMMR EL PITO COPPER MINE FILE  
CLAIMS EXTEND INTO SEC 15, 20 & 22

**ARIZONA DEPARTMENT OF MINERAL RESOURCES**  
**Mineral Building, Fairgrounds**  
**Phoenix, Arizona**

- 1. Information from: ✓ Andree ROBINSON  
Address: 337 West Pasadena, Phoenix, Arizona 85013 Phone: (602) 274-6379
- 2. Mine: ✓ El Pito Copper 3. No. of Claims - Patented \_\_\_\_\_  
Unpatented 7
4. Location: \_\_\_\_\_
5. Sec 15,20,21,22 Tp 2N Range 13E 6. Mining District Pinto Creek
- 7. Owner: ✓ Andree Robinson, Jacques Robinson, Yvonne Harrington
8. Address: Jacques Robinson, 225 W. Pasadena, Phnx 85013  
Yvonne Harrington, 337 W. Pasadena, Phnx 85013
9. Operating Co.: None
10. Address: N/A
11. President: N/A 12. Gen. Mgr.: N/A
- 13. Principal Metals: ✓ Copper 14. No. Employed: None
15. Mill, Type & Capacity: None
16. Present Operations: (a) Down ☐ (b) Assessment work ☒ (c) Exploration ☐  
(d) Production ☐ (e) Rate \_\_\_\_\_tpd.
17. New Work Planned: Owners holding claims.
- 18. Misc. Notes: The El Pito Copper Mine which consists of now seven claims  
of an original 105. The present seven were retained to hold the apex of  
the structure. They are the Coronado #1, Black Eagle, Black Hawk, Torez #1,  
Pito #1, Gordo #1, and Tuna #1, Pinto Creek Mining District, Gila County.  
The properties border Cities Services Corporation's Pinto Valley Mine.  
Mr. Robinson provided two maps for the file.

Date: June 27, 1979

Ken A. Phillips  
(Signature)

Ken A. Phillips  
(Field Engineer)

mw

**DEPARTMENT OF MINERAL RESOURCES**  
**STATE OF ARIZONA**  
**FIELD ENGINEERS REPORT**

Mine      El Pito Copper      Date      July 3, 1979  
District    Castle Dome, Gila County      Engineer    Ken A. Phillips *KAP*  
Subject:    Additional Information To Report, Dated June 27, 1979

The original El Pito Copper Mine claim group consisted of over 100 claims. Each contiguous block of either 5 or 10 claims had a different name. The following claim names were all part of the group:

Little Monster	Black Hawk
Happy Jack	Coronado
Small Fry	Gordo
Miassis Dra	Pito
Stones Throw	Torres
Colorado	Tuna
Howzatt	Suzette
Lulabell	Yvonne
Black Eagle	Jacques

The claim group has been submitted to numerous exploration companies, among which have been Phelps Dodge, Cities Service, Occidental, and Bear Creek.

A Mr. John Johnson, of Sedona, is reported to own an interest in the claim group for which he is obligated to perform assessment work.

August 6, 1979

Mrs. Yvonne Harrington  
337 West Pasadena Avenue, Apt 11  
Phoenix, Arizona 85013

Dear Mrs. Harrington:

Enclosed is a copy of a sketch of the El Pito Group on the appropriate topographic map base. The map, after the individual claim names have been added, will be acceptable for filing with the Bureau of Land Management. The map is inaccurate because the sketches you supplied are at best approximations and not to scale.

The decision on whether or not to keep the claims is indeed difficult. I sympathize with your quandary.

Please feel free to contact us any time we might be of further assistance.

Sincerely

Ken A. Phillips  
Mineral Resources Engineer

KAP:mw

Enclosure

John Harrington  
337 W. Pasadena Cir. Apt 11  
Phoenix, 265-5931  
Windsor 274-6379

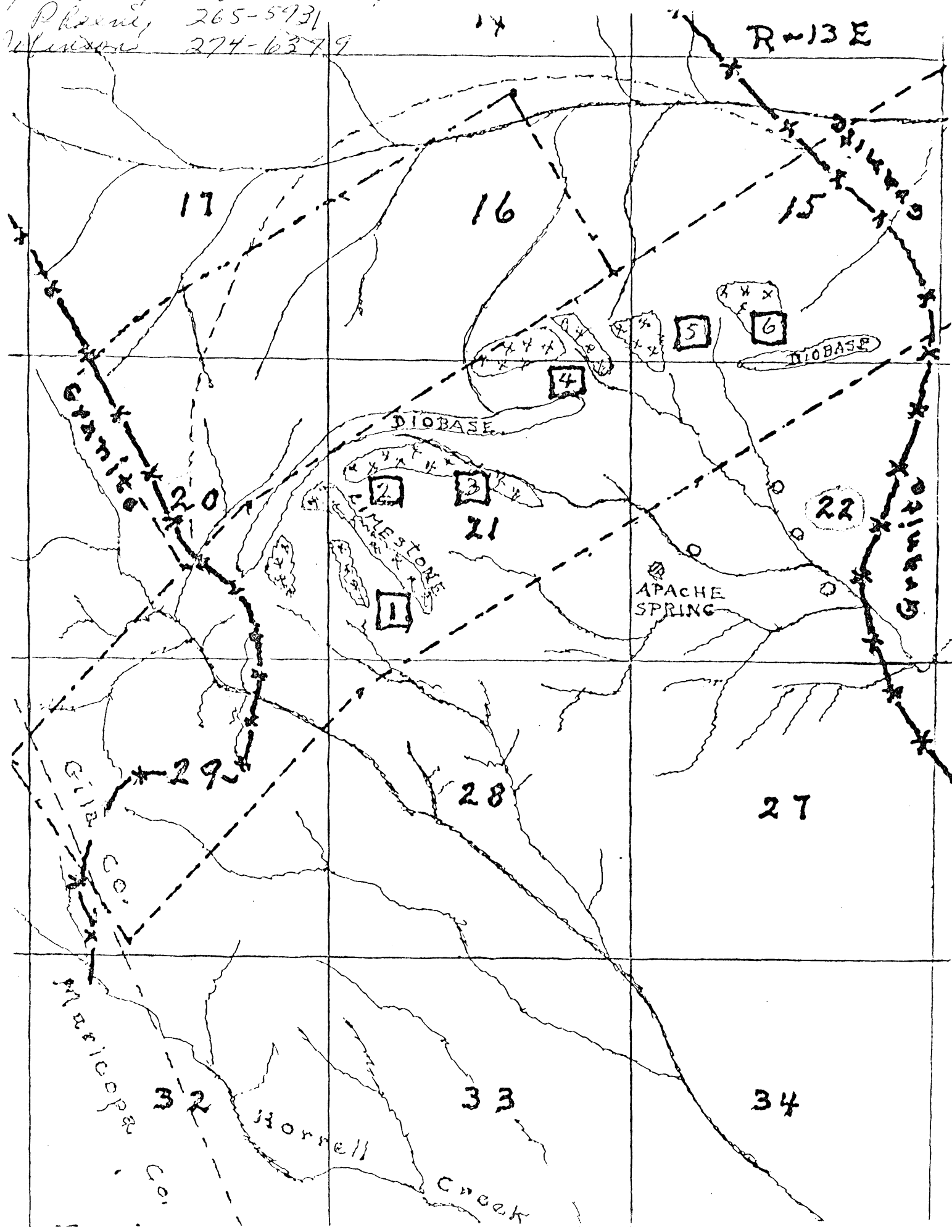

265-5931  
Robinson 274-6319

David	
Suzanne	
Jacques	
Yvonne	Colorado
TUNA	Stones-throw
Torrez	Little-Monster
Pito	Small-Fry
Gordo	Happy Jack
Coronado	Missis Dragon
Black Hawk	
Black Eagle	
Jug Head	
Lulu Bell	
Houzzatt	

WHITE SPRINGS MINING TRUST  
MINING PROPERTY

W → N

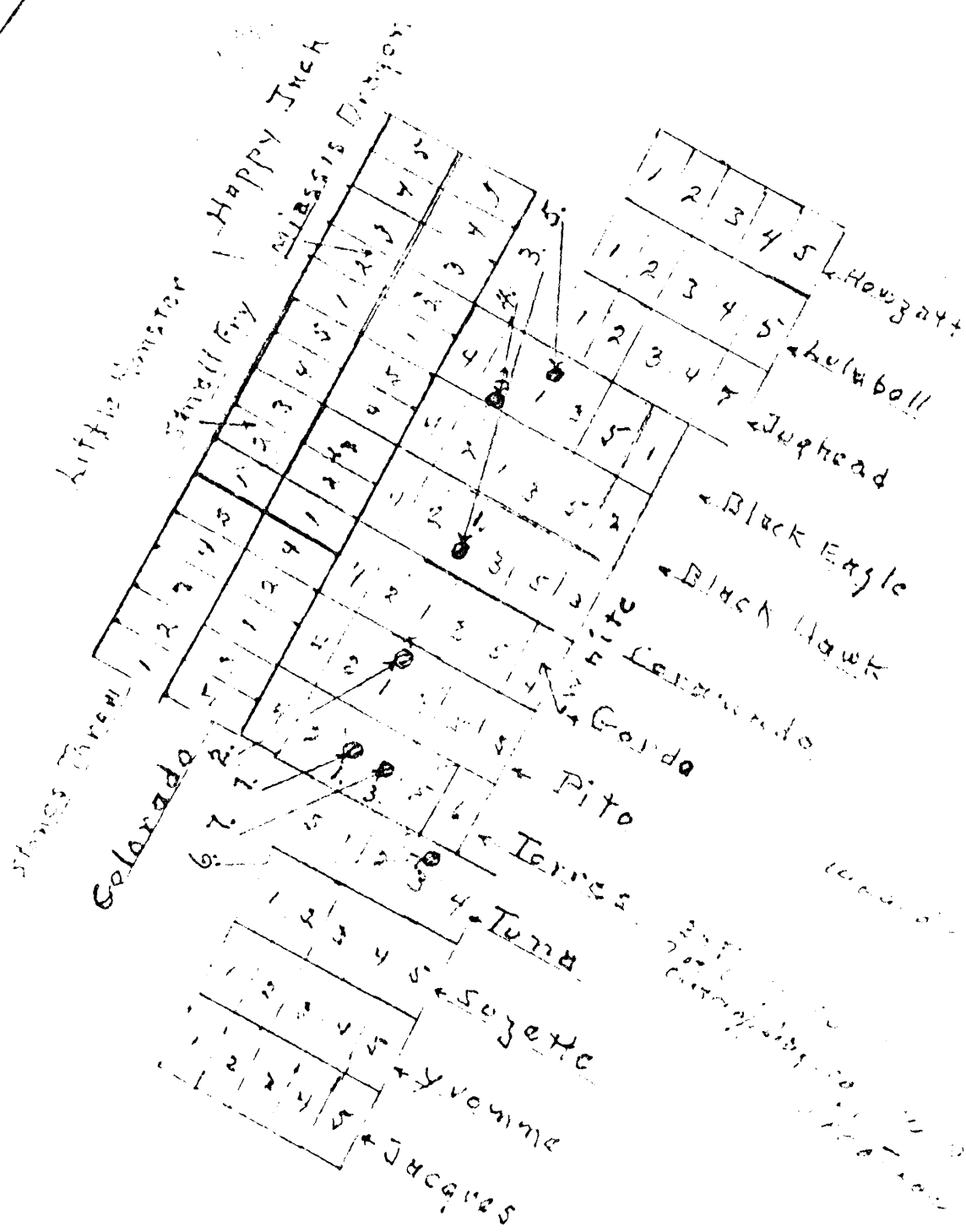



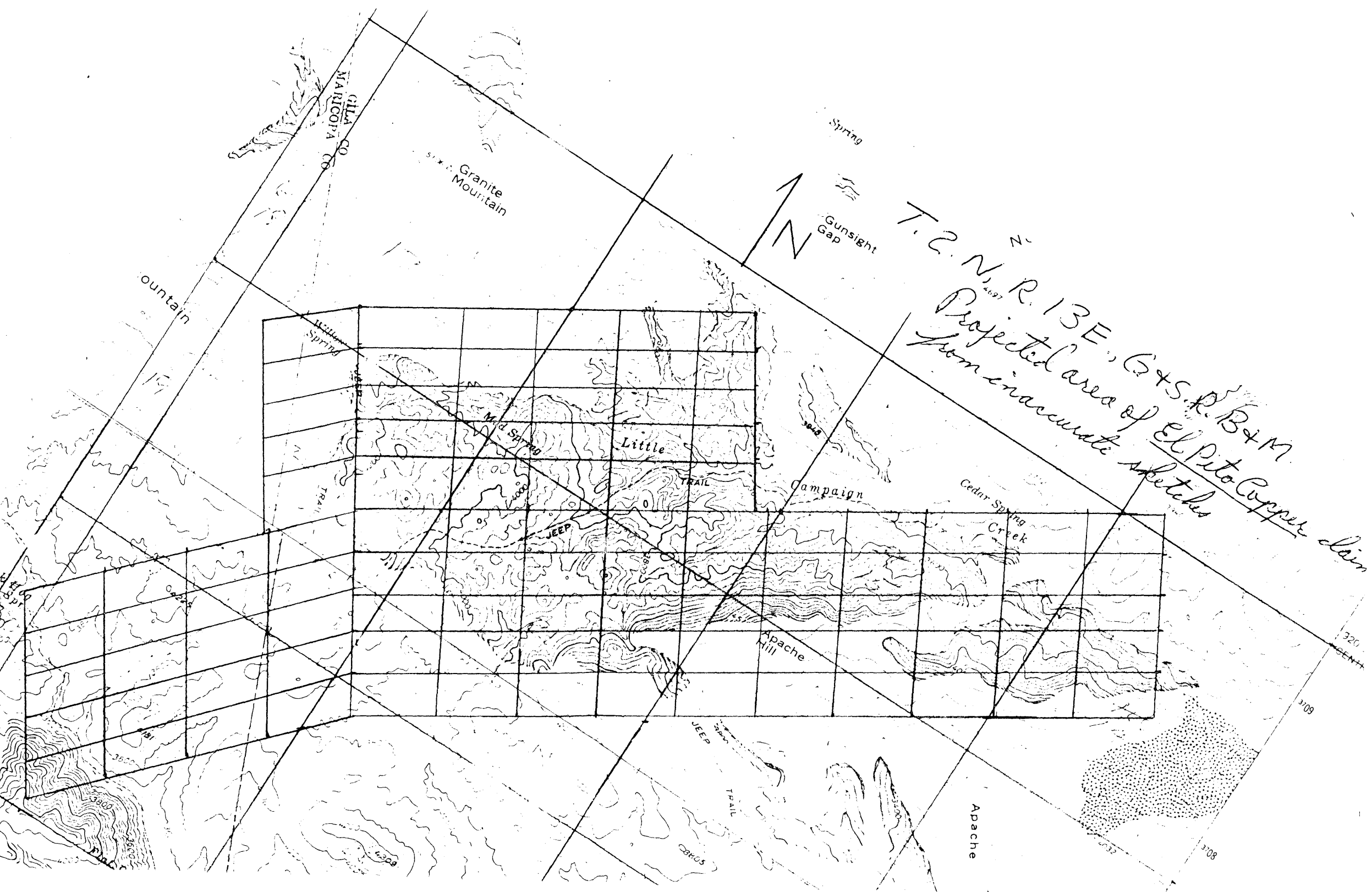



Projected area of El Pito Copper claims  
from inaccurate sketches



TWO BAR MTN, AZ  
7 1/2' QUAD

HAUNTED CANYON, AZ  
7 1/2' QUAD



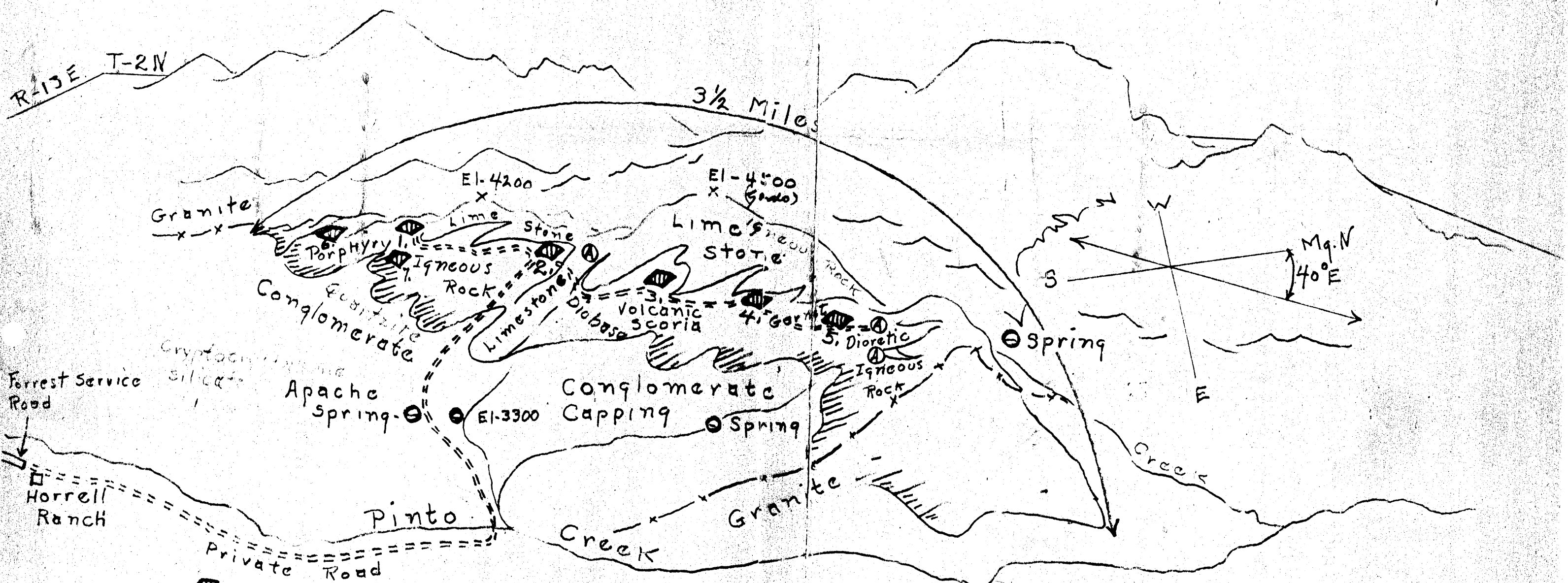

El Pito Copper  
 PO Box 302  
 Tempe, Arizona

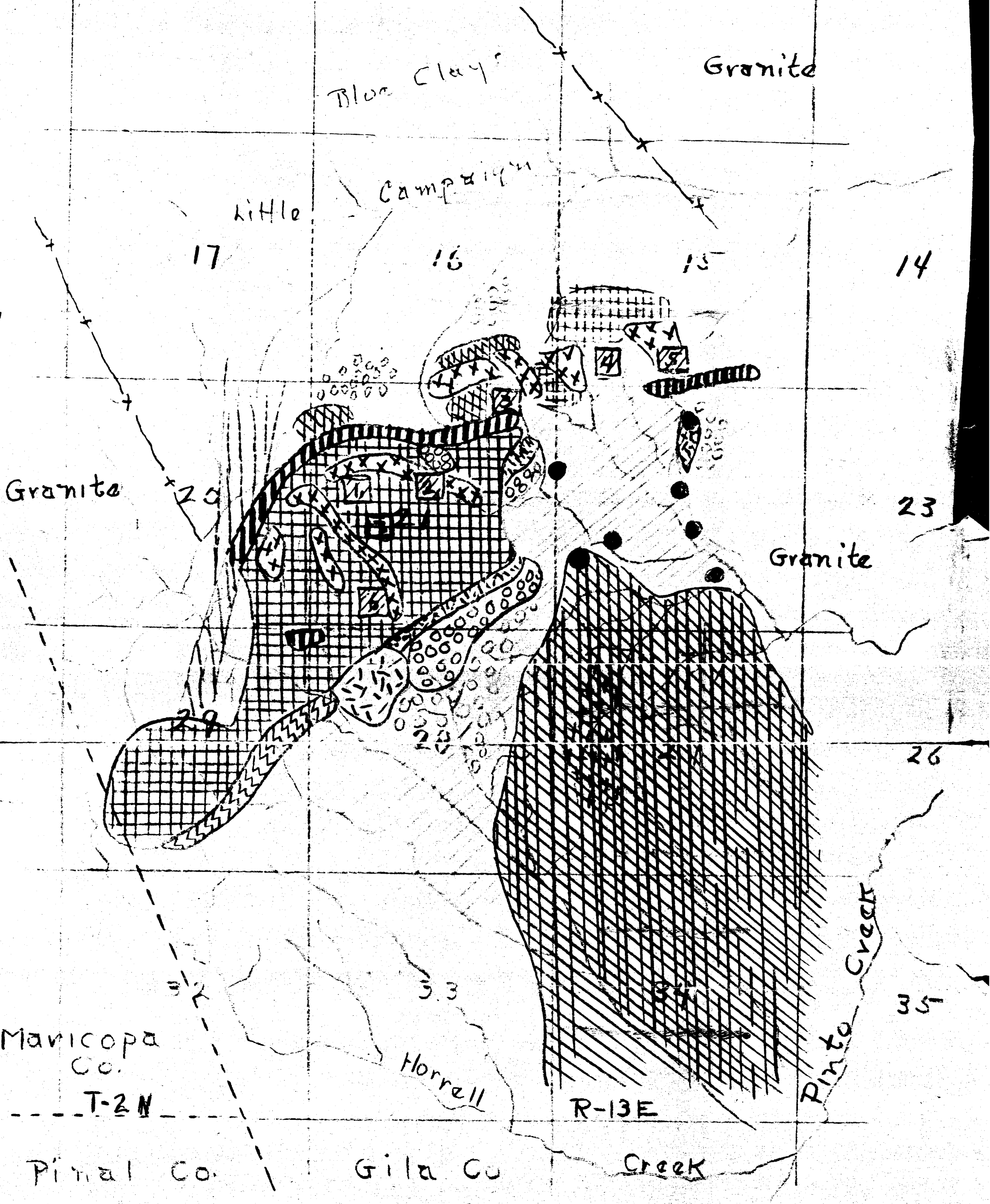

-  Copper Outcrops
-  Asbestos Outcrops
-  Springs

# El Pito COPPER



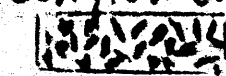

  
 Dioritic  
  
 Diabase

  
 Andesitic  
  
 Tuff

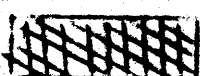
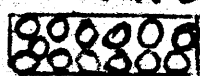
  
 Conglomerate  
  
 Sandstone

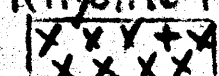
  
 Silicate  
  
 Limestone

  
 Rhyolite P.  
  
 Limestone

  
 Ore Outcrops  
  
 Springs