



CONTACT INFORMATION

Mining Records Curator
Arizona Geological Survey
1520 West Adams St.
Phoenix, AZ 85007
602-771-1601
<http://www.azgs.az.gov>
inquiries@azgs.az.gov

The following file is part of the

Arizona Department of Mines and Mineral Resources Mining Collection

ACCESS STATEMENT

These digitized collections are accessible for purposes of education and research. We have indicated what we know about copyright and rights of privacy, publicity, or trademark. Due to the nature of archival collections, we are not always able to identify this information. We are eager to hear from any rights owners, so that we may obtain accurate information. Upon request, we will remove material from public view while we address a rights issue.

CONSTRAINTS STATEMENT

The Arizona Geological Survey does not claim to control all rights for all materials in its collection. These rights include, but are not limited to: copyright, privacy rights, and cultural protection rights. The User hereby assumes all responsibility for obtaining any rights to use the material in excess of "fair use."

The Survey makes no intellectual property claims to the products created by individual authors in the manuscript collections, except when the author deeded those rights to the Survey or when those authors were employed by the State of Arizona and created intellectual products as a function of their official duties. The Survey does maintain property rights to the physical and digital representations of the works.

QUALITY STATEMENT

The Arizona Geological Survey is not responsible for the accuracy of the records, information, or opinions that may be contained in the files. The Survey collects, catalogs, and archives data on mineral properties regardless of its views of the veracity or accuracy of those data.

DEPARTMENT OF MINERAL RESOURCES
STATE OF ARIZONA
FIELD ENGINEERS REPORT

Mine El Oro
(Formerly Rand Gold Mines)

Date July 20, 1944

District White Picacho of Yavapai Co., Ariz.

Engineer B. W. Brown

Subject:

Examination for Mr. A. C. Haigler, 1211 N. 1st St. Phoenix, Ariz., owner.
Preliminary investigation.

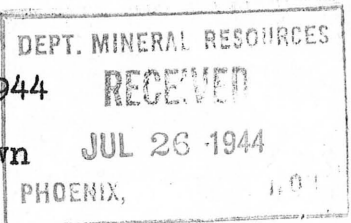

I did this day examine the El Oro Group of 10 unpatented mining claims which is situated partly in sections 25 and 36 of T-8-N, R-3-W, and sections 30 and 31 of T-8N, R-2-W in the White Picacho mining district of Yavapai county Arizona and which adjoins the Independence mine on the northeast and the Trilby mine on the east. The Independence mine is at this time producing some very excellent grade lead-silver ore under the operation of Mr. Fred Jensen. The Trilby mine is said to be one of the early gold producers of the district.

The property is held by Mr. A. C. Haigler whose address is 1211 N. 1st St. Phoenix Ariz.. All assays and reports of value hereinafter cited were kindly furnished me by Mr. A. C. Haigler, owner, and, although I cannot vouch for them, I have no reason to believe them unreliable.

The mine is reached from Morrystown, a station on the Santa-Fe railroad by about 8 miles of graded road and thence up Trilby wash (also called Tipton's wash) by about eight miles of dry sand and gravel creek bed. It lies in rolling desert hills at the headwaters of the Trilby wash and a branch of the Buckhorn. In general the geology is one of altered schist, quartz vein displacement within the schist, and a massive post-mineral pegmatite intrusive which has thoroughly disturbed the region.

Special emphasis was placed on workings on two claims, the Lookout and the Rand. More than 100 ft of trenching and shallow adit has revealed a quartz vein on the Lookout claim carrying cube iron with gold values reported to be very high-- the highest being 20 ounces. This vein runs in width from a mere seam to as high, in places, as 8 inches. In general it strikes northeasterly and dips to the west steeply (about 70 degrees). On the Rand claim an 80 ft. adit and shallow shaft (now caved) disclosed a mineralized zone within a dyke of altered hornblende schist. This dyke appears to grade into a silicified diorite carrying fine-grained pyrite (probably arsenical) with reported values up to \$27.00 taken over an 18 inch width and up to 3.94 ounces in gold sampled on a 4 inch width. This property was promoted in recent years under the name - Rand Gold Mines Co.

Domestic and mining water has not been developed but may be developed by sinking a shallow well in the Independence wash

DEPARTMENT OF MINERAL RESOURCES

STATE OF ARIZONA

FIELD ENGINEERS REPORT

Mine El Oro Date July 20, 1944
(Formerly Rand Gold Mines)
District White Picacho of Yavapai Co., Ariz. Engineer B. W. Brown
Subject: Examination for Mr. A. C. Haigler, 1211 N. 1st St., Phoenix, Arizona, owner.
Preliminary investigation.

I did this day examine the El Oro Group of 10 unpatented mining claims which is situated partly in sections 25 and 36 of T-8-N, R-3-W, and sections 30 and 31 of T-8-N, R-2-W in the White Picacho mining district of Yavapai County, Arizona and which adjoins the Independence Mine on the northeast and the Trilby Mine on the east. The Independence Mine is at this time producing some very excellent grade lead-silver ore under the operation of Mr. Fred Jensen. The Trilby Mine is said to be one of the early gold producers of the district.

The property is held by Mr. A. C. Haigler whose address is 1211 N. 1st St., Phoenix, Arizona. All assays and reports of value hereinafter cited were kindly furnished me by Mr. A. C. Haigler, owner, and, although I cannot vouch for them, I have no reason to believe them unreliable.

The mine is reached from Morristown, a station on the Santa Fe railroad by about 8 miles of graded road and thence up Trilby wash (also called Tipton's wash) by about eight miles of dry sand and gravel creek bed. It lies in rolling desert hills at the headwaters of the Trilby wash and a branch of the Buckhorn. In general the geology is one of altered schist, quartz vein displacement within the schist, and a massive post-mineral pegmatite intrusive which has thoroughly disturbed the region.

Special emphasis was placed on workings on two claims, the Lookout and the Rand. More than 100 ft. of trenching and shallow adit has revealed a quartz vein on the Lookout claim carrying cube iron and gold values reported to be very high -- the highest being 20 ounces. This vein runs in width from a mere seam to as high, in places, as 8 inches. In general it strikes northeasterly and dips to the west steeply (about 70 degrees). On the Rand claim an 80 ft. adit and shallow shaft (now caved) disclosed a mineralized zone within a dyke of altered hornblende schist. This dyke appears to grade into a silicified diorite carrying fine-grained pyrite (probably arsenical) with reported values up to \$27.00 taken over an 18 inch width and up to 3.94 ounces in gold sampled on a 4 inch width. This property was promoted in recent years under the name - Rand Gold Mines Co.

Domestic and mining water has not been developed but may be developed by sinking a shallow well in the Independence wash.

In conclusion, further work must be done to arrive at any estimate of value for this property. It is recommended that this work be carried out on the Rand claim.

/s/ B. W. Brown

Registered Mining Engineer

DEPARTMENT OF MINERAL RESOURCES
STATE OF ARIZONA
FIELD ENGINEERS REPORT

Mine **El Oro**

Date

District

Engineer **B. W. Brown**

Subject: **Continued**

In conclusion, further work must be done to arrive at any estimate of value for this property. It is recommended that this work be carried out on the Rand claim.



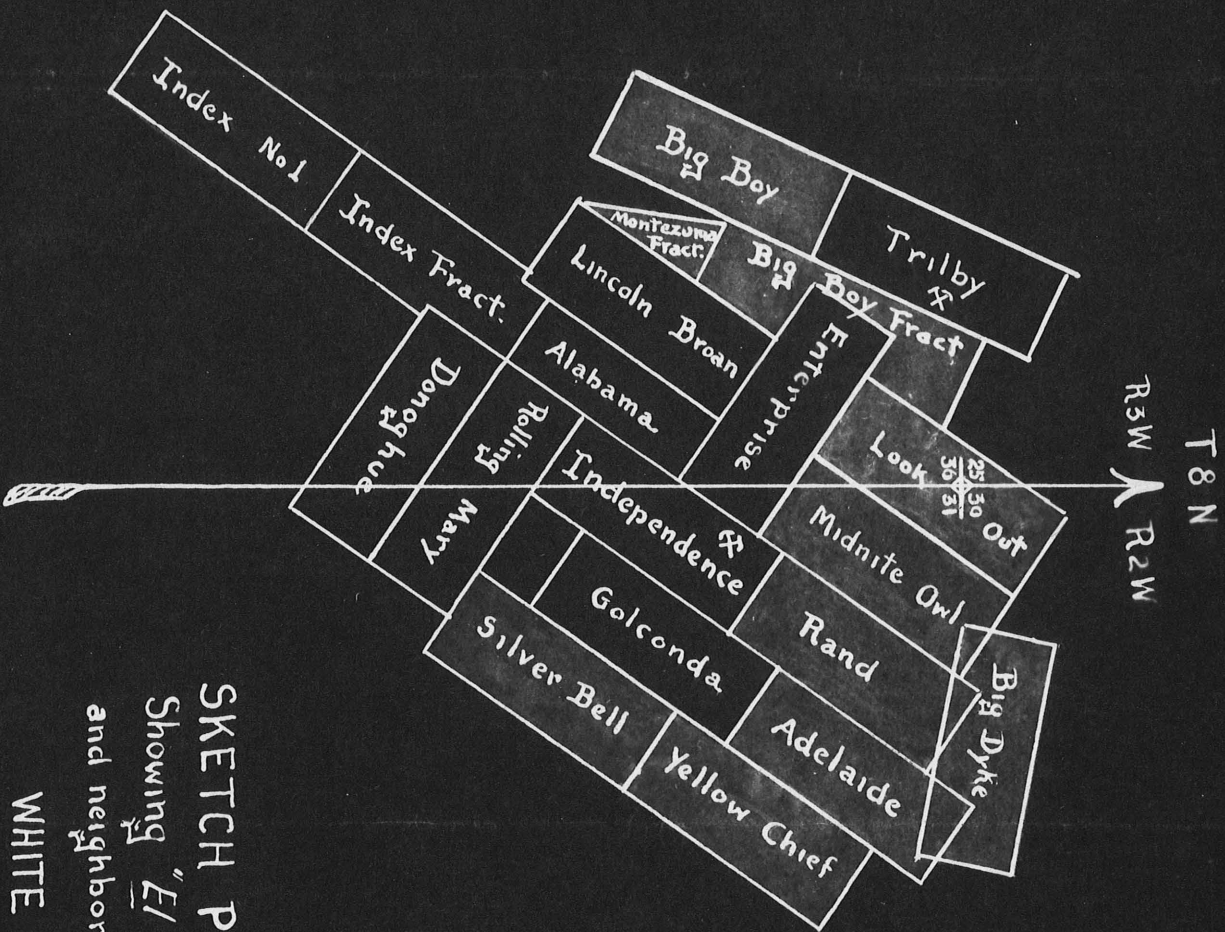

SKETCH PLAT OF CLAIMS
 Showing "El Oro Group" Mine
 and neighboring properties in
 WHITE PICACHO DIST.

YAVAPAI Co.

ARIZ.

7-44 / *3/18/23*

Approximate Scale 1" = 1200'
 Shaded Area Indicates "El Oro Group"
 Taken from information supplied by Mr. A. C. Haigler, owner

DEPARTMENT OF MINERAL RESOURCES
STATE OF ARIZONA
MINE OWNER'S REPORT

Date June 17, 1944

1. Mine El Oro Group
3. Mining District & County Yavapia.
White Puacho District
4. Former name
5. Owner A.C. & V. M. Heigler
7. Operator Same
9. President, Owning Co.
10. Gen. Mgr.
11. Mine Supt.
12. Mill Supt.
13. Men Employed
18. Operations: Present
None

2. Location Castle Hot Springs Road 8 miles. Turn to left up Tiptoris wash, keep right road 6 7/10 miles. Go to Independence Mine. Find Fred Jensen who will show you the property, or contact A.C. Heigler, 1211 N. 1st St., Phoenix, Arizona. Phone 3-3065
6. Address (Owner)
8. Address (Operator)
- 9A. President, Operating Co.
14. Principal Minerals
15. Production Rate
16. Mill: Type & Cap.
17. Power: Amt. & Type

9. Operations: Planned
Development for Gold

20. Number Claims, Title, etc.
Ten

21. Description: Topography & Geography

This property is North extension of Independence Mine

22. Mine Workings: Amt. & Condition

- 1 - tunnel 100'
- 2 - " 20' each
- 1 - Shaft 30' caved

Geology & Mineralization

ALABAMA STATE GEOLOGICAL SURVEY
MONTGOMERY, ALABAMA
36104-0001

Ore: Positive & Probable, Ore Dumps, Tailings

A. Dimensions and Value of Ore body

Mine, Mill Equipment & Flow-Sheet

Road Conditions, Route

Drive to within 1/2 mile.

Water Supply

none

Brief History

Special Problems, Reports Filed

Remarks

If property for sale: Price, terms and address to negotiate.

Wants to sell.

32. Signature.....

Use additional sheets if necessary.

DEPARTMENT OF MINERAL RESOURCES
STATE OF ARIZONA
MINE OWNER'S REPORT

ME-27

Date 6/19/44

1. Mine El Oro Group.
3. Mining District & County Yavapai - White Peach Dist
4. Former name
5. Owner AC+VM Haigler
7. Operator same
9. President, Owing Co.
10. Gen. Mgr.
11. Mine Supt.
12. Mill Supt.
13. Men Employed
18. Operations: Present
None

2. Location
6. Address (Owner)
8. Address (Operator)
9A. President, Operating Co.
14. Principal Minerals
15. Production Rate
16. Mill: Type & Cap.
17. Power: Amt. & Type

19. Operations: Planned
Development for Gold.

20. Number Claims, Title, etc.
10

21. Description: Topography & Geography
This property is North extension
of Independence Mine.

Coatle Hot Springs
Road 8 miles
Turn to left up Tipton's
wash keep right road
6 7/10 miles. go to
Independence Mine.
There may ^{be} Fred Jensen
who will show to this
property.
On contact AC Haigler
at 1211 N 1st St Phoenix
Phone 33065.

22. Mine Workings: Amt. & Condition
1- tunnel 100'
2- " 20' each
1- shaft 30' caved
(over)

23. Geology & Mineralization

24. Ore: Positive & Probable, Ore Dumps, Tailings

24A. Dimensions and Value of Ore body

25. Mine, Mill Equipment & Flow-Sheet

26. Road Conditions, Route

Drive to 1/2 mile.

27. Water Supply

None

28. Brief History

29. Special Problems, Reports Filed

30. Remarks

31. If property for sale: Price, terms and address to negotiate.

Wants to sell.

32. Signature.....

33. Use additional sheets if necessary.