



## **CONTACT INFORMATION**

Mining Records Curator  
Arizona Geological Survey  
1520 West Adams St.  
Phoenix, AZ 85007  
602-771-1601  
<http://www.azgs.az.gov>  
[inquiries@azgs.az.gov](mailto:inquiries@azgs.az.gov)

The following file is part of the

Arizona Department of Mines and Mineral Resources Mining Collection

## **ACCESS STATEMENT**

These digitized collections are accessible for purposes of education and research. We have indicated what we know about copyright and rights of privacy, publicity, or trademark. Due to the nature of archival collections, we are not always able to identify this information. We are eager to hear from any rights owners, so that we may obtain accurate information. Upon request, we will remove material from public view while we address a rights issue.

## **CONSTRAINTS STATEMENT**

The Arizona Geological Survey does not claim to control all rights for all materials in its collection. These rights include, but are not limited to: copyright, privacy rights, and cultural protection rights. The User hereby assumes all responsibility for obtaining any rights to use the material in excess of "fair use."

The Survey makes no intellectual property claims to the products created by individual authors in the manuscript collections, except when the author deeded those rights to the Survey or when those authors were employed by the State of Arizona and created intellectual products as a function of their official duties. The Survey does maintain property rights to the physical and digital representations of the works.

## **QUALITY STATEMENT**

The Arizona Geological Survey is not responsible for the accuracy of the records, information, or opinions that may be contained in the files. The Survey collects, catalogs, and archives data on mineral properties regardless of its views of the veracity or accuracy of those data.

PRINTED: 01-10-2013

ARIZONA DEPARTMENT OF MINES AND MINERAL RESOURCES AZMILS DATA

PRIMARY NAME: CROWN PRINCE

ALTERNATE NAMES:  
BANCOFT TUNNEL

MARICOPA COUNTY MILS NUMBER: 296

LOCATION: TOWNSHIP 6 N RANGE 10 W SECTION 23 QUARTER SW  
LATITUDE: N 33DEG 50MIN 48SEC LONGITUDE: W 113DEG 16MIN 42SEC  
TOPO MAP NAME: GLADDEN - 15 MIN

CURRENT STATUS: UNKNOWN

COMMODITY:  
GOLD

BIBLIOGRAPHY:  
USGS GLADDEN QUAD  
ADMMR CROWN PRINCE MINE FILE

## ARIZONA DEPARTMENT OF MINES AND MINERAL RESOURCES

VERBAL INFORMATION SUMMARY

1. Information from: Steven Grooms  
Company: Mother Lode Mining Co.  
Address: P.O. Box 903  
Wickenburg, AZ 85358
2. Phone: \_\_\_\_\_
3. Mine: CROWN PRINCE
4. ADMMR Mine File: Same
5. County: Maricopa
6. Summary of information received, comments, etc.: \_\_\_\_\_

Reported that the Crown Prince is in Section 35 as noted by BLM and not in section 23 as noted in MILS.

Date: December 12, 1988

Susie Schinner



SCALE 1:62500

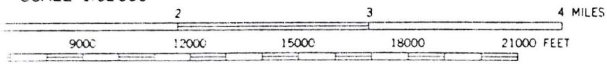

ROAD CLASSIFICATION  
 Heavy-duty Glades Light-duty

*Crown Pointe  
 Location ??*

CROWN PRINCE

MARICOPA

Mr. Clifford Russell, Phoenix, came in to discuss the Crown Prince mine in T6N R10W about 15 miles SW of Aguila. He has restaked 3 claims on the old Bancoft tunnel. We have no file on this deposit but Mr. Russell said samples taken from an area 600' by 400' resulted in assays from \$6.00/ton Au to \$48. Mr. Russell would like to dispose of this property. He was given the name and address of Virgil Wells in Aguila who is a dirt moving contractor but who has recently become interested in gold mining. GW WR 3/29/73

---

# 34924 SURPRISE NO 5

I 04

REPORT DATE: MAY 09, 1985  
STATE: ARIZONA

PCN: LT891PP1

UNITED STATES DEPARTMENT OF THE INTERIOR  
BUREAU OF LAND MANAGEMENT

PAGE NO: 1133

## SERIAL NUMBER INDEX

SERIAL NO.	CASE TYPE	CLAIM NAME/NUMBER	CLAIMANT(S)	-- -LEGAL DESCRIPTION-- -				GEO BLM	LEAD	COUNTY	LOCATION	LATEST CASE			
				MER	TWNSHP	RANGE	SEC	SUBDV	CTY	DST	FILE	BOOK;PAGE	DATE	ASSMT-YR	CLOSED
34924	LD	SURPRISE NO 5	PROHOROFF ALEX	14	10	N	1	E 1 NW	25	2		933 347	9 17 1974	1984	
34925	LD	SURPRISE NO 6	PROHOROFF ALEX	14	10	N	1	E 1 SW	25	2		933 348	9 17 1974	1984	
34926	LD	SURPRISE NO 7	PROHOROFF ALEX	14	10	N	1	E 1 SW	25	2		933 349	9 17 1974	1984	
								12 NW	25	2					
34927	LD	SURPRISE NO 8	PROHOROFF ALEX	14	10	N	1	E 1 NW	25	2		933 350	9 17 1974	1984	
34928	LD	SURPRISE NO 9	PROHOROFF ALEX	14	10	N	1	E 1 NW	25	2		933 351	9 17 1974	1984	
34929	LD	SURPRISE NO 10	PROHOROFF ALEX	14	10	N	1	E 1 W2	25	2		933 352	9 17 1974	1984	
34930	LD	RUSSELL MINE #1	RUSSELL CLIFFORD	14	10	N	4	W 29 NW	25	2		772 371	9 01 1972	1984	
			BLACKBURN THOMAS					30 NE	25	2					
34931	LD	RUSSELL MINE #2	RUSSELL CLIFFORD	14	10	N	4	W 30 NE	25	2	34930	784 898	10 25 1972	1984	
			BLACKBURN THOMAS												
34932	LD	RUSSELL MINE #3	RUSSELL CLIFFORD	14	10	N	4	W 30 NE	25	2	34930	784 899	10 25 1972	1984	
			BLACKBURN THOMAS					29 NW	25	2					
34933	LD	RUSSELL MINE #4	RUSSELL CLIFFORD	14	10	N	4	W 29 NW	25	2	34930	820 285	2 15 1973	1984	
			BLACKBURN THOMAS												
34934	LD	CROWN PRINCE #1	RUSSELL CLIFFORD	14	6	N	10	W 35 SE	13	2		6438 218	2 10 1967	1984	
			<del>RUSSELL FRANK</del>												
34935	LD	CROWN PRINCE #2	RUSSELL CLIFFORD	14	6	N	10	W 35 SE	13	2		6503 714	4 01 1967	1984	
			<del>RUSSELL FRANK</del>												
34936	LD	CROWN PRINCE #3	RUSSELL CLIFFORD	14	6	N	10	W 35 SE	13	2		6945 627	1 27 1968	1984	
			<del>RUSSELL FRANK</del>												
34937	LD	NORTH MANZANITA #1	RUSSELL CLIFFORD	14	9	N	2	W 1 SW	25	2		982 567	9 20 1975	1984 10 13 1983	
			RUSSELL ALLEN												
34938	LD	NORTH MANZANITA #2	RUSSELL CLIFFORD	14	9	N	2	W 1 S2	25	2		982 568	9 20 1975	1984 10 13 1983	
			RUSSELL ALLEN												
34939	LD	NORTH MANZANITA #3	RUSSELL CLIFFORD	14	9	N	2	W 1 SE	25	2		982 569	9 20 1975	1984 10 13 1983	
			RUSSELL ALLEN												
34940	LD	NORTH MANZANITA #4	RUSSELL CLIFFORD	14	9	N	2	W 1 SE	25	2		982 570	9 20 1975	1984 10 13 1983	
			RUSSELL ALLEN												
34941	LD	NORTH MANZANITA #5	RUSSELL CLIFFORD	14	9	N	2	W 1 SE	25	2		982 571	9 20 1975	1984 10 13 1983	
			RUSSELL ALLEN												
34942	LD	NORTH MANZANITA #6	RUSSELL CLIFFORD	14	9	N	2	W 1 SW	25	2		982 572	9 20 1975	1984 10 13 1983	
			RUSSELL ALLEN												
34943	LD	NORTH MANZANITA #7	RUSSELL CLIFFORD	14	9	N	2	W 1 W2	25	2		982 573	9 20 1975	1984 10 13 1983	
			RUSSELL ALLEN												
34944	LD	NORTH MANZANITA #8	RUSSELL CLIFFORD	14	9	N	2	W 1 W2	25	2		982 574	9 20 1975	1984 10 13 1983	
			RUSSELL ALLEN												
34945	LD	NORTH MANZANITA #9	RUSSELL CLIFFORD	14	9	N	2	W 1 NW	25	2		982 575	9 20 1975	1984 10 13 1983	
			RUSSELL ALLEN												
34946	LD	NORTH MANZANITA #10	RUSSELL CLIFFORD	14	9	N	2	W 1 NW	25	2		982 576	9 20 1975	1984 10 13 1983	
			RUSSELL ALLEN												
34947	LD	NORTH MANZANITA #11	RUSSELL CLIFFORD	14	9	N	2	W 1 NW	25	2		986 518	10 12 1975	1984	
			RUSSELL ALLEN												

\* \* DISCLOSURE\* \* ALL INFORMATION RECEIVED IN THIS OFFICE MAY NOT YET BE LISTED ON THIS REPORT. NAMES AND ADDRESSES ARE ENTERED AS THEY APPEAR ON THE LOCATION NOTICE OR ARE ABBREVIATED TO FIT LIMITED SPACE; THEREFORE THEY MAY NOT APPEAR IN THE EXPECTED SEQUENCE. A BLANK LATEST ASSESSMENT YEAR IN THIS REPORT DOES NOT CONSTITUTE AN ABANDONED CLAIM.

ARIZONA DEPARTMENT OF MINERAL RESOURCES  
Mineral Building, Fairgrounds  
Phoenix, Arizona

- 1. Information from: Alfred Russell  
Address: \_\_\_\_\_ 944-3568
- 2. Mine: Crown Prince 3. No. of Claims - Patented \_\_\_\_\_  
Unpatented 5
- 4. Location: Maricopa Co
- 5. Sec \_\_\_\_\_ Tp 6N Range 10W 6. Mining District: Elsworth
- 7. Owner: Alfred Russell
- 8. Address: \_\_\_\_\_
- 9. Operating Co.: private inactive
- 10. Address: \_\_\_\_\_
- 11. President: \_\_\_\_\_ 12. Gen. Mgr.: \_\_\_\_\_
- 13. Principal Metals: Fe 14. No. Employed: \_\_\_\_\_
- 15. Mill, Type & Capacity: \_\_\_\_\_
- 16. Present Operations: (a) Down  (b) Assessment work  (c) Exploration   
(d) Production  (e) Rate \_\_\_\_\_ tpd.
- 17. New Work Planned: \_\_\_\_\_  
\_\_\_\_\_  
\_\_\_\_\_
- 18. Misc. Notes: Free gold in schist - 600' x 400' x 6' also 4500  
2' lens of gtz -  
Related to Parrott tunnel.  
\_\_\_\_\_  
\_\_\_\_\_  
\_\_\_\_\_  
\_\_\_\_\_  
\_\_\_\_\_  
\_\_\_\_\_

Date: Mar 29 1973 \_\_\_\_\_ F T / Elmer \_\_\_\_\_  
(Signature) (Field Engineer)

1. DISTANCES  
 RE APPROX.

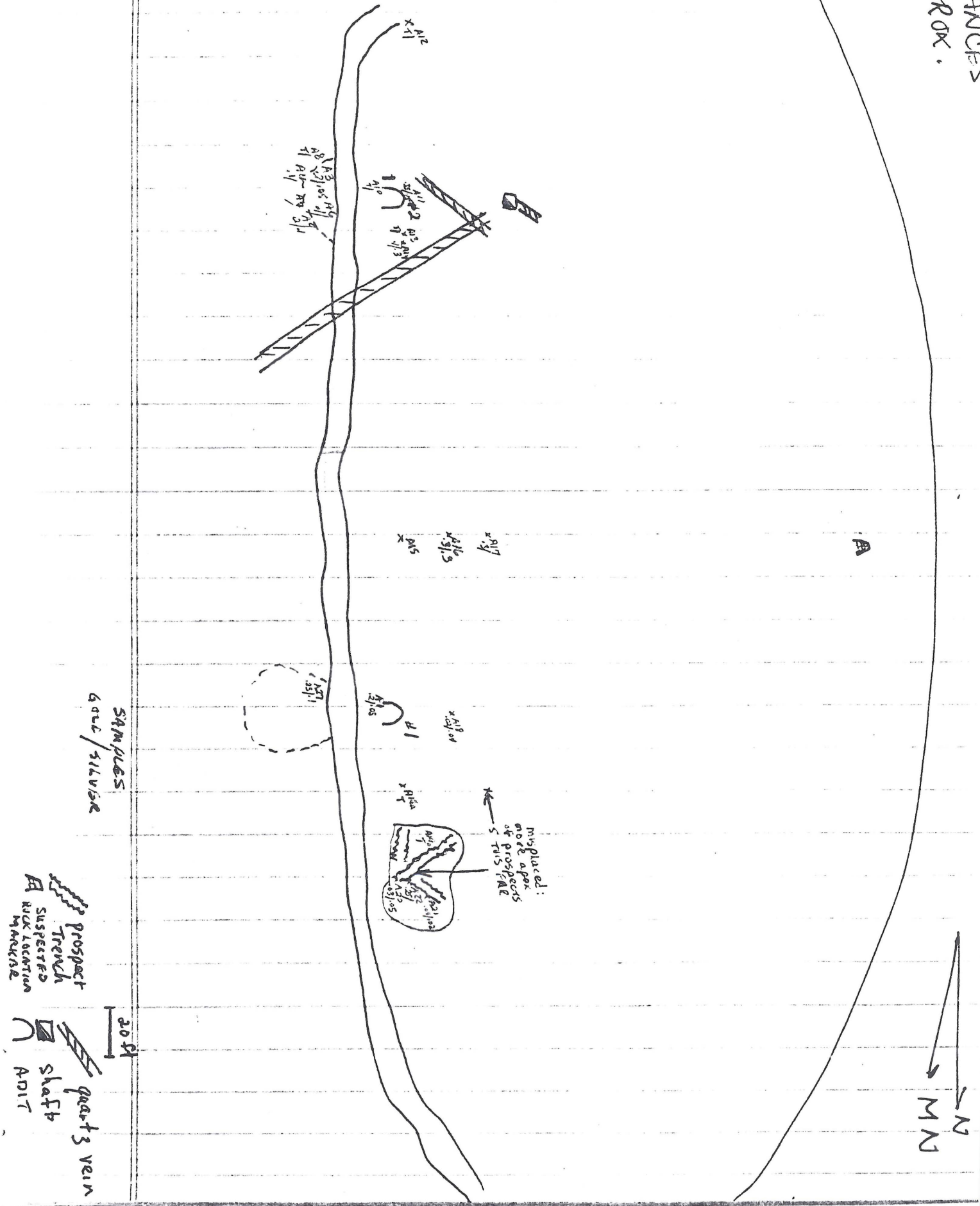

...the property (as you might now be) since I had had the



Brian Cowger  
327 Winona Blvd.  
Rochester, NY 14617

Frank Ferrall  
P.O. Box 101  
Ferrall, NE 55555

No.	Wt.	Method	Dore'	Au.	Remarks
A <sub>3</sub>	30g	F.A.	.25	.5 Ag. .2 Au	TAKEN FROM DUMP ADIT # 2
A <sub>4</sub>	30g	F.A.	.1	.1	TAKEN FROM DUMP ADIT # 2
A <sub>6</sub>	30g	F.A.	.15	.1	TAKEN FROM DUMP ADIT # 2
A <sub>17</sub>	30g	F.A.	.35	.3 Au	TAKEN 70' feet south of ADIT # 1 35' above (west) of ADIT LEVEL
A <sub>22</sub>	30g	F.A.	.3	.25 Au	TAKEN FROM FURTHEREST PROSPECT TRENCH OF 3; 35' N. of ADIT # 1; APPROX. SAME LEVEL AS ADIT
A <sub>25</sub>	30g	F.A.	.25	.2 Ag fossil Au	TAKEN FROM FURTHEREST PROSPECT TAKEN FROM SAMPLE MARKER TEST HOLE MIDDLE CLAIM; 100's of feet below (E) OF TOP CLAIM.
A <sub>27</sub>	30g	F.A.	.35	.1 Ag .25 Au	TAKEN FROM DUMP OF ADIT # 1

NUMBER.	AMOUNT	METHOD	RESULTS DORÉ	AG oz/T	AU oz/T	comments
16	30g.	FA	.6mg	.3	.3	TAKEN 20' above (W) of a point 70' S of adit #1; alluvial off top of mtn.?
17	30g.	FA	.4mg	.3	.1	In place rock, TAKEN 18' N. of adit #2
11 <sub>0</sub>	30g.	FA	.5mg	.15	.35	SHAFT AREA, WEST (ABOVE) adit #2
10	30g.	FA	.1mg	/	trace	MOUTH OF ADIT #2 (free gold?)
18	30g.	FA	.1mg	/	trace	TAKEN OFF DUMP OF ADIT #2 (wall rock?)
13	30g.	FA	less .1mg	/	trace	In place rock, near quartz vein, 15' N of adit #2
11 <sub>0</sub>	30g.	FA	.2mg	.1	.7	
21	30g.	FA	.1mg	.02	.08	TAKEN from furthest prospect trench 3, 35' N. of adit #1
24	30g.	FA	.05mg	/	trace	TAKEN FROM SAMPLE MARKER TEST HOLE; middle claim
4 <sub>0</sub>	30g.	FA	.1mg		.05	TAKEN OFF DUMP ADIT #2
12	30g.	FA	less .1	/	trace	TAKEN 70' S of adit #2, at shaft level
23	30g.	FA	.1	.01	.09	TAKEN FROM SAMPLE MARKER TEST HOLE; middle claim
20	30g.	FA	.08	.05	.03	FURTHEST PROSPECT OF 3, 35' N of adit #1.
11 <sub>0</sub>	30g.	FA	.1	.01	.09	
17	30g.	FA	/	/	/	TAKEN OFF DUMP ADIT #2
18	30g.	FA	.06	.04	.02	SHALE 20' ABOVE (W) OF ADIT #1
1	30g.	FA	.25	.05	.2	MOUTH OF ADIT #1
13A	30g.	FA	.1	/	trace	APPEARED TO BE AN URIDE TAKEN FROM ZONE IN PROSPECT 30' N OF ADIT #1
9	30g.	FA	.3	.1	.2	TAKEN OFF DUMP ADIT #2