



CONTACT INFORMATION

Mining Records Curator
Arizona Geological Survey
1520 West Adams St.
Phoenix, AZ 85007
602-771-1601
<http://www.azgs.az.gov>
inquiries@azgs.az.gov

The following file is part of the

Arizona Department of Mines and Mineral Resources Mining Collection

ACCESS STATEMENT

These digitized collections are accessible for purposes of education and research. We have indicated what we know about copyright and rights of privacy, publicity, or trademark. Due to the nature of archival collections, we are not always able to identify this information. We are eager to hear from any rights owners, so that we may obtain accurate information. Upon request, we will remove material from public view while we address a rights issue.

CONSTRAINTS STATEMENT

The Arizona Geological Survey does not claim to control all rights for all materials in its collection. These rights include, but are not limited to: copyright, privacy rights, and cultural protection rights. The User hereby assumes all responsibility for obtaining any rights to use the material in excess of "fair use."

The Survey makes no intellectual property claims to the products created by individual authors in the manuscript collections, except when the author deeded those rights to the Survey or when those authors were employed by the State of Arizona and created intellectual products as a function of their official duties. The Survey does maintain property rights to the physical and digital representations of the works.

QUALITY STATEMENT

The Arizona Geological Survey is not responsible for the accuracy of the records, information, or opinions that may be contained in the files. The Survey collects, catalogs, and archives data on mineral properties regardless of its views of the veracity or accuracy of those data.

05/03/99

ARIZONA DEPARTMENT OF MINES AND MINERAL RESOURCES FILE DATA

PRIMARY NAME: COPPER PRINCE

ALTERNATE NAMES:

MARICOPA COUNTY MILS NUMBER: 647

LOCATION: TOWNSHIP 8 N RANGE 5 W SECTION 36 QUARTER NW
LATITUDE: N 33DEG 59MIN 39SEC LONGITUDE: W 112DEG 43MIN 49SEC
TOPO MAP NAME: WICKENBURG - 7.5 MIN

CURRENT STATUS: PAST PRODUCER

COMMODITY:

GOLD LODE
SILVER
COPPER

BIBLIOGRAPHY:

ADMMR COPPER PRINCE MINE FILE

ARIZONA DEPARTMENT OF MINERAL RESOURCES
MINERAL BUILDING, FAIRGROUNDS
PHOENIX, ARIZONA

April 28, 1958

To the Owner or Operator of the Arizona Mining Property named below:

<u>COPPER PRINCE MINE (Maricopa County)</u>	<u>COPPER</u>
(Property)	(ore)

We have an old listing of the above property which we would like to have brought up to date.

Please fill out the enclosed Mine Owner's Report form with as complete detail as possible and attach copies of reports, maps, assay returns, shipment returns or other data which you have not sent us before and which might interest a prospective buyer in looking at the property.

Frank P. Knight

FRANK P. KNIGHT,
Director.

Enc: Mine Owner's Report

DEPARTMENT OF MINERAL RESOURCES
STATE OF ARIZONA
Mineral Building, Fairgrounds
PHOENIX, ARIZONA

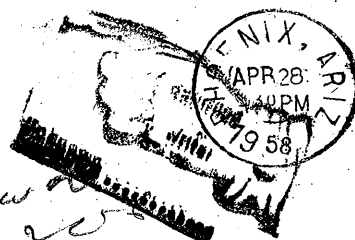

UNKNOWN
OR

Mr. H. M. Mayes
~~3907 Lankershim Blvd.~~
North Hollywood, California

Copper Prince Mine

H. M. MAYES
ATTORNEY-AT-LAW
3907 LANKERSHIM BLVD.
NORTH HOLLYWOOD, CALIFORNIA

February 9, 1933.

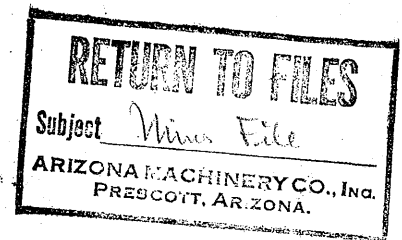

Operators and Developers, Inc.,
231 North Cortez Street,
Prescott, Arizona.

Mr. Clyde Matthews, Secretary,

Dear Sir:

Acknowledging your favor of the 30, ult. in reply to my inquiry to the Mayor of your city.

The mining property which I mention is in Maricopa County, Arizona. From Salome, southeasterly on the Buckeye Rd. to sign, "To Alaska Mine"; thence easterly about 12 miles, via Alaska mine to end of road. This is Copper Prince Mine. A Mr. Stagner is on the ground and am told, knows it thoroughly.

Tunnels, 75 ft. - 125 ft. and 300 ft. are on the property consisting of ten claims, besides other small diggings.

Considerable ore has been shipped from tunnels, but does not justify marketing in this way.

The owners are, probably, average miners, and hope to place a mill thereon, as in this way one can depend upon good returns.

They say this is Fisher vein and the values are worthwhile for mill on the ground. Water is available on the premises by well.

I inclose map with certificate of Assay, which will reveal more than I can state here. Will ask that map be returned to me when you have your data therefrom.

Your clients would, before concluding acquisition, satisfy themselves of its value. If so interested from this data, they may go upon these claims (Mr. Stagner will assist), determine for themselves.

The owners prefer not to sell this property, as before stated, they hope to work it sometime. They, however, would make a fair lease to work it by satisfactory people.

Will you kindly advise at your earliest convenience, whether your clients will give attention to the matter, as they may be protected in time to do so.

Yours very truly,

H. M. Mayes

Dec 26 8 N, 5 W,

About 15 Degrees North of West

ARIZONA MACHINERY COMPANY
231 N. CORTEZ STREET
PRESCOTT, ARIZONA

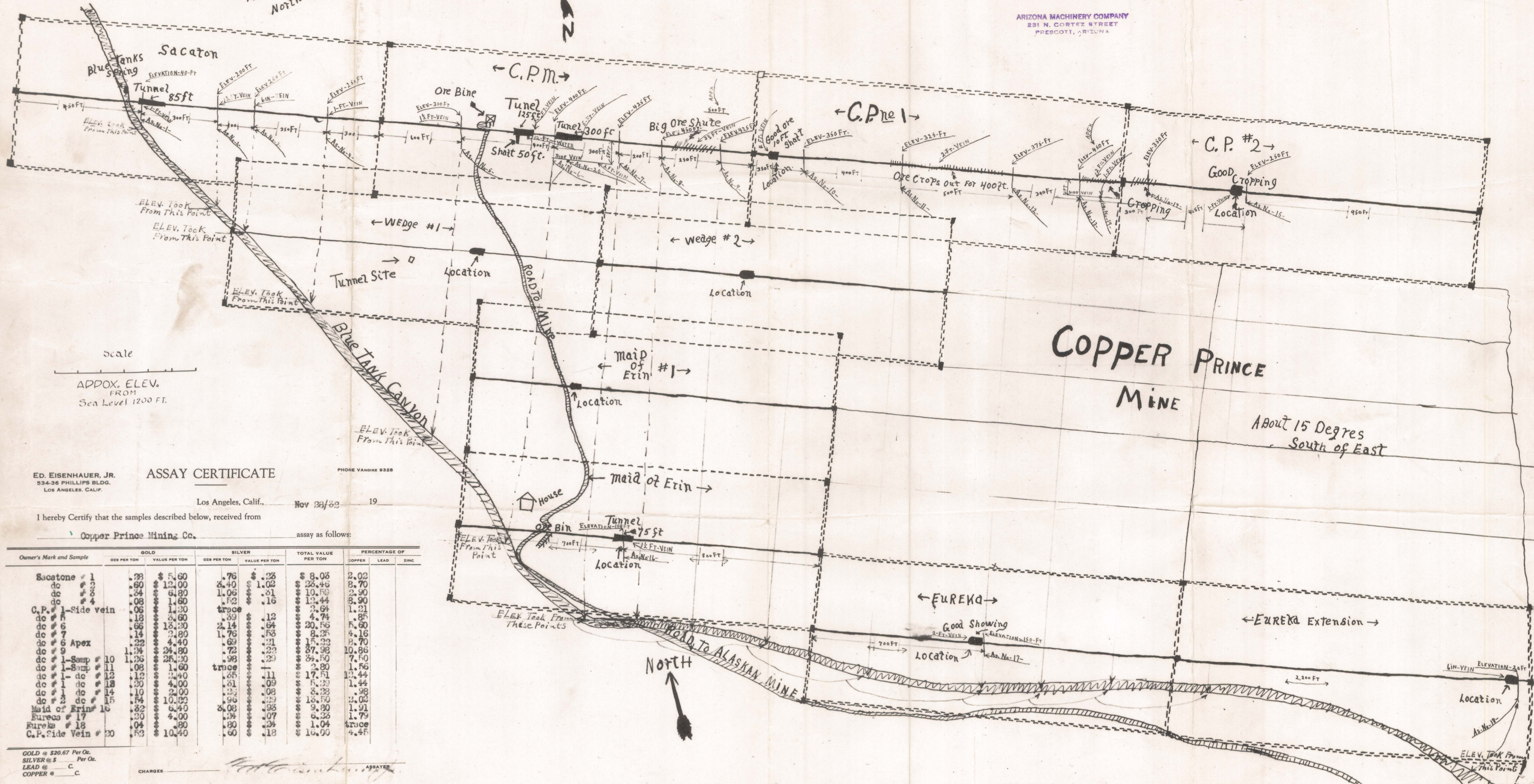

Scale
APPROX. ELEV. FROM SEA LEVEL 1200 FT.

ED. EISENHAUER, JR.
534-36 PHILLIPS BLDG.
LOS ANGELES, CALIF.

ASSAY CERTIFICATE

PHONE VANDORE 9328

Los Angeles, Calif., Nov 23/62 19

I hereby Certify that the samples described below, received from
Copper Prince Mining Co., assay as follows:

Owner's Mark and Sample	GOLD		SILVER		TOTAL VALUE PER TON	PERCENTAGE OF		
	OZS PER TON	VALUE PER TON	OZS PER TON	VALUE PER TON		COPPER	LEAD	ZINC
Sacaton # 1	.28	\$ 5.60	.76	\$.23	\$ 8.06	2.02		
do # 2	.60	12.00	6.40	1.02	26.46	8.70		
do # 3	.64	6.80	1.06	.61	10.59	2.90		
do # 4	.52	1.60	.52	.16	13.44	8.90		
C.P. # 1-Side vein	.06	1.20	trace		2.64	1.21		
do # 5	.18	3.60	.39	.12	4.74	1.85		
do # 6	.66	13.20	2.14	.64	20.56	5.60		
do # 7	.14	2.80	1.76	.53	8.35	4.16		
do # 6 Apex	.22	4.40	.69	.21	15.22	8.70		
do # 9	1.24	24.80	.72	.22	37.98	10.86		
do # 1-Samp	1.26	25.20	.98	.29	34.50	7.50		
do # 1-Samp	.08	1.60	trace		2.80	1.56		
do # 1- do	.12	2.40	.65	.11	17.51	12.44		
do # 1- do	.20	4.00	.61	.09	5.32	1.44		
do # 1- do	.10	2.00	.36	.08	8.38	.98		
do # 2- do	.74	10.92	.96	.29	18.50	2.02		
Maid of Erin # 16	.82	6.40	6.08	.93	9.80	1.91		
Eureka # 17	.20	4.00	.34	.07	6.26	1.79		
Eureka # 18	.04	.80	.80	.24	1.04	trace		
C.P. Side Vein # 20	.52	10.40	.60	.18	16.00	4.45		

GOLD @ \$20.67 Per Oz.
SILVER @ \$ Per Oz.
LEAD @ C.
COPPER @ C.

CHARGES

[Signature]
ASSAYER

NORTH

About 15 Degrees South of East