



## **CONTACT INFORMATION**

Mining Records Curator  
Arizona Geological Survey  
1520 West Adams St.  
Phoenix, AZ 85007  
602-771-1601  
<http://www.azgs.az.gov>  
[inquiries@azgs.az.gov](mailto:inquiries@azgs.az.gov)

The following file is part of the

Arizona Department of Mines and Mineral Resources Mining Collection

## **ACCESS STATEMENT**

These digitized collections are accessible for purposes of education and research. We have indicated what we know about copyright and rights of privacy, publicity, or trademark. Due to the nature of archival collections, we are not always able to identify this information. We are eager to hear from any rights owners, so that we may obtain accurate information. Upon request, we will remove material from public view while we address a rights issue.

## **CONSTRAINTS STATEMENT**

The Arizona Geological Survey does not claim to control all rights for all materials in its collection. These rights include, but are not limited to: copyright, privacy rights, and cultural protection rights. The User hereby assumes all responsibility for obtaining any rights to use the material in excess of "fair use."

The Survey makes no intellectual property claims to the products created by individual authors in the manuscript collections, except when the author deeded those rights to the Survey or when those authors were employed by the State of Arizona and created intellectual products as a function of their official duties. The Survey does maintain property rights to the physical and digital representations of the works.

## **QUALITY STATEMENT**

The Arizona Geological Survey is not responsible for the accuracy of the records, information, or opinions that may be contained in the files. The Survey collects, catalogs, and archives data on mineral properties regardless of its views of the veracity or accuracy of those data.

06/13/91

ARIZONA DEPARTMENT OF MINES AND MINERAL RESOURCES FILE DATA

PRIMARY NAME: COPPER FLAT GROUP

ALTERNATE NAMES:

WINKLER FAULKNER PROJECT  
ESSEX MINING  
BIG BIRD GROUP  
BONITA GROUP  
COFFEE GROUP

GRAHAM COUNTY MILS NUMBER: 100

LOCATION: TOWNSHIP 6 S RANGE 26 E SECTION 16 QUARTER ALL  
LATITUDE: N 32DEG 54MIN 34SEC LONGITUDE: W 109DEG 41MIN 23SEC  
TOPO MAP NAME: SAFFORD - 15 MIN

CURRENT STATUS: EXP PROSPECT

COMMODITY:

COPPER

BIBLIOGRAPHY:

ADMMR COPPER FLAT GROUP FILE  
ADMMR INFO  
AZ. STATE LAND DEPT. LEASES

FEB 3 1966  
By G.F

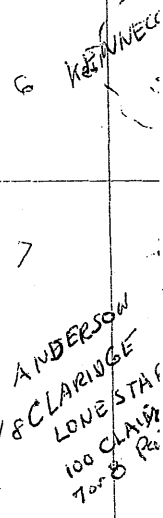
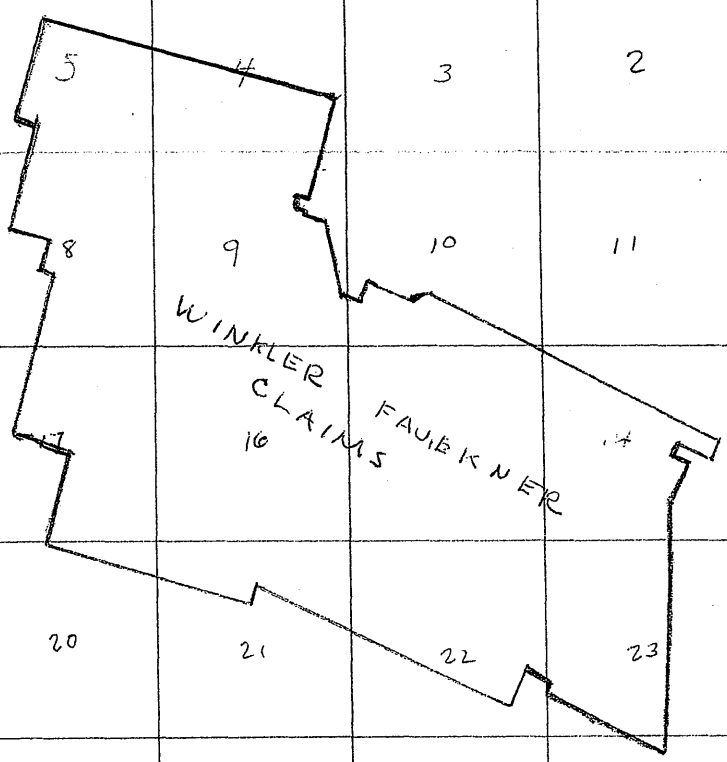
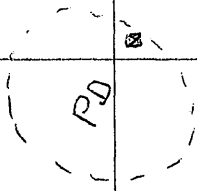

R26E

SAFFORD A12  
SHEET.

WINKLER-FAULKNER

GRAHAM COUNTY

Do Not Reproduce

Paul Eimanof ESSEX International said that a Mr. Mike Rebold of Alburquerque has acquired the Winkler-Faulkner property north of Safford. No more details are available at the present

GD WR 9-12-73

---

DEPARTMENT OF MINERAL RESOURCES  
STATE OF ARIZONA  
FIELD ENGINEERS REPORT

Mine Copper Flat Group & adjoining groups of claims  
Date October 6, 1960  
District Lone Star Mining District, Graham Co. Engineer Axel L. Johnson

Subject: Field Engineers Report. ~~Personal Visit &~~ Information from Paul E. Winkler, and Annan Cook.

References: Report of July 2, 1959.

Number of Claims: 227 unpatented claims in 4 separate groups. (See report of July 2, 1959.)

Owners: Big Bird Development Co., Box 772, Safford, et al. (See report of July 2, 1959.)

Principal Minerals: See report of July 2, 1959.

Present Activity: None.

Review of Recent Operations: Paul E. Winkler and other owners of the Big Bird Development Co. drilled one rotary drill hole through the surface overburden to bed rock, using a Phalanx Rotary Drill, which they had purchased. The bed rock was hit at a depth of 347 ft., after which drilling was suspended some time in June, with the expectation that it would be resumed later, using a diamond drill bit, (AX size).

Annan Cook stated that he had examined this bed rock and described it as andesite, which was unaltered and not mineralized.

Paul Winkler stated that his company expects to resume drilling about next December, and expects to hit ore at a depth of 630 ft.

DEPARTMENT OF MINERAL RESOURCES

STATE OF ARIZONA

FIELD ENGINEERS REPORT

Mine Copper Flat Group & adjoining groups of claims Date Oct. 3, 1962  
District Lone Star Mining District, Graham Co. Engineer Axel L. Johnson  
Subject: Field Engineers Report. Information from Paul E. Winkler.

References Report of Oct. 6, 1960, and previous reports

Number of Claims 227 unpatented claims in 4 separate groups. (See Report of July 2, '59)

Owners : Big Bird Development Co., Box 772, Safford, Ariz. et. al. (See Report of " )

Principal Minerals See report of July 2, 1959

Present Activity Diamond drilling with one diamond drill rig.

Review of Recent Operations The diamond drilling is being done by Paul Winkler and Ted Faulkner with their Joy 22 diamond drill rig. The other owners of the claims pay for their share of the drilling cost, in proportion to the number of claims they own. Mr. Winkler reports that 5 holes have now been drilled with their Joy 22 diamond drill, the depths of the holes varying according to the amount of overburden, etc. NX core is used most of the time. He reports that the hole now being drilled is down to a depth of 1254 ft. and is still going down. He reports 670 ft. of overburden at this location. Mr. Winkler says he hopes to hit commercial ore soon. Traces of ore has been reported at various depths.

DEPARTMENT OF MINERAL RESOURCES

STATE OF ARIZONA

FIELD ENGINEERS REPORT

Mine Copper Flat Group & adjoining groups Date Dec. 5, 1962  
District Lone Star Mining District, Graham Co. Engineer Axel L. Johnson  
Subject: Field Engineers Report. Information from Paul E. Winkler.

References Report of Oct. 3, 1962 and previous reports.

Number of Claims Over 200 claims in 4 separate groups (originally 227 claims, but some reported sold). The groups are Copper Flat, Big Bird, Bonita, & Coffee. (see report of July 2, 1959 for the number of claims in each group)

Owners Big Bird Development Co., Box 772, Safford, Ariz.

Principal Minerals Claims covered by overburden. Owners hope to find a large disseminated copper ore body underlying the overburden.

Present Activity Rotary drilling by Paul Winkler and Ted Faulkner with one drill rig.

Review of Recent Operations

(1) 5 diamond drill holes were put down up until Oct. 1962. The drilling was started in 1960, when one hole was drilled to a depth of 347 ft., after which drilling was postponed. Drilling was resumed again early in 1962, after which 4 more drill holes were put down. The last drill hole went down to a depth of 1256', but the other 3 holes were much shallower, probably varying from 400' to 600'. This hole was finished about Oct. 5, 1962.

(2) A magnetometer survey was made by Dirk den Baars and Associates of Tucson on parts of the area covered by the four groups of claims. Mr. Winkler showed ~~the~~ field engineer ~~xxxx~~ a map made by Mr. den Baars, showing the magnetic readings ~~obtained~~ obtained from this survey. The map was titled "Magnetic Anomaly Locations" by Dirk denBaars, Consulting Geologist. This map shows the location for the drilling of 2 diamond drill holes on the magnetic highs.

(3) Drilling was started on one of the magnetic high locations on Dec. 4, now being down to a depth of 10 ft. drilled and cased. A 3 7/8 in. tricone rock bit is being used for this drilling, while drilling through the overburden. When solid rock is reached, a core drill will be used with NX core.

Additional

(1) Mr. Winkler reported that he had found out that Sec. 16 - T 6 S - R 26 E was Federal surface with State mineral ownership. As some of the claims on one of the groups were in Sec. 16, and these were located previously as Federal claim locations, he got busy and obtained a State Prospecting Permit on Sec. 16.

(2) Mr. Winkler expressed to the field engineer a desire to apply for an O M E Exploration loan. He was informed that "copper" was removed from the list of minerals eligible for an exploration loan.

DEPARTMENT OF MINERAL RESOURCES  
STATE OF ARIZONA  
FIELD ENGINEERS REPORT

Mine      Copper Flat Group & adjoining Groups      Date      Feb. 6, 1963  
District   Lone Star District, Graham Co.      Engineer   Axel L. Johnson  
Subject:   Field Engineers Report.      Information from Paul Winkler.

References      Report of Dec. 5, 1963 and previous reports.

Present Activity      Diamond drilling by Paul Winkler and Ted Faulkner with one drill rig.

Review of Operations      Drilling was started on one of the magnetic high locations, as determined by Dirk den Baars magnetometer survey, on Dec. 4, 1962. A 3 7/8 in. tricone bit was used for drilling through the overburden. Mr. Winkler reports that solid rock was reached at a depth of 910 ft. a few days ago, and that they are now using a diamond bit for the continuation of the hole to the desired depth. Mr. Winkler reports that he has now employed the services of an experienced veteran driller by the name of Augie Greenwood to supervise the drilling operations.



DEPARTMENT OF MINERAL RESOURCES

STATE OF ARIZONA

FIELD ENGINEERS REPORT

Mine Copper Flat Group & adjoining groups

Date April 3, 1963

District Lone Star District, Graham Co.

Engineer Axel L. Johnson

Subject: Field Engineers Report. Information from Paul Winkler.

References: Report of Feb. 6, 1963 and previous reports.

Present Activity: Diamond drilling by Paul Winkler and Ted Faulkner with one drill rig.

Review of Operations: The drill hole that was started on a magnetic high location on Dec. 4, 1962 (See report of Dec. 5, 1962) was reported to have gone down to a depth of 1240 ft.

A second hole was then drilled to a depth of 730 ft.

A third hole has now been started.

It was reported that some of the Phelps Dodge geologists from Morenci have examined some of the drill cores for a study of the geology.

*Active mine list 1/63*

DEPARTMENT OF MINERAL RESOURCES

STATE OF ARIZONA  
FIELD ENGINEERS REPORT

Mine Copper Flat Group Date February 3, 1965  
(also called Big Bird Group)  
District Lone Star District, Graham County Engineer Axel L. Johnson  
Subject: Field Engineers Report. Information from Paul Winkler, et al

References: Reports of April 3, 1963, Feb. 6, 1963 and Dec. 5, 1962

Location: Part or all of Sections 4, 5, 8, 9, 10, 14, 15, 16, 17, 20, 21, 22 & 23 -  
T. 6 S. - R. 26 E. (See area enclosed in red on the accompanying map.)

Number of Claims: A total of 240 unpatented claims. The claims on Sec. 16 are State  
claims and the remainder are Federal claims.

Owners: Big Bird Development Co., Box 772, Safford. Principal owners are Paul E. Winkler,  
Box 772, Safford and Ted Faulkner, 215 Highway 70 E, Safford. Numerous claims in this  
group and 2% interests have been purchased by several Safford investors.

Lease with option to Purchase: Newmont Exploration Ltd. and Hecla Mining Co. - a joint  
venture. The main provisions of the contract are:

- (1) 5 months free time to do at least \$20,000 worth of geophysical work.
- (2) \$25,000 payments at the end of 5 months and at the end of 3 successive years.
- (3) Option to purchase for \$3,000,000 (\$12,500 per claim) within the lease period of  
3 years, 5 months.

Principal Minerals: Exploration work being done for copper.

Present Mining Activity:

- (1) Geological work being done by J. Douglas Bell, 6101 E. Oak St., Tucson, Geologist for  
Hecla Mining Co.
- (2) Geophysical work being done by Heinrichs Geoexploration Co., 808 W. Grant Road,  
Tucson, on contract.

Review of Recent Operations: Paul Winkler and Ted Faulkner have done considerable rotary  
and diamond drilling on this property from 1960 to 1964. A magnetometer survey was  
made by Dirk den Baars and Associates, Tucson, Ariz. in 1962, after which drilling was  
done on the magnetic anomaly locations.

Proposed Plans: See terms of lease & option (1), (2) & (3).

Adjacent Areas: 115 claims in TV Group, 8 claims in the Dixie Group, and 19 claims in  
the MCM Group in Sections 12, 13, 14, 15, 22, 23, and 24 - T. 6 S. - R. 25 E., owned by  
Paul E. Winkler and Ted Faulkner are not included in the lease & option.

DEPARTMENT OF MINERAL RESOURCES  
STATE OF ARIZONA  
FIELD ENGINEERS REPORT

Mine Winkler - Faulkner Project  
(formerly called Copper Flat Group)

Date May 4, 1965

District Lone Star District, Graham Co.

Engineer Axel L. Johnson

Subject: Field Engineers Report. Information from J. Douglas Bell, Geol., Hecla Mining Co  
2020 E. 13th St., Tucson.

References Report of Copper Flat Group -- Feb. 3, 1965 and previous reports.

Location See report of Feb. 3, 1965 on the Copper Flat Group.

Number of Claims See report of Feb. 3, 1965 on the Copper Flat Group.

Owners See report of Feb. 3, 1965, as above.

Lease with option to purchase See report of Feb. 3, 1965 on the Copper Flat Group.

Principal Minerals Exploration for copper.

Present Activity

Drilling with 1 diamond drill on contract from Boyles Bros.

Drilling with 1 rotary drill on contract to Ted Faulkner through the surface material preparatory to the drilling with the diamond drill.

Review of Recent Operations

(1) Geological work was done by J. Douglas Bell, geologist for Hecla Mining Co, 2020 E. 13th St., Tucson ---- Tel. 792-1745 (Note change of address & tel. no.)

(2) Geophysical work was done by Heinrichs Geosexploration Co., 808 W. Grant Rd., Tucson on contract.

DEPARTMENT OF MINERAL RESOURCES

STATE OF ARIZONA

FIELD ENGINEERS REPORT

Mine Copper Flat Group &  
adjoining groups of Claims  
District Lone Star Mining District, Graham Co.

Date July 2, 1959  
Engineer Axel L. Johnson

Subject: Field Engineers Report. Personal Visit & Information from Paul E. Winkler.

Location: Most of the claims lie in Secs. 3, 4, 9 & 10 -- T 6 S, R 26 E. Starting from Safford, drive 2 miles N. Turn right on Airport Road and drive about 3 miles NE. Turn left and drive  $2\frac{1}{2}$  to 3 miles N to the claims.

Number of Claims: 227 unpatented claims, viz:

(1) Copper Flat Group	--	57	claims
(2) Big Bird Group	--	120	"
(3) Bonita Group	--	43	"
(4) Coffee Group	--	7	"

Location work has been done on all except 50 claims located in the Big Bird Group about one month ago. Most of the location work has been done with a back holer.

Owners:

(1) Copper Flat Group	--	10	different owners
(2) Big Bird Group	--	10	" "
(3) Bonita Group	--	8	" "
(4) Coffee Group	--	2	" "

On all four groups there are about 20 different owners, the principal ones being Big Bird Development Co., Box 772, Safford, Arizona, with Paul E. Winkler, Ted Faulkner and Warren Matthews being the principal owners of this company, and also Wilford R. Richardson, 516 Main, Safford.

Principal Minerals: Practically all the claims are covered with overburden. Owners are of the opinion that an extension of the ore bodies, found on the Bear Creek and Phelps Dodge exploration projects, underlies this overburden.

Present Activity: None, with the exception of location work.

Proposed Plans: Operators plan to do some churn drilling or rotary drilling on some of the claims. They also plan to sink a well for water supply.

Additional: Mr. Winkler states that the claims are for sale, and that the owners will consider any reasonable offer.

DEPARTMENT OF MINERAL RESOURCES  
STATE OF ARIZONA  
FIELD ENGINEERS REPORT

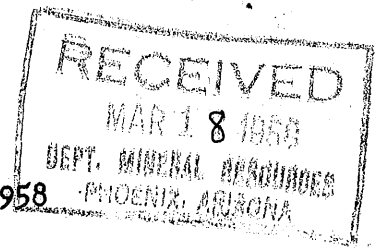

Mine ✓ Copper Flat Mining Claims

Date March 6, 1958

District Lone Star Mining District, Graham Co.

Engineer Axel L. Johnson

Subject: Field Engineers Report. Personal Visit & Information from Paul E. Winkler.

Location Sections 14 & 15 -- T 6 S -- R 26 E. Starting from Safford, drive 2 miles north. Turn right on Airport road and drive 3 1/2 miles NE. Turn left and drive 2 to 2 1/2 miles north to the claims.

Number of Claims 26 unpatented claims, located during the past month.

Owners ✓ Big Bird Development Co., Box 772, Safford, Ariz.  
✓ Paul E. Winkler, Box 772, Safford, Ariz.  
✓ Ted Faulkner, Safford, Ariz.  
✓ Warren Matthews, Rte. # 1, Safford, Ariz.

Principal Minerals No minerals visible, on account of ground covered by overburden. Owners are of the opinion that a large body of copper ore will be found in depth.

Present Mining Activity None, except location work.

Geology No ore visible. Owners hope that a continuation of the Lone Star deposit underlies the talus overburden.

Ore in Sight & Probable None.

Proposed Plans Owners plan on selling the mining claims to Bear Creek Mining Co., or some other large mining corporation.

Additional Mr. Winkler also reports that his company the "Big Bird Development Co." has also staked out the "Big Bird Mining Claims", comprising 48 unpat. claims, which lie approximately 2 miles NW of the Copper Flat Mining Claims, described above. Legal description of these claims is Secs. 4, 5, 8, & 9 -- T 6 S -- R 26 E.

These claims were not visited by the field engineer. Conditions of these claims, very likely, are somewhat similar to those of the Copper Flat Mining Claims described above.

THE T.V., M.C.M. AND DIXIE MINING CLAIMS  
 BELOW WERE ADDED TO THIS MAP BY  
 CLYDE FAULKNER 1-20-65

T.S.S.

T.C.S.

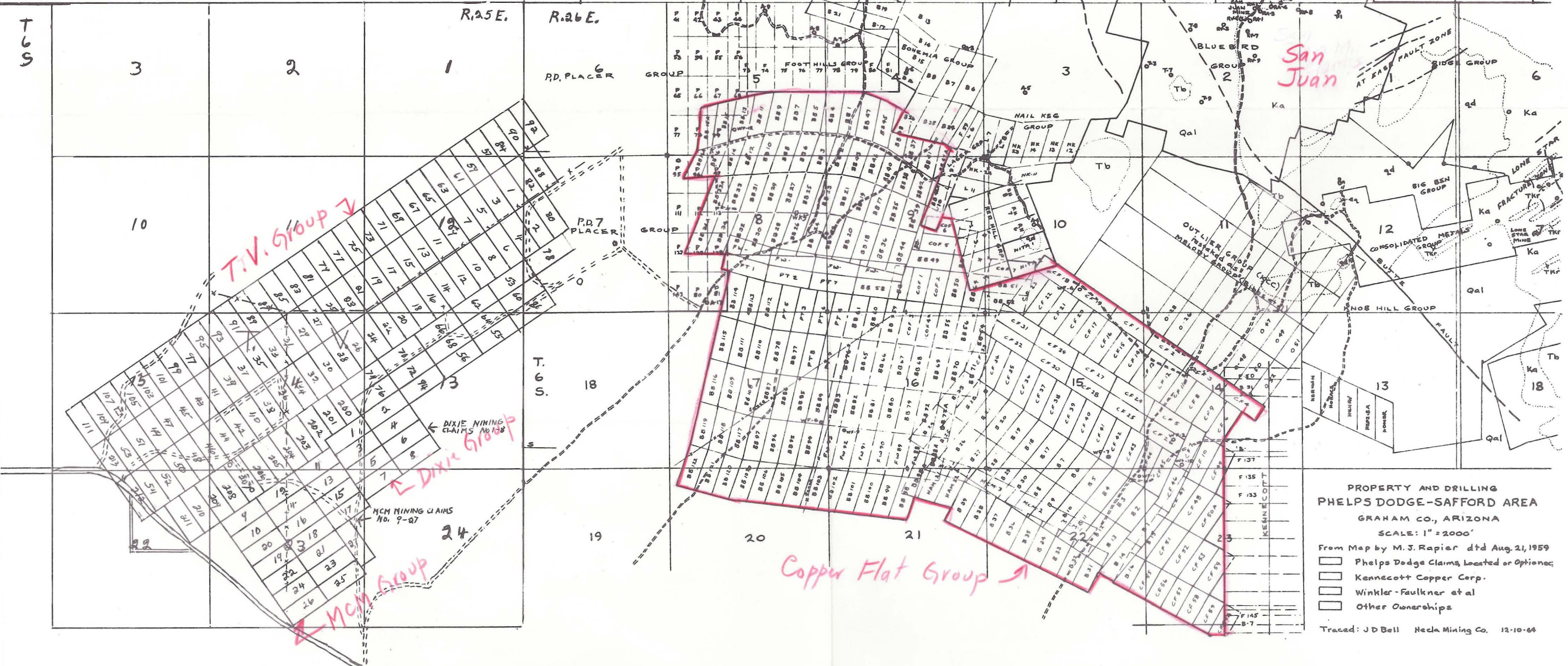
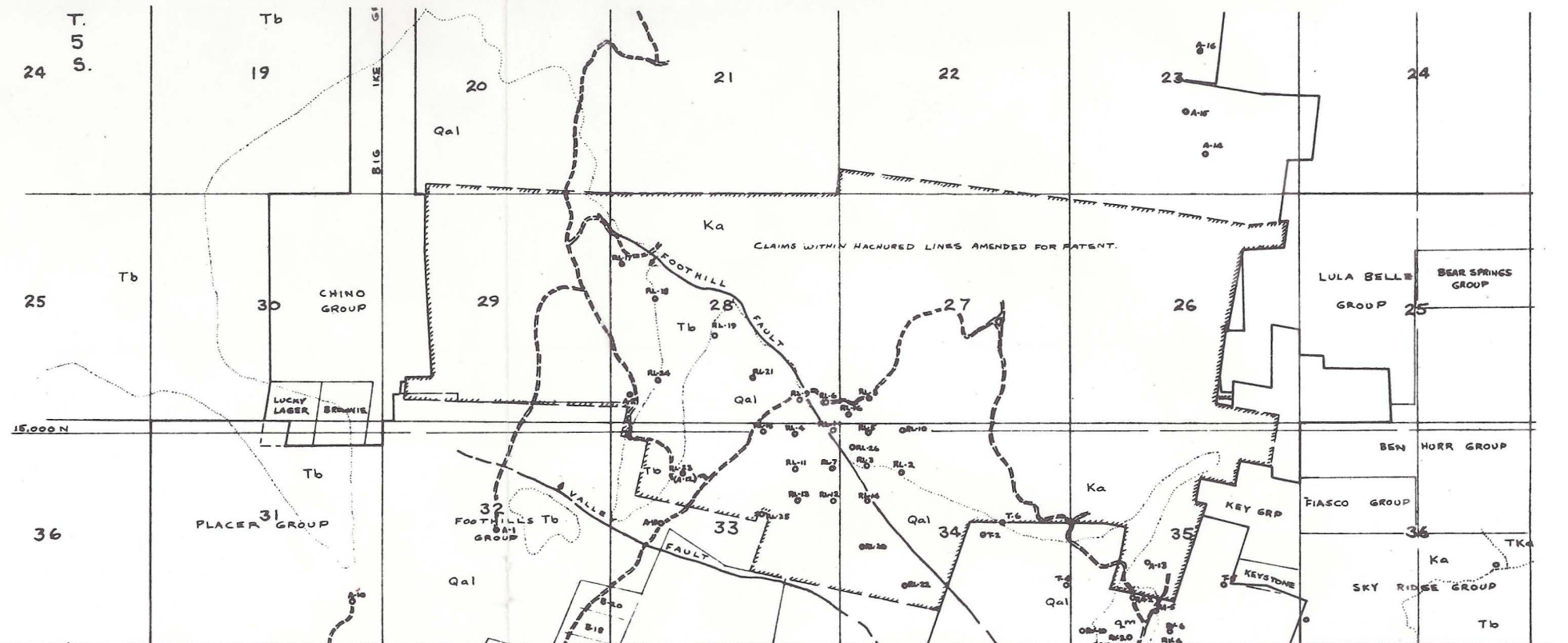

PROPERTY AND DRILLING  
 PHELPS DODGE-SAFFORD AREA  
 GRAHAM CO., ARIZONA  
 SCALE: 1" = 2000'  
 From Map by M. J. Rapier dtd Aug. 21, 1959  
 Phelps Dodge Claims, Located or Options  
 Kennecott Copper Corp.  
 Winkler-Faulkner et al  
 Other Ownerships

Traced: J.D. Bell Necla Mining Co. 12-10-64