



CONTACT INFORMATION

Mining Records Curator
Arizona Geological Survey
1520 West Adams St.
Phoenix, AZ 85007
602-771-1601
<http://www.azgs.az.gov>
inquiries@azgs.az.gov

The following file is part of the

Arizona Department of Mines and Mineral Resources Mining Collection

ACCESS STATEMENT

These digitized collections are accessible for purposes of education and research. We have indicated what we know about copyright and rights of privacy, publicity, or trademark. Due to the nature of archival collections, we are not always able to identify this information. We are eager to hear from any rights owners, so that we may obtain accurate information. Upon request, we will remove material from public view while we address a rights issue.

CONSTRAINTS STATEMENT

The Arizona Geological Survey does not claim to control all rights for all materials in its collection. These rights include, but are not limited to: copyright, privacy rights, and cultural protection rights. The User hereby assumes all responsibility for obtaining any rights to use the material in excess of "fair use."

The Survey makes no intellectual property claims to the products created by individual authors in the manuscript collections, except when the author deeded those rights to the Survey or when those authors were employed by the State of Arizona and created intellectual products as a function of their official duties. The Survey does maintain property rights to the physical and digital representations of the works.

QUALITY STATEMENT

The Arizona Geological Survey is not responsible for the accuracy of the records, information, or opinions that may be contained in the files. The Survey collects, catalogs, and archives data on mineral properties regardless of its views of the veracity or accuracy of those data.

PRINTED: 01/15/2003

ARIZONA DEPARTMENT OF MINES AND MINERAL RESOURCES AZMILS DATA

PRIMARY NAME: COPA DE ORO PLANT

ALTERNATE NAMES:

COCHISE COUNTY MILS NUMBER: 750

LOCATION: TOWNSHIP 23 S RANGE 26 E SECTION 6 QUARTER NW
LATITUDE: N 31DEG 27MIN 59SEC LONGITUDE: W 109DEG 44MIN 50SEC
TOPO MAP NAME: DOUBLE ADOBE - 7.5 MIN

CURRENT STATUS: UNKNOWN

COMMODITY:
MILL HEAP LEACH

BIBLIOGRAPHY:
ADMMR COPA DE ORO PLANT FILE

ARIZONA DEPARTMENT OF MINERAL RESOURCES
Mineral Building, Fairgrounds
Phoenix, Arizona

1. Information from: Arizona Deputy Mine Inspector Canuto Sena
Address: _____
2. Mine: COPA de ORO PLANT 3. No. of Claims - Patented _____
(Cochise Co.) Unpatented _____
4. Location: East of Bisbee on Elfrida Cutoff road (see Double Adobe 7½' Quad.)
5. Sec. ^{NW¼} 6 Tp. 23S Range 26E 6. Mining District Paul
7. Owner: _____
8. Address: _____
9. Operating Co.: Minera Copa de Oro, Inc. (phone (915) 592-5872)
10. Address: 10420 Montwood, Suite S, El Paso, TX 79935
11. President: Mack W. Dalton 12. Gen. Mgr.: Fred Baker
13. Principal Metals: Gold & silver 14. No. Employed: _____
15. Mill, Type & Capacity: Heap leach
16. Present Operations: (a) Down (b) Assessment work (c) Exploration
(d) Production (e) Rate _____ tpd.
17. New Work Planned: There is no activity at this site and apparently no activity planned.
18. Misc. Notes: Apparently in the fall of 1981, the company began to prepare a site for a cyanide heap leaching facility. Shortly after work began, however, the operation was stopped because of problems with county permitting. In addition there may have been financial difficulties.
- _____
- _____
- _____
- _____
- _____
- _____

Date: March 14, 1985

M. N. Greeley
(Signature) (Field Engineer)

DEPARTMENT OF THE INTERIOR
GEOLOGICAL SURVEY

Double Adobe 7 1/2' Quad.

V. SE

109° 45' ↑ 619000m. E.

R. 26 E

42' 30"

31° 30'

35000m. N.

To Cowan Rd
(~ 6 3/4 miles) 19

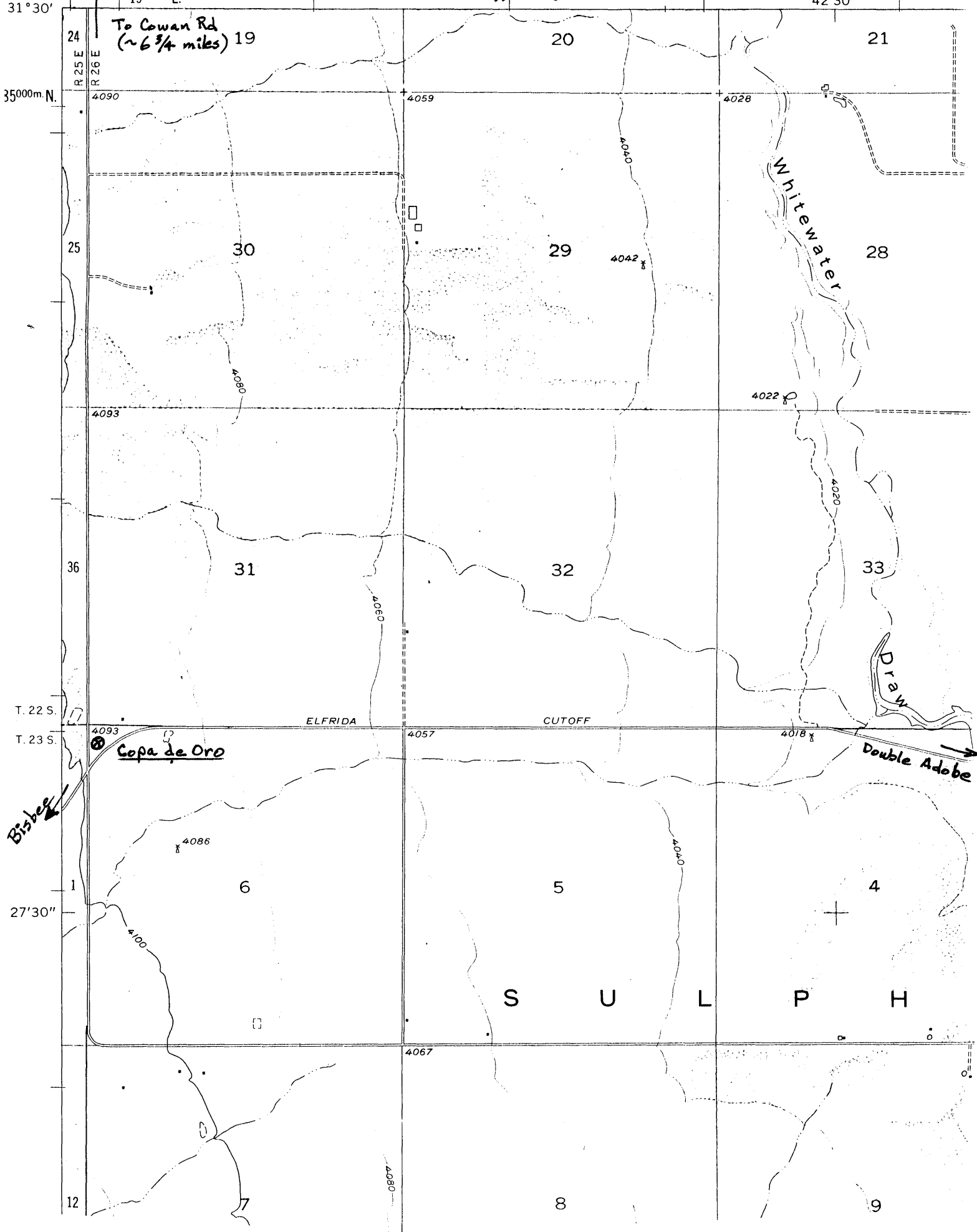

Bisbee

Copa de Oro

Whitewater

Drew

Double Adobe

S U L P H