



CONTACT INFORMATION

Mining Records Curator
Arizona Geological Survey
1520 West Adams St.
Phoenix, AZ 85007
602-771-1601
<http://www.azgs.az.gov>
inquiries@azgs.az.gov

The following file is part of the

Arizona Department of Mines and Mineral Resources Mining Collection

ACCESS STATEMENT

These digitized collections are accessible for purposes of education and research. We have indicated what we know about copyright and rights of privacy, publicity, or trademark. Due to the nature of archival collections, we are not always able to identify this information. We are eager to hear from any rights owners, so that we may obtain accurate information. Upon request, we will remove material from public view while we address a rights issue.

CONSTRAINTS STATEMENT

The Arizona Geological Survey does not claim to control all rights for all materials in its collection. These rights include, but are not limited to: copyright, privacy rights, and cultural protection rights. The User hereby assumes all responsibility for obtaining any rights to use the material in excess of "fair use."

The Survey makes no intellectual property claims to the products created by individual authors in the manuscript collections, except when the author deeded those rights to the Survey or when those authors were employed by the State of Arizona and created intellectual products as a function of their official duties. The Survey does maintain property rights to the physical and digital representations of the works.

QUALITY STATEMENT

The Arizona Geological Survey is not responsible for the accuracy of the records, information, or opinions that may be contained in the files. The Survey collects, catalogs, and archives data on mineral properties regardless of its views of the veracity or accuracy of those data.

PRINTED: 12/11/2002

ARIZONA DEPARTMENT OF MINES AND MINERAL RESOURCES AZMILS DATA

PRIMARY NAME: BRICK

ALTERNATE NAMES:

SANTA CRUZ COUNTY MILS NUMBER: 61

LOCATION: TOWNSHIP 23 S RANGE 11 E SECTION 6 QUARTER NE
LATITUDE: N 31DEG 27MIN 41SEC LONGITUDE: W 111DEG 15MIN 04SEC
TOPO MAP NAME: ORO BLANCO - 15 MIN

CURRENT STATUS: PAST PRODUCER

COMMODITY:

GOLD
SILVER
COPPER
LEAD
ZINC

BIBLIOGRAPHY:

REPORT OF THE REGION CONTIGUOUS TO THE
MONTANA MINE, P. 63
SANTA CRUZ CO. RECORDER'S RECORDS
INDEX TO MINING PROP. IN SANTA CRUZ CO.
FOWLER & MURPHY, REPORT ON MONTANA MINE AREA
ADMMR GEOL. FILE
ADMMR BRICK MINE FILE

BRICK MINE

SANTA CRUZ COUNTY

MG WR 11/11/83: Visited the Brick Mine. Mr. Jim "Jettaway" Knight is caretaker. He is keeping the mine pumps operational.

MG WR 8/16/85: Visited the Brick mine (Santa Cruz Co.) It appears that all equipment except a large trailer has been removed. There is no activity at the property.

HEM WR 4/29/88: Charles Porter (card) has listed for sale the Brick Mine (file) Santa Cruz County. The mine is currently inactive.

BRICK MINE

SANTA CRUZ COUNTY

MG WR 12/31/82: Visited the Brick Mine, Santa Cruz County. Mr. Duane Arnold the Mine Engineer, took me through the mine. The decline has been connected on the 100-level to the old workings on the west and east sides. Approximately 1300 feet of new workings have been driven. There has been no exploration drilling by the operator, Ord Silver Mining Co. Apparently Cimetta Engineering and Construction Co., Tucson, is a consultant on the property; reportedly Cimetta is doing mill feasibility tests.

MG 3/4/83: Re: The Brick Mine, Santa Cruz County. This property, controlled by Arivaca Silver Mines Ltd. and operated by Ord Silver Mines, Inc., has apparently been purchased from Mr. Charles Hagerty. Arivaca Silver Mines Ltd. is reportedly a member of Four Star Group, Mr. B. L. Williams, President, 210-700 W. Pender St., Vancouver, B. C. V6C 1G8, Canada, phone (604)669-4637.

MG WR 5/13/83: Development work was temporarily stopped in mid-April at the Brick Mine. It is reported that Ord Silver Mines had Venture Drilling rotary drill approximately 700 feet on the Brick property in late April. Heinrichs Geoexploration apparently ran an IP survey during early May.

MG WR 6/10/83: Have heard rumors that Ord Silver Mines, Inc., has discovered 10,000 tons, averaging 10 oz/t silver, at the Brick Mine, Santa Cruz County. No decision to mine this deposit has been made. Exploration rotary holes are still being drilled from the surface.

NJN WR 6/17/83: With Mike Greeley visits were made to the St. Patrick, St. Christopher and San Francisco Mines. Mike will write reports with the details for these visits. Also visited were the Brick Mine where evidence indicated recent drilling activity, and the Choctaw, Austerlitz, Idaho and Montana Mines. No activity was observed at these last four mines. All of the above mines are located in Santa Cruz County or Pima County.

MG WR 7/8/83: The Brick Mine, Santa Cruz County has been shut down. Mr. Duane Arnold, the mine engineer who has been laid off, told me the mine pumps are still in operation. Approximately 22 rotary holes, averaging 300 feet each, were drilled from the surface on the property. The exact location of the 10,000 ton ore reserve, blocked out by Mr. Arnold, is unclear to me but I think it is in the main vein, adjacent and west of the old workings. Apparently no additional ore was found as a result of the surface drilling.

BRICK MINE

SANTA CRUZ COUNTY

MG WR 4/28/82: Drove by the Brick Mine, Santa Cruz County, but was unable to visit. A sign states that the Operator of the mine is Ord Silver Mines, Inc., a wholly owned subsidiary of Arivaca Silver Mines Ltd. It is reported that a 720 to 750 ft. decline (?) is being driven on the property.

MG WR 6/4/82: According to Mr. John Taylor of the AZ Mine Inspector's office, there are 9 men employed at the Brick mine. Two shifts work five day/week. The mine portal is west of the old Brick workings. Mr. Taylor reports that the parent company, Arivaca Silver Mines Ltd., is listed on the Vancouver, B.C., Canada, stock exchange.

Mr. George Ryberg, District Geologist, B & B Mining Company reports that a company named Pacific Resources did some exploration work at the Brick Mine several years ago. The exploration program included both core and rotary drilling. Some drill intercepts reportedly ran 22 oz Ag/ton.

MG WR 7/30/82: Mr. John Taylor of the State Mine Inspectors office reports that a Mr. B. Williams is manager of the Ord Silver Mining Co., 1325 E. Lemon St., Tempe, AZ 85281, phone 768-4002. This company operates the Brick Mine in Santa Cruz County.

MG WR 9/3/82: Provided file information on the Brick mine, Santa Cruz County to Mr. Bob Crist of ASARCO, Tucson. The brick mine management has inquired about selling ore to ASARCO.

MG WR 9/17/82: Contacted Mr. Ed Grasmoe, 2009 Estrella Rd., Prescott, Az 86301, phone 445-4478. He sent me some assay reports and a smelter report on ore that he and his brother mined in 1976 at the Brick Mine, Santa Cruz County. I copied the Phoenix office with this information.

MG WR 9/24/82: U.S. Bureau of Mines Reported production from Oro Blanco Mining District, Santa Cruz County. The Brick mine, operated in 1939-44, 1966 and 1976 produced 4,103 Tons of ore which treated produced 23,424 pounds of copper; 277 pounds of lead, 69,317 ounces of silver and 356 ounces of gold.

I drove to the Brick mine where I picked up Ed Grasmoe. We drove about 3/4 mile south of the Brick to a claim which Grasmoe recently located. We mucked out a caved portal to an adit and then examined the workings. I cut two samples which Grasmoe will assay. There are traces of lead and zinc minerals associated with two faults. It is believed that the ores do not contain sufficient grade to ship to the Tonto mill. VBD WR 4/16/76

GWI phone call 5/25/73:

He said that the Brick and Montana are close together, but actually aren't the same thing. Mrs. Hugo Miller has kept up the Brick up until last year when someone jumped the claim.

B&B Mining Company has optioned the Brick mine in the Oro Blanco Mining District, Santa Cruz County. VBD WR 6/9/76

Mark V Mines Ltd. (Steve Radvak), 3161 Westmount Place, Vancouver, B.C., has purchased the Brick Mine from the Grasmoe Brothers and adjoining claims from Chuck Haggerty of Arivaca. The Canadian firm has said that they will start a drilling project soon. VBD WR 8/13/76

MG WR 11/27/79: Was informed at this meeting that a Mr. Chick Haggerty sold (or optioned?) his Brick gold-silver property, located near Ruby (Santa Cruz Co.), Arizona, to Noranda. Noranda apparently completed a drilling program there 15 to 18 months ago.

MG WR 11/28/80: Visited the Brick Mine. A separate report will be written.

KAP WR 4/16/82: During a field interview, Dick Beard and myself were shown a letter from Arivaca Silver Mines Ltd. The firm is reported (in the letter) to have commenced work on the Brick Mine, Santa Cruz County, on March 23, 1982. Pertinent people and addresses mentioned in the letter are: Arivaca Silver Mines Ltd. #1908-1450 W. Georgia St., Vancouver, B.C. V6G 2T8. Mr. B. L. Williams, President, Santa Rita Mining Co., Ltd., (same address); Steve Radvak (Radavak), President, Mr. John Rud, Project Mgr. and Geologist.

BRICK MINE

SANTA CRUZ COUNTY

Mine visit - Brick mine. GWI WR 5-10-71

Mr. Pierson, Day Mines Company, Wallace, Idaho called regarding the Brick mine. The best information we had was given plus a letter containing copies of reports. GW WR 6-11-73

Called Vernon Dale regarding ownership of the Brick mine in Santa Cruz County. He said E.B. Grasmoe, 2009 Estrella Road, Prescott, was the owner. He thinks this is a good property. GW WR 6/11/73

Grasmoe Brothers continue to open up the old Brick shaft in the Oro Blanco district. The air shaft has been completed and a new headframe is nearly completed on the main shaft. I contributed a good Shiv wheel to the operation. VBD WR 7/17/75

I met with Maurice Hedderman at his home in Amado, then drove him to the Brick claim near Ruby, Arizona. VBD WR 8/6/75

I drove to the Brick mine. The Grasmoe Brothers have delivered samples to the Inspiration smelter and to Tonto Mining and Milling Company. VBD WR 9/9/75

Ed Grasmoe called to advise that Asarco would accept two carloads of ore from the Brick mine. He will use the Esperanza railroad loading ramp presently under lease to Jack Hamilton by Duval Corp. VBD WR 1/12/76

I drove to the Brick claim one mile west of Ruby. The Grasmoe Brothers have shipped, on a test basis, two carloads of ore to the Asarco copper smelter at El Paso to be used as flux. Results and smelter returns were not known. Freight charges from the Esperanza siding near Continental to El Paso amounted to \$895. I suggested if shipments are finally made on a regular schedule, that the brothers investigate the purchase of a truck and trailer to haul 40 tons per trip to El Paso and stop supporting Southern Pacific. The Grasmoe brothers donated an old compressor made from a Ford Model A engine to the Dept. VBD WR 1/29/76

Drove to Grasmoe's Brick mine. They do not want any publication about their mine at the present time. B&B Mining is sampling and geologizing the Brick property at the present time. VBD WR 2/13/76

I drove to the Brick mine near Ruby, Arizona, where I assisted and advised Al & Ed Grasmoe in locating 2 millsites south of Ruby for mill water supply. VBD WR 3/1/76

ARIZONA DEPARTMENT OF MINES & MINERAL RESOURCES
Mineral Building, Fairgrounds
Phoenix, Arizona

1. Information from: Jim Knight and Duane Arnold (Mining Engineer)
Address: c/o Ord Silver Mines, Inc., P.O. Box 305, Arivaca, AZ 85601
2. Mine: BRICK
(Santa Cruz Co.)
3. No. of Claims - Patented _____
Unpatented yes
4. Location: Approx. 1 1/4 miles west of Ruby on south side of road between Arivaca & Ruby.
5. Sec 31 Tp 22S Range 11E
6. Mining District Oro Blanco
7. Owner: Charles Hagerty
8. Address: P.O. Box 40, Arivaca, AZ 85601
9. Operating Co.: Ord Silver Mines, Inc.
10. Address: same as above
11. President: B. L. Williams
12. Foreman: Jim Knight
~~Gen. Mgr.~~
13. Principal Metals: Ag
14. No. Employed: 10(?)
15. Mill, Type & Capacity: _____
16. Present Operations: (a) Down ☐ (b) Assessment work ☐ (c) Exploration ☒
(d) Production ☐ (e) Rate _____tpd.
17. New Work Planned: A portable mill, approx. capacity 1 ton per hour, is being installed at Ruby. Discussions have been held concerning drilling the Brick property from the surface as part of an exploration program.
18. Misc. Notes: Cimetta Engineering & Construction Co. is no longer consulting the Brick operation. Exploration and development is still being carried out by drifting east on the 100-ft level. The drift is in the foot wall and plans call for a short crosscut every 50 to 100 feet to probe the vein.

Date: February 28, 1983

(Signature)

M. W. Grooby

(Field Engineer)

ARIZONA DEPARTMENT OF MINES & GEOLOGICAL RESOURCES

Mineral Building, Fairgrounds

Phoenix, Arizona

1. Information from: John "Blacky" McKinney
Address: _____
2. Mine: BRICK 3. No. of Claims - Patented _____
(Santa Cruz Co.) Unpatented _____
4. Location: Approx. 1½ mile west of Ruby on south side of road between Arivaca and Ruby.
5. Sec. 31 Tp. 22S Range 11E 6. Mining District Oro Blanco
7. Owner: Charles Hagerty
8. Address: P.O. Box 40, Arivaca, AZ 85601
9. Operating Co.: Ord Silver Mines, Inc., subsidiary of Arivaca Silver Mines Ltd.
10. Address: 213-475 Howe St., Vancouver, B.C. V6C 2B3, Canada
11. President: _____ 12. Foreman: John McKinney
~~Gen. Mgr.~~
13. Principal Metals: Pb-Ag 14. No. Employed: approx. 13
15. Mill, Type & Capacity: _____
16. Present Operations: (a) Down ☐ (b) Assessment work ☐ (c) Exploration ☒
(d) Production ☐ (e) Rate _____ tpd.
17. New Work Planned: Approximately 1,000 feet of adit is to be driven under the old Brick workings.
18. Misl. Notes: Adit has been driven 250 feet and at some point is declined.
Initially the adit trends south and then turns east.
There are several mobile trailers and tents on the property. Equipment includes 2 loaders and an air compressor.
Mr. Bob Wagner reportedly is the mine geologist and Mr. Steve Radvak is reportedly a principal of Arivaca Silver Mines Ltd.

Date: June 9, 1982

(Signature)



(Field Engineer)

IA DEPARTMENT OF MINES & GEOLOGICAL SOURCES

Mineral Building, Fairgrounds

Phoenix, Arizona

Abstracted 7/80

1. Information from: Mine Visit
Address: _____
2. Mine: Brick 3. No. of Claims - Patented _____
Unpatented _____
4. Location: Santa Cruz Co.
5. Sec 6 Tp 23 S Range 11 E 6. Mining District _____
7. Owner: _____
8. Address: _____
9. Operating Co.: _____
10. Address: _____
11. President: _____ 12. Gen. Mgr.: _____
13. Principal Metals: _____ 14. No. Employed: _____
15. Mill, Type & Capacity: _____
16. Present Operations: (a) Down ☒ (b) Assessment work ☐ (c) Exploration ☐
(d) Production ☐ (e) Rate _____ tpd.
17. New Work Planned: _____

18. Misc. Notes: There appears to have been no recent activity. There is one open cut, two vertical shafts that are flooded, an adit, and one inclined, 2 - compartment shaft.

Date: 11-25-80

Michael N. Greeley
(Signature) (Field Engineer)

IRON KING ASSAY OFFICE

BOX 14 -- PHONE 632-7410

HUMBOLDT, ARIZONA 86329



ASSAY
MADE
FOR

E & B MINING CO.

P.O. Box 965

Prescott, Ariz. 86301

Feb. 19, 1976

[illegible]

CHARGES _____

ASSAYER

**IRON KING ASSAY OFFICE
ASSAY CERTIFICATE**

BOX 14 — PHONE 632-7410
HUMBOLDT, ARIZONA 86329

*Brick
Santa Cruz*



ASSAY
MADE
FOR

B & B MINING CO.
P.O. Box 965
Prescott, Ariz. 86301

Feb. 21, 1976

| Ref no. | DESCRIPTION | oz/ton Au | oz/ton Ag | % Fe | % Pb | % Zn | % Cu |
|---------|-------------------------------------|--------------|--------------|------|------|------|------|
| 2-19-3 | 160 level #21 East Face | .010 | 1.73 | | N11 | 0.22 | 0.04 |
| 2-19-4 | 100 level #22 West end back fill | .052 | 24.43 | | N11 | 0.18 | 0.11 |
| 2-19-5 | " " #23 East Face | .032 | 13.71 | | N11 | 1.84 | 0.06 |
| 2-19-6 | " " #24 Ore pile (broken) | .042 | 12.98 | | N11 | 0.32 | 0.06 |
| 2-19-7 | 60 " #25 East Face | .056 | 12.28 | | N11 | 0.12 | 0.05 |
| 2-19-8 | " " #26 33 West Face | .026 | 3.73 | | N11 | 0.22 | 0.07 |
| 2-19-9 | " " #34 Cross fracture | .060 | 5.12 | | N11 | 0.32 | 0.08 |
| 2-19-10 | Dump #35 str can cut face by trough | .120 | 1.60 | | N11 | 0.38 | 0.33 |
| 2-19-11 | Pit #36 on point to west | .022 | 3.98 | | N11 | 0.32 | 0.28 |
| 2-19-12 | Ore pile #37 in canyon | .196 | 11.80 | | N11 | 0.14 | 1.55 |
| | | | | | | | |
| | | | | | | | |

CHARGES _____

ASSAYER _____

REGISTERED ATTORNEY
 CERTIFICATE NO.
 2978
 WALTER G.
 STATLER
 Date Signed _____
 ARIZONA, U.S.A.

BOX 14 -- PHONE 632-7410
HUMBOLDT, ARIZONA 85329

B & B MINING CO
~~Box~~ Box 965
 Prescott, Ariz. 86301

March 3, 1976

[illegible]

CHARGES

ASSAYER

| | | | | |
|--|--------------------------------|-----------------|-----------|----|
| BOUGHT OF | THE BRICK MINE (Santa Cruz Co) | EL PASO, TEXAS, | 8/11/76 | 19 |
| ADDRESS | 40 ED. GRASMAN - Box 196 | SMELTER LOT | 1151 | |
| SHIPPING POINT | PRINEA, ARIZONA 85601 | SHIPPERS LOT | | |
| NAME OF MINE | | CLASSIFICATION | sub. etc. | |
| RATES, EXCEPT ON CONTRACTS, SUBJECT TO CHANGE WITHOUT NOTICE | | PURCHASE TERMS | | |
| | | C7642 | | |

[illegible][illegible]

| VALUES PER TON | | | | DEDUCTIONS | | CHARGE | CREDIT |
|------------------------------|-----------------|-----------|---------|------------------------------|------------------------|--------|--------|
| PAYMENT | | | | FREIGHT | BASE, INCL. LABOR ADJ. | | |
| PAY CONTENT | PRICE | AMOUNT | (FIXED) | EXCESS VALUZ OVER \$ 100.00 | | | |
| GOLD 22 MIN. 75% | 06475 | 11146 | 723 | \$ PER UNIT Pb/Cu ± % | | | |
| SILVER, LESS 1 MIN. 75% | 12445 | 4.25 | 5284 | LEAD--COPPER PRICE ESCALATOR | | | |
| LEAD, LESS @ % | | | | SILICA | | | |
| COPPER, LESS @ % | | | | | | | |
| | | | | ZINC | | | |
| | | | | AS: BS: BI: | | | |
| | | | | NET CHARGE | | | |
| GROSS VALUE | | 6011 | | | | | |
| LESS DEDUCTIONS (NET CHARGE) | | 1392 | | | | | |
| FREIGHT VALUE | | X X X | | | | | |
| NET VALUE | | 4619 | | | | | |
| LESS FREIGHT: 100.00 | WET TONS @ 6.69 | P.T. | | | | | |
| LESS SWITCHING: 182951 | RESETS: 101535 | REWEIGHS: | | | | | |
| LESS SAMPLING: | 11/1 200,000 | | | | | | |
| LESS UMPIRE: | | | | | | | |
| LESS HAULING: | | | | | | | |
| LESS REPRESENTATION: | | | | | | | |
| LESS ROYALTY: | | | | | | | |
| LESS ADVANCE: | | | | | | | |
| BALANCE DUE SHIPPER/SHIPPER | | | | | | | |
| TOTALS | | | | | | | |

the only shipment I can find but we probably shipped seven or eight.

| B/L SUMMARY OF CARS | | | | | | |
|---------------------|----------|------------|---------|---------|------|------------------|
| No. | Date | Dry Weight | Assay | | | Paid Smelter Net |
| | | | Oz. Au. | Oz. Ag. | % Cu | |
| 1 | 9/25/39 | 37.1960 | 0.06 | 16.40 | 0.30 | \$303.21 |
| 2 | 10/11/39 | 32.2140 | 0.07 | 17.40 | 0.46 | 299.97 |
| 3 | 11/1/39 | 48.2705 | 0.08 | 10.95 | --- | 277.40 |
| 4 | 11/21/39 | 44.6270 | 0.05 | 9.38 | --- | 163.18 |
| 5 | 12/12/39 | 38.6905 | 0.055 | 11.48 | --- | 203.85 |
| 6 | 1/5/40 | 35.2965 | 0.04 | 8.45 | --- | 94.36 |
| 7 | 1/16/40 | 35.2530 | 0.038 | 8.18 | --- | 84.92 |
| 8 | 1/27/40 | 36.3385 | 0.04 | 7.00 | 0.30 | 42.23 |
| 9 | 2/14/40 | 33.2625 | 0.053 | 6.92 | --- | 77.38 |
| 10 | 4/18/40 | 42.3465 | 0.100 | 6.45 | --- | 152.88 |
| 11 | 7/3/41 | 53.6960 | 0.07 | 10.02 | --- | 252.94 |
| 12 | 8/8/41 | 42.4900 | 0.065 | 9.25 | --- | 164.07 |
| 13 | 8/20/41 | 36.2755 | 0.048 | 11.36 | --- | 178.29 |
| 14 | 8/29/41 | 31.6835 | 0.12 | 19.80 | --- | 398.39 |
| 15 | 9/16/41 | 37.0560 | 0.14 | 21.60 | --- | 301.82 |
| 16 | 10/2/41 | 37.5100 | 0.13 | 11.45 | --- | 280.32 |
| 17 | 10/15/41 | 30.9845 | 0.065 | 8.20 | --- | 94.12 |
| 18 | 10/30/41 | 30.3350 | 0.07 | 10.70 | --- | 153.44 |
| 19 | 1/10/41 | 49.6130 | 0.12 | 19.45 | --- | 606.26 |
| 20 | 12/8/41 | 48.9820 | 0.062 | 10.66 | --- | 218.25 |
| 21 | 1/2/42 | 30.4100 | 0.05 | 7.50 | --- | 77.38 |

← 1939

← 1940

← 1941

← 1942



2009 Estrella Road
Prescott, Arizona
August 16, 1976

Brick Mine File

Mr. John Jett
State Department of Mineral Resources
Phoenix, Arizona

Dear Mr. Jett:

We wish to express our appreciation for the help the Arizona Bureau of Mineral Resources has given us with the Brick Mine. You have been very helpful in the development, production and, finally, in the sale to a large mining company. Mr. Vernon Dale has been great in furnishing us with information and suggestions.

Best Regards,

Edward B. Freeman

ARIZONA DEPARTMENT OF MINERAL RESOURCES
Mineral Building, Fairgrounds
Phoenix, Arizona

1. Information from: Mine Visit & Mrs Hugo Miller
Address: _____
2. Mine: Brick Mine 3. No. of Claims - Patented _____
Unpatented _____
4. Location: Near Ruby
5. Sec _____ Tp _____ Range _____ 6. Mining District _____
7. Owner: Mrs Hugo Miller
8. Address: 222 Petre Ave Nogales
9. Operating Co.: Not operating
10. Address: _____
11. President: _____ 12. Gen. Mgr.: _____
13. Principal Metals: _____ 14. No. Employed: _____
15. Mill, Type & Capacity: _____
16. Present Operations: (a) Down ☐ (b) Assessment work ☐ (c) Exploration ☐
(d) Production ☐ (e) Rate _____ tpd.
17. New Work Planned: _____

18. Misl. Notes: Joe & Fred Alexander Drilling on Rough &
Ready claim.

Date: 5-4-71

[Signature]
(Signature)

(Field Engineer)

BRICK MINE

SANTA CRUZ COUNTY

Active Mine List Oct. 1965 - 3 men

McFarland-Hullinger making another ore shipment from the Brick Mine. Arivaca Briefs 9-27-65

Visited Brick Mine - no activity. GWI WR 3-11-67

Visited Brick Mine - Hole drilled for assessment work. GWI 5-6-67

Visited Brick Mine - Alexander Brothers drilling - assessment work. GWI WR 7-11-70

BRICK MINE

Montana Mine (file) Santa Cruz County

Fluorspar mill (file) Gile

Asarco (file)

ABM Bull. 191, Pg. 63, T23S, R11E, Sec. NE 1/4 6

SANTA CRUZ COUNTY

C.M. Oliver

& Company Limited
Investments Since 1907

David Levi

Investment Broker

Second Floor
750 West Pender Street
Vancouver, B.C. V6C 1B5
Tel.: 684-9211
Telex: 04-51215

From Plunders
File

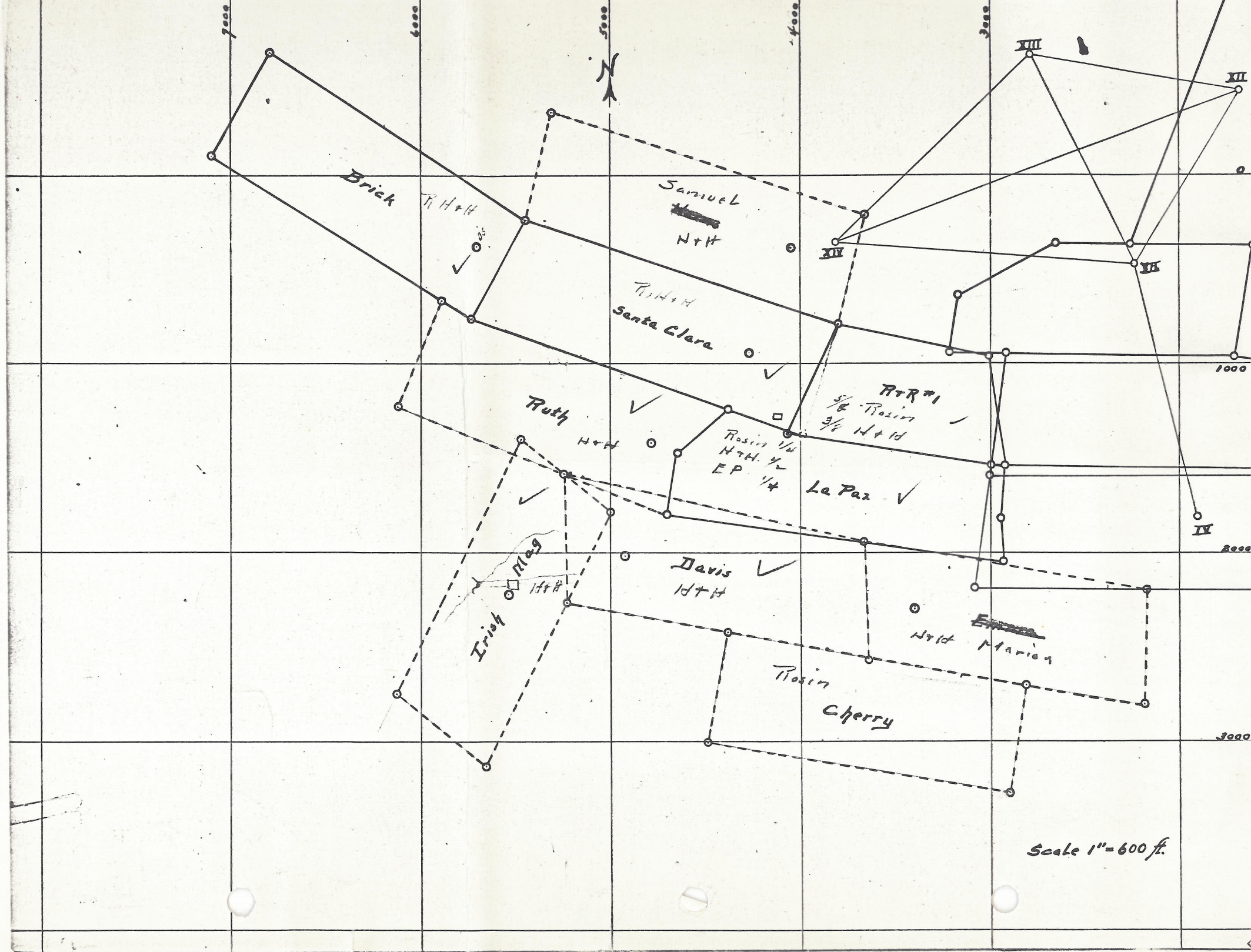

MAP OF WORKINGS ON BRICK CLAIM

Measured on Strike & Dip of Vein

Average Incline or Dip 54° Width Mined - 4 to 12 Feet

Scale 1" = 10'

Mines Of
MILLER-HANSON

Langdon Miller, Nogales Arizona
Owner

Oct. 31, 1942

