



CONTACT INFORMATION

Mining Records Curator
Arizona Geological Survey
1520 West Adams St.
Phoenix, AZ 85007
602-771-1601
<http://www.azgs.az.gov>
inquiries@azgs.az.gov

The following file is part of the

Arizona Department of Mines and Mineral Resources Mining Collection

ACCESS STATEMENT

These digitized collections are accessible for purposes of education and research. We have indicated what we know about copyright and rights of privacy, publicity, or trademark. Due to the nature of archival collections, we are not always able to identify this information. We are eager to hear from any rights owners, so that we may obtain accurate information. Upon request, we will remove material from public view while we address a rights issue.

CONSTRAINTS STATEMENT

The Arizona Geological Survey does not claim to control all rights for all materials in its collection. These rights include, but are not limited to: copyright, privacy rights, and cultural protection rights. The User hereby assumes all responsibility for obtaining any rights to use the material in excess of "fair use."

The Survey makes no intellectual property claims to the products created by individual authors in the manuscript collections, except when the author deeded those rights to the Survey or when those authors were employed by the State of Arizona and created intellectual products as a function of their official duties. The Survey does maintain property rights to the physical and digital representations of the works.

QUALITY STATEMENT

The Arizona Geological Survey is not responsible for the accuracy of the records, information, or opinions that may be contained in the files. The Survey collects, catalogs, and archives data on mineral properties regardless of its views of the veracity or accuracy of those data.

PRINTED: 12/11/2002

ARIZONA DEPARTMENT OF MINES AND MINERAL RESOURCES AZMILS DATA

PRIMARY NAME: BOUSE GYPSUM

ALTERNATE NAMES:

LA PAZ COUNTY MILS NUMBER: 806

LOCATION: TOWNSHIP 7 N RANGE 17 W SECTION 24 QUARTER SW
LATITUDE: N 33DEG 55MIN 54SEC LONGITUDE: W 113DEG 59MIN 10SEC
TOPO MAP NAME: UTTING - 15 MIN

CURRENT STATUS: RAW PROSPECT

COMMODITY:
GYPSUM

BIBLIOGRAPHY:
ADMMR BOUSE GYPSUM FILE

(BLACK PEAK)

UNITED STATES
DEPARTMENT OF THE INTERIOR
GEOLOGICAL SURVEY

UTTING 15' QUAD

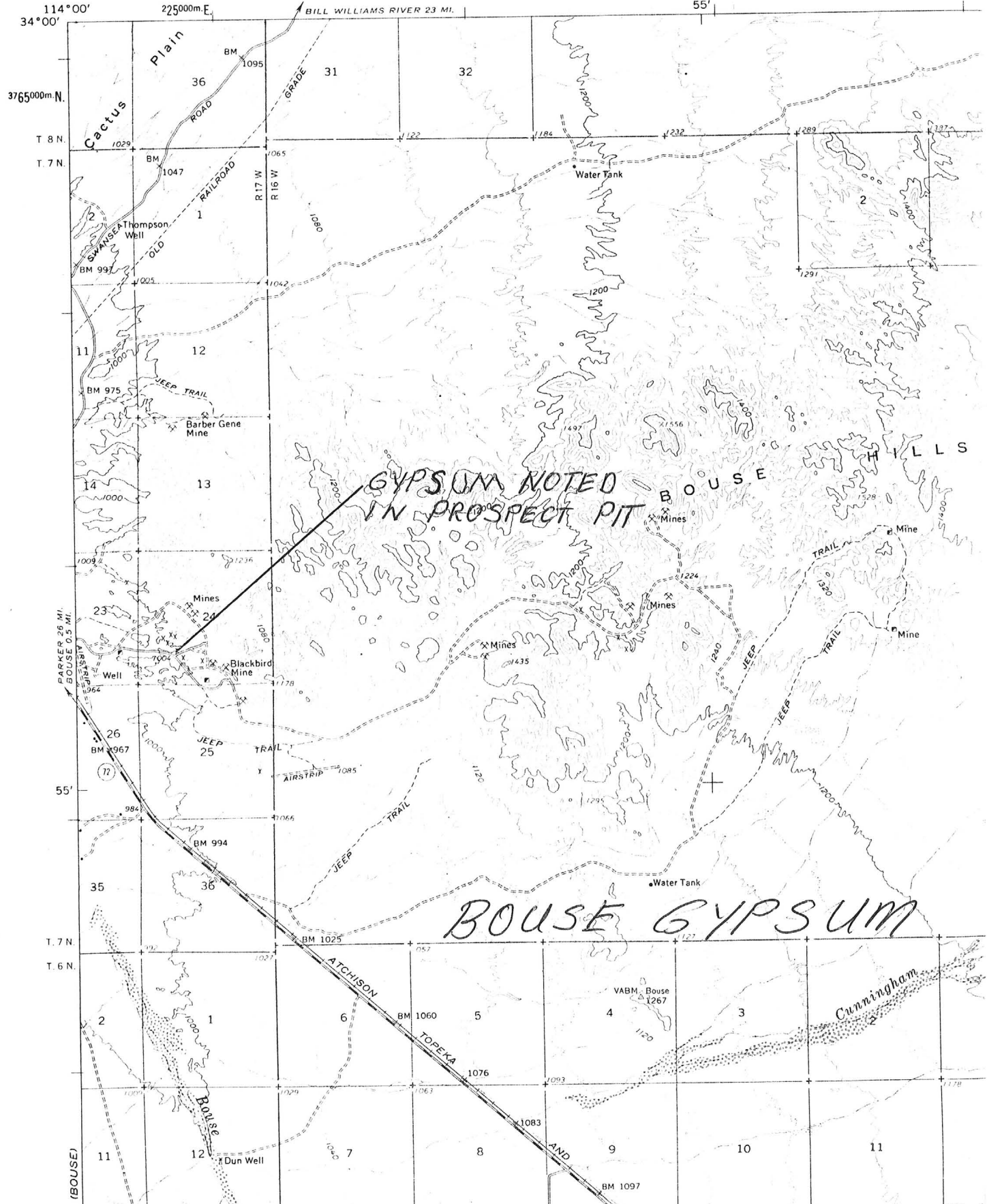

GYPSUM NOTED
IN PROSPECT PIT

BOUSE GYPSUM

BOUSE GYPSUM

LA PAZ COUNTY

KAP WR 3/20/87: In the company of Mike Greeley a visit was made to a gypsum occurrence east of Bouse. Gypsum is exposed in a shallow prospect pit. The occurrence is likely more extensive but time was not available for additional reconnaissance. The occurrence is listed as La Paz County MILS #806 and is called Bouse Gypsum (file).

DEPARTMENT OF MINES & MINERAL RESOURCES

FIELD VISIT DATA SUMMARY

ENGINEER: Ken A. Phillips

DATE: March 18, 1987

MINE: Bouse Gypsum

COUNTY: La Paz

LOCATION: T7N R7W Sec 24 SW

TOPO: Utting 15 min

WORKINGS: Prospect pit

ECONOMIC MINERALS: Gypsum

COMMENTS: During a very quick stop while in route to another property, granular gypsum was noted at a prospect pit. More data is needed to correlate.