



CONTACT INFORMATION

Mining Records Curator
Arizona Geological Survey
1520 West Adams St.
Phoenix, AZ 85007
602-771-1601
<http://www.azgs.az.gov>
inquiries@azgs.az.gov

The following file is part of the

Arizona Department of Mines and Mineral Resources Mining Collection

ACCESS STATEMENT

These digitized collections are accessible for purposes of education and research. We have indicated what we know about copyright and rights of privacy, publicity, or trademark. Due to the nature of archival collections, we are not always able to identify this information. We are eager to hear from any rights owners, so that we may obtain accurate information. Upon request, we will remove material from public view while we address a rights issue.

CONSTRAINTS STATEMENT

The Arizona Geological Survey does not claim to control all rights for all materials in its collection. These rights include, but are not limited to: copyright, privacy rights, and cultural protection rights. The User hereby assumes all responsibility for obtaining any rights to use the material in excess of "fair use."

The Survey makes no intellectual property claims to the products created by individual authors in the manuscript collections, except when the author deeded those rights to the Survey or when those authors were employed by the State of Arizona and created intellectual products as a function of their official duties. The Survey does maintain property rights to the physical and digital representations of the works.

QUALITY STATEMENT

The Arizona Geological Survey is not responsible for the accuracy of the records, information, or opinions that may be contained in the files. The Survey collects, catalogs, and archives data on mineral properties regardless of its views of the veracity or accuracy of those data.

PRINTED: 12/11/2002

PART 2 of 2

ARIZONA DEPARTMENT OF MINES AND MINERAL RESOURCES AZMILS DATA

PRIMARY NAME: BOAZ

ALTERNATE NAMES:

SOUTHERN BELLE VEIN
JONES
RANKIN PROPERTY

YAVAPAI COUNTY MILS NUMBER: 845

LOCATION: TOWNSHIP 9 N RANGE 2 W SECTION 1 QUARTER N2
LATITUDE: N 34DEG 09MIN 13SEC LONGITUDE: W 112DEG 24MIN 57SEC
TOPO MAP NAME: MINNEHAHA - 7.5 MIN

CURRENT STATUS: PAST PRODUCER

COMMODITY:

GOLD
SILICON QUARTZ
SILVER

BIBLIOGRAPHY:

USGS MINNEHAHA QUAD
BLM MINING DISTRICT SHEETS 207 & 237
ADMMR BOAZ MINE FILE
LINDGREN, W. ORE DEPTS OF THE JEROME AND
BRADSHAW MTS QUADS USGS BULL 782 1926 P 177
CLAIMS EXTEND INTO SEC. 1 AND INTO SEC. 6
T9N-R1W
ABM BULL 137, P. 60

Date Printed: 10/18/93

ARIZONA DEPARTMENT OF MINES AND MINERAL RESOURCES

VERBAL INFORMATION SUMMARY

Information from: Richard W. Frank

Company:

Address: ~~6324 E. Aster Drive~~ 1444 N Rockwood Rd
City, State ZIP: Scottsdale, Arizona 85254 Mesa, Arizona 85208
Phone: 602-483-8452 602 396 6991

MINE: Boaz

ADMMR Mine File: Boaz Mine file

County: Yavapai

AzMILS Number: 845

SUMMARY

Richard W. Frank reported that he is the sole owner of the Boaz Property as a result of buying out the other heirs. He wants to move the property to anyone interested. His interest in the property is limited to selling or optioning it.

He owns 104.9 acres.

Ken A. Phillips, Chief Engineer

Date: May 1993

BOAZ MINE

YAVAPAI COUNTY

RRB WR 7/3/87: Lee Liley, 248-8487 reports assays of from .03 to 3.5 oz/ton gold and "good" silver assays at the Boaz Mine.

RRB WR 2/12/88: John L. Helbert, president, Arizona Mining & Minerals, 4223 N. 12th St., Suite 101, Phoenix, Arizona 85014: phone 279-0791 reports that they have an option on the Boaz (file), the Pacific (Silver Mountain - file) T9N R1W Sec 9 and the O'Brien in Yavapai County. The O'Brien is considered by the company to be an adjacent part of the Pacific. They are shipping in a thiourea plant to treat the ore. They will start mining at the Boaz.

RRB WR 4/22/88: Richard A. Stevens, Executive Vice President, Arizona Mining and Minerals, 5227 N. 7th St., Suite 100, Phoenix, Arizona 85014, phone 279-0791 reports that they expect to be in operation at the Boaz (file) Yavapai County by this summer. He is looking for a custom mill or a mill he can buy or lease to get started. I suggested the Button Mill which is nearby. He says the outcrop is a high- grade silica carrying 0.2 oz/ton gold and he is looking for a market for the silica also. Mr. Stevens said that they would work the outcrop and some low grade placer ground first while developing the underground.

BOAZ MINE

YAVAPAI COUNTY

RRB WR 1/22/82: James Blanton has been working at the Boaz and reports that they shipped some ore to Arizona City (Stutenrouth's?) for tests but they have not received any results. They are still trying to mine as silica flux.

RRB WR 3/12/82: Visited the Boaz Mine, Yavapai County. No one was at the property but it appears that some material has been shipped from a 10' wide quartz vein striking S60°E and dipping 50° to the north from a point 1,000 feet beyond the old mill site.

KAP WR 7/2/82: Chuck Bentzen of Reuter Equipment Co. reported that the developers of the Boaz Mine, Yavapai County are planning to assemble equipment for mining and processing.

RRB WR 7/16/82: Frank Arnsperger, formerly mining superintendent for G.D. & L. at the Buckeye-Apache was in. He is now in charge of mining at the Boaz and is looking for a custom mill or smelter to ship silicious ore to. I gave him names and addresses of smelters and the Springold Mill.

RRB WR 3/25/83: Richard Frank, 5902 E. Campo Bello Drive, Scottsdale, AZ 85255, part owner of the Boaz Mine, Yavapai County, reports that the leasees have not lived up to the terms of the lease. He also reports that they made off with most of the records, reports, etc. so he came in to copy our files.

NJN WR 3/25/83: Richard Frank, owner of the Boaz Mine, Yavapai County, visited. He reported that the lease between him and the Boaz Mining group is being terminated. The group did produce 30 tons of handpicked ore which was milled by Archie Stutenroth of Casa Grande and then refined by someone in Mesa. Mr. Balstra, from Youngtown, Ohio, one of the previous investors, is going to pick up the property next. If this proves to be an unsatisfactory arrangement, Mr. Frank would like to sell the property.

BOAZ MINE

Yavapai County
Humburg District

KAP WR 10/24/80: William F. and Geraldine Silliman, dba Gold Mesa Inc., Boaz Mine, P.O. Box 1568, Bullhead City, Arizona 86430, reported that they have obtained ten samples of siliceous gold ore from the Boaz Mine, Yavapai County. The ten samples weighing approximately 10 lbs each, were sent to ASARCO at Hayden for evaluation as siliceous flux.

KAP WR 12/19/80: Bill Silliman (Boaz Mine) requested information on possible buyers of silica that he hopes to produce from the Boaz Mine, Yavapai County. It was explained that the majority of the silica is too barren for siliceous flux and not pure enough for high priority quartz use.

~~Richard Billingsley of Duncan, Arizona, phone 359-2241, is part owner of the Compensation Mine. A Canadian company, Queen Stake (?) is financially involved. Billingsley is leasing the property to Mr. Dewey Wilkins of Duncan who is shipping silver-bearing silicious flux to Phelps Dodge at Douglas. This mine is northwest of the Ash Peak Mine, about one mile. I believe it is in Sec. 4, T8S, R30E, straddling the Greenlee and Graham Co. line.~~

WRONG
FILE

RRB WR 2/27/81: Edward Kuryn, Mine Superintendent of the Boaz Mine, came in for an interpretation of assay reports that they got back from ASARCO.

KAP WR 2/27/81: Ed Kuryn, Phoenix, reported he is General Manager of the Boaz Mine, which is planned for operation by the Boaz Corporation. They are planning an office and post office box in Yarnell.

MEMO FROM John H. Jett: 8/12/81: Telephone call from Mr. Ned Fledderjohn, 6343 East Osborn, Scottsdale, AZ 85251. One quarter owner in partnership that owns Boaz Mining Corporation (Inc. Feb. 1981) William Sellarman is President; Ed Lantz of Canfield, Ohio as attorney.

Silliman(?)

Mr Fledderjohn was upset that they were illegally blasting (his words) sides of the tunnels. Was supposed to be shipping to ASARCO.

He stated the Corporation Commission Securities Division and the FBI were watching them for illegally selling stock. He wants to get the lessees out of the mine.

~~DO NOT REPRODUCE~~

BOAZ MINE

YAVAPAI COUNTY

Ned Fledderjohn, Phoenix, called regarding the "no lien" notice to be placed on a leased mine saying he and his associates have leased the old Boaz mine west of Crown King to some Vancouver people. GW WR 6/9/75

CH/WR 5/9/79 - Visitor Richard Frank, Phoenix, Phone: 991-4379 with others, owns the Boaz Mine (Au) in the Bradshaw Mtns., Yav. Co. Suggested he contact Dalton Foster. 6/20/79 a.p.

CH/WR 5/23/79 - Dalton Foster is considering buying the Boaz Mine, Yav. Co., and dump leaching for gold and silver. Copied eleven pages on cyanidation for him. He let us copy some maps, reports and assay returns for inclusion in the mine file. 6/20/79 a.p.

Mr. Quinan spoke with Mr. Jett and stated that he had recently purchased the patented Compensation Claim. He asked about the mica gold and how to process it. He stated he will return with a sample for us to look at and will have it sampled by Walt Statler. 4/2/80

KAP WR 10/10/80: In the company of Dick Beard, a visit was made to the Boaz Mine, Silver Mountain District, Yavapai County.

CJH WR 10/10/80: Mr. and Mrs. William Silliman, P.O. Box 1568, Bullhead City, Arizona 86430, phone 758-6892, and 758-5888, have a purchase option on the Boaz Mine. The mine is owned by Walter and Richard Frank of Phoenix. Could not find a phone book listing but Mr. Silliman says Walter lives at 16th Street and Baseline. Richard lives on Shea Blvd in Scottsdale.

CJH WR 10/17/80: Mr. and Mrs. William Silliman, P.O. Box 1568, Bullhead City, Arizona, 86430, phone 758-6892, and 758-5888, have purchased the Boaz Mine, Pine Grove District, Yavapai County, Sec. 1, T9N, R2W (see CJH WR ending 10-10-80)

KAP WR 10/17/80: William F. and Geraldine Silliman, dba Gold Mesa, Inc. - Boaz Mine, Po.o. Box 1568, Bullhead City, Arizona 86430, along with Joseph P. Caletta, President, International Financial Advisors and Developers, Ltd., P.O. Box 5071, Poland, Ohio 44514, phone (216) 757-8875, Fred Lanz and Ed Karyn (also from Poland, Ohio) reported they have purchased the Boaz Mine and plan to evaluate it as a possible shipper of siliceous gold ore to ASARCO's Hayden Smelter. They reported that ASARCO requires a minimum value of \$75 per ton. Fred Lanz is a coal mining engineer who will be doing the engineering and evaluation of the mine.

DO NOT REPRODUCE



Office of State Mine Inspector

705 West Wing, Capitol Building
Phoenix, Arizona 85007
602-255-5971

RECEIVED

FEB 25 1985

DEPT. MINERAL RESOURCES
PHOENIX, ARIZONA

JAN 15 1985

NOTICE TO ARIZONA STATE MINE INSPECTOR

In compliance with Arizona Revised Statute Section 27-303* we are submitting this written notice to the Arizona State Mine Inspector (705 West Wing, Capitol Building, Phoenix, Arizona 85007) of our intent to start/stop (please circle one) a mining operation.

COMPANY NAME SKOR INTERNATIONAL R & D. LIMITED PARTNERSHIPCHIEF OFFICER JAMES G. KOLBINSKYCOMPANY ADDRESS 6581 HARRISON AVE CINTI. OHIO 45247COMPANY TELEPHONE NUMBER 513-574-5760MINE OR PLANT NAME SAME

MINE OR PLANT LOCATION (including county and nearest town, as well as directions for locating by vehicle)

SECTION 1, 9N-2W BOOK #

TOWNSHIP 9N, RANGE 2W, RYLAND GULCH
OF THE AGUA FRIA WATERSHED

TYPE OF OPERATION PLACER MILL PRINCIPAL PRODUCT GOLD & SILVERSTARTING DATE 1/1/85 CLOSING DATE UNKNOWNDURATION OF OPERATION UNKNOWNPERSON SENDING THIS NOTICE JAMES G. KOLBINSKYTITLE OF PERSON SENDING THIS NOTICE GENERAL PARTNERDATE NOTICE SENT TO STATE MINE INSPECTOR 1/9/85

*A.R.S. Section 27-303 NOTIFICATION TO INSPECTOR OF BEGINNING OR SUSPENDING OPERATIONS: When mining operations are commenced in any mine or when operations therein are permanently suspended, the operator shall give written notice to the inspector at his office prior to commencement or suspension of operations.

STATE MINE INSPECTOR Office of State Mine Inspector

JAN 15 1985

705 West Wing, Capitol Building
Phoenix, Arizona 85007
602-255-5971NOTICE TO ARIZONA STATE MINE INSPECTOR

In compliance with Arizona Revised Statute Section 27-303*, we are submitting this written notice to the Arizona State Mine Inspector (705 West Wing, Capitol Building, Phoenix, Arizona 85007) of our intent to start/stop (please circle one) a mining operation.

COMPANY NAME ARIZONA PROPERTIES
 CHIEF OFFICER CARL R. OLSEN
 COMPANY ADDRESS P.O. Box 373, YARNELL, AZ 85362
 COMPANY TELEPHONE NUMBER 602-427-3126
 MINE OR PLANT NAME REESE VEAN
 MINE OR PLANT LOCATION (including county and nearest town, as well as directions for locating by vehicle)
SECTION 1, 9N-2W
TOWNSHIP 9N, RANGE 2W, RYLAND GULCH
OF THE ~~THE~~ AQUA FRIA WATERSHED
 TYPE OF OPERATION UG PRINCIPAL PRODUCT AU + AG
 STARTING DATE 1/1/85 CLOSING DATE UNKNOWN
 DURATION OF OPERATION UNKNOWN
 PERSON SENDING THIS NOTICE CARL R. OLSEN
 TITLE OF PERSON SENDING THIS NOTICE PRES. + OWNER
 DATE NOTICE SENT TO STATE MINE INSPECTOR 1/9/85

*A.R.S. Section 27-303 NOTIFICATION TO INSPECTOR OF BEGINNING OR SUSPENDING OPERATIONS: When mining operations are commenced in any mine or when operations therein are permanently suspended, the operator shall give written notice to the inspector at his office prior to commencement or suspension of operations.

BOAZ MINE PROJECT

THIS MAP WAS TRACED FROM A MAP MADE BY KEITH BELL FOR ECHO LAY MINING COMPANY IN DECEMBER, 1935. THE ROCK CHIP SAMPLES ALONG THE VEIN OUTCROP AS WELL AS THE CHANNEL SAMPLES ALONG THE VEIN IN THE UNDERGROUND WORKINGS WERE TAKEN BY BELL. ALL SAMPLES WERE CRUSHED, SPLIT AND GROUND TO ABOUT 150 MESH BEFORE BEING ANALYZED BY FIRE ASSAY METHODS. THERE WAS POOR REPRODUCIBILITY DUE TO NUGGET EFFECT.

THE DRILL HOLES WERE CORED THROUGH THE MINERALIZED ZONE. CORES WERE SPLIT AND ANALYZED AS FOLLOWS:

EBB No. 1	Interval	Gold	Silver
		oz./T Au	oz./T Ag
	180-185	.006	.01
	188-190	.048	.01
	190-192	.020	.06
	192-194	.033	.09
	194-196	.059	.07
	196-198	.060	.03
	198-200	.018	.01
EBB No. 2	206.5-208.5	.016	.15
	208.5-210.5	.004	.17
	210.5-212.5	.192	.03
	212.5-214.5	.030	.01
	214.5-216.5	.008	.01
	216.5-221	.005	.01
	221-223	.002	.01
	223-225	.110	.07
	225-228	.465	.12
	228-229.5	.003	.01
EBB No. 3	212-216	.012	.01
	216-218	.094	.10
	218-220	.068	.01
	220-224	.002	.01
	227.5-228.5	.006	.01

Boaz Mine Project

This map was traced from a map made by Keith Bell for Echo Bay Mining Company in December, 1985. The rock chip samples along the vein outcrop as well as the channel samples along the vein in the underground workings were taken by Bell. All samples were crushed, split and ground to about 150 mesh before being analyzed by fire assay methods. There was poor reproducibility due to nugget effect.

The drill holes were cored through the mineralized zone. Cores were split and analyzed as follows.

Mineralized hits in three Echo Bay Drill holes.

Drill Hole No. 1	Interval	oz/ton Au	oz/ton Ag
	186-188 = 2'	.006	.01
	188-190 = 2'	.0483	.01
	190-192 = 2'	.020	.06
	192-194 = 2'	.033	.09
	194-196 = 2'	.059	.07
	196-198 = 2'	.060	.06
	198-200 = 2'	.018	.01
Drill hole No. 2	206.5-208.5 = 2'	.016	.19
	208.5-210.5 = 2'	.004	.17
	210.5-212.5 = 2'	.192	.03
	212.5-214.5 = 2'	.030	.01
	214.5-216.5 = 2'	.008	.01
	216.5-221 = 4.5'	.005	.01
	221-223 = 2'	.002	.01
	223-225 = 2'	.110	.07
	225-228 = 3'	.465	.12
	228-???5 = ?'	.008	.01
Drill Hole No. 3	212-216 = 2'	.012	.01
	216-218 = 2'	.094	.19
	218-224 = 2'	.068	.01
	220-224 = 2'	.002	.01
	227.5-228.5 = 1'	.006	.01

[Hand written note:

Here are the mineralized zones in the three Echo Bay drill holes. The map was very dim - the three holes were drilled on the east (?) side of the ridge to hit the down dip extension of the structure.]

Retyped by Nyal J. Niemuth of ADMMR on 4-25-95 from poor original. Transcription errors are possible in the silver values.

Boaz

DATE: January 18, 1985

TO: Mr. F. J. Menzer, Chief Geologist ✓

FROM: J. A. Waegli, Geologist

SUBJECT: Arizona Department of Mineral Resources
List of Flux Properties

In early October, 1984, Mr. John Robertson, Ore Buyer for Phelps Dodge Corporation, requested that the Arizona Department of Mineral Resources (ADMR) compile a list of properties in the state that could produce material grading +80% SiO₂ and +1/3 O/T Au. In response, Mr. Nyal Niemuth, Mineral Resources Specialist with the ADMR, compiled a list of 16 properties (attached) that he feels are capable of producing +70% SiO₂ with \$100.00 metal credits. (He stated that he did not know of any mines capable of meeting Mr. Robertson's criteria.)

November 19-21 were spent in Phoenix examining ADMR files to obtain information on each of the mines. Mr. J. E. DuHamel of Western Exploration screened their files and compiled the resulting information in a memo dated November 27 (attached). Based on his memo, pertinent reports were copied from the Western Exploration files on December 3 and 4.

The following is a listing of these 16 properties arranged in order by quad number. A brief description of each property is given, with information on current activity and a summary of past work conducted by Phelps Dodge Corporation. Recommendations based on information compiled to date are also given. Table 1 summarizes information compiled in this report.

No. 1", 1,400 tons per vertical foot in "breccia pipe No. 2" and 2,000 tons per vertical foot in "breccia pipe No. 3". The grade of the latter two pipes is not given.

Mike Pawlowski examined the property in September, 1984. Fourteen samples collected on the property ranged from nondetectable to 0.325 O/T Au. The latter is from a dump sample. The evaluation was in progress when the owners (Jack and Dorothy Devault) signed an agreement with Sunshine Mining Company in October.

It is recommended that Sunshine's activity on the property be monitored and M. R. Pawlowski's final report be completed on a low priority basis.

7. BOAZ (Figure 2): Yavapai County, T.9N., R.2W., Sec.1, AZ 246

The Boaz mine, located south of Crown King, developed an east-west gold-quartz vein. Workings include a 650-foot shaft and 2,500 feet of drifts (Wilson, et al, 1934). The property is currently held by Mr. Richard Frank of Scottsdale, Arizona.

An October, 1980 report by Ken Phillips and Dick Beard of the ADMR states that the water level in the shaft is approximately 50 feet below the main tunnel level. Past production is estimated at 800 to 8,000 tons which averaged around 1.0 O/T Au.

In November of 1980, a group called Gold Mesa, Inc., leased the property and submitted several samples to Asarco at Hayden for analysis. No sample locations or descriptions are given, but the three samples averaged 0.145 O/T Au, 0.25 O/T Ag, 0.74% Pb, 0.05% Cu, 0.10% Zn, 86.6% SiO₂, 0.1% CaO, and 1.1 % Al₂O₃.

Several lessors have held the property since then, including Frank Arnsperger, formerly of Gold Depository and Loan Company. No significant work was done; in fact, Arnsperger's group reportedly stole most of the records and reports on the mine.

No work has been conducted on the property by Phelps Dodge personnel. Based on the Asarco assays, the material would make excellent flux, but the precious metal grades and vein widths are not known. Other Precambrian veins in the Bradshaws tend to be narrow with erratic grades, and apparently the Boaz is no exception. It may be worthwhile to contact Mr. Frank, the owner, but the property is considered to be of low priority interest.

f.l.

REFERENCE 4 F4 <

RECORD IDENTIFICATION

+ ESSENTIAL SOMETIMES OR HIGHLY RECOMMENDED

[illegible]

GENERAL COMMENTS GEN<

Classified 7/90

DEPARTMENT OF MINERAL RESOURCES
STATE OF ARIZONA
FIELD ENGINEERS REPORT

Mine ☒ BOAZ MINE
District SILVER MOUNTAIN
Subject: YAVAPAI COUNTY

Date October 10, 1980
Engineer Ken A. Phillips, Mineral Resources
Engineer
Dick R. Beard, Mineral Resources
Specialist

Commodities: Gold, silver, siliceous flux.

Subject: Property visit by Ken Phillips and Dick Beard, and information on current status.

References: Arizona Department of Mineral Resources; Boaz Mine File, Yavapai Co.

Lindgren, Waldemar; 1926, Ore Deposits of the Jerome and Bradshaw Mtns. Quadrangles, Arizona U.S. Geological Survey Bulletin 782, pp 177-178.

Wilson, Eldred D., et. al. 1934, Arizona Lode Gold Mines and Gold Mining, Arizona Bureau Geology and Mineral Technology Bulletin 137, pp 60. (This is a direct quotation of Lindgren, 1926).

Numerous independent consultant reports have also been written.

Property: The Boaz patented property group consists of 17 patented claims and possible additional unpatented claims all located in Sec. 1, T9N, R2W, and Sec. 6, T9N, R1W. The patented claims are listed below and shown on attached Map #1.

<input checked="" type="checkbox"/> Compensation	<input checked="" type="checkbox"/> Little Annie	<input checked="" type="checkbox"/> Seattle
<input checked="" type="checkbox"/> Cleveland	<input checked="" type="checkbox"/> *Southern Belle	<input checked="" type="checkbox"/> Fort Worth
<input checked="" type="checkbox"/> Boston	<input checked="" type="checkbox"/> Beatrice	<input checked="" type="checkbox"/> High Grade
<input checked="" type="checkbox"/> Hilltop	<input checked="" type="checkbox"/> Nil Desperandum	<input checked="" type="checkbox"/> Pittsburg
<input checked="" type="checkbox"/> Campview	<input checked="" type="checkbox"/> Atlantic City	<input checked="" type="checkbox"/> **Phelon
<input checked="" type="checkbox"/> Chicago	<input checked="" type="checkbox"/> Surprise	<input checked="" type="checkbox"/> New York

*Surveyed as the Southern Belle and later patented as the Beatrice.

**Surveyed as the Phelon and later patented as the Little Annie.

The group also includes a patented mill sight.

Location: Section 1, T9N, R2W, and Section 6, T9N, R1W, see attached map #2, shown on U.S. Geological Survey, Minnehaha, Az. 7 1/2 Quadrangle.

Ownership: See report of office visit by ☒ William and Geraldine Silliman on October 14, 1980, under present operations, below:

History: Lindgren (1926) reports the vein was opened up by the late F.E. Harrington in about 1902. The operation was equipped with a 20-stamp mill and a cyanide plant. Foundations rubble and shack are all that remains. Tailings piles from two cyanide mills were noted during our visit as noted on Map #2. Each pile contains an estimated 100 to 400 tons of tailings.

Past Production: Yes. No reports are available. Estimates can range from 800 to 8,000 tons of ore which Lindgren (1926) reports to have been about \$20.00 (one troy ounce per ton) in gold from upper workings.

Workings: Described in Arizona Department of Mineral Resources Boaz Mine File.

Inclined shaft - 650' deep, two compartments, water standing about 50' below main tunnel level. Closed by caving at the collar, but open and in good condition at the tunnel level. Shaft inclined approximately 45° N.

Tunnel - approximately 280' bearing N 32° E. to intersect shaft at vein. Tunnel is in excellent condition. Driven in barren granite. Includes one stub cross tunnel (exploratory?) and one crosscut to an ore chute under a pocket.

Drifts - Lindgren (1926) reports 2,500'. One drift runs on the vein in both directions from the shaft - tunnel station. It appears in fair conditions.

Numerous shallow shafts and pits and short drifts are on the outcrop of the vein. Most are caved.

Dumps.

Geology: Lindgren (1926) reports the deposit as an east-west quartz vein which is "spotty" and "frozen to the walls". It is reported to be a precambrian vein. During the authors' visit the strike of the vein was measured at N 80 W dipping 49 N. The outcrop of the vein forms a prominent feature and can be readily traced along the surface. It outcrops as massive quartz with occasional iron stained vugs. Where the outcrop and wall rocks can be observed together the quartz vein material appears to more or less grade into the country rock (granite? - possibly quartz monzonite). Wall rock alteration is slight to absent. Fresh vein material on dumps contains massive quartz with pyrite and rare chalcopyrite and copper staining.

Present Operations: The first mile of the road to the Boaz Mine from its junction with the Wagoner-Minneha road has been graded.

William F. and Geraldine Silliman, dba Gold Mesa Inc. - Boaz Mine, P.O. Box 1568, Bullhead City, Arizona 86430, along with Joseph P. Caletta, President, International Financial Advisors and Developers, Ltd., P.O. Box 5071, Poland Ohio 44514, phone (216) 757-8875, Fred Lanz and Ed Karyn (also from Poland, Ohio), were in the Department's office on October 14, 1980. During the visit they reported they have purchased the Boaz Mine and plan to evaluate it as a possible shipper of siliceous gold ore to ASARCO's Hayden smelter. They reported that ASARCO requires a minimum value of \$75 per ton. Fred Lanz is a coal mining engineer who will be doing the engineering and evaluation of the mine.

KAP-DRB/ap

PLEASE RETURN THIS PORTION WITH PAYMENT TO:

RICHARD A. JACOBS
COUNTY TREASURER
255 EAST GURLEY ST
PRESCOTT, AZ 86301

DELINQ. TAX DUE

TAX ROLL NUMBER

37818

PARCEL IDENTIFICATION

204-20-030 4

TAX AREA CODE

1400

*IF TOTAL TAX DUE IS \$10.00 OR LESS FULL
AMOUNT IS DUE NOW. SEE PAYMENT
INSTRUCTIONS ON REVERSE SIDE OF THIS NOTICE

PLEASE RETURN
BOTH COUPONS
WHEN PAYING
FULL YEAR TAX

ENTER ADDRESS CORRECTION ON THE BACK OF
THIS COUPON.

RECEIPT REQUESTED ()

PRIMARY NET	6312	3156
SECONDARY	140	70
CODE	SPECIAL DISTRICT TAX	
TOTALS → TOTAL TAX 6452 HALF TAX 3226		
TO PAY 1st HALF ONLY		PAY → 32.26
TO PAY FULL YEAR TAX		PAY → 64.52

NOTE: 1st HALF TAXES DELINQUENT AFTER NOV. 1, 1984

Frank
PAID 84F
1984 MS
YAVAPAI COUNTY
1984 1st HALF COUPON

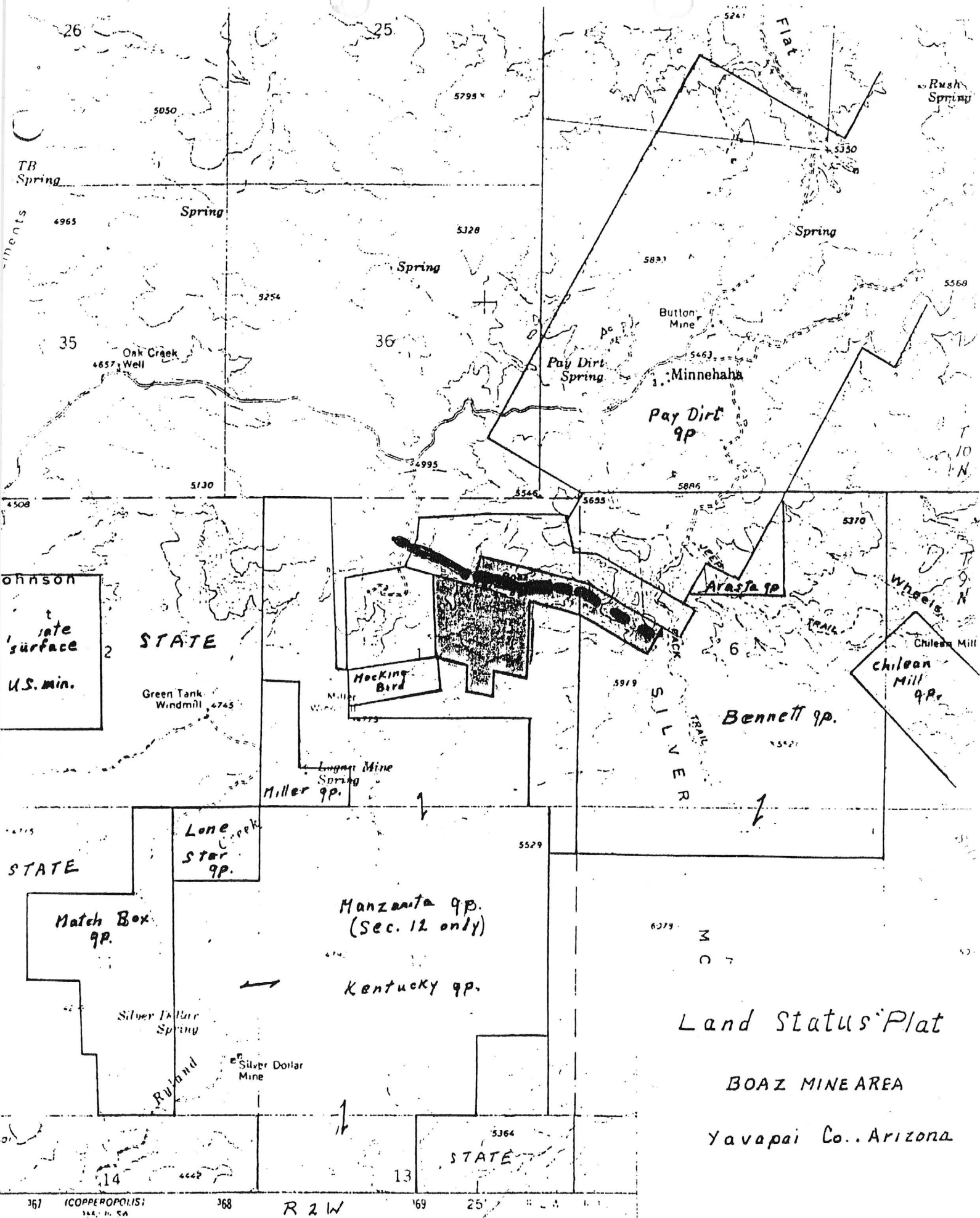

LEGAL DESCRIPTION

EXHIBIT "A"

LITTLE ANNIE, BEATRICE, HIGH GRADE, SURPRISE and NIL DESPERANDUM Lode Mining Claims and NIL DESPERANDUM MILL SITE, designated by the Surveyor General as Lots numbered 1557A and 1557B United States Patent whereof is of record in Book 63 of Deeds at Page 499 et seq., in the office of the County Recorder of Yavapai County, Arizona and THE ATLANTIC CITY lode Mining Claim, designated by the Surveyor General as Lot numbered 1675, United States Patent whereof is of record in Book 83 of Deeds at Page 233, et seq. said records. EXCEPTING all minerals and sub-surface rights and privileges pertaining to the following described premises: Beginning at corner No. 2 of Little Annie Lode Claim; thence South $14^{\circ} 15'$ West, 600 feet to corner No. 3 of Little Annie Lode Claim bears South $75^{\circ} 45'$ East, 1150 feet to a point from which corner No. 4 of Little Annie Lode Claim bears South $75^{\circ} 45'$ East, 350 feet distant; thence North $14^{\circ} 15'$ East to a point from which corner No. 1 of Little Annie Lode Claim bears South $75^{\circ} 45'$ East, 350 feet distant; thence North $75^{\circ} 45'$ West 1150 feet to corner No. 2 of Little Annie Lode Claim, the place of beginning. Located in the Bradshaw Mining District.

C.C. HUSTON & ASSOCIATES

MINING AND GEOLOGICAL CONSULTANTS

2001-80 RICHMOND STREET WEST

TORONTO 1

C.C. HUSTON

H.H. COX

S.C. BROWN

G.S. DISLER

G.W. GOETTLER

N. FINTH

EMPIRE 2-1474-5-8

CABLE "HURONTO"

July 12th, 1960,

Mr. A. R. Lee,
c/o 2001 West Hadley Street,
PHOENIX,
Arizona.

Dear Mr. Lee:

The other day after seeing you, I talked with Mr. and Mrs. Rankin on the telephone and they are agreeable to the option which we discussed and whose terms I outline as follows:-

1. We will proceed to have our lawyer draw an Option Agreement for signature by all parties.
2. We will pay on signature the sum of two thousand five hundred dollars (\$2,500.) for the option for six months.
3. After the expiry of six months, we will pay five hundred dollars (\$500.) per month to maintain the option for eighteen further months and at our option, on or before two years from the date of signature, we will purchase all the patented claims held by you for the further sum of seventy-five thousand dollars (\$75,000.).

During the tenure of our option you will continue to pay the taxes and we will rebate to you such tax payments.

It is understood that you wish to retain the grazing rights here until final payment is made. This will be acceptable to us and incorporated in the Option Agreement.

Boaz Mine ^{Cash} ^{1/2.} 105

2.

Mr. A. R. Lee

July 12th, 1960.

A copy of this letter is enclosed herewith, so that you may send it to Mr. and Mrs. Rankin.

You will in a very short time hear from our lawyer in this connection and in the meantime, I would ask you, if possible, to mail the original or a copy of the claim map which I saw in your office, to Mr. John Riggins, P.O. Box 27, Yarnell, Arizona, so that he can try to find the relevant claim corners.

The claims to which this option refers are as follows:-

Little Annie	-	20.649	acres
Beatrice	-	20.620	"
High Grade	-	18.643	"
Surprise	-	20.249	"
Nil Desperandum	-	19.980	"
Nil Desperandum Mill Site	-	4.823	"
Atlantic City	-	15.81	"

Will you advise me that these are the actual claims, all lying in Yavapai County, Arizona.

Yours very truly,

C. C. HUSTON & ASSOCIATES.

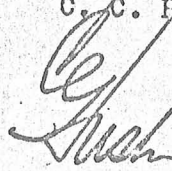
C. C. Huston, P.Eng.

CCH:md

Enc.

File No.

Date.....8..AUG..1967..

VALUES
Latest Quotation

1 oz. Gold.....

1 oz. Silver.....

1 lb. Copper.....

1 lb. Lead.....

1 lb. Zinc.....

THIS CERTIFIES

Samples submitted for assay
contain as follows:

Arizona Assay Office

815 NORTH FIRST STREET

Phone: 253-4001

Phoenix, Arizona 85001

P. O. BOX 1148

Short Ton 2000 Lbs.

Short Ton Unit 20 Lbs.

Long Ton 2240 Lbs.

Long Ton Unit 22.4 Lbs.

MARKS	SILVER PER TON		VALUE PER TON	GOLD PER TON		VALUE PER TON	TOTAL VALUE PER TON of Gold & Silver	PERCENTAGE			REMARKS
	Ozs.	Tenths		Ozs.	Hundredths						
BOAZ EAST VEIN		.6	\$.90	.80	28.00						
<p><i>pluse silver not tested</i></p> <p><i>Boaz West</i></p> <p><i>East Vein</i></p>											

Charges \$ 4.00

ANDY CHUKA, PRINT

Assayer.....

JACK STONE REG. NO. 5479

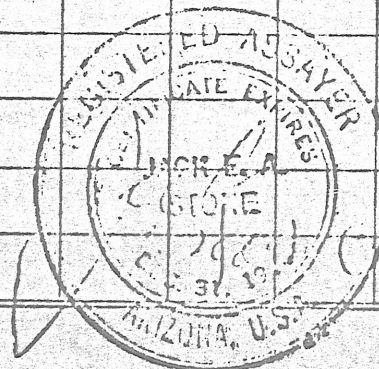

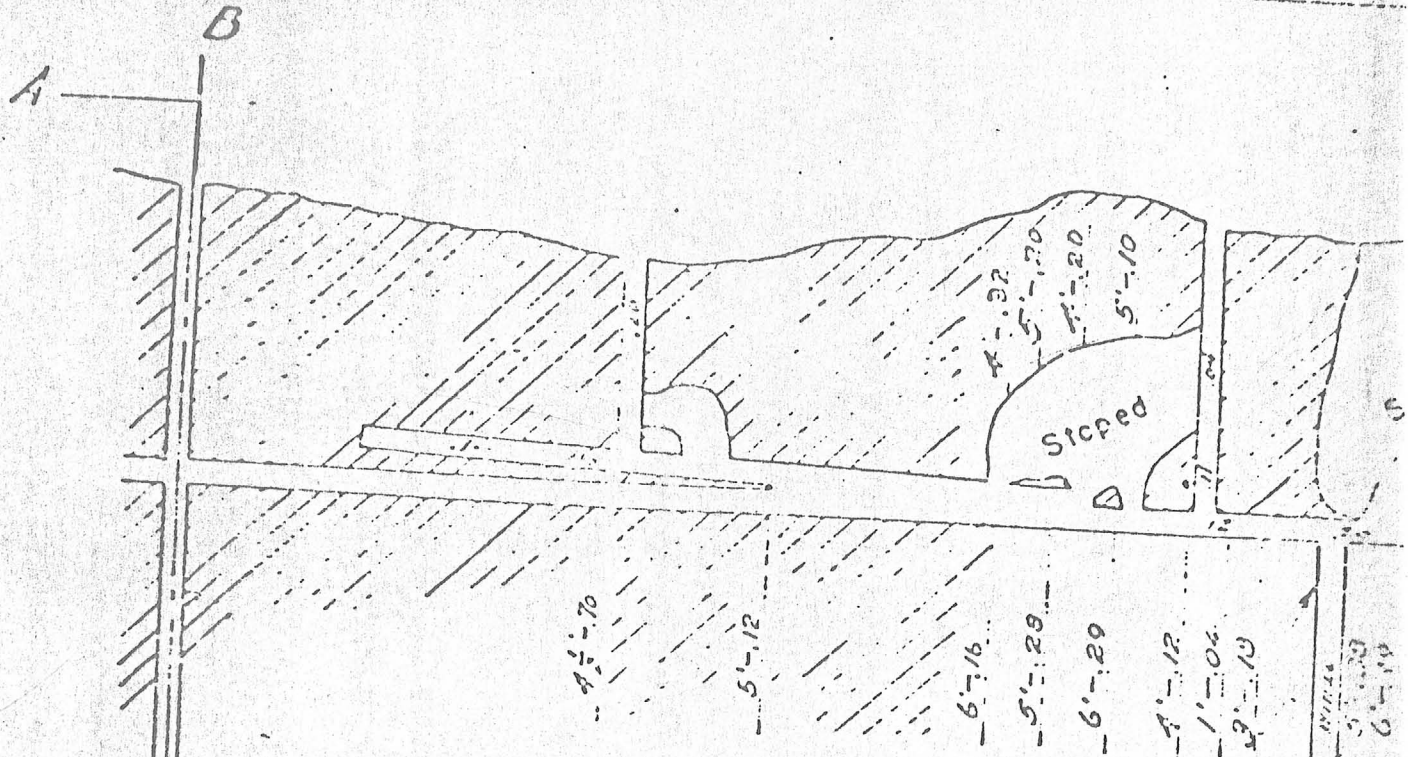

Water Level 60' Below Tunnel Level:

*plus Silver
not shown*

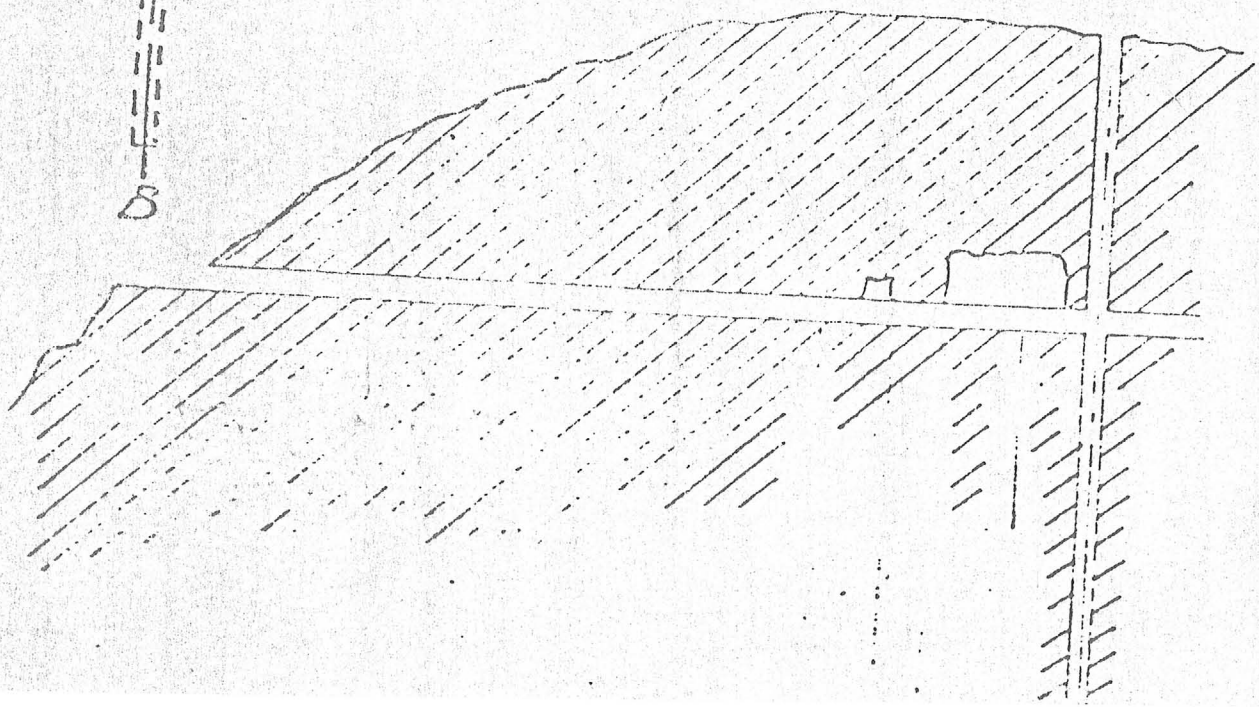

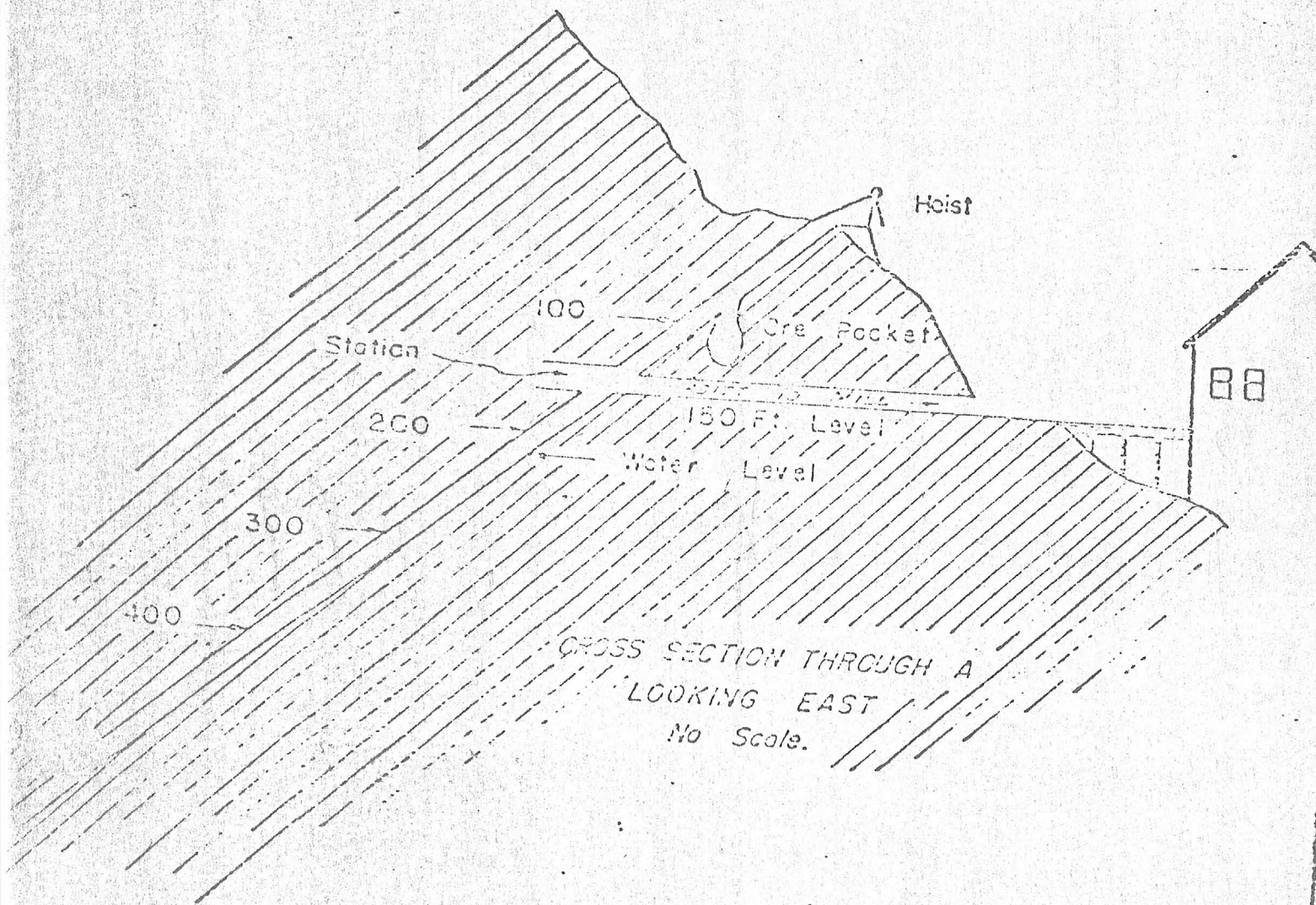
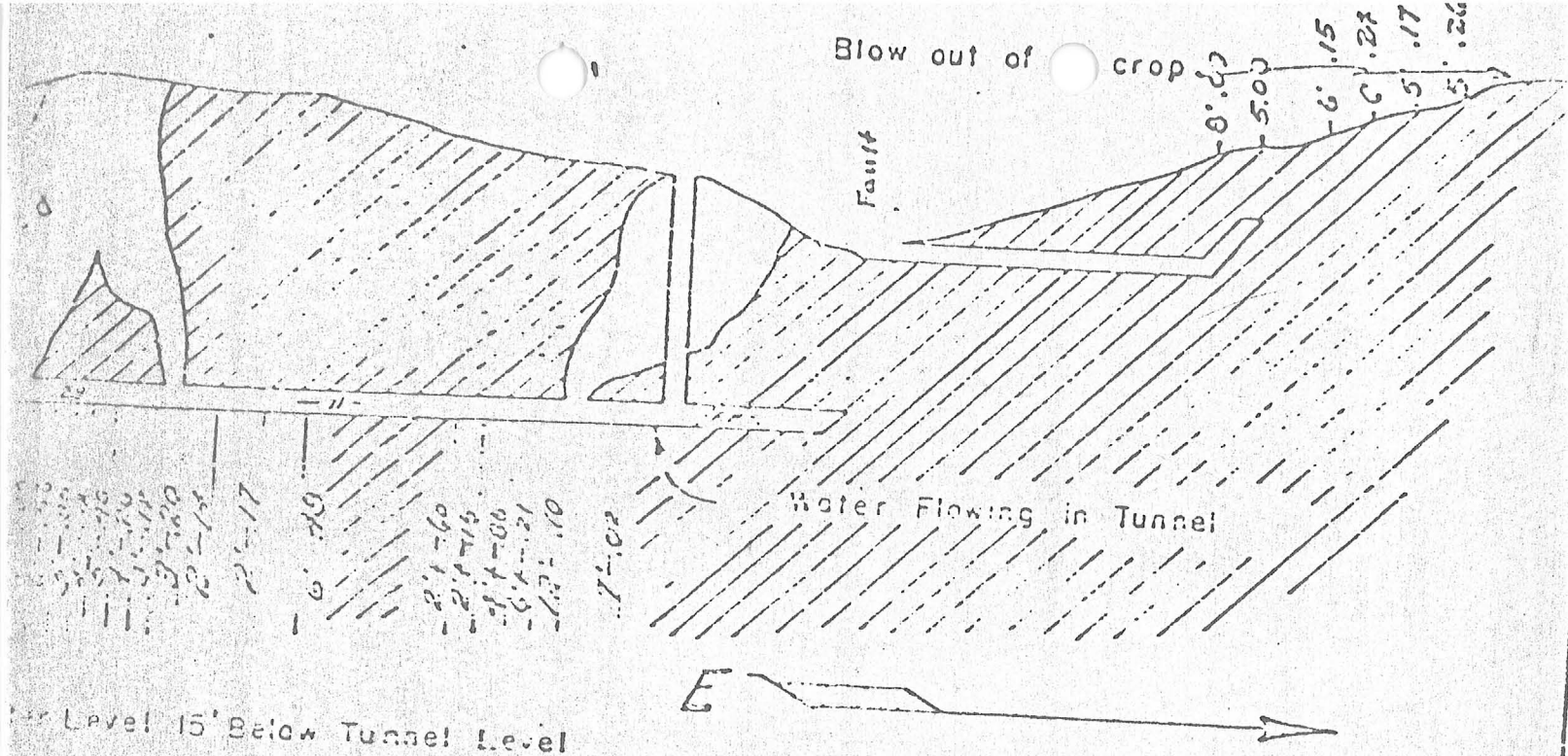

SOUTHERN BELLE VEIN
 GOLD VALUES IN OUNCES PER TON
 Scale 1" = 100'

DRAWN FOR MRS. WANDA H. JONES
 BY Forrest H. Coulter

ATLANTIC CITY

NIL DESPERANDUM

dur. No 1557A.

N 0° 30' W 867 FT.

COR. No 8

S 75° 45' E 94.7 FT.
1.43

COR. No 6

N 0° 30' W 827.4 FT.
1.99

COR. No 5

NIL DESPERANDUM

MILL-SITE

dur. No 1557A.

N 0° 30' W 1000 FT.
D/S SHAF T NO. 1

COURSE OF VEIN S 0° 30' E 1000 FT. FROM D/S

S.E.C. 300 FT.

N 75° 45' W 600 FT.

COR. No 4

S 0° 30' E 833 FT.

COR. No 3

S 0° 30' E 867 FT.

COR. No 2

S 75° 45' E 96 FT.
1.43

SURPRISE

dur. No 1557A.

COR. No 1

S 75° 45' E 408 FT.

COR. No 2

N 95° 01' E 10212 FT.
S 89° 30' E 32710 FT.

PRELIMINARY GEOLOGICAL
STUDY
ON THE
"BOAZ" MINE
IN
HUMBUG MINING DISTRICT
YAVAPIA COUNTY, ARIZONA
FOR
RICHARD FRANK
BY
GRANT W. KIME
CONSULTING GEOLOGIST

GRANT W. KIME
CONSULTING GEOLOGIST
9412 RAMBLER DR.
HUNTINGTON BEACH, CALIF.
536-3757

June 10, 1969

Mr. Richard Frank
1223 South 7th Street
Phoenix, Arizona

Re: "BOAZ" MINE

Dear Mr. Frank;

I am pleased to transmit in accordance with your request a Geological Study of certain mining claims that you and your family own in the Huumbug Mining District, Yavaipia County, Arizona.

After an extensive reconnaissance survey of the entire property, I am attaching the foregoing study.

All data and information gathered in my investigation are believed to reflect a factual and objective picture of the claims as of this date.

The property is an extremely interesting prospect and with the silver market at a new high, it appears that this is a large and valuable group of claims.

Thank you for allowing me the privilege to serve you and if any further questions pertaining to this study is needed, please feel free to call me.

Respectfully submitted,

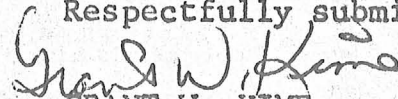
GRANT W. KIME
GEOLOGIST

GENERAL DISCUSSION

The "BOAZ" mining claims are located in a highly mineralized area. The mine has produced in excess of ten million (\$10,000,000) dollars in silver and gold around the turn of the century.

The mine was closed because the price of silver and gold at that time made it non-economical.

The large veins found in the mine ran as high as seventeen hundred (\$1,700.) dollars per ton and as low as three (\$3.00) dollars per ton.

The vein that is exposed on the out side of the property could be very easily stripped and also on an economical basis. The rich ore of this particular vein is quite visible to the eye.

The large vein found in the tunnel is also quite rich in precious metals and it is quite significant to the eye.

The history of Arizona mining properties indicates that the richer ore is found at much greater depths. The "BOAZ" mine under discussion in this study has never been worked at a depth more than about fifty feet below the ground level.

From all indications the "BOAZ" mine should be core drilled and it is quite probable that a large rich ore body would be found.

LOCATION

The "Boaz" Mining claims is located in the Crown King Quadrangle, Section 1, Township (9) North, Range (2) West, Yavapai County, Arizona. The property is located approximately ten (10) miles east of Wagoner, Arizona. Wagoner is situated about sixty (60) miles north of Phoenix, Arizona.

The area under discussion in this study is one of modest relief, with altitudes ranging from four thousand (4,000) feet in the valley floor to a height of six thousand (6,000) feet at the ridge of the Silver Mountain Range about one and a half miles from the mine. The "Boaz" mine is situated about fifty three hundred (5,300) feet.

The property consists of six (6) patented claims with approximately one hundred (100.141) acres. A good road that can be traveled the year around makes the property continuously accessible.

The general area several years back at the turn of the century was one of the states largest producing silver and gold mining districts.

GEOLOGY

Most of the rocks exposed in the "BOAZ" mining area make up a metamorphosed pre-Cambrian complex of volcanic rocks, tuffaceous rocks and sedimentary rocks and associated intruded igneous rocks of diverac composition. After consider-

able erosion, this pre-Cambrian complex was covered by rhyolite tuff and intruded by associated dikes of late Cretaceous or early Tertiary Age. Later, stocks of quartz monzonite and associated dikes were displaced. Some of the granite found in the area is impregnated with iron pyrites over which lies a series of rocks including quartz veins with glassy quartz and a chalcopryite, galena, and sphalerite. The wall rock of amphibolite shows no sericitization.

All of these rocks have been subjected to faulting and folding and sheer zones have been formed in which there has been a deposition from ascending solutions of vein materials including large veins of high grade silver and gold associated with the iron pyrites and with gangue minerals which are mainly quartz, calcite and brecciated wall rock. The ore in the tunnel has been largely oxidized and in places there were zones of secondary enrichment.

There are two large veins exposed on the property that take on a significant value in this mine. One vein is exposed outside of the tunnel. This particular vein is approximately five (5) wide and runs up the mountain about 150 feet. The ore in this vein averages approximately thirty six dollars (\$36.00) per ton. Some of the ore was extremely rich in values. The second vein was inside the tunnel about seventy five feet (75'), this vein was approximately 55' wide and looked like it could be quite deep.

ASARCO INCORPORATED
HAYDEN PLANT
ASSAY CERTIFICATE

DATE ASSAYED

11/4 1980

14 MARKED

Hand Sample #3369

[illegible]

Net per Ton 84.50

BY

BOAZ MINE - No SAMPLE LOC. or DESCRIPTIONS
(FILE)

ASARCO INCORPORATED
HAYDEN PLANT
ASSAY CERTIFICATE

DATE ASSAYED

11/4 19 E

3KED

Hand Sample # 3368 D

[illegible]

BY

~~CHEA: ST~~

ASSAY CERTIFICATE

BOAZ MINE - No SAMPLE LOC. & DESCRIPTION

11/4 1900

MARKED

Hand Sample # 3374

Line 2 from

5. Alumina

Net 181.00 per T.W.

BY

[Signature]

~~CHEMIST~~

Box 481,
Wickenburg, Arizona,
October 4, 1949.

C. H. Dunning,
Mineral Resources Bureau,
Room 304, Ariz. Title Bldg.
Phoenix, Arizona.

Dear Mr. Dunning:

I am the owner of a group of patented mining claims located in the Tiger mining district of Yavapai county and known as the Boaz Mine, The Jones Mine or the Rankin property. Some three or four years ago I leased it to Moores and Roberts who shipped a little ore but gave up their lease because they had trouble getting labor.

I have been told that they turned into you a good report on the property. Capt. John A. Hassell of Los Angeles is interested in the property and has asked me to write to you for whatever information you can give me on it.

Any information you can give me will be greatly appreciated.

Very truly yours,

Wanda Rankin
(Mrs. J. O. Rankin)

8	02	480
9	02	530
10	03	550
11	10	570
12	14	600
13	30	
14	06	

Boaz

1	02	16	08
2	18	17	28
3	08	18	04
4	16		
5	18		
6	02		

Boaz

May 16, 1946

Mrs. Wanda Rankin
Box 481
Wickenburg, Arizona

Dear Mrs. Rankin:

Mr. E. H. Sweeney of Phoenix, who is well known to this department, would be interested in the Boaz Mine under the terms outlined in your letter of May 11.

Mr. Sweeney is making plans to examine and sample the mine next week and following that we will help you get together on a definite deal. In the meantime he thinks your letter is sufficient to justify him in making the examination.

Hoping it will work out satisfactorily.

Yours very truly,

Chas. H. Dunning
Director

CHD:LP

June 21, 1946

Mr. W. F. Paine
Arizona Barite Co.
Box 926
Mesa, Arizona

Dear Bill:

Enclosed is the assay map of the Southern Bell or Boaz Mine we talked about. This mine is located 33 miles east of Kirkland Junction in Yavapai County.

There is a cave at the point I have marked with a red circle that prevents one from checking the intriguing assays in that area beyond.

According to this map there is in that area about 400 feet of ore averaging about 5.0 feet wide and nearly 1/2 an ounce.

If this is true it would be well worth while, as the whole thing is laid out for rather economical mining, and is readily amenable to sample cyanide milling.

I have confidence in the map as submitted, and feel that one would be well justified in cleaning out that cave to check the assays beyond.

I have gone to some extent to investigate the history of the mine and find that there has been little, if any, work done there since 1902. No one has seen it below water level since then. I talked with the man who was foreman when they sank the main 650 foot shaft, and he said the vein continued in and out of the shaft all the way down but "didn't get any better". The work done where that intriguing ore is, including that 100 foot winze, was done after that, and I can find no authentic stories regarding it.

It may be another of "those things" but I think it justifies looking behind that cave.

One of its best features is that I believe a very reasonable deal can be obtained. Mr. E. H. Sweeney, whom you know, holds the lease and option, and I feel sure he would be amenable to a lot of reason.

Yours sincerely,

Boaz

April 15, 1946

MEMORANDUM

TO: A. C. Nebeker

FROM: Chas. H. Dunning

The letter to Mrs. Rankin, care of L. Older, has been returned for better address. I also wrote to Jack Crist over a week ago but never got an answer.

Will you get this information as soon as possible, or better, see Mrs. Rankin and get all the dope?

CHD:LP

April 5, 1946

Mr. Jack Crist
Wickenburg, Arizona

Dear Jack:

Could you get me the address
of Mrs. Rankin who owns the Boaz Mine and
lives on a ranch up the Hassayampa?

A letter without definite
address has come back unclaimed.

Yours very truly,

Chas. H. Dunning
Director

CHD:LP

Boaz
March 19, 1946

Mrs. Rankin
c/o Mr. L. Older
Wickenburg, Arizona

Dear Mrs. Rankin:

Mr. Nebeker has shown us the assay map of your Boaz Mine and it seems as if this property should interest someone if the terms and conditions are satisfactory.

It would be well if we had more information regarding the property than the map shows, particularly as to what was disclosed below the water level.

Do you know of anyone who is familiar with the lower workings that we could consult?

Please send us any additional information you may have and also an outline of the price and terms.

Yours very truly,

Chas. H. Dunning
Director

CHD:LP

NAME OF MINE: BOAZ
OWNER:

COUNTY: Yavapai
DISTRICT:
METALS: Au

OPERATOR AND ADDRESS

MINE STATUS

Date:	OPERATOR AND ADDRESS
10/45	Chas. F. Moores & Art Robard, Crown King, Ariz.

Date:	MINE STATUS
10/45	Developing
3/46	Idle

Nil Desperandum, Beatrice, High Grade, Surprise, and Atlantic City, patented lode mining claims, situated in the Tiger Mining District, Yavapai County, Arizona, the United States Patent whereof is of record in the office of the County Recorder of Yavapai County, Arizona, in Book 63 of Deeds at page 499, et seq;

Together with the Nil Desperandum Millsite, the United States Patent whereof is of record as aforesaid; and

Together with the Little Annie, patented lode mining claim, situated in said Mining District, County and State, the United States Patent whereof is of record as aforesaid; subject, however, to the rights of George P. Dawson and Florence Dawson, his wife, under that certain deed, executed by Archibald M. Jones and Wanda H. Jones, his wife, of record in the office of said County Recorder in Book 181 of Deeds at pages 244-5.

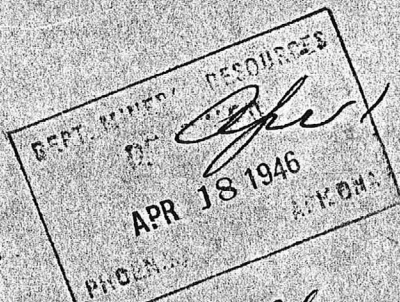

Dear Dunning:

I have had a talk with Mrs Rankin about the Boag mine. She talks me that Mr Moore has promised her, that he would send her the contract he had

if the purchaser wishes
to see us we are living
at the Atox mine 14 miles
north east of Wickenburg
out the Constellation road.

Thanking you for your
interest in the matter,
I am

Very truly yours,

J. B. Rankin

Wanda Rankin

No. 203 De

Phoenix, Arizona,

CHAS. A. DIEHL

May 24, 1946

ARIZONA ASSAY OFFICE

Phone 3-4001

815 North First Street

P. O. Box 11

This Certifies That samples submitted for assay by Department of Mineral Resources contain as follows per ton of 2000 lb.

MARKS	No.	SILVER		VALUE (Oz.)	GOLD		VALUE (Oz.)	TOTAL VALUE Of Gold and Silver	PERCENTAGE		
		Ounces	Tenths		Ounces	Hundredths			%	%	%
							\$35.00				
85' W. of shaft	1				.02		\$.70				
60' W. of shaft	2				.18		\$ 6.30				
15' W. 3'	3				.08		\$ 2.80				
200' E. 7' 8"	4				.16		\$ 5.60				
300' E. 6'	5				.18		\$ 6.30				
400' E. of shaft	6				.02		\$.70				
5' E. 440' N. of shaft	7				.02		\$.70				
480' E. of shaft 6'	8				.02		\$.70				
530 E. 8'	9				.02		\$.70				
	10				.03		\$ 1.05				
1 foot	11				.20		\$ 3.50				
2' 6" winze	12				.14		\$ 4.90				
Face S. tunnel N.	13				.30		\$ 10.50				
apex E. of fault											
Apex 750 E. winze	14				.06		\$ 2.10				
Surface 100' E. of	15				.27		\$ 9.45				
winze.											
Top of raise 25'	16				.08		\$ 2.80				
west of winze.											
Surface top of sft	17				.28		\$ 9.80				
Dump S. tunnel on	18				.04		\$ 1.40				
vein.											

Charges \$18.00

Assayer ARIZONA ASSAY OFFICE



H. C. SMOOT
CHEMIST AND ASSAYER
REGISTRATION NO. 460

CUSTOM ASSAY OFFICE

Assay Certificate



For Carl C. Barth, Jr.

Prescott, Arizona, 9-7-37

DESCRIPTION	GOLD PER TON		SILVER PER TON		GOLD AND SILVER VALUE	OTHER METALS	
	OZS. TROY	VALUE	OZS. TROY	VALUE		PER CENT	VALUE
✓ Silver Doread N Side	1.20	\$ 42.00	8.8	\$ 6.82	\$ 48.82		\$
✓ " " Wall Rock	.02	.70	Trace		.70		
✓ " " S. "	.39	13.65	1.2	.93	14.58		
✓ Campbell Pyrites	.24	8.40	0.2	.15	8.55		
✓ Gold Note	.74	25.90	4.5	3.49	29.39		
Table Concentrates	2.48	86.80	11.7	9.07	95.87		

MARKET VALUES

GOLD PER OZ.	SILVER PER OZ.	COPPER PER LB.	LEAD PER LB.	ZINC PER LB.
35.00	.77			

Charges \$

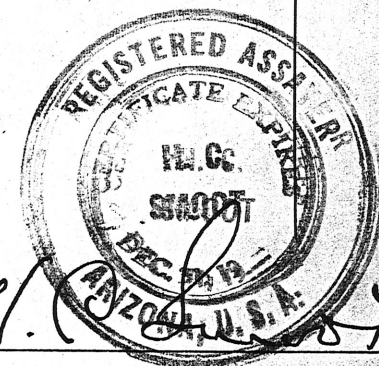

No. 194 Du

Phoenix, Arizona,

April 3, 1946.

CHAS. A. DIEHL

ARIZONA ASSAY OFFICE

Mail: P. O. Box 1148

815 North First Street

Phone 3-4001

THIS CERTIFIES That samples submitted for assay by Mr. J. H. Lanning.

contain as follows per ton of 2000 lbs. Avair.

MARKS	Wt.	SILVER		VALUE (OZ.)	GOLD		VALUE (OZ.)	TOTAL VALUE Of Gold & Silver	PERCENTAGE				REMARKS
		Ounces	Tenths		Ounces	Half							
Screen Heeds		.32			.36		6.47						
Minus 10 mesh-518	397				.095		3.32						
" 30 "	397				.13		4.55						
" 50 "	300				.23		8.17						
" 100 "	330				.41		14.35						

Charges \$ 5.25 (assaying)

Assayer ARIZONA ASSAY OFFICE

Boaz Mine
Southern Bell vein

VALLEY ASSAY OFFICE
AND ORE TESTING LABORATORY
 MEMORANDUM OF ASSAY

Made for **Boas Mine**

Tempe, Arizona, **April 29**

19**68**

SAMPLE NO.	PER TON OF 2000 POUNDS AVOIRDUPOIS								COPPER, OR			LEAD, OR			ZINC			TOTAL	
	GOLD				SILVER														
	AT 38.00 PER OUNCE				AT 2.00 PER OUNCE														
	OZS.	100's	\$	CTS.	OZS.	100's	\$	CTS.	AT	PER LB.		AT	PER LB.		AT	PER LB.		\$	CTS.
1	0.22	7	70		0.70	1	40											9	10
<i>Dump at assay House</i>																			
<i>Wm. L. Lee</i>																			
REMARKS:																			

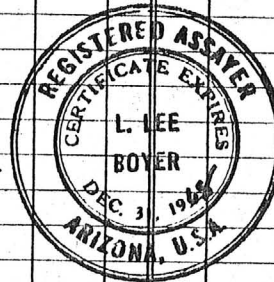

IO.

BY

L. Lee Boyer
 Registered Assayer.

CHARGE \$ **5.00** Pd.

VALLEY ASSAY OFFICE
AND ORE TESTING LABORATORY
 MEMORANDUM OF ASSAY

Made for **Ned C. Fledderjohn**

Tempe, Arizona, **June 30**

19**71**

SAMPLE NO.	PER TON OF 2000 POUNDS AVOIRDUPOIS								COPPER, OR			LEAD, OR			ZINC, OR			TOTAL	
	GOLD				SILVER														
	AT 38.00 PER OUNCE				AT 2.00 PER OUNCE														
	OZS.	100's	\$	CTS.	OZS.	100's	\$	CTS.	AT	PER LB.		AT	PER LB.		AT	PER LB.		\$	CTS.
1	0.52	18	20		6.10	12	20					1.3	3	90				34.30	
REMARKS: Copper is one of the constituents. Also																			

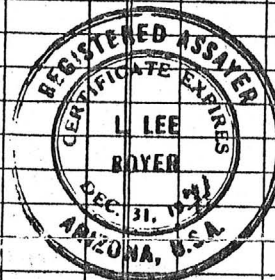

BY

L. Lee Boyer
 Registered Assayer.

ARGE \$ **9.00** Pd.

ATL ARIZONA TESTING LABORATORIES

PHOENIX • TUCSON

A DIVISION OF CLAUDE E. McLEAN & SON LABORATORIES, INC.
 PHONE ALpine 3-6272 817 WEST MADISON ST. P. O. BOX 1888 PHOENIX

Chemists... Engineers

For **Mr. R. R. Kinney** Date **July 23, 1957**
210 South 24th Street
Phoenix, Arizona

Sample of **Ore** Received: **7-23-57**

Submitted by: **Same**

ASSAY CERTIFICATE

Gold figured at \$ **35.00** per ounce. Silver figured at \$ **0.90** per ounce.

Lab. No.	Identification	Gold		Silver		Percentages	
		Oz. per Ton	Value	Oz. per Ton	Value		
135941	No Mark	26.80	\$938.00				

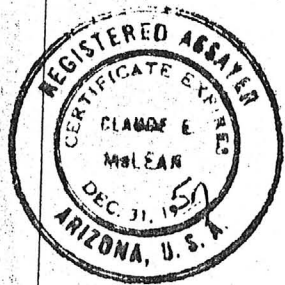

Respectfully submitted,
 ARIZONA TESTING LABORATORIES
Claude E. McLean
 Claude E. McLean

Charges: \$ **2.00** (Paid - Receipt #5893)
 10M ANPCO

RESEARCH
 ASSAY
 ORE TESTING
 PHYSICAL TESTING

Phoenix, Arizona.

CHAS. A. DIEHL

May 24, 1946

ARIZONA ASSAY OFFICE

Phone 3-4001

815 North First Street
Department of Mineral Resources

P. O. Box 1148

This Certifies That samples submitted for assay by

contain as follows per ton of 2000 lbs. Avair.

MARKS	No.	SILVER Ounces Tenth	VALUE Dollars	GOLD Ounces Tenth	VALUE Dollars	TOTAL VALUE Of Gold and Silver	% PERCENTAGE	REMARKS
					\$35.00			
85' W. of shaft	1			.02	\$.70		
60' W. of shaft	2			.18	\$	6.30		
15' W. 3'	3			.08	\$	2.80		
200' E. 7' 8"	4			.16	\$	5.60		
300' E. 6'	5			.18	\$	6.30		
400' E. of shaft	6			.02	\$.70		
5' E. 440' N. of shaft	7			.02	\$.70		
480' E. of shaft 6'	8			.02	\$.70		
530 E. 8'	9			.02	\$.70		
	10			.03	\$	1.05		
1 foot	11			.10	\$	3.50		
2' 6" winze	12			.14	\$	4.90		
Face S. tunnel N.	13			.30	\$	10.50		
apex E. of fault								
Apex 750 E. winze	14			.06	\$	2.10		
Surface 100' E. of	15			.27	\$	9.45		
winze.								
Top of raise 25'	16			.08	\$	2.80		
west of winze.								
Surface top of sft	17			.28	\$	9.80		
Dump S. tunnel on	18			.04	\$	1.40		
vein.								

Boaz mine
Southern Belle Vein

Charges \$18.00

Assayer ARIZONA ASSAY OFFICE

STATE OF ARIZONA, County of Yavapai—ss.

942203

ARIZONA TITLE INSURANCE & TRUST CO.

I do hereby certify that the within instrument was filed and recorded at the request of
on March 7 A.D., 196 7 at 11:05 o'clock P. M. Book 434 Official Records
Page 311 Records of Yavapai County, Arizona.

WITNESS my hand and official seal the day and year first above written.

FRANK C. BAUER, County Recorder.

By Bredlyn D. Jones

Deputy

Compared

Photostated

Fee:

Witness my hand and official seal.

N. C. "KELLY" MOORE, County Recorder

By

Deputy Recorder

INDEXED

When recorded, mail to:

Arizona Title

P.O. Box 3915

Phoenix, Arizona

244865

Joint Tenancy Deed

For the consideration of Ten Dollars, and other valuable considerations, I or we,

A. R. LEE and AUDREY LEE, husband and wife, as to an undivided one-half interest and WANDA H. RANKIN, a widow, as to an undivided one-half interest do hereby convey to
WALTER W. FRANK and SUSIE A. FRANK, husband and wife, and RICHARD W. FRANK a single man,
as tenants in common and not as community property estate, but as joint tenants with right of survivorship, the following described property situated in the County of Maricopa, State of Arizona.

Yavapai,

BEATRICE, HIGH GRADE, SURPRISE and NIL DESPERANDUM lode Mining Claims and NIL DESPERANDUM MILL SITE, designated by the Surveyor General as Lots numbered 1557A and 1557B, United States Patent whereof is of record in Book 63 of Deeds at Page 499, et seq., in the office of the County Recorder of Yavapai County, Arizona and THE ATLANTIC CITY Lode Mining Claim, designated by the Surveyor General as Lot numbered 1675, United States Patent whereof is of record in Book 82 of Deeds at Page 233, et seq.

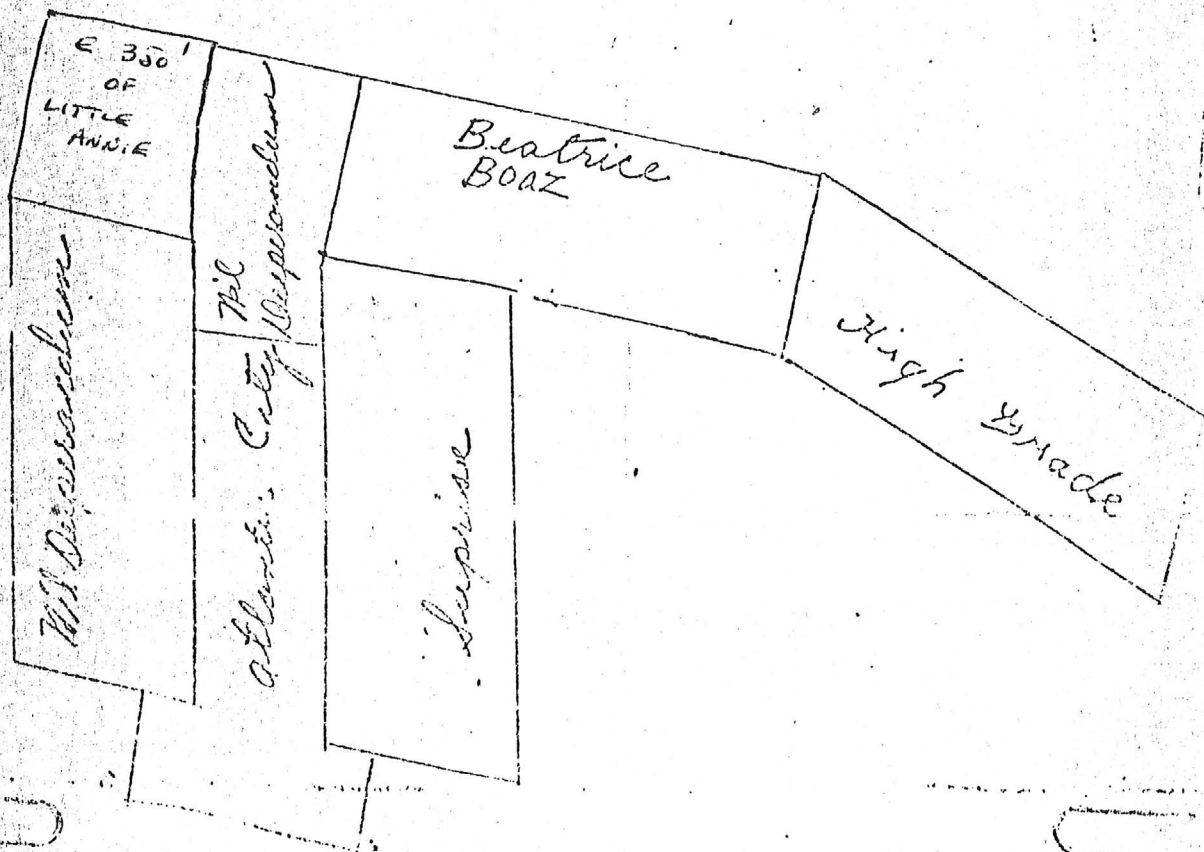

WICKENBURG ORE MARKET
Operated by John C. Herr

Wickenburg, Arizona Aug. 31. 1941. 194...

Settlement for Lot No. 706

Classification:

Shipper: A. M. Jones
Address: Wagoner Ariz.

Net Weight of Lot: 1166 lbs.
Moisture: 7% per cent 81 lbs.

Name of Claim: Southern Belle:
Mining District: Tiger:
County: Yavapai:

Net dry weight: 1085 lbs.

Equivalent in tons (2000 lbs.): 0.542 Tons

PAYMENTS PER TON

Assay	Amount Paid For	Rate	Value
Gold: 2.80 ozs.	All	oz. at \$ 32.20	\$ 90.16
Silver: 2.00 ozs.	All	oz. at 70	1.40
Copper: Pct.		lbs. at	
Lead: 3% Pct.	None	lbs. at	

Value per ton at shipping point: \$ 91.56

Freight Rate per ton: \$ 5.00

Smelter—Treatment per ton: 6.00

\$ 11.00

Net smelter value per dry ton: \$ 80.56

WICKENBURG ORE MARKET

Operated by John C. Herr

Wickenburg, Arizona Aug. 1st. 1941. 194...

Settlement for Lot No. 1069

Classification:

Shipper: A. M. Jones:
Address: Wagoner Ariz.

Net Weight of Lot: 649 lbs.
Moisture: 12% per cent 77 lbs.

Name of Claim: Boaz.
Mining District: Tiger
County: Yavapai:

Net dry weight: 572 lbs.

Equivalent in tons (2000 lbs.): 0.286 Tons

PAYMENTS PER TON

Assay	Amount Paid For	Rate	Value
Gold: 4.80 ozs.	All	oz. at \$ 32.20	\$ 154.56
Silver: 4.30 ozs.	All	oz. at 70	3.01
Copper: Pct.		lbs. at	
Lead: Pct.		lbs. at	

Value per ton at shipping point: \$ 157.57

Freight Rate per ton: \$ 7.00

Smelter—Treatment per ton: 6.00

\$ 13.00

Net smelter value per dry ton: \$ 144.57

Operated by John C. Herr

Wickenburg, Arizona April 26th 1941 1941

Settlement for Lot No. 875

Classification:

Shipper: A. M. Jones:
Address: Wagoner, Ariz.

Name of Claim: Southern Belle:
Mining District: Tiger:
County: Yavapai:

Net Weight of Lot: 2130 lbs.
Moisture: 3% per cent 63 lbs.

Net dry weight: 2067 lbs.

Equivalent in tons (2000 lbs.): 1.033 Tons

PAYMENTS PER TON

Assay	Amount Paid For	Rate	Value
Gold: 1.50	ozs. All	oz. at \$ 32.20	\$ 48.30
Silver: 1.50	ozs. All	oz. at 70	1.05
Copper:	Pct.	lbs. at	
Lead:	Pct.	lbs. at	

Value per ton at shipping point: \$ 49.35

Freight Rate per ton: \$ 3.60
Smelter—Treatment per ton: 6.00

\$ 9.60 \$ 9.60

Net smelter value per dry ton: \$ 39.75

WICKENBURG ORE MARKET

Operated by John C. Herr

Wickenburg, Arizona Oct. 21st 1941 1941

Settlement for Lot No. 1203

Classification:

Shipper: A. M. Jones.
Address: Wagoner Ariz.

Southern Belle Mine
Name of Claim: Boaz.
Mining District: Tiger:
County: Yavapai:

Net Weight of Lot: 1160 lbs.
Moisture: 6% per cent 70 lbs.

Net dry weight: 1090 lbs.

Equivalent in tons (2000 lbs.): 0.545 Tons

PAYMENTS PER TON

Assay	Amount Paid For	Rate	Value
Gold: 4.10	ozs. All	oz. at \$ 32.20	\$ 132.02
Silver: 2.30	ozs. All	oz. at 70	70
Copper:	Pct.	lbs. at	
Lead:	Pct.	lbs. at	

Value per ton at shipping point: \$ 132.72

Freight Rate per ton: \$ 6.10
Smelter—Treatment per ton: 6.00

\$ 12.10 \$ 12.10

Net smelter value per dry ton: \$ 120.62

THIS AGREEMENT, made this ____ day of August, 1946, between WANDA JONES RANKIN, of Wickenburg, Arizona, first party, and E. H. SWEENEY, of Phoenix, Arizona, second party:

WITNESSETH:

That first party, for and in consideration of the sum of Twenty Five Dollars, lawful money of the United States, to her in hand paid by second party, and the further covenants and agreements, hereinafter set forth, to be performed by second party, has given and granted, and by these presents does give and grant, unto second party, the sole and exclusive option to lease and purchase the following described mining claims and millsite, on the terms and conditions hereinafter set forth, to-wit:

Nil Desperandum, Beatrice, High Grade, Surprise, and Atlantic City, patented lode mining claims, situated in the Tiger Mining District, Yavapai County, Arizona, the United States Patent whereof is of record in the office of the County Recorder of Yavapai County, Arizona, in Book 63 of Deeds, at page 499, et seq;

Nil Desperandum Millsite, the United States Patent whereof is of record as aforesaid;

Little Annie, patented lode mining claim, situated in said Mining District, County and State, the United States Patent whereof is of record as aforesaid; subject, however, to the rights of George P. Dawson and Florence Dawson, his wife, and their successors in interest, under that certain deed, executed by Archibald M. Jones and Wanda H. Jones, his wife, of record in the office of said County Recorder in Book 161 of Deeds, at pages 244-5.

The option herein granted may be exercised by second party by giving written notice to first party at any time prior to the expiration of sixty (60) days after the date hereof, during which time second party shall have the right to go upon said mining claims, examine the workings thereof, and take samples of ore, and upon such

exercise second party shall be deemed to have a lease of said mining claims and millsite, upon the following terms and conditions, to-wit:

(1) Second party shall have the right to the possession of said mining claims, millsite and premises for mining purposes, together with the right of ingress and egress to and from the same, and to extract, remove and ship for milling or smelting ores therefrom; subject, however, to the right of first party and persons identified in interest with her, which is hereby expressly reserved, to the full use of said premises for grazing of livestock and purposes incidental thereto; provided such use shall not interfere with the mining operations of second party, it being understood that only a small part of the surface of said premises will be necessary for mining.

(2) Second party covenants and agrees to pay to first party a royalty equal to five per cent (5%) of the net smelter or mill returns from all ores and mineral substances removed from said mining claims, or of the values of all ores taken at the head of the mill in the event a mill should be constructed on said property; provided, however, that such royalty, or minimum rental, shall not be less than Twenty Five Dollars (\$25.00) per month, payable monthly, on the _____ day of each month, commencing with the month of September, 1946, and continuing throughout the entire term this lease remains in effect. All royalty payments on ores actually shipped for treatment by smelter or mill shall be paid within ten (10) days following the receipt of returns, and all such payments shall be accompanied by duplicate copies of smelter or mill returns. Second party shall be entitled

to deduct minimum royalty payments from actual royalties in excess of the minimum, but only for the month in which such payments are made.

(3) The term "net smelter or mill returns", as herein used, shall be construed to mean the net values found and accounted for by the smelter, mill, or other place of treatment and sale, less smelter, mill or other treatment charges, penalties and deductions; railway transportation or the reasonable cost of trucking between railway shipping points, and taxes, if any, levied on the production and/or sale of metals.

(4) Second party shall perform all work on said mining claims in a good and minerlike manner, in conformity with the laws of the State of Arizona and the rules and regulations of the State Mine Inspector.

(5) Second party shall pay all direct property taxes levied on said mining claims during the life of this lease, commencing with taxes to be levied for the year 1946, as well as taxes levied on personal property which may be brought upon said premises, before the same shall become delinquent.

(6) First party shall have the right at all times to go upon said property and into all working places for the purposes of inspection and examination; to inspect and examine all books of account and other records kept by second party in connection with the working of said property, and to take copies of the same, and second party agrees to furnish first party all information concerning his operation of said property upon request.

(7) The term of this lease shall be ten (10) years, commencing with the date hereof, and second party

shall have the right and option, during said term, to purchase said mining claims, millsite and premises for the price of Seventy Five Thousand Dollars (\$75,000.00), all royalty payments hereafter to be made hereunder to be credited on said price. In the event second party shall, within said term, pay an amount equal to one-half of said price, he shall have the right to renew this lease and option to purchase for an additional term of ten (10) years, on all the terms and provisions herein set forth.

(8) Second party agrees to record, post, and keep continuously posted, in the manner required by law, a notice of non-liability for labor performed and materials furnished, as provided by law; and further agrees to comply in all respects with the Workmen's Compensation Law of the State of Arizona, and to that end keep all premiums for liability insurance currently paid or covered by deposit in accordance with the rules of the Industrial Commission of Arizona.

(9) Upon the payment in full of the purchase price herein named, first party shall execute and deliver to second party a good and sufficient mining deed of the herein described mining claims, millsite and premises, and second party covenants and agrees with first party to keep and preserve said property free of liens and encumbrances of every kind and character.

(10) Upon the expiration or earlier termination of this lease second party shall have the right to remove from said property all machinery, equipment, tools, appliances, and improvements or property of every kind and character which he may have installed or brought thereon, save only timbers and pipe installed underground, within

six months after such expiration or termination; provided second party shall not be in default in the performance of any of his duties or obligations hereunder.

So long as second party shall perform this agreement on his part he shall have and enjoy the peaceable possession and quiet enjoyment of said property, subject to the conditions herein named; but if default be made in the payment of any of the sums of money herein required of him to be paid, or if second party shall fail to keep or perform any of the covenants, conditions or agreements herein required of him to be kept or performed, first party shall have the right, by giving second party ten (10) days prior written notice and demand of performance to declare this agreement terminated, and if, at the expiration of said time, the default or defaults in respect of which such notice shall have been given be not cured, this agreement shall stand terminated and at an end, first party shall be entitled to recover the actual and peaceable possession of said premises, with all improvements and betterments thereto, all sums of money theretofore paid by second party hereunder shall be deemed forfeited to first party as liquidated damages for the breach of this agreement and as reasonable rental for the use and occupancy of said premises, and all parties hereto shall thereupon stand relieved of further obligation hereunder.

Second party shall not assign this agreement, or any interest therein, or sublet the whole or any part of said premises, without the prior written consent of first party.

The covenants, conditions and agreements herein

contained shall extend to, be binding on, and inure to the benefit of the heirs, executors, administrators, and permitted assigns of the respective parties hereto.

IN WITNESS WHEREOF, the parties have hereunto set their hands the day and year first above written.

First Party

Second Party

STATE OF ARIZONA)
) SS.
COUNTY OF MARICOPA)

THIS INSTRUMENT was acknowledged before me this _____ day of August, 1946, by Wanda Jones Rankin, first party within named.

My commission expires _____

Notary Public

STATE OF ARIZONA)
) SS.
COUNTY OF YAVAPAI)

THIS INSTRUMENT was acknowledged before me this _____ day of August, 1946, by E. H. Sweeney, second party within named.

My commission expires _____

Notary Public

July 12, 1946

Mr. Leo T. Stack
Valley National Bank Bldg.
Prescott, Arizona

Dear Leo:

In regard to the Wanda Jones agreement the factors of royalty and minimum royalty were agreed upon.

I agree with you that there should be some time limit but the proposition would be much more acceptable with a 20 year life than a 10 year.

There would be no objection to a proper forfeiture clause.

In consideration of the minimum royalty there could be no minimum working requirements. Those things are often beyond the control of the operator now days and if Mrs. Jones can draw down \$25.00 per month from now on, I would think she would be very happy. It would take quite a large cash investment to return that at present interest rates and then there are the taxes too.

So why don't you fix this up, Leo, the way you want it, and I'll try it out on Sweeney.

Sincerely,

Chas. H. Dunning
Director

CHD:LP

Boa Mine

LEO T. STACK
ATTORNEY-AT-LAW
VALLEY NATIONAL BANK BUILDING
PRESCOTT ARIZONA

August 10, 1946

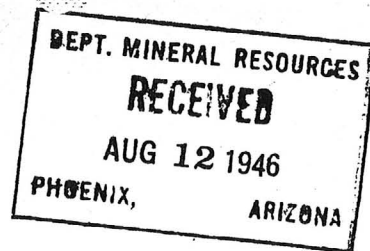

Department of Mineral Resources,
304 Home Builders Bldg.,
Phoenix, Arizona.

Attention: Mr. C. H. Dunning,
Director

Dear Chuck:

Sorry to have delayed so long in rewriting
the lease between Mrs. Rankin and E. H. Sweeney.

However, it is enclosed. I think I have
drawn a fair contract, embracing all the terms here-
tofore agreed on and the usual provisions.

If this contract is acceptable to Mr. Sweeney
please have him sign and acknowledge both copies and
return them to me, when I will have them executed by
Mrs. Rankin and return you one fully executed copy.

Also have Mr. Sweeney send me one check pay-
able to Mrs. Rankin for \$25.00 to cover the first
advance royalty, and one to me for \$26.00 to cover my
fee, plus \$1.00 for recording the notice of non-liability.

Awaiting your further advice, I remain,

Very truly yours,

A large, stylized handwritten signature in dark ink, appearing to read "Leo T. Stack".

LTS:M

August 14, 1946

Mr. Leo T. Stack
Attorney-at-Law
Valley National Bank Bldg.
Prescott, Arizona

Dear Leo:

I submitted your letter of the 10th inst., together with its enclosure of proposed agreement, to Mr Sweeney who referred it to his attorney, Fred J. Elliott.

The latter promptly advised Mr. Sweeney that he could not concur with the proposed changes, and that it is apparent that you had in mind the duty you deem necessary to protect Mrs. Rankin beyond the original intent. Mr. Elliott feels that charges for services should be rendered to your client and not to his client.

Mr. Sweeney informs me that under the circumstances he is no longer interested in the property.

Very truly yours

Chas. H. Dunning
Director

CHD/ba

August 16, 1946

Mrs. Wanda Rankin
Box 987
c/o Homer Edwards
Prescott, Arizona

Dear Mrs. Rankin:

We are sorry that this Department seemed unable to bring you and a possible buyer for your property together.

We have a great many requests for feasible properties but the old method of 10% royalty, down payment, etc., will not be considered by legitimate buyers under present conditions. The cream of high-grade properties has been picked, and the owners of those marginal or low-grade properties that are left must realize that the old regime is out and they will have to grant more favorable conditions for the investor or operator.

I advised Mr. Sweeney the best I knew how. He has many persons wanting small mines, but they will not enter into any agreement that doesn't give them, who must venture their money, a fair break. Such items as the non-assignable clause which Mr. Stack injected into the agreement makes it impossible. In fact, nearly every paragraph had a monkey wrench in it.

Why Mr. Stack should also expect Mr. Sweeney to pay him for writing an agreement, especially designed and worded to be impossible from a buyer's point of view, also seems most strange and added to Mr. Sweeney's disgust.

We are enclosing a copy of the correspondence with Mr. Stack.

Yours very truly

Chas. H. Dunning
Director

CHD/ba

October 10, 1949

Mrs. J. O. Rankin
Box 481
Wickenburg, Arizona

Dear Mrs. Rankin:

We have your letter regarding the Boaz Mine, etc.

The only thing we have is an assay map on the Boaz and as that was obtained from you by Mr. Nebeker, we presume you have a copy.

Sorry that we do not have any farther information.

Yours very truly,

CHD:mh

Chas. H. Dunning
Director

I expect to be in Prescott for a few weeks at the above address.

Very truly yours,

Wanda Parkin

(Mrs. J. Q. Parkin)

Box 987, K4 mes Edwards,
Prescott, Arizona
June 20, 1946

Mr. C. H. Dunning,
Director of Dept. of Mineral Resources,
404 Arizona Title Building,
Phoenix, Arizona

Dear Mr. Dunning,

It has been some time since I
heard from you about the Boggy Mine. I have
been wondering if Sweeney ever sampled it and
if so what he found and what his intentions
are. I stopped in today to see Mr. Meeker but
he knew nothing more about it.

I just received a letter from David B.
Molven, a real estate broker in Desert Hot Springs,
California, asking about the property so if you
are no longer interested please let me know
Mr. Molven may write to you or I gave him
your address and referred him to you as to
whether the property was open for a deal.

6008
June 26, 1946

Mrs. J. O. Rankin
c/o Homer Edwards
Box 987
Prescott, Arizona

My dear Mrs. Rankin:

I got Mr. Sweeney together with an attorney in whom we all have confidence (Mr. F. J. Elliott) and we made up an agreement which we are enclosing for your approval.

I might say that Mr. Sweeney went to the mine and took several samples. These worked out fairly well except that one important section did not seem to check. However, he seems to feel sufficiently encouraged to go ahead and plan to get behind that cave and examine that section which seems to have real values. It will cost quite a little money.

I have done the best I know how in helping frame this agreement, to be fair to both of you, and I trust it will meet with your approval.

We are enclosing an extra copy, so you can keep one for yourself, and if everything is satisfactory, I will see that a copy signed by Mr. Sweeney is returned to you forthwith.

Mr. Sweeney would particularly like to have a copy of the smelter settlements or records of the ore recently shipped by Mr. Moores. We presume you were furnished with a copy of same, and even in case you only have one copy, if you will send it to this department, we will take off the necessary data and assure you that the original will be returned to you.

Trusting this department has been able to do something of benefit to you as a prospect owner.

Yours very truly,

Chas. H. Dunning
Director

CHD:LP
Enc. 2

LEO T. STACK
ATTORNEY-AT-LAW
VALLEY NATIONAL BANK BUILDING
PRESCOTT ARIZONA

July 11, 1946

Department of Mineral Resources,
304 Home Builders Bldg.,
Phoenix, Arizona.

Attention: Mr. Chas. H. Dunning,
Director

Dear Chuck:

Mrs. Wanda Jones has shown me the agreement you forwarded to her on her claims.

There are some objections to it. A royalty of 5% is too low, and a minimum payment of \$25 per month is not enough, but in case these factors have been agreed on the substantial objection is that no time for the exercise of the option is provided. If my figures are not in error this option could run over a period of 250 years. I think a reasonable limit, such as ten years, should be fixed.

A further objection is that there is no forfeiture clause. In contracts such as this I usually provide for termination on ten days prior written notice.

I also notice there are no minimum working requirements. In a case such as this, where the minimum royalty is low, I think there should be some reasonable rate of work.

You might also suggest to your attorney that he use acknowledgments instead of jurats.

The description is indefinite, and so I am enclosing a copy of the description used in the Moores contract.

Please let me have your comments.

Very truly yours,

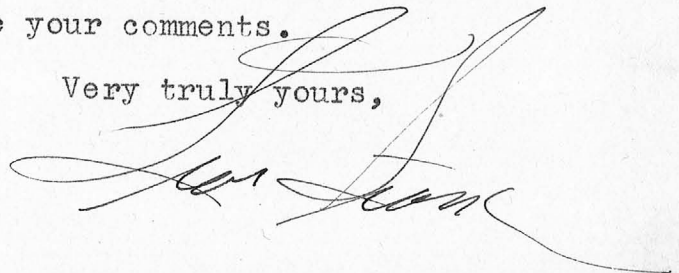

LTS:M

Survey No 1675 ✓
Pilsco's Land District

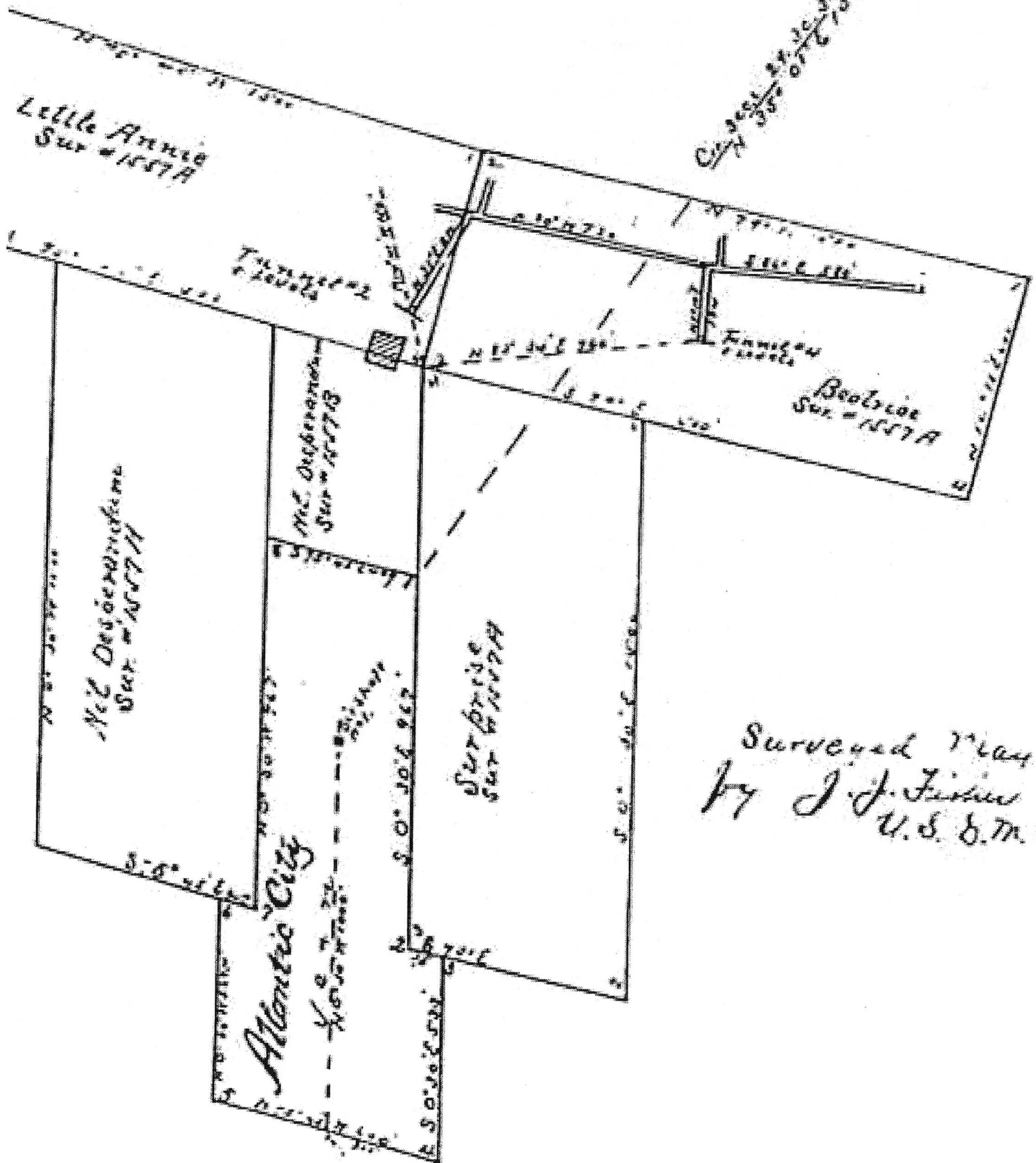

Surveyed May 27-
by J. J. Fisher
U. S. S. M. Sur

$C_{\text{in}} = \frac{360}{N} \times \frac{27}{35} \times \frac{30}{8} \times \frac{32}{16} \times \frac{38}{5} \times \frac{7}{2} \times \frac{10}{4} \times \frac{11}{2} \times \dots$

Thyridopteryx

Mr. DeLoach
JAN 27 1963

Revol. 100
S. 100 - 100

Yitz Desiderius
Sec. 11/27/11

42-6749-100

Atlantic City

Surveyed May 27-
by J. J. Fisher
U. S. S. M. Suer

H. C. SMOOT
CHEMIST AND ASSAYER
REGISTRATION NO. 460

CUSTOM ASSAY OFFICE

Assay Certificate



For Carl G. Barth, Jr.,

Prescott, Arizona, 9-7-37

DESCRIPTION	GOLD PER TON		SILVER PER TON		GOLD AND SILVER VALUE	OTHER METALS	
	OZS. TROY	VALUE	OZS. TROY	VALUE		PER CENT	VALUE
✓ Silver Dollad N Side	1.20	\$ 42.00	8.8	\$ 6.82	\$ 48.82		\$
4 " " Wall Rock	.02	.70	Trace		.70		
3 ✓ " " S. "	.39	13.65	1.2	.93	14.58		
5 Campbell-Pyrites	.24	8.40	0.2	.15	8.55		
6 Gold-Note	.74	25.90	4.5	3.49	29.39		
Table Concentrates	2.48	86.80	11.7	9.07	95.87		

MARKET VALUES

GOLD PER OZ.	SILVER PER OZ.	COPPER PER LB.	LEAD PER LB.	ZINC PER LB.
35.00	.77			

Charges \$

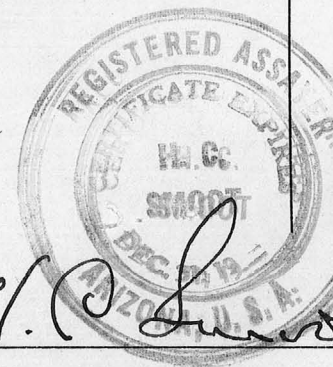

H. C. Smoot

No. 203 De

Phoenix, Arizona,

CHAS. A. DIEHL

May 24, 1946

ARIZONA ASSAY OFFICE

Phone 3-4001

815 North First Street

P. O. Box 1148

This Certifies That samples submitted for assay by

Department of Mineral Resources

contain as follows per ton of 2000 lbs. Avoir.

MARKS	No.	SILVER		VALUE (Oz.)	GOLD		VALUE (Oz.)	TOTAL VALUE Of Gold and Silver	PERCENTAGE			REMARKS
		Ounces	Tenths		Ounces	Handths			%		%	
							\$35.00					
85' W. of shaft	1				.02		\$.70					
60' W. of shaft	2				.18		\$ 6.30					
15' W. 3'	3				.08		\$ 2.80					
200' E. 7' 8"	4				.16		\$ 5.60					
300' E. 6'	5				.18		\$ 6.30					
400' E. of shaft	6				.02		\$.70					
5' E. 440' N. of shaft	7				.02		\$.70					
480' E. of shaft 6'	8				.02		\$.70					
530 E. 8'	9				.02		\$.70					
	10				.03		\$ 1.05					
1 foot	11				.10		\$ 3.50					
2' 6" winze	12				.14		\$ 4.90					
Face S. tunnel N.	13				.30		\$ 10.50					
apex E. of fault												
Apex 750 E. winze	14				.06		\$ 2.10					
Surface 100' E. of	15				.27		\$ 9.45					
winze.												
Top of raise 25'	16				.08		\$ 2.80					
west of winze.												
Surface top of sft	17				.28		\$ 9.80					
Dump S. tunnel on	18				.04		\$ 1.40					
vein.												

Charges \$18.00

Assayer ARIZONA ASSAY OFFICE

Phoenix, Arizona,

April 3, 1946.

Boon

CHAS. A. DIEHL

ARIZONA ASSAY OFFICE

Mail: P. O. Box 1148

815 North First Street

Phone 3-4001

CERTIFIES That samples submitted for assay by **Mr. C. H. Dunning.**

contain as follows per ton of 2000 lbs. Avoir.

[illegible]

\$ 5.25 (assaying)

Assayer ARIZONA ASSAY OFFICE

94 Du

Phoenix, Arizona,

April 3, 1946.

Bum

CHAS. A. DIEHL

ARIZONA ASSAY OFFICE

Mail: P. O. Box 1148

815 North First Street

Phone 3-4001

CERTIFIES That samples submitted for assay by Mr. C. H. Dunning.

contain as follows per ton of 2000 lbs. Avoir.

MARKS	Wt.	SILVER		VALUE (OZ.)	GOLD		VALUE (OZ.)	TOTAL VALUE Of Gold & Silver	PERCENTAGE				REMARKS
		Ounces	Tenths		Ounces	Handths							
en Heads			.32			21	35.00						
Gr.						185	6.47						
s 10 mesh-518						.095	3.32						
30 "	397					.13	4.55						
50 "	300					.231	8.17						
100 "	330					.41	14.35						

s \$ 5.25 (assaying)

Assayer ARIZONA ASSAY OFFICE

No 8-

480 E of shaft
6'

#

" 9-530' E. " " "
8'

2003

#

" 10-550 E of shaft-
5' @ Raise

#

1-11-570 E. of shaft-
1'

#

No 12-600 @ Wing
2'

#

" 13- Small tunnel
on approx 70' E of Wing
E of fault

Sample
1 - 85' West of Shaft
3'6" #

2 - 60' W of Shaft
3'6" #

3 - 15' West of Shaft
3' #

4 - 200' East
7'6" #

5 - 300' East of Shaft
5' #

6 - 400' East of Shaft
5' #

7 - 440 " " " " " "
5' #

14 Apex. 4"
 750' E. - Wing. 119
~~15 X 181~~
~~15 Top of Rains 363~~
~~300' W of Wing - 148~~
~~#~~

15 Surface 100 E
 J. Wing 1200
 X

16 Top of Rains 25'
 West of Wing
 #

17 Top of Shaft-

18 X
 Drunk sample of
 short-tunnel in vein
 South of Old Antea