



CONTACT INFORMATION

Mining Records Curator
Arizona Geological Survey
1520 West Adams St.
Phoenix, AZ 85007
602-771-1601
<http://www.azgs.az.gov>
inquiries@azgs.az.gov

The following file is part of the

Arizona Department of Mines and Mineral Resources Mining Collection

ACCESS STATEMENT

These digitized collections are accessible for purposes of education and research. We have indicated what we know about copyright and rights of privacy, publicity, or trademark. Due to the nature of archival collections, we are not always able to identify this information. We are eager to hear from any rights owners, so that we may obtain accurate information. Upon request, we will remove material from public view while we address a rights issue.

CONSTRAINTS STATEMENT

The Arizona Geological Survey does not claim to control all rights for all materials in its collection. These rights include, but are not limited to: copyright, privacy rights, and cultural protection rights. The User hereby assumes all responsibility for obtaining any rights to use the material in excess of "fair use."

The Survey makes no intellectual property claims to the products created by individual authors in the manuscript collections, except when the author deeded those rights to the Survey or when those authors were employed by the State of Arizona and created intellectual products as a function of their official duties. The Survey does maintain property rights to the physical and digital representations of the works.

QUALITY STATEMENT

The Arizona Geological Survey is not responsible for the accuracy of the records, information, or opinions that may be contained in the files. The Survey collects, catalogs, and archives data on mineral properties regardless of its views of the veracity or accuracy of those data.

PRINTED: 11/21/2002

ARIZONA DEPARTMENT OF MINES AND MINERAL RESOURCES AZMILS DATA

PRIMARY NAME: ARIZONA

ALTERNATE NAMES:

ARAVAIPA MINING CORP.
PATENTED CLAIMS MS 1038
TULE UNPAT. CLAIMS

GRAHAM COUNTY MILS NUMBER: 146B

LOCATION: TOWNSHIP 5 S RANGE 19 E SECTION 25 QUARTER W2
LATITUDE: N 32DEG 58MIN 08SEC LONGITUDE: W 110DEG 21MIN 35SEC
TOPO MAP NAME: COBRE GRANDE MTN - 7.5 MIN

CURRENT STATUS: DEVEL DEPOSIT

COMMODITY:

LEAD SULFIDE
ZINC SULFIDE
SILVER
GOLD
SILICON
MANGANESE OXIDE
IRON FERRIC OXIDE

BIBLIOGRAPHY:

USGS PP. 461, GEOLOGY OF THE KLONDYKE QUAD,
1964, P. 132
AZBM BULL. 156, AZ. ZINC AND LEAD DEPOSITS,
PART 1, 1950, P. 60
SEE ADMMR GRAND REEF FILE (HENDRIKSON REPORT)
ADMMR ARIZONA FILE
SEE ADMMR ARAVAIPA DISTRICT LEAD-ZINC DEPTS.
UNPAT. CLAIMS EXTEND INTO SEC. 26
ADMMR U FILE
DENTON, T.C., ARAVAIPA LEAD ZINC DEPOSITS,
USBM RI 4007, 1947, P. 6
BLM AMC FILE 6032

ARAVAIPA MINING CORP.

REFERENCES

GRAHAM COUNTY
ARAVAIPA DIST.
T5S R19E Sec. 25

MAPS - Upstairs in the ABM rolled file boxes listed under Panama, Havilina, Aravipa Mining Co. maps include the Panama Adit sketch, 3 claim maps and geology sketches.

USGS PP 461, p. 135

Far Mining Enterprises file

USBM RI 4007

BLM Mining District Sheet 747

MAPS - Upstairs in Flat File - Drawer 6 (Aravaipa lead-zinc file)

Graham county MILS Index #146B

ABM Bull. 140, p. 93

ABM Bul.. 156. p. 63

Cobre Grande 7.5' Topo (included in file)

3950 III
AN CARLOS
RESERVOIR
1:62 500

UNITED STATES
DEPARTMENT OF THE INTERIOR
GEOLOGICAL SURVEY

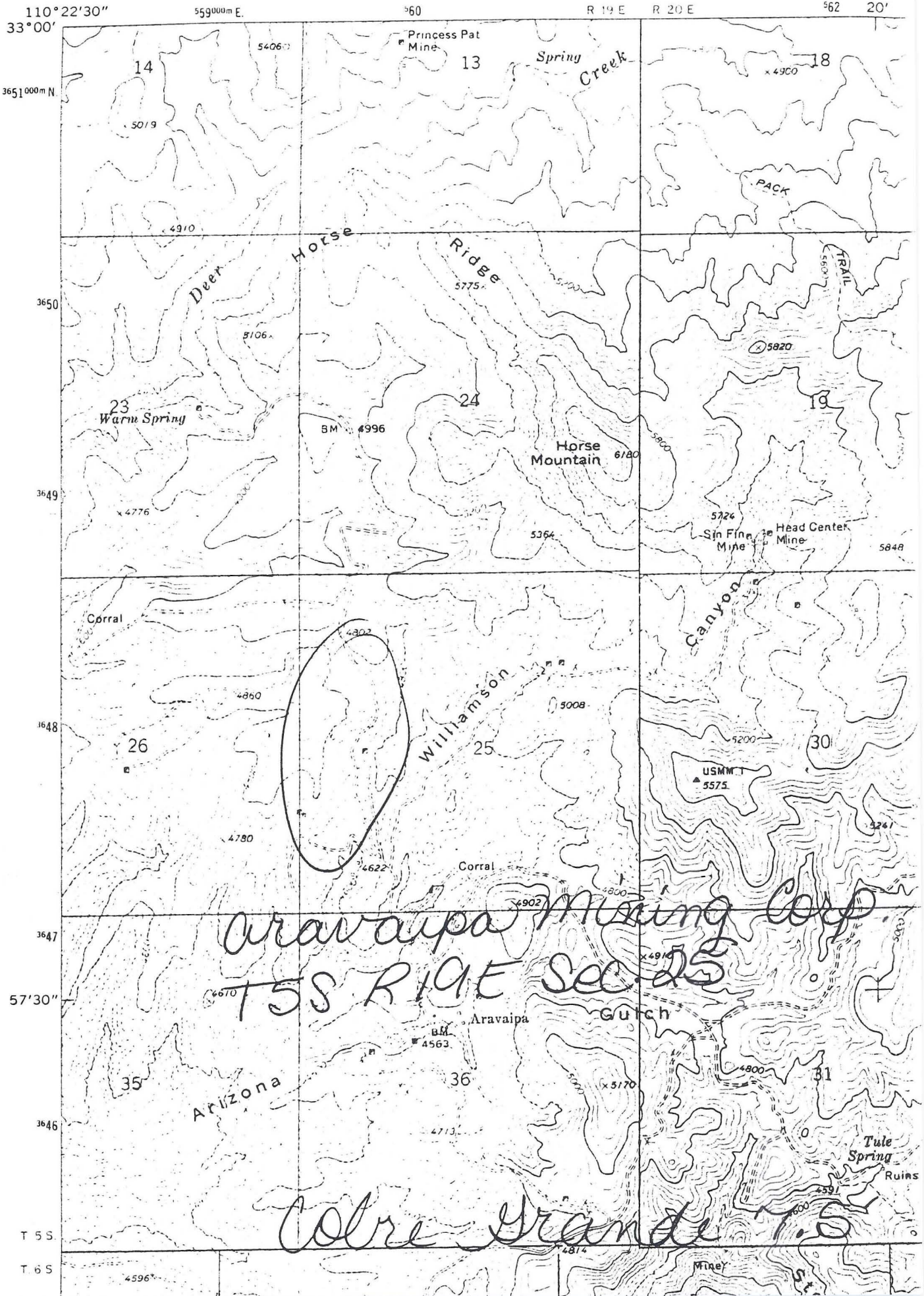

To- JHJ
From-GI

August 15, 1979

ABM bulletin 156: p55

1890-95 Aravaipa Mining Corp. operating in the Northern part of the district, sank Arizona shaft to its present depth of 580' and shipped two carloads of ore.

p60

The Arizona mine is about a mile north of Aravaipa on the west slope of a low southward trending ridge.

Geology And Ore Deposits of the Aravaipa and Standley Mining Districts
by Clyde P. Ross . USGS 763, 1925
Page 96 mentions the Arizona shaft.